

File No. 120460

Committee Item No. 17

Board Item No. _____

COMMITTEE/BOARD OF SUPERVISORS

AGENDA PACKET CONTENTS LIST

Committee: Land Use and Economic Development Date July 16, 2012

Board of Supervisors Meeting Date _____

Cmte Board

- Motion
- Resolution
- Ordinance
- Legislative Digest
- Budget and Legislative Analyst Report
- Legislative Analyst Report
- Youth Commission Report
- Introduction Form (for hearings)
- Department/Agency Cover Letter and/or Report
- MOU
- Grant Information Form
- Grant Budget
- Subcontract Budget
- Contract/Agreement
- Form 126 – Ethics Commission
- Award Letter
- Application
- Public Correspondence

OTHER (Use back side if additional space is needed)

- * Planning Commission Resolution No. 18591
- * Planning Commission Motion No. 18592
- * Notice of Public Hearing
- _____
- _____
- _____
- _____
- _____
- _____
- _____
- _____

Completed by: Alisa Miller Date July 13, 2012

Completed by: _____ Date _____

An asterisked item represents the cover sheet to a document that exceeds 25 pages. The complete document can be found in the file.

1 [General Plan Map - California Pacific Medical Center: Cathedral Hill Campus]

2
3 **Ordinance amending the General Plan of the City and County of San Francisco by: 1)**
4 **amending Map 4 of the Urban Design Element to allow for development up to a height**
5 **of 265 feet on the block bounded by Van Ness Avenue, Geary Boulevard, Franklin and**
6 **Post Streets; 2) amending Map 5 of the Urban Design Element to reflect the proposed**
7 **maximum plan dimensions and maximum diagonal plan dimensions of 385' and 466',**
8 **respectively, for the Cathedral Hill Hospital site and 265' and 290', respectively, for the**
9 **Cathedral Hill Medical Office Building site; 3) amending Map 1 of the Van Ness Area**
10 **Plan, to designate the sites of the proposed Cathedral Hill Hospital and Medical Office**
11 **Building as the Van Ness Medical Use Subdistrict; and 4) amending Map 2 of the Van**
12 **Ness Area Plan to create a 265-V height/bulk district coterminous with the Hospital site;**
13 **and adopting findings, including environmental findings, Planning Code Section 340**
14 **findings, and findings of consistency with the General Plan and the priority policies of**
15 **Planning Code Section 101.1.**

16 NOTE: Additions are *single-underline italics Times New Roman*;
17 deletions are *strike through italics Times New Roman*.
18 Board amendment additions are double-underlined;
Board amendment deletions are ~~strikethrough normal~~.

19 Be it ordained by the People of the City and County of San Francisco:

20 Section 1. Findings. The Board of Supervisors of the City and County of San Francisco
21 hereby finds and determines that:

22 (a) Pursuant to San Francisco Charter Section 4.105 and Planning Code Section
23 340, any amendments to the General Plan shall first be considered by the Planning
24 Commission and thereafter recommended for approval or rejection by the Board of
25 Supervisors. On April 26, 2012, by Resolution No. 10591, the

1 Commission conducted a duly noticed public hearing on the General Plan Amendments
2 pursuant to Planning Code Section 340, found that the public necessity, convenience and
3 general welfare require the proposed General Plan Amendments, adopted the General Plan
4 Amendments, and recommended them for approval to the Board of Supervisors. A copy of
5 Planning Commission Resolution No. 10591 is on file with the Clerk of the Board
6 of Supervisors in File No. 120460, and the Board hereby incorporates those
7 findings by reference.

8 (b) The Board finds that this ordinance is, on balance, in conformity with the priority
9 policies of Planning Code Section 101.1 and consistent with the General Plan as it is
10 proposed for amendment herein and in the related ordinances amending Maps 4 and 5 of the
11 General Plan Urban Design Element and the Van Ness Area Plan to accommodate the Near-
12 Term Projects at the Cathedral Hill Campus as described in California Pacific Medical
13 Center's Long Range Development Plan (Ordinance Nos. _____ and _____)
14 for the reasons set forth in Planning Commission Motion No. 10592, and the Board
15 hereby incorporates these findings herein by reference.

16 (c) On April 26, 2012, by Motion No. 10500, the
17 Planning Commission certified as adequate, accurate and complete the Final Environmental
18 Impact Report ("FEIR") for the California Pacific Medical Center Long Range Development
19 Plan. A copy of Planning Commission Motion No. 10500 is on file with the Clerk
20 of the Board of Supervisors in File No. 120357. In accordance with the actions
21 contemplated herein, this Board has reviewed the FEIR, and adopts and incorporates by
22 reference, as though fully set forth herein, the findings, including a statement of overriding
23 considerations and the mitigation monitoring and reporting program, pursuant to the California
24 Environmental Quality Act (California Public Resources Code Section 21000 et seq.), adopted
25 by the Planning Commission on April 26, 2012, in Motion No. 10509.

1 Said Motion is on file with the Clerk of the Board of Supervisors in File No. 120357,

2 and is incorporated herein by reference.

3
4 Section 2. The Board of Supervisors hereby approves amendments to the General
5 Plan, as follows:

6 (a) Map 4 (Urban Design Guidelines for Height of Buildings) of the Urban Design
7 Element of the General Plan of the City and County of San Francisco shall be amended to
8 change the height for the site identified for a hospital within the proposed Van Ness Medical
9 Use Subdistrict (Block 0695/Lots 005, 006 and their successor Blocks and Lots) from 161-240
10 feet to up to 265 feet;

11 (b) Map 5 (Urban Design Guidelines for Bulk of Buildings) of the Urban Design
12 Element of the General Plan of the City and County of San Francisco shall be amended to
13 change the bulk limits for the site identified for the proposed Cathedral Hill Hospital (Block
14 0695/Lots 005, 006 and their successor Blocks and Lots) from a maximum plan dimension of
15 110' and maximum diagonal plan dimension of 140' to a maximum plan dimension of 385' and
16 maximum diagonal plan dimension of 466', and to change the bulk limits for the site identified
17 for the proposed Cathedral Hill Medical Office Building (Block 0694/Lots 005, 006, 007, 008,
18 009, 009A, 010 and their successor Blocks and Lots) from a maximum plan dimension of 110'
19 and maximum diagonal plan dimension of 125' to a maximum plan dimension of 265' and
20 maximum diagonal plan dimension of 290'.

21 (c) Map 1 (Generalized Land Use and Density Plan) of the Van Ness Area Plan of
22 the General Plan of the City and County of San Francisco shall be amended to change the
23 Floor Area Ratio (FAR) of the hospital site (Block 0695/Lots 005, 006 and their successor
24 Blocks and Lots) from 7.1:1.0 to 9.0:1.0 and to change the FAR of the site identified for a
25 medical office building within the proposed Van Ness Medical Use Subdistrict (Block

1 0694/Lots 005, 006, 007, 08, 009, 009A, 010 and their successor Blocks and Lots) from
2 7.1:1.0 to 7.5:1.0 and to designate the sites identified for the new hospital and medical office
3 building as the "Van Ness Medical Use Subdistrict"; and

4 (d) Map 2 (Height and Bulk Districts) of the Van Ness Area Plan of the General Plan
5 of the City and County of San Francisco shall be amended to increase the maximum height of
6 the hospital site (Block 0695/Lots 005, 006 and their successor Blocks and Lots) from 130-V
7 to 265-V.

8
9 Section 3. This section is uncodified. Effective Date. This ordinance shall become
10 effective 30 days from the date of passage.

11 APPROVED AS TO FORM:
12 DENNIS J. HERRERA, City Attorney

13
14 By: 
15 AUDREY WILLIAMS PEARSON
16 Deputy City Attorney

LEGISLATIVE DIGEST

[General Plan Map - California Pacific Medical Center: Cathedral Hill Campus]

Ordinance amending the General Plan of the City and County of San Francisco by: 1) amending Map 4 of the Urban Design Element to allow for development up to a height of 265 feet on the block bounded by Van Ness Avenue, Geary Boulevard, Franklin and Post Streets; 2) amending Map 5 of the Urban Design Element to reflect the proposed maximum plan dimensions and maximum diagonal plan dimensions of 385' and 466', respectively, for the Cathedral Hill Hospital site and 265' and 290', respectively, for the Cathedral Hill MOB site; 3) amending Map 1 of the Van Ness Area Plan, to designate the sites of the proposed Cathedral Hill Hospital and Medical Office Building as the Van Ness Medical Use Subdistrict; and 4) amending Map 2 of the Van Ness Area Plan to create a 265-V height/bulk district coterminous with the Hospital site; and adopting findings, including environmental findings, Planning Code Section 340 findings, and findings of consistency with the General Plan and the priority policies of Planning Code Section 101.1.

Existing Law

Currently, maps in the San Francisco General Plan Urban Design Element and Van Ness Area Plan proscribe certain limits to the height, bulk and floor area ratios for developments located near the intersection of Geary Street/Boulevard and Van Ness Avenue.

Amendments to Current Law

This Ordinance amends four maps in the San Francisco General Plan:

- 1) Urban Design Element Map 4, regulating the height of buildings, is amended to allow development of up to 265 feet (from 240 feet) on the site of the proposed new Cathedral Hill Hospital, which is the block bounded by Geary Boulevard, Van Ness Avenue, Post and Franklin Streets.
- 2) Urban Design Element Map 5, regulating the bulk of buildings, is amended to allow maximum dimensions and maximum plan dimensions of 385 feet and 466 feet (from 110' and 140') respectively for the site identified for the proposed Cathedral Hill Hospital, and to allow a maximum plan dimension and maximum diagonal plan dimension of 265 feet and 290 feet (from 110' and 125') respectively, for the site proposed for the Cathedral Hill medical office building, on the block bounded by Van Ness Avenue, Geary Street, Cedar Street and just west of Polk Street.
- 3) Van Ness Area Plan Map 1 is amended to allow floor area ratios of 9.0 to 1 (from 7.1 to 1) for the Cathedral Hill Hospital site, and 7.5 to 1.1 (from 7.1 to 1) for the Cathedral Hill medical

office building site, and to designate the sites for the hospital and office building as the "Van Ness Medical Use Subdistrict."

4) Van Ness Area Plan Map 2, governing height and bulk districts, is amended to allow a maximum height and bulk of 265-V (from 130-V) at the Cathedral Hill Hospital site.

Background Information

California Pacific Medical Center ("CPMC") currently operates four acute care medical centers in San Francisco: the California Campus, the Pacific Campus, the St. Luke's Campus, and the Davies Campus. As part of its program to meet state seismic readiness deadlines, CPMC's Long Range Development Plan ("LRDP") proposes a five campus system with three acute care hospitals – at Davies, St. Luke's, and a new hospital at the proposed Cathedral Hill Campus – providing approximately 903 licensed beds and three full-service emergency departments (one at each of the acute care hospitals). Once the proposed Cathedral Hill Hospital is built at the Cathedral Hill Campus, the acute care services at the California and Pacific campuses will be transferred to the Cathedral Hill Hospital. The Pacific Campus's existing acute care hospital would undergo renovation and reuse as an ambulatory care center. CPMC would sell the California Campus after the transfer of acute care and non-acute care services to the Cathedral Hill and/or the Pacific Campus. In the near term, under the LRDP, CPMC would also construct a new medical office building at Cathedral Hill, a new medical office building at Davies, and replace the existing hospital and construct a new medical office building at St. Luke's. More details regarding CPMC's LRDP, including plans and renderings, can be found on the Planning Department's website at cpmc.sfplanning.org.

This ordinance concerns the proposed Cathedral Hill Campus at Van Ness Avenue and Geary Boulevard/Street. The Cathedral Hill Campus includes a new acute care hospital on the block bounded by Van Ness, Geary, Franklin and Post Streets, a new medical office building on the site bounded by Van Ness, Geary, Cedar Street and one property west of Polk Street, and a pedestrian tunnel under Van Ness Avenue to connect the two facilities. Additional medical office space for the campus will be provided within the existing building at 1375 Sutter Street.

The proposed Cathedral Hill Hospital will be a 555-bed, 265' tall, 15-story, approximately 875,378 gross square foot acute care hospital, with related hospital space, including 513 parking spaces on three underground levels. The proposed medical office building, across Van Ness Avenue, will be nine stories tall, approximately 130' tall, and will contain approximately 261,691 gross square feet of floor area and 542 off-street parking spaces on seven underground levels.

Among other approvals, the Cathedral Hill Campus will also require ordinances to amend the Planning Code and Zoning Map. CPMC also seeks approval of a development agreement with the City primarily related to the facilities at Cathedral Hill, the new medical office building at the Davies Campus, and construction of a replacement hospital and medical office building at the St. Luke's Campus.

General Plan Van Ness Area Plan Map 1

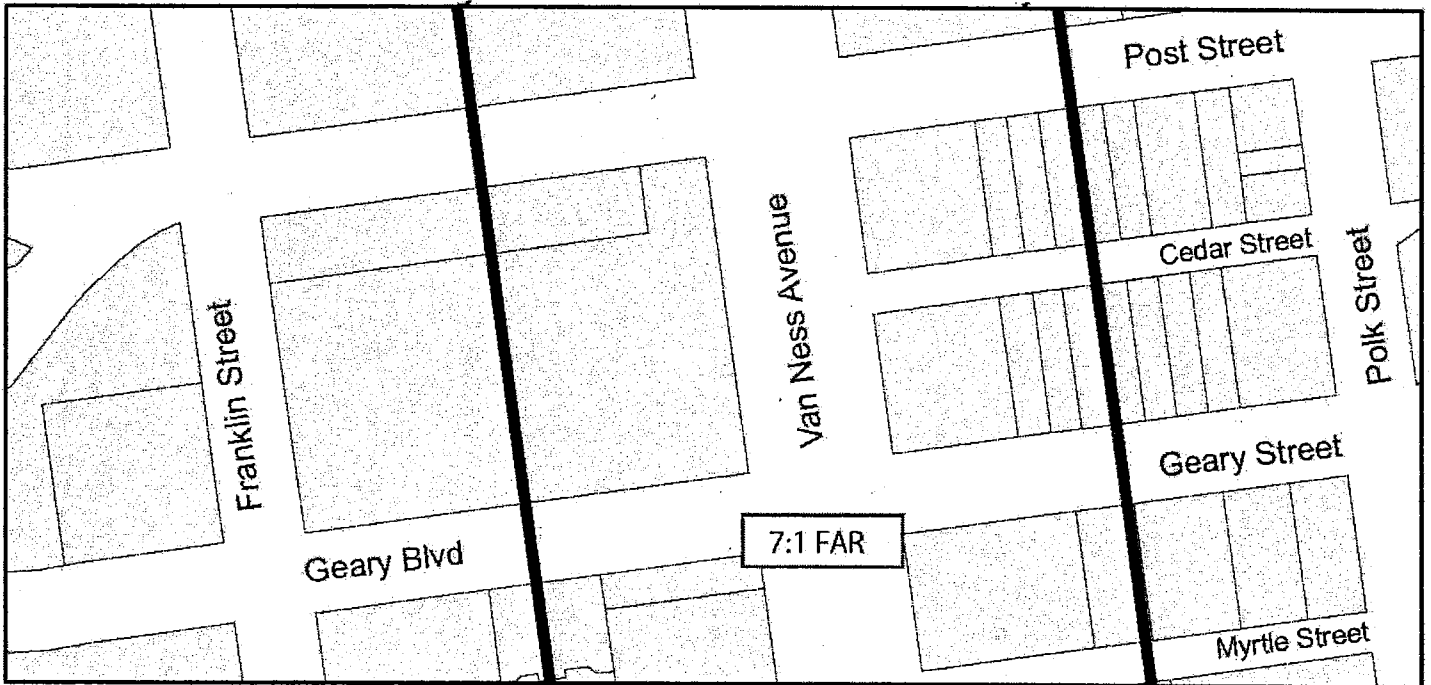

EXISTING

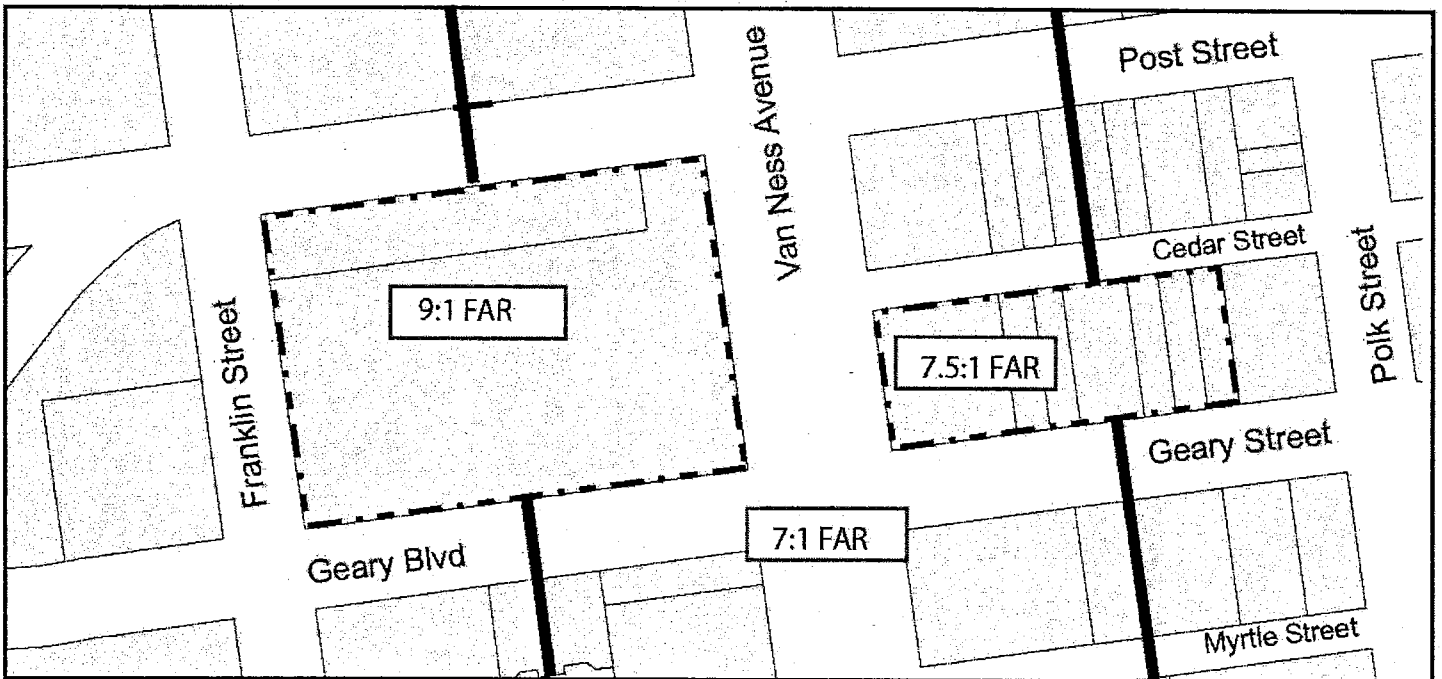

PROPOSED



General Plan Van Ness Area Plan Map 2

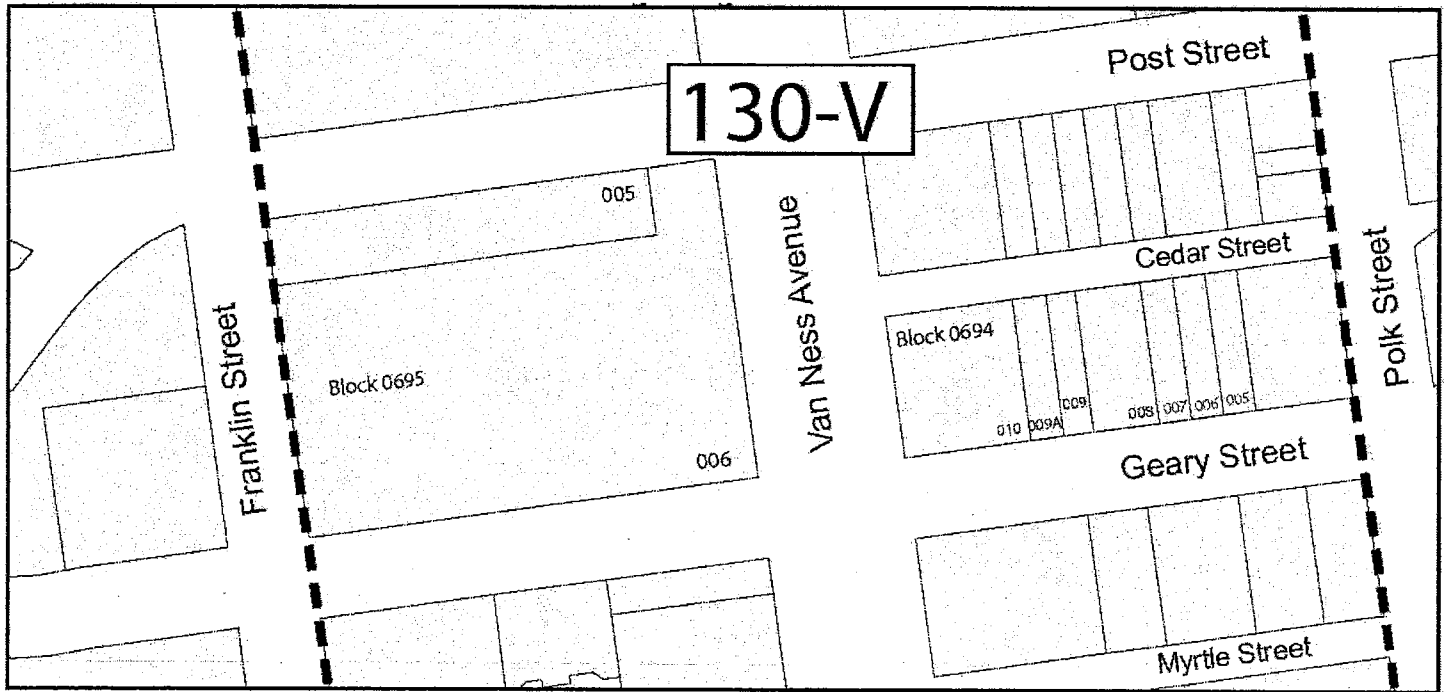

EXISTING

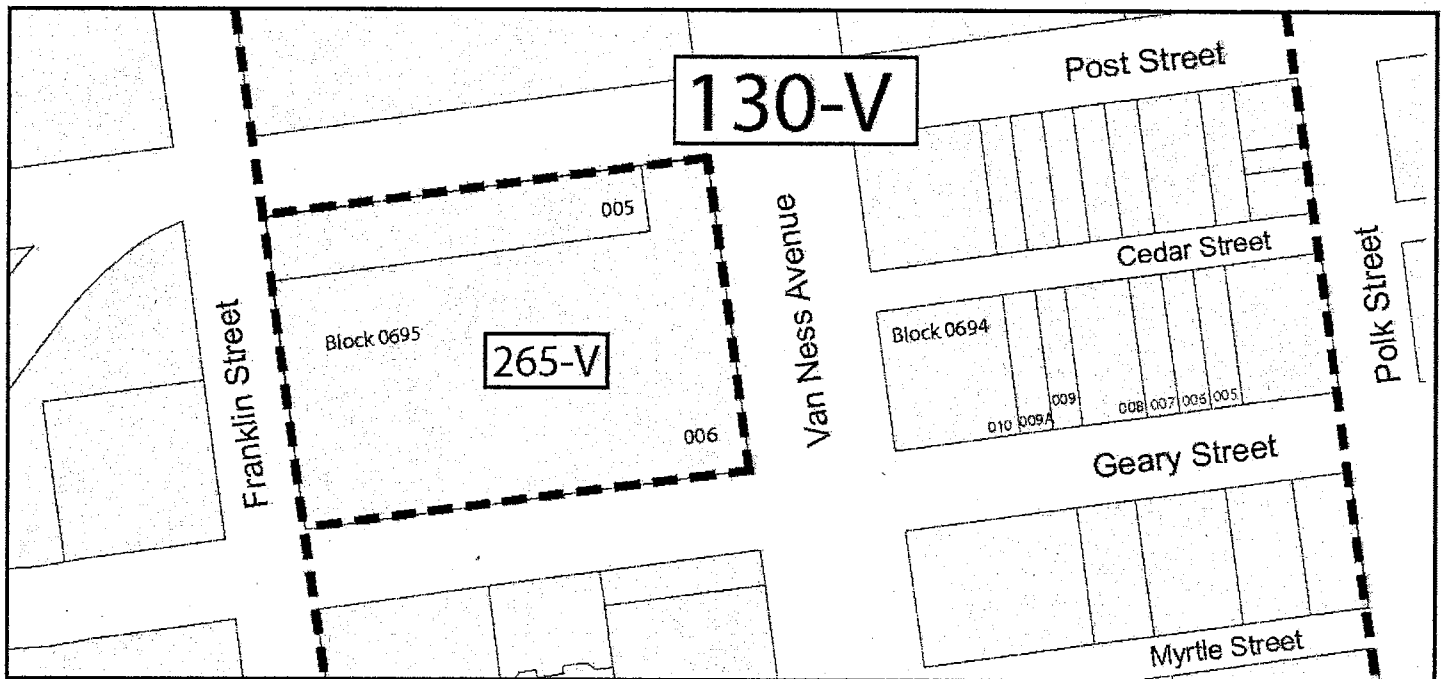

PROPOSED



General Plan Urban Design Element Map 4

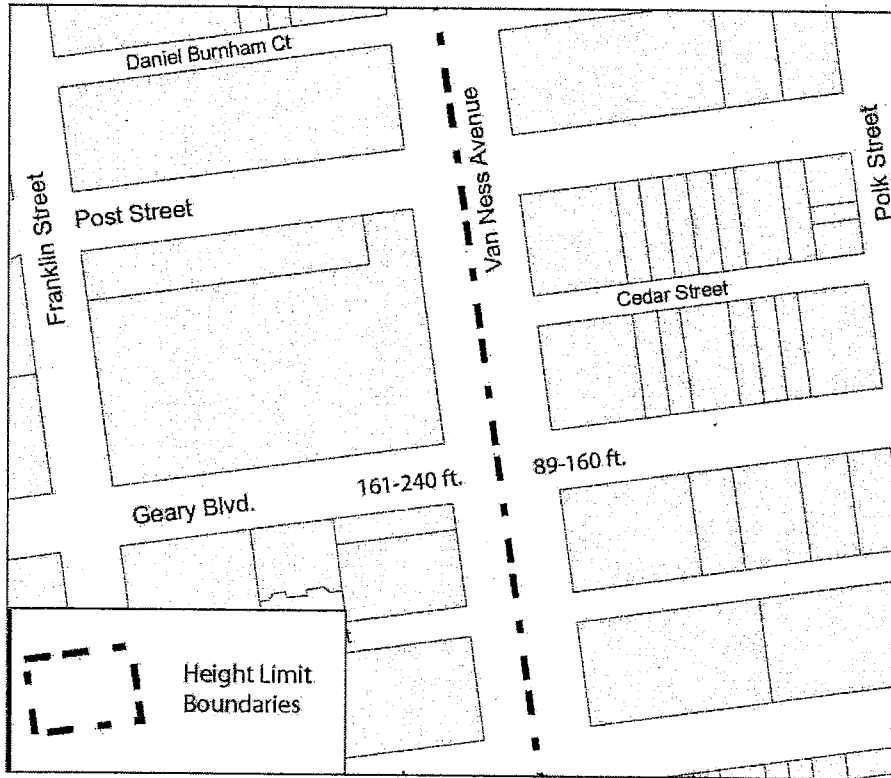

EXISTING

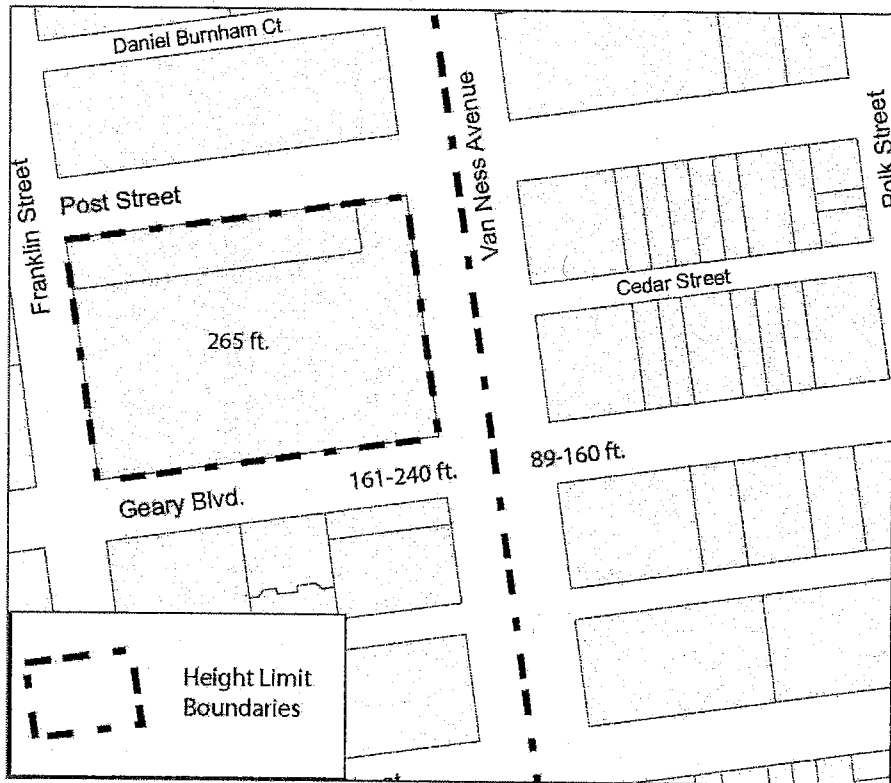

PROPOSED



General Plan Urban Design Element Map 5

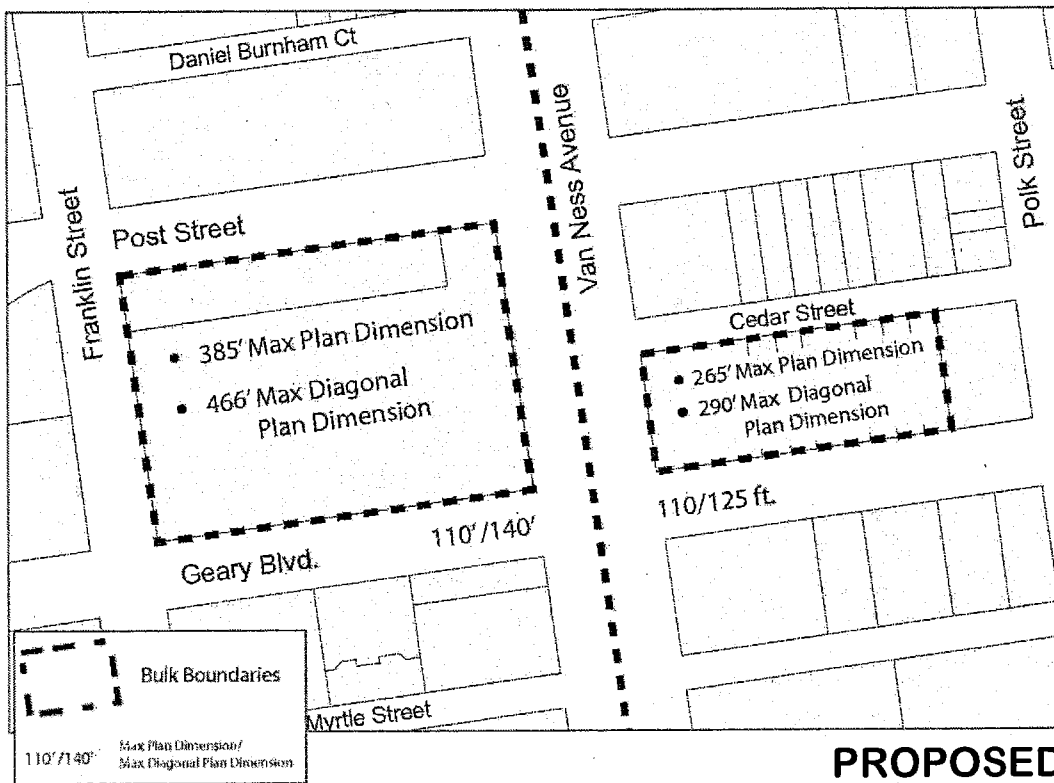
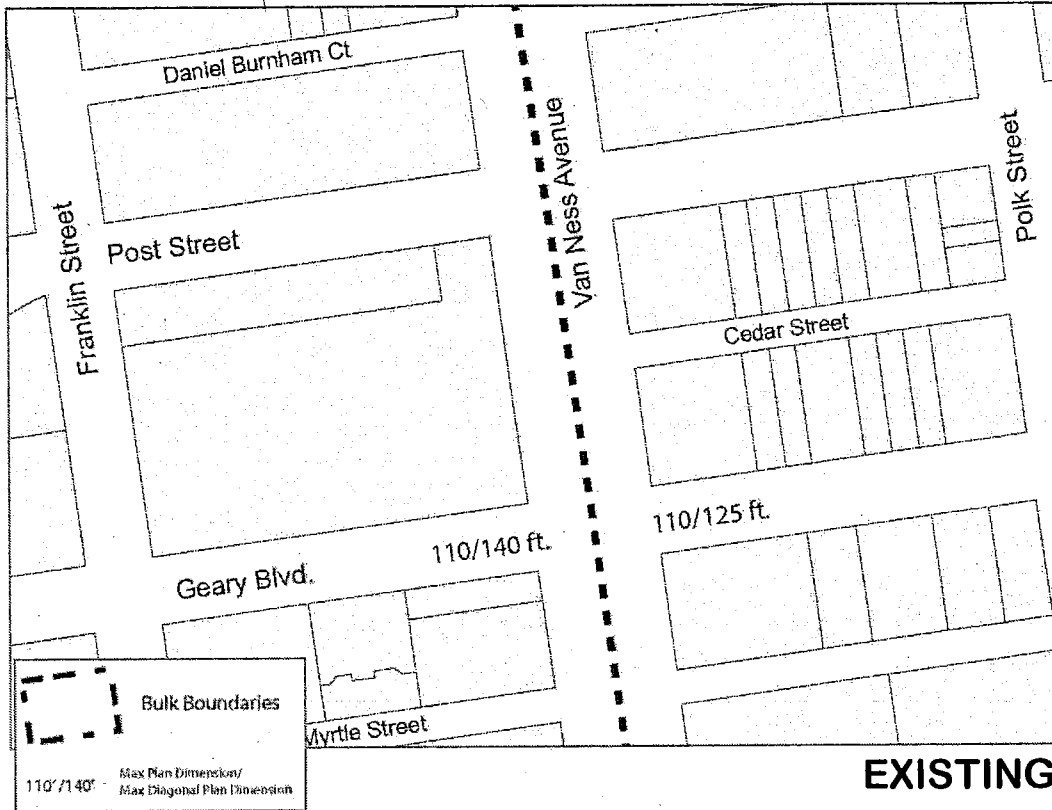



SAN FRANCISCO PLANNING DEPARTMENT



April 27, 2012

Ms. Angela Calvillo, Clerk
Board of Supervisors
City and County of San Francisco
City Hall, Room 244
1 Dr. Carlton B. Goodlett Place
San Francisco, CA 94102

1650 Mission St.
Suite 400
San Francisco,
CA 94103-2479

Reception:
415.558.6378

Fax:
415.558.6409

Planning
Information:
415.558.6377

Re: Transmittal of Planning Department Case Numbers:
2009.0885MTZCBRSK, 2009.0886MTZCBRSK, 2012.0403W:
California Pacific Medical Center Long Range Development Plan Project

BOS File No.'s: 120357, 120358, 120359, 120360, 120366, plus pending General Plan
Amendment File No's _____ and _____
Planning Commission Recommendation: Approval

Dear Ms. Calvillo,

Attached please find one original hardcopy plus this electronic transmittal of the proposed General Plan Amendment Ordinances, Planning Code Text Amendment Ordinances, Zoning Map Amendment Ordinances, and a Development Agreement Ordinance (collectively, the "Ordinances") for Board of Supervisors' approval. These Ordinances are associated with the California Pacific Medical Center Long Range Development Plan Project (hereinafter "CPMC LRDP Project"), which is a multi-phased development strategy to meet state seismic safety requirements for hospitals and to create a 20-year framework for CPMC's four existing medical campuses and for construction of a proposed new medical campus (the "Cathedral Hill Campus") in San Francisco. The proposed LRDPs would facilitate the development of certain Near-Term Projects under the CPMC LRDP at CPMC's St. Luke's, Cathedral Hill, and Davies Campuses.

On April 5, 2012, the San Francisco Planning Commission (hereinafter "Commission") conducted a duly noticed public hearing at a regularly scheduled meeting to consider the initiation of the proposed General Plan Amendment Ordinances associated with the CPMC LRDP Project.

On April 10, 2012, the Mayor introduced at the regularly scheduled Board of Supervisors hearing various legislation associated with the CPMC LRDP Project, including the Planning Code Text Amendment Ordinances, Zoning Map Amendment Ordinances, and a Development Agreement Ordinance.

On April 26, 2012, the Commission conducted a duly noticed public hearing at a regularly scheduled meeting to consider the proposed Ordinances as part of the CPMC LRDP Project.

www.sfplanning.org

* Complete memorandum in File No. 120357 *



SAN FRANCISCO PLANNING DEPARTMENT



CPMC Long Range Development HEARING DATE: APRIL 26, 2012

1650 Mission St.
Suite 400
San Francisco,
CA 94103-2479

Reception:
415.558.6378

Fax:
415.558.6409

Planning
Information:
415.558.6377

Date: April 12, 2012

Case No.: **Cathedral Hill Campus:** 2009.0885MTZWCBRSK
St. Luke's Campus: 2009.0886MTZWCBRSK
Davies Campus: 2004.0603CW
All Campuses: 2005.0555E; 2012.0403W

Project Address: **Cathedral Hill Campus:** 1100 & 1101 Van Ness Avenue; 1255 Post Street; 1020, 1028-1030, 1034-1036, 1040-1052, 1054-1060, and 1062 Geary Street; 1375 Sutter Street
St. Luke's Campus: 3555, 3615 Cesar Chavez Street; 1580 Valencia Street
Davies Campus: 601 Duboce Avenue
Pacific Campus: 2315 & 2333 Buchanan Street; 2300 California Street; 2330, 2340-2360, 2351, 2400, & 2405 Clay Street; 2315, 2323, 2324, 2329, & 2395 Sacramento Street; 2018, 2100 & 2200 Webster Street
California Campus: 3698, 3700, 3838 & 3848-3850 California Street; 3801, 3905, 3773 & 3901 Sacramento Street; 460 Cherry Street

Zoning/Ht. & Blk. **Cathedral Hill Campus:** RC-4, Van Ness Special Use District/130-V; NC-3/130-E
St. Luke's Campus: RH-2/105-E, 65-A
Davies Campus: RH-3/65-D, 130-E
Pacific Campus: RM-1, RM-2; 40-X, 160-F
California Campus: RH-2, RM-2; 40-X, 80-E

Proposed Zoning/ Height & Bulk: **Cathedral Hill Campus:** RC-4, Van Ness Special Use District, Van Ness Avenue Medical Use Subdistrict/265-V (hospital site), 130-V (MOB site); NC-3/130-E (1375 Sutter Street site)
St. Luke's Campus: RH-2, Cesar Chavez/Valencia Streets Medical Use Special Use District/105-E
Davies Campus: No Change
Pacific Campus: No Change
California Campus: No Change

Assessor's Block/Lot: **Cathedral Hill Campus:** 0695/005, 006; 0694/005, 006, 007, 008, 009, 009A, 010; 0690/016
St. Luke's Campus: 6575/001, 002; 6576/021 and a portion of San Jose Avenue between Cesar Chavez Street and 27th Street
Davies Campus: 3539/001
Pacific Campus: 0612/008; 0613/002, 029; 0628/013, 014; 0629/041, 044; 0636/033; 0637/014, 015, 016, 017, 018, 019
California Campus: 1015/001, 016, 052, 053, 054; 1016/001, 002, 003, 004, 005, 006, 007, 008, 009; 1017/027, 028

www.sfplanning.org

* Complete memorandum in File No. 120357 *



SAN FRANCISCO PLANNING DEPARTMENT

Planning Commission Resolution No. 18591

General Plan Amendment

HEARING DATE: APRIL 26, 2012

1650 Mission St.
Suite 400
San Francisco,
CA 94103-2479

Reception:
415.558.6378

Fax:
415.558.6409

Planning
Information:
415.558.6377

Date: April 12, 2012
Case No.: 2005.0555E; 2009.0885MTZCBRSK; 2012.0403W
Project Address: 1100, 1101 Van Ness Avenue; 1255 Post Street; 1020, 1028-1030, 1034-1036, 1040-1052, 1054-1060, 1062 Geary Street
Zoning/Ht. & Blk.: RC-4/Van Ness Special Use District/130-V
Proposed Zoning/ Van Ness Special Use District, Van Ness Avenue Medical Use Subdistrict
Height & Bulk: 265-V (Hospital site), 130-V (MOB site)
Assessor's Block/Lot: 0695/005, 006; 0694/005, 006, 007, 008, 009, 009A, 010
Project Sponsor: Geoffrey Nelson, CPMC
633 Folsom Street, 5th Floor
San Francisco, CA 94107
(415) 600-7206
NelsonGK@Sutterhealth.org
Staff Contact: Elizabeth Watty - (415) 558-6620
Elizabeth.Watty@sfgov.org

RECOMMENDING THAT THE BOARD OF SUPERVISORS ADOPT FINDINGS RELATING TO AMENDMENTS TO THE GENERAL PLAN TO: (1) AMEND THE TEXT OF THE VAN NESS AREA PLAN TO SUPPORT A HIGH DENSITY MEDICAL CENTER AT THE INTERSECTION OF VAN NESS AVENUE AND GEARY STREET/BOULEVARD THAT IS CONSISTENT WITH THE CITY'S BETTER STREETS PLAN AND REFLECT VARIOUS ELEMENTS OF THIS USE; (2) AMEND MAP 1 OF THE VAN NESS AREA PLAN ("VNAP") TO DESIGNATE THE SITES PROPOSED FOR THE NEW CATHEDRAL HILL HOSPITAL AND MEDICAL OFFICE BUILDING ("CATHEDRAL HILL MOB") AS "THE VAN NESS MEDICAL USE SUBDISTRICT", AND TO INCREASE THE ALLOWABLE FLOOR AREA RATIO ("FAR") FOR THE CATHEDRAL HILL HOSPITAL SITE FROM 7:1 TO 9:1, AND FOR THE CATHEDRAL HILL MOB SITE FROM 7:1 TO 7.5:1; (3) AMEND MAP 2 OF THE VAN NESS AREA PLAN TO CREATE A 265-V HEIGHT AND BULK DISTRICT COTERMINOUS WITH THE HOSPITAL SITE, IN ORDER TO AMEND THE HEIGHT LIMIT FOR THE CATHEDRAL HILL HOSPITAL SITE FROM 130'-0" TO 265'-0"; (4) AMEND MAP 4 OF THE URBAN DESIGN ELEMENT TO REFLECT A MAXIMUM HEIGHT APPLICABLE TO THE CATHEDRAL HILL HOSPITAL SITE OF 265'-0"; AND (5) AMEND MAP 5 OF THE URBAN DESIGN ELEMENT TO REFLECT THE PROPOSED MAXIMUM PLAN AND MAXIMUM DIAGONAL PLAN DIMENSIONS OF 385'-0" AND 466'-0", RESPECTIVELY, FOR THE CATHEDRAL HILL HOSPITAL SITE, AND 265'-0" AND 290'-0", RESPECTIVELY, FOR THE CATHEDRAL HILL MOB SITE; AND MAKE AND ADOPT FINDINGS, INCLUDING FINDINGS UNDER PLANNING CODE SECTION 340, ENVIRONMENTAL FINDINGS AND FINDINGS OF CONSISTENCY WITH THE GENERAL PLAN AND THE EIGHT PRIORITY POLICIES OF PLANNING CODE SECTION 101.1.

PREAMBLE

On June 10, 2005, Ralph F. Marchese of The Marchese Company, Inc., acting on behalf of the California Pacific Medical Center ((hereinafter referred to variously as "CPMC" and "Project Sponsor"), submitted an Environmental Evaluation Application ("EEA") with the Planning Department ("Department"), Case No. 2005.0555E¹. The Department issued a Notice of Preparation of Environmental Review on July 1, 2006, to owners of properties within 300 feet, adjacent tenants, and other potentially interested parties. However, as planning for the CPMC Long Range Development Plan ("LRDP") continued, additional components were added to the LRDP that resulted in a reissuance of a revised NOP for a 30-day public review period on May 27, 2009.

On July 21, 2010, the Draft Environmental Impact Report ("DEIR") for CPMC's LRDP Project, including the Cathedral Hill Hospital and Medical Office Building ("MOB") Project, was prepared and published for public review, and was available for public comment until October 19, 2010.

On September 23, 2010, the Commission conducted a duly noticed public hearing at a regularly scheduled meeting to solicit comments regarding the DEIR. On March 29, 2012, the Department published a Comments and Responses document, responding to comments made regarding the DEIR prepared for the LRDP. Together, the Comments and Responses document, the DEIR, and any Errata Sheets, (the Appendices to the DEIR and C&R document), Department staff testimony and responses to questions and comments at the Commission's April 26, 2012, public hearing regarding certification of the Final EIR, and all of the supporting information that has been reviewed and considered by the Department, comprise the Final EIR for the LRDP ("FEIR").

On April 26, 2012, the Commission reviewed and considered the FEIR and found that the contents of said report and the procedures through which the FEIR was prepared, publicized, and reviewed complied with the California Environmental Quality Act (California Public Resources Code Sections 21000 *et seq.*) ("CEQA"), 14 California Code of Regulations Sections 15000 *et seq.* (the "CEQA Guidelines"), and Chapter 31 of the San Francisco Administrative Code ("Chapter 31").

The Commission found the FEIR was adequate, accurate and objective, reflected the independent analysis and judgment of the Department and the Commission, and that the summary of comments and responses contained no significant revisions to the DEIR, and certified the FEIR for the LRDP Project in compliance with CEQA, the CEQA Guidelines and Chapter 31.

The Planning Department, Linda Avery, is the custodian of records, located in the File for Case No. 2005.0555E, at 1650 Mission Street, Fourth Floor, San Francisco, California.

Department staff prepared a Mitigation Monitoring and Reporting program ("MMRP") for the LRDP Project, which material was made available to the public and this Commission for this Commission's review, consideration and action.

¹ At the time of this application, the Cathedral Hill Hospital site was within the boundaries, and was governed by the land use controls, of the Western Addition A-2 Plan. Those controls expired on January 1, 2009.

On June 10, 2010, the Project Sponsor submitted a request, as modified by subsequent submittals, to the Department to amend the following sections of the General Plan: (1) the text of the Van Ness Area Plan to support a high density medical center at the intersection of Van Ness Avenue and Geary Boulevard that is consistent with the City's Better Streets Plan and reflect various elements of this use; (2) "Map 1 – Generalized Land Use and Density Plan" of the Van Ness Area Plan to designate the sites proposed for the new Cathedral Hill Hospital and MOB as "The Van Ness Medical Use Subdistrict", and to increase the allowable floor area ratio ("FAR") for the Cathedral Hill Hospital site from 7:1 to 9:1, and to increase the FAR for the Cathedral Hill MOB site from 7:1 to 7.5:1; (3) "Map 2 – Height and Bulk Districts" of the Van Ness Area Plan to create a 265-V Height and Bulk District coterminous with the Hospital site, in order to amend the height limit for the Cathedral Hill Hospital site from 130'-0" to 265'-0"; (4) "Map 4 – Height Map" of the Urban Design Element, to reflect a maximum height applicable to the Hospital site of 265'-0"; and (5) "Map 5 – Bulk Map" of the Urban Design Element, to reflect the proposed maximum plan and maxim diagonal plan dimensions of 385'-0" and 466'-0", respectively, for the Cathedral Hill Hospital site, and 265'-0" and 290'-0", respectively, for the Cathedral Hill MOB site (2009.0885M), with respect to a proposal to: (1) demolish the existing Cathedral Hill Hotel and 1255 Post Street office building (Assessor's Block/Lot 0695-005, 006) and construct a new, approximately 15 story, 555-bed, 875,378 g.s.f acute care hospital with 513 underground parking spaces at 1101 Van Ness Avenue; (2) demolish seven existing vacant residential and commercial buildings (Assessor's Blocks/Lots 0694-005, 0694-006, 0694-007, 0694-008, 0694-009, 0694-009A, 0694-010) and construct a new, approximately 261,691 g.s.f MOB with 542 underground parking spaces at 1100 Van Ness Avenue; (3) construct a pedestrian tunnel under Van Ness Avenue to connect the Cathedral Hill Hospital to the Cathedral Hill MOB; and (4) various streetscape, sidewalk, and landscape improvements surrounding the Campus (collectively, "Cathedral Hill Project"), within the RC-4 (Residential-Commercial, High Density) District, VNSUD, and 130-V Height and Bulk District.

On June 10, 2010, the Project Sponsor submitted a request, as modified by subsequent submittals, to the Department to amend the following sections of the San Francisco Planning Code: Section 243, the Van Ness Special Use District, to create a new Van Ness Medical Use Subdistrict, that would allow an FAR up to 9:1 for the Cathedral Hill Hospital site and 7.5:1 for the Cathedral Hill MOB site; allow modification of otherwise applicable standards for building projections to allow for coverage of drop-off and entry areas required by medical facilities; allow modification of otherwise applicable standards for obstructions over streets or alleys for vertical dimension and horizontal projections to allow architectural features that achieve appropriate articulation of building facades and that reduce pedestrian level wind currents; allow modification through Conditional Use authorization of otherwise applicable standards for street frontage requirements as necessary for large-plate medical facilities on sloping sites with multiple frontages; allow modification through Conditional Use authorization of otherwise applicable parking standards for medical centers, provided that the amount of parking shall not exceed 150% of the number of spaces otherwise allowed by the Planning Code; allow modification of otherwise applicable loading standards for medical centers; and to allow modification through Conditional Use authorization of otherwise applicable bulk standards to allow for the unique massing requirements of medical facilities. (Case No. 2009.0885T).

On June 10, 2010, the Project Sponsor submitted a request, as modified by subsequent submittals, to the Department to amend the following Zoning Maps of the San Francisco Planning Code: (1) Map HT02 to

reclassify the Cathedral Hill Hospital site from 130-V to 265-V Height and Bulk District; and (2) Map SU02 to show the boundaries of the Van Ness Medical Use Subdistrict (Case No. 2009.0885Z).

On June 10, 2010, the Project Sponsor filed an application, as modified by subsequent submittals, with the Department for Conditional Use Authorization to allow (1) the Cathedral Hill Hospital and Cathedral Hill MOB as a medical center use within the RC-4 District and pursuant to the provisions for the Van Ness Special Use District ("VNSUD"); (2) allow construction of buildings over 50'-0" in an RC-4 District; (3) authorize demolition of five residential dwelling-units at the Cathedral Hill MOB site; (4) modify standards for active ground floor uses and width of curb cuts; (5) provide an exception to allow wind speeds greater than 11 mph at certain sidewalk locations around the perimeter of the Campus; (6) modify the bulk limits applicable to the Cathedral Hill Hospital and MOB sites; (7) modify the 3:1 residential to net new non-residential ratio requirement in the VNSUD, pursuant to Planning Code Sections 145.1, 209.3, 243, 253, 270, 271, 303, and 317.

On June 10, 2010, the Project Sponsor submitted a request, as modified by subsequent submittals, for the allocation of Office Space for approximately 194,000 s.f of medical office space along with ancillary hospital and medical support service space on the upper floors of the proposed Cathedral Hill MOB (Case No. 2009.0885B).

On April 28, 2011, the Project Sponsor submitted a request for a General Plan Referral, Case No. 2009.0885R, regarding construction of a tunnel that would connect the Cathedral Hill Hospital and MOB sites below grade under Van Ness Avenue, installation of two diesel fuel tanks under the Geary Boulevard sidewalk at the Cathedral Hill Hospital site; and sidewalk widening along various streets adjacent to the Campus (2009.0885R).

On March 30, 2012, the Project Sponsor submitted an Application for a Development Agreement relating to the construction and reconstruction of Health Care Facilities in furtherance of the CPMC's Long Range Development Plan by and between the City and County of San Francisco and CPMC, pursuant to Administrative Code Section 56.4. This Application was endorsed and accepted as complete by the Planning Director on April 4, 2012.

On April 5, 2012, the Commission conducted a duly noticed public hearing at a regularly scheduled meeting and adopted Resolution No. 18571, initiating the requested General Plan Amendments.

On April 10, 2012, the Mayor, at the Board of Supervisors hearing, introduced the (1) Planning Code Text Amendments in Board File No. 120357; (2) the Zoning Map Amendments in Board File No. 120359, (3) the street encroachment ordinance in Board File No.120362, (4) the Development Agreement in Board File No. 120366, and (5) sidewalk width legislation in Board File No. 120364.

On April 26, 2012, by Motion No. 18588, the Commission certified as accurate, adequate and complete the FEIR for the LRDP Project, which includes the Cathedral Hill Hospital and MOB Project. A copy of Commission Motion No. 18588 is in the file for Case No.2005.0555E. Also on April 26, 2012, by Motion No. 18589, the Commission adopted findings, including a statement of overriding considerations, and an MMRP, pursuant to CEQA. In accordance with the actions contemplated herein, the Commission has reviewed the FEIR and adopts and incorporates by reference as though fully set forth herein the findings,

including the statement of overriding considerations, pursuant to CEQA, adopted by the Commission on April 26, 2012, in Motion No. 18589.

On April 26, 2012, the Planning Commission conducted a duly noticed public hearing at a regularly scheduled meeting and adopted: (1) Motion No. 18592, approving the General Plan and Planning Code Section 101.1 Findings; (2) Resolution No. 18597, recommending that the Board of Supervisors approve the requested Planning Code Text Amendments and the requested Zoning Map Amendments; (3) Motion No. 18598, approving the Conditional Use authorization; (4) Motion No. 18599, approving the Office Allocation; (5) Motion No. 18600, approving the General Plan Referral; and (6) Resolution No. 18602, recommending that the Board of Supervisors approve the Development Agreement.

On April 26, 2012, the Commission conducted a duly noticed public hearing at a regularly scheduled meeting on Case No. 2009.0885EMTZCBRSK.

The Commission has heard and considered the testimony presented to it at the public hearing and has further considered written materials and oral testimony presented on behalf of the applicant, Department staff, and other interested parties.

The Commission has reviewed the proposed General Plan Amendment Ordinances; and

MOVED, that the Commission hereby recommends that the Board of Supervisors approve the proposed General Plan Amendment Ordinances, and adopt the attached Resolution to that effect.

FINDINGS

Having reviewed the materials identified in the preamble above, and having heard all testimony and arguments, this Commission finds, concludes, and determines as follows:

1. The Commission finds the Cathedral Hill Project to be a beneficial development to the City that could not be accommodated without the actions requested.
2. CPMC has provided quality health care to the San Francisco community for over 150 years. It is the largest medical center in the City, and is presently responsible for about one-third of all hospitalizations, about one-half of all births in the City, about 40 percent of all patients receiving health services in the City and almost 40 percent of emergency visits. Each year CPMC cares for more than 75,000 persons in its emergency departments. The LRDP would ensure CPMC's continued existence and viability in San Francisco.
3. The existing acute care hospitals at the Pacific and California Campuses do not meet State seismic standards. Regardless of the State legal mandate, it is in the public interest that CPMC meet these seismic standards as soon as possible. These Ordinances, along with the Development Agreement and related approvals, achieve the objective of allowing CPMC's facilities to be rebuilt to meet the desired and legally mandated seismic standards, without any interruption in delivery of acute care services at the existing hospitals due to construction.
4. The Cathedral Hill Hotel and 1255 Post Street office building sites were selected for the location of a new acute care hospital because these aggregated parcels met CPMC's site selection

- objectives, including: (1) being available for sale; (2) being large enough to accommodate the co-location of acute care services from the California and Pacific Campuses; (3) preventing the interruption of existing services at the California and Pacific Campuses during the construction; (4) being located on geologically stable soil; (5) being at a major transit nexus; and (6) the availability of adjacent properties for the construction of a medical office building.
5. The General Plan was not created with the new construction of hospitals as a focused land use typology, and thus does not recognize the complexity, site and Building Code constraints, and health care delivery intricacies involved therein.
 6. A number of conforming amendments to elements of the San Francisco General Plan, including General Plan maps, are required in order to resolve the aforementioned issues and facilitate the implementation of the CPMC LRDP.
 7. The CPMC LRDP and its proposed amendments to the General Plan support the underlying goals of the General Plan, such as maintaining a sound and diverse economic base, providing expanded employment opportunities, promoting high quality urban design, enhancing San Francisco's position as a national and regional center for health services, and promoting adequate health services in all geographic districts.
 8. CPMC's facilities, particularly if they are rebuilt to remain operational after an earthquake, are an essential part of the City's preparation for, and ability to respond to a disaster. If CPMC were not to build the new hospitals, the City would lose approximately one-third of all acute care beds, and three full-service emergency departments, one of which provides specialty pediatric emergency care.
 9. Construction of the LRDP will double the number of earthquake safe beds in San Francisco, inject about \$1.9 billion into the local economy during the next five years, and create 1,500 high paying union construction jobs.
 10. The Near-Term Projects in the LRDP would allow the City to retain CPMC as a substantial employer, employing approximately 6,200 persons, of which about half are San Francisco residents. The LRDP would also permit the City to retain and enhance its domestic and international reputation as an education, training, and research center for medical services that benefit the residents of San Francisco. This benefits the City and its residents because it will attract patients, doctors and researchers to San Francisco.
 11. Under the terms of the Development Agreement, CPMC would increase entry-level local construction employment and internship opportunities. CPMC would make good faith efforts to achieve 30% local hire measured by construction trade hours for the Near-Term Projects under the LRDP overall for each contractor, by each trade. CPMC would achieve 50% local hire for new entry-level administrative and engineering positions and internships, would fill half of all new apprentice positions with graduates from the CityBuild Academy, and would create and administer a structured program to advance apprentices from CityBuild Academy to journey-level status in their trade by the end of the Project. CPMC plans to hire at least 40 San Francisco-resident permanent entry-level hires annually for five years, representing just under half of all entry level hires, targeting residents of the Western Addition, Tenderloin, Mission/SOMA, Outer Mission/Excelsior, Chinatown and Southeastern neighborhoods. CPMC would also provide \$2 million for community workforce services, which would provide grants to community-based

organizations through the City's Office of Economic and Workforce Development for recruitment, training, and job retention services.

12. The Near-Term Projects will assure the availability of modern and high quality, general and specialized inpatient and out-patient, emergency and urgent health care to the residents of San Francisco, including seniors, Medicare, Medi-Cal, insured and un-insured.
13. The Near-Term Projects at the Cathedral Hill Campus will assure the availability of medical offices for physicians located near hospital facilities to serve the residents of San Francisco.
14. The new Cathedral Hill Hospital would be a full-service, acute care hospital with an approximately 12,000 sf emergency department integrated into the CPMC city-wide system of care. It would provide critical services including inpatient medical care, Obstetrics/Gynecology, Medical/Surgical, Intensive Care, as well as specialized programs such as organ transplantation, interventional cardiology and newborn intensive care.
15. Emergency services, including psychiatric emergency care, would be provided at the St. Luke's, Davies and Cathedral Hill Campuses. These emergency departments serve patients regardless of ability to pay.
16. The 18 psychiatric inpatient beds in the mental health center on the Pacific Campus would remain in service.
17. Under the terms of the proposed Development Agreement, CPMC would commit to providing services to the poor and underserved, including traditional charity care, hospital care for additional Medi-Cal managed care beneficiaries enrolled in the San Francisco Health Plan, unpaid costs and other benefits for the poor and underserved. Specifically, CPMC would commit to:
 - a. Two new, seismically-safe hospitals, at the St. Luke's and Cathedral Hill campuses;
 - b. A secure future for St. Luke's hospital;
 - c. Significantly increased provision of healthcare for low-income and underserved San Franciscans, including hospital care for 10,000 additional Medi-Cal beneficiaries, which represents one-third of the City's new Medi-Cal beneficiaries expected under federal healthcare reform; and
 - d. \$20 million endowment by CPMC of a new Community Care Innovation Fund, to support the services of community clinics and other social service organizations.
 - e. Funding to develop capacity of one or more Tenderloin clinics to participate in Medi-Cal managed care;
18. Under the terms of the proposed Development Agreement, CPMC would provide additional funding to the City, including:
 - a. \$62 million for affordable housing, to replace the 20 residential hotel units and five dwelling units displaced, fund new affordable rental units, and to help moderate income CPMC employees purchase a home in San Francisco, resulting in approximately 320 affordable units [145 from initial \$29M payments; 175 from DALP recapture] to the market over 13 years, and assisting at least 145 moderate income CPMC employees buy a home in San Francisco.

- b. \$20 million from CPMC for MTA transit facilities and service.
- c. \$13 million from CPMC for pedestrian safety and streetscape improvements.
- 19. The LRDP will be constructed at no cost to the City, and will provide substantial direct and indirect economic benefits to the City;
- 20. The LRDP is necessary and desirable, is compatible with the surrounding neighborhoods, and would not be detrimental to persons or adjacent properties in the vicinity;
- 21. The General Plan Amendments are necessary in order to approve the CPMC LRDP Project;
- 22. **General Plan Compliance.** The Cathedral Hill Project is, on balance, consistent with the Objectives and Policies of the General Plan, as outlined in **Motion No. 18592.**
- 23. **Planning Code Section 101.1(b)** establishes eight priority-planning policies and requires review of permits for consistency with said policies. On balance, the Cathedral Hill Project complies with said policies, as outlined in **Motion No. 18592.**
- 24. The Cathedral Hill Project is consistent with and would promote the general and specific purposes of the Code provided under Section 101.1(b) as outlined in **Motion No. 18592** and also in that, as designed, the Cathedral Hill Project would contribute to the healthcare delivery and emergency services in San Francisco, include substantial economic benefits to the City during both the construction and operational phases, provide substantial other public benefits as outlined in the proposed Development Agreement, and be compatible with the character and stability of the neighborhood, thereby constituting a beneficial development.
- 25. Based on the foregoing, the public necessity, convenience and general welfare require the proposed General Plan amendments.

I hereby certify that the Planning Commission ADOPTED the foregoing Resolution on April 26, 2012.

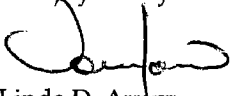
Linda D. Avery
Commission Secretary

PCAL

- AYES: Fong, Antonini, Borden, Miguel
- NAYS: Moore and Sugaya
- ABSENT: Wu
- ADOPTED: April 26, 2012



SAN FRANCISCO PLANNING DEPARTMENT



Planning Commission Motion No.18592 GENERAL PLAN FINDINGS

PLANNING CODE SECTION 101.1 FINDINGS

HEARING DATE: APRIL 26, 2012

1650 Mission St.
Suite 400
San Francisco,
CA 94103-2479

Reception:
415.558.6378

Fax:
415.558.6409

Planning
Information:
415.558.6377

Date: April 12, 2012

Project Name: California Pacific Medical Center Long Range Development Plan

Case Numbers: 2005.0555E; 2009.0886MTZCBRKS;
2009.0885MTZCBRKS; 2004.0603C; 2012.0403W

Initiated by: Geoffrey Nelson, CPMC
633 Folsom Street, 5th Floor
San Francisco, CA 94107
(415) 600-7206
NelsonGK@Sutterhealth.org

Staff Contact: Elizabeth Watty, Planner
Elizabeth.Watty@sfgov.org, 415-558-6620

Reviewed By: Kelley Amdur, Director Neighborhood Planning
Kelley.Amdur@sfgov.org, 415-558-6351

Recommendation: Adopt General Plan/Planning Code 101.1 Consistency Findings

ADOPTING FINDINGS OF CONSISTENCY WITH THE SAN FRANCISCO GENERAL PLAN AND PLANNING CODE SECTION 101.1 FOR THE CALIFORNIA PACIFICA MEDICAL CENTER'S LONG RANGE DEVELOPMENT PLAN TO ALLOW THE IMPLEMENTATION OF THE NEAR-TERM PROJECTS AND THE LEGISLATION ASSOCIATED THEREWITH, ALONG WITH THE DEVELOPMENT AGREEMENT ("PROJECT"), AT THE CATHEDRAL HILL CAMPUS (ASSESSOR'S BLOCKS-LOTS: 0690-016, 0694-005, 0694-006, 0694-007, 0694-008, 0694-009, 0694-009A, 0694-010, 0695-005, 0695-006); St. LUKE'S CAMPUS (ASSESSOR'S BLOCKS-LOTS 6575/001, 002; 6576/021 AND A PORTION OF SAN JOSE AVENUE BETWEEN CESAR CHAVEZ STREET AND 27TH STREET) AND THE DAVIES CAMPUS (ASSESSOR' BLOCK-LOTS 3539-001), AND INCLUDING ENVIRONMENTAL FINDINGS.

PREAMBLE

The CPMC Long Range Development Plan ("LRDP") is a multi-phased development strategy to meet state seismic safety requirements for hospitals mandated originally in 1994 by Senate Bill ("SB") 1953 as modified through successor legislation, and to create a 20-year framework for CPMC's four existing medical campuses and for construction of a proposed new medical campus in San Francisco.

The four existing CPMC medical campuses are the St. Luke's Campus in the Mission District, Pacific Campus in the Pacific Heights area, the California Campus in the Presidio Heights area, and the Davies Campus in the Duboce Triangle area. The proposed new medical campus is the Cathedral Hill



NOTICE OF PUBLIC HEARING

BOARD OF SUPERVISORS OF THE CITY AND COUNTY OF SAN FRANCISCO LAND USE & ECONOMIC DEVELOPMENT COMMITTEE

NOTICE IS HEREBY GIVEN THAT the Land Use and Economic Development Committee will hold a public hearing to consider the following proposal and said public hearing will be held as follows, at which time all interested parties may attend and be heard:

Date: Friday, June 15, 2012
Time: 10:00 a.m.
Location: Legislative Chamber, Room 250 located at City Hall
1 Dr. Carlton B. Goodlett Place, San Francisco, CA
Subject: California Pacific Medical Center Long Range Development Plan

120357 Planning Code - Increase Maximum Floor Area Ratios and Create the Van Ness Medical Use Subdistrict Within the Van Ness Special Use District - California Pacific Medical Center: Cathedral Hill Campus

Ordinance amending the San Francisco Planning Code by: 1) amending Section 124 to allow a floor area ratio of 9:1 for a hospital and 7.5:1 for a medical office building within the Van Ness Special Use District, Medical Use Subdistrict; 2) amending Section 243 to include the establishment of the Van Ness Medical Use Subdistrict and associated controls; and 3) adopting findings, including environmental findings, Planning Code Section 302 findings, and findings of consistency with the General Plan and the priority policies of Planning Code Section 101.1.

120358 Planning Code - Increase Maximum Permitted Floor Area Ratio and Establish the Cesar Chavez/Valencia Streets Medical Use Special Use District - California Pacific Medical Center: St. Luke's Campus

Ordinance amending the San Francisco Planning Code by: 1) adding Section 124(k) to allow a floor area ratio of 2.5 to 1 in the Cesar Chavez/Valencia Streets Medical Use Special Use District; 2) adding Section 249.68 to establish the Cesar Chavez/Valencia Streets Medical Use Special Use District; and 3) adopting findings, including environmental findings, Planning Code Section 302 findings, and findings of consistency with the General Plan and the priority policies of Planning Code Section 101.1.

120359 Zoning Map - California Pacific Medical Center: Cathedral Hill Campus

Ordinance amending the San Francisco Planning Code Sectional Maps SU02 and HT02 of the Zoning Map of the City and County of San Francisco to: 1) reflect the creation of the Van Ness Medical Use Subdistrict at Assessor's Block Nos. 0695 (Lot Nos. 005, 006) and 0694 (Lot Nos. 005, 006, 007, 008, 009, 009A, 010); 2) allow an increase in height at Assessor's Block No. 0695 (Lot Nos. 005, 006) in order to allow for a new seismically safe hospital; and 3) adopt findings, including environmental findings, Section 302 findings, and findings of consistency with the General Plan and the priority policies of Planning Code Section 101.1.

120360 Zoning Map - California Pacific Medical Center: St. Luke's Campus

Ordinance amending the San Francisco Planning Code Sectional Maps SU07 and HT07 of the Zoning Map of the City and County of San Francisco to: 1) reflect the creation of the Cesar Chavez/Valencia Streets Medical Use Special Use District at the California Pacific Medical Center's St. Luke's Campus (Block No. 6575, Lot Nos. 001 and 002; Block No. 6576, Lot No. 021; and a portion of San Jose Avenue between Cesar Chavez and 27th Streets); 2) allow an increase in height throughout the western portion of the California Pacific Medical Center's St. Luke's Campus (Block No. 6576, Lot No. 021; and a portion of San Jose Avenue between Cesar Chavez and 27th Streets) in order to allow for a new seismically safe replacement hospital; and 3) adopt findings, including environmental findings, Section 302 findings, and findings of consistency with the General Plan and the priority policies of Planning Code Section 101.1.

120361 Summary Street Vacation - Portion of San Jose Avenue - California Pacific Medical Center: St. Luke's Campus

Ordinance ordering the summary street vacation of a portion of San Jose Avenue, between 27th Street and Cesar Chavez Street; rescinding an existing encroachment permit; adopting environmental findings pursuant to the California Environmental Quality Act and findings that the action contemplated herein are consistent with the San Francisco General Plan and eight priority policies of San Francisco Planning Code Section 101.1; and authorizing official acts in connection with this ordinance.

120362 Street Encroachments - Van Ness Avenue, Cedar Street, and Geary Boulevard - California Pacific Medical Center: Cathedral Hill Campus

Resolution: 1) granting revocable permission to the California Pacific Medical Center to a) occupy a portion of the public right-of way on Van Ness Avenue in order to construct and maintain a pedestrian tunnel under Van Ness Avenue (State Highway 101) to connect the new medical office building and the new hospital located at 1100 and 1101 Van Ness Avenue respectively; b) construct and maintain off-site improvements on the north side of Cedar Street between Van Ness Avenue and Polk Street, across the street from the medical office building and on the south side of Cedar Street contiguous to the property at 1001 Polk Street (Block No. 0694, Lot No. 004), including reconstructing and widening the existing sidewalk, installing new landscaping and reconstructing the existing roadway with pavers; and c) install and maintain two 30,000 gallon diesel fuel tanks within the public right of way under Geary Boulevard between Franklin Street and Van Ness Avenue, in order to serve the hospital at 1101 Van Ness Avenue; and 2) making environmental findings and findings of consistency with the General Plan and the priority policies of Planning Code Section 101.1.

120363 Land Transf Agreement - Sale of a Portion of § Jose Avenue Between 27th Street and Cesar Chavez Street - Sutter West Bay Hospitals - California Pacific Medical Center: St. Luke's Campus

Resolution authorizing the Director of Property to execute a Land Transfer Agreement with Sutter West Bay Hospitals, doing business as California Pacific Medical Center, for the future conveyance by the City and County of San Francisco to California Pacific Medical Center of real property consisting of a portion of San Jose Avenue between 27th Street and Cesar Chavez Street; and making findings, including findings under the California Environmental Quality Act and findings of consistency with the General Plan and Planning Code Section 101.1.

120364 Changing the Official Sidewalk Widths - Portions of Post Street, Geary Boulevard, Geary Street, Cedar Street, Franklin Street, and Van Ness Avenue - California Pacific Medical Center: Cathedral Hill Campus

Ordinance: 1) amending Ordinance No. 1061 entitled "Regulating the Width of Sidewalks" by adding thereto Section 1596 to change the official sidewalk width of: a) the southerly side of Post Street starting at the southeast intersection with Franklin Street continuing east to the southwest intersection with Van Ness Avenue; b) the northerly side of Geary Boulevard starting at the northeast intersection with Franklin Street continuing east to the northwest intersection with Van Ness Avenue; c) the northerly side of Geary Street starting at the northeast intersection of Van Ness Avenue continuing east 325 feet; d) both sides of Cedar Street starting at the intersection with Van Ness Avenue continuing east to the intersection with Polk Street; e) the westerly side of Van Ness Avenue starting at the intersection with Geary Boulevard continuing north to the intersection with Post Street; and f) the easterly side of Van Ness Avenue starting at the intersection with Geary Street continuing north to the intersection with Cedar Street; 2) making environmental findings and findings pursuant to the General Plan and Planning Code Section 101.1; and 3) requiring relocation, modification, or both of facilities affected by the sidewalk width change.

120365 Changing the Official Sidewalk Widths - Portions of Cesar Chavez Street, Valencia Street and 27th Street - California Pacific Medical Center: St. Luke's Campus

Ordinance: 1) amending Ordinance No. 1061 entitled "Regulating the Width of Sidewalks" by adding thereto Section 1591 to change the official sidewalk width of: a) the southerly side of Cesar Chavez Street starting at the southeast intersection with Guerrero Street continuing east to the southwest intersection with Valencia Street; b) the westerly side of Valencia Street, starting at the southwest intersection with Cesar Chavez Street continuing south to the northwest intersection with Duncan Street; and c) the northern portion of 27th Street starting at the intersection of 27th Street and San Jose Avenue and continuing west for 44.24 feet; 2) making environmental findings and findings pursuant to the General Plan and Planning Code Section 101.1; and 3) requiring relocation, modification, or both of facilities affected by the sidewalk width change.

120366 Development Agreement - Sutter West Bay Hospitals - California Pacific Medical Center

Ordinance: 1) approving a Development Agreement between the City and County of San Francisco and Sutter West Bay Hospitals, for certain real property associated with the California Pacific Medical Center Long Range Development Plan located at various locations in the City and County of San Francisco and generally referred to as the St. Luke's Campus, Cathedral Hill (Van Ness and Geary) Campus, Davies Campus, Pacific Campus, and California Campus; 2) making findings under the California Environmental Quality Act, findings of conformity with the City's General Plan and with the eight priority policies of Planning Code Section 101.1(b); and 3) waiving certain provisions of Administrative Code Chapter 56, and ratifying certain actions taken in connection therewith.

120458 General Plan - Van Ness Area Plan Amendments - California Pacific Medical Center: Cathedral Hill Campus

Ordinance amending the San Francisco General Plan Van Ness Area Plan in order to facilitate the development of a high density medical center at the transit nexus of Van Ness Avenue and Geary Boulevard and reflect various elements of this use; and adopting findings, including environmental findings, Planning Code Section 340 findings, and findings of consistency with the General Plan and the priority policies of Planning Code Section 101.1.

120459 General Plan Map - California Pacific Medical Center: St. Luke's Campus

Ordinance amending the General Plan of the City and County of San Francisco by: 1) amending Map 4 of the Urban Design Element to increase the height limit for the California Pacific Medical Center's St. Luke's Campus (Block No. 6575/Lot Nos. 001, 002; Block No. 6576/Lot No. 021, and the portion of San Jose Avenue between Cesar Chavez Street and 27th Street) to 105 feet; and 2) amending Map 5 of the Urban Design Element to reflect the proposed maximum plan dimensions and maximum diagonal plan dimensions of 227' and 270', respectively, for the St. Luke's Replacement Hospital site and 204' and 228', respectively, for the medical office building site at the St. Luke's Campus; and adopting findings, including environmental findings, Section 340 findings, and findings of consistency with the General Plan and the priority policies of Planning Code Section 101.1.

120460 General Plan Map - California Pacific Medical Center: Cathedral Hill Campus

Ordinance amending the General Plan of the City and County of San Francisco by: 1) amending Map 4 of the Urban Design Element to allow for development up to a height of 265 feet on the block bounded by Van Ness Avenue, Geary Boulevard, Franklin and Post Streets; 2) amending Map 5 of the Urban Design Element to reflect the proposed maximum plan dimensions and maximum diagonal plan dimensions of 385' and 466', respectively, for the Cathedral Hill Hospital site and 265' and 290', respectively, for the Cathedral Hill MOB site; 3) amending Map 1 of the Van Ness Area Plan, to designate the sites of the proposed Cathedral Hill Hospital and Medical Office Building as the Van Ness Medical Use Subdistrict; and 4) amending Map 2 of the Van Ness Area Plan to create a 265-V height/bulk district coterminous with the Hospital site; and adopting findings, including environmental findings, Planning Code Section 340 findings, and findings of consistency with the General Plan and the priority policies of Planning Code Section 101.1.

In accordance with Section 67.7-1 of the San Francisco Administrative Code, persons who are unable to attend the hearing on these matters may submit written comments to the City prior to the time the hearing begins. These comments will be made a part of the official public records in these matters, and shall be brought to the attention of the Members of the Committee. Written comments should be addressed to Angela Calvillo, Clerk of the Board, Room 244, City Hall, 1 Dr. Carlton Goodlett Place, San Francisco, 94102. Information relating to this matter is available in the Office of the Clerk of the Board and agenda information relating to this matter will be available for public review on Friday, June 8, 2012.



Angela Calvillo, Clerk of the Board

DATED: May 30, 2012

MAILED: June 1, 2012

PUBLISHED: June 1 & 8, 2012 (Street Vacation); June 5, 2012 (General Plan Amendments & Development Agreement)

CALIFORNIA NEWSPAPER SERVICE BUREAU

DAILY JOURNAL CORPORATION

Mailing Address : 915 E FIRST ST, LOS ANGELES, CA 90012
Telephone (213) 229-5300 / Fax (213) 229-5481
Visit us @ WWW.DAILYJOURNAL.COM

Alisa Miller
S.F. BD OF SUPERVISORS (OFFICIAL NOTICES)
1 DR CARLTON B GOODLETT PL #244
SAN FRANCISCO, CA 94102

COPY OF NOTICE

Notice Type: GPN GOVT PUBLIC NOTICE
Ad Description AM - 06.15.12 CPMC Land Use Hearing

To the right is a copy of the notice you sent to us for publication in the SAN FRANCISCO CHRONICLE. Please read this notice carefully and call us with any corrections. The Proof of Publication will be filed with the Clerk of the Board. Publication date(s) for this notice is (are):

06/05/2012

Daily Journal Corporation

Serving your legal advertising needs throughout California. Call your local

BUSINESS JOURNAL, RIVERSIDE	(951) 784-0111
DAILY COMMERCE, LOS ANGELES	(213) 229-5300
LOS ANGELES DAILY JOURNAL, LOS ANGELES	(213) 229-5300
ORANGE COUNTY REPORTER 10%, SANTA ANA	(714) 543-2027
ORANGE COUNTY REPORTER, SANTA ANA	(714) 543-2027
SAN DIEGO COMMERCE, SAN DIEGO	(619) 232-3486
SAN FRANCISCO DAILY JOURNAL, SAN FRANCISCO	(800) 640-4829
SAN JOSE POST-RECORD, SAN JOSE	(408) 287-4866
SONOMA COUNTY HERALD-RECORDER, SANTA ROSA	(707) 545-1166
THE DAILY RECORDER, SACRAMENTO	(916) 444-2355
THE INTER-CITY EXPRESS, OAKLAND	(510) 272-4747

CNS 2324255

NOTICE OF PUBLIC HEARING
BOARD OF SUPERVISORS OF THE
CITY AND COUNTY OF SAN FRAN-
CISCO LAND USE & ECONOMIC DE-
VELOPMENT COMMITTEE FRIDAY,
JUNE 15, 2012 - 10:00 AM LEGISLA-
TIVE CHAMBER ROOM 250, CITY
HALL, 1 DR. CARLTON B. GOOD-
LETT PL, SF, CA

NOTICE IS HEREBY GIVEN THAT
THE LAND USE AND ECONOMIC DE-
VELOPMENT COMMITTEE WILL A-
HOLD A PUBLIC HEARING TO CON-
SIDER THE FOLLOWING PROPOSAL
AND SAID PUBLIC HEARING WILL
BE HELD AS FOLLOWS, AT WHICH
TIME ALL INTERESTED PARTIES
MAY ATTEND AND BE HEARD. SUB-
JECT: CALIFORNIA PACIFIC MEDI-
CAL CENTER LONG RANGE DEVEL-
OPMENT PLAN. (File No. 120366) De-
velopment Agreement - Sutter West
Bay Hospitals - California Pacific
Medical Center. Ordinance: 1) approv-
ing a Development Agreement between
the City and County of San Francisco
and Sutter West Bay Hospitals, for cer-
tain real property associated with the
California Pacific Medical Center Long
Range Development Plan located at
various locations in the City and County
of San Francisco and generally referred
to as the St. Luke's Campus, Cathedral
Hill (Van Ness and Geary) Campus, Dav-
ies Campus, Pacific Campus, and Cali-
fornia Campus; 2) making findings un-
der the California Environmental Quality
Act, findings of conformity with the City's
General Plan and with the eight priority
policies of Planning Code Section
101.1(b) and 3) waiving certain pro-
visions of Administrative Code Chapter
56, and ratifying certain actions taken in
connection therewith. (File No. 120459)
**General Plan - Van Ness Area Plan
Amendments - California Pacific
Medical Center: Cathedral Hill Cam-
pus.** Ordinance amending the San
Francisco General Plan Van Ness Area
Plan in order to facilitate the develop-
ment of a high density medical center at
the transit nexus of Van Ness Avenue
and Geary Boulevard and reflect various
elements of this use; and adopting find-
ings, including environmental findings,
Planning Code Section 340 findings,
and findings of consistency with the
General Plan and the priority policies of
Planning Code Section 101.1. (File No.
120459) **General Plan Map - California
Pacific Medical Center: St. Luke's
Campus.** Ordinance amending the
General Plan of the City and County of
San Francisco by: 1) amending Map 4
of the Urban Design Element to in-
crease the height limit for the California
Pacific Medical Centers St. Luke's
Campus (Block No. 6575/Lot Nos. 001,
002; Block No. 6576/Lot No. 021, and
the portion of San Jose Avenue be-
tween Cesar Chavez Street and 27th
Street) to 105 feet; and 2) amending
Map 5 of the Urban Design Element to
reflect the proposed maximum plan di-
mensions and maximum diagonal plan
dimensions of 227' and 270', respec-
tively, for the St. Luke's Replacement
Hospital site and 204' and 228', respec-
tively, for the medical office building site
at the St. Luke's Campus; and adopting
findings, including environmental find-

ings, Section 340 findings, and findings
of consistency with the General Plan
and the priority policies of Planning
Code Section 101.1. (File No. 120460)
**General Plan Map - California Pacific
Medical Center: Cathedral Hill Cam-
pus.** Ordinance amending the General
Plan of the City and County of San
Francisco by: 1) amending Map 4 of the
Urban Design Element to allow for de-
velopment up to a height of 265 feet on
the block bounded by Van Ness Ave-
nue, Geary Boulevard, Franklin and
Post Streets; 2) amending Map 5 of the
Urban Design Element to reflect the
proposed maximum plan dimensions
and maximum diagonal plan dimensions
of 385' and 466', respectively, for the
Cathedral Hill Hospital site and 265' and
230', respectively, for the Cathedral Hill
MOB site; 3) amending Map 1 of the
Van Ness Area Plan, to designate the
sites of the proposed Cathedral Hill
Hospital and Medical Office Building as
the Van Ness Medical Use Subdistrict;
and 4) amending Map 2 of the Van Ness
Area Plan to create a 265-V height/bulk
district coterminous with the Hospital
site; and adopting findings, including
environmental findings, Planning Code
Section 340 findings, and findings of
consistency with the General Plan and
the priority policies of Planning Code
Section 101.1.

In accordance with Section 67.7-1 of the
San Francisco Administrative Code,
persons who are unable to attend the
hearing on these matters may submit
written comments to the City prior to the
time the hearing begins. These com-
ments will be made a part of the official
public records in these matters, and
shall be brought to the attention of the
Members of the Committee. Written
comments should be addressed to An-
gela Calvillo, Clerk of the Board, Room
244, City Hall, 1 Dr. Carlton Goodlett
Place, San Francisco, 94102. Informa-
tion relating to this matter is available in
the Office of the Clerk of the Board and
agenda information relating to this mat-
ter will be available for public review on
Friday, June 8, 2012.
Angela Calvillo, Clerk of the Board



* A 0 0 0 0 0 2 6 8 0 5 2 3 *