



**SAN FRANCISCO FIRE DEPARTMENT**  
CITY AND COUNTY OF SAN FRANCISCO

**MEMORANDUM**

**TO:** John Updike, Director  
Real Estate Division

**FROM:** Joanne Hayes-White, Chief  
San Francisco Fire Department

**DATE:** September 26, 2016

**RE:** **Jurisdictional Transfer from the Real Estate Division to the San Francisco Fire Department - Block 5286A, Lot 004**

The City, under the jurisdiction of the Real Estate Division (RED) owns a parcel strip located between McKinnon Avenue and Jerrold Avenue. The site is located adjacent to a City-owned parcel, Block 5286A, Lot 006, under the jurisdiction of the San Francisco Fire Department (SFFD). The subject property is approximately 12, 863 sq. ft., as depicted in Exhibit A, and is vacant.

In June 2016, San Francisco voters approved the \$350 million Public Health and Safety bond (Prop A). This bond measure has specifically identified the Ambulance Deployment Facility as one project to be funded by Prop A. The Ambulance Deployment Facility project will construct a new San Francisco Fire Department Emergency Medical Services (EMS) Facility and new parking structure at 2245 Jerrold Avenue in San Francisco, to improve the seismic performance of the facility, increase efficiency and improve ambulatory response times. The new facility would also improve the City's capacity for meeting current and future demands for EMS services, including training of staff.

The Ambulance Deployment Facility project involves demolition of two structures built in the 1950's and construction of a three-story, approximately 30,344-gross-square-foot (gsf) Ambulance Deployment Facility and a three-level, approximately 62,000 gsf parking structure behind the existing Fire Department Fire Station 9 located on same block/lot 5286A / 006. The 1.7-acre project site consists of these two parcels in an intensively developed area of San Francisco's Bayview neighborhood characterized by various warehouse, distribution and light industrial uses.

The subject parcel 5286A / 004 is critical to the use and function of the Ambulance Deployment Facility project, and it is required in order to allow for the traffic circulation that is necessary for the project. No portion of the Ambulance Deployment Facility or parking garage will front on either Jerrold Avenue or McKinnon Avenue; the two structures would be located in the interior of the project site. The only access and egress to and from the Ambulance Deployment Facility and parking garage will be through block / lot 5286A / 004.

The facility will operate 24 hours a day, seven days a week and will be staffed for both daytime and night-time shifts. Emergency vehicles will not be dispatched from the proposed facility to emergency incidents; rather (and as currently practiced), they will be dynamically deployed from the proposed facility to pre-determined positions throughout the City at the start of each work shift.

SFFD is requesting the jurisdictional transfer of the subject property from RED to SFFD to accommodate the project.

If RED has no objections, please confirm by signing below where indicated and returning a copy of this memo to Fire Chief Joanne Hayes-White, San Francisco Fire Department, 698 Second Street, San Francisco, CA 94107. We will then request the Real Estate Division to initiate the jurisdictional transfer of the above referenced property.

The Real Estate Division concurs with a jurisdictional transfer of the parcel as shown in Exhibit A to the San Francisco Fire Department.

**Real Estate Division**

By \_\_\_\_\_  
Director

Dated this \_\_\_\_ day of \_\_\_\_\_, 2016.

Attachments

EXTENT OF WORK

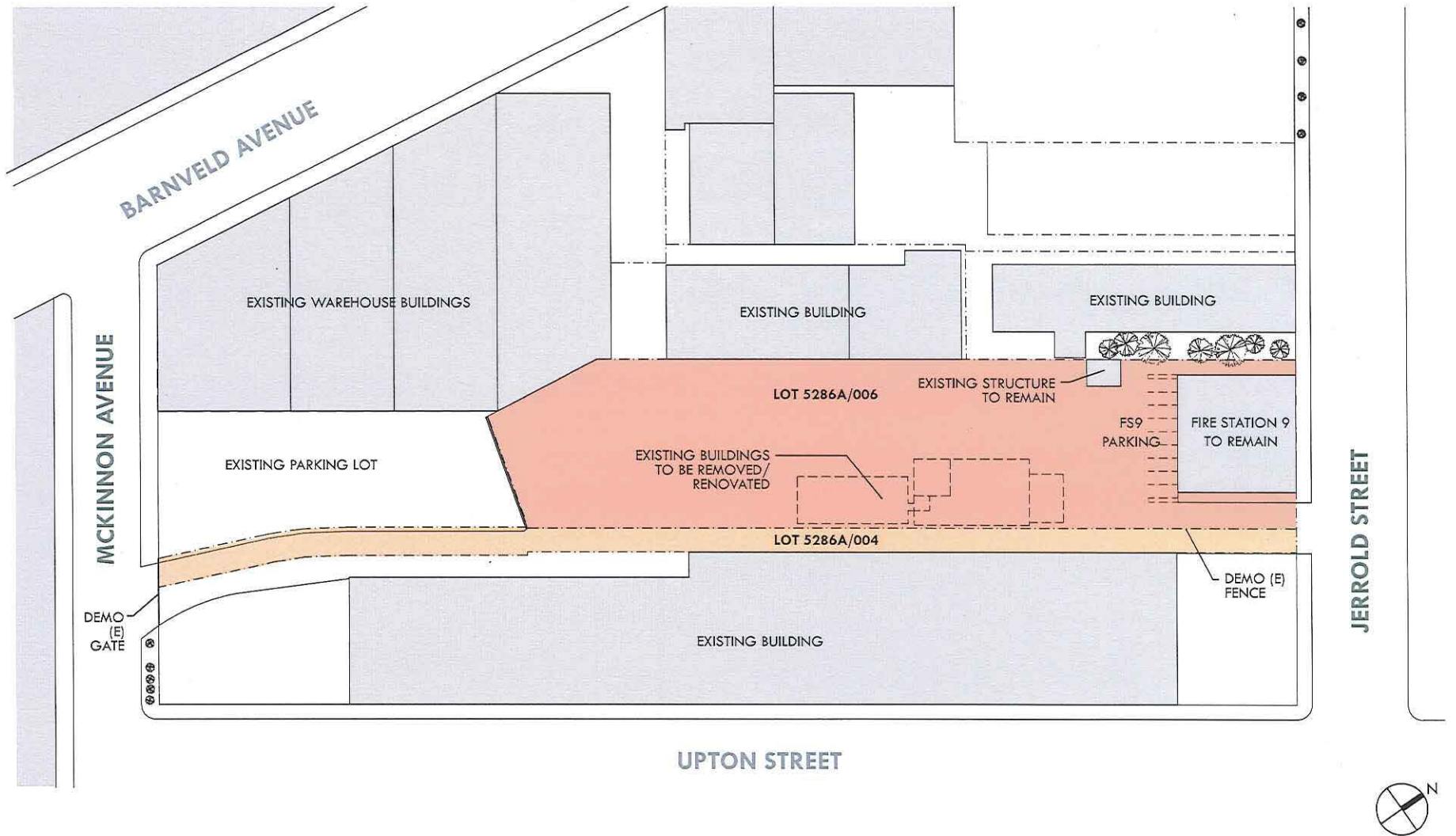

August 28th, 2015

EMS AT JERROLD AVENUE

ASSESSOR'S BLOCK MAP

