

**RECORDING REQUESTED BY:
City and County of San Francisco**

**WHEN RECORDED MAIL TO:
Director of Property
Real Estate Department
City and County of San Francisco
25 Van Ness Avenue, Suite 400
San Francisco, CA 94102**

**Documentary Transfer Tax is Zero;
No fee for recording pursuant to
Government Code § 27383**

**APN: 5000-046
[No Situs] Gilman Ave, San Francisco, CA**

Space above this line for Recorder's Use

**OFFER OF DEDICATION
Lot V (Gilman Avenue)
Final Map No. 12681 Candlestick Point Major Phase 2**

CP DEVELOPMENT CO., LLC, a Delaware limited liability company, being the fee title owner of record of the herein described property, hereby irrevocably offers to dedicate, in fee title, to the City and County of San Francisco, a municipal corporation (the "City"), any and all right, title and interest in the real property situated in the City and County of San Francisco, State of California, as described in **Exhibit A** (Legal Description) and shown on **Exhibit A-1** (Plat Map) attached hereto and made a part hereof.

It is understood and agreed that the City, and its successors and assigns, shall incur no liability or obligation whatsoever by virtue of this offer of dedication, and shall not assume any responsibility for the offered land unless and until the land is conveyed to and accepted by the City by appropriate action of the City's Board of Supervisors. Any such conveyance and acceptance will be evidenced by the execution and recordation of a grant deed.

The provisions hereof shall inure to the benefit of and be binding upon the heirs, successors, assigns and personal representatives of the respective parties hereto.

(Signatures on following page)

IN WITNESS WHEREOF, the undersigned has executed this instrument as of this 2nd
day of JUNE, 2026.

CP DEVELOPMENT CO., LLC,
a Delaware limited liability company

By: 
Name: Suheil J. Totah
Title: Vice President

A notary public or other officer completing this certificate verifies only the identity of the individual who signed the document to which this certificate is attached, and not the truthfulness, accuracy, or validity of that document.

State of California)
County of San Francisco)

On June 2, 2026, before me, Cathy Pruetto, a Notary Public, personally appeared Suheil J. Totah, who proved to me on the basis of satisfactory evidence to be the person whose name is subscribed to the within instrument and acknowledged to me that he executed the same in his authorized capacity, and that by his signature on the instrument the person, or the entity upon behalf of which the person acted, executed the instrument.

I certify under PENALTY OF PERJURY under the laws of the State of California that the foregoing paragraph is true and correct.

WITNESS my hand and official seal.

Signature

Cathy Pruetto



Exhibit A

LEGAL DESCRIPTION

MAY 26, 2026
JOB NO.: 1804-040

**EXHIBIT A
LEGAL DESCRIPTION
GILMAN AVENUE
LOT V, FINAL MAP NO. 12681
CITY AND COUNTY OF SAN FRANCISCO, CALIFORNIA**

REAL PROPERTY IN THE CITY OF SAN FRANCISCO, COUNTY OF SAN FRANCISCO,
STATE OF CALIFORNIA, DESCRIBED AS FOLLOWS:

BEING ALL OF LOT V (GILMAN AVENUE), AS SAID LOT AND STREET ARE SHOWN
AND SO DESIGNATED ON FINAL MAP NO. 12681, FILED ON _____,

2026, IN BOOK ____ OF FINAL MAPS, AT PAGES ____ THROUGH ____, IN THE
OFFICE OF THE RECORDER OF THE CITY AND COUNTY OF SAN FRANCISCO.

ATTACHED HERETO IS AN ILLUSTRATIVE PLAT TO ACCOMPANY LEGAL
DESCRIPTION, AND BY THIS REFERENCE MADE A PART HEREOF.

THIS REAL PROPERTY DESCRIPTION WAS PREPARED BY ME, OR UNDER MY
DIRECTION, IN CONFORMANCE WITH THE PROFESSIONAL LAND SURVEYORS ACT.



END OF DESCRIPTION

S. Kyle Pack

SABRINA KYLE PACK P.L.S.
P.L.S. NO. 8164

5/28/2026
DATE

Exhibit A-1

PLAT MAP

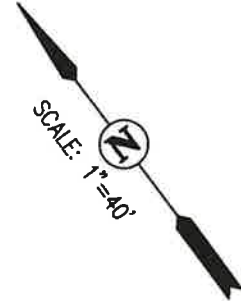

GILMAN AVENUE
80' WIDE

GILMAN AVENUE
20' WIDE

GILMAN AVENUE
WIDTH VARIES
LOT V⁽¹⁾

GIANTS DRIVE
WIDTH VARIES
U MAPS 58

LOT 1⁽¹⁾

REFERENCES:

(1) FINAL MAP NO. 12681

EXHIBIT A-1
ILLUSTRATIVE
PLAT TO ACCOMPANY LEGAL DESCRIPTION

GILMAN AVENUE
LOT V, FINAL MAP NO. 12681
CITY AND COUNTY OF SAN FRANCISCO, CALIFORNIA

MAY 26, 2026

SHEET 1 OF 1



CIVIL ENGINEERS

SAN RAMON ■ (925) 866-0322

ROSEVILLE ■ (916) 788-4456

WWW.CBANDG.COM

■ SURVEYORS ■ PLANNERS