

DETAIL A

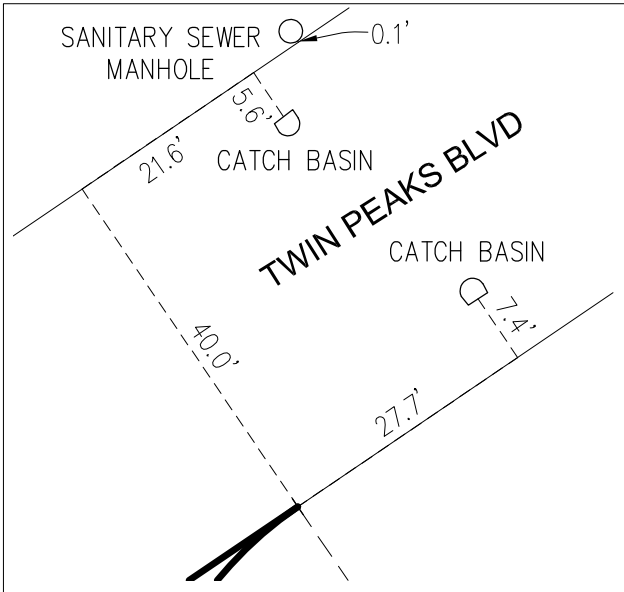

DETAIL B

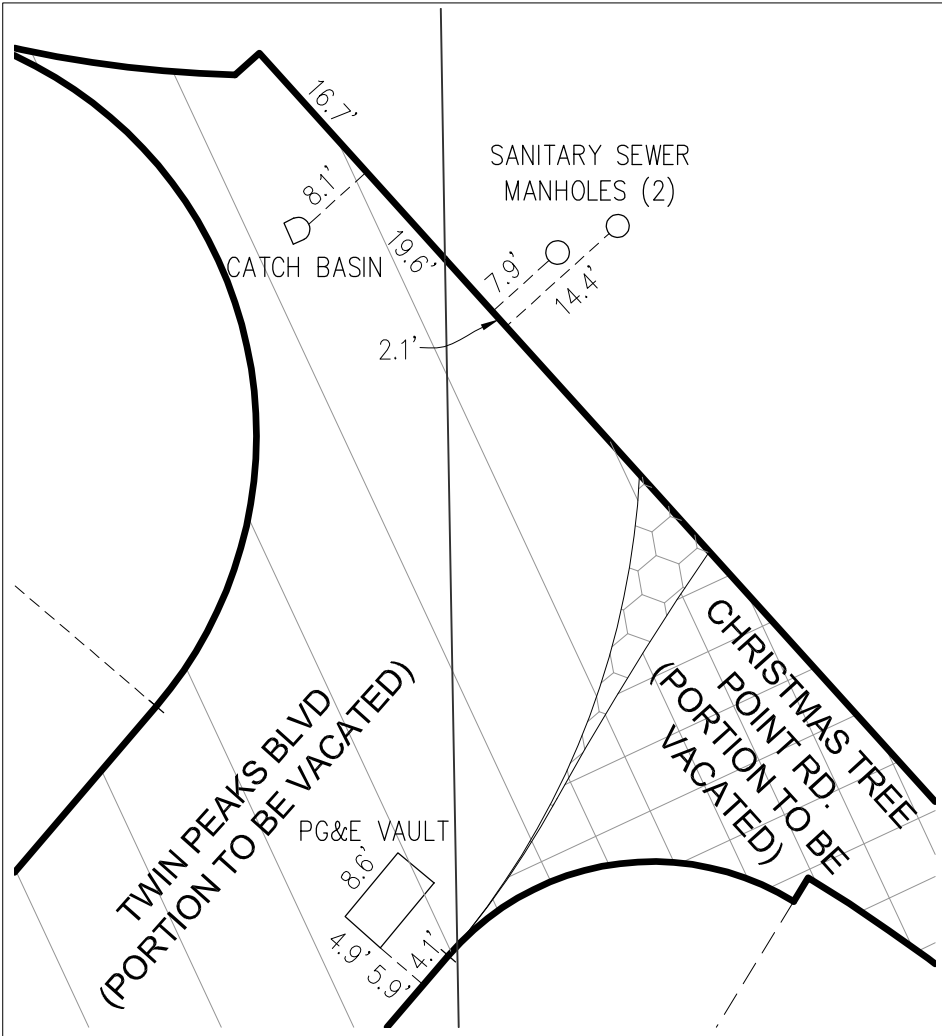

DETAIL C

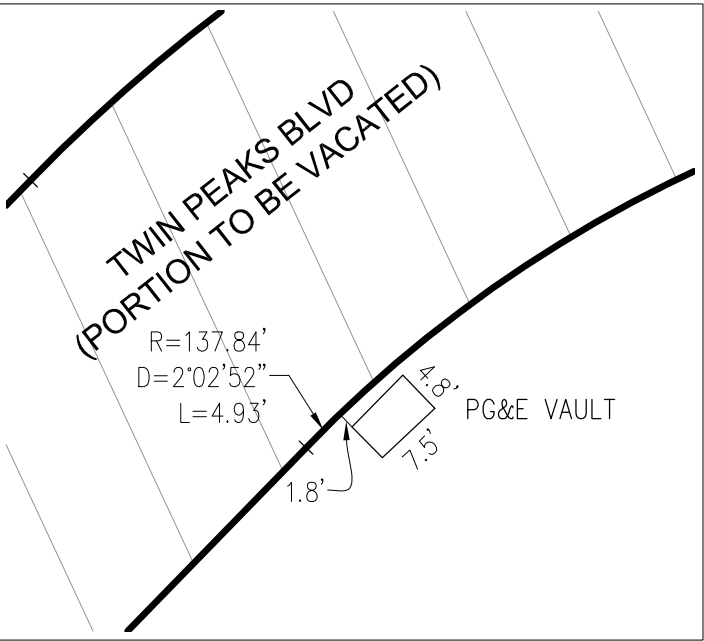

DETAIL E

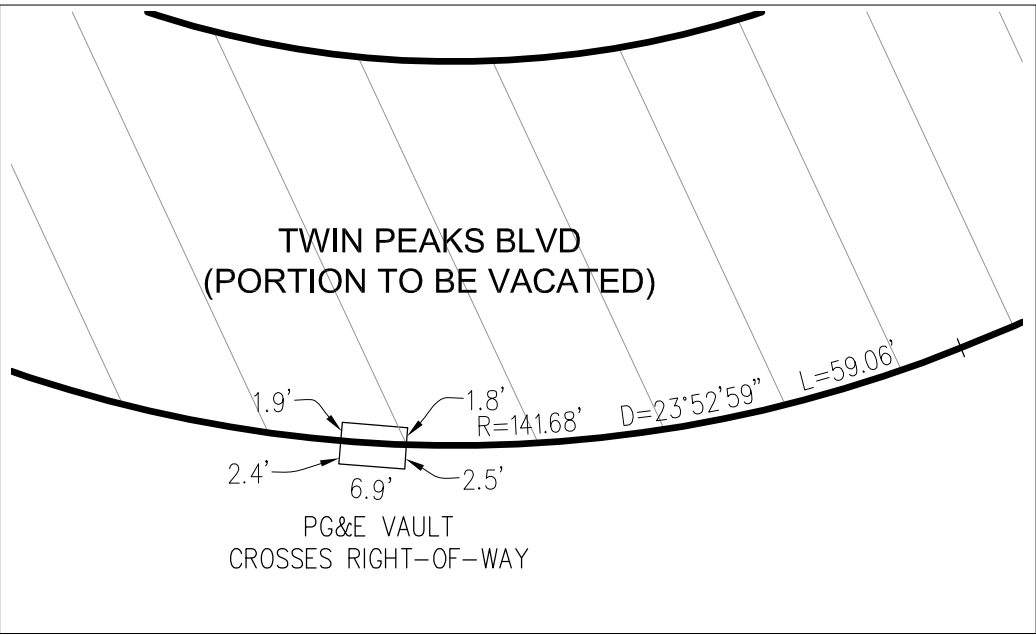

DETAIL D



APPROVED:

ELIAS WINSLOW FRENCH, PLS 9406
CITY AND COUNTY SURVEYOR

COUNTY SURVEYOR'S NOTE: VACATION AREA IS UNDER JURISDICTION & CONTROL OF CITY & COUNTY OF SAN FRANCISCO PER BOOK H OF MAPS PAGE 110, BOOK R OF MAPS PAGE 88, AND BOOK U OF MAPS PAGE 102, ALL ON FILE IN THE OFFICE OF THE RECORDER OF THE CITY AND COUNTY OF SAN FRANCISCO.

10-20-2025

DATE

CITY AND COUNTY OF SAN FRANCISCO

DEPARTMENT OF PUBLIC WORKS

VACATION OF A PORTION OF TWIN PEAKS BLVD AND A PORTION OF
CHRISTMAS TREE POINT RD.

FILE:
SUR 2025-005

SHEET 2 OF 2

SCALE 1" = 20'

REVISION: