





**ABBREVIATIONS**

APN	ASSESSOR'S PARCEL NUMBER
N	NORTH
EX	EXISTING
ROW	RIGHT OF WAY
TC	TOP OF CURB
FL	FLOW LINE
C	CURVE
CONC	CONCRETE
L	LINE
S/W	SIDEWALK
BSW	BACK OF SIDEWALK
BVCE	BEGINNING OF VERTICAL CURVE ELEVATION
EVCE	END OF VERTICAL CURVE ELEVATION
PVIE	POINT OF VERTICAL INTERSECTION ELEVATION

**NOTE:**

1. THE LINE AND CURVE DATA SHOWN MAY OVERLAP ON MULTIPLE SHEETS.

**LEGEND**

	PROPERTY LINE
	CENTERLINE
	PROPOSED CURB
	EXISTING OFFICIAL CURB TO REMAIN
	NEW CURB RAMP

**REFERENCES:**

1. "PARCEL MAP 9640", RECORDED FEBRUARY 12, 2020 IN BOOK 50 OF PARCEL MAPS, PAGES 41-45, IN THE OFFICE OF THE CITY & COUNTY RECORDER.

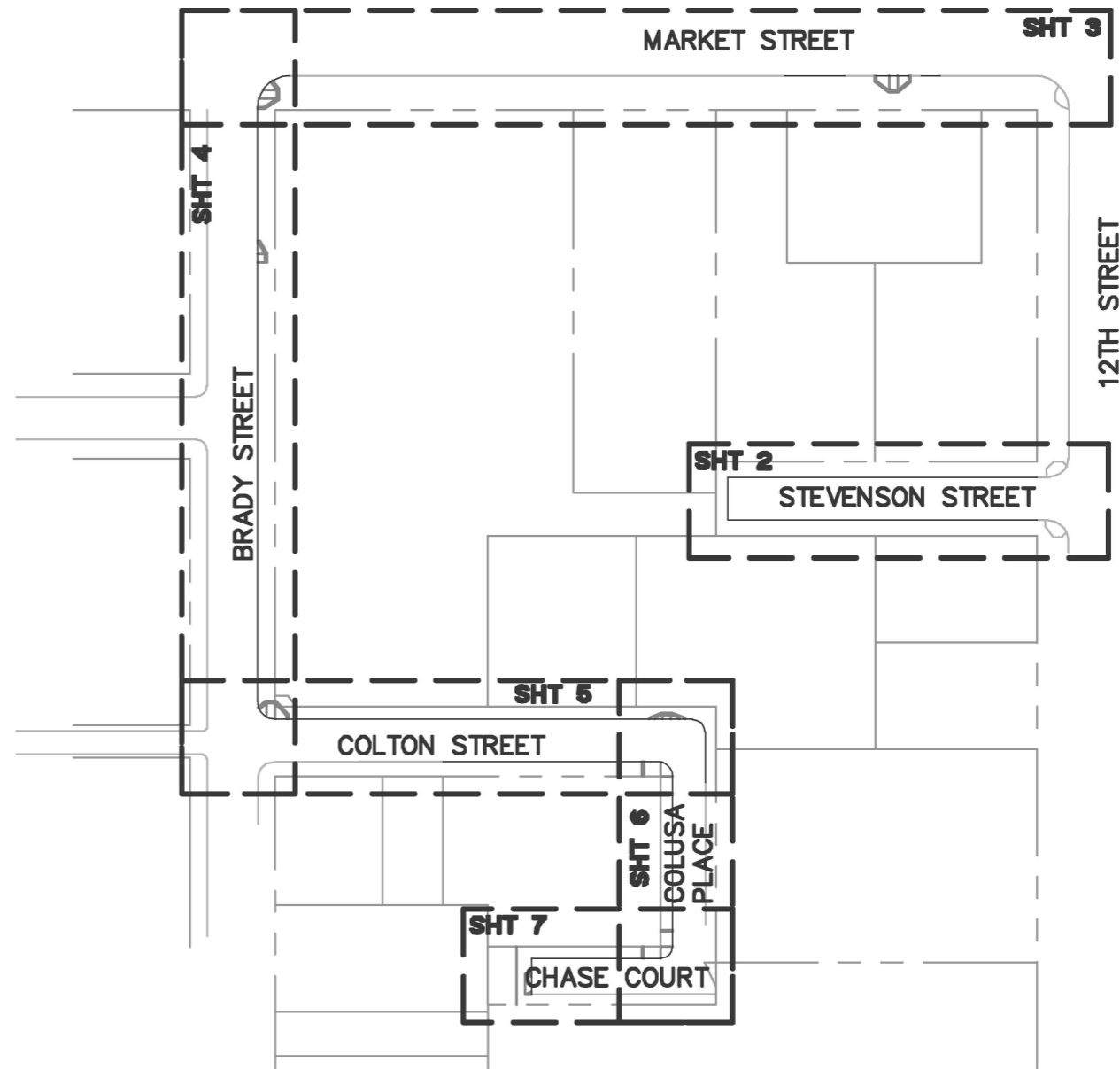

*BR*

DOUGLAS PETERSEN, PE  
SR. PROJECT MANAGER  
BKF ENGINEERS



07/14/2023

DATE



APPROVED:

\_\_\_\_\_  
WILLIAM E. BLACKWELL JR., PLS 8251  
ACTING CITY & COUNTY SURVEYOR

\_\_\_\_\_  
DATE

**CITY AND COUNTY OF SAN FRANCISCO**  
SAN FRANCISCO PUBLIC WORKS

OFFICIAL GRADES OF SIDEWALK AND CURB ELEVATIONS ALONG STEVENSON STREET, 12TH STREET, MARKET STREET, BRADY STREET, COLTON STREET, COLUSA PLACE, AND CHASE COURT

FILE: Q-20-1202

SHEET 1 OF 7

SCALE: 1"=80'

REVISION

Apr 11, 2024 - 2:08pm K:\2017\176049\_1629-Market\ENG\PLITS-Q&A-MAP\A-20\1629MKT-020.dwg

LINE TABLE - SIDEWALK		
LINE NO.	LENGTH	DIRECTION
L1	145.42	N46°17'46"E
L2	20.00	S43°42'14"E
L3	145.42	N46°17'46"E

LINE TABLE - BSW & ROW		
LINE NO.	LENGTH	DIRECTION
L14	150.92	S46°17'46"W
L15	35.00	N43°42'14"W
L16	150.92	N46°17'46"E

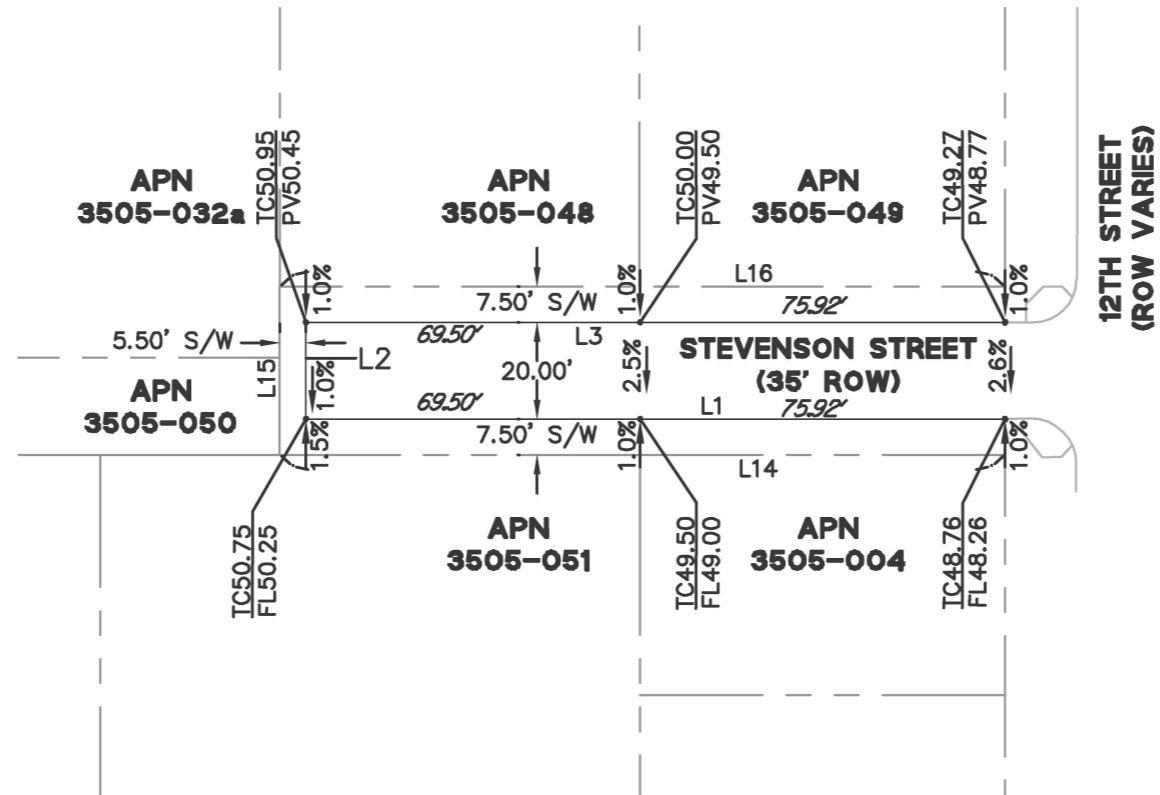

**NOTES:**

1. ITALIC NUMBERS REPRESENT THE DISTANCE BETWEEN ELEVATIONS.

**KEY MAP**

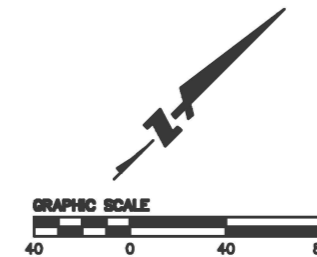
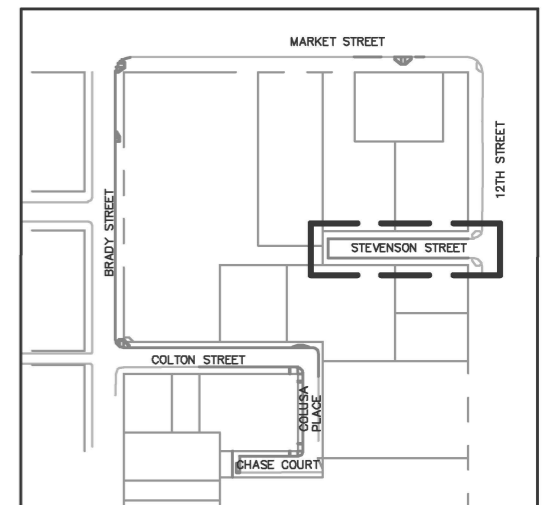

APPROVED:

\_\_\_\_\_  
 WILLIAM E. BLACKWELL JR., PLS 8251  
 ACTING CITY & COUNTY SURVEYOR

\_\_\_\_\_  
 DATE

**CITY AND COUNTY OF SAN FRANCISCO**  
 SAN FRANCISCO PUBLIC WORKS

OFFICIAL GRADES OF SIDEWALK AND CURB ELEVATIONS ALONG STEVENSON STREET, 12TH STREET, MARKET STREET, BRADY STREET, COLTON STREET, COLUSA PLACE, AND CHASE COURT

FILE: Q-20-1202

SHEET 2 OF 7

SCALE: 1" = 40'

REVISION

LINE TABLE - SIDEWALK		
LINE NO.	LENGTH	DIRECTION
L4	8.68	N46°17'46"E
L5	15.66	N46°17'46"E
L6	28.08	N46°17'46"E
L7	279.29	N43°42'14"W

CURVE TABLE			
CURVE NO.	LENGTH	RADIUS	DELTA
C1	23.56	15.00	090°00'00"

LINE TABLE - BSW & ROW		
LINE NO.	LENGTH	DIRECTION
L17	358.29	S46°17'46"W
L18	280.29	S43°42'14"E

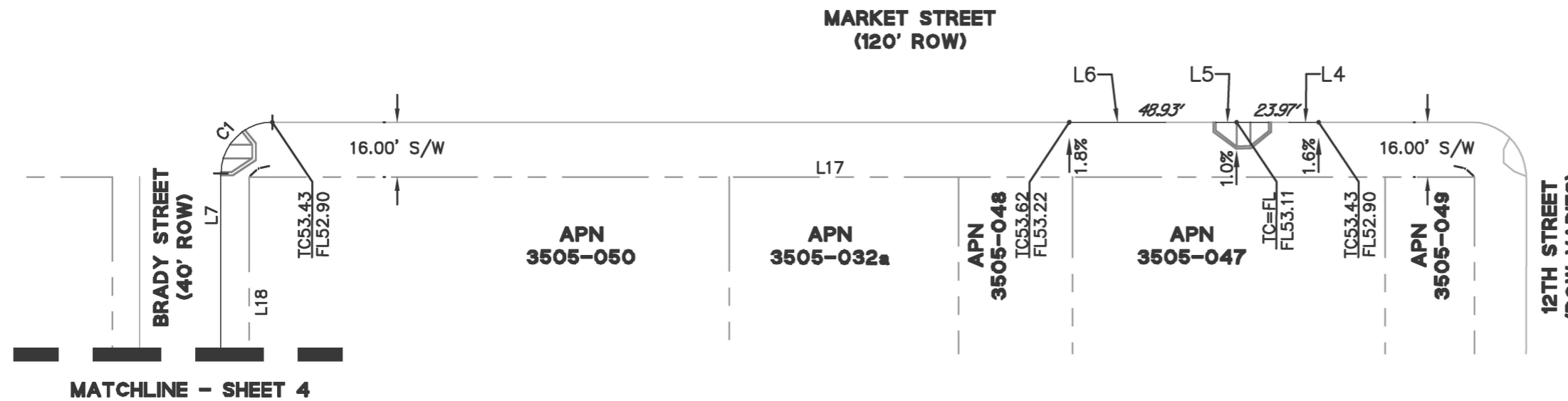

**NOTES:**

1. ITALIC NUMBERS REPRESENT THE DISTANCE BETWEEN ELEVATIONS.

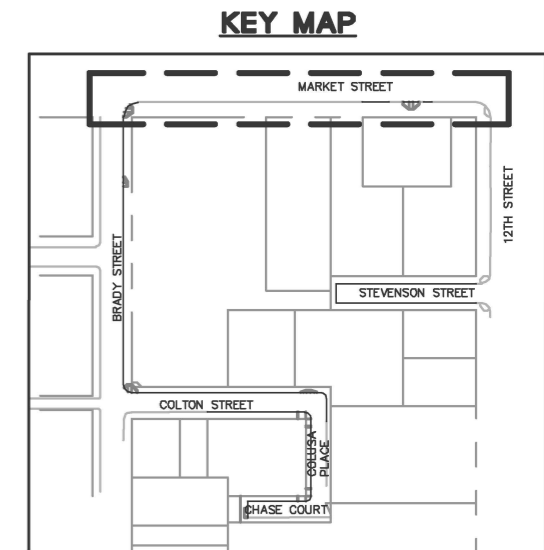
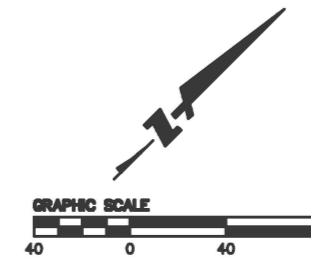

APPROVED:

\_\_\_\_\_  
 WILLIAM E. BLACKWELL JR., PLS 8251  
 ACTING CITY & COUNTY SURVEYOR

\_\_\_\_\_  
 DATE

**CITY AND COUNTY OF SAN FRANCISCO**  
 SAN FRANCISCO PUBLIC WORKS

OFFICIAL GRADES OF SIDEWALK AND CURB ELEVATIONS ALONG STEVENSON STREET, 12TH STREET, MARKET STREET, BRADY STREET, COLTON STREET, COLUSA PLACE, AND CHASE COURT

FILE: Q-20-1202

SHEET 3 OF 7

SCALE: 1" = 40'

REVISION

LINE TABLE - SIDEWALK		
LINE NO.	LENGTH	DIRECTION
L7	279.29	N43°42'14"W
L8	196.63	S46°17'46"W

CURVE TABLE			
CURVE NO.	LENGTH	RADIUS	DELTA
C1	23.56	15.00	090°00'00"
C2	12.57	8.00	090°00'00"

LINE TABLE - BSW & ROW		
LINE NO.	LENGTH	DIRECTION
L17	358.29	S46°17'46"W
L18	280.29	S43°42'14"E
L19	207.38	N46°17'46"E

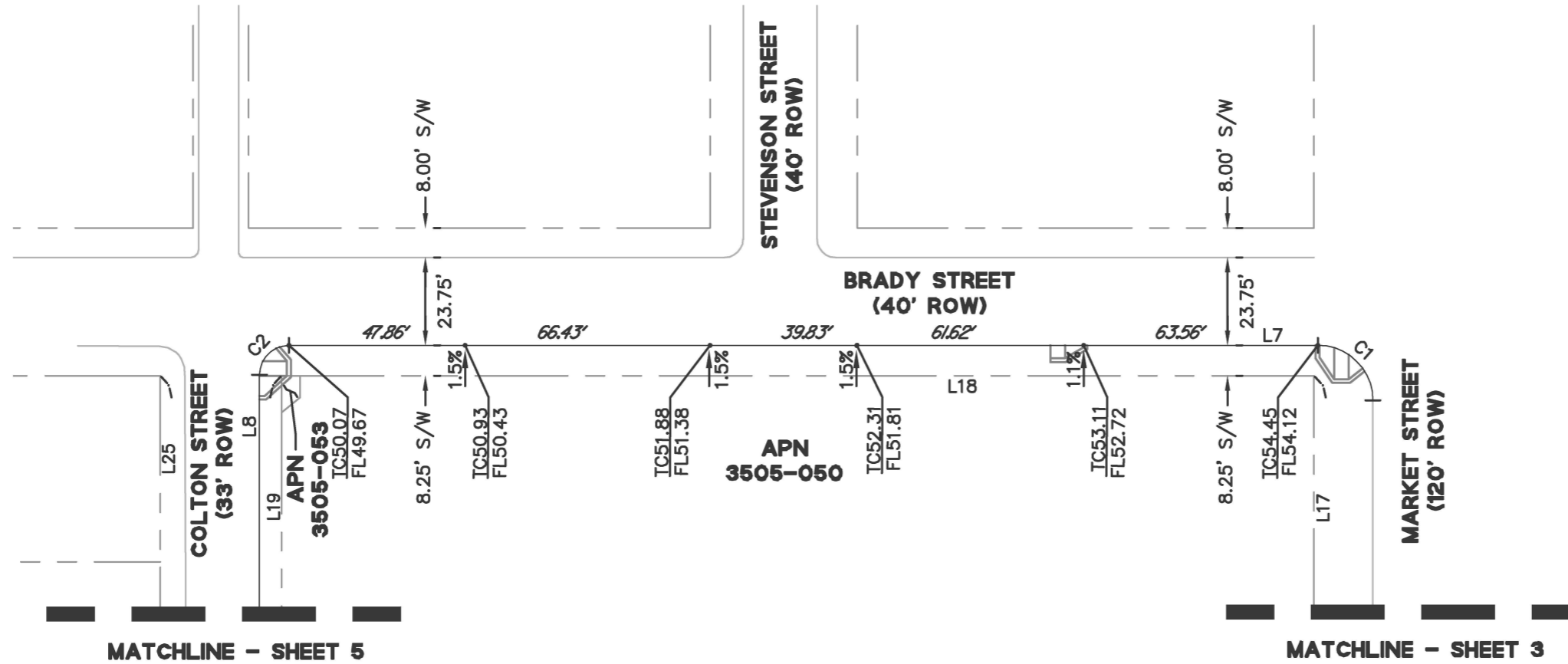

**KEY MAP**

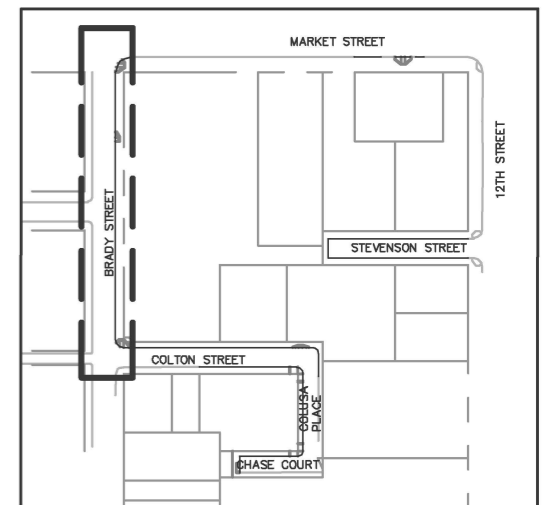

**NOTES:**

1. ITALIC NUMBERS REPRESENT THE DISTANCE BETWEEN ELEVATIONS.



APPROVED:

WILLIAM E. BLACKWELL JR., PLS 8251  
ACTING CITY & COUNTY SURVEYOR

DATE

CITY AND COUNTY OF SAN FRANCISCO  
SAN FRANCISCO PUBLIC WORKS

OFFICIAL GRADES OF SIDEWALK AND CURB ELEVATIONS ALONG STEVENSON STREET, 12TH STREET, MARKET STREET, BRADY STREET, COLTON STREET, COLUSA PLACE, AND CHASE COURT

FILE: Q-20-1202

SHEET 4 OF 7

SCALE: 1" = 40'

REVISION

LINE TABLE - SIDEWALK		
LINE NO.	LENGTH	DIRECTION
L7	279.29	N43°42'14"W
L8	196.63	S46°17'46"W
L9	23.90	N43°42'14"W
L10	100.88	S46°17'46"W
L11	80.50	N43°42'14"W

CURVE TABLE			
CURVE NO.	LENGTH	RADIUS	DELTA
C2	12.57	8.00	090°00'00"
C3	9.42	6.00	090°00'00"
C4	11.00	7.00	090°00'00"

LINE TABLE - BSW & ROW		
LINE NO.	LENGTH	DIRECTION
L18	280.29	S43°42'14"E
L19	207.38	N46°17'46"E
L20	120.40	S43°42'14"E
L24	80.00	N43°42'14"W
L25	181.38	S46°17'46"W

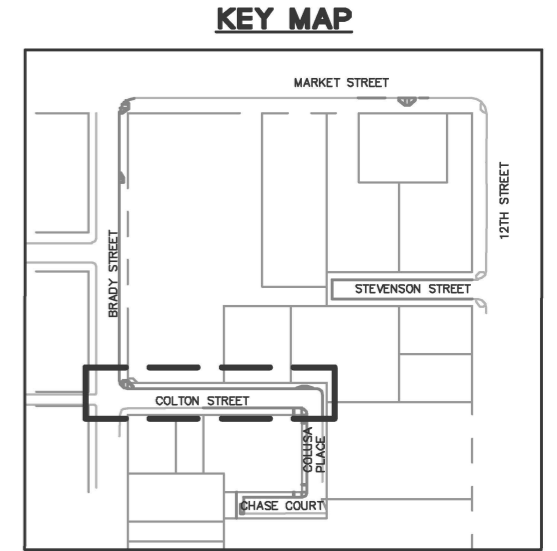
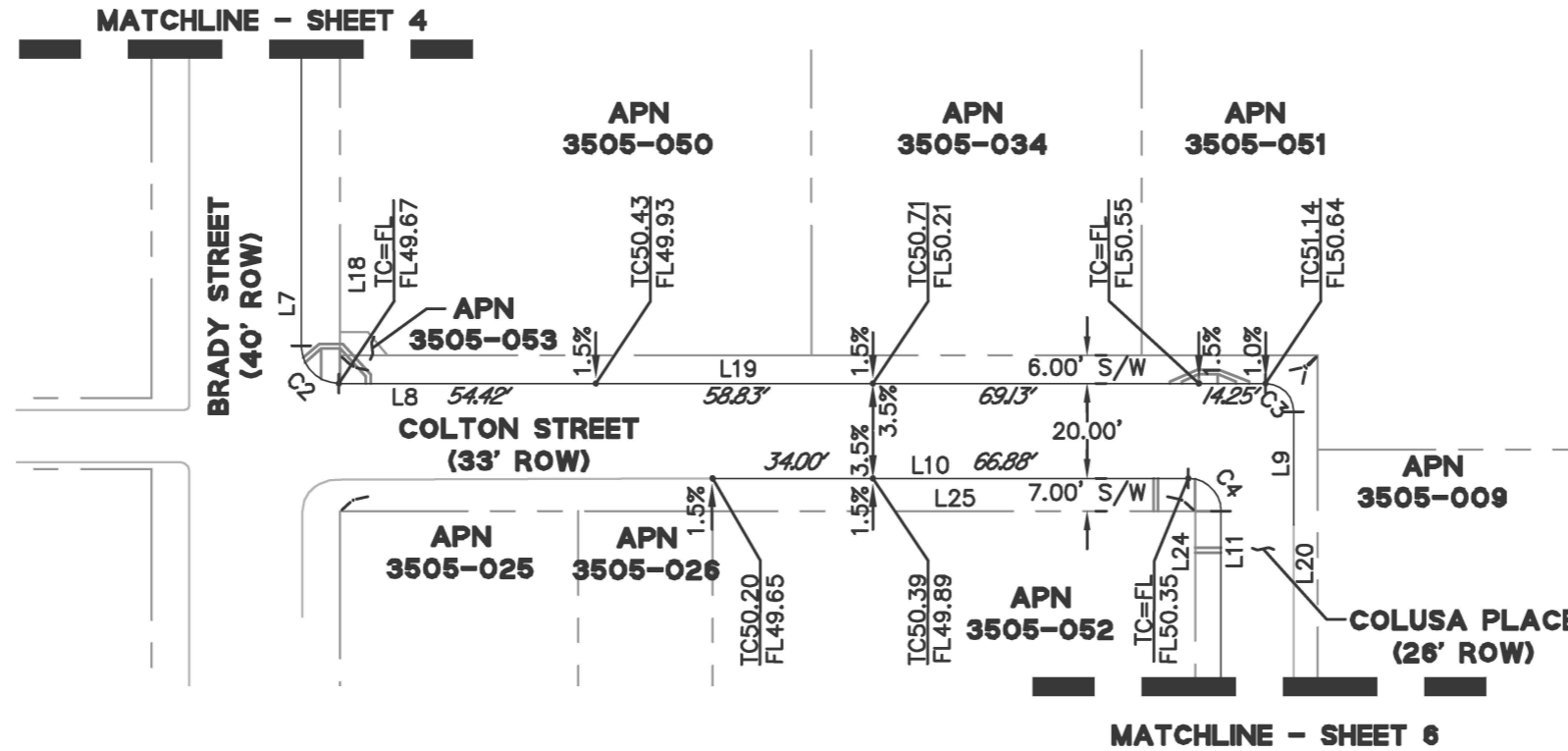

**NOTES:**  
 1. ITALIC NUMBERS REPRESENT THE DISTANCE BETWEEN ELEVATIONS.



APPROVED:  
 \_\_\_\_\_  
 WILLIAM E. BLACKWELL JR., PLS 8251  
 ACTING CITY & COUNTY SURVEYOR

DATE  
 \_\_\_\_\_

CITY AND COUNTY OF SAN FRANCISCO  
 SAN FRANCISCO PUBLIC WORKS

OFFICIAL GRADES OF SIDEWALK AND CURB ELEVATIONS ALONG STEVENSON STREET, 12TH STREET, MARKET STREET, BRADY STREET, COLTON STREET, COLUSA PLACE, AND CHASE COURT

FILE: Q-20-1202      SHEET 5 OF 7      SCALE: 1" = 40'      REVISION

Apr 11, 2024 - 2:34pm K:\2017\176049\_1629-Market\ENG\PLOTS-04A-MAP\0-20\1629MKT-020.dwg

LINE TABLE - SIDEWALK		
LINE NO.	LENGTH	DIRECTION
L8	196.63	S46°17'46"W
L9	23.90	N43°42'14"W
L10	100.88	S46°17'46"W
L11	80.50	N43°42'14"W
L12	61.19	S46°17'46"W

CURVE TABLE			
CURVE NO.	LENGTH	RADIUS	DELTA
C3	9.42	6.00	090°00'00"
C4	11.00	7.00	090°00'00"
C5	7.85	5.00	090°00'00"

LINE TABLE - BSW & ROW		
LINE NO.	LENGTH	DIRECTION
L19	207.38	N46°17'46"E
L20	120.40	S43°42'14"E
L21	107.37	S46°17'48"W
L23	81.38	N46°17'46"E
L24	80.00	N43°42'14"W
L25	181.38	S46°17'46"W

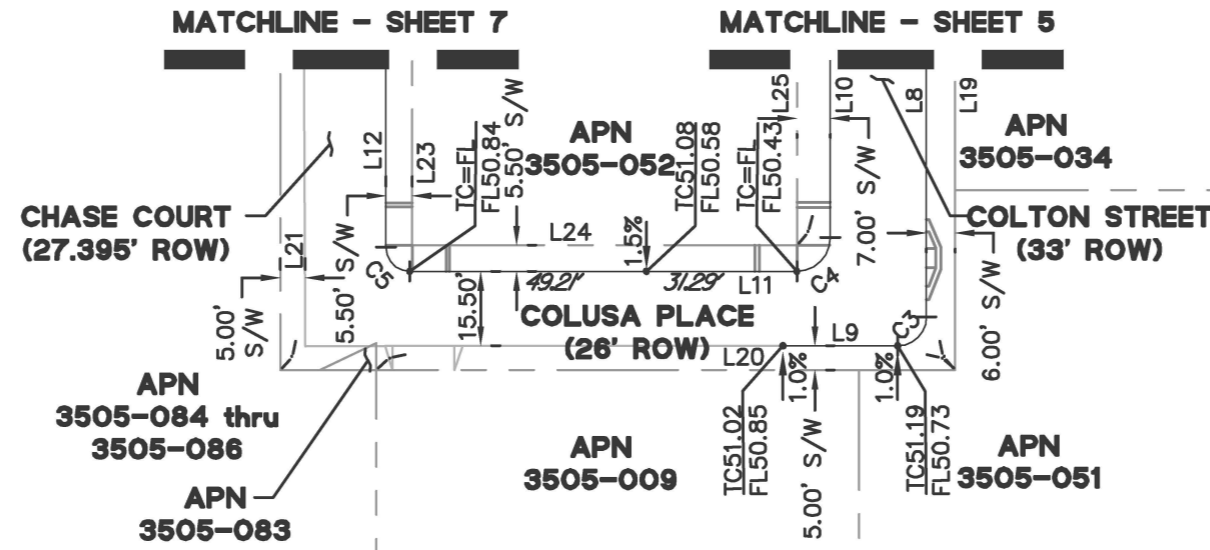

**NOTES:**

1. ITALIC NUMBERS REPRESENT THE DISTANCE BETWEEN ELEVATIONS.

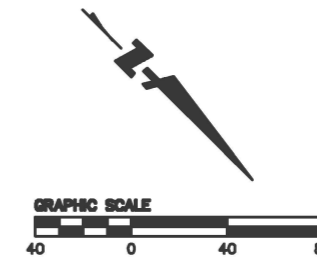

**KEY MAP**

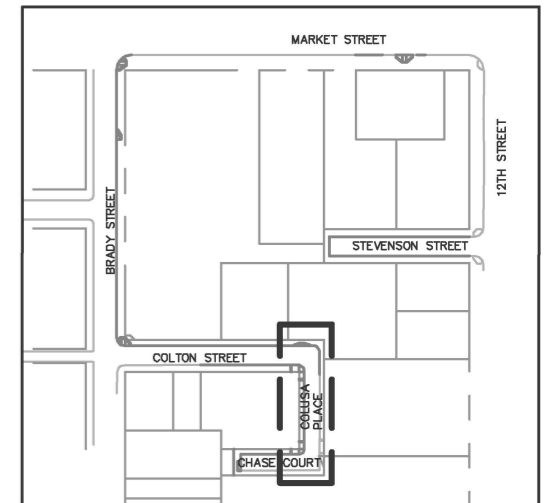

APPROVED:

\_\_\_\_\_  
 WILLIAM E. BLACKWELL JR., PLS 8251  
 ACTING CITY & COUNTY SURVEYOR

\_\_\_\_\_  
 DATE

**CITY AND COUNTY OF SAN FRANCISCO**  
 SAN FRANCISCO PUBLIC WORKS

OFFICIAL GRADES OF SIDEWALK AND CURB ELEVATIONS ALONG STEVENSON STREET, 12TH STREET, MARKET STREET, BRADY STREET, COLTON STREET, COLUSA PLACE, AND CHASE COURT

FILE: Q-20-1202

SHEET 6 OF 7

SCALE: 1" = 40'

REVISION

LINE TABLE - SIDEWALK		
LINE NO.	LENGTH	DIRECTION
L11	80.50	N43°42'14"W
L12	61.19	S46°17'46"W
L13	17.11	N43°42'14"W

CURVE TABLE			
CURVE NO.	LENGTH	RADIUS	DELTA
C5	7.85	5.00	090°00'00"

LINE TABLE - BSW & ROW		
LINE NO.	LENGTH	DIRECTION
L20	120.40	S43°42'14"E
L21	107.37	S46°17'48"W
L22	27.40	N43°42'14"W
L23	81.38	N46°17'46"E
L24	80.00	N43°42'14"W

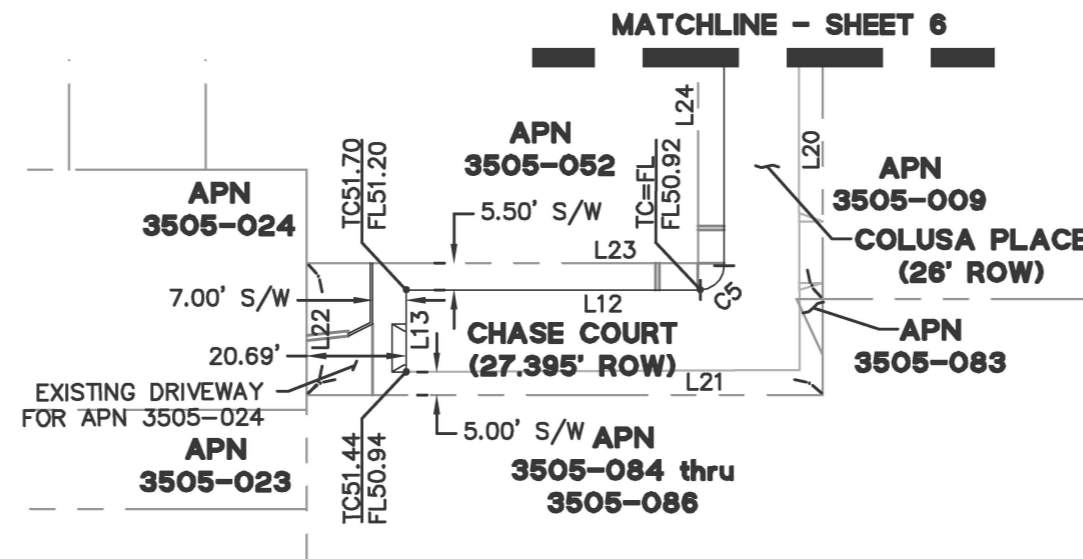

**NOTES:**

1. ITALIC NUMBERS REPRESENT THE DISTANCE BETWEEN ELEVATIONS.

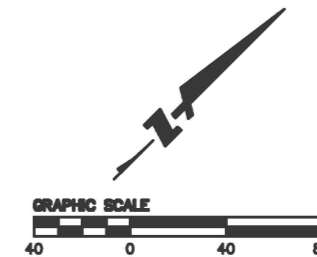

**KEY MAP**

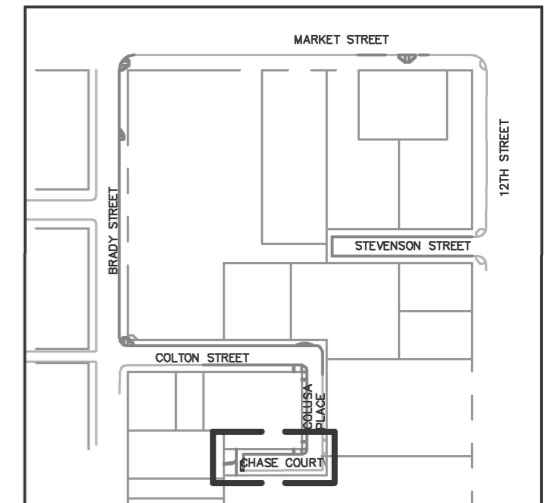

APPROVED:

\_\_\_\_\_  
 WILLIAM E. BLACKWELL JR., PLS 8251  
 ACTING CITY & COUNTY SURVEYOR

\_\_\_\_\_  
 DATE

**CITY AND COUNTY OF SAN FRANCISCO**  
 SAN FRANCISCO PUBLIC WORKS

OFFICIAL GRADES OF SIDEWALK AND CURB ELEVATIONS ALONG STEVENSON STREET, 12TH STREET, MARKET STREET, BRADY STREET, COLTON STREET, COLUSA PLACE, AND CHASE COURT

FILE: Q-20-1202

SHEET 7 OF 7

SCALE: 1" = 40'

REVISION