

DE HARO ST  
(80' WIDE)

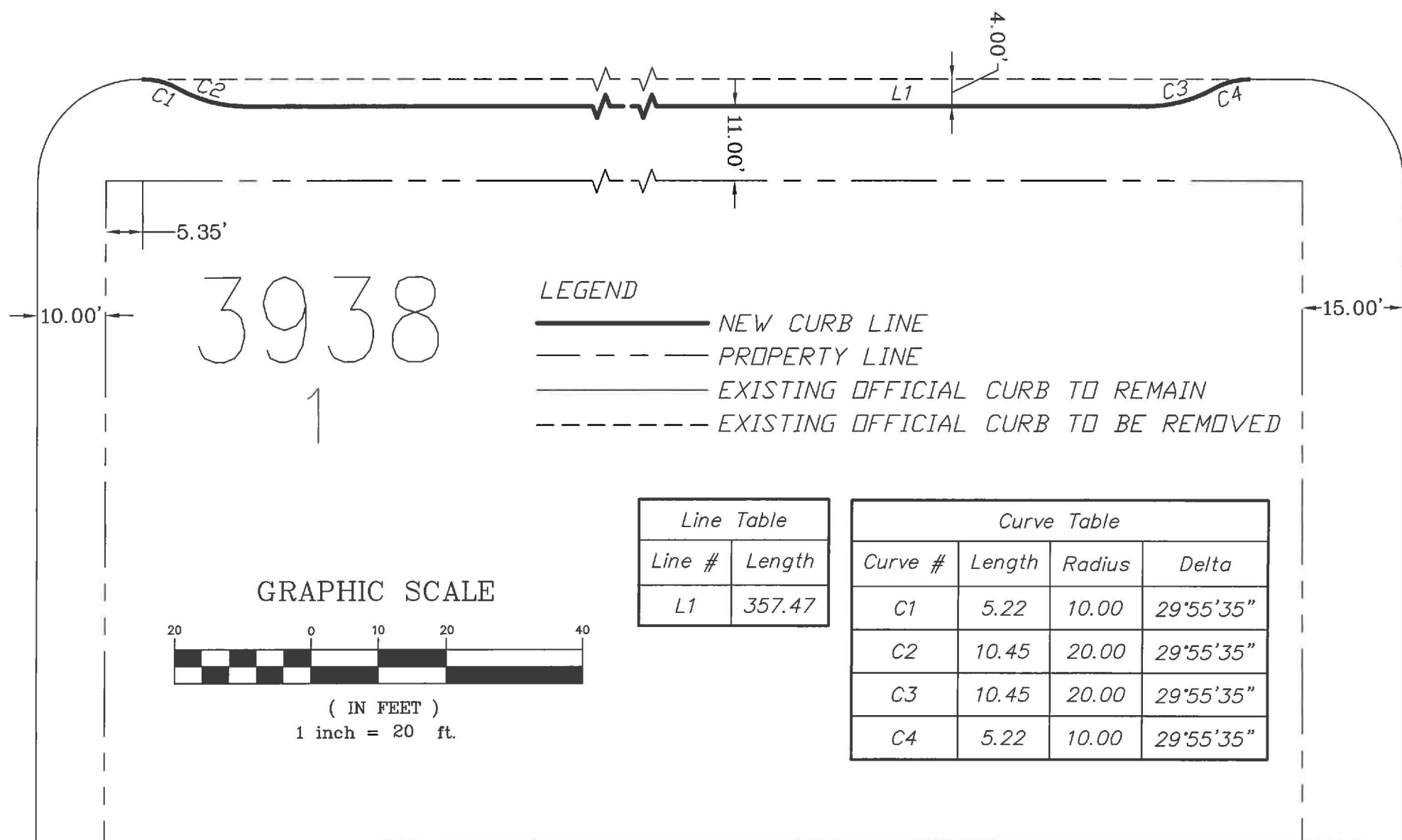

**LEGEND**

- NEW CURB LINE
- PROPERTY LINE
- EXISTING OFFICIAL CURB TO REMAIN
- EXISTING OFFICIAL CURB TO BE REMOVED

Line Table	
Line #	Length
L1	357.47

Curve Table			
Curve #	Length	Radius	Delta
C1	5.22	10.00	29°55'35"
C2	10.45	20.00	29°55'35"
C3	10.45	20.00	29°55'35"
C4	5.22	10.00	29°55'35"

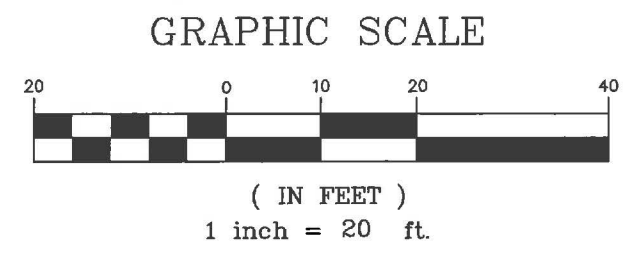

REFERENCE APPROVED:  
G.M. 311

*Bruce R. Storrs*  
BRUCE R. STORRS  
CITY & COUNTY SURVEYOR

*9/30/15*  
DATE

**CITY AND COUNTY OF SAN FRANCISCO**  
**DEPARTMENT OF PUBLIC WORKS**

OFFICIAL SIDEWALK CHANGE ALONG THE EAST SIDE OF DE HARO ST.  
BETWEEN 15TH ST. AND 16TH ST., FRONTING AB 3938 LOT 001

FILE: Q-20-793 SHEET 1 OF 1 SCALE: 1:20 CHANGE