

File No. 100009

Committee Item No. 4

Board Item No. _____

COMMITTEE/BOARD OF SUPERVISORS

AGENDA PACKET CONTENTS LIST

Committee: Land Use and Economic Development Date February 8, 2010

Board of Supervisors Meeting

Date _____

Cmte Board

- | | | |
|-------------------------------------|--------------------------|--|
| <input type="checkbox"/> | <input type="checkbox"/> | Motion |
| <input type="checkbox"/> | <input type="checkbox"/> | Resolution |
| <input checked="" type="checkbox"/> | <input type="checkbox"/> | Ordinance |
| <input checked="" type="checkbox"/> | <input type="checkbox"/> | Legislative Digest |
| <input type="checkbox"/> | <input type="checkbox"/> | Budget Analyst Report |
| <input type="checkbox"/> | <input type="checkbox"/> | Legislative Analyst Report |
| <input type="checkbox"/> | <input type="checkbox"/> | Youth Commission Report |
| <input type="checkbox"/> | <input type="checkbox"/> | Introduction Form (for hearings) |
| <input checked="" type="checkbox"/> | <input type="checkbox"/> | Department/Agency Cover Letter and/or Report |
| <input type="checkbox"/> | <input type="checkbox"/> | MOU |
| <input type="checkbox"/> | <input type="checkbox"/> | Grant Information Form |
| <input type="checkbox"/> | <input type="checkbox"/> | Grant Budget |
| <input type="checkbox"/> | <input type="checkbox"/> | Subcontract Budget |
| <input type="checkbox"/> | <input type="checkbox"/> | Contract/Agreement |
| <input type="checkbox"/> | <input type="checkbox"/> | Form 126 – Ethics Commission |
| <input type="checkbox"/> | <input type="checkbox"/> | Award Letter |
| <input type="checkbox"/> | <input type="checkbox"/> | Application |
| <input type="checkbox"/> | <input type="checkbox"/> | Public Correspondence |

OTHER

(Use back side if additional space is needed)

<input type="checkbox"/>	<input type="checkbox"/>	_____
<input type="checkbox"/>	<input type="checkbox"/>	_____
<input type="checkbox"/>	<input type="checkbox"/>	_____
<input type="checkbox"/>	<input type="checkbox"/>	_____
<input type="checkbox"/>	<input type="checkbox"/>	_____

Completed by: Alisa Somera Date February 4, 2010
 Completed by: _____ Date _____

An asterisked item represents the cover sheet to a document that exceeds 25 pages.
 The complete document can be found in the file and the online version.

1
2
3
4
5
6
7
8
9
10
11
12
13
14
15
16
17
18
19
20
21
22
23
24
25

[Acceptance of Streets and Roadway Structures for Maintenance and Liability Purposes]

Ordinance accepting for maintenance and liability purposes the streets and roadway structures listed herein, subject to specified limitations and conditions, pursuant to California Streets and Highways Code Section 1806 and San Francisco Administrative Code Sections 1.51 et seq.; and approving Department of Public Works Order No. 178,355.

NOTE: Additions are single-underline italics Times New Roman; deletions are ~~strike-through italics Times New Roman~~. Board amendment additions are double-underlined; Board amendment deletions are ~~strikethrough-normal~~.

Be it ordained by the People of the City and County of San Francisco:

Section 1. **Findings.** (a) The Board of Supervisors has reviewed and approves the certification and recommendation of the City Engineer and Director of the Department of Public Works concerning the acceptance for maintenance and liability purposes of the street segments and roadway structures listed herein and as contained in Department of Public Works Order No. 178,355, dated October 29, 2009, a copy of which is in Clerk of the Board of Supervisors File No. 100009 and is incorporated herein by reference.

Section 2. **Acceptance of Streets for Maintenance and Liability Purposes.**

(a) Pursuant to California Streets and Highways Code Section 1806, San Francisco Administrative Code Sections 1.51 et seq., and Department of Public Works Order No. 178,355, dated October 29, 2009, the Board of Supervisors hereby accepts the following street segments for maintenance and liability purposes, subject to the limitations and conditions set forth in Subsection (b).

	CNN	Street Name	From	To
1				
2	141000	02ND ST	STILLMAN ST	BRYANT ST
3	181000	03RD ST	KING ST	BERRY ST
4	269000	04TH ST	KING ST	BERRY ST
5	270002	04TH ST	BERRY ST	CHANNEL ST
6	310000	05TH ST	KING ST	BERRY ST
7	375000	07TH ST	BRYANT ST	BRANNAN ST
8	381000	07TH ST	HOOPER ST	IRWIN ST
9	382000	07TH ST	IRWIN ST	HUBBELL ST
10	383000	07TH ST	HUBBELL ST	DAGGETT ST
11	415001	08TH ST	I-80 W OFF RAMP	I-80 W OFF RAMP
12	415002	08TH ST	I-80 W OFF RAMP	BRYANT ST
13	418000	08TH ST	TOWNSEND ST	DIVISION ST
14	445000	09TH AVE	09TH AVE (bulb)	RIVERA ST
15	516000	11TH ST	HARRISON ST	BRYANT ST
16			11TH ST \ BRYANT ST \	
17	548101	13TH ST	DIVISION ST	HARRISON ST
18			11TH ST \ BRYANT ST \	
19	548201	13TH ST	DIVISION ST	HARRISON ST
20	549101	13TH ST	HARRISON ST	TRAINOR ST
21	549102	13TH ST	TRAINOR ST	FOLSOM ST
22	549201	13TH ST	HARRISON ST	BERNICE ST
23	549202	13TH ST	BERNICE ST	ISIS ST
24	549203	13TH ST	ISIS ST	FOLSOM ST
25				

1	550101	13TH ST	FOLSOM ST	SOUTH VAN NESS AVE
2	550201	13TH ST	FOLSOM ST	SOUTH VAN NESS AVE
3	551101	13TH ST	SOUTH VAN NESS AVE	HWY 101 S ON RAMP
4				DUBOCE AVE \ HWY 101
5	551102	13TH ST	HWY 101 S ON RAMP	NORTHBOUND RAMP \
6				MISSION ST \ OTIS ST
7				DUBOCE AVE \ HWY 101
8	551201	13TH ST	SOUTH VAN NESS AVE	NORTHBOUND RAMP \
9				MISSION ST \ OTIS ST
10	641000	15TH ST	BRYANT ST	FLORIDA ST
11	664000	15TH ST	SANCHEZ ST	NOE ST
12	935000	19TH AVE	RANDOLPH ST	SAINT CHARLES AVE
13	943000	19TH ST	19TH ST	PENNSYLVANIA AVE
14	1173000	22ND ST	KANSAS ST	VERMONT ST
15	1176000	22ND ST	VERMONT ST	SAN BRUNO AVE
16	1508000	26TH ST	KANSAS ST	VERMONT ST
17	1597000	28TH AVE	VICENTE ST	END (265 feet from Vicente St)
18	2078000	48TH AVE	TARAVAL ST	ULLOA ST
19	2134000	ALAMEDA ST	VERMONT ST	SAN BRUNO AVE
20	2135000	ALAMEDA ST	SAN BRUNO AVE	UTAH ST
21	2138000	ALAMEDA ST	HAMPSHIRE ST	BRYANT ST
22	2157201	ALEMANY BLVD	HWY 101 S OFF RAMP	FOLSOM ST
23	2157202	ALEMANY BLVD	FOLSOM ST	I-280 OFF RAMP
24	2181101	ALEMANY BLVD	ORIZABA AVE	BRIGHT ST
25				

1	218202	ALEMANY BLVD	BROTHERHOOD WAY	BROTHERHOOD WAY
2	12914000	ALEMANY BLVD	DE WOLF ST	SICKLES AVE
3	2212000	ALPHA ST	TUCKER AVE	END (60 feet from Tucker Ave)
4	5580000	ARELIIOUS WALKER DR	HUDSON AVE	INNES AVE
5	2460000	ARMSTRONG AVE	JENNINGS ST	KEITH ST
6	2464000	ARMSTRONG AVE	KALMANOVITZ ST	NEWHALL ST
7	2507000	ASH ST	END	GOUGH ST
8	2530000	ATALAYA TER	START: 1-99 Block (284 feet	FULTON ST
9			from Fulton St)	
10	2591000	BACON ST	AMHERST ST	CAMBRIDGE ST
11	2762000	BATTERY ST	PACIFIC AVE	BROADWAY
12	2763000	BATTERY ST	BROADWAY	VALLEJO ST
13	2799206	BAY SHORE BLVD	COSTA ST	FAITH ST
14	2799207	BAY SHORE BLVD	FAITH ST	OAKDALE AVE
15	2800101	BAY SHORE BLVD	OAKDALE AVE	FLOWER ST
16	2800102	BAY SHORE BLVD	FLOWER ST	CORTLAND AVE
17	2800201	BAY SHORE BLVD	OAKDALE AVE	COSGROVE ST
18	2800202	BAY SHORE BLVD	COSGROVE ST	CORTLAND AVE
19	2801101	BAY SHORE BLVD	CORTLAND AVE	WATERLOO ST
20	2801102	BAY SHORE BLVD	WATERLOO ST	MARENGO ST
21	2801103	BAY SHORE BLVD	MARENGO ST	INDUSTRIAL ST
22	2801201	BAY SHORE BLVD	CORTLAND AVE	INDUSTRIAL ST ON RAMP
23	2805000	BAY SHORE BLVD	SILVER AVE	THORNTON AVE
24	2806000	BAY SHORE BLVD	THORNTON AVE	QUINT ST
25				

1	2807000	BAY SHORE BLVD	QUINT ST	DONNER AVE
2	2808000	BAY SHORE BLVD	DONNER AVE	BACON ST
3	2809000	BAY SHORE BLVD	BACON ST	PHELPS ST
4	2810000	BAY SHORE BLVD	PHELPS ST	FITZGERALD AVE
5	2811000	BAY SHORE BLVD	FITZGERALD AVE	WAYLAND ST
6	2812000	BAY SHORE BLVD	WAYLAND ST	WOOLSEY ST
7	2814000	BAY SHORE BLVD	PAUL AVE	WHEAT ST
8	2864000	BEALE ST	MISSION ST	HOWARD ST
9	2865000	BEALE ST	HOWARD ST	FOLSOM ST
10				County Line (244 ft from Pope
11	2906000	BELLEVUE AVE	POPE ST	St)
12	2946000	BERNAL HEIGHTS BLVD	CARVER ST	BRADFORD ST
13	2955000	BERRY ST	05TH ST	06TH ST
14	2956001	BERRY ST	06TH ST	END (780 feet from 06th St)
15	14001000	BITTING AVE	NEWHALL ST	KALMANOVITZ ST
16	3026101	BOSWORTH ST	I-280 S ON RAMP	DIAMOND ST
17	3026201	BOSWORTH ST	I-280 S ON RAMP	DIAMOND ST
18	3033000	BOUTWELL ST	INDUSTRIAL ST	END (620 feet from Industrial St)
19	3118000	BREWSTER ST	COSTA ST	FAITH ST
20	3126000	BRIGHT ST	PALMETTO AVE	ALEMANY BLVD
21	3294000	BRYANT ST	LANGTON ST	KATE ST
22	3301000	BRYANT ST	10TH ST	DIVISION ST
23			START: 1-99 BLOCK (127 feet	
24	3404000	BURROWS ST	from San Bruno Ave)	SAN BRUNO AVE
25				

1	3419000	BUSH ST	MARKET ST	BATTERY ST
2	3428000	BUSH ST	SAINT GEORGE ALY	CLAUDE LN
3	3574000	CALIFORNIA ST	CHERRY ST	JORDAN AVE
4			START: 1-99 BLOCK (207 feet	
5	3658000	CAPITOL AVE	from Sagamore St)	SAGAMORE ST
6	3705000	CAROLINA ST	CHANNEL ST	15TH ST
7	3818000	CAYUGA AVE	MILTON ST	ROUSSEAU ST
8	2471000	CÉSAR CHAVEZ ST	INDIANA ST	IOWA ST
9	2479103	CESAR CHAVEZ ST	HWY 101 S ON RAMP	HAMPSHIRE ST
10				END: 300-336 BLOCK (162 feet
11	3947000	CHESTER AVE	PALMETTO AVE	from Palmetto Ave)
12	3948000	CHESTER AVE	ALEMANY BLVD	BELLE AVE
13	3951000	CHESTNUT ST	MONTGOMERY ST	Winthrop St
14	4044000	CIRCULAR AVE	MONTEREY BLVD	HEARST AVE
15	4045000	CIRCULAR AVE	HEARST AVE	BADEN ST
16	4046000	CIRCULAR AVE	BADEN ST	FLOOD AVE
17	4048000	CIRCULAR AVE	CONGO ST	STAPLES AVE
18	4049000	CIRCULAR AVE	STAPLES AVE	DETROIT ST
19	4050000	CIRCULAR AVE	DETROIT ST	MARSTON AVE
20	4080000	CLAY ST	DRUMM ST	DAVIS ST
21				END: 1-99 BLOCK (284 feet
22	4282000	COLONIAL WAY	SAN JOSE AVE	from San Jose Ave)
23	4333000	CONGO ST	CIRCULAR AVE	FLOOD AVE
24	4441000	CORTLAND AVE	HILTON ST	BAY SHORE BLVD
25				

1	4464000	COTTER ST	CAYUGA AVE	SAN JOSE AVE
2			START: 1-99 BLOCK (417 feet	
3	4544000	CUESTA CT	from Portola Dr)	PORTOLA DR
4	4565000	CUVIER ST	BOSWORTH ST	MIRANDO WAY
5	4609000	DAVIS ST	JACKSON ST	BROADWAY
6				DE LONG ST(125 ft from
7	4650000	DE LONG ST	SHAKESPEARE ST	Shakespeare St)
8	4705000	DELTA ST	TUCKER AVE	CAMPBELL AVE
9	4773000	DIAMOND ST	BOSWORTH ST	SAN JOSE AVE
10	4795000	DIGBY ST	EVERSON ST	ADDISON ST
11				END: 400-499 BLOCK (54 feet
12	4900000	DONAHUE ST	KIRKWOOD AVE	from Kirkwood Ave)
13	4911000	DONNER AVE	PHELPS ST	BAY SHORE BLVD
14	4969000	DRUMM ST	MARKET ST	CALIFORNIA ST
15	4972000	DRUMM ST	CLAY ST	WASHINGTON ST
16			13TH ST \ HWY 101	
17			NORTHBOUND RAMP \	
18	4978101	DUBOCE AVE	MISSION ST \ OTIS ST	WOODWARD ST
19	4978102	DUBOCE AVE	WOODWARD ST	STEVENSON ST
20			13TH ST \ HWY 101	
21			NORTHBOUND RAMP \	
22	4978201	DUBOCE AVE	MISSION ST \ OTIS ST	STEVENSON ST
23	4979000	DUBOCE AVE	STEVENSON ST	VALENCIA ST
24	5078000	EDGAR AVE	START: 1-39 BLOCK (86 feet	NIAGARA AVE
25				

1
2
3
4
5
6
7
8
9
10
11
12
13
14
15
16
17
18
19
20
21
22
23
24
25

			from Niagara Ave)	
5119000	EGBERT AVE	PHELPS ST		BAY SHORE BLVD
		START: 1350-1441 BLOCK		
5184000	ELLIS ST	(66 feet from Hollis St)		HOLLIS ST
5204000	ELM ST	FRANKLIN ST		GOUGH ST
		ELMIRA ST (610 ft from		
5211000	ELMIRA ST	Augusta St)		AUGUSTA ST
				END: 1-75 BLOCK (374 feet
5243000	ERVINE ST	WILDE AVE		from Wilde Ave)
5337000	EVANS AVE	RANKIN ST		SELBY ST
5442000	FELL ST	GOUGH ST		OCTAVIA ST
				END: WEST (124 feet from
5491000	FILBERT ST	SANSOME ST		Sansome St)
5685000	FOLSOM ST	12TH ST		13TH ST
		END: EAST (105 feet from		
5755000	FRANCISCO ST	Grant Ave)		GRANT AVE
5882000	FULTON ST	FRANKLIN ST		GOUGH ST
5974000	FUNSTON AVE	AERIAL WAY		AERIAL WAY
6003000	GARDENSIDE DR	VISTA LN		BURNETT AVE
				END: 401-499 BLOCK (370 feet
6035001	GAVEN ST	BOWDOIN ST		from Bowdoin St)
6106000	GEARY ST	MARKET ST		KEARNY ST
6184000	GILMAN AVE	DONAHUE ST		EARL ST
6209000	GIRARD ST	FRATESSA CT		03RD ST

1	6221000	GLENVIEW DR	PORTOLA DR	PORTOLA DR
2	6293000	GONZALEZ DR	CRESPI DR	CRESPI DR
3	6266000	GOLDEN GATE AVE	VAN NESS AVE	FRANKLIN ST
4	6321000	GOUGH ST	GROVE ST	FULTON ST
5	6431101	GREAT HWY	POINT LOBOS AVE	BALBOA ST
6	6431201	GREAT HWY	POINT LOBOS AVE	BALBOA ST
7	6432101	GREAT HWY	BALBOA ST	CABRILLO ST
8	6432201	GREAT HWY	BALBOA ST	CABRILLO ST
9	6433101	GREAT HWY	CABRILLO ST	FULTON ST
10	6433201	GREAT HWY	CABRILLO ST	FULTON ST
11	6434101	GREAT HWY	FULTON ST	JOHN F KENNEDY DR
12	6434201	GREAT HWY	FULTON ST	JOHN F KENNEDY DR
13	6435101	GREAT HWY	JOHN F KENNEDY DR	LINCOLN WAY
14	6435201	GREAT HWY	JOHN F KENNEDY DR	LINCOLN WAY
15	6436101	GREAT HWY	LINCOLN WAY	SLOAT BLVD
16	6436201	GREAT HWY	LINCOLN WAY	SLOAT BLVD
17	6557000	GROVE ST	GOUGH ST	OCTAVIA ST
18			GOUGH ST \	
19	6602000	HAIGHT ST	MARKET ST	GOUGH ST
20	6603000	HAIGHT ST	GOUGH ST	OCTAVIA ST
21				County Line (274 ft from Lowell
22	6670000	HANOVER ST	LOWELL ST	St)
23	6702000	HARRIET ST	AHERN WAY	BRYANT ST
24	6728000	HARRISON ST	07TH ST	I-80 W ON RAMP
25				

1	6764000	HARRISON ST	END (14 ft from Ripley St)	RIPLEY ST
2	6811000	HAYES ST	MARKET ST	LARKIN ST
3	6816000	HAYES ST	GOUGH ST	OCTAVIA ST
4			START: 1-49 BLOCK (125 feet	
5	6846000	HEAD ST	from Santa Barbara Ave)	SANTA BARBARA AVE
6	13796000	HERBST RD	LAKE MERCED BLVD	ARMORY RD
7	6894002	HESTER AVE	LOIS LN	PENINSULA AVE
8	6895000	HESTER AVE	PENINSULA AVE	WHEELER AVE
9	6896000	HESTER AVE	WHEELER AVE	BAY SHORE BLVD
10	6900001	HICKORY ST	GOUGH ST	OCTAVIA ST
11	6901000	HICKORY ST	OCTAVIA ST	END
12	7014000	HOLYOKE ST	WOOLSEY ST	KAREN CT
13	7030000	HOWARD ST	MAIN ST	BEALE ST
14				UNNAMED #047 (Candlestick
15	7096000	HUNTERS POINT EXPY	GILMAN AVE	Point SRA)
16	7174000	ILLINOIS ST	25TH ST	26TH ST \ ILLINOIS ST
17	7175000	ILLINOIS ST	26TH ST \ ILLINOIS ST	CESAR CHAVEZ ST
18	7176000	ILLINOIS ST	CESAR CHAVEZ ST	MARIN ST
19	7201000	INDIANA ST	CESAR CHAVEZ ST	MARIN ST
20	7202000	INDIANA ST	MARIN ST	END (275 ft from Marin St)
21	7203000	INDIANA ST	MARIN ST	END (275 ft from Marin St)
22	7204101	INDUSTRIAL ST	OAKDALE AVE	PALOU AVE
23	7204201	INDUSTRIAL ST	OAKDALE AVE	PALOU AVE
24	7206101	INDUSTRIAL ST	BARNEVELD AVE	CHARTER OAK AVE
25				

1	7207101	INDUSTRIAL ST	CHARTER OAK AVE	LOOMIS ST
2	7207201	INDUSTRIAL ST	CHARTER OAK AVE	LOOMIS ST
3	7208201	INDUSTRIAL ST	LOOMIS ST	BAY SHORE BLVD
4	7247000	INGERSON AVE	GRIFFITH ST	CORONADO ST
5	14002000	ISSLEIB AVE	NEWHALL ST	ORSI CIR
6	7350000	IVY ST	GOUGH ST	OCTAVIA ST
7	7426000	JAMESTOWN AVE	IGNACIO AVE	GILROY ST
8	7427000	JAMESTOWN AVE	GILROY ST	GRIFFITH ST
9			START: 32-50 BLOCK (95 feet	
10	7467000	JENNINGS CT	from Jennings Ct)	JENNINGS CT
11	7468000	JENNINGS CT	JENNINGS CT	MEADE AVE
12	7484000	JENNINGS ST	CARROLL AVE	DONNER AVE
13	7485000	JENNINGS ST	DONNER AVE	EGBERT AVE
14	7504000	JERROLD AVE	BARNEVELD AVE	JERROLD AVE
15	7554000	JOHNSTONE DR	CLARENDON AVE	ADOLPH SUTRO CT
16	7687000	JUDSON AVE	DETROIT ST	EDNA ST
17	14003000	KALMANOVITZ ST	ARMSTRONG AVE	ORSI CIR
18	14004000	KALMANOVITZ ST	ORSI CIR	ORSI CIR
19	14005000	KALMANOVITZ ST	ORSI CIR	LYDIA AVE
20	14006000	KALMANOVITZ ST	LYDIA AVE	BITTING AVE
21	7735000	KANSAS ST	22ND ST	HUMBOLDT ST
22	7736000	KANSAS ST	HUMBOLDT ST	23RD ST
23	7737000	KANSAS ST	23RD ST	24TH ST
24	7738000	KANSAS ST	24TH ST	25TH ST
25				

1	7746000	KEARNY ST	03RD ST	GEARY ST
2	7795000	KEITH ST	JAMESTOWN AVE	KEY AVE
3				END: 1053-1089 BLOCK (234
4	7820000	KEY AVE	03RD ST	feet from 03rd St)
5	7837000	KING ST	07TH ST	DIVISION ST
6	8231000	LE CONTE AVE	MEADE AVE	LE CONTE AVE
7			COUNTY LINE (60 ft from	
8	8329000	LIEBIG ST	Lessing St)	LESSING ST
9	8335001	LILY ST	GOUGH ST	OCTAVIA ST
10	8393001	LINDEN	GOUGH ST	OCTAVIA BLVD
11	8405000	LISBON ST	AVALON AVE	AVALON AVE
12				END: 80-99 BLOCK (98 feet
13	8545000	LUPINE AVE	WOOD ST	from Wood St)
14	14008000	LYDIA AVE	NEWHALL ST	KALMANOVITZ ST
15	8628000	MAIN ST	MISSION ST	HOWARD ST
16	8629000	MAIN ST	HOWARD ST	FOLSOM ST
17	8699000	MARIN ST	END (885 ft from Evans Ave)	EVANS AVE
18	8727000	MARIPOSA ST	VERMONT ST	HWY 101 N OFF RAMP
19	8728000	MARIPOSA ST	SAN BRUNO AVE	UTAH ST
20				HWY 101 \
21	8759101	MARKET ST	VALENCIA ST	OCTAVIA ST
22				HWY 101 \
23	8759201	MARKET ST	VALENCIA ST	OCTAVIA ST
24	8760202	MARKET ST	HWY 101 \	OCTAVIA ST
25				

1		OCTAVIA ST		
2				GUERRERO ST \
3	8760203	MARKET ST	OCTAVIA ST	LAGUNA ST
4	8887000	MCALLISTER ST	MARKET ST	JONES ST
5	8896000	MCALLISTER ST	FRANKLIN ST	GOUGH ST
6	8936000	MEADE AVE	LE CONTE AVE	JENNINGS CT
7	8937000	MEADE AVE	JENNINGS CT	JENNINGS ST
8	8938000	MEADE AVE	JENNINGS ST	03RD ST
9				END: 132-160 BLOCK (77 feet
10	8973000	MENDOSA AVE	MENDOSA AVE	from Mendosa Ave)
11	9085000	MISSION ST	MAIN ST	BEALE ST
12			YELLOW CAB ACCESS	
13			ROAD (156 ft from Cesar	
14	9218000	MISSOURI ST	Chavez St)	CESAR CHAVEZ ST
15	4042000	MONTEREY BLVD	JOOST AVE	SAN JOSE AV ON RAMP
16	4043000	MONTEREY BLVD	SAN JOSE AV ON RAMP	I-280 S OFF RAMP
17	9318000	MONTGOMERY ST	FILBERT ST	GREENWICH ST
18			START: 1-145 BLOCK (229	
19	9437000	MOUNTAIN SPRING AVE	feet from Stanyan St)	STANYAN ST
20	9451000	MUNICH ST	GENEVA AVE	SOUTH HILL BLVD
21				END: 300-342 BLOCK (241 feet
22	9479000	NAGLEE AVE	CAYUGA AVE	from Cayuga Ave)
23	9502000	NAPLES ST	MUNICH ST	CURTIS ST
24	9578000	NEWHALL ST	BAY VIEW CIR	BAY VIEW CIR

1	9582002	NEWHALL ST	LYDIA AVE	BITTING AVE
2	9582003	NEWHALL ST	BITTING AVE	EGBERT AVE
3	9587000	NEWTON ST	BRUNSWICK ST	NAPLES ST
4	9595000	NIAGARA AVE	SAN MIGUEL ST	TARA ST
5			START: 1-199 BLOCK (686	
6	9718000	NUEVA AVE	feet from Blanken Ave)	BLANKEN AVE
7	9752000	OAK ST	GOUGH ST	OCTAVIA ST
8	9753000	OAK ST	OCTAVIA ST	LAGUNA ST
9	9894000	OCTAVIA ST	WASHINGTON ST	JACKSON ST
10	9874001	OCTAVIA ST	MARKET ST	WALLER ST
11	9875101	OCTAVIA ST	WALLER ST	HAIGHT ST
12	9875201	OCTAVIA ST	OCTAVIA ST	HAIGHT ST
13			HWY 101 \	
14	9875301	OCTAVIA ST	MARKET ST	HAIGHT ST
15			HWY 101 \	
16	9875401	OCTAVIA ST	MARKET ST	HAIGHT ST
17	9875402	OCTAVIA ST	OCTAVIA ST	HAIGHT ST
18	9876101	OCTAVIA ST	HAIGHT ST	ROSE ST
19	9876201	OCTAVIA ST	HAIGHT ST	ROSE ST
20	9876301	OCTAVIA ST	HAIGHT ST	PAGE ST
21	9876401	OCTAVIA ST	HAIGHT ST	PAGE ST
22	9877101	OCTAVIA ST	ROSE ST	PAGE ST
23	9877201	OCTAVIA ST	ROSE ST	PAGE ST
24	9878101	OCTAVIA ST	PAGE ST	LILY ST
25				

1	9878201	OCTAVIA ST	PAGE ST	LILY ST
2	9878301	OCTAVIA ST	PAGE ST	OAK ST
3	9878401	OCTAVIA ST	PAGE ST	OAK ST
4	9879101	OCTAVIA ST	LILY ST	OAK ST
5	9878201	OCTAVIA ST	LILY ST	OAK ST
6	9880101	OCTAVIA ST	OAK ST	HICKORY ST
7	9880201	OCTAVIA ST	OAK ST	HICKORY ST
8	9880301	OCTAVIA ST	OAK ST	FELL ST
9	9880401	OCTAVIA ST	OAK ST	FELL ST
10	9881101	OCTAVIA ST	HICKORY ST	FELL ST
11	9881201	OCTAVIA ST	HICKORY ST	FELL ST
12	9882101	OCTAVIA ST	FELL ST	LINDEN ST
13	9882201	OCTAVIA ST	FELL ST	LINDEN ST
14	9883101	OCTAVIA ST	LINDEN ST	HAYES ST
15	9883201	OCTAVIA ST	LINDEN ST	HAYES ST
16	9981000	ORIZABA AVE	SAGAMORE ST	SADOWA ST
17	14009000	ORSI CIR	KALMANOVITZ ST	ISSLEIB AVE
18	14010000	ORSI CIR	ISSLEIB AVE	KALMANOVITZ ST
19	10046000	OTIS ST	MISSION ST	BRADY ST
20	10047000	OTIS ST	BRADY ST	GOUGH ST
21	10048000	OTIS ST	GOUGH ST	MISSION ST
22	10168000	PAGE ST	12TH ST \ MARKET ST	FRANKLIN ST
23	10170000	PAGE ST	GOUGH ST	OCTAVIA ST
24	10206000	PALO ALTO AVE	PALO ALTO AVE	LA AVANZADA
25				

1			PALOU AVE (547 ft from	
2	10215000	PALOU AVE	Griffith St)	GRIFFITH ST
3	10391000	PHELAN AVE	JUDSON AVE	JUDSON AVE
4	10412000	PHELPS ST	EGBERT AVE	BAY SHORE BLVD
5	10450000	PILGRIM AVE	SAN JOSE AVE	END (100 ft from San Jose)
6	10511000	PLYMOUTH AVE	SAN JOSE AVE	SAGAMORE ST
7	10512000	PLYMOUTH AVE	SAGAMORE ST	SADOWA ST
8	4374000	PORTOLA DR	CORBETT AVE	PORTOLA DR
9	4376000	PORTOLA DR	PORTOLA DR	FENTON LN
10				END: 0-0 BLOCK (261 feet from
11	12905000	PORTOLA DR	GLENVIEW DR	Glenview Dr)
12	10724000	POWHATTAN AVE	PERALTA AVE	FRANCONIA ST
13	4449000	PRECITA AVE	MISSION ST	COSO AVE
14				END: 1-99 BLOCK (266 feet
15	10783000	PROGRESS ST	WHITNEY YOUNG CIR	from Whitney Young Cir)
16	10844000	QUINT ST	CARROLL AVE	BAY SHORE BLVD
17	10912000	RANDALL ST	WHITNEY ST	WHITNEY ST
18				END: 300-399 BLOCK (562 feet
19	10928000	RANKIN ST	EVANS AVE	from Evans Ave)
20	10957000	REDWOOD ST	FRANKLIN ST	END
21			START: 1900-1999 BLOCK	
22	10980000	REVERE AVE	(84 feet from Quint St)	QUINT ST
23	11026000	RIDGE LN	HOWTH ST	JOSIAH AVE
24	11094000	ROANOKE ST	ARLINGTON ST	END: 300-321 BLOCK (128 feet
25				

1
2
3
4
5
6
7
8
9
10
11
12
13
14
15
16
17
18
19
20
21
22
23
24
25

			from Arlington St)
11110000	ROCKRIDGE DR	12TH AVE	FUNSTON AVE
11152001	ROSE ST	GOUGH ST	OCTAVIA ST
11276000	SADOWA ST	SAN JOSE AVE	PLYMOUTH AVE
11280000	SAGAMORE ST	SAN JOSE AVE	PLYMOUTH AVE
11281000	SAGAMORE ST	PLYMOUTH AVE	CAPITOL AVE
11284000	SAGAMORE ST	ORIZABA AVE	ALEMANY BLVD
11285000	SAGAMORE ST	SAGAMORE ST	ALEMANY BLVD
11351000	SAN BRUNO AVE	15TH ST	16TH ST
11352000	SAN BRUNO AVE	16TH ST	17TH ST
11358000	SAN BRUNO AVE	END (Freeway)	22ND ST
11362000	SAN BRUNO AVE	25TH ST	END (Freeway)
11410000	SAN DIEGO AVE	DE LONG ST	COUNTY LINE
11498000	SAN MIGUEL ST	NIAGARA AVE	MOUNT VERNON AVE
11554000	SANSOME ST	PACIFIC AVE	BROADWAY
			END (117 feet from San Jose
11594000	SANTA ROSA AVE	SAN JOSE AVE	Ave)
11766000	SERRANO DR	GONZALEZ DR	CRESPI DR
		SHAFTER AVE (403 ft from	
11789000	SHAFTER AVE	Elmira St)	ELMIRA ST
12018101	SOUTH VAN NESS AVE	HOWARD ST	13TH ST
12046000	SPEAR ST	HOWARD ST	FOLSOM ST
12103000	STAPLES AVE	CIRCULAR AVE	DETROIT ST
12940000	STATE DR	LAKE MERCED BLVD	END:0-0 BLOCK

1				TUBBS ST (170 Feet from 22nd
2	12486000	TENNESSEE ST	22ND ST	Street)
3	12488000	TENNESSEE ST	23RD ST	24TH ST
4	12489000	TENNESSEE ST	24TH ST	25TH ST
5	12492000	TENNESSEE ST	26TH ST	CESAR CHAVEZ ST
6	12566000	THERESA ST	CAYUGA AVE	SAN JOSE AVE
7	12600000	THORNTON AVE	MERCURY ST	MERCURY ST
8	12615000	TINGLEY ST	CAYUGA AVE	SAN JOSE AVE
9	12663000	TOWNSEND ST	04TH ST	05TH ST
10	12724000	TURK ST	VAN NESS AVE	FRANKLIN ST
11	13040000	UTAH ST	MARIPOSA ST	18TH ST
12				END (30 feet from Alta Vista
13	13099001	VALLEJO ST	ALTA VISTA TER	Ter)
14	13142000	VAN DYKE AVE	LANE ST	03RD ST
15	13208000	VERMONT ST	DIVISION ST	ALAMEDA ST
16	13209000	VERMONT ST	ALAMEDA ST	15TH ST
17	13210000	VERMONT ST	15TH ST	16TH ST
18	13211000	VERMONT ST	16TH ST	17TH ST
19	13212000	VERMONT ST	17TH ST	MARIPOSA ST
20	13216000	VERMONT ST	20TH ST	END (165 feet from 20th St)
21	13219000	VERMONT ST	22ND ST	HUMBOLDT ST
22	13220000	VERMONT ST	HUMBOLDT ST	23RD ST
23	13221000	VERMONT ST	23RD ST	24TH ST
24	13222000	VERMONT ST	24TH ST	25TH ST
25				

1	13685101	WINSTON DR	19TH AVE	20TH AVE
2	13685201	WINSTON DR	19TH AVE	20TH AVE
3	13765000	YORBA ST	YORBA ST	41ST AVE

(b) The Board accepts the street segments listed above subject to the following limitations: (1) acceptance is only for that portion of the street which is improved to City standards from back of curb to back of curb; (2) privately maintained sewers are excluded from acceptance, (3) encroachments that are permitted, unpermitted, or both are excluded from acceptance; and (4) the acceptance of the street does not obviate, amend, alter, or in any other way affect existing maintenance agreements between the City and parties to such maintenance agreements.

(c) The Department of Public Works is hereby directed to add the street segments identified herein onto its official list of City-maintained streets.

Section 3. Acceptance of Roadway Structures for Maintenance and Liability

Purposes. (a) Pursuant to California Streets and Highways Code Section 1806, San Francisco Administrative Code Sections 1.51 et seq., and the Department of Public Works Order No. 178,355, dated October 29, 2009, the Board of Supervisors hereby accepts the following roadway structures for maintenance and liability purposes, subject to the limitations and conditions set forth in Subsection (b).

Table A – Bernal Heights Street Improvement Project

Brewster/Joy Area on the East Slope			
Structure Name	Location of Structure (Nearest Cross Streets)	Structure Type	Assigned Structure ID
Rutledge Street Wall	Between Brewster Street	Retaining	366A

	and Stairs	and Holladay Ave.	Wall /Stairs	
1				
2	Rutledge Street Wall and Stairs	Between Brewster Street and Holladay Ave.	Retaining Wall /Stairs	366B
3	Brewster Street Wall and Stairs	Between Costa Street and Rutledge Street	Retaining Wall /Stairs	367

5	Faith Street Wall and Stairs	Between Brewster Street and Holladay Ave.	Retaining Wall /Stairs	368
6				
7	Joy Street Wall and Stairs	Between Brewster Street and Holladay Ave.	Retaining Wall /Stairs	369
8				
9	Brewster Street Guardrail	Between Joy Street and Faith Street	Guardrail/wall	370
10				
11	Mayflower Street Stair	Between Franconia Street and Holladay Ave.	Stairs	371

Banks/Chapman Area on the South Slope

13	Nevada Street Stairway	Between Chapman Street and Powhattan Ave.	Retaining Wall /Stairs	372
14				
15	Rosenkranz Street Stairway	Between Chapman Street and Bernal Heights Blvd	Retaining Wall /Stairs	373A
16				
17	Rosenkranz Street Stairway	Between Chapman Street and Bernal Heights Blvd	Retaining Wall /Stairs	373B
18				
19	Upper Prentiss Stairway	Between Chapman Street and Bernal Heights Blvd	Retaining Wall /Stairs	374A
20				
21	Upper Prentiss Stairway	Between Chapman Street and Bernal Heights Blvd	Retaining Wall /Stairs	374B
22				
23	Gates Street Stairway	Between Powhattan Ave. and Bernal Heights Blvd	Retaining Wall /Stairs	375
24				
25	Powhattan Ave. (East) Wall	Between Prentiss Street and Nevada Street	Retaining Wall	376
	Powhattan Ave. (West) Wall	Between Gates Street and Prentiss Street	Retaining Wall	377

Powhattan Ave. Wall	Between Nevada Street and Bradford Street	Retaining Wall	378
---------------------	---	----------------	-----

Table B – Coso Avenue Rockfall Emergency Remediation

Coso Ave. Retaining Wall			
Coso Ave. Retaining Wall	Between Winfield Street and Prospect Ave	Retaining Wall	379

(b) The Board accepts the roadway structures subject to the following limitation: the acceptance of the street does not obviate, amend, alter, or in any other way affect existing maintenance agreements between the City and parties to such maintenance agreements.

(c) The Department of Public Works is hereby directed to add the roadway structures identified herein onto its official list of City-maintained street structures.

RECOMMENDED:
DEPARTMENT OF PUBLIC WORKS

Edward Reiskin
Director of Public Works

DESIGNATION CERTIFIED BY:
DEPARTMENT OF PUBLIC WORKS

Fuad Sweiss, PE, PLS
City Engineer

APPROVED AS TO FORM:
DENNIS J. HERRERA, City Attorney

By: 
John D. Malamut
Deputy City Attorney

Supervisor Dufty
BOARD OF SUPERVISORS

LEGISLATIVE DIGEST

[Acceptance of streets and roadway structures for maintenance and liability purposes.]

Ordinance accepting for maintenance and liability purposes the streets and roadway structures listed herein, subject to specified limitations and conditions, pursuant to California Streets and Highways Code Section 1806 and San Francisco Administrative Code Sections 1.51 et seq.; and approving Department of Public Works Order No.

178,355.

Existing Law

In accordance with State and local law, the Board of Supervisors via legislation accepted for City maintenance and liability purposes most of the public street segments in San Francisco that meet the City's specifications and plans for street design. Other public streets that do not meet these requirements are unaccepted public right-of-way, which remains the responsibility of the fronting property owner. The City follows a similar process to accept roadway structures, such as retaining walls and stairways, for City maintenance and liability purposes.

Amendments to Current Law

The legislation would constitute formal acceptance of the listed street segments and roadway structures for maintenance purposes pursuant to the California Streets and Highways Code section 1806, San Francisco Administrative Code section 1.52 and DPW Order No. 178,355. Approval of this Ordinance would allow the City to expend its financial resources, including gas tax and road fund revenues, to improve and maintain the specified street segments and roadway structures. The street acceptance would be subject to certain limitations specified in the legislation.



Gavin Newsom, Mayor
Edward D. Reiskin, Director



File No. 000009
Phone: (415) 554-6920
Fax: (415) 554-6944
TDD: (415) 554-6900
www.sfdpw.org

Department of Public Works
Office of the Director
City Hall, Room 348
1 Dr. Carlton B. Goodlett Place
San Francisco, CA 94102-4645

ORDER NO. 178,355

TRANSMITTING ORDINANCE TO THE BOARD OF SUPERVISORS RECOMMENDING ACCEPTANCE FOR MAINTENANCE AND LIABILITY PURPOSES OF 354 STREET SEGMENTS AS NOTED IN ATTACHED APPENDIX "A"; AND RECOMMENDING ACCEPTANCE FOR MAINTENANCE AND LIABILITY PURPOSES OF 17 ROADWAY STRUCTURES AS NOTED IN ATTACHED APPENDIX "B".

ACCEPTANCE FOR MAINTENANCE AND LIABILITY PURPOSES OF STREET SEGMENTS

The Department of Public Works (DPW) identified, conducted, and completed a survey of 3,635 unaccepted street segments for compliance with the City's Street Acceptance Standards as follows:

- A. Minimum street width of 40 feet including sidewalks.
- B. Minimum paved width of 26 feet (one lane).
- C. Curbs on both sides of the street
- D. At least one four-foot sidewalk
- E. Minimum pavement thickness of 6 inches for residential streets

Using a checklist of visual features that indicate the extent to which street segments meet the Street Acceptance Standards, DPW determined that 354 street segments could be accepted for maintenance and liability purposes. Refer to Appendix "A" for a detailed report and a list of the 346 street segments.

ACCEPTANCE FOR MAINTENANCE AND LIABILITY PURPOSES OF ROADWAY STRUCTURES

The Department of Public Works (DPW) identified, conducted, and completed an assessment of 17 street structures for compliance with Street Structures Acceptance Procedures/Criteria. Refer to Appendix "B" for the Street Structures Acceptance Procedures/Criteria report and a list of the 17 street of structures. DPW has determined that the 17 street structures conform to the Street Structures Acceptance Procedures/Criteria.

This DPW Order hereby transmits the attached Ordinance, Appendix "A", and Appendix "B" to the Board of Supervisors recommending acceptance for maintenance and liability purposes of the 355 street segments and 17 street structures attached hereto.

APPROVED:



**Edward D. Reiskin
Director**

RECOMMENDED:

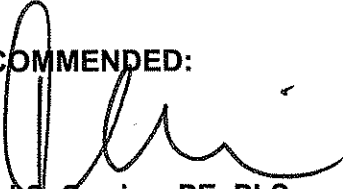

**Fuad S. Sweiss, PE, PLS
City Engineer and
Deputy Director for Engineering**

RECOMMENDED:



**Peg Divine
Manager
Bureau of Engineering**

APPROVED: October 29, 2009

Outside of BOE
Dept. Files (2)
BSSR - 2323 Cesar Chavez
DPW-BSM

Inside of BOE
Streets & Highways Section
Structural Section

**UNACCEPTED STREETS
(APPENDIX A)**

DEPARTMENT OF PUBLIC WORKS

Bureau of Engineering

November 9, 2009

TABLE OF CONTENTS

Accepted Streets of San Francisco	3
Street Acceptance Standards	3
Unaccepted Streets Survey Project	3
Recommendation	4
Table A	6

Accepted Streets of San Francisco

The Department of Public Works (DPW) of the City and County of San Francisco assumes responsibility only for those streets that were built to its standards, inspected by the City Engineer, and formally accepted for maintenance by Ordinance of the Board of Supervisors.

Board of Supervisor Ordinance # 138-98 adopted the Official Record of Accepted Streets in the City and County of San Francisco, the publication entitled "City Maintained Streets", dated October 31, 1997. In addition, Board of Supervisors accepted 1,191 street segments listed in DPW Order #170,357 and 169 street segments listed in DPW Order #170,657. The "City Maintained Streets" publication dated October 31, 1997 was updated in May 1998 to include the street segments in DPW Orders #170,357 and #170,657. Street segments not listed in said publication on the effective date are deemed unaccepted for street maintenance purposes.

Street Acceptance Standards

In order for a street to be accepted for maintenance, it must be built to City standards. These standards include:

- A. Minimum street width of 40 feet including sidewalks;
- B. Minimum paved width of 26 feet (one lane);
- C. Curbs on both sides of the street;
- D. At least one four-foot wide sidewalk;
- E. Minimum pavement thickness of 6-inches for residential streets or 8 inches for arterials.

Additional streets or street segments may be accepted for street maintenance purposes only if the City Engineer certifies that such street or street segments are constructed to City standards pursuant to San Francisco Administrative Code Section 1.52 or a successor ordinance and the Board of Supervisors accepted such streets or segments pursuant to applicable local and state law.

Unaccepted Streets Survey Project

DPW identified 3,635 Unaccepted Street Segments. During the summers of 2004 and 2005, interns completed field surveying the 3,635 Unaccepted Street Segments using a checklist of visual features that indicated the extent to which those streets met Street Acceptance Standards. Teams of between two and four members collected visual data,

took photographs, measured street widths, identified existing utilities, access information, and other notes. The data was input into an Access database. The survey team could not collect information on Standard E – “Minimum pavement thickness of 6-inches for residential streets or 8 inches for arterials” because it required core drilling the street pavement.

The information was input into an Access database. From this database, analysis was performed to determine how many DPW segments met the Street Acceptance Standards A, B, C, D and E. Although standard E was not verified, it was assumed that the pavement thicknesses met the standard. From the list of 3,635 Unaccepted Street Segments, 334 street segments met the Street Acceptance Standards. An additional 20 segments which included street segments along The Great Highway and streets that were previously under the old Central Freeway have been recommended for acceptance even though they did not meet the Street Acceptance Standards. The following is a list of the 20 street segments:

CNN	Street Name	From	To	Standards Met
2507000	ASH ST	END	GOUGH ST	C; D
5204000	ELM ST	FRANKLIN ST	GOUGH ST	B; D
6431101	GREAT HWY	POINT LOBOS AVE	BALBOA ST	B; C; D
6431201	GREAT HWY	POINT LOBOS AVE	BALBOA ST	B; C; D
6432101	GREAT HWY	BALBOA ST	CABRILLO ST	B
6432201	GREAT HWY	BALBOA ST	CABRILLO ST	B
6433101	GREAT HWY	CABRILLO ST	FULTON ST	B
6433201	GREAT HWY	CABRILLO ST	FULTON ST	B
6434101	GREAT HWY	FULTON ST	JOHN F KENNEDY DR	B
6434201	GREAT HWY	FULTON ST	JOHN F KENNEDY DR	A; B
6435101	GREAT HWY	JOHN F KENNEDY DR	LINCOLN WAY	B
6435201	GREAT HWY	JOHN F KENNEDY DR	LINCOLN WAY	B
6436101	GREAT HWY	LINCOLN WAY	SLOAT BLVD	B;C
6436201	GREAT HWY	LINCOLN WAY	SLOAT BLVD	B; C
6900001	HICKORY ST	GOUGH ST	OCTAVIA ST	C
6901000	HICKORY ST	OCTAVIA ST	END	C; D
7350000	IVY ST	GOUGH ST	OCTAVIA ST	C; D
8335001	LILY ST	GOUGH ST	OCTAVIA ST	C; D
8393001	LINDEN	GOUGH ST	OCTAVIA BLVD	C; D
11152001	ROSE ST	GOUGH ST	OCTAVIA ST	C; D

Recommendation

The list of 354 street segments in Table A represents those street segments that either meet Street Acceptance Standard's A, B, C and D or have been certified by the City Engineer to be accepted. Although Standard E was not verified for the 354 street

segments, the Director of Public Works is recommending that the Board of Supervisors accepts the list of 354 street segments for maintenance.

Table A

CNN	Street Name	From	To
141000	02ND ST	STILLMAN ST	BRYANT ST
181000	03RD ST	KING ST	BERRY ST
269000	04TH ST	KING ST	BERRY ST
270002	04TH ST	BERRY ST	CHANNEL ST
310000	05TH ST	KING ST	BERRY ST
375000	07TH ST	BRYANT ST	BRANNAN ST
381000	07TH ST	HOOPER ST	IRWIN ST
382000	07TH ST	IRWIN ST	HUBBELL ST
383000	07TH ST	HUBBELL ST	DAGGETT ST
415001	08TH ST	I-80 W OFF RAMP	I-80 W OFF RAMP
415002	08TH ST	I-80 W OFF RAMP	BRYANT ST
418000	08TH ST	TOWNSEND ST	DIVISION ST
445000	09TH AVE	09TH AVE (bulb)	RIVERA ST
516000	11TH ST	HARRISON ST	BRYANT ST
548101	13TH ST	11TH ST \ BRYANT ST \ DIVISION ST	HARRISON ST
548201	13TH ST	11TH ST \ BRYANT ST \ DIVISION ST	HARRISON ST
549101	13TH ST	HARRISON ST	TRAINOR ST
549102	13TH ST	TRAINOR ST	FOLSOM ST
549201	13TH ST	HARRISON ST	BERNICE ST
549202	13TH ST	BERNICE ST	ISIS ST
549203	13TH ST	ISIS ST	FOLSOM ST
550101	13TH ST	FOLSOM ST	SOUTH VAN NESS AVE
550201	13TH ST	FOLSOM ST	SOUTH VAN NESS AVE
551101	13TH ST	SOUTH VAN NESS AVE	HWY 101 S ON RAMP
551102	13TH ST	HWY 101 S ON RAMP	DUBOCE AVE \ HWY 101 NORTHBOUND RAMP \ MISSION ST \ OTIS ST
551201	13TH ST	SOUTH VAN NESS AVE	DUBOCE AVE \ HWY 101 NORTHBOUND RAMP \ MISSION ST \ OTIS ST
641000	15TH ST	BRYANT ST	FLORIDA ST
664000	15TH ST	SANCHEZ ST	NOE ST
935000	19TH AVE	RANDOLPH ST	SAINT CHARLES AVE
943000	19TH ST	19TH ST	PENNSYLVANIA AVE
1173000	22ND ST	KANSAS ST	VERMONT ST
1176000	22ND ST	VERMONT ST	SAN BRUNO AVE
1508000	26TH ST	KANSAS ST	VERMONT ST
1597000	28TH AVE	VICENTE ST	END (265 feet from Vicente St)
2078000	48TH AVE	TARAVAL ST	ULLOA ST
2134000	ALAMEDA ST	VERMONT ST	SAN BRUNO AVE
2135000	ALAMEDA ST	SAN BRUNO AVE	UTAH ST
2138000	ALAMEDA ST	HAMPSHIRE ST	BRYANT ST

2157201	ALEMANY BLVD.	HWY 101 S OFF RAMP	FOLSOM ST
2157202	ALEMANY BLVD.	FOLSOM ST.	I-280 OFF RAMP
2181101	ALEMANY BLVD.	ORIZABA AVE.	BRIGHT ST.
2181202	ALEMANY BLVD.	BROTHERHOOD WAY	BROTHERHOOD WAY
12914000	ALEMANY BLVD.	DE WOLF ST.	SICKLES AVE.
2212000	ALPHA ST	TUCKER AVE	END (60 feet from Tucker Ave)
5580000	ARELIIOUS WALKER DR	HUDSON AVE	INNES AVE
2460000	ARMSTRONG AVE	JENNINGS ST	KEITH ST
2464000	ARMSTRONG AVE	KALMANOVITZ ST	NEWHALL ST
2507000	ASH ST	END	GOUGH ST
2530000	ATALAYA TER	START: 1-99 Block (284 feet from Fulton St)	FULTON ST
2591000	BACON ST	AMHERST ST	CAMBRIDGE ST
2762000	BATTERY ST	PACIFIC AVE	BROADWAY
2763000	BATTERY ST	BROADWAY	VALLEJO ST
2799206	BAY SHORE BLVD	COSTA ST	FAITH ST
2799207	BAY SHORE BLVD	FAITH ST	OAKDALE AVE
2800101	BAY SHORE BLVD	OAKDALE AVE	FLOWER ST
2800102	BAY SHORE BLVD	FLOWER ST	CORTLAND AVE
2800201	BAY SHORE BLVD	OAKDALE AVE	COSGROVE ST
2800202	BAY SHORE BLVD	COSGROVE ST	CORTLAND AVE
2801101	BAY SHORE BLVD	CORTLAND AVE	WATERLOO ST
2801102	BAY SHORE BLVD	WATERLOO ST	MARENGO ST
2801103	BAY SHORE BLVD	MARENGO ST	INDUSTRIAL ST
2801201	BAY SHORE BLVD	CORTLAND AVE	INDUSTRIAL ST ON RAMP
2805000	BAY SHORE BLVD	SILVER AVE	THORNTON AVE
2806000	BAY SHORE BLVD	THORNTON AVE	QUINT ST
2807000	BAY SHORE BLVD	QUINT ST	DONNER AVE
2808000	BAY SHORE BLVD	DONNER AVE	BACON ST
2809000	BAY SHORE BLVD	BACON ST	PHELPS ST
2810000	BAY SHORE BLVD	PHELPS ST	FITZGERALD AVE
2811000	BAY SHORE BLVD	FITZGERALD AVE	WAYLAND ST
2812000	BAY SHORE BLVD	WAYLAND ST	WOOLSEY ST
2814000	BAY SHORE BLVD	PAUL AVE	WHEAT ST
2864000	BEALE ST	MISSION ST	HOWARD ST
2865000	BEALE ST	HOWARD ST	FOLSOM ST
2906000	BELLEVUE AVE	POPE ST	County Line (244 ft from Pope St)
2946000	BERNAL HEIGHTS BLVD	CARVER ST	BRADFORD ST
2955000	BERRY ST	05TH ST	06TH ST
2956001	BERRY ST	06TH ST	END (780 feet from 06th St)
14001000	BITTING AVE	NEWHALL ST	KALMANOVITZ ST
3026101	BOSWORTH ST	I-280 S ON RAMP	DIAMOND ST
3026201	BOSWORTH ST	I-280 S ON RAMP	DIAMOND ST
3033000	BOUTWELL ST	INDUSTRIAL ST	END (620 feet from Industrial St)
3118000	BREWSTER ST	COSTA ST	FAITH ST
3126000	BRIGHT ST	PALMETTO AVE	ALEMANY BLVD

3294000	BRYANT ST	LANGTON ST	KATE ST
3301000	BRYANT ST	10TH ST	DIVISION ST
3404000	BURROWS ST	START: 1-99 BLOCK (127 feet from San Bruno Ave)	SAN BRUNO AVE
3419000	BUSH ST	MARKET ST	BATTERY ST
3428000	BUSH ST	SAINT GEORGE ALY	CLAUDE LN
3574000	CALIFORNIA ST	CHERRY ST	JORDAN AVE
3658000	CAPITOL AVE	START: 1-99 BLOCK (207 feet from Sagamore St)	SAGAMORE ST
3705000	CAROLINA ST	CHANNEL ST	15TH ST
3818000	CAYUGA AVE	MILTON ST	ROUSSEAU ST
2471000	CESAR CHAVEZ ST	INDIANA ST	IOWA ST
2479103	CESAR CHAVEZ ST	HWY 101 S ON RAMP	HAMPSHIRE ST
3947000	CHESTER AVE	PALMETTO AVE	END: 300-336 BLOCK (162 feet from Palmetto Ave)
3948000	CHESTER AVE	ALEMANY BLVD	BELLE AVE
3951000	CHESTNUT ST	MONTGOMERY ST	Winthrop St
4044000	CIRCULAR AVE	MONTEREY BLVD	HEARST AVE
4045000	CIRCULAR AVE	HEARST AVE	BADEN ST
4046000	CIRCULAR AVE	BADEN ST	FLOOD AVE
4048000	CIRCULAR AVE	CONGO ST	STAPLES AVE
4049000	CIRCULAR AVE	STAPLES AVE	DETROIT ST
4050000	CIRCULAR AVE	DETROIT ST	MARSTON AVE
4080000	CLAY ST	DRUMM ST	DAVIS ST
4282000	COLONIAL WAY	SAN JOSE AVE	END: 1-99 BLOCK (284 feet from San Jose Ave)
4333000	CONGO ST	CIRCULAR AVE	FLOOD AVE
4441000	CORTLAND AVE	HILTON ST	BAY SHORE BLVD
4464000	COTTER ST	CAYUGA AVE	SAN JOSE AVE
4544000	CUESTA CT	START: 1-99 BLOCK (417 feet from Portola Dr)	PORTOLA DR
4565000	CUVIER ST	BOSWORTH ST	MIRANDO WAY
4609000	DAVIS ST	JACKSON ST	BROADWAY
4650000	DE LONG ST	SHAKESPEARE ST	DE LONG ST(125 ft from Shakespeare St)
4705000	DELTA ST.	TUCKER AVE.	CAMPBELL AVE.
4773000	DIAMOND ST	BOSWORTH ST	SAN JOSE AVE
4795000	DIGBY ST	EVERSON ST	ADDISON ST
4900000	DONAHUE ST	KIRKWOOD AVE	END: 400-499 BLOCK (54 feet from Kirkwood Ave)
4911000	DONNER AVE	PHELPS ST	BAY SHORE BLVD
4969000	DRUMM ST	MARKET ST	CALIFORNIA ST
4972000	DRUMM ST	CLAY ST	WASHINGTON ST
4978101	DUBOCE AVE	13TH ST \ HWY 101 NORTHBOUND RAMP \ MISSION ST \ OTIS ST	WOODWARD ST
4978102	DUBOCE AVE	WOODWARD ST	STEVENSON ST
4978201	DUBOCE AVE	13TH ST \ HWY 101	STEVENSON ST

		NORTHBOUND RAMP \ MISSION ST \ OTIS ST	
4979000	DUBOCE AVE	STEVENSON ST	VALENCIA ST
5078000	EDGAR AVE	START: 1-39 BLOCK (86 feet from Niagara Ave)	NIAGARA AVE
5119000	EGBERT AVE	PHELPS ST	BAY SHORE BLVD
5184000	ELLIS ST	START: 1350-1441 BLOCK (66 feet from Hollis St)	HOLLIS ST
5204000	ELM ST	FRANKLIN ST	GOUGH ST
5211000	ELMIRA ST	ELMIRA ST (610 ft from Augusta St)	AUGUSTA ST
5243000	ERVINE ST	WILDE AVE	END: 1-75 BLOCK (374 feet from Wilde Ave)
5337000	EVANS AVE	RANKIN ST	SELBY ST
5442000	FELL ST	GOUGH ST	OCTAVIA ST
5491000	FILBERT ST	SANSOME ST	END: WEST (124 feet from Sansome St)
5685000	FOLSOM ST	12TH ST	13TH ST
5755000	FRANCISCO ST	END: EAST (105 feet from Grant Ave)	GRANT AVE
5882000	FULTON ST	FRANKLIN ST	GOUGH ST
5974000	FUNSTON AVE	AERIAL WAY	AERIAL WAY
6003000	GARDENSIDE DR	VISTA LN	BURNETT AVE
6035001	GAVEN ST	BOWDOIN ST	END: 401-499 BLOCK (370 feet from Bowdoin St)
6106000	GEARY ST	MARKET ST	KEARNY ST
6184000	GILMAN AVE	DONAHUE ST	EARL ST
6209000	GIRARD ST	FRATESSA CT	03RD ST
6221000	GLENVIEW DR	PORTOLA DR	PORTOLA DR
6293000	GONZALEZ DR	CRESPI DR	CRESPI DR
6266000	GOLDEN GATE AVE	VAN NESS AVE	FRANKLIN ST
6321000	GOUGH ST	GROVE ST	FULTON ST
6431101	GREAT HWY	POINT LOBOS AVE	BALBOA ST
6431201	GREAT HWY	POINT LOBOS AVE	BALBOA ST
6432101	GREAT HWY	BALBOA ST	CABRILLO ST
6432201	GREAT HWY	BALBOA ST	CABRILLO ST
6433101	GREAT HWY	CABRILLO ST	FULTON ST
6433201	GREAT HWY	CABRILLO ST	FULTON ST
6434101	GREAT HWY	FULTON ST	JOHN F KENNEDY DR
6434201	GREAT HWY	FULTON ST	JOHN F KENNEDY DR
6435101	GREAT HWY	JOHN F KENNEDY DR	LINCOLN WAY
6435201	GREAT HWY	JOHN F KENNEDY DR	LINCOLN WAY
6436101	GREAT HWY	LINCOLN WAY	SLOAT BLVD
6436201	GREAT HWY	LINCOLN WAY	SLOAT BLVD
6557000	GROVE ST	GOUGH ST	OCTAVIA ST
6602000	HAIGHT ST	GOUGH ST \ MARKET ST	GOUGH ST
6603000	HAIGHT ST	GOUGH ST	OCTAVIA ST
6670000	HANOVER ST	LOWELL ST	County Line (274 ft from

			Lowell St)
6702000	HARRIET ST	AHERN WAY	BRYANT ST
6728000	HARRISON ST	07TH ST	I-80 W ON RAMP
6764000	HARRISON ST	END (14 ft from Ripley St)	RIPLEY ST
6811000	HAYES ST	MARKET ST	LARKIN ST
6816000	HAYES ST	GOUGH ST	OCTAVIA ST
6846000	HEAD ST	START: 1-49 BLOCK (125 feet from Santa Barbara Ave)	SANTA BARBARA AVE
13796000	HERBST RD	LAKE MERCED BLVD	ARMORY RD
6894002	HESTER AVE	LOIS LN	PENINSULA AVE
6895000	HESTER AVE	PENINSULA AVE	WHEELER AVE
6896000	HESTER AVE	WHEELER AVE	BAY SHORE BLVD
6900001	HICKORY ST	GOUGH ST	OCTAVIA ST
6901000	HICKORY ST	OCTAVIA ST	END
7014000	HOLYOKE ST	WOOLSEY ST	KAREN CT
7030000	HOWARD ST	MAIN ST	BEALE ST
7096000	HUNTERS POINT EXPY	GILMAN AVE	UNNAMED #047 (Candlestick Point SRA)
7174000	ILLINOIS ST	25TH ST	26TH ST \ ILLINOIS ST
7175000	ILLINOIS ST	26TH ST \ ILLINOIS ST	CESAR CHAVEZ ST
7176000	ILLINOIS ST	CESAR CHAVEZ ST	MARIN ST
7201000	INDIANA ST	CESAR CHAVEZ ST	MARIN ST
7202000	INDIANA ST	MARIN ST	END (275 ft from Marin St)
7203000	INDIANA ST	MARIN ST	END (275 ft from Marin St)
7204101	INDUSTRIAL ST	OAKDALE AVE	PALOU AVE
7204201	INDUSTRIAL ST	OAKDALE AVE	PALOU AVE
7206101	INDUSTRIAL ST	BARNEVELD AVE	CHARTER OAK AVE
7207101	INDUSTRIAL ST	CHARTER OAK AVE	LOOMIS ST
7207201	INDUSTRIAL ST	CHARTER OAK AVE	LOOMIS ST
7208201	INDUSTRIAL ST	LOOMIS ST	BAY SHORE BLVD
7247000	INGERSON AVE	GRIFFITH ST	CORONADO ST
14002000	ISSLEIB AVE	NEWHALL ST	ORSI CIR
7350000	IVY ST	GOUGH ST	OCTAVIA ST
7426000	JAMESTOWN AVE	IGNACIO AVE	GILROY ST
7427000	JAMESTOWN AVE	GILROY ST	GRIFFITH ST
7467000	JENNINGS CT	START: 32-50 BLOCK (95 feet from Jennings Ct)	JENNINGS CT
7468000	JENNINGS CT	JENNINGS CT	MEADE AVE
7484000	JENNINGS ST	CARROLL AVE	DONNER AVE
7485000	JENNINGS ST	DONNER AVE	EGBERT AVE
7504000	JERROLD AVE	BARNEVELD AVE	JERROLD AVE
7554000	JOHNSTONE DR.	CLARENDON AVE.	ADOLPH SUTRO CT.
7687000	JUDSON AVE	DETROIT ST	EDNA ST
14003000	KALMANOVITZ ST	ARMSTRONG AVE	ORSI CIR
14004000	KALMANOVITZ ST	ORSI CIR	ORSI CIR
14005000	KALMANOVITZ ST	ORSI CIR	LYDIA AVE
14006000	KALMANOVITZ ST	LYDIA AVE	BITTING AVE
7735000	KANSAS ST	22ND ST	HUMBOLDT ST

7736000	KANSAS ST	HUMBOLDT ST	23RD ST
7737000	KANSAS ST	23RD ST	24TH ST
7738000	KANSAS ST	24TH ST	25TH ST
7746000	KEARNY ST	03RD ST	GEARY ST
7795000	KEITH ST	JAMESTOWN AVE	KEY AVE
7820000	KEY AVE	03RD ST	END: 1053-1089 BLOCK (234 feet from 03rd St)
7837000	KING ST	07TH ST	DIVISION ST
8231000	LE CONTE AVE	MEADE AVE	LE CONTE AVE
8329000	LIEBIG ST	COUNTY LINE (60 ft from Lessing St)	LESSING ST
8335001	LILY ST	GOUGH ST	OCTAVIA ST
8393001	LINDEN	GOUGH ST	OCTAVIA BLVD
8405000	LISBON ST	AVALON AVE	AVALON AVE
8545000	LUPINE AVE	WOOD ST	END: 80-99 BLOCK (98 feet from Wood St)
14008000	LYDIA AVE	NEWHALL ST	KALMANOVITZ ST
8628000	MAIN ST	MISSION ST	HOWARD ST
8629000	MAIN ST	HOWARD ST	FOLSOM ST
8699000	MARIN ST	END (885 ft from Evans Ave)	EVANS AVE
8727000	MARIPOSA ST	VERMONT ST	HWY 101 N OFF RAMP
8728000	MARIPOSA ST	SAN BRUNO AVE	UTAH ST
8759101	MARKET ST	VALENCIA ST	HWY 101 \ OCTAVIA ST
8759201	MARKET ST	VALENCIA ST	HWY 101 \ OCTAVIA ST
8760202	MARKET ST	HWY 101 \ OCTAVIA ST	OCTAVIA ST
8760203	MARKET ST	OCTAVIA ST	GUERRERO ST \ LAGUNA ST
8887000	MCALLISTER ST	MARKET ST	JONES ST
8896000	MCALLISTER ST	FRANKLIN ST	GOUGH ST
8936000	MEADE AVE	LE CONTE AVE	JENNINGS CT
8937000	MEADE AVE	JENNINGS CT	JENNINGS ST
8938000	MEADE AVE	JENNINGS ST	03RD ST
8973000	MENDOSA AVE	MENDOSA AVE	END: 132-160 BLOCK (77 feet from Mendosa Ave)
9085000	MISSION ST	MAIN ST	BEALE ST
9218000	MISSOURI ST	YELLOW CAB ACCESS ROAD (156 ft from Cesar Chavez St)	CESAR CHAVEZ ST
4042000	MONTEREY BLVD	JOOST AVE	SAN JOSE AV ON RAMP
4043000	MONTEREY BLVD	SAN JOSE AV ON RAMP	I-280 S OFF RAMP
9318000	MONTGOMERY ST	FILBERT ST	GREENWICH ST
9437000	MOUNTAIN SPRING AVE	START: 1-145 BLOCK (229 feet from Stanyan St)	STANYAN ST
9451000	MUNICH ST	GENEVA AVE	SOUTH HILL BLVD
9479000	NAGLEE AVE	CAYUGA AVE	END: 300-342 BLOCK (241 feet from Cayuga Ave)
9502000	NAPLES ST	MUNICH ST	CURTIS ST

9578000	NEWHALL ST	BAY VIEW CIR	BAY VIEW CIR
9582002	NEWHALL ST	LYDIA AVE	BITTING AVE
9582003	NEWHALL ST	BITTING AVE	EGBERT AVE
9587000	NEWTON ST	BRUNSWICK ST	NAPLES ST
9595000	NIAGARA AVE	SAN MIGUEL ST	TARA ST
9718000	NUEVA AVE	START: 1-199 BLOCK (686 feet from Blanken Ave)	BLANKEN AVE
9752000	OAK ST	GOUGH ST	OCTAVIA ST
9753000	OAK ST	OCTAVIA ST	LAGUNA ST
9894000	OCTAVIA ST	WASHINGTON ST	JACKSON ST
9874001	OCTAVIA ST	MARKET ST	WALLER ST
9875101	OCTAVIA ST	WALLER ST	HAIGHT ST
9875201	OCTAVIA ST	OCTAVIA ST	HAIGHT ST
9875301	OCTAVIA ST	HWY 101 \ MARKET ST	HAIGHT ST
9875401	OCTAVIA ST	HWY 101 \ MARKET ST	HAIGHT ST
9875402	OCTAVIA ST	OCTAVIA ST	HAIGHT ST
9876101	OCTAVIA ST	HAIGHT ST	ROSE ST
9876201	OCTAVIA ST	HAIGHT ST	ROSE ST
9876301	OCTAVIA ST	HAIGHT ST	PAGE ST
9876401	OCTAVIA ST	HAIGHT ST	PAGE ST
9877101	OCTAVIA ST	ROSE ST	PAGE ST
9877201	OCTAVIA ST	ROSE ST	PAGE ST
9878101	OCTAVIA ST	PAGE ST	LILY ST
9878201	OCTAVIA ST	PAGE ST	LILY ST
9878301	OCTAVIA ST	PAGE ST	OAK ST
9878401	OCTAVIA ST	PAGE ST	OAK ST
9879101	OCTAVIA ST	LILY ST	OAK ST
9878201	OCTAVIA ST	LILY ST	OAK ST
9880101	OCTAVIA ST	OAK ST	HICKORY ST
9880201	OCTAVIA ST	OAK ST	HICKORY ST
9880301	OCTAVIA ST	OAK ST	FELL ST
9880401	OCTAVIA ST	OAK ST	FELL ST
9881101	OCTAVIA ST	HICKORY ST	FELL ST
9881201	OCTAVIA ST	HICKORY ST	FELL ST
9882101	OCTAVIA ST	FELL ST	LINDEN ST
9882201	OCTAVIA ST	FELL ST	LINDEN ST
9883101	OCTAVIA ST	LINDEN ST	HAYES ST
9883201	OCTAVIA ST	LINDEN ST	HAYES ST
9981000	ORIZABA AVE	SAGAMORE ST	SADOWA ST
14009000	ORSI CIR	KALMANOVITZ ST	ISSLEIB AVE
14010000	ORSI CIR	ISSLEIB AVE	KALMANOVITZ ST
10046000	OTIS ST	MISSION ST	BRADY ST
10047000	OTIS ST	BRADY ST	GOUGH ST
10048000	OTIS ST	GOUGH ST	MISSION ST
10168000	PAGE ST	12TH ST \ MARKET ST	FRANKLIN ST
10170000	PAGE ST	GOUGH ST	OCTAVIA ST
10206000	PALO ALTO AVE	PALO ALTO AVE	LA AVANZADA

10215000	PALOU AVE	PALOU AVE (547 ft from Griffith St)	GRIFFITH ST
10391000	PHELAN AVE	JUDSON AVE	JUDSON AVE
10412000	PHELPS ST	EGBERT AVE	BAY SHORE BLVD
10450000	PILGRIM AVE	SAN JOSE AVE	END (100 ft from San Jose)
10511000	PLYMOUTH AVE	SAN JOSE AVE	SAGAMORE ST
10512000	PLYMOUTH AVE	SAGAMORE ST	SADOWA ST
4374000	PORTOLA DR	CORBETT AVE	PORTOLA DR
4376000	PORTOLA DR	PORTOLA DR	FENTON LN
12905000	PORTOLA DR	GLENVIEW DR	END: 0-0 BLOCK (261 feet from Glenview Dr)
10724000	POWHATTAN AVE	PERALTA AVE	FRANCONIA ST
4449000	PRECITA AVE	MISSION ST	COSO AVE
10783000	PROGRESS ST	WHITNEY YOUNG CIR	END: 1-99 BLOCK (266 feet from Whitney Young Cir)
10844000	QUINT ST	CARROLL AVE	BAY SHORE BLVD
10912000	RANDALL ST	WHITNEY ST	WHITNEY ST
10928000	RANKIN ST	EVANS AVE	END: 300-399 BLOCK (562 feet from Evans Ave)
10957000	REDWOOD ST	FRANKLIN ST	END
10980000	REVERE AVE	START: 1900-1999 BLOCK (84 feet from Quint St)	QUINT ST
11026000	RIDGE LN	HOWTH ST	JOSIAH AVE
11094000	ROANOKE ST	ARLINGTON ST	END: 300-321 BLOCK (128 feet from Arlington St)
11110000	ROCKRIDGE DR	12TH AVE	FUNSTON AVE
11152001	ROSE ST	GOUGH ST	OCTAVIA ST
11276000	SADOWA ST	SAN JOSE AVE	PLYMOUTH AVE
11280000	SAGAMORE ST	SAN JOSE AVE	PLYMOUTH AVE
11281000	SAGAMORE ST	PLYMOUTH AVE	CAPITOL AVE
11284000	SAGAMORE ST	ORIZABA AVE	ALEMANY BLVD
11285000	SAGAMORE ST	SAGAMORE ST	ALEMANY BLVD
11351000	SAN BRUNO AVE	15TH ST	16TH ST
11352000	SAN BRUNO AVE	16TH ST	17TH ST
11358000	SAN BRUNO AVE	END (Freeway)	22ND ST
11362000	SAN BRUNO AVE	25TH ST	END (Freeway)
11410000	SAN DIEGO AVE	DE LONG ST	COUNTY LINE
11498000	SAN MIGUEL ST	NIAGARA AVE	MOUNT VERNON AVE
11554000	SANSOME ST	PACIFIC AVE	BROADWAY
11594000	SANTA ROSA AVE	SAN JOSE AVE	END (117 feet from San Jose Ave)
11766000	SERRANO DR	GONZALEZ DR	CRESPI DR
11789000	SHAFTER AVE	SHAFTER AVE (403 ft from Elmira St)	ELMIRA ST
12018101	SOUTH VAN NESS AVE	HOWARD ST	13TH ST
12046000	SPEAR ST	HOWARD ST	FOLSOM ST
12103000	STAPLES AVE	CIRCULAR AVE	DETROIT ST
12940000	STATE DR.	LAKE MERCED. BLVD	END:0-0 BLOCK

12486000	TENNESSEE ST	22ND ST	TUBBS ST (170 Feet from 22nd Street)
12488000	TENNESSEE ST	23RD ST	24TH ST
12489000	TENNESSEE ST	24TH ST	25TH ST
12492000	TENNESSEE ST	26TH ST	CESAR CHAVEZ ST
12566000	THERESA ST	CAYUGA AVE	SAN JOSE AVE
12600000	THORNTON AVE	MERCURY ST	MERCURY ST
12615000	TINGLEY ST	CAYUGA AVE	SAN JOSE AVE
12663000	TOWNSEND ST	04TH ST	05TH ST
12724000	TURK ST	VAN NESS AVE	FRANKLIN ST
13040000	UTAH ST	MARIPOSA ST	18TH ST
13099001	VALLEJO ST	ALTA VISTA TER	END (30 feet from Alta Vista Ter)
13142000	VAN DYKE AVE	LANE ST	03RD ST
13208000	VERMONT ST	DIVISION ST	ALAMEDA ST
13209000	VERMONT ST	ALAMEDA ST	15TH ST
13210000	VERMONT ST	15TH ST	16TH ST
13211000	VERMONT ST	16TH ST	17TH ST
13212000	VERMONT ST	17TH ST	MARIPOSA ST
13216000	VERMONT ST	20TH ST	END (165 feet from 20th St)
13219000	VERMONT ST	22ND ST	HUMBOLDT ST
13220000	VERMONT ST	HUMBOLDT ST	23RD ST
13221000	VERMONT ST	23RD ST	24TH ST
13222000	VERMONT ST	24TH ST	25TH ST
13685101	WINSTON DR	19TH AVE	20TH AVE
13685201	WINSTON DR	19TH AVE	20TH AVE
13765000	YORBA ST	YORBA ST	41ST AVE

**ACCEPTANCE OF STREET STRUCTURES
(APPENDIX B)**

DEPARTMENT OF PUBLIC WORKS

Bureau of Engineering

October 28, 2009

TABLE OF CONTENTS

Acceptance of Street Structures of San Francisco	2
Street Structures Acceptance Procedures/Criteria	2
Background	3
Bernal Heights Street Improvement Project	3
Coso Avenue Rockfall Emergency Remediation	3
Discussion	4
Recommendation	4
Table A – Bernal Heights Street Improvement Project	5
Table B – Coso Avenue Rockfall Emergency Remediation	6
Figure 1 – Bernal Heights Street Improvement Project	6
Figure 2 – Brewster/Joy Area on the East Slope	7
Figure 3 – Banks/Chapman Area on the South Slope	8
Figure 4 – Coso Ave. Retaining Wall	9

Acceptance of Street Structures of San Francisco

The Department of Public Works (DPW) of the City and County of San Francisco assumes responsibility only for those street structures that were built to its standards, inspected by the City Engineer, and formally accepted for maintenance by Ordinance of the Board of Supervisors.

Street Structures Acceptance Procedures/Criteria

Street structures in the City's right-of-way and constructed by the City are considered to be City-owned structures and maintained by the City.

For street structures in the City's right-of-way and constructed by private entities, property owner(s) may request that the City accept the structures for City maintenance only if the structure meets or exceeds engineering standards and the Board of Supervisors adopts legislation (via Ordinance) accepting the structures based on a recommendation from the Director of Public Works and certification of the City Engineer.

In order for a street structure to be accepted for maintenance, private entities must submit an individual request for each structure in writing. The City will evaluate the structure and determine whether it meets engineering standards for acceptance using the following procedure:

1. DPW–Bureau of Engineering will identify if a particular street structure is City-owned from available resources which include, but not are limited to, the Roadway Structures Information System (RSIS) database, DPW archives, and Bureau of Street Use and Mapping's (BSM) Records.
2. If there is no documentation that the structure was accepted by the City, the structure may be accepted if all of the following requirements are met:
 - The structure is in the City's right-of-way;
 - The structure meets the latest edition of the San Francisco Building Code, Occupational Safety and Health Administration Regulations (29 CFR Parts 1910-1926), and Americans with Disabilities Act Standards for Accessible Design;
 - Field condition assessment performed by an authorized City inspector(s) determines that the structure is in good condition with a condition assessment score of 70 or above (100 being a perfect score for a structure with no observable deficiency);
OR
 - If the structure is in poor condition with a condition assessment score of 69 or below, the structure's owner(s) will be required to make necessary

repairs and/or improvements to improve the structure's condition assessment score to 90 or above before the City will consider accepting the structure for maintenance.

3. If the structure meets all the requirements listed in item 2 above, the City Engineer will prepare a DPW Order which lists each structure that has been recommended for acceptance for review and approval by the Director of Public Works. Then, the Director of Public Works will transmit legislation to the Board of Supervisors. Upon review of the ordinance, the Board of Supervisors approves the list of structures for maintenance by the Department of Public Works.

Background

Bernal Heights Street Improvement Project

The Bernal Heights Street Improvement Project involved constructing the streets and infrastructure of portions of the Bernal Heights area up to City standards so that emergency vehicles and other public services can be safely provided to the community. The improvements included upgrading substandard streets and enhancing public access to open space, public stairs, and other rights-of-way.

In 1988, the Board of Supervisors designated the Bernal Heights East and South Slope as Survey Areas for the purpose of developing redevelopment projects in these areas (Res. 906-88). The Redevelopment Agency identified three sub-areas for initial improvements (Figure 1): The Brewster/Joy Area on the East Slope (Figure 2); the Banks/Chapman Area on the South Slope (Figure 3); and the Bradford/Jarboe Area on the Southeast Slope. The Finance Committee of the Board of Supervisors approved funds for the Planning Department to coordinate the infrastructure improvement process.

Under two construction contracts, improvements were made at the Bernal Heights Area.

Coso Avenue Rockfall Emergency Remediation

In November 2004, it was reported that the slope within the public right-of-way between the curbside of Coso Avenue and the property of 2-4 Winfield Street was failing. As a result, an emergency was declared (DPW Order No. 175,107), and the City issued a contract to build a permanent retaining wall at that location to mitigate the hazardous condition. Figure 4 shows the Coso Ave. Retaining Wall on the North Slope of the Bernal Heights Park.

The construction was completed on March 29, 2006 in accordance with the plans and specifications, and to the satisfaction of the Director of Public Works. The Certification

of Completion (Order No. 176,409) was signed by the Director of Public Works on October 11, 2006.

Discussion

DPW has determined that the list of 17 street structures in Tables A and B conform to Street Structures Acceptance Procedures/Criteria.

Recommendation

We recommend that all 17 street structures listed in Tables A and B be accepted and the improvements to railings/guardrails made upon approval of acceptance.

Table A – Bernal Heights Street Improvement Project

Brewster/Joy Area on the East Slope			
Structure Name	Location of Structure (Nearest Cross Streets)	Structure Type	Assigned Structure ID
Rutledge Street Wall and Stairs	Between Brewster Street and Holladay Ave.	Retaining Wall /Stairs	366A
Rutledge Street Wall and Stairs	Between Brewster Street and Holladay Ave.	Retaining Wall /Stairs	366B
Brewster Street Wall and Stairs	Between Costa Street and Rutledge Street	Retaining Wall /Stairs	367
Faith Street Wall and Stairs	Between Brewster Street and Holladay Ave.	Retaining Wall /Stairs	368
Joy Street Wall and Stairs	Between Brewster Street and Holladay Ave.	Retaining Wall /Stairs	369
Brewster Street Guardrail	Between Joy Street and Faith Street	Guardrail/wall	370
Mayflower Street Stair	Between Franconia Street and Holladay Ave.	Stairs	371
Banks/Chapman Area on the South Slope			
Nevada Street Stairway	Between Chapman Street and Powhattan Ave.	Retaining Wall /Stairs	372

Rosenkranz Street Stairway	Between Chapman Street and Bernal Heights Blvd	Retaining Wall /Stairs	373A
Rosenkranz Street Stairway	Between Chapman Street and Bernal Heights Blvd	Retaining Wall /Stairs	373B
Upper Prentiss Stairway	Between Chapman Street and Bernal Heights Blvd	Retaining Wall /Stairs	374A
Upper Prentiss Stairway	Between Chapman Street and Bernal Heights Blvd	Retaining Wall /Stairs	374B
Gates Street Stairway	Between Powhattan Ave. and Bernal Heights Blvd	Retaining Wall /Stairs	375
Powhattan Ave. (East) Wall	Between Prentiss Street and Nevada Street	Retaining Wall	376
Powhattan Ave. (West) Wall	Between Gates Street and Prentiss Street	Retaining Wall	377
Powhattan Ave. Wall	Between Nevada Street and Bradford Street	Retaining Wall	378

Table B – Coso Avenue Rockfall Emergency Remediation

Coso Ave. Retaining Wall			
Coso Ave. Retaining Wall	Between Winfield Street and Prospect Ave	Retaining Wall	379

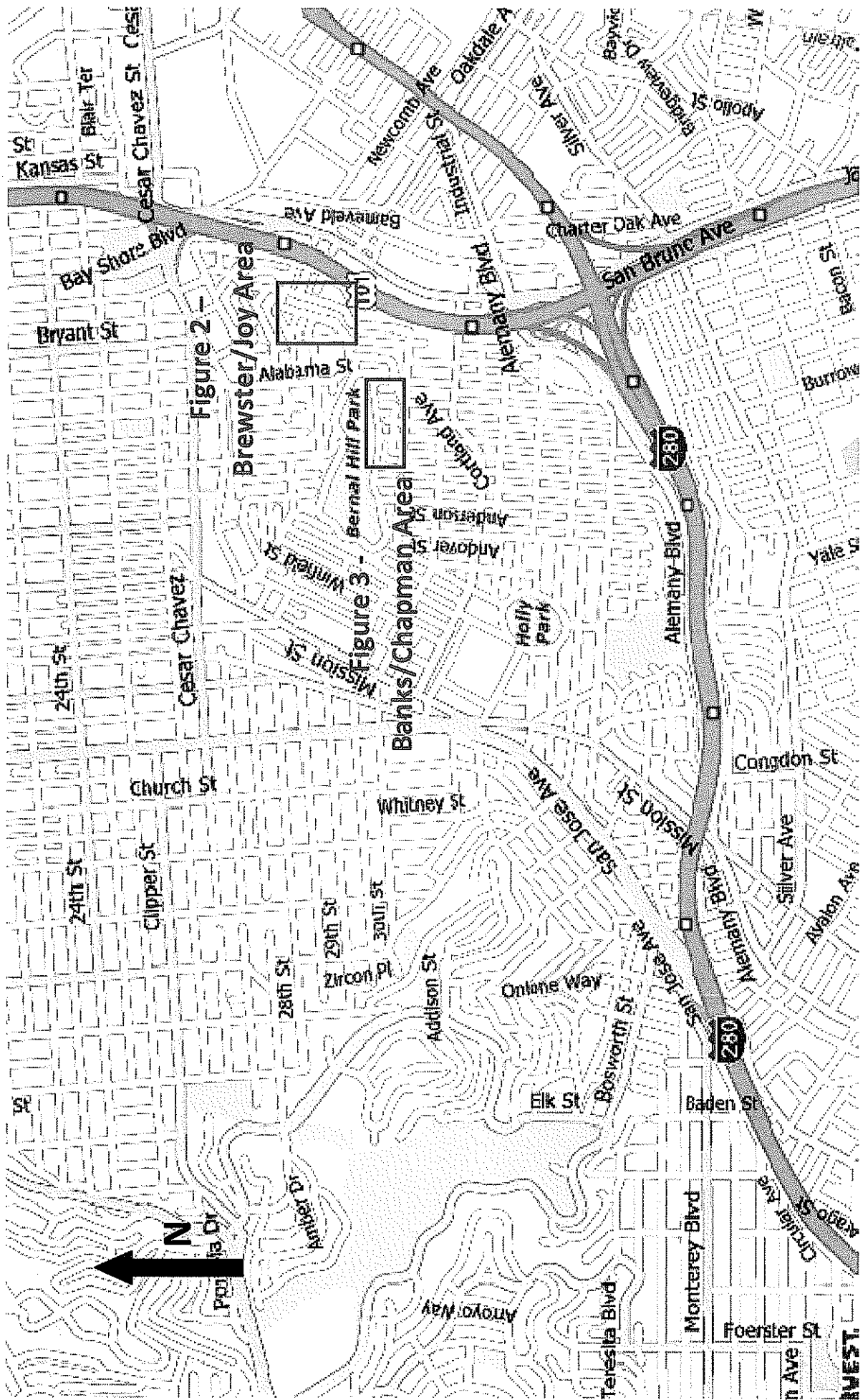

Figure 1 – Bernal Heights Street Improvement Project

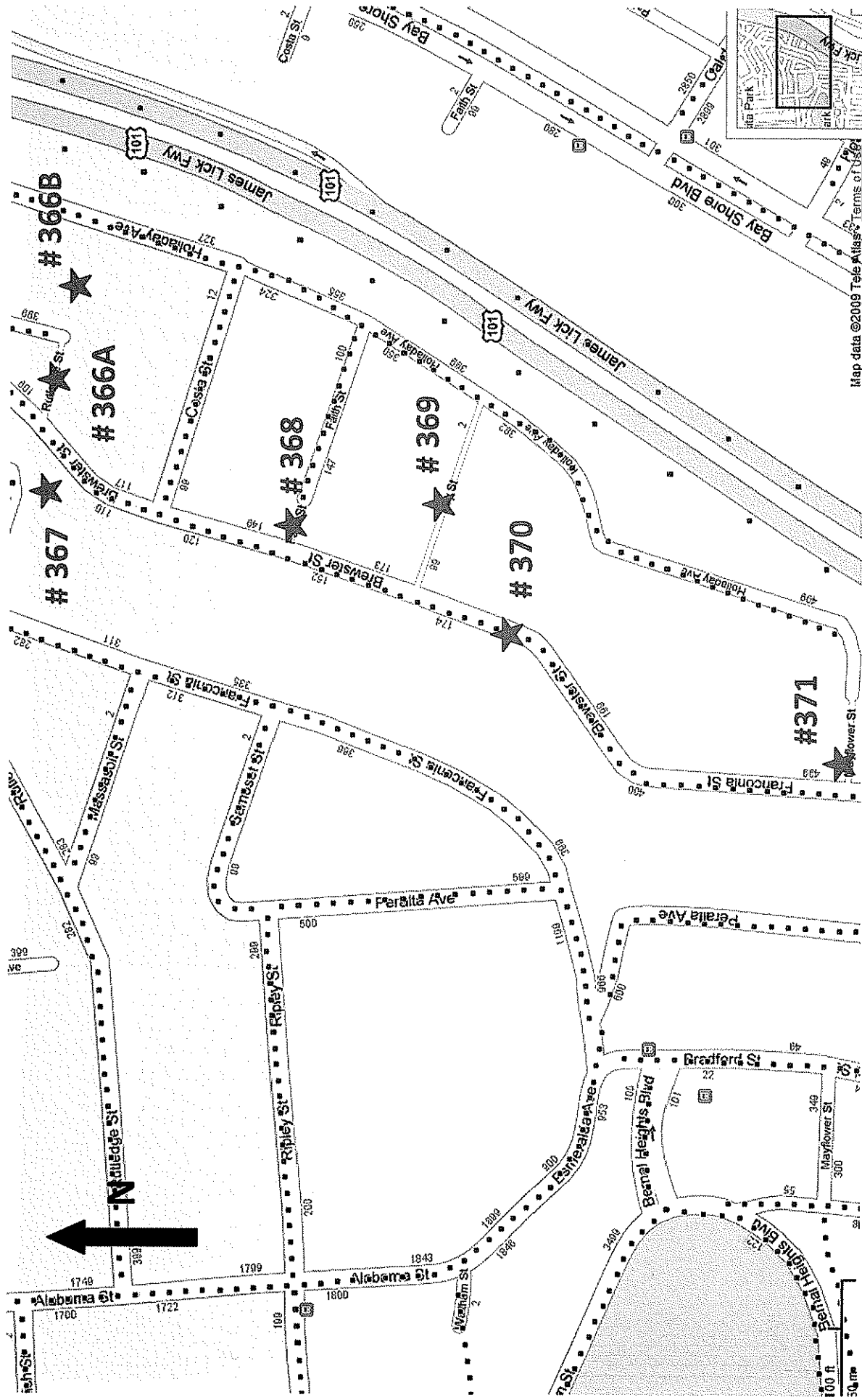

Figure 2 – Brewster/Joy Area on the East Slope

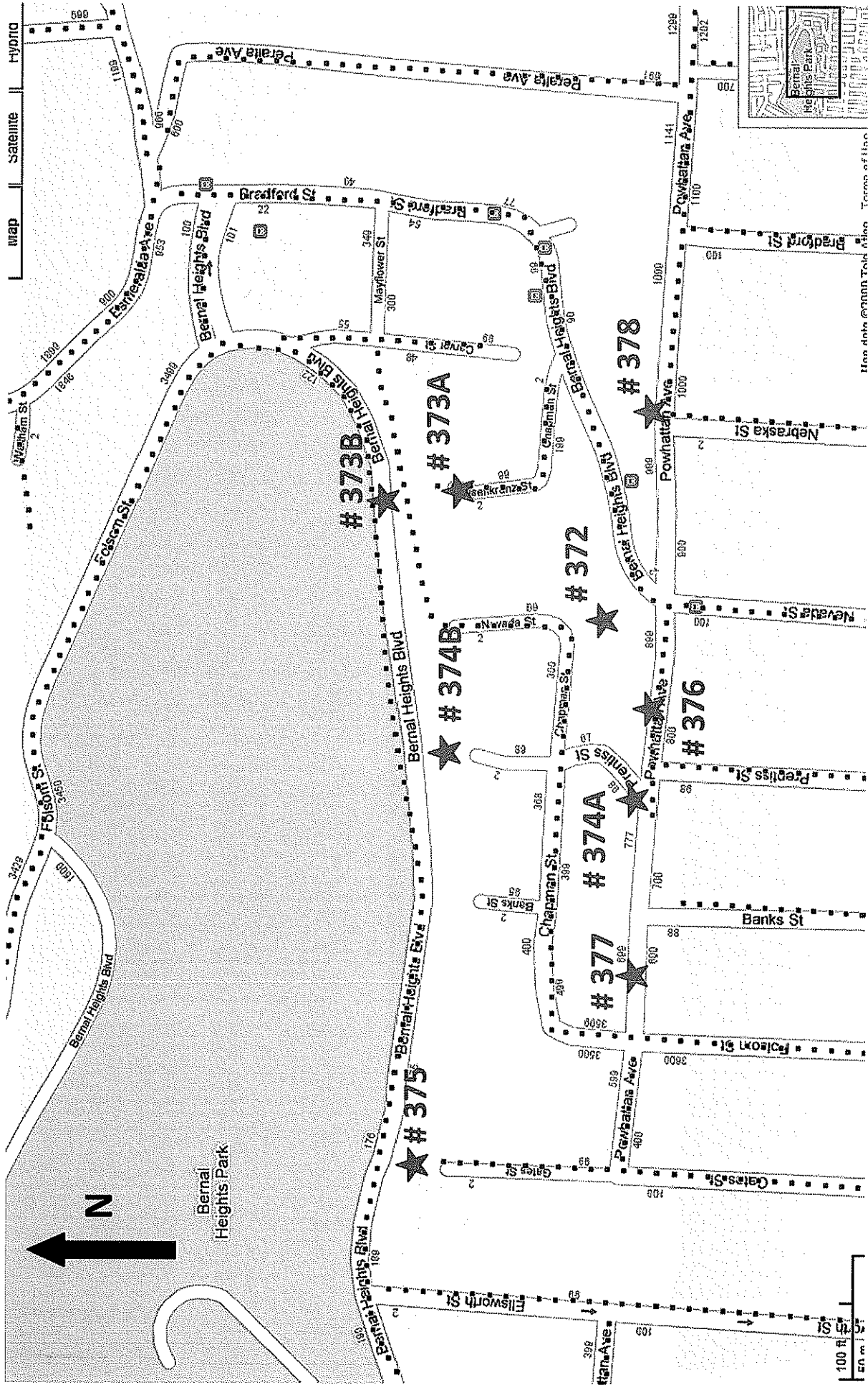

Figure 3 – Banks/Chapman Area on the South Slope

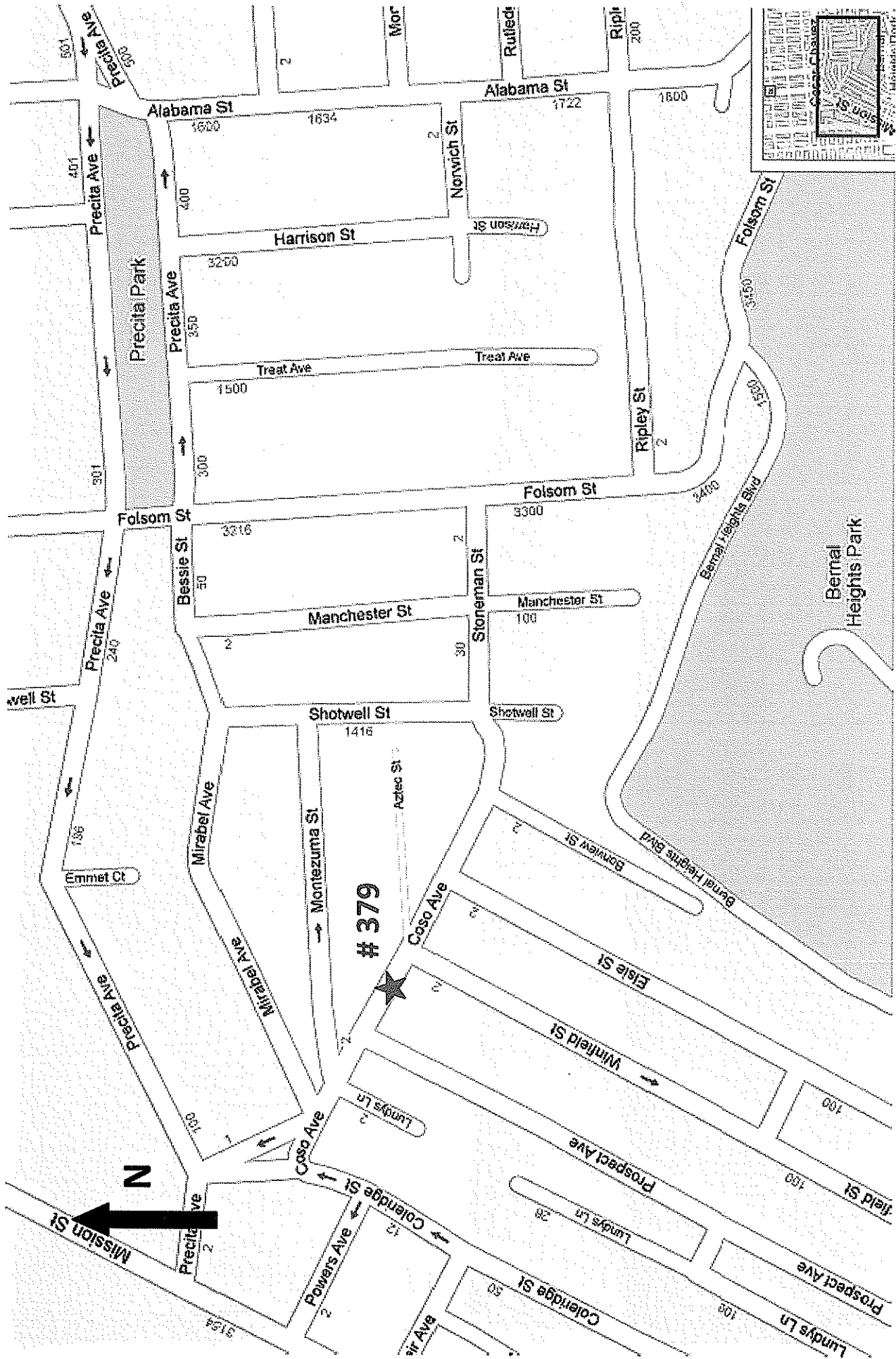

Figure 4 – Coso Avenue Rockfall Emergency Remediation