

SHEET NOTES

- 1 R/S EXISTING POLE AND SIGNALS 29, 48, AND 62. R/C EXISTING FOUNDATION AT LOCATION (A). F/I NEW POLE AND FOUNDATION TO LOCATION (E). RELOCATE SIGNAL HEAD 29 TO LOCATION (E). CC (A) 80,128± SqFt
- 2 F/I NEW FOUNDATION AT LOCATION (F). RELOCATE EXIST POLE FROM LOCATION (A) TO LOCATION (F). RELOCATE PED SIGNAL HEAD 48 AND #4 PPB FROM LOCATION (A) TO LOCATION (F). F/I NEW PULL BOX AND SIGNAL HEAD 23. EXTEND CONDUIT (A) TO NEW PULL BOX AT LOCATION (F). EXTEND NEW CONDUCTORS FROM LOCATION (F) TO CONTROLLER.
- 3 F/I 1-A POLE, FOUNDATION AND PULL BOX. RELOCATE #4 PPB FROM LOCATION (E) TO LOCATION (C). RELOCATE SIGNAL HEAD 65. F/I SIGNAL HEADS 49 AND 68 AND SIGNAL MOUNTING. EXTEND NEW CONDUIT RUNS (A) AND (A). EXTEND NEW CONDUCTORS TO CONTROLLER. F/I SIGNAL HEAD 65. F/I PED SIGNAL HEADS 49 AND 68 AND SIGNAL MOUNTING.
- 4 REDIRECT PED SIGNAL 49, MOUNTING HARDWARE AND WIRE AT CONTROLLER AS PED SIGNAL HEAD 69. REMOVE #4 PPB AT LOCATION (B) AND RELOCATE TO LOCATION (C). REPAIR PED SIGNAL HEAD 69 AT CONTROLLER. WELD AND PAINT OR OTHERWISE PATCH PPB MOUNTING HOLES PER DIRECTION OF TRAFFIC.
- 5 F/I SIGNAL HEAD 63 AT LOCATION (C). MODIFY SIGNAL MOUNTING EQUIPMENT AS REQUIRED. EXTEND #6 CONDUCTORS TO CONTROLLER.
- 6 F/I NEW PULL BOX, SIGNAL HEAD 41, AND SENSYS NETWORK ACCESS POINT AT LOCATION (H). CHIP AND GROUT FOUNDATION TO ALLOW FOR INSTALLATION OF SIGNAL CONDUIT INTO POLE (H). EXTEND SIGNAL CONDUCTORS AND ACCESS POINT CAT 5e CABLE TO CONTROLLER.
- 7 EXTEND ONE #14 CONDUCTOR FROM CONTROLLER TO LOCATIONS (B) AND (E) FOR FUTURE 4-SECTION HEADS 62 AND 64. LABEL AND COIL IN ADJACENT PULL BOX AND CONTROLLER.
- 8 EXTEND FOUR #14 CONDUCTORS FROM CONTROLLER TO LOCATIONS (B) AND (E) FOR FUTURE 4-SECTION HEADS 25 AND 26. LABEL AND COIL IN ADJACENT PULL BOX AND CONTROLLER.
- 9 EXTEND ONE #14 CONDUCTOR FROM CONTROLLER TO LOCATION (D) FOR FUTURE 4-SECTION HEAD 24. LABEL AND COIL IN ADJACENT PULL BOX AND CONTROLLER.
- 10 F/I SENSYS VEHICLE DETECTION SYSTEM WITH ACCESS POINT, SENSOR, AND CONTACT CLOSURE CARD COMPLETE AND OPERATIONAL. EXTEND CAT 5e CABLE FROM ACCESS POINT TO CONTROLLER.

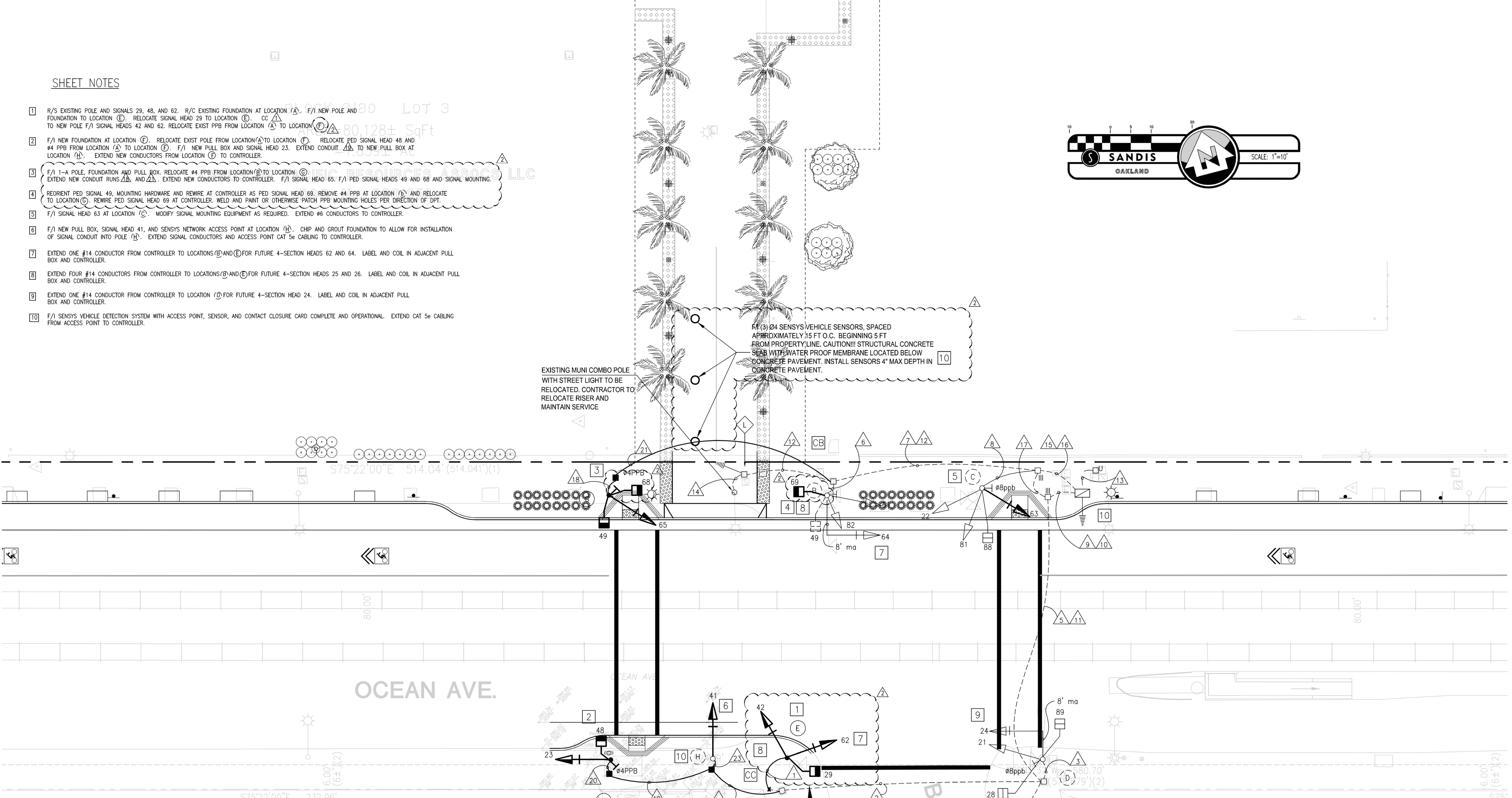

EXISTING PHASE DIAGRAM:

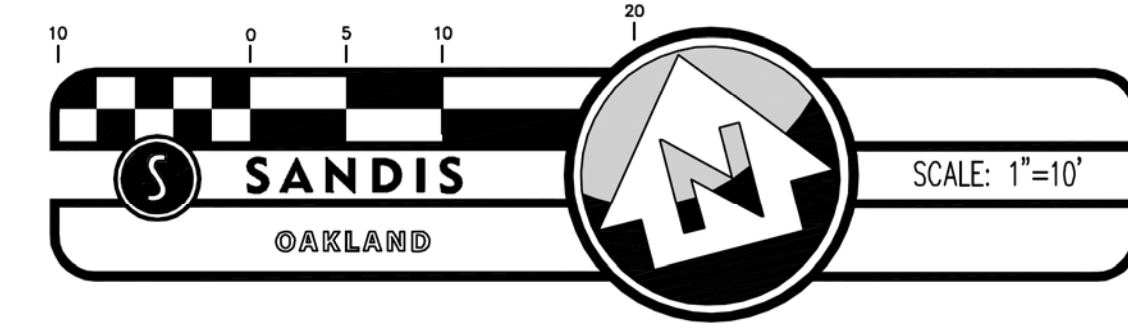
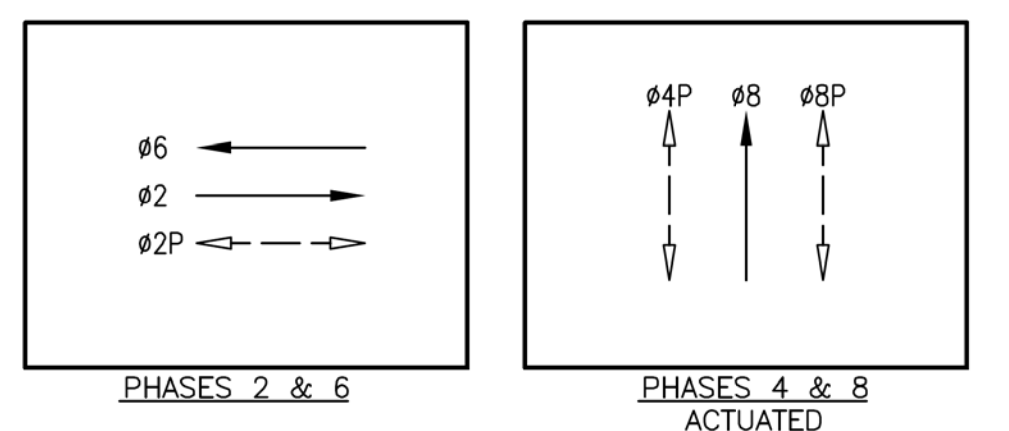

PROPOSED PHASE DIAGRAM:

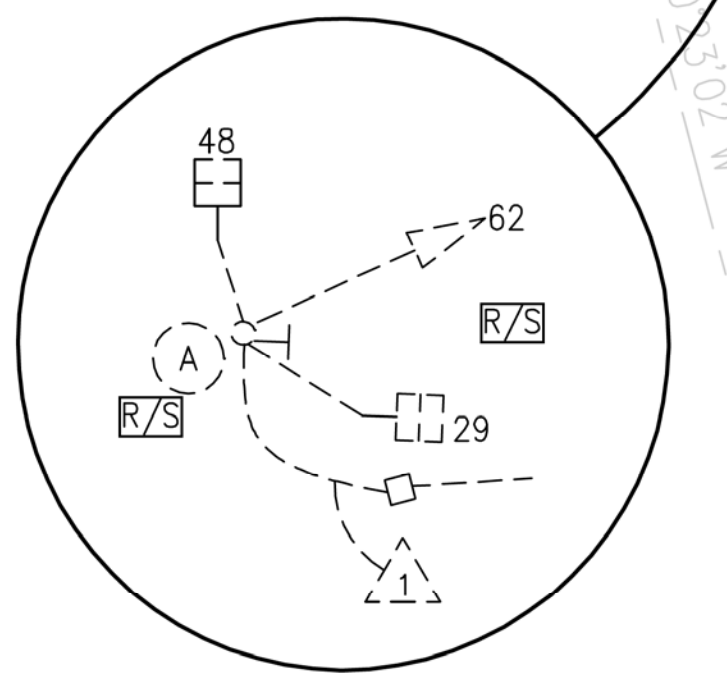
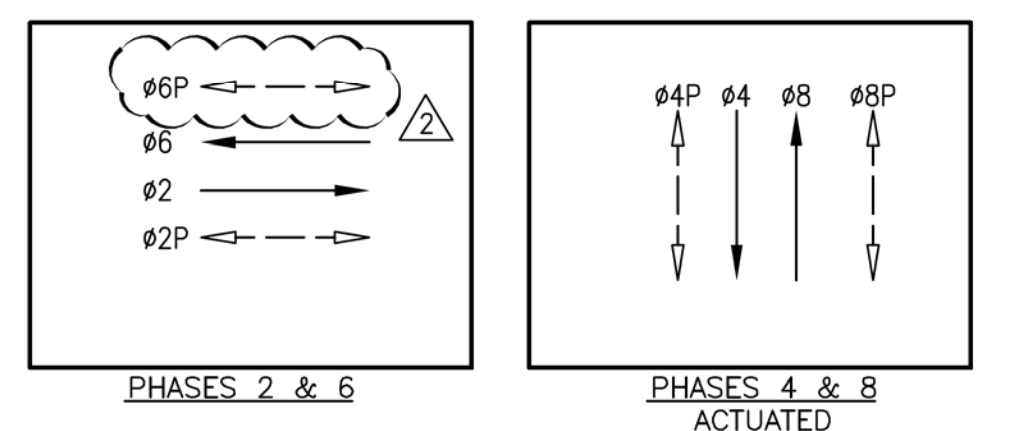

DETAIL NOTES:

1 EXISTING IN-LINE FUSE HOLDER W/ 40A FUSE FOR IC SERVICE. R/S EXISTING PULLBOX. F/I NEW TRAFFIC-RATED PULLBOX.

architecture planning research
 1611 Telegraph Avenue, Suite 200
 Oakland, California 94612
 510.465.7010 p | 510.465.8575 f
 www.pyatok.com

- Consultants:**
- Sandis**
1721 Broadway, Suite 201
Oakland, CA 94612
 - Miller Company**
1585 Folsom Street
San Francisco, CA 94103
 - FBA Inc., Structural Engineers**
1675 Sabre Street
Hayward, CA 94545
 - L.S. Mason & Associates**
3468 Mt. Diablo Blvd., Suite B-120
Lafayette, CA 94549
 - Fard Engineering, Inc.**
309 Lennon Lane, Suite 200
Walnut Creek, CA 94598
 - Rosen Goldberg & Der**
1100 Larkspur Landing Circle, #354
Larkspur, CA 94939
 - Simpson Gumpertz & Heger, Inc.**
The Landmark @ One Market, Suite 600
San Francisco, CA 94105

1150 OCEAN AVENUE
San Francisco, CA

Client:
AvalonBay COMMUNITIES, INC.
 400 Race Street, Suite 200
 San Jose, CA 95126

Revision Schedule		
Rev. No.	Issue	Date
	STREET IMPROVEMENT SET	10/13/09
	SIDEWALK BULB-OUT REVIEW	02/09/10
	STREET IMPROVEMENT SET SUB #2	09/27/10
	STREET IMPROVEMENT SET SUB #3	11/05/10
	STREET IMPROVEMENT SET SUB #4	12/06/10
	STREET IMPROVEMENT SET SUB #5	01/12/11
	STREET IMPROVEMENT SET SUB #6	02/11/11
	STREET IMPROV. SET SPWATER SUB	04/13/11

Stamp:

Job Number: 0531
 Drawn by: RAB
 Checked by: JMS
 Date: 06/16/11
 Scale:

Title:
TRAFFIC SIGNAL MODIFICATIONS
OCEAN AVENUE AT BRIGHTON
SIGNAL PLAN
 Sheet

T1.2