

Whole Foods Market

City Center Mall, 2675 Geary Boulevard

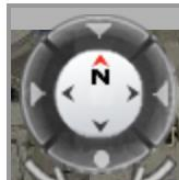



MASONIC

GEARY BLVD

LYON

Loading

Store

LOT C

LOT E

O'FARRELL (one way)



Construction Trade Unions

- \$9.6 million in union trade labor
- Commitment to hire union mechanical, electrical, and plumbing
- 84%-94% union trade labor on recent projects
- Projected \$31 million for pipeline projects



Whole Foods SF Employee Profiles

- 76% of Whole Foods' 1,420 SF employees live in the city
- 72% of employees are full-time
- 57% identify as people of color
- Project: 200 employees



Partnership with Booker T. Washington

- Prioritize 30% of employee hires through Booker T. Washington Community Services Center
- Two recruitment events, with OEWD and other non-profits
- Community workshop for current job openings
- \$1,000/month for healthy snacks
- Volunteer program
- Sponsor 100th anniversary event
- Garden enhancement program



Coalition of Supporters

- Anza Vista Neighborhood Association
- Booker T. Washington Community Services Center
- Collective Impact/Magic Zone
- Food Runners
- Fillmore and Geary Merchant Associations
- SF Chamber of Commerce
- NIBBI and Eric F. Anderson GCs
- Resident Support



Loading Methodology

- Grocery store loading demand is based on sales
- Existing tenant space
- Appellants misrepresent difference in size between stores
- Appellants have no expert opinion or modeling
- Technical memo based on square footage confirms City estimate





Loading



TARGET
LOW PRICE. NOT LESS.

LOT E

Store
Entrance



LOT C

Ramboll Findings

As shown in **Table 3**, the maximum cancer risk from Project operations is calculated to be 2.6 in 1 million, compared to a threshold of 7 in 1 million, based on a maximum PM_{2.5} concentration of 0.008 µg/m³ (threshold of 0.2 µg/m³). These results are all well below the APEZ thresholds of significance; thus, health risk impacts associated with construction of the Project are less than significant.

Table 3
Health Risk Assessment
2675 Geary Whole Foods Market
San Francisco, California

Receptor Type	Hourly Dispersion Factor ¹	Annual Dispersion Factor ²	PM ₁₀ Emission Rate	Annual PM ₁₀ Concentration (C)	Inhalation Factor (IF _{inh})	Cancer Potency Factor (CPF)	Lifetime Cancer Risk
	[ug/m ³ /g/s]	[ug/m ³ /g/s]	[g/s]	[ug/m ³]	[m ³ /kg-day] ⁻¹	[mg/kg-day]	[in a million]
Daycare Child	544	54.4	1.55E-04	8.46E-03	0.28	1.1	2.6
Resident Child	194.9	19.49	1.55E-04	3.03E-03	0.68	1.1	2.3

ESA Findings

TABLE 1
OPERATIONAL EMISSIONS COMPARISON FOR BEST BUY AND PROPOSED WHOLE FOODS

	Year 2021 Annual Emissions (pound per day)				Year 2021 Annual Emissions (tons per year)			
	ROG	NO _x	PM ₁₀	PM _{2.5}	ROG	NO _x	PM ₁₀	PM _{2.5}
Whole Foods	10.1	38.1	16.7	4.7	1.8	7.0	3.0	0.9
Best Buy	4.5	13.0	5.4	1.5	0.8	2.4	1.0	0.3
Incremental Increase	5.6	25.1	11.3	3.2	1.0	4.6	2.1	0.6
BAAQMD Thresholds	54	54	82	54	10	10	15	10
Over Thresholds?	No	No	No	No	No	No	No	No

ABBREVIATIONS:

ROG = reactive organic gases; NO_x = oxides of nitrogen; PM₁₀ = particulate matter with diameter equal to or less than 10 microns; PM_{2.5} = particulate matter with diameter equal to or less than 2.5 microns.



2020 Air Pollutant Exposure Zone

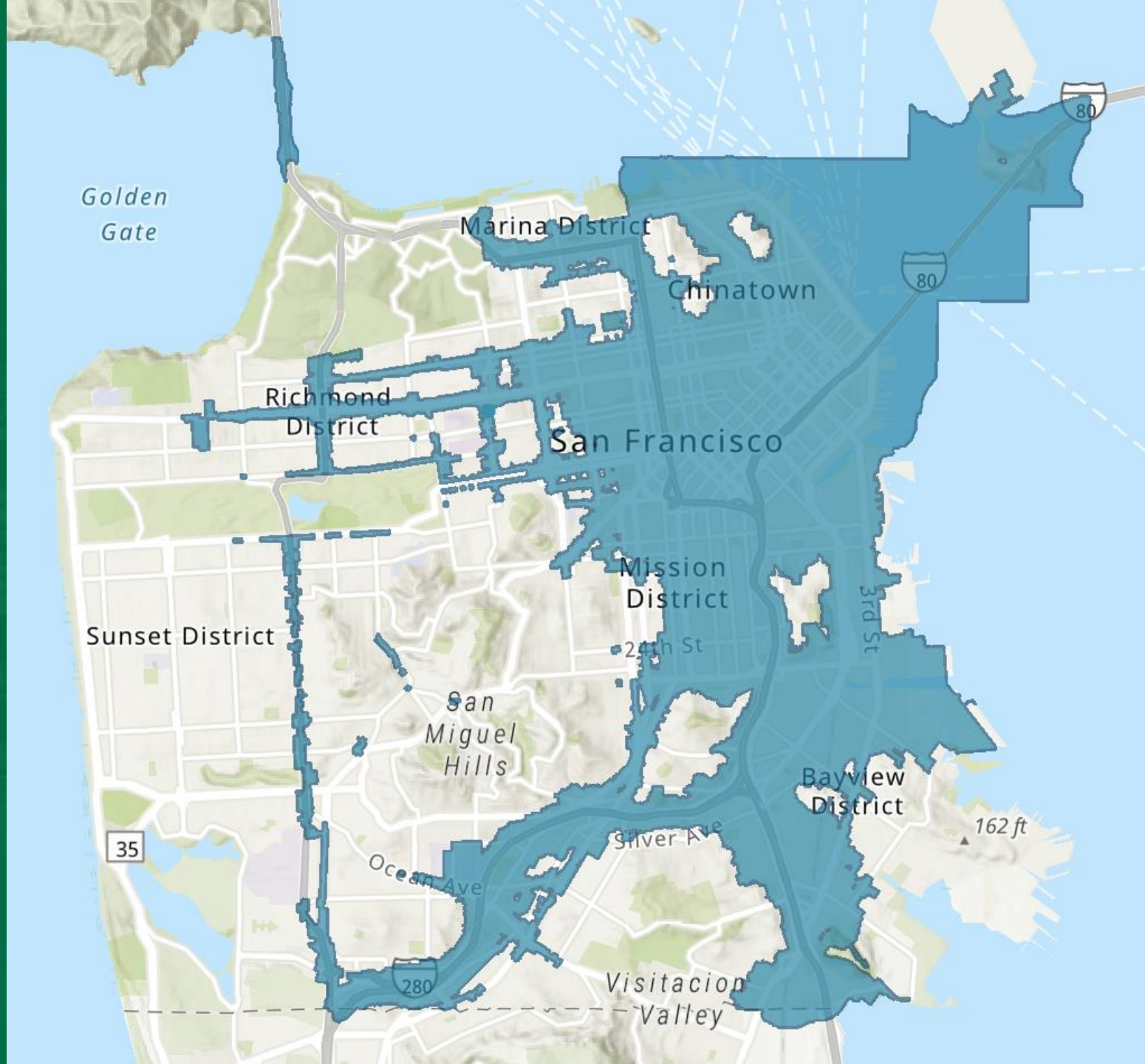

Thank you



Floor Plan Proposed - Whole Foods

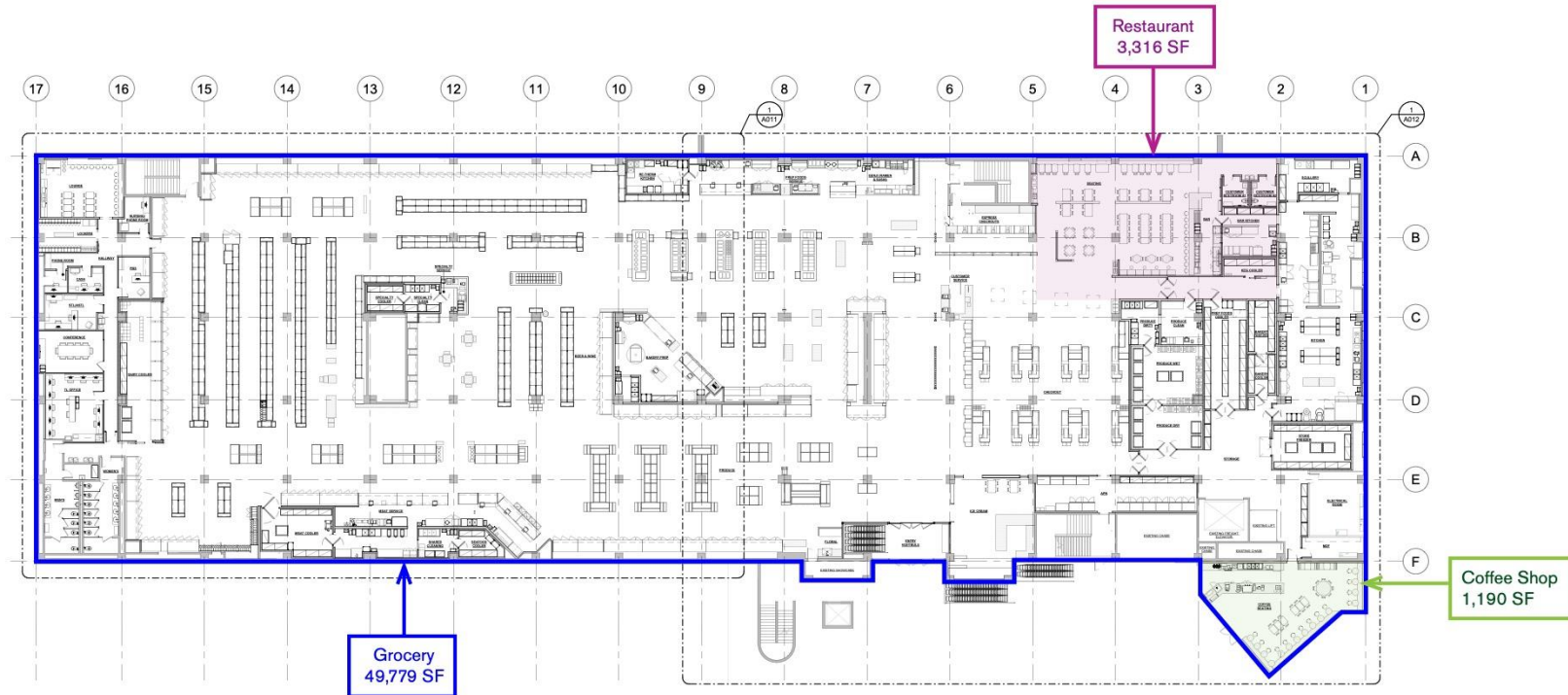

SF TOTALS

Street Level

- Grocery 49,779 SF
- Coffee Shop 1,190 SF
- Restaurant 3,316 SF

Sub Total 54,285 SF

Loading Dock Level

- Loading Dock 3,528 SF

TOTAL: 57,813 SF

