

AGRAM FOR THE ICT KNOWN AS THE ITY BENEFIT DISTRICT

s Improvement District
of San Francisco, State of California,
ia ST.s and Highways Code
District Law of 1994," §§36600 et seq.)
Business and Tax Regulations Code

AN ASSESSMENT WAS LEVIED BY THE BOARD OF SUPERVISORS FOR THE CITY AND COUNTY OF SAN FRANCISCO, STATE OF CALIFORNIA, ON THE LOTS, PIECES, AND PARCELS OF LAND SHOWN ON THIS ASSESSMENT DIAGRAM. THE LEVY OF ASSESSMENT WAS APPROVED BY THE BOARD OF SUPERVISORS ON THE 28 DAY OF January, 2020; AND SIGNED BY THE MAYOR ON THE 7 DAY OF February, 2020. RESOLUTION NO. 53-20. THE ASSESSMENT DIAGRAM WAS FILED IN THE OFFICE OF THE CLERK OF THE BOARD OF SUPERVISORS FOR THE CITY AND COUNTY OF SAN FRANCISCO ON THE 12 DAY OF February, 2020.

SAID RESOLUTION NO. 53-20, TOGETHER WITH THE STATUTORILY REQUIRED MANAGEMENT DISTRICT PLAN AND CERTIFIED ENGINEER'S REPORT FOR THIS DISTRICT AS ALSO APPROVED BY THE BOARD OF SUPERVISORS ARE ON FILE WITH THE BOARD OF SUPERVISORS AND ARE SUBMITTED WITH THE ASSESMENT DIAGRAM TO THE OFFICE OF THE ASSESSOR-RECORDER FOR THE CITY AND COUNTY OF SAN FRANCISCO FOR RECORDING. REFERENCE IS MADE TO THE MANAGEMENT DISTRICT PLAN, CERTIFIED ENGINEER'S REPORT AND ASSESSMENT DIAGRAM FOR THE AMOUNT OF EACH ASSESSMENT LEVIED AGAINST EACH PARCEL OF LAND SHOWN ON THIS ASSESSMENT DIAGRAM.

UPON RECORDATION BY THE COUNTY ASSESSOR-RECORDER, A CONFORMED COPY OF THE ASSESSMENT DIAGRAM WILL BE FILED WITH THE CLERK OF THE BOARD OF SUPERVISORS FOR THE CITY AND COUNTY OF SAN FRANCISCO, AND A NOTICE OF ASSESSMENT WILL BE ISSUED PURSUANT TO CALIFORNIA STREETS AND HIGHWAYS CODE §§3114 AND 36627.

Alisa Gomez

ANGELA CALVILLO, CLERK OF THE BOARD OF SUPERVISORS, CITY AND COUNTY OF SAN FRANCISCO

THE ASSESSMENT DIAGRAM AND RESOLUTION NO. 191027, TOGETHER WITH THE MANAGEMENT DISTRICT PLAN AND ENGINEER'S REPORT FOR THIS ASSESSMENT DISTRICT, THAT WERE SUBMITTED FOR RECORDING BY THE CLERK OF THE BOARD OF SUPERVISORS (SEE PARAGRAPH 1, ABOVE), WERE RECORDED BY THE ASSESSOR-RECORDER FOR THE CITY AND COUNTY OF SAN FRANCISCO, STATE OF CALIFORNIA ON THE 18th DAY OF February, 2020. THE ASSESSMENT DIAGRAM WAS FILED IN BOOK 1 OF MAPS OF ASSESSMENT AND COMMUNITY FACILITIES DISTRICTS AT PAGE(S) 172, IN THE OFFICE OF THE ASSESSOR-RECORDER, CITY AND COUNTY OF SAN FRANCISCO, STATE OF CALIFORNIA, AT THE HOUR OF 9:21 O'CLOCK AM, ON THIS SAME DATE.

Carmen Chu

CARMEN CHU, ASSESSOR-RECORDER, CITY AND COUNTY OF SAN FRANCISCO

FOR PARTICULARS OF THE LINES AND DIMENSIONS OF ASSESSOR PARCELS, REFERENCE IS MADE TO THE MAPS OF THE ASSESSOR OF THE CITY AND COUNTY OF SAN FRANCISCO.

CONFORMED COPY of document recorded

02/18/2020, 2020K902796

on _____ with document no. _____
This document has not been compared with the original
SAN FRANCISCO ASSESSOR-RECORDER

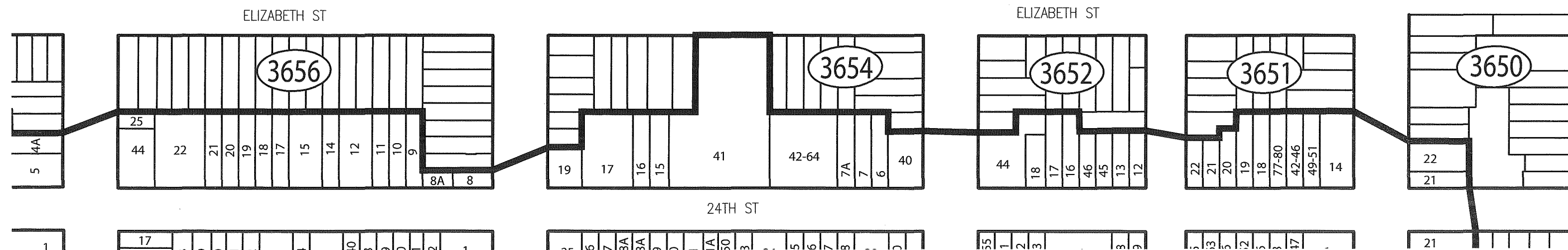

ASSESSMENT DIAGRAM FOR THE ASSESSMENT DISTRICT KNOWN AS THE NOE VALLEY COMMUNITY BENEFIT DISTRICT

A Property and Business Improvement District
Established in the City and County of San Francisco, State of California,
Under Part 7 of the California ST.s and Highways Code
("Property and Business Improvement District Law of 1994," §§36600 et seq.)
and Article 15 of the San Francisco Business and Tax Regulations Code

AN ASSESSMENT WAS LEVIED BY THE BOARD OF SUPERVISORS FOR THE CITY AND COUNTY OF SAN FRANCISCO, STATE OF CALIFORNIA, ON THE LOTS, PIECES, AND PARCELS OF LAND SHOWN ON THIS ASSESSMENT DIAGRAM. THE LEVY OF ASSESSMENT WAS APPROVED BY THE BOARD OF SUPERVISORS ON THE ____ DAY OF _____, 20____; AND SIGNED BY THE MAYOR ON THE ____ DAY OF _____, 20____, RESOLUTION NO. _____. THE ASSESSMENT DIAGRAM WAS FILED IN THE OFFICE OF THE CLERK OF THE BOARD OF SUPERVISORS FOR THE CITY AND COUNTY OF SAN FRANCISCO ON THE ____ DAY OF _____, 20____.

SAID RESOLUTION NO. _____, TOGETHER WITH THE STATUTORILY REQUIRED MANAGEMENT DISTRICT PLAN AND CERTIFIED ENGINEER'S REPORT FOR THIS DISTRICT AS ALSO APPROVED BY THE BOARD OF SUPERVISORS ARE ON FILE WITH THE BOARD OF SUPERVISORS AND ARE SUBMITTED WITH THE ASSESSMENT DIAGRAM TO THE OFFICE OF THE ASSESSOR-RECORDER FOR THE CITY AND COUNTY OF SAN FRANCISCO FOR RECORDING. REFERENCE IS MADE TO THE MANAGEMENT DISTRICT PLAN, CERTIFIED ENGINEER'S REPORT AND ASSESSMENT DIAGRAM FOR THE AMOUNT OF EACH ASSESSMENT LEVIED AGAINST EACH PARCEL OF LAND SHOWN ON THIS ASSESSMENT DIAGRAM.

UPON RECORDATION BY THE COUNTY ASSESSOR-RECORDER, A CONFORMED COPY OF THE ASSESSMENT DIAGRAM WILL BE FILED WITH THE CLERK OF THE BOARD OF SUPERVISORS FOR THE CITY AND COUNTY OF SAN FRANCISCO, AND A NOTICE OF ASSESSMENT WILL BE ISSUED PURSUANT TO CALIFORNIA STREETS AND HIGHWAYS CODE §§3114 AND 36627.

ANGELA CALVILLO, CLERK OF THE BOARD OF SUPERVISORS, CITY AND COUNTY OF SAN FRANCISCO



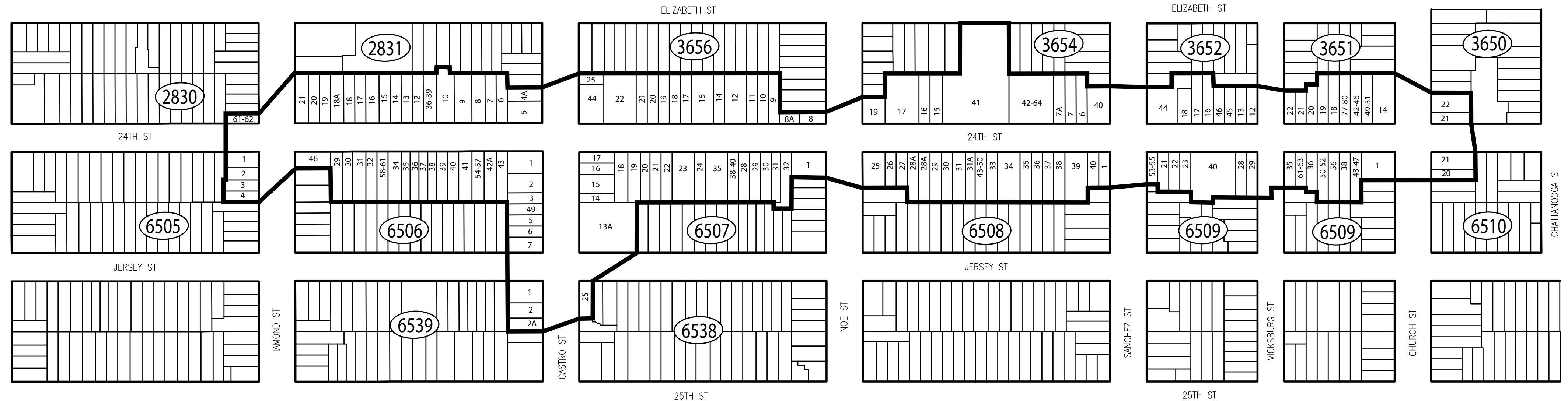

THE ASSESSMENT DIAGRAM AND RESOLUTION NO. _____, TOGETHER WITH THE MANAGEMENT DISTRICT PLAN AND ENGINEER'S REPORT FOR THIS ASSESSMENT DISTRICT, THAT WERE SUBMITTED FOR RECORDING BY THE CLERK OF THE BOARD OF SUPERVISORS (SEE PARAGRAPH 1, ABOVE), WERE RECORDED BY THE ASSESSOR-RECORDER FOR THE CITY AND COUNTY OF SAN FRANCISCO, STATE OF CALIFORNIA ON THE ____ DAY OF _____, 20____. THE ASSESSMENT DIAGRAM WAS FILED IN BOOK ____ OF MAPS OF ASSESSMENT AND COMMUNITY FACILITIES DISTRICTS AT PAGE(S) _____, IN THE OFFICE OF THE ASSESSOR-RECORDER, CITY AND COUNTY OF SAN FRANCISCO, STATE OF CALIFORNIA, AT THE HOUR OF ____ O'CLOCK ____M, ON THIS SAME DATE.

CARMEN CHU, ASSESSOR-RECORDER, CITY AND COUNTY OF SAN FRANCISCO

FOR PARTICULARS OF THE LINES AND DIMENSIONS OF ASSESSOR PARCELS, REFERENCE IS MADE TO THE MAPS OF THE ASSESSOR OF THE CITY AND COUNTY OF SAN FRANCISCO.

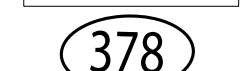

LEGEND

-  CBD Boundary
-  Lot Boundary
-  Block Number
-  Lot Number

