



# ABBREVIATED CEQA CHECKLIST FOR Better Streets Plan Improvement Projects

Please include the following supporting materials with this checklist:

- Project Description and scope of work
- Existing and Proposed* Site plans
- Site photos
- Scope of work for: Air Quality Analysis Tech Memo *(if applicable)*<sup>1</sup>
- Green House Gas Emission Checklist<sup>2</sup> *(if applicable)*

I - PROJECT INFORMATION	
DATE	
PROJECT NAME	
LOCATION/ NEIGHBORHOOD	
CONSTRUCTION DURATION	
II - PROJECT CONTACT	
RESPONSIBLE AGENCY	
NAME	
ADDRESS	
PHONE	
EMAIL	
III - PROJECT CHARACTERISTICS	
STREET TYPE <sup>3</sup>	<input type="checkbox"/> Varies (See attachment _____) OR Provide a description: Residential Thoroughway
STREET NAME	
<sup>4</sup> FROM (CROSS-STREET 1) TO (CROSS-STREET 2)	

<sup>1</sup> Individual projects prepared pursuant to the BSP would be required to undergo a separate environmental review that would consider whether the Proposed Project's location and construction plan could affect nearby sensitive receptors - p. 123 of the BSP's PMND - **[Contact EP planner for a copy of scope of work outline]**.

<sup>2</sup> Individual streetscape projects would be required to undergo a separate environmental review pursuant to CEQA. The environmental review would include an analysis of the individual project's potential to emit GHGs. p.128 of the BSP's PMND. **[Contact EP planner for a copy of GHG Checklist]**.

<sup>3</sup> See Table 1 in PMND and verify final list of street types with the online version of the BSP.

<sup>4</sup> Street type determines what elements are appropriate for a design element. Different blocks of the same street may be characterized as different street types pursuant to BSP. Therefore, need to provide boundaries for project segments.

**PROJECT NAME:**

**PROJECT SCREENING PART I**

*(On the table below, please identify BSP's design elements that are part of the proposed project)*

**DETAILED DESIGNED ELEMENTS**

**STANDARD IMPROVEMENTS**

<b>BSP NUMBER/ NAME</b>	<b>PROJECT ELEMENT</b>	<b>Requires Subsequent Environmental Review<sup>5</sup> (EP PLANNER DETERMINATION ONLY)</b>
SI-1 Accessible curb ramps	<input type="checkbox"/>	<input type="checkbox"/>
SI-2 Marked crosswalks	<input type="checkbox"/>	<input type="checkbox"/>
SI-3 Pedestrian signal timing	<input type="checkbox"/>	<input type="checkbox"/>
SI-4 Curb radii guidelines	<input type="checkbox"/>	<input type="checkbox"/>
SI-5 Corner curb extensions	<input type="checkbox"/>	<input type="checkbox"/>
SI-6 Street trees	<input type="checkbox"/>	<input type="checkbox"/>
SI-7 Tree basin furnishing	<input type="checkbox"/>	<input type="checkbox"/>
SI-8 Sidewalk planters	<input type="checkbox"/>	<input type="checkbox"/>
SI-9 Stormwater management tools	<input type="checkbox"/>	<input type="checkbox"/>
SI-10 Street lighting	<input type="checkbox"/>	<input type="checkbox"/>
SI-11 Special paving	<input type="checkbox"/>	<input type="checkbox"/>
SI-12 Site furnishings	<input type="checkbox"/>	<input type="checkbox"/>

**CASE-BY-CASE IMPROVEMENTS**

CBC-1 High-visibility crosswalk	<input type="checkbox"/>	<input type="checkbox"/>
CBC-2 Special crosswalk	<input type="checkbox"/>	<input type="checkbox"/>
CBC-3 Vehicle turning movements	<input type="checkbox"/>	<input type="checkbox"/>
CBC-4 Removal or reduction of permanent crosswalk closures	<input type="checkbox"/>	<input type="checkbox"/>

<sup>5</sup> Please check analysis in PMND to determine if design element has been cleared under CEQA. For example, as stated in p.89 of the BSP's PMND the implementation of RTOR prohibition at intersections that experience high volumes of right-turning movements (greater than 300 vehicles in the peak hour) or have near-side bus stops would require additional study and environmental review.

**PROJECT NAME:**

**PROJECT SCREENING PART I CONT.**

NUMBER/ NAME	PROJECT ELEMENT	REQUIRES SUBSEQUENT ENVIRONMENTAL REVIEW <sup>6</sup> (DO NOT FILL IN, THIS SECTION IS FOR EP PLANNER DETERMINATION ONLY)
CBC-5 Mid-block crosswalks	<input type="checkbox"/>	<input type="checkbox"/>
CBC-6 Raised crosswalks	<input type="checkbox"/>	<input type="checkbox"/>
CBC-7 Extended bulb-outs	<input type="checkbox"/>	<input type="checkbox"/>
CBC-8 Mid-block blub-out	<input type="checkbox"/>	<input type="checkbox"/>
CBC-9 Center or side medians	<input type="checkbox"/>	<input type="checkbox"/>
CBC-10 Pedestrian refugee islands	<input type="checkbox"/>	<input type="checkbox"/>
CBC-11 Transit bulb-out	<input type="checkbox"/>	<input type="checkbox"/>
CBC-12 Transit boarding islands	<input type="checkbox"/>	<input type="checkbox"/>
CBC-13 Perpendicular or angled parking	<input type="checkbox"/>	<input type="checkbox"/>
CBC-14 Flexible use of parking	<input type="checkbox"/>	<input type="checkbox"/>
CBC-15 Parking lane planters	<input type="checkbox"/>	<input type="checkbox"/>
CBC-16 Chicanes	<input type="checkbox"/>	<input type="checkbox"/>
CBC-17 Traffic calming circles	<input type="checkbox"/>	<input type="checkbox"/>
CBC-18 Roundabouts	<input type="checkbox"/>	<input type="checkbox"/>
CBC-19 Pocket parks	<input type="checkbox"/>	<input type="checkbox"/>
CBC-20 Reuse of 'pork chops'	<input type="checkbox"/>	<input type="checkbox"/>
CBC-21 Boulevard treatments	<input type="checkbox"/>	<input type="checkbox"/>

<sup>6</sup> Please check analysis in PMND to determine if design element has been cleared under CEQA. For example, as stated in p.89 of the BSP's PMND the implementation of RTOR prohibition at intersections that experience high volumes of right-turning movements (greater than 300 vehicles in the peak hour) or have near-side bus stops would require additional study and environmental review.

**PROJECT NAME:**

**PROJECT SCREENING PART I CONT.**

NUMBER/ NAME	PROJECT ELEMENT	REQUIRES SUBSEQUENT ENVIRONMENTAL REVIEW <sup>7</sup> <i>(DO NOT FILL IN, THIS SECTION IS FOR EP PLANNER DETERMINATION ONLY)</i>
CBC-22 Shared public ways	<input type="checkbox"/>	<input type="checkbox"/>
CBC-23 Pedestrian-only streets	<input type="checkbox"/>	<input type="checkbox"/>
CBC-24 Public stairs	<input type="checkbox"/>	<input type="checkbox"/>
CBC-25 Multi-use paths	<input type="checkbox"/>	<input type="checkbox"/>
CBC-26 Above-ground landscaping	<input type="checkbox"/>	<input type="checkbox"/>

**OTHER DESIGN IMPROVEMENTS IN THE BETTER STREETS PLAN (BSP)**  
*(Not identified above)*

DESIGN ELEMENT NAME	BSP PAGE NUMBER	
		<input type="checkbox"/>

**(EP PLANNER COMMENTS):**

<sup>7</sup> Please check analysis in PMND to determine if design element has been cleared under CEQA. For example, as stated in p.89 of the BSP's PMND the implementation of RTOR prohibition at intersections that experience high volumes of right-turning movements (greater than 300 vehicles in the peak hour) or have near-side bus stops would require additional study and environmental review.

**PROJECT NAME:**

**PROJECT SCREENING PART I CONT.**  
*(On the table below, please identify BSP’s design elements that are part of the proposed project. If any of the questions listed below pertain to this project, please answer “YES”. If none apply, indicate so by checking the red box below.)*

**IDENTIFY STORM WATER FACILITIES THAT ARE PART OF THE PROJECT**

	Project Element	Requires Subsequent Environmental Review <sup>8</sup> (FOR EP PLANNER DETERMINATION ONLY)
Permeable Paving	<input type="checkbox"/>	<input type="checkbox"/>
Bioretention Facilities	<input type="checkbox"/>	<input type="checkbox"/>
Swales	<input type="checkbox"/>	<input type="checkbox"/>
Infiltration Boardwalks	<input type="checkbox"/>	<input type="checkbox"/>
Infiltration and Soakage Trench	<input type="checkbox"/>	<input type="checkbox"/>
Channels and Runnels	<input type="checkbox"/>	<input type="checkbox"/>
Vegetated Buffer Strip	<input type="checkbox"/>	<input type="checkbox"/>
Vegetated Gutter	<input type="checkbox"/>	<input type="checkbox"/>
Other (describe stormwater improvements)	<input type="checkbox"/>	<input type="checkbox"/>

**If none of the above BSP design elements apply, please indicate so by checking this box**

**(EP PLANNER COMMENTS):**

<sup>8</sup> Please check analysis in PMND to determine if design element has been cleared under CEQA. For example, as stated in p.89 of the BSP’s PMND the implementation of RTOR prohibition at intersections that experience high volumes of right-turning movements (greater than 300 vehicles in the peak hour) or have near-side bus stops would require additional study and environmental review.

**PROJECT NAME:**

**PROJECT SCREENING PART II**  
*(If any of the questions listed below pertain to this project, please answer "YES". If none apply, indicate so by checking the red box below.*  
*Note: If you answer "YES" to any of the questions listed below, this checklist may not be utilized, and therefore, and Environmental Evaluation application must be filled.)*

**TRANSPORTATION/CIRCULATION**

Does the project include right turn on red (RTOR) at locations where the peak hour right-turning traffic volume exceeds 300 vehicles per hour; or require any removal of multiple turn lanes; or the bus stop is located in the near side?	Yes
Does the project include removal of crosswalk closures?	Yes
Does the project include mid-block crosswalks on a two-way street where traffic volumes exceed 500 vehicles per hour in either direction during the peak hour?	Yes
Does the project include roundabouts?	Yes
Does the project include pedestrian-only streets on a street where through traffic is greater than 100 vehicles per hour in the peak hour, or there is transit service, or there are driveways or parking garages, or loading activities cannot be accommodated during off-peak hours?	Yes
Does the project include multi-use paths? <sup>9</sup>	Yes
Does the project include shared public ways on streets with park garages with parking spaces > 100, or through traffic > 100 cars per hours, or transit service?	Yes

**PROJECT ELEMENTS THAT WILL REQUIRE TECH SPEC EVALUATION:<sup>10</sup>**  
*(If the project includes any of the elements listed below, the project will require Tech Spec Evaluation).*

**HISTORICAL/ARCHEO RESOURCES**  
*(All applications need preliminary review for potential impacts to archeological resources pursuant to EP practice.)*

Is the proposed project located within a potential historic district or on a street adjacent to a historic landmark? <b>Please state the name of the historic district or historic landmark:</b> _____	Yes
Does the proposed project involve an identified historic resource among the following: street furniture, light standards, signage, curbs, places, bricks, walls, and other paving materials? <b>Please identify the historic elements that are part of the proposed project:</b> _____	Yes
Does the proposed project involve removal of trees adjacent to historic resources?	Yes

**If none of the above BSP design elements apply, please indicate so by checking this box**

<sup>9</sup> The BSP does not provide guidance on the location or design of Multi-use Paths. Therefore, at the time a location for implementation is proposed, it would be subject to site-specific environmental review.

<sup>10</sup> EP NEEDS TO DETERMINE HOW COORDINATION WILL OCCUR

**PROJECT NAME:**

<b>PROJECT SCREENING PART III</b>					
<i>Project elements that would require implementation of Mitigation Measures and Monitoring Reports organized by CEQA Topic.</i>					
<b>CEQA Topic</b>	<b>Sub-topic</b>	<b>Meet criteria/threshold:<sup>11</sup> Yes/No or N/A</b>	<b>Requires mitigation measure: Yes/No</b>	<b>Potential impacts differ from PMND analysis (Y/N). If "Yes" briefly describe on a separate sheet.</b>	<b>Project Sponsor Agrees to Implement Mitigation Measures</b>
<b>Aesthetics</b>					
Does the proposed project involve removal of significant trees? Yes <input type="checkbox"/> No <input type="checkbox"/>	Significant trees	N/A			<input type="checkbox"/>
Does the project involve tree root trimming? Yes <input type="checkbox"/> No <input type="checkbox"/> If so, is tree root trimming greater than two inches? Yes <input type="checkbox"/> No <input type="checkbox"/>		N/A	Aesthetics Tree Root Protection Mitigation Measure M-AE-1 applies if trimming of roots are greater than two (2) inches in diameter (p.53).		<input type="checkbox"/>
<input type="checkbox"/> None of the above CEQA topics apply to the project					
<b>Historical/Archeological Resources</b>					
Does the project require excavation depth greater than two (2) feet? Yes <input type="checkbox"/> No <input type="checkbox"/>	Accidental discovery		Archeological Accidental Discovery mitigation measure Cul-1 applies to all projects except for those occurs in an area within Hispanic Period Archeological District (p.64).		<input type="checkbox"/>
Does the project occur in an area within the Hispanic Period Archeological District? <sup>12</sup> Yes <input type="checkbox"/> No <input type="checkbox"/>	Hispanic Period District		Archeological Monitoring Hispanic Period mitigation measure Cul-2 applies (p.64).		<input type="checkbox"/>
<input type="checkbox"/> None of the above CEQA topics apply to the project					
<b>Transportation and Circulation</b>					
Does the project include removal of loading spaces? Yes <input type="checkbox"/> No <input type="checkbox"/>	Loading		Provision of New Loading Space, Mitigation Measure TR-1 (p.78).		<input type="checkbox"/>

<sup>11</sup> The Project sponsor should discuss with EP planner how to proceed with projects that do not meet the PMND's thresholds.

<sup>12</sup> **TO BE EVALUATED BY EP PLANNER.** The Spanish Period Map is not available for public review due to the sensitivity of the archeological resources encountered in the area.

**PROJECT NAME:**

**PROJECT SCREENING PART III CONT.**

*Project elements that would require implementation of Mitigation Measures and Monitoring Reports organized by CEQA Topic.*

**Air Quality**

	Construction impacts		Dust Control Plan, Mitigation Measure AQ-1 applies to <b>ALL</b> projects (p.120).		
--	----------------------	--	--	--	--

**Biological Resources**

Does the project include tree removal? Yes <input type="checkbox"/> No <input type="checkbox"/>	Nesting birds		Nesting Birds Mitigation Measure M-Bio-1 (p.151).		
--	---------------	--	---	--	--

**Biological Resources (Cont.)**

What is the expected duration period of construction? _____	Nesting birds		Nesting Birds Mitigation Measure M-Bio-1 (p.151).		
--	---------------	--	---	--	--

Which months would construction occur? _____	Nesting birds		Nesting Birds Mitigation Measure M-Bio-1 (p.151).		
---	---------------	--	---	--	--

**Hazardous Materials**

Does the project occur in an area within the Maher-designated area? <sup>13</sup> Yes <input type="checkbox"/> No <input type="checkbox"/>	Determination of contaminated soil		Hazardous Materials Mitigation Measure M-HAZ-1 (p.161).		
---	------------------------------------	--	---	--	--

**(EP PLANNER COMMENTS):**

<sup>13</sup> [www.sfdph.org/dph/EH/HazWaste/MaherSiteMap.asp](http://www.sfdph.org/dph/EH/HazWaste/MaherSiteMap.asp)



**PROJECT NAME:**

**This section is to be filled by EP Planner. Use check boxes to indicate type of review conducted (as applicable). Leave blank if not applicable to the Project.**

- Project was screened for potential impacts to archeological resources pursuant to EP practice.
- Project was screened by a Tech Spec for potential impacts to historical resources pursuant to EP practice.
- Applicable Mitigation Measures are applied to the project.
- Green House Gas analysis performed and approved by EP.
- Air Quality Memo approved by EP.
- The project was reviewed by DPH and DTSC, and a memo of concurrence was submitted to EP (for projects within the Maher Layer only).
- PMND was reviewed and no items were identified that would require subsequent environmental review.

**CEQA Determination**

- Note to file, contingent upon regulatory agency approval or other information, as follows:
  - Note to file (no additional documentation required)
  - Addendum
  - Supplemental EIR or MND

**Notes:**

**Planner Signature**

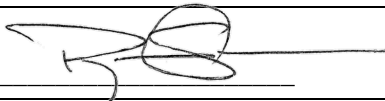
Signee (print name): \_\_\_\_\_  \_\_\_\_\_ Date: \_\_\_\_\_

At both intersections; construction of new ADA compliant curb ramps with concrete detectable warning tiles, grooved warning bands, 3.5' thick concrete sidewalk, combined 6' wide concrete curb and 2' wide concrete gutter, removal and replacement of concrete base around the curb return area, and ACWS, existing 8" road base would be removed, the sub-base excavated to a depth of 2", backfilled, and compacted, and new 8" road base constructed and covered with 2" ACWS, remove and salvage/reset granite curb where it exists. Depth of excavation for the curb ramp will be approximately 0.5'. Existing utility vaults and boxes will be reset, with adjustments as needed. Existing trees will be protected in place.

A B C D E F G H I J K L M N O P

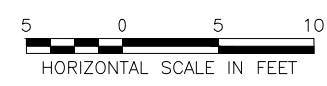
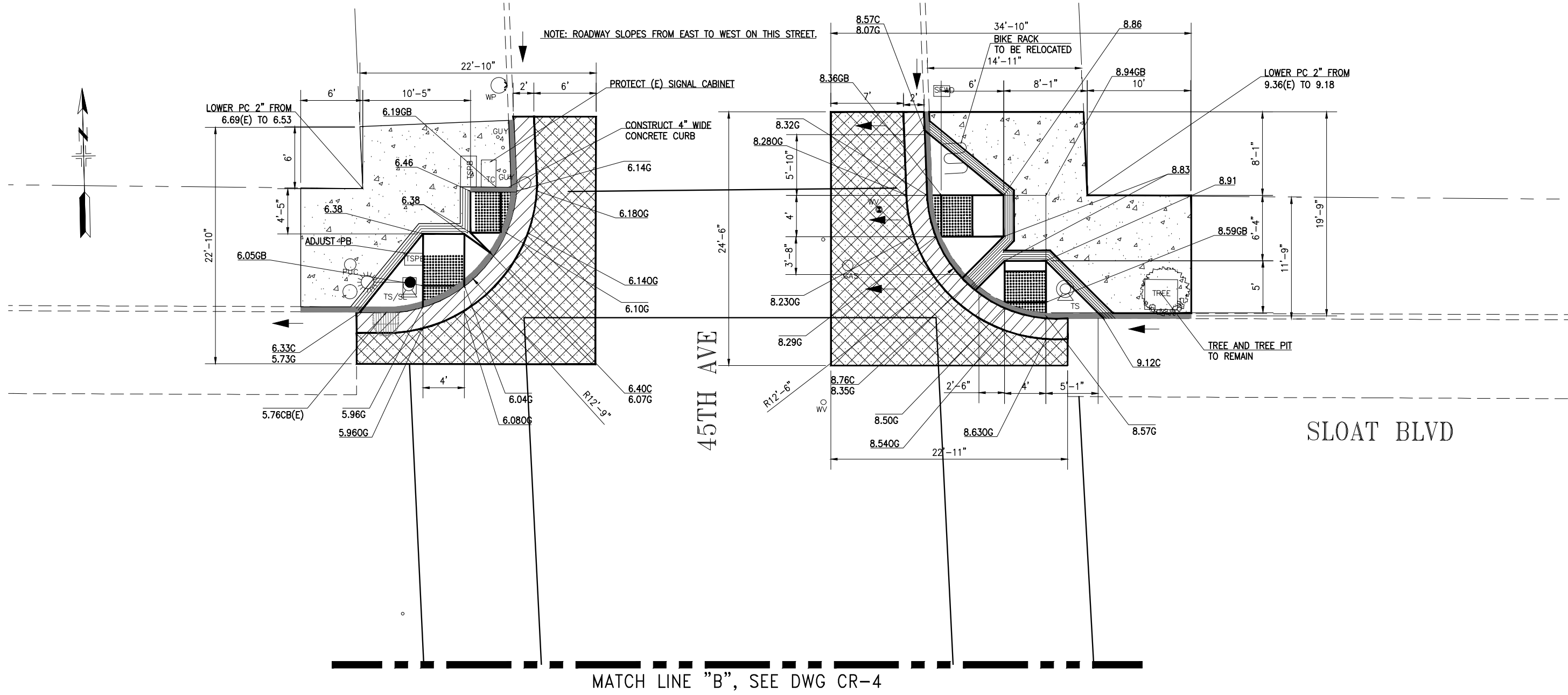

PRELIMINARY  
NOT FOR CONSTRUCTION USE

NO.	DATE	DESCRIPTION	BY	APP.
TABLE OF REVISIONS				
THIS DRAWING WAS LAST MODIFIED: 12/09/20 10:27, BY: ty				

REFERENCE INFORMATION  
& FILE NO. OF SURVEYS



**BUREAU OF ENGINEERING**  
CITY & COUNTY OF SAN FRANCISCO  
**SAN FRANCISCO PUBLIC WORKS**  
49 SOUTH VAN NESS AVENUE, SUITE 800  
SAN FRANCISCO, CA 94103

Date: \_\_\_\_\_  
Acting Section Mgr: ERIC KJELSBERG  
Deputy Bureau Mgr: FERNANDO CISNEROS  
Acting Bureau Mgr: IQBAL DHAPA

DESIGNED: DATE: T.YILMAZ 12/20  
DRAWN: DATE: M. BAUTISTA 12/20  
CHECKED: DATE: R.CHIRCOP 12/20



SCALE:  
1" = 5'  
SHEET OF SHEETS  
OF

SLOAT INFRASTRUCTURE IMPROVEMENTS  
SLOAT BLVD AND 45TH AVENUE NORTH  
CURB RAMP DETAILS

CONTRACT NO. 10037211  
DRAWING NO. CR-3  
FILE NO. xxxxxx  
REV. NO.

Xrefs: V:\12951\_Sloat\_Infrastructure\_Improvements\_10032507\Official\_Project\_TB\_22x34.dwg  
 V:\12951\_Sloat\_Infrastructure\_Improvements\_10032507\Official\_Project\_TB\_22x34.dwg  
 Model Units: Feet  
 Plot Time: Fri, 11 Dec 2020 - 7:47am

MATCH LINE "B", SEE DWG CR-3

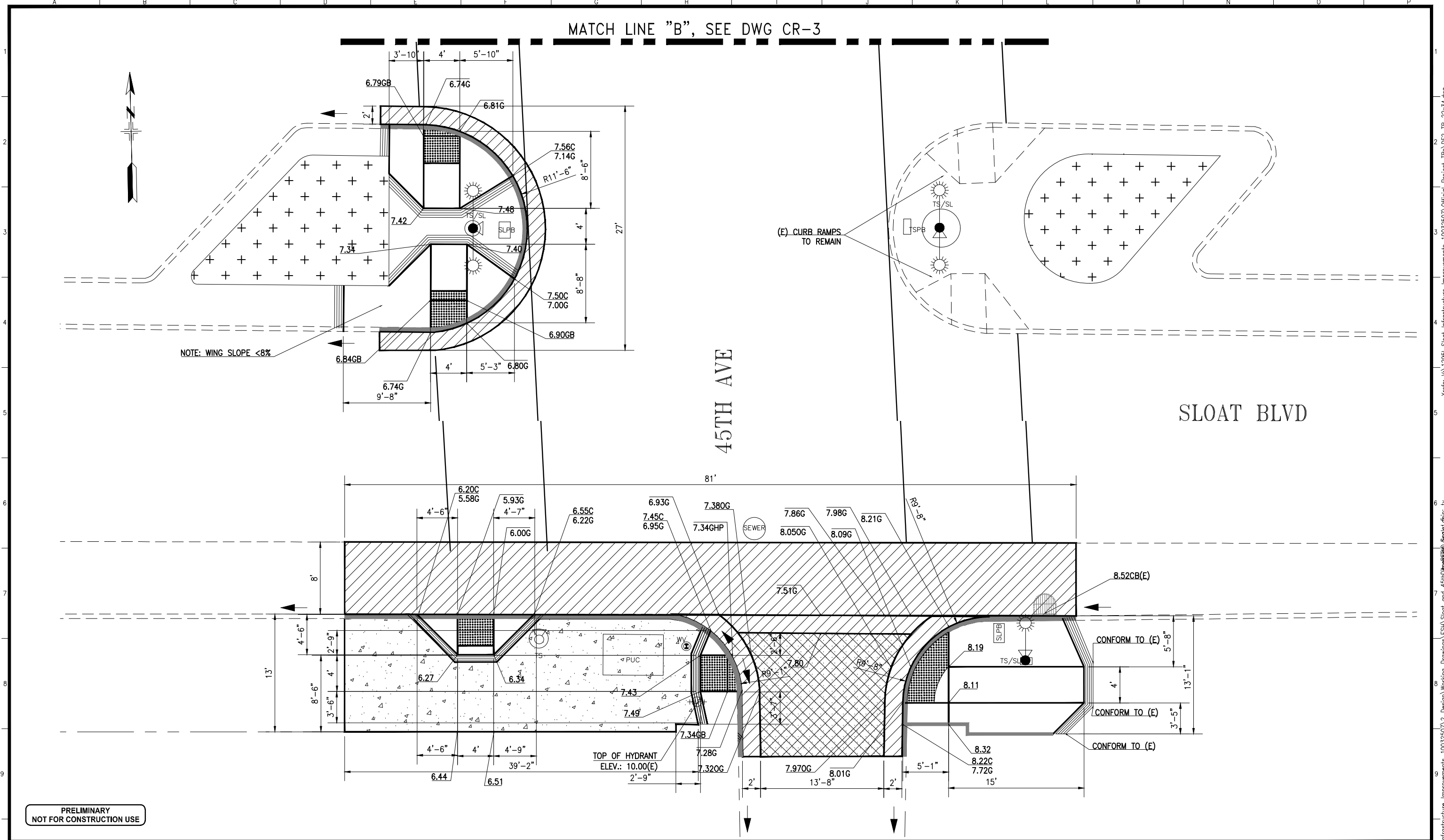

PRELIMINARY  
NOT FOR CONSTRUCTION USE

NO.	DATE	DESCRIPTION	BY	APP.
TABLE OF REVISIONS				
THIS DRAWING WAS LAST MODIFIED: 12/09/20 10:27, BY: ty				

REFERENCE INFORMATION  
& FILE NO. OF SURVEYS



Acting Section Mgr: ERIC KJELSBERG  
Deputy Bureau Mgr: FERNANDO CISNEROS  
Acting Bureau Mgr: IQBAL DHAPA

DESIGNED: T.YILMAZ 12/20  
DRAWN: M. BAUTISTA 12/20  
CHECKED: R.CHIRCOP 12/20

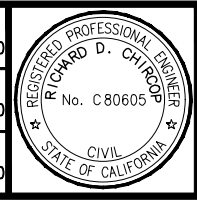

SCALE: 1" = 5'  
SHEET OF SHEETS  
OF

SLOAT INFRASTRUCTURE IMPROVEMENTS  
SLOAT BLVD AND 45TH AVENUE SOUTH  
CURB RAMP DETAILS

CONTRACT NO. 10037211  
DRAWING NO. CR-4  
FILE NO. xxxxxx  
REV. NO.

Drawing Path: V:\2951\_Sloat\_Infrastructure\_Improvements\_10032507\2\_Design\_Working\_Drawings\ESH\Sloat and 45th\Drawings\Bldg\_Signage.dgn; ty  
 Model Units: Feet  
 Xrefs: V:\2951\_Sloat\_Infrastructure\_Improvements\_10032507\Official\_Project\TBS\DE2\_TB\_22334.dwg

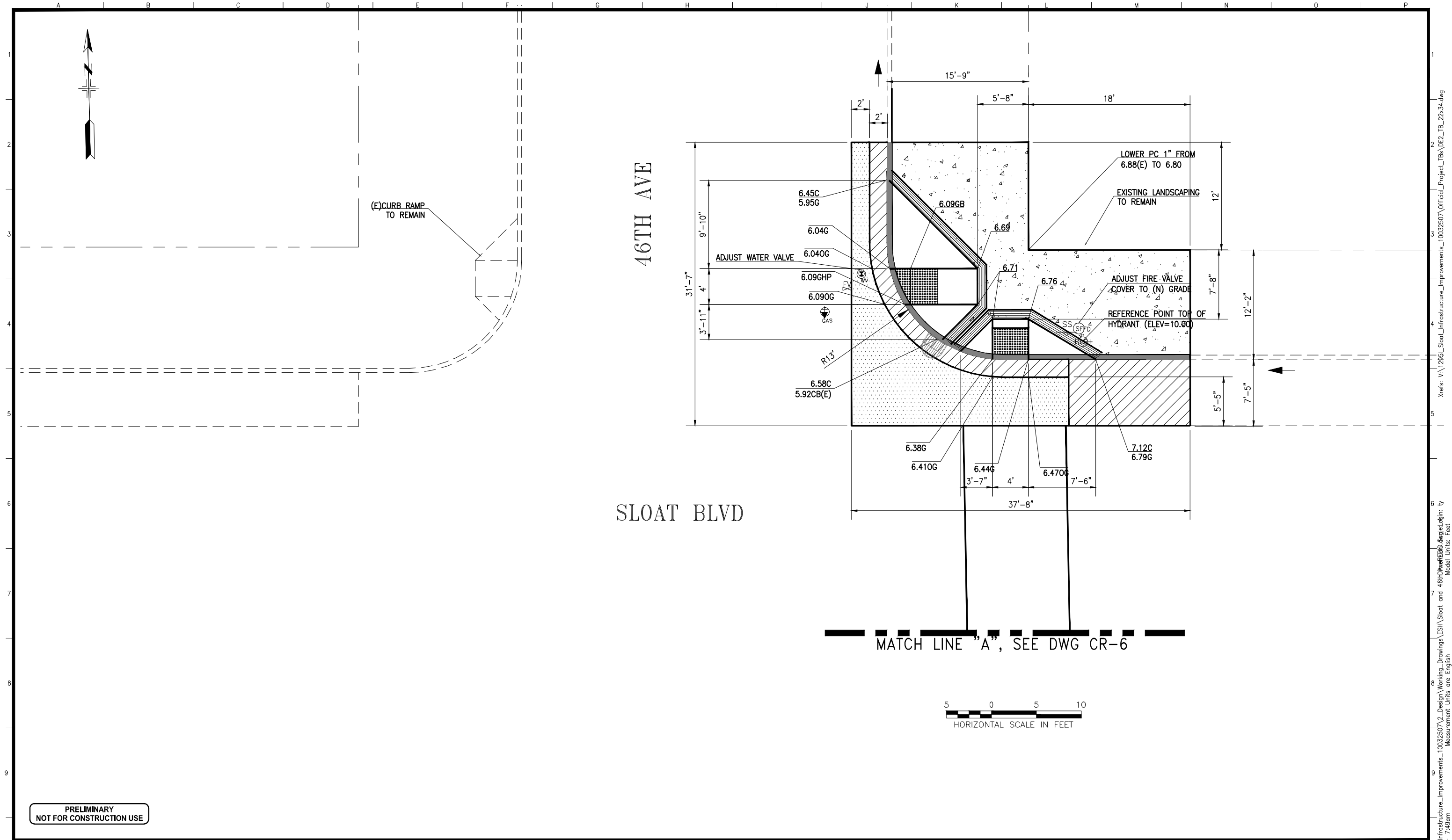

**PRELIMINARY  
NOT FOR CONSTRUCTION USE**

NO.	DATE	DESCRIPTION	BY	APP.
TABLE OF REVISIONS				
THIS DRAWING WAS LAST MODIFIED: 12/09/20 10:23, BY: ty				

REFERENCE INFORMATION  
& FILE NO. OF SURVEYS



**BUREAU OF ENGINEERING**  
CITY & COUNTY OF SAN FRANCISCO  
**SAN FRANCISCO PUBLIC WORKS**  
49 SOUTH VAN NESS AVENUE, SUITE 800  
SAN FRANCISCO, CA 94103

Acting Section Mgr:	ERIC KJELSBERG
Deputy Bureau Mgr:	FERNANDO CISNEROS
Acting Bureau Mgr:	IQBAL DHAPA

DESIGNED:	T.YILMAZ	DATE:	12/20
DRAWN:	M. BAUTISTA	DATE:	12/20
CHECKED:	R.CHIRCOP	DATE:	12/20



SCALE:  
1" = 5'  
SHEET OF SHEETS  
OF

**SLOAT INFRASTRUCTURE IMPROVEMENTS**  
**SLOAT BLVD AND 46TH AVENUE NORTH**  
**CURB RAMP DETAILS**

CONTRACT NO.	10037211
DRAWING NO.	CR-5
FILE NO.	XXXXXX
REV. NO.	

Xrefs: V:\12951\_Sloat\_Infrastructure\_Improvements\10032507\Official\_TBs\TB\_22x34.dwg  
 V:\12951\_Sloat\_Infrastructure\_Improvements\ES\12951\_Sloat\_Infrastructure\_Improvements.dwg  
 Model Units: Feet  
 Plot Time: Fri, 11 Dec 2020 - 7:49am

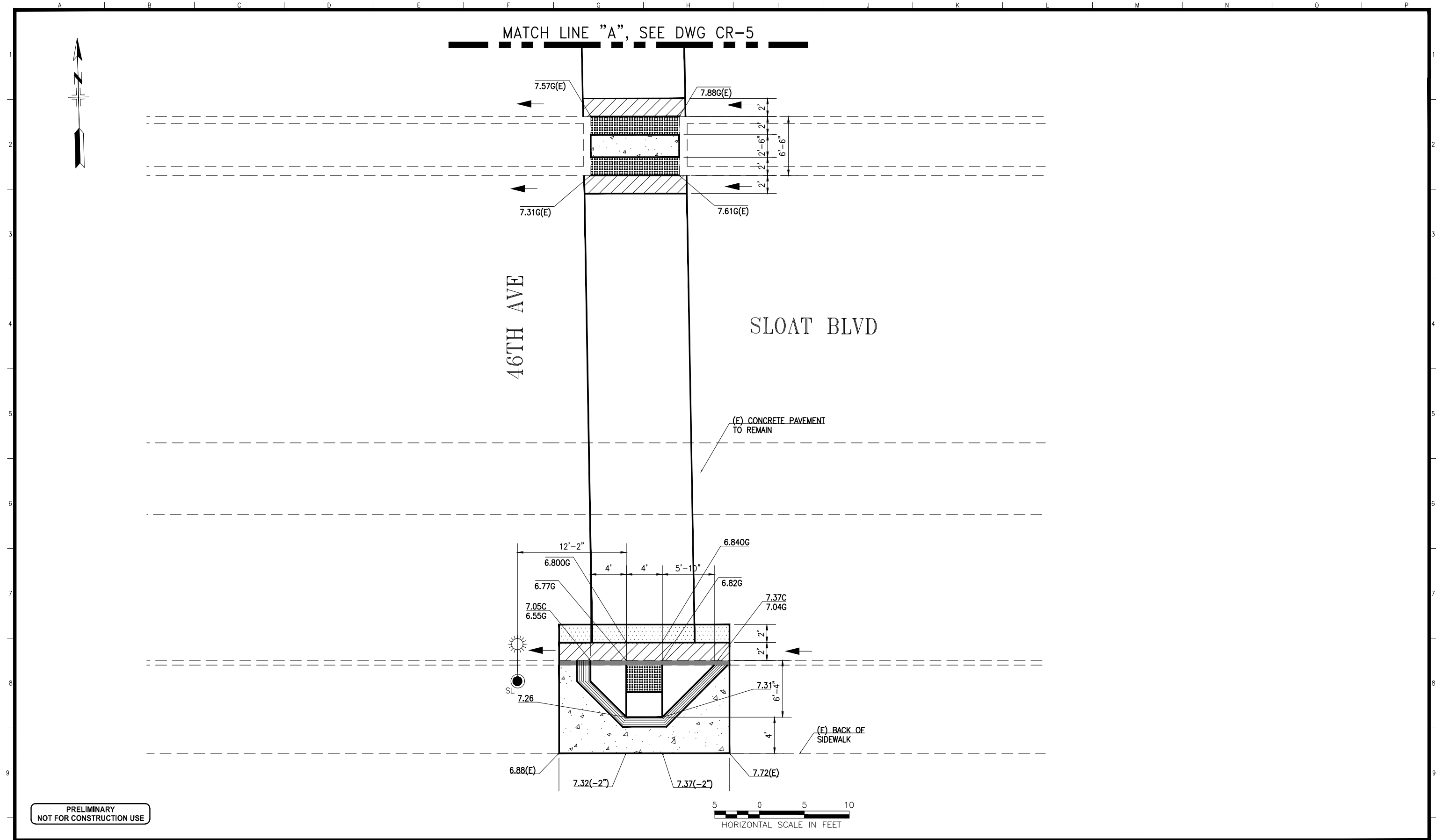

PRELIMINARY  
NOT FOR CONSTRUCTION USE



NO.	DATE	DESCRIPTION	BY	APP.
TABLE OF REVISIONS				
THIS DRAWING WAS LAST MODIFIED: 12/09/20 10:23, BY: ty				

REFERENCE INFORMATION  
& FILE NO. OF SURVEYS



**BUREAU OF ENGINEERING**  
CITY & COUNTY OF SAN FRANCISCO  
**SAN FRANCISCO PUBLIC WORKS**  
49 SOUTH VAN NESS AVENUE, SUITE 800  
SAN FRANCISCO, CA 94103

Date: \_\_\_\_\_  
Acting Section Mgr: ERIC KJELSBERG  
Deputy Bureau Mgr: FERNANDO CISNEROS  
Acting Bureau Mgr: IQBAL DHAPA

DESIGNED: DATE: T.YILMAZ 12/20  
DRAWN: DATE: M. BAUTISTA 12/20  
CHECKED: DATE: R.CHIRCOP 12/20



SCALE:  
1" = 5'  
SHEET OF SHEETS  
OF

SLOAT INFRASTRUCTURE IMPROVEMENTS  
SLOAT BLVD AND 46TH AVENUE SOUTH  
CURB RAMP DETAILS

CONTRACT NO. 10037211  
DRAWING NO. CR-6  
FILE NO. xxxxxx  
REV. NO.

Drawing Path: V:\12951\_Sloat\_Infrastructure\_Improvements\_10037211\Drawings\ESH\Sloat and 46th Avenue South\CR-6.dwg  
 Project: 10037211  
 Title: SLOAT BLVD AND 46TH AVENUE SOUTH CURB RAMP DETAILS  
 Date: 12/09/20  
 Author: ty  
 Model Units: Feet

# Maher Ordinance Screening Request

For a project to which you have been assigned as a Public Works project manager, complete the top of this form and submit to SAR, with plan showing the limits of excavation and of known Maher locations in the work area.

Project Name: \_\_\_\_\_ JO# \_\_\_\_\_ Date submitted: \_\_\_\_\_

Submitted by: \_\_\_\_\_ Date requested by (minimum of 20 working days): \_\_\_\_\_

Describe the general project scope, and give details of ground-disturbing activities:

Describe the project location(s). For work in parcels, provide street addresses. For work in the public right-of-way, provide street addresses for the beginning and ends of each street segment in which work will be done:

Estimated volume of excavated native material or earthen fill that the project will generate:  yd<sup>3</sup> Does the project require a building or grading permit from DBI? Yes  No

## FOR SITE ASSESSMENT & REMEDIATION USE

SA&R: Complete this section, initial, and forward to Project Manager and Regulatory Affairs Manager:

Date returned to PM: \_\_\_\_\_ Initial: \_\_\_\_\_ Date forwarded to RA: \_\_\_\_\_ Initial: \_\_\_\_\_

- Project does not meet excavation-volume threshold and/or intersect with a known Maher site. Maher does not apply.
- Project does not require a building or grading permit from the Department of Building Inspection. This includes all projects for the repair and replacement (“R&R”) of existing structures in the public right-of-way for end-of-life replacement and/or to address structural inadequacies found during regular inspection. Per Health Code §22A.3 and Building Code §106A.2.4, the Maher Ordinance does not apply.
- Project does not require a building or grading permit and Maher does not apply, but the project will require construction specifications for protection for workers and the public, and for hazardous-materials handling and disposal to meet state and federal regulatory requirements. Please budget an estimated \$ \_\_\_\_\_ for specification development.
- Project requires a building permit and/or grading permit and will bring to the surface 50 or more cubic yards of native material or earthen fill. A Maher application is required. Please budget an initial \$ \_\_\_\_\_ in SFPH fees. We anticipate that the following will also be required:
  - Site history (Phase I ESA).
  - Phase II / Phase II workplan.
    - With site mitigation plan.
    - With site mitigation report/ Environmental inspection.

Recommended by:

Signature

Print Name

Date

To complete this form, you will need the following information:

You will need to know that approximate total amount of excavated earth and earthen fill your project will bring to the surface, both permanent excavation and excavation that later will be backfilled. The key to whether or not activities add to your Maher total is whether or not the material brought up is earth or earthen fill -- roadway base, for example, does not count -- and whether or not it is brought to the surface -- pile driving does not count, but the spoils of holes drilled for piles will.

The easiest way to arrive at an approximate total is to classify excavations by type. For example, your project may have 12 pole footings, and two linear trenches. Each footing requires excavation of an area approximately 5' x 5' to a depth of 5'. There are 12 of these, so  $5' \times 5' \times 5' \times 12 = 1,500 \text{ ft}^3$ . For the trenches, one is 10' deep, 5' wide, and 40' long, and the other is 8' deep, 5' wide, and 20' long. This would be  $(10' \times 5' \times 40') + (8' \times 5' \times 20') = 2,800 \text{ ft}^3$ . Together, the total excavation for Maher is about 150 yd<sup>3</sup>, which would go over the 50 yd<sup>3</sup> limit that triggers Maher screening.

You'll need to provide a brief description of your project. Provide a general scope of your project (whether it is a streetscape project, a building-rehabilitation project, etc.) and provide details on the construction activities that will disturb the soil. For example, discuss the pole footings and the excavation that will accompany their construction. Provide identifiable project location(s). If your project is on a parcel, give the project address. If the project is in the public right-of-way, give, at a minimum, the street addresses at the beginning and end of each street segment. If the project is on a large public parcel (such as a park/open space), give enough information so that the location can clearly be identified.

You will need to provide mapping of your excavations with the Maher mapping overlain in order to facilitate SAR's presentation of your project information to San Francisco Public Health (SFPH), who oversee Maher compliance. Present the layers of your plans that contain the bulk of your excavation activities, and overlay the Maher Map. Maher mapping in GIS and DWG form can be found on the Public Works GIS server at \\dpwhyd1\boe5m\sfgGeology\MaherSitesAndBlocks. (You may have \\dpwhyd1\boe5m mapped as the K: drive.)

Email this mapping along with the filled-out (top section only) digital version of the PDF form to the Site Assessment and Remediation (SAR) section. SAR will respond (after a minimum of 20 working days) with an assessment of whether or not your project requires further action, and what this action will be.

**SAR: Robert Begley <robert.c.begley@sfdpw.org>**

**Regulatory Affairs: Boris Deunert <boris.deunert@sfdpw.org>**





Image capture: Aug 2014 © 2021 Google

San Francisco, California



Street View

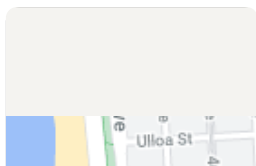

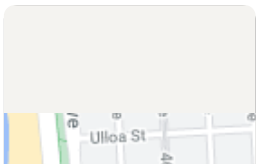

Image capture: Jun 2019 © 2021 Google

San Francisco, California



Street View





**CEQA EXEMPTION / NEPA CATEGORICAL EXCLUSION  
DETERMINATION FORM (rev. 11/2020)**

**Project Information**

**Project Name (if applicable):** Sloat Boulevard Infrastructure Improvements

**DIST-CO-RTE:** 04-SF-0-CR

**PM/PM:** N/A

**EA:** N/A

**Federal-Aid Project Number:** FERPL18-5934(186)

**Project Description**

San Francisco Public Works proposes to construct improvements on Sloat Boulevard at the intersections of 45<sup>th</sup> Avenue and 46<sup>th</sup> Avenue in the City of San Francisco. Project work includes: construction of new ADA-compliant curb ramps with concrete detectable warning tiles; grooved warning bands; 3.5' thick concrete sidewalk; combined 6' wide concrete curb and 2' wide concrete gutter; removal and replacement of concrete base around the curb return area; removal and replacement of 8" road base and 2" sub-base with 2" ACWS cover; removal and salvage/reset of granite curb; and resetting existing utility vaults and boxes with adjustments as needed. All work will occur within existing right of way.

**Caltrans CEQA Determination** (Check one)

- Not Applicable** – Caltrans is not the CEQA Lead Agency
- Not Applicable** – Caltrans has prepared an IS or EIR under CEQA

Based on an examination of this proposal and supporting information, the project is:

- Exempt by Statute.** (PRC 21080[b]; 14 CCR 15260 et seq.)
- Categorically Exempt. Class** Enter class. (PRC 21084; 14 CCR 15300 et seq.)
  - No exceptions apply that would bar the use of a categorical exemption (PRC 21084 and 14 CCR 15300.2). See the [SER Chapter 34](#) for exceptions.
- Covered by the Common Sense Exemption.** This project does not fall within an exempt class, but it can be seen with certainty that there is no possibility that the activity may have a significant effect on the environment (14 CCR 15061[b][3].)

**Senior Environmental Planner or Environmental Branch Chief**

Print Name	Signature	Date
------------	-----------	------

**Project Manager**

Print Name	Signature	Date
------------	-----------	------



CEQA EXEMPTION / NEPA CATEGORICAL EXCLUSION DETERMINATION FORM

Caltrans NEPA Determination (Check one)

Not Applicable

Caltrans has determined that this project has no significant impacts on the environment as defined by NEPA, and that there are no unusual circumstances as described in 23 CFR 771.117(b). See SER Chapter 30 for unusual circumstances. As such, the project is categorically excluded from the requirements to prepare an EA or EIS under NEPA and is included under the following:

23 USC 326: Caltrans has been assigned, and hereby certifies that it has carried out the responsibility to make this determination pursuant to 23 USC 326 and the Memorandum of Understanding dated April 18, 2019, executed between FHWA and Caltrans. Caltrans has determined that the project is a Categorical Exclusion under:

- 23 CFR 771.117(c): activity (c)(3)
23 CFR 771.117(d): activity (d)(Enter activity number)
Activity Enter activity number listed in Appendix A of the MOU between FHWA and Caltrans

23 USC 327: Based on an examination of this proposal and supporting information, Caltrans has determined that the project is a Categorical Exclusion under 23 USC 327. The environmental review, consultation, and any other actions required by applicable Federal environmental laws for this project are being, or have been, carried out by Caltrans pursuant to 23 USC 327 and the Memorandum of Understanding dated December 23, 2016 and executed by FHWA and Caltrans.

Senior Environmental Planner or Environmental Branch Chief

Tom Holstein
Signature: T. Holstein
Date: 12 May 2021

Project Manager/ DLA Engineer

Jimmy Panmai
Signature: Jimmy Panmai
Date: 5/12/2021

Date of Categorical Exclusion Checklist completion: 4/20/2021
Date of Environmental Commitment Record or equivalent: N/A

Briefly list environmental commitments on continuation sheet if needed (i.e., not necessary if included on an attached ECR). Reference additional information, as appropriate (e.g., additional studies and design conditions).



# CEQA EXEMPTION / NEPA CATEGORICAL EXCLUSION DETERMINATION FORM



London N. Breed  
Mayor

Alaric Degrafinried  
Acting Director

Patrick Rivera, PE  
Acting Bureau Manager

Bureau of Project Management  
49 South Van Ness, 7th Floor  
San Francisco, CA 94103

[sfpublicworks.org](http://sfpublicworks.org)  
[facebook.com/sfpublicworks](https://facebook.com/sfpublicworks)  
[twitter.com/sfpublicworks](https://twitter.com/sfpublicworks)

Mr. Dan Rivas  
Associate Environmental Planner  
Caltrans Office of Local Assistance, District 4  
dan.rivas@dot.ca.gov; 510-286-5743

Date: April 7, 2021

Regarding: San Francisco Public Works: FERPL18-5934(186)  
Sloat Infrastructure Improvement Project  
NEPA Clearance Mitigation Measures Letter

Dear Mr. Rivas,

We are writing to you regarding the Sloat Infrastructure Improvement Project, FERPL18-5934(186). This letter is our written commitment to include the following Standard Mitigation Measures in the project:

Check	Number	Mitigation
<b>Traffic</b>		
X	T4	There will be advance notification of construction work to the community and stakeholders in accordance with Local Agency procedures.
<b>Noise</b>		
X	N1	Construction activity will only occur during the Local Agency's allowable daytime construction hours.
X	N2	Construction activity will comply with Section 14-8 of the Caltrans Standard Specifications (Noise Control).
X	N3	Construction activity will comply with all applicable local noise ordinances and regulations.
<b>Water Quality</b>		
X	W1	Best Management Practices will be used to prevent construction-related debris entering drainage inlets or indirectly into any other water resources.
<b>Biology</b>		
X	B2	Tree protection fencing will be used to protect the trees that are not to be removed during construction
X	B5	All work will be contained within the existing paved area



## CEQA EXEMPTION / NEPA CATEGORICAL EXCLUSION DETERMINATION FORM

Archaeology		
X	A1	If cultural materials are discovered during construction, work shall be halted in that area until a qualified archaeologist has assessed the potential discovery and determined the need for further action.
Equipment Staging		
X	E1	Equipment staging will be left to the contractor. The specifications will require the following: <ul style="list-style-type: none"><li>• The staging area will be located on an existing asphalt or concrete surface area. Excavation below the asphalt or concrete will not be permitted.</li><li>• The staging area will be included in any SWPPP or WPCP prepared for the project.</li><li>• The staging area will not be located adjacent to environmentally or culturally sensitive areas (eg wildlife sites, wetlands, archaeological sites).</li><li>• The staging area will not be located in a regulatory floodway or within the base floodplain (100-year).</li><li>• The staging area will not affect access to properties or roadways.</li></ul>

The above measures will be added to the construction contract. We appreciate your assistance on this project. Please feel free to call me at (415) 554-8258 or by email at [edmund.lee@sfdpw.org](mailto:edmund.lee@sfdpw.org).

Sincerely,

Edmund Lee  
San Francisco Public Works  
Project Manager