

NOTES:

1. ALL DISTANCES ARE MEASURED IN FEET AND DECIMAL FEET.
2. ALL ANGLES ARE 90 DEGREES UNLESS OTHERWISE NOTED.
3. PROPERTY AND RIGHT-OF-WAY LINES SHOWN HEREON ARE BASED ON RECORD DATA AND NOT INTENDED TO BE A DETAILED FINAL SURVEY OF THE PROPERTY. BOUNDARY INFORMATION SHOWN HEREON IS FOR PLANNING PURPOSES ONLY.

{ } = RECORD/FILED INFORMATION SUCH AS STREET WIDTHS, DEED OR MAP INFORMATION SHOWN FOR REFERENCE.

THE ELEVATIONS SHOWN ON THIS SURVEY ARE BASED ON CITY OF SAN FRANCISCO DATUM. THE BENCH MARK FOR THIS SURVEY IS THE "+" CUT FOUND ON THE STORM WATER INLET AT THE SOUTHWEST CORNER OF FELL STREET AND WEBSTER STREET. ELEVATION = 154.245 FEET

LEGEND/REFERENCES

- O.R. = OFFICIAL RECORDS OF THE CITY AND COUNTY OF SAN FRANCISCO, CALIFORNIA
- R1 = THAT DEED RECORDED ON AUGUST 1, 2012 ON REEL K701 O.R., AT IMAGE 0662
- R2 = THAT PARCEL MAP FILED ON FEBRUARY 3, 2009 IN BOOK 47 OF PARCEL MAPS, O.R., AT PAGES 181-182
- R3 = THAT DEED RECORDED ON AUGUST 22, 2007 ON REEL J460 O.R., AT IMAGE 0152

SURVEYOR'S STATEMENT:

THIS MAP WAS PREPARED BY ME, OR UNDER MY DIRECTION, AND IS BASED UPON A FIELD SURVEY PERFORMED IN MARCH OF 2013.

DATE: MARCH 24, 2013

Richard L. Langford
 RICHARD L. LANGFORD, PLS 6895
 LICENSE EXPIRATION DATE: JUNE 30, 2013

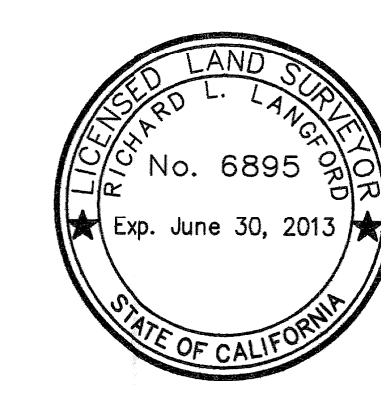

TENTATIVE PARCEL MAP 7534

A SUBDIVISION OF THE REAL PROPERTY DESCRIBED IN THE DEED RECORDED AUGUST 1, 2012, ON REEL K701 AT IMAGE 0662 IN THE OFFICIAL RECORDS OF THE CITY AND COUNTY OF SAN FRANCISCO, STATE OF CALIFORNIA
 MARCH 2013

ASSESSOR'S BLOCK 829
 WESTERN ADDITION BLOCK 287

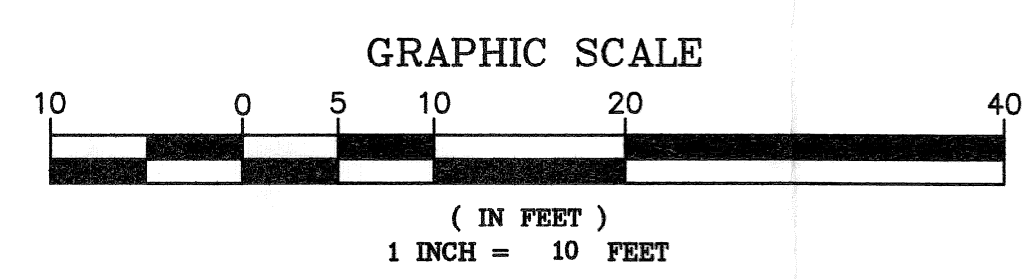

LANGFORD LAND SURVEYING
 424 PRESTON COURT
 LIVERMORE, CA 94551
 PHONE (510) 530-5200
 JOB#13-2400 DRAWING=2400FELL.DWG

Office Copy