

**LEGEND**

- (E) EXISTING FEATURE DIMENSION
- P.O.B. POINT OF BEGINNING (SEE SHEET 4 FOR MAP CLOSURE INFO)
- PROPOSED CURB LINE
- EXISTING CURB LINE TO REMAIN
- EXISTING CURB LINE TO BE REMOVED
- RIGHT-OF-WAY LINE

\*DRIVEWAY LOCATIONS AND WIDTHS ARE APPROXIMATE.

REFERENCES:

APPROVED:

BRUCE R. STORRS  
CITY & COUNTY SURVEYOR

5/16/13

DATE

BY

DATE

DRW

CK

APP

**CITY AND COUNTY OF SAN FRANCISCO**  
DEPARTMENT OF PUBLIC WORKS

OFFICIAL SIDEWALK CHANGE ON THE SOUTH SIDE OF CESAR CHAVEZ STREET  
BETWEEN GUERRERO STREET AND VALENCIA STREET

SCALE:  
1" = 40'

SHEET  
1 OF 4

FILE

Q-20-701

CHANGE

CALIFORNIA PACIFIC MEDICAL CENTER  
SAINT LUKE'S CAMPUS

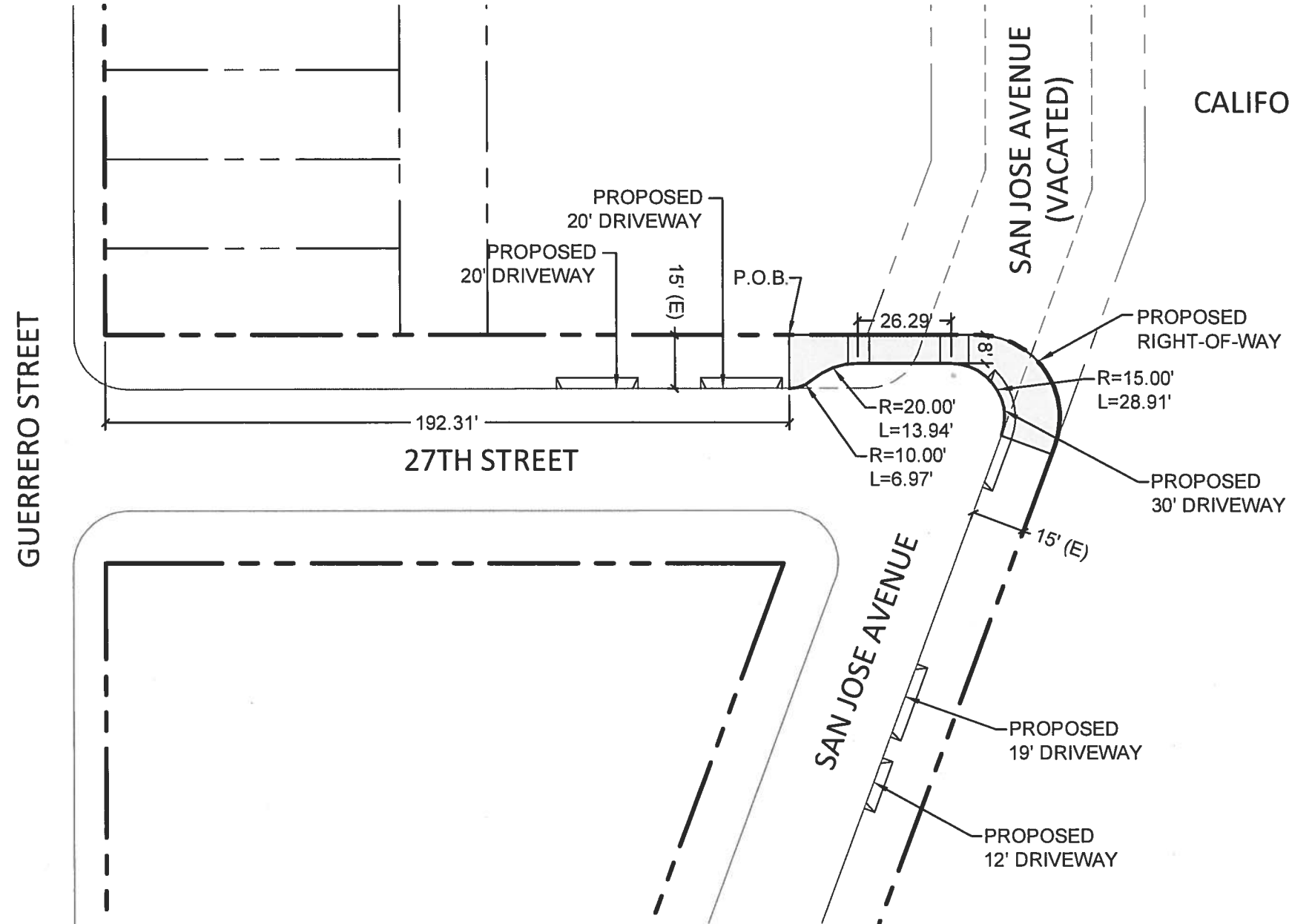

**LEGEND**

- (E) EXISTING FEATURE DIMENSION
- P.O.B. POINT OF BEGINNING (SEE SHEET 4 FOR MAP CLOSURE INFO)
- PROPOSED CURB LINE
- EXISTING CURB LINE TO REMAIN
- EXISTING CURB LINE TO BE REMOVED
- RIGHT-OF-WAY LINE

\*DRIVEWAY LOCATIONS AND WIDTHS ARE APPROXIMATE.

REFERENCES:

APPROVED:

BRUCE R. STORRS  
CITY & COUNTY SURVEYOR

5/16/13

DATE

BY

DATE

DRW

CK

APP

**CITY AND COUNTY OF SAN FRANCISCO**  
DEPARTMENT OF PUBLIC WORKS

OFFICIAL SIDEWALK CHANGE ON THE NORTH SIDE OF 27TH STREET  
AT THE INTERSECTION WITH SAN JOSE AVENUE

SCALE:  
1" = 40'

SHEET  
2 OF 4

FILE

Q-20-701

CHANGE



VALENCIA STREET

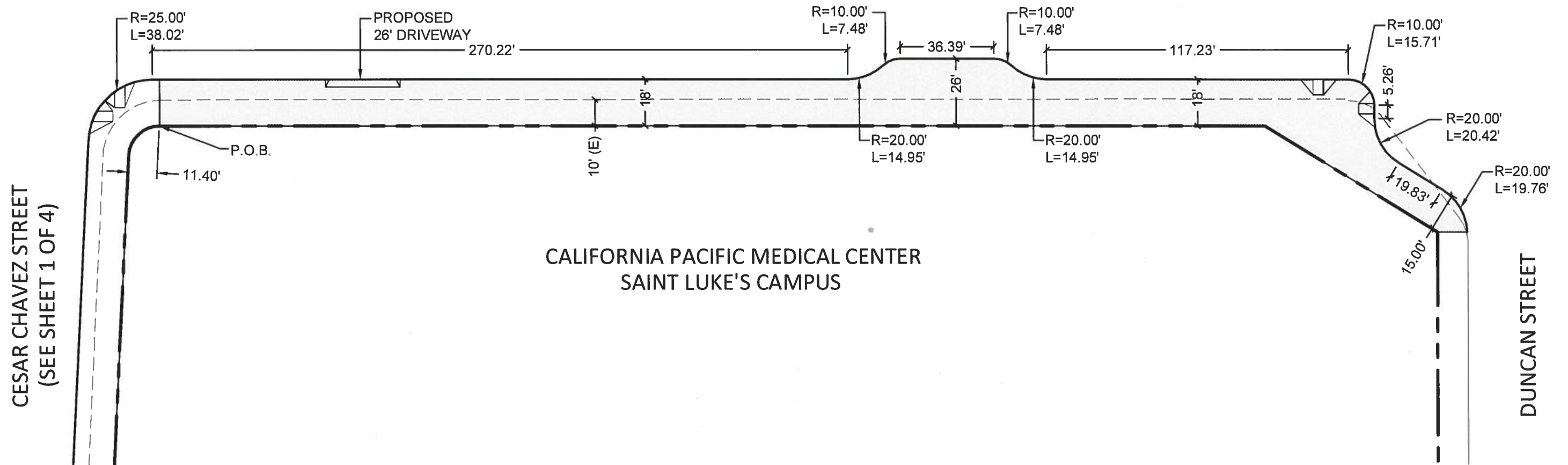

CALIFORNIA PACIFIC MEDICAL CENTER  
SAINT LUKE'S CAMPUS

CESAR CHAVEZ STREET  
(SEE SHEET 1 OF 4)

DUNCAN STREET

LEGEND

- (E) EXISTING FEATURE DIMENSION
- P.O.B. POINT OF BEGINNING (SEE SHEET 4 FOR MAP CLOSURE INFO)
- PROPOSED CURB LINE
- EXISTING CURB LINE TO REMAIN
- - - EXISTING CURB LINE TO BE REMOVED
- - - RIGHT-OF-WAY LINE

\*DRIVEWAY LOCATIONS AND WIDTHS ARE APPROXIMATE.

REFERENCES:

APPROVED:

BRUCE R. STORRS  
CITY & COUNTY SURVEYOR

5/16/13

DATE

BY

DATE

DRW

CK

APP

CITY AND COUNTY OF SAN FRANCISCO  
DEPARTMENT OF PUBLIC WORKS

OFFICIAL SIDEWALK CHANGE ON THE WEST SIDE OF VALENCIA STREET  
BETWEEN CESAR CHAVEZ STREET AND DUNCAN STREET

SCALE:  
1" = 40'

SHEET  
3 OF 4

FILE

Q-20-701

CHANGE

MAP CHECK CLOSURE FOR: CESAR CHAVEZ STREET  
TOTAL # OF COURSES: 18

COURSE #1	DELTA: 90°00'00"	ARC LENGTH: 31.42'	RADIUS: 20.00'
COURSE #2	BEARING: N 85°39'47" E	LENGTH: 269.49'	
COURSE #3	BEARING: N 88°31'21" E	LENGTH: 241.91'	
COURSE #4	DELTA: 87°08'26"	ARC LENGTH: 18.25'	RADIUS: 12.00'
COURSE #5	BEARING: N 85°39'47" E	LENGTH: 18.00'	
COURSE #6	BEARING: N 04°20'13" W	LENGTH: 2.75'	
COURSE #7	DELTA: 87°08'26"	ARC LENGTH: 38.02'	RADIUS: 25.00'
COURSE #8	BEARING: S 88°31'21" W	LENGTH: 175.44'	
COURSE #9	DELTA: 36°52'11"	ARC LENGTH: 6.43'	RADIUS: 10.00'
COURSE #10	DELTA: 36°52'11"	ARC LENGTH: 12.87'	RADIUS: 20.00'
COURSE #11	BEARING: S 88°31'21" W	LENGTH: 53.57'	
COURSE #12	BEARING: S 85°39'47" W	LENGTH: 115.03'	
COURSE #13	DELTA: 36°52'12"	ARC LENGTH: 12.87'	RADIUS: 20.00'
COURSE #14	DELTA: 36°52'14"	ARC LENGTH: 6.44'	RADIUS: 10.00'
COURSE #15	BEARING: S 85°39'47" W	LENGTH: 147.71'	
COURSE #16	DELTA: 90°00'00"	ARC LENGTH: 28.27'	RADIUS: 18.00'
COURSE #17	BEARING: S 04°20'13" E	LENGTH: 18.00'	
COURSE #18	BEARING: N 85°39'47" E	LENGTH: 9.00'	

PERIMETER: 1205.48' AREA: 8,286 SF, 0.19 AC.  
ERROR OF CLOSURE: S 56°42'58" E 0.0070'  
PRECISION 1 IN 172,210.00

MAP CHECK CLOSURE FOR: 27TH STREET  
TOTAL # OF COURSES: 9

COURSE #1	BEARING: N 85°39'47" E	LENGTH: 53.02'	
COURSE #2	DELTA: 110°25'27"	ARC LENGTH: 44.33'	RADIUS: 23.00'
COURSE #3	BEARING: S 16°05'14" W	LENGTH: 2.61'	
COURSE #4	BEARING: N 73°54'-46" W	LENGTH: 15.00'	
COURSE #5	DELTA: 110°25'27"	ARC LENGTH: 28.91'	RADIUS: 15.00'
COURSE #6	BEARING: S 85°39'47" W	LENGTH: 26.29'	
COURSE #7	DELTA: 39°56'40"	ARC LENGTH: 13.94'	RADIUS: 20.00'
COURSE #8	DELTA: 39°56'40"	ARC LENGTH: 6.97'	RADIUS: 10.00'
COURSE #9	BEARING: N 04°20'13" W	LENGTH: 15.00'	

PERIMETER: 206.07' AREA: 957 SF, 0.02 AC.  
ERROR OF CLOSURE: S 29°19'44" W 0.0038'  
PRECISION: 1 IN 54,228.95

MAP CHECK CLOSURE FOR: VALENCIA STREET  
TOTAL # OF COURSES: 16

COURSE #1	BEARING: N 04°20'13" W	LENGTH: 429.40'	
COURSE #2	BEARING: N 27°10'18" E	LENGTH: 78.59'	
COURSE #3	BEARING: N 04°20'13" W	LENGTH: 11.49'	
COURSE #4	DELTA: 56°37'02"	ARC LENGTH: 19.76'	RADIUS: 20.00'
COURSE #5	BEARING: S 27°10'18" W	LENGTH: 19.83'	
COURSE #6	DELTA: 58°29'29"	ARC LENGTH: 20.42'	RADIUS: 20.00'
COURSE #7	BEARING: S 85°39'47" W	LENGTH: 5.26'	
COURSE #8	DELTA: 90°00'00"	ARC LENGTH: 15.71'	RADIUS: 10.00'
COURSE #9	BEARING: N 04°20'13" W	LENGTH: 117.25'	
COURSE #10	DELTA: 42°50'00"	ARC LENGTH: 14.95'	RADIUS: 20.00'
COURSE #11	DELTA: 42°50'00"	ARC LENGTH: 7.48'	RADIUS: 10.00'
COURSE #12	BEARING: S 04°20'13" E	LENGTH: 36.39'	
COURSE #13	DELTA: 42°50'00"	ARC LENGTH: 7.48'	RADIUS: 10.00'
COURSE #14	DELTA: 42°50'00"	ARC LENGTH: 14.95'	RADIUS: 20.00'
COURSE #15	BEARING: S 04°20'13" E	LENGTH: 267.46'	
COURSE #16	BEARING: S 85°39'47" W	LENGTH: 18.00'	

PERIMETER: 1084.42 AREA: 10,053 SQ FT 0.23 AC.  
ERROR OF CLOSURE: S 02°12'32" W 0.0103'  
PRECISION: 1 IN 105,283.50

\*DRIVEWAY LOCATIONS AND WIDTHS ARE APPROXIMATE.

**LEGEND**

- (E) EXISTING FEATURE DIMENSION
- P.O.B. POINT OF BEGINNING (SEE SHEET 4 FOR MAP CLOSURE INFO)
- PROPOSED CURB LINE
- EXISTING CURB LINE TO REMAIN
- - - - - EXISTING CURB LINE TO BE REMOVED
- RIGHT-OF-WAY LINE

REFERENCES:

APPROVED:

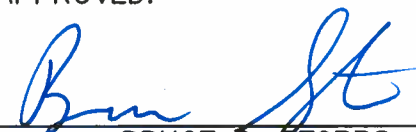

BRUCE R. STORRS  
CITY & COUNTY SURVEYOR

5/16/13

DATE

BY

DATE

DRW

CK

APP

CITY AND COUNTY OF SAN FRANCISCO  
DEPARTMENT OF PUBLIC WORKS

SIDEWALK LEGISLATION - SIDEWALK MAP CHECK CLOSURES

SCALE:  
1" = 40'

SHEET  
4 OF 4

FILE

Q-20-701

CHANGE