

File No. 131167

Committee Item No. 1

Board Item No. _____

COMMITTEE/BOARD OF SUPERVISORS

AGENDA PACKET CONTENTS LIST

Committee: Neighborhood Services & Safety Date February 6, 2014

Board of Supervisors Meeting Date _____

Cmte Board

- | | | |
|-------------------------------------|--------------------------|--|
| <input type="checkbox"/> | <input type="checkbox"/> | Motion |
| <input type="checkbox"/> | <input type="checkbox"/> | Resolution |
| <input type="checkbox"/> | <input type="checkbox"/> | Ordinance |
| <input type="checkbox"/> | <input type="checkbox"/> | Legislative Digest |
| <input type="checkbox"/> | <input type="checkbox"/> | Budget and Legislative Analyst Report |
| <input type="checkbox"/> | <input type="checkbox"/> | Legislative Analyst Report |
| <input type="checkbox"/> | <input type="checkbox"/> | Youth Commission Report |
| <input type="checkbox"/> | <input type="checkbox"/> | Introduction Form (for hearings) |
| <input checked="" type="checkbox"/> | <input type="checkbox"/> | Department/Agency Cover Letter and/or Report |
| <input type="checkbox"/> | <input type="checkbox"/> | MOU |
| <input type="checkbox"/> | <input type="checkbox"/> | Grant Information Form |
| <input type="checkbox"/> | <input type="checkbox"/> | Grant Budget |
| <input type="checkbox"/> | <input type="checkbox"/> | Subcontract Budget |
| <input type="checkbox"/> | <input type="checkbox"/> | Contract/Agreement |
| <input type="checkbox"/> | <input type="checkbox"/> | Form 126 – Ethics Commission |
| <input type="checkbox"/> | <input type="checkbox"/> | Award Letter |
| <input checked="" type="checkbox"/> | <input type="checkbox"/> | Application |
| <input type="checkbox"/> | <input type="checkbox"/> | Public Correspondence |

OTHER (Use back side if additional space is needed)

<input type="checkbox"/>	<input type="checkbox"/>	_____
<input type="checkbox"/>	<input type="checkbox"/>	_____
<input type="checkbox"/>	<input type="checkbox"/>	_____
<input type="checkbox"/>	<input type="checkbox"/>	_____
<input type="checkbox"/>	<input type="checkbox"/>	_____
<input type="checkbox"/>	<input type="checkbox"/>	_____
<input type="checkbox"/>	<input type="checkbox"/>	_____
<input type="checkbox"/>	<input type="checkbox"/>	_____
<input type="checkbox"/>	<input type="checkbox"/>	_____
<input type="checkbox"/>	<input type="checkbox"/>	_____

Completed by: Derek Evans Date 1/31/14

Completed by: _____ Date _____

An asterisked item represents the cover sheet to a document that exceeds 25 pages.
The complete document can be found in the file.



San Francisco Police Department
ABC Liaison Unit



Alcoholic Beverage License -
*Public Convenience and
Necessity Recommendation*

To: The San Francisco Board of Supervisors' Committee on City
Operations & Neighborhood Services

Supervisor David Campos
Supervisor Eric Mar
Supervisor Norman Yee

From: Officer Alberto Duarte
ABC Liaison Unit (ALU) 553-1049

Date: December 18, 2013

Subject: P.C.N. Investigation Regarding: Liz Zaninovich
DBA: BevMo!
1301 Van Ness Ave
(925) 609-6153

Liz Zaninovich representing, BevMo!, has filed an application with the California Department of Alcoholic Beverage Control seeking the expansion of 1301 Van Ness Avenue. The premise already exists and it's only move is to create a larger store by taking over its neighboring empty storefront. This location has a Type 42 (On-Sale Public Premise) license and Type 21 (Off-Sale General), they are currently conditioned by PCN file #060287 passed by resolution # 352-06 dated June 13, 2006.

It should be noted that during the application process, notification date for the 500⁺ mailer has been sent out as of November 18, 2013. The Notice to the Public was posted on November 7, 2013.

For the purposes of this hearing, the California Department of Alcoholic Beverage Control (ABC) seeks a determination from the Board of Supervisors as to the approval or denial of this license.

Police Calls for Service: From September 2012 to September 2013

17 Police calls

Police Reports: From September 2012 to September 2013
2 Report

San Francisco Plot Information:

This premise is located in Plot **541**

The High Crime area is defined as 86 or more police reports in a plot.

This plot had **471** police reports recorded for 2012.

Applicant's premises is located in a "High Crime" area.

State Census Tract Information:

This premise is located in Census Tract **151**

Population for this tract is: **2,493**

On-sale license authorized by census tract: **8**

Active on-sale licenses: **14**

Off-sale licenses authorized by census tract: **2**

Active off-sale licenses: **5**

Applicant's premise is **currently** located in an "undue concentrated" area. However, this is not a new license. It's has been in existence since 2006.

Letters of Protest:

As of **November 19, 2013** no letters of protest have been received by the California Department of Alcoholic Beverage Control, (ABC).

Letters of Support:

None recorded with the California Department of Alcoholic Beverage Control, (ABC).

Departmental Recommendation:

Northern Police Station has given *approval with the existing conditions*.

We've been in communication with Supervisors Farrell's Office and they are in support of the expansion.

The ALU recommends **approval with the current conditions** passed on June 13, 2006.

export To **New!**

Records 1 through 7 of 7

Call No	Report No	Received Date	Received Time	Priority	Call Type	Unit ID	Disposition	Location
<u>131170861</u>		04/27/2013	08:55:40	B	917	3E5A	DUP	1301 VAN NESS AV
<u>130970440</u>		04/07/2013	02:58:55	B	100A	3E13E	NCR	1301 VAN NESS AV
<u>130723139</u>		03/13/2013	20:13:30	A	488	3E13D	HAN	1301 VAN NESS AV
<u>130620763</u>		03/03/2013	07:55:16	B	100A	3E2A	NCR	1301 VAN NESS AV
<u>130280266</u>		01/28/2013	03:35:32	B	100A	3E13E	PAS	1301 VAN NESS AV
<u>130250671</u>	130069526	01/25/2013	08:21:36	C	470	3E13A	REP	1301 VAN NESS AV
<u>130051540</u>		01/05/2013	14:11:39	C	601	3E3A	HAN	1301 VAN NESS AV

End of document

export To  **New!**Records **1** through **10** of **10**

Call No	Report No	Received Date	Received Time	Priority	Call Type	Unit ID	Disposition	Location
<u>132991653</u>		10/26/2013	13:36:14	B	601	3E48	HAN	1301 VAN NESS AV
<u>132790972</u>		10/06/2013	08:59:18	B	100A	3E4A	NOM	1301 VAN NESS AV
<u>132773214</u>		10/04/2013	18:45:46	C	601			1301 VAN NESS AV
<u>132313107</u>		08/19/2013	21:00:20	B	601	3E14D	HAN	1301 VAN NESS AV
<u>132300790</u>		08/18/2013	07:56:28	B	100S	3E4A	NCR	1301 VAN NESS AV
<u>132253011</u>		08/13/2013	19:55:51	B	488	3E13D	GOA	1301 VAN NESS AV
<u>132121985</u>		07/31/2013	14:43:01	B	601	3E12C	GOA	1301 VAN NESS AV
<u>132101058</u>	130623843	07/29/2013	10:33:08	B	240	3E11A	REP	1301 VAN NESS AV
<u>132062195</u>		07/25/2013	16:31:49	A	800	3E13D	HAN	1301 VAN NESS AV
<u>131770383</u>		06/26/2013	05:47:31	B	100S	3E4A	NCR	1301 VAN NESS AV

End of document

LIQUOR LICENSE REVIEW

TO: Planning Department
AnMarie Rodgers/CTYPLN/SFGOV
Georgia Powell/CTYPLN/SFGOV@sfgov
Fax No.: 558-6409

File: 131167

TO: Police Department
Officer Alberto Duarte
Inspector Darcy Keller
Fax No.: 553-1463

DATE: November 12, 2013

Block/Lot: 0671/002
Zoning: RC-4
Quad: NW
RMB # 1301817

This item is tentatively scheduled to be heard in four to six weeks.

PLEASE EMAIL YOUR RESPONSE BY: December 24, 2013, to Derek Evans,
Clerk, Neighborhood Services and Safety Committee.

Derek.Evans@sfgov.org - Fax No: 554-7714

Applicant Name: Liz Zaninovich
and Business Name: BevMo!
(1301 Van Ness Avenue)

Applicant Address: 1401 Willow Pas Rd. Suite 900
Concord, CA
and Phone No. (925) 609-6153

PLANNING COMMENTS: Approval Denial

ABC license Types 21 and 42 previously
approved by Planning Dept. on 11/22/2013 per
Planning Resolution (attached) case No. 2013.0530 C.
All conditions shall be observed.

POLICE COMMENTS: Approval Denial

A. Kirby
12/11/13

BevMo!

1401 Willow Pass Rd., Suite 900 • Concord, California 94520 • T 925.609.6074 • F 925.798.7150 • www.bevmo.com

VIA FEDERAL EXPRESS

November 21, 2013

Attn: Clerk of the Board
San Francisco Board of Supervisors
1 Dr. Carlton B. Goodlett Place, Room 244
San Francisco, CA 94102

**RE: Beverages & More, Inc. – 1301 Van Ness Ave., San Francisco, CA
Request for Public Convenience or Necessity Resolution**

Dear Clerk of the Board:

Since 2006, Beverages & More, Inc. (BevMo!) has operated a 10,000 square foot retail store at 1301 Van Ness Avenue. The Board of Supervisors previously approved a Resolution for Public Convenience or Necessity (enclosed) for this location for both our off-premises (Type 21) and on-premises (Type 42) licenses. BevMo! recently exercised an option to lease the vacant space adjacent to the existing BevMo! store and the Planning Department unanimously approved our Conditional Use Permit for this expansion on August 8, 2013 (Case # 2013.0530C, approval enclosed).

BevMo! is now in the process of updating existing liquor licenses with the Department of Alcoholic Beverage Control (ABC). Due to the expansion of the premises, the ABC, in its discretion, has deemed a premises-to-premises transfer of our existing licenses is required. There will be no actual increase in the number of on- or off-premises licenses in the census tract. This premises-to-premises transfer is what triggers the requirement for a Public Convenience or Necessity (PCN) approval. In addition to the premises-to-premises transfer of our existing licenses, BevMo! has also made application for a Type 86 (Instructional Tasting) license, this license type does not require PCN approval.

Applicant Information

Contact Information: Liz Zaninovich 925-609-6153

Business Name: Beverages & More, Inc. (BevMo!)

License Types Applied For: Type 21, 42, and 86 (only licenses requiring PCN approval are Type 21 and 42)

Business Address: 1301 Van Ness Avenue, San Francisco, CA

Transfer Premises Address: 1301 Van Ness Ave., San Francisco, CA (PCN required due to expansion)

Mailing Address: 1401 Willow Pass Rd. Suite 900 Concord, CA

Hours of Operation: Monday-Friday from 10:00a.m. to 9:00p.m., Saturday from 9:00a.m. to 9:00p.m., and Sunday from 10:00a.m. to 7:00p.m., except during the holiday period when hours of operation may increase by one hour in the morning and evening hours. No change to the existing hours of operation are proposed.

BevMo!

1401 Willow Pass Rd., Suite 900 • Concord, California 94520 • T 925.609.6074 • F 925.798.7150 • www.bevmo.com

Summary of Outreach Efforts

As part of the Conditional Use Permit process, BevMo! conducted outreach with the community, including the following:

April 9th, 2013: Held a pre-application meeting open to neighbors. This meeting was noticed twice (using the planning departments notice list): once on March 22nd and again on April 5th. Only two people from the community attended the meeting and they were both supportive of the project.

April 14th, 2013: Having received our notice for the April 9th meeting, the Alliance for a Better District 6 invited BevMo! to attend their monthly community meeting. Liz Zaninovich (licensing specialist for BevMo!) and Julia Wan (project manager, MCG Architecture) attended. Alliance for a Better District 6 wrote a letter of support for the project (enclosed).

August 8th, 2013: BevMo! met with representatives from Middle Polk, Cathedral Hill, and Lower Polk neighborhood associations, as well as Supervisor Chiu, on the morning of the Planning Commission hearing. The meeting was held at the store and BevMo! representatives walked community members through the store to explain what the project would entail. As a result, BevMo! was able to answer the questions posed by these groups and the groups voiced no opposition to the project.

August 12th, 2013: Ms. Zaninovich presented information about the expansion of the store to the Community Leadership Alliance.

October 23rd, 2013: Ms. Zaninovich attended an additional Community Leadership Alliance meeting to update the group on the progress of the project.

November 12th 2013: Ms. Zaninovich attend an additional Alliance for a Better District 6 meeting to update the group on the progress of the project.

BevMo! representatives will continue to reach out to other neighborhood associations, including Lower Polk, Middle Polk, and Cathedral Hill to update the groups on the status of the project.

Please contact me at the number listed below if you have any questions.

Sincerely,

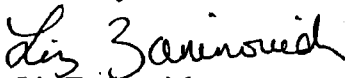

Liz Zaninovich

Licensing and Permit Entitlement Specialist

zaninoviche@bevmo.com

925-609-6153

BevMo!

1401 Willow Pass Rd., Suite 900 • Concord, California 94520 • T 925.609.6074 • F 925.798.7150 • www.bevmo.com

VIA FEDERAL EXPRESS

November 21, 2013

Attn: Clerk of the Board
San Francisco Board of Supervisors
1 Dr. Carlton B. Goodlett Place, Room 244
San Francisco, CA 94102

**RE: Beverages & More, Inc. – 1301 Van Ness Ave., San Francisco, CA
Request for Public Convenience or Necessity Resolution**

Dear Clerk of the Board:

Beverages & More, Inc (BevMo!) is in the process of updating existing liquor licenses with the Department of Alcoholic Beverage Control (ABC). Due to the expansion of the premises, the ABC, in its discretion, has deemed a premises-to-premises transfer of our existing licenses is required. There will be no actual increase in the number of on- or off-premises licenses in the census tract. This premises-to-premises transfer is what triggers the requirement for a Public Convenience or Necessity (PCN) approval.

Enclosed please find the following application materials related to this request:

- 1) Letter Requesting PCN for expanded premises
- 2) ABC Form 257 Licensed Premises Diagram (Retail)
- 3) Original PCN Board of Supervisors approval for this location
- 4) Planning Commission Approval of expansion—Notice of Special Restrictions
- 5) ABC Form 245 Information and Instructions – Section 23958.4 B& P

Please contact me at the number listed below if you have any questions.

Sincerely,



Liz Zaninovich

Licensing and Permit Entitlement Specialist

zaninovich@bevmo.com

925-609-6153

RECEIVED
BOARD OF SUPERVISORS
SAN FRANCISCO
2013 NOV 22 AM 10:32
AK



1401 Willow Pass Rd., Suite 900 • Concord, California 94520 • T 925.609.6074 • F 925.798.7150 • www.bevmo.com

VIA FEDERAL EXPRESS

November 21, 2013

Attn: Clerk of the Board
San Francisco Board of Supervisors
1 Dr. Carlton B. Goodlett Place, Room 244
San Francisco, CA 94102

**RE: Beverages & More, Inc. – 1301 Van Ness Ave., San Francisco, CA
Request for Public Convenience or Necessity Resolution**

Dear Clerk of the Board:

Since 2006, Beverages & More, Inc. (BevMo!) has operated a 10,000 square foot retail store at 1301 Van Ness Avenue. The Board of Supervisors previously approved a Resolution for Public Convenience or Necessity (enclosed) for this location for both our off-premises (Type 21) and on-premises (Type 42) licenses. BevMo! recently exercised an option to lease the vacant space adjacent to the existing BevMo! store and the Planning Department unanimously approved our Conditional Use Permit for this expansion on August 8, 2013 (Case # 2013.0530C, approval enclosed).

BevMo! is now in the process of updating existing liquor licenses with the Department of Alcoholic Beverage Control (ABC). Due to the expansion of the premises, the ABC, in its discretion, has deemed a premises-to-premises transfer of our existing licenses is required. There will be no actual increase in the number of on- or off-premises licenses in the census tract. This premises-to-premises transfer is what triggers the requirement for a Public Convenience or Necessity (PCN) approval. In addition to the premises-to-premises transfer of our existing licenses, BevMo! has also made application for a Type 86 (Instructional Tasting) license, this license type does not require PCN approval.

Applicant Information

Contact Information: Liz Zaninovich 925-609-6153

Business Name: Beverages & More, Inc. (BevMo!)

License Types Applied For: Type 21, 42, and 86 (only licenses requiring PCN approval are Type 21 and 42)

Business Address: 1301 Van Ness Avenue, San Francisco, CA

Transfer Premises Address: 1301 Van Ness Ave., San Francisco, CA (PCN required due to expansion)

Mailing Address: 1401 Willow Pass Rd. Suite 900 Concord, CA

Hours of Operation: Monday-Friday from 10:00a.m. to 9:00p.m., Saturday from 9:00a.m. to 9:00p.m., and Sunday from 10:00a.m. to 7:00p.m., except during the holiday period when hours of operation may increase by one hour in the morning and evening hours. No change to the existing hours of operation are proposed.

BevMo!

1401 Willow Pass Rd., Suite 900 • Concord, California 94520 • T 925.609.6074 • F 925.798.7150 • www.bevmo.com

Public Convenience or Necessity

Approving this request for PCN will allow BevMo! to continue serving the public convenience or necessity by offering our customers a wide selection of beer, wine, spirits, gourmet food items, and party accessories at competitive prices. Expansion of this store will drastically improve the layout of the store with wider aisles, lower shelving, an improved selection of wine which will be featured in a new “wine vault,” and drastically improved wine and beer educational tasting area. In addition, the expansion of the store will allow BevMo! to expand food offerings from a small 8 foot cheese display to a much larger dedicated area of the store with staff assisting customers with the selection of gourmet cheeses and other food items.

In addition, BevMo! will continue operating responsibly by following company-wide policies, which include:

- 1) As noted above, our hours of operation are limited to normal retail hours.
- 2) Our company policy prohibits the sale of cigarettes and products of abuse (such as 40 oz. of malt liquor, and low-priced screw-top fortified wines).
- 3) Our company policy prohibits the use of video or pinball games, sale of pornographic videos and magazines, pay telephones, lottery tickets, newspaper stands and other items that would encourage loitering or minors patronizing the store.
- 4) Our company posts and maintains a professional quality sign stating “No Loitering”, “No public drinking of alcoholic beverages”, and “Stop you must be 21 to enter unless accompanied by an adult.”
- 5) Anyone who appears to be under the age of 50 is carded. We also use ID scanning equipment at all of our registers. In addition, we secret shop each store monthly to ensure our employees are following company policy.
- 6) No one under the age of 21 is allowed to enter the store, unless accompanied by an adult. No one under the age of 21 is allowed in the tasting area.
- 7) We do not employ persons under the age of 21.
- 8) Our stores are equipped with excellent security systems which have been shown to be a strong crime deterrent. As part of this expansion, BevMo! will be expanding and improving upon the existing security system.

Our company policies and employee training programs, which exceed state and local regulations and recommendations, have contributed greatly to our excellent track record with the ABC and the communities in which we are located. In fact, in the six years BevMo! has operated at this location, this store has never been the subject of an ABC accusation or violation.

BevMo!

1401 Willow Pass Rd., Suite 900 • Concord, California 94520 • T 925.609.6074 • F 925.798.7150 • www.bevmo.com

Summary of Outreach Efforts

As part of the Conditional Use Permit process, BevMo! conducted outreach with the community, including the following:

April 9th, 2013: Held a pre-application meeting open to neighbors. This meeting was noticed twice (using the planning departments notice list): once on March 22nd and again on April 5th. Only two people from the community attended the meeting and they were both supportive of the project.

April 14th, 2013: Having received our notice for the April 9th meeting, the Alliance for a Better District 6 invited BevMo! to attend their monthly community meeting. Liz Zaninovich (licensing specialist for BevMo!) and Julia Wan (project manager, MCG Architecture) attended. Alliance for a Better District 6 wrote a letter of support for the project (enclosed).

August 8th, 2013: BevMo! met with representatives from Middle Polk, Cathedral Hill, and Lower Polk neighborhood associations, as well as Supervisor Chiu, on the morning of the Planning Commission hearing. The meeting was held at the store and BevMo! representatives walked community members through the store to explain what the project would entail. As a result, BevMo! was able to answer the questions posed by these groups and the groups voiced no opposition to the project.

August 12th, 2013: Ms. Zaninovich presented information about the expansion of the store to the Community Leadership Alliance.

October 23rd, 2013: Ms. Zaninovich attended an additional Community Leadership Alliance meeting to update the group on the progress of the project.

November 12th 2013: Ms. Zaninovich attend an additional Alliance for a Better District 6 meeting to update the group on the progress of the project.

BevMo! representatives will continue to reach out to other neighborhood associations, including Lower Polk, Middle Polk, and Cathedral Hill to update the groups on the status of the project.

Please contact me at the number listed below if you have any questions.

Sincerely,

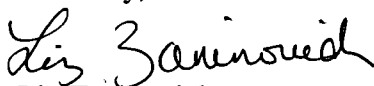

Liz Zaninovich

Licensing and Permit Entitlement Specialist

zaninoviche@bevmo.com

925-609-6153

#71

FILE NO. 060287

RESOLUTION NO. 352-06

1 [Liquor License, 1301 Van Ness Avenue]

2
3 **Resolution determining that the transfer of a Type 21 off-sale general license from**
4 **2 Sanchez Street to 1301 Van Ness Avenue, to Steve McLaren for Beverages &**
5 **more!, and the issuance of a Type 42 on-sale beer and wine public premises**
6 **license to the same applicant, will serve the public convenience and necessity of**
7 **the people of the City and County of San Francisco, in accordance with Section**
8 **23958.4 of the California Business and Professions Code, with conditions.**

9
10 WHEREAS, Steve McLaren is seeking transfer of a Type 21 off-sale general
11 license from 2 Sanchez Street to 1301 Van Ness Avenue and the issuance of a Type 42
12 on-sale beer and wine public premises license for Beverages & more!, located at 1301
13 Van Ness Avenue; and,

14 WHEREAS, The Redevelopment Agency has verified that the area is properly
15 zoned and recommends approval with conditions and,

16 WHEREAS, The Police Department recommends that the liquor license
17 application be approved with conditions; now, therefore, be it

18 RESOLVED, That in accordance with Section 23958.4 of the California Business
19 and Professions Code, the Board of Supervisors of the City and County of San
20 Francisco hereby determines for the foregoing reasons that the transfer of a Type 21
21 off-sale general license and the issuance of a Type 42 on-sale beer and wine public
22 premises license, to Steve McLaren for Beverages & more!, located at 1301 Van Ness
23 Avenue will serve the public convenience and necessity of the people of the City and
24 County of San Francisco.



City and County of San Francisco

City Hall
1 Dr. Carlton B. Goodlett Place
San Francisco, CA 94102-4689

Tails

Resolution

File Number: 060287

Date Passed:

Resolution determining that the transfer of a Type 21 off-sale general license from 2 Sanchez Street to 1301 Van Ness Avenue, to Steve McLaren for Beverages & more!, and the issuance of a Type 42 on-sale beer and wine public premises license to the same applicant, will serve the public convenience and necessity of the people of the City and County of San Francisco, in accordance with Section 23958.4 of the California Business and Professions Code, with conditions.

June 13, 2006 Board of Supervisors ~~---~~ ADOPTED

Ayes: 10 - Alioto-Pier, Ammiano, Daly, Dufty, Elsbernd, Maxwell, McGoldrick,
Mirkarimi, Peskin, Sandoval

Excused: 1 - Ma

NOTICE OF SPECIAL RESTRICTIONS UNDER THE PLANNING CODE

RECORDING REQUESTED BY:)

And When Recorded Mail To:)

Name: Bev Mo!)

ATTN: REAL ESTATE)

Address:)

1401 Willow Pass)

City:)

CONCORD, CA)

California)

94520)

) Space Above This Line For Recorder's Use

**CONFORMED COPY of document recorded
08/21/2013, 2013J732934**

on _____ with document no _____
This document has not been compared with the original
SAN FRANCISCO ASSESSOR-RECORDER

6

I (We) STEPHEN JON SHIDLER the
owner(s) of that certain real property situated in the City and County of San Francisco, State of
California, more particularly described as follows (or see attached sheet marked Exhibit A on
which property is more fully described):

Being Assessor's Block 0671, Lot 002, commonly known as 1301 Van Ness Avenue,
hereby give notice that there are special restrictions on the use of said property under Part II,
Chapter II of the San Francisco Municipal Code (Planning Code).

Said restrictions consist of conditions attached to Conditional Use Application No.
2013.0530C, authorized by the Planning Commission of the City and County of San Francisco
on August 8, 2013 as set forth in Planning Commission Motion No. 18947, TO ALLOW AN
EXISTING FORMULA RETAIL ESTABLISHMENT (D.B.A. BevMo!) INTO THE ADJCAENT
VACANT COMMERCIAL SPACE, IN EXCESS OF 6,000 GROSS SQUARE FEET WITHIN THE RC-4
(RESIDENTIAL-COMMERCIAL COMBINED, HIGH DENSITY) DISTRICT, THE 130-V HEIGHT
AND BULK DISTRICT, AND VAN NESS SPECIAL USE DISTRICT..

NOTICE OF SPECIAL RESTRICTIONS UNDER THE PLANNING CODE

Conditions of Approval, Compliance, Monitoring, and Reporting PERFORMANCE

1. **Validity and Expiration.** The authorization and right vested by virtue of this action is valid for three years from the effective date of the Motion. A building permit from the Department of Building Inspection to construct the project and/or commence the approved use must be issued as this Conditional Use authorization is only an approval of the proposed project and conveys no independent right to construct the project or to commence the approved use. The Planning Commission may, in a public hearing, consider the revocation of the approvals granted if a site or building permit has not been obtained within three (3) years of the date of the Motion approving the Project. Once a site or building permit has been issued, construction must commence within the timeframe required by the Department of Building Inspection and be continued diligently to completion. The Commission may also consider revoking the approvals if a permit for the Project has been issued but is allowed to expire and more than three (3) years have passed since the Motion was approved.

For information about compliance, contact Code Enforcement, Planning Department at 415-575-6863, www.sf-planning.org.

2. **ABC License.** The Project Sponsor shall obtain all necessary approvals from the Department of Alcoholic Beverage Control (ABC) prior to operating any alcoholic tasting. The authorized alcohol tasting use shall also comply with all of the conditions imposed by the Department of ABC and the Planning Department.

For information about compliance, contact the Department of Alcoholic Beverage Control, at (916) 419-2500, <http://www.abc.ca.gov/>

DESIGN

3. **Garbage, composting and recycling storage.** Space for the collection and storage of garbage, composting, and recycling shall be provided within enclosed areas on the property and clearly labeled and illustrated on the architectural addenda. Space for the collection and storage of recyclable and compostable materials that meets the size, location, accessibility and other standards specified by the San Francisco Recycling Program shall be provided at the ground level of the buildings.

For information about compliance, contact the Case Planner, Planning Department at 415-558-6378, www.sf-planning.org.

4. **Odor Control Unit.** In order to ensure any significant noxious or offensive odors are prevented from escaping the premises once the project is operational, the building permit application to implement the project shall include air cleaning or odor control equipment details and manufacturer specifications on the plans if applicable as determined by the project planner. Odor control ducting shall not be applied to the primary façade of the building.

For information about compliance, contact the Case Planner, Planning Department at 415-558-6378, www.sf-planning.org.

NOTICE OF SPECIAL RESTRICTIONS UNDER THE PLANNING CODE

For information about compliance, contact Code Enforcement, Planning Department at 415-575-6863, www.sf-planning.org

The use of said property contrary to these special restrictions shall constitute a violation of the Planning Code, and no release, modification or elimination of these restrictions shall be valid unless notice thereof is recorded on the Land Records by the Zoning Administrator of the City and County of San Francisco; except that in the event that the zoning standards above are modified so as to be less restrictive and the uses therein restricted are thereby permitted and in conformity with the provisions of the Planning Code, this document would no longer be in effect and would be null and void.

Dated: Aug 21, 2013 at San Francisco, California





(Owner's Signature)

(Agent's Signature)

This signature(s) must be acknowledged by a notary public before recordation; add Notary Public Certification and Official Notarial Seal.

SL:gwf

Department of Alcoholic Beverage Control
LICENSED PREMISES DIAGRAM (RETAIL)

State of California

1 APPLICANT NAME (Last, first, middle) Beverages & More, Inc.	2 LICENSE TYPE 42
3. PREMISES ADDRESS (Street number and name, city, zip code) 1301 Van Ness Avenue, San Francisco, CA 94109	4 NEAREST CROSS STREET Sutter

The diagram below is a true and correct description of the entrances, exits, interior walls and exterior boundaries of the premises to be licensed, including dimensions and identification of each room (i.e., "storeroom", "office", etc.).

DIAGRAM

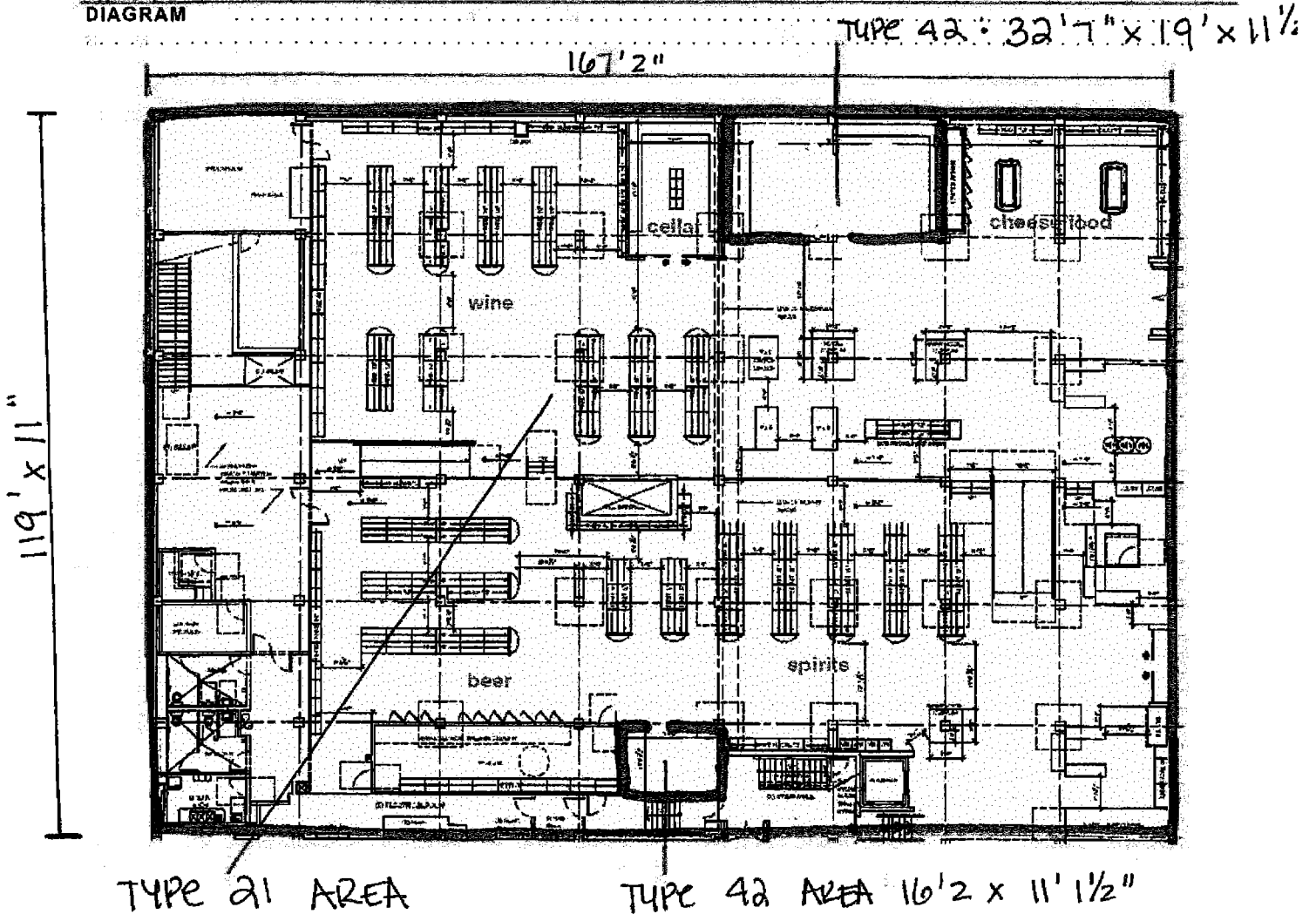

It is hereby declared that the above-described boundaries, entrances and planned operation as indicated on the reverse side, will not be changed without first notifying and securing prior written approval of the Department of Alcoholic Beverage Control. I declare under penalty of perjury that the foregoing is true and correct.

APPLICANT SIGNATURE (Only one signature required) <i>Denise M. Rowan</i>	DATE SIGNED 10/10/13
FOR ABC USE ONLY	
CERTIFIED CORRECT (Signature)	PRINTED NAME
	INSPECTION DATE

INFORMATION AND INSTRUCTIONS -

SECTION 23958.4 B&P

- Instructions This form is to be used for all applications for original issuance or premises to premises transfer of licenses.
- Part 1 is to be completed by an ABC employee, given to applicant with pre-application package, with copy retained in holding file or applicant's district file.
 - Part 2 is to be completed by the applicant, and returned to ABC.
 - Part 3 is to be completed by the local governing body or its designated subordinate officer or body, and returned to ABC.

PART 1 - TO BE COMPLETED BY ABC

1. APPLICANT'S NAME
BEVERAGES & MORE INC

2. PREMISES ADDRESS (Street number and name, city, zip code)
1301 VAN NESS AVE., SAN FRANCISCO, CA 94109

3. LICENSE TYPE
21/42

4. TYPE OF BUSINESS

<input type="checkbox"/> Full Service Restaurant	<input type="checkbox"/> Hofbrau/Cafeteria	<input type="checkbox"/> Cocktail Lounge	<input type="checkbox"/> Private Club
<input type="checkbox"/> Deli or Specialty Restaurant	<input type="checkbox"/> Comedy Club	<input type="checkbox"/> Night Club	<input type="checkbox"/> Veterans Club
<input type="checkbox"/> Cafe/Coffee Shop	<input type="checkbox"/> Brew Pub	<input type="checkbox"/> Tavern: Beer	<input type="checkbox"/> Fraternal Club
<input type="checkbox"/> Bed & Breakfast:	<input type="checkbox"/> Theater	<input type="checkbox"/> Tavern: Beer & Wine	<input type="checkbox"/> Wine Tasting Room
<input type="checkbox"/> Wine only	<input type="checkbox"/> All		

Supermarket Membership Store Service Station Swap Meet/Flea Market

Liquor Store Department Store Convenience Market Drive-in Dairy

Drug/Variety Store Florist/Gift Shop Convenience Market w/Gasoline

Other - describe:

5. COUNTY POPULATION
812820 (350)

6. TOTAL NUMBER OF LICENSES IN COUNTY
980 On-Sale Off-Sale

7. RATIO OF LICENSES TO POPULATION IN COUNTY
 On-Sale Off-Sale

8. CENSUS TRACT NUMBER
151

9. NO. OF LICENSES ALLOWED IN CENSUS TRACT
2 On-Sale Off-Sale

10. NO. OF LICENSES EXISTING IN CENSUS TRACT
5 On-Sale Off-Sale

11. IS THE ABOVE CENSUS TRACT OVERCONCENTRATED WITH LICENSES? (i.e., does the ratio of licenses to population in the census tract exceed the ratio of licenses to population for the entire county?)
 Yes, the number of existing licenses exceeds the number allowed
 No, the number of existing licenses is lower than the number allowed
3x PUB

12. DOES LAW ENFORCEMENT AGENCY MAINTAIN CRIME STATISTICS?
 Yes (Go to Item #13) No (Go to Item #20)

13. CRIME REPORTING DISTRICT NUMBER
541

14. TOTAL NUMBER OF REPORTING DISTRICTS
653

15. TOTAL NUMBER OF OFFENSES IN ALL REPORTING DISTRICTS
46,883

16. AVERAGE NO. OF OFFENSES PER DISTRICT
72

17. 120% OF AVERAGE NUMBER OF OFFENSES
86

18. TOTAL NUMBER OF OFFENSES IN REPORTING DISTRICT
471

19. IS THE PREMISES LOCATED IN A HIGH CRIME REPORTING DISTRICT? (i.e., has a 20% greater number of reported crimes than the average number of reported crimes as determined from all crime reporting districts within the jurisdiction of the local law enforcement agency)
 Yes, the total number of offenses in the reporting district equals or exceeds the total number in item #17
 No, the total number of offenses in the reporting district is lower than the total number in item #17

20. CHECK THE BOX THAT APPLIES (check only one box)

a. If "No" is checked in both item #11 and item #19, Section 23958.4 B&P does not apply to this application, and no additional information will be needed on this issue. Advise the applicant to bring this completed form to ABC when filing the application.

b. If "Yes" is checked in either item #11 or item #19, and the applicant is applying for a non-retail license, a retail bona fide public eating place license, a retail license issued for a hotel, motel or other lodging establishment as defined in Section 25503.16(b) B&P, or a retail license issued in conjunction with a beer manufacturer's license, or winegrower's license, advise the applicant to complete Section 2 and bring the completed form to ABC when filing the application or as soon as possible thereafter.

c. If "Yes" is checked in either item #11 or item #19, and the applicant is applying for an off-sale beer and wine license, an off-sale general license, an on-sale beer license, an on-sale beer and wine (public premises) license, or an on-sale general (public premises) license, advise the applicant to take this form to the local governing body, or its designated subordinate officer or body to have them complete Section 3. The completed form will need to be provided to ABC in order to process the application.

Governing Body/Designated Subordinate Name: **Board of Supervisors**

FOR DEPARTMENT USE ONLY

PREPARED BY (Name of Department Employee)

INFORMATION AND INSTRUCTIONS -

SECTION 23958.4 B&P

- Instructions This form is to be used for all applications for original issuance or premises to premises transfer of licenses.
- Part 1 is to be completed by an ABC employee, given to applicant with pre-application package, with copy retained in holding file or applicant's district file.
 - Part 2 is to be completed by the applicant, and returned to ABC.
 - Part 3 is to be completed by the local governing body or its designated subordinate officer or body, and returned to ABC.

PART 1 - TO BE COMPLETED BY ABC

1. APPLICANT'S NAME BEVERAGES & MORE INC.		
2. PREMISES ADDRESS (Street number and name, city, zip code) 1301 VAN NESS AVE., SAN FRANCISCO, CA 94109		3. LICENSE TYPE 42
4. TYPE OF BUSINESS		
<input type="checkbox"/> Full Service Restaurant	<input type="checkbox"/> Hofbrau/Cafeteria	<input type="checkbox"/> Cocktail Lounge
<input type="checkbox"/> Deli or Specialty Restaurant	<input type="checkbox"/> Comedy Club	<input type="checkbox"/> Night Club
<input type="checkbox"/> Cafe/Coffee Shop	<input type="checkbox"/> Brew Pub	<input type="checkbox"/> Tavern: Beer
<input type="checkbox"/> Bed & Breakfast:	<input type="checkbox"/> Theater	<input type="checkbox"/> Tavern: Beer & Wine
<input type="checkbox"/> Wine only	<input type="checkbox"/> All	<input type="checkbox"/> Private Club
<input type="checkbox"/> Supermarket	<input type="checkbox"/> Membership Store	<input type="checkbox"/> Service Station
<input type="checkbox"/> Liquor Store	<input type="checkbox"/> Department Store	<input type="checkbox"/> Convenience Market
<input type="checkbox"/> Drug/Variety Store	<input type="checkbox"/> Florist/Gift Shop	<input type="checkbox"/> Convenience Market w/Gasoline
<input type="checkbox"/> Other - describe:		<input type="checkbox"/> Swap Meet/Flea Market
<input type="checkbox"/> Drive-in Dairy		
5. COUNTY POPULATION 812820 (2, 493)	6. TOTAL NUMBER OF LICENSES IN COUNTY 284	7. RATIO OF LICENSES TO POPULATION IN COUNTY
	<input checked="" type="checkbox"/> On-Sale <input type="checkbox"/> Off-Sale	<input checked="" type="checkbox"/> On-Sale <input type="checkbox"/> Off-Sale
8. CENSUS TRACT NUMBER 151	9. NO. OF LICENSES ALLOWED IN CENSUS TRACT 8	10. NO. OF LICENSES EXISTING IN CENSUS TRACT
	<input checked="" type="checkbox"/> On-Sale <input type="checkbox"/> Off-Sale	14 <input checked="" type="checkbox"/> On-Sale <input type="checkbox"/> Off-Sale
11. IS THE ABOVE CENSUS TRACT OVERCONCENTRATED WITH LICENSES? (i.e., does the ratio of licenses to population in the census tract exceed the ratio of licenses to population for the entire county?)		
<input checked="" type="checkbox"/> Yes, the number of existing licenses exceeds the number allowed		
<input type="checkbox"/> No, the number of existing licenses is lower than the number allowed		
3X PUB		
12. DOES LAW ENFORCEMENT AGENCY MAINTAIN CRIME STATISTICS?		
<input checked="" type="checkbox"/> Yes (Go to Item #13) <input type="checkbox"/> No (Go to Item #20)		
13. CRIME REPORTING DISTRICT NUMBER 541	14. TOTAL NUMBER OF REPORTING DISTRICTS 653	15. TOTAL NUMBER OF OFFENSES IN ALL REPORTING DISTRICTS 46,883
16. AVERAGE NO. OF OFFENSES PER DISTRICT 72	17. 120% OF AVERAGE NUMBER OF OFFENSES 86	18. TOTAL NUMBER OF OFFENSES IN REPORTING DISTRICT 471
19. IS THE PREMISES LOCATED IN A HIGH CRIME REPORTING DISTRICT? (i.e., has a 20% greater number of reported crimes than the average number of reported crimes as determined from all crime reporting districts within the jurisdiction of the local law enforcement agency)		
<input checked="" type="checkbox"/> Yes, the total number of offenses in the reporting district equals or exceeds the total number in item #17		
<input type="checkbox"/> No, the total number of offenses in the reporting district is lower than the total number in item #17		
20. CHECK THE BOX THAT APPLIES (check only one box)		
<input type="checkbox"/> a. If "No" is checked in both item #11 and item #19, Section 23958.4 B&P does not apply to this application, and no additional information will be needed on this issue. Advise the applicant to bring this completed form to ABC when filing the application.		
<input type="checkbox"/> b. If "Yes" is checked in either item #11 or item #19, and the applicant is applying for a non-retail license, a retail bona fide public eating place license, a retail license issued for a hotel, motel or other lodging establishment as defined in Section 25503.16(b) B&P, or a retail license issued in conjunction with a beer manufacturer's license, or winegrower's license, advise the applicant to complete Section 2 and bring the completed form to ABC when filing the application or as soon as possible thereafter.		
<input checked="" type="checkbox"/> c. If "Yes" is checked in either item #11 or item #19, and the applicant is applying for an off-sale beer and wine license, an off-sale general license, an on-sale beer license, an on-sale beer and wine (public premises) license, or an on-sale general (public premises) license, advise the applicant to take this form to the local governing body, or its designated subordinate officer or body to have them complete Section 3. The completed form will need to be provided to ABC in order to process the application.		

Governing Body/Designated Subordinate Name: **BOARD OF SUPERVISORS**

FOR DEPARTMENT USE ONLY

PREPARED BY (Name of Department Employee)

LIQUOR LICENSE REVIEW

TO: Planning Department
AnMarie Rodgers/CTYPLN/SFGOV
Georgia Powell/CTYPLN/SFGOV@SFGOV
Fax No.: 558-6409

File: 131167

TO: Police Department
Officer Alberto Duarte
Inspector Darcy Keller
Fax No.: 553-1463

DATE: November 12, 2013

This item is tentatively scheduled to be heard in four to six weeks.
PLEASE EMAIL YOUR RESPONSE BY: December 24, 2013, to Derek Evans,
Clerk, Neighborhood Services and Safety Committee.

Derek.Evans@sfgov.org - Fax No: 554-7714

Applicant Name: Liz Zaninovich
and Business Name: BevMo!
(1301 Van Ness Avenue)

Applicant Address: 1401 Willow Pas Rd. Suite 900
Concord, CA
and Phone No. (925) 609-6153

PLANNING COMMENTS: Approval Denial

POLICE COMMENTS: Approval Denial