

LIQUOR LICENSE PUBLIC CONVENIENCE OR NECESSITY REFERRAL

TO: Planning Department
Phone No. (415) 558-6371

DATE: April 6, 2021

AP Block/Lot Nos.: 6516/023

TO: Police Department
Inspector Georgia Sawyer
Phone No. (415) 553-9550

Zoning: Mission Street NCT 55-X

Quad: SE Planning Team

Record No.: 2021-003491MIS

Please submit your response within three weeks. The Public Safety and Neighborhood Services Committee will tentatively schedule the PC or N hearing for a regular meeting in June of 2021.

PLEASE EMAIL YOUR RESPONSE BY April 23, 2021, to John Carroll,
Public Safety and Neighborhood Services Committee Clerk.

john.carroll@sfgov.org - Phone No: 554-4445

Applicant name: Binaya Pokharel

Business name: 24 Bart Liquor Store

Application address: 3347-24 Street
San Francisco, CA 94110

Applicant contact info: David Villa-Lobos
CLA Consulting
415-921-4192
david_villalobos@sbcglobal.net

PLANNING REVIEW: Approval Denial

Planning Staff Contact: Elton Wu elton.wu@sfgov.org 628-652-7415

Please print review comments on a trailing page.

Recommend approval for 3347 24th Street for an ABC Type 21 License per Planning Code Section 102, 249.60, and 754. All areas devoted to the display and sale of the alcoholic beverages must occupy less than 15% of the occupied floor area of the establishment.

POLICE REVIEW: Approval Denial

Please print review comments in a trailing report.

Attn: San Francisco Board of Supervisors
City and County of San Francisco, Ca.

Re: 3347 24th Street (dba: 24 Bart Liquor store)
San Francisco, Ca. 94110
Type 21 Off-Sale Beer Wine & Distilled Spirits

Dear Honorable San Francisco Board of Supervisors,

My business name is called 24 Bart Liquor Store and it is located on 24th Street San Francisco CA, 94110 in Mission. I plan to sell liquor, beer, groceries, dairy goods, medicine, and some stationery and household products. I believe it will benefit the community members because I am also a member of the community.

I strongly believe that bringing a liquor store to the neighborhood would benefit the community as a convenience. If anyone needs a few things that do not warrant a trip to the local grocery store, a trip to the convenience store down the street makes more sense. It also offers an economic boost to the community by providing job opportunities.

Respectfully



Binaya Pokharel

David J. Villa-Lobos, Licensing Agent
CLA Consulting
P.O. Box 642201
San Francisco, Ca. 94164
415. 921.4192
David_villalobos@sbcglobal.net

RECEIVED
BOARD OF SUPERVISORS
SAN FRANCISCO
2001 APR -5 PM 3:38
BY 

INFORMATION AND INSTRUCTIONS -

SECTION 23958.4 B&P

- Instructions: This form is to be used for all applications for original issuance or premises to premises transfer of licenses.
- Part 1 is to be completed by an ABC employee, given to applicant with pre-application package, with copy retained in holding file or applicant's district file.
 - Part 2 is to be completed by the applicant, and returned to ABC.
 - Part 3 is to be completed by the local governing body or its designated subordinate officer or body, and returned to ABC.

PART 1 - TO BE COMPLETED BY ABC

1 APPLICANT'S NAME: Pokharel, Binaya

2 PREMISES ADDRESS (Street number and name, city, zip code): 3347 24th St., San Francisco, CA 94110

3 LICENSE TYPE: 21

4 TYPE OF BUSINESS

| | | | |
|---|--|--|--|
| <input type="checkbox"/> Full Service Restaurant | <input type="checkbox"/> Hofbrau/Cafeteria | <input type="checkbox"/> Cocktail Lounge | <input type="checkbox"/> Private Club |
| <input type="checkbox"/> Deli or Specialty Restaurant | <input type="checkbox"/> Comedy Club | <input type="checkbox"/> Night Club | <input type="checkbox"/> Veterans Club |
| <input type="checkbox"/> Cafe/Coffee Shop | <input type="checkbox"/> Brew Pub | <input type="checkbox"/> Tavern: Beer | <input type="checkbox"/> Fraternal Club |
| <input type="checkbox"/> Bed & Breakfast | <input type="checkbox"/> Theater | <input type="checkbox"/> Tavern: Beer & Wine | <input type="checkbox"/> Wine Tasting Room |
| <input type="checkbox"/> Wine only | <input type="checkbox"/> All | | |
| <input type="checkbox"/> Supermarket | <input type="checkbox"/> Membership Store | <input type="checkbox"/> Service Station | <input type="checkbox"/> Swap Meet/Flea Market |
| <input checked="" type="checkbox"/> Liquor Store | <input type="checkbox"/> Department Store | <input type="checkbox"/> Convenience Market | <input type="checkbox"/> Drive-in Dairy |
| <input type="checkbox"/> Drug/Variety Store | <input type="checkbox"/> Florist/Gift Shop | <input type="checkbox"/> Convenience Market w/Gasoline | |
| <input type="checkbox"/> Other - describe: | | | |

5 COUNTY POPULATION: 897,806

6 TOTAL NUMBER OF LICENSES IN COUNTY: On-Sale Off-Sale

7 RATIO OF LICENSES TO POPULATION IN COUNTY: 1171 On-Sale Off-Sale

8 CENSUS TRACT NUMBER: 0209.00

9 NO. OF LICENSES ALLOWED IN CENSUS TRACT: 3 On-Sale Off-Sale

10 NO. OF LICENSES EXISTING IN CENSUS TRACT: 9 On-Sale Off-Sale

11 IS THE ABOVE CENSUS TRACT OVERCONCENTRATED WITH LICENSES? (i.e., does the ratio of licenses to population in the census tract exceed the ratio of licenses to population for the entire county?)
 Yes, the number of existing licenses exceeds the number allowed
 No, the number of existing licenses is lower than the number allowed

12 DOES LAW ENFORCEMENT AGENCY MAINTAIN CRIME STATISTICS?
 Yes (Go to Item #13) No (Go to Item #20)

13 CRIME REPORTING DISTRICT NUMBER: 454

14 TOTAL NUMBER OF REPORTING DISTRICTS: 4

15 TOTAL NUMBER OF OFFENSES IN ALL REPORTING DISTRICTS: 15,022

16 AVERAGE NO. OF OFFENSES PER DISTRICT: 84.13

17 120% OF AVERAGE NUMBER OF OFFENSES: 100.96

18 TOTAL NUMBER OF OFFENSES IN REPORTING DISTRICT: 304

19 IS THE PREMISES LOCATED IN A HIGH CRIME REPORTING DISTRICT? (i.e., has a 20% greater number of reported crimes than the average number of reported crimes as determined from all crime reporting districts within the jurisdiction of the local law enforcement agency)
 Yes, the total number of offenses in the reporting district equals or exceeds the total number in item #17
 No, the total number of offenses in the reporting district is lower than the total number in item #17

20 CHECK THE BOX THAT APPLIES (check only one box)

a. If "No" is checked in both item #11 and item #19, Section 23958.4 B&P does not apply to this application, and no additional information will be needed on this issue. Advise the applicant to bring this completed form to ABC when filing the application.

b. If "Yes" is checked in either item #11 or item #19, and the applicant is applying for a non-retail license, a retail bona fide public eating place license, a retail license issued for a hotel, motel or other lodging establishment as defined in Section 25503.16(b) B&P, or a retail license issued in conjunction with a beer manufacturer's license, or winegrower's license, advise the applicant to complete Section 2 and bring the completed form to ABC when filing the application or as soon as possible thereafter.

c. If "Yes" is checked in either item #11 or item #19, and the applicant is applying for an off-sale beer and wine license, an off-sale general license, an on-sale beer license, an on-sale beer and wine (public premises) license, or an on-sale general (public premises) license, advise the applicant to take this form to the local governing body or its designated subordinate officer or body to have them complete Section 3. The completed form will need to be provided to ABC in order to process the application.

Governing Body/Designated Subordinate Name

Board of Supervisors

FOR DEPARTMENT USE ONLY

PREPARED BY (Name of Department Employee)

ABC

Sheet Index

JOB INFORMATION

A0.0 Cover Sheet

Job: Gurewitz Kitchen Remodel
 Site: 184 Brentwood Ave.
 Lot Size: 467.6 Sq. Ft.
 Zoning: RH-1 (D)
 Code: 2019 California Building Code
 2019 California Electrical Code
 2019 California Mechanical Code
 2019 California Plumbing Code
 2019 California Fire Code
 2019 California Green Building Code
 Local City Building Code and Amendments
 Occupancy: B/R2
 Const. Type: V-B
 Historic Rating: 'C'
 Lot: 0023
 Block: 6516
 Project Description:
 LAND USE CHANGE

LINEA³

Peter Petrucci
 A.I.A. N.C.A.R.B.
 1165 Francisco No. 7
 San Francisco, Calif.
 415-674-8039

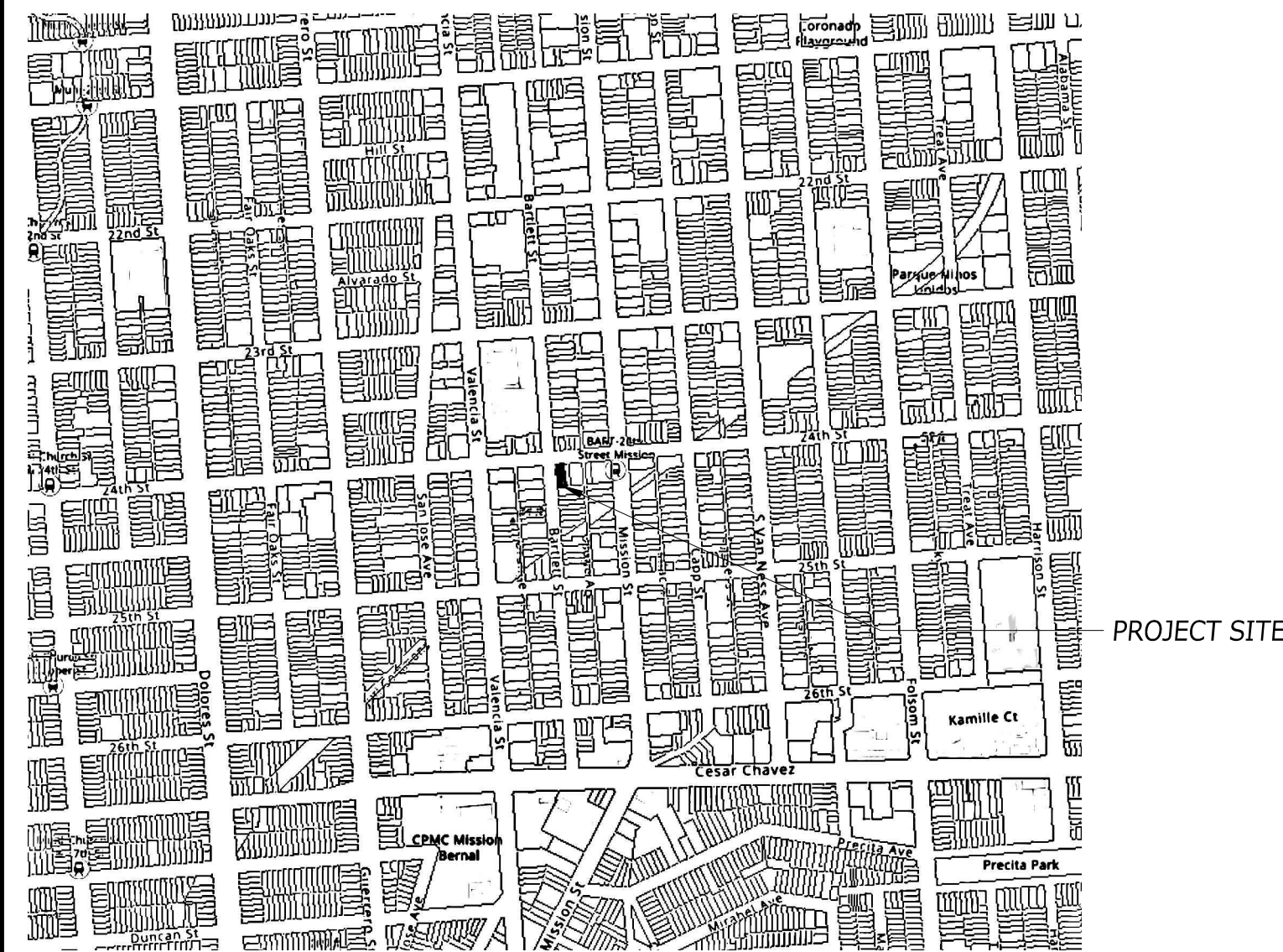
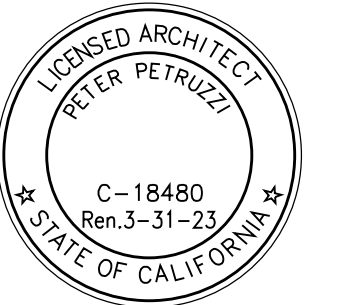

2 LOCATION MAP
 N.T.S.

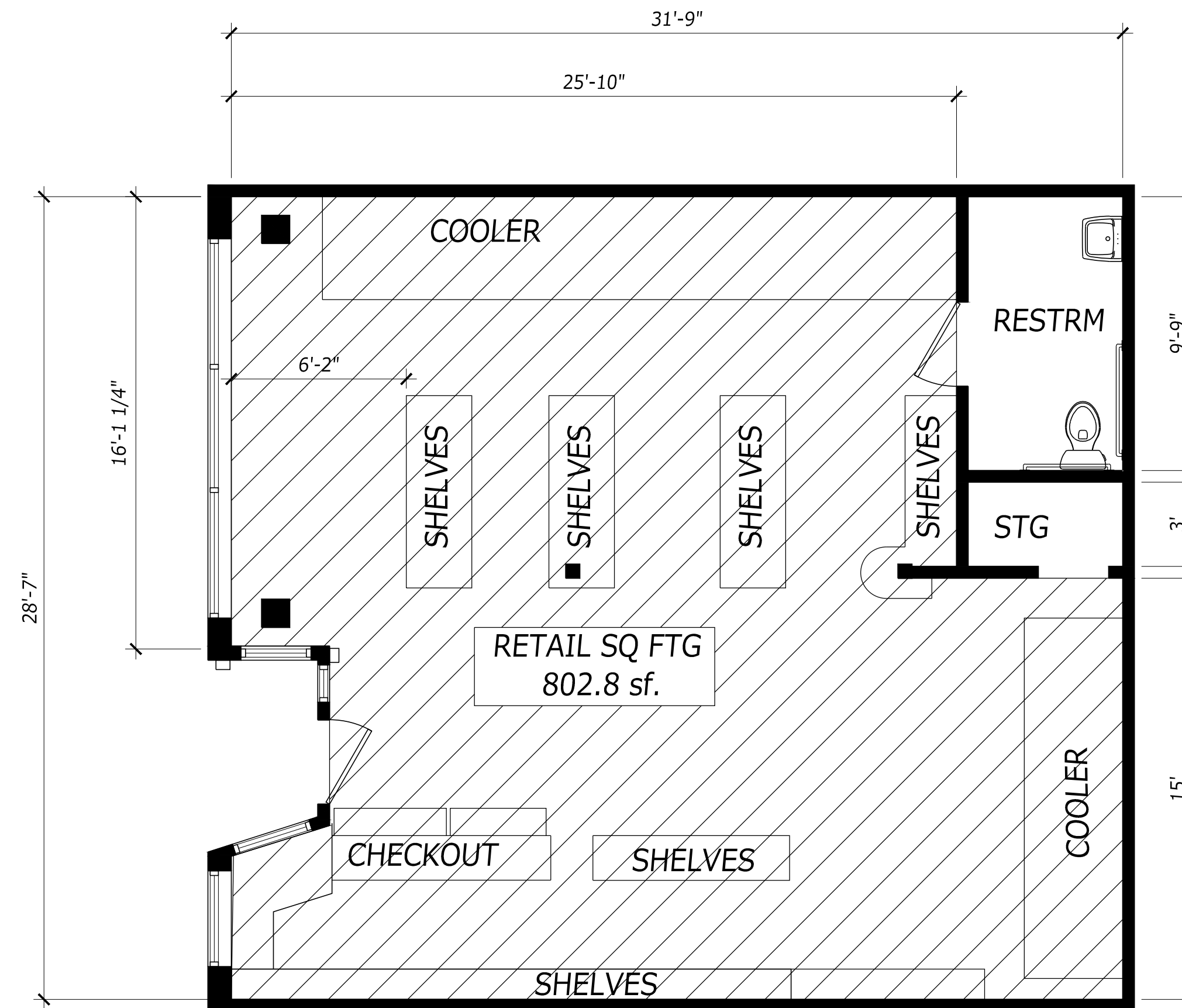
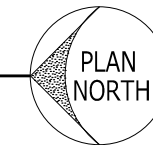

ALLOWABLE ALCOHOL SALES AREA

TOTAL RETAIL SF. 802.8 sf.

ALLOWABLE AREA
 802.8 X 15% = 120.4 sf.

4 RETAIL AREA
 1"=4'

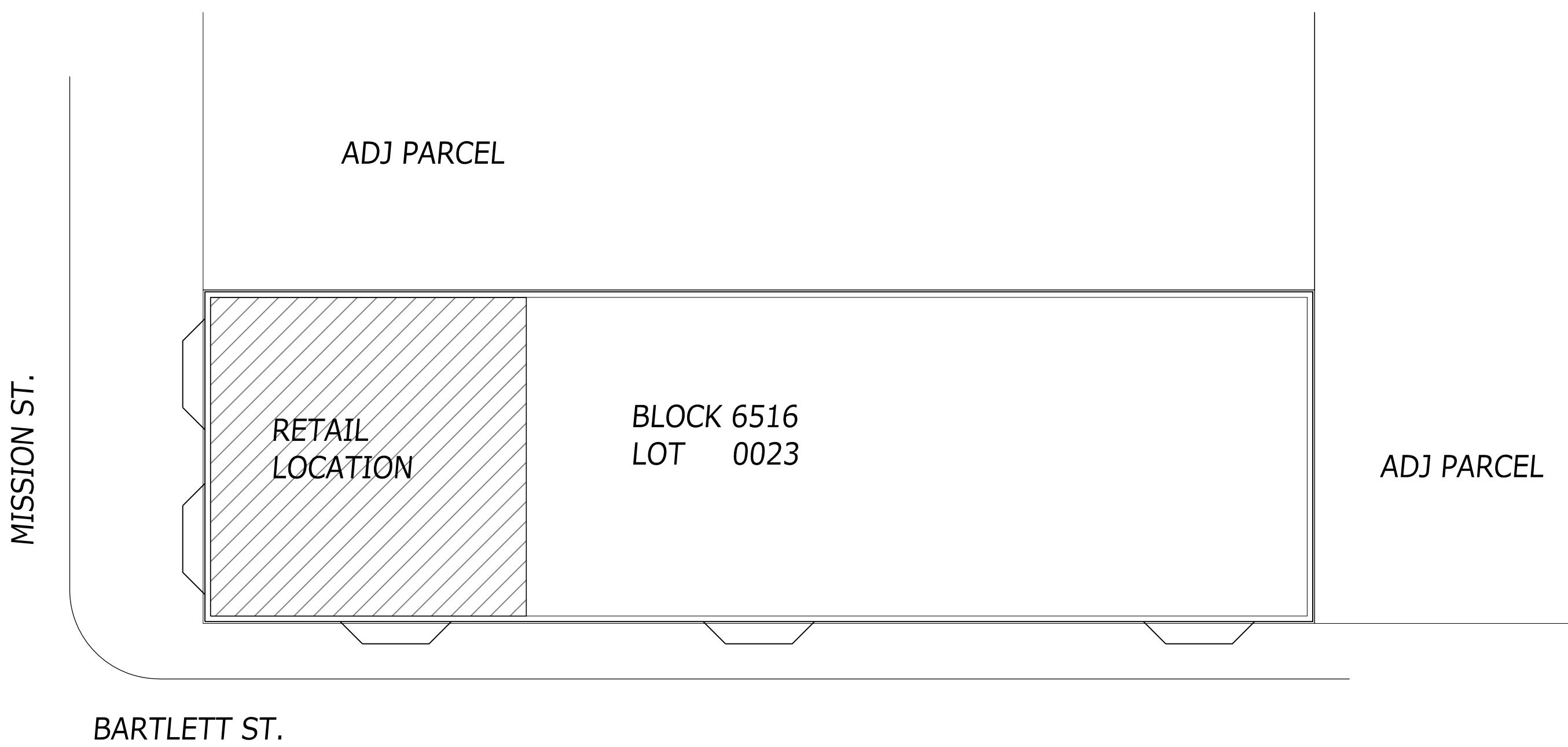
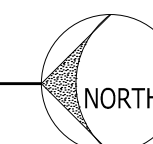

1 SITE PLAN
 1"=10'

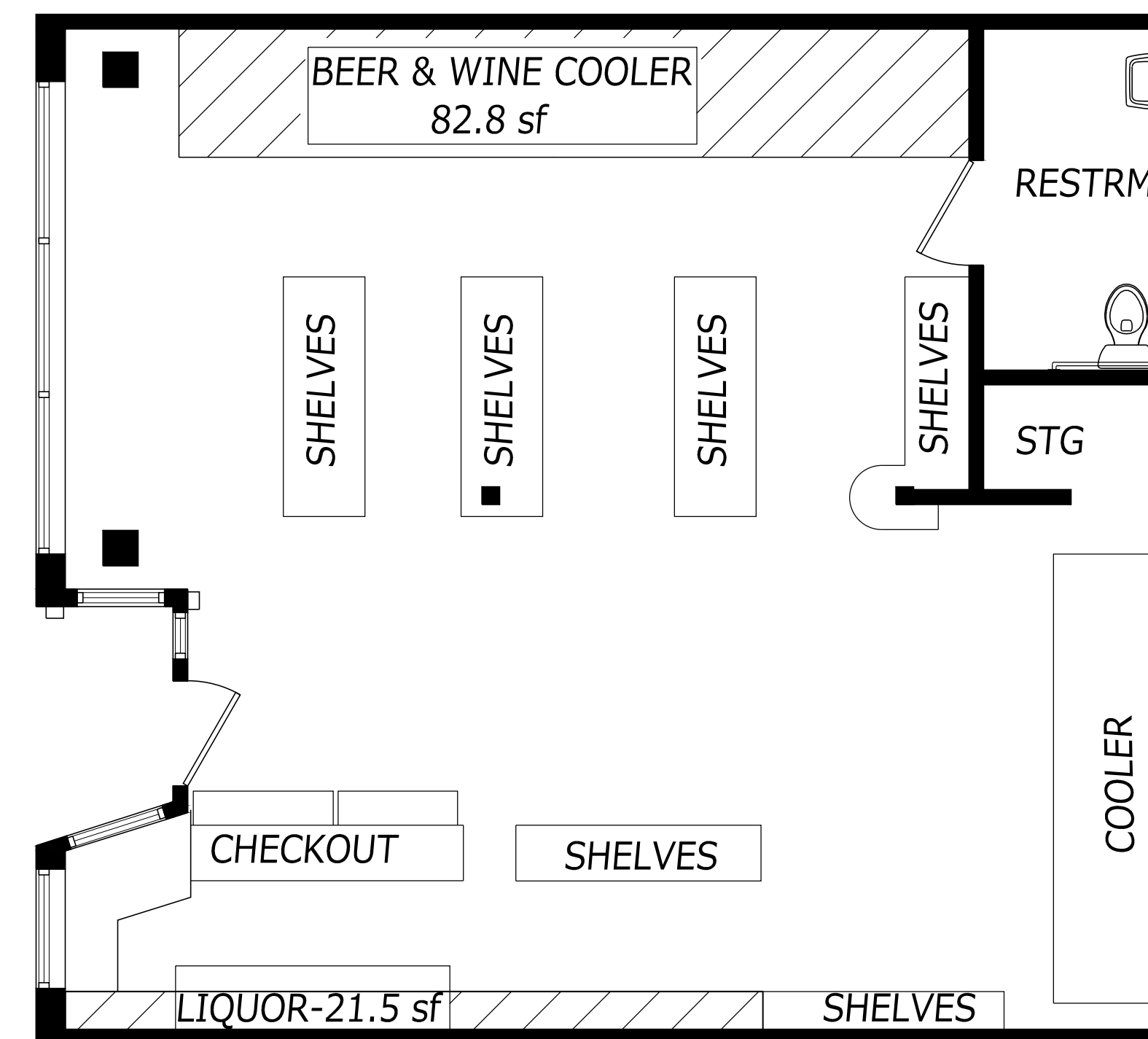
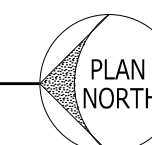

| | |
|--------------|-------|
| ALCOHOL AREA | 82.8 |
| TOTAL | 104.5 |

104.5 sf < 120.4 sf ALLOWABLE

3 LIQUOR AREA
 1"=4'

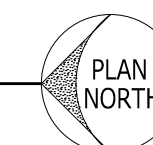

REVISION

24 Hour Bart
 3347 24th Street
 San Francisco, Calif.

FOR SFDBI USE ONLY

DESCRIPTION:

Cover

JOB NUMBER: 21-0050
 DRAWN BY: PP
 SCALE: -

A0.0

DATE: 4.19.21

Copyright © 2020 Peter Petrucci

NOTICE: All or part of this drawing is the property of the architect and may be used only for this project. Modifications to this drawing may be made only by the architect.