

CAFE LEASE

between

CITY AND COUNTY OF SAN FRANCISCO,
as Landlord

and

POETS CAFE LLC,

as Tenant

For the lease of

Library Café

100 Larkin, Main Library, Lower Level

San Francisco, California 94102

March 11, 2016

TABLE OF CONTENTS

	<u>Page</u>
1. BASIC LEASE INFORMATION	1
2. PREMISES; AS IS CONDITION	3
2.1. Lease Premises	3
2.2. As Is Condition.....	3
3. TERM	3
3.1. Lease Term.....	3
3.2. Delay in Delivery of Possession.....	4
3.3. Delays Caused by Tenant	4
4. RENT	4
4.1. Base Rent.....	4
4.2. Additional Charges.....	5
4.3. Late Charges.....	5
4.4. Default Interest.....	5
5. USE.....	5
5.1. Permitted Use	5
5.2. Standards of Operation; Appearance of Café.....	6
5.3. Health and Safety; Janitorial Services; Clean-Up	7
5.4. Hours of Operation.....	7
5.5. No Unlawful Uses, Nuisances or Waste	8
6. TENANT IMPROVEMENTS	9
6.1. Tenant Improvement Work	9
7. ALTERATIONS	9
7.1. Tenant’s Alterations	9
7.2. Title to Improvements	10
7.3. Tenant’s Personal Property	10
7.4. City’s Alterations of the Building and Building Systems	11
8. REPAIRS AND MAINTENANCE.....	11
8.1. City’s Repairs	11
8.2. Tenant’s Repairs.....	11
9. LIENS AND ENCUMBRANCES	12
9.1. Liens	12
9.2. Encumbrances	12

10.	UTILITIES AND SERVICES	12
10.1.	Utilities and Services	12
10.2.	Water and Energy Conservation; Mandatory or Voluntary Restrictions ...	12
10.3.	Excess Use.....	13
10.4.	Floor Load	13
10.5.	Interruption of Services	13
11.	COMPLIANCE WITH LAWS / RISK MANAGEMENT REQUIREMENTS.....	14
11.1.	Compliance with Laws	14
11.2.	Regulatory Approvals.....	14
11.3.	Compliance with City’s Risk Management Requirements	15
12.	SUBORDINATION.....	15
13.	INABILITY TO PERFORM	16
14.	DAMAGE AND DESTRUCTION	16
14.1.	Damage and Destruction	16
14.2.	Waiver	17
15.	EMINENT DOMAIN	17
15.1.	Definitions	17
15.2.	General	17
15.3.	Total Taking; Automatic Termination	18
15.4.	Partial Taking; Election to Terminate.	18
15.5.	Rent; Award	18
15.6.	Partial Taking; Continuation of Lease.....	18
15.7.	Temporary Takings	19
16.	ASSIGNMENT AND SUBLETTING	19
16.1.	Restriction on Assignment and Subletting	19
16.2.	Notice of Proposed Transfer.....	19
16.3.	City’s Response.....	20
16.4.	Sublease or Recapture Space.....	21
16.5.	Effect of Sublease or Assignment	21
16.6.	Assumption by Transferee.....	22
16.7.	Indemnity for Relocation Benefits	22
17.	DEFAULT; REMEDIES	22
17.1.	Events of Default.....	22
17.2.	Remedies	23
17.3.	Waiver of Redemption	25

17.4.	City’s Right to Cure Tenant’s Defaults	25
18.	WAIVER OF CLAIMS; INDEMNIFICATION	26
18.1.	Limitation on City’s Liability; Waiver of Claims	26
18.2.	Tenant’s Indemnity.....	26
19.	INSURANCE.....	27
19.1.	Tenant’s Insurance	27
19.2.	Tenant’s Personal Property	28
19.3.	City’s Self Insurance	28
19.4.	Waiver of Subrogation	28
20.	ACCESS BY CITY	29
21.	CERTIFICATES.....	29
21.1.	Tenant’s Certificates.....	29
21.2.	City’s Certificates.....	30
22.	RULES AND REGULATIONS	30
23.	SECURITY DEPOSIT	30
24.	SURRENDER OF PREMISES	31
25.	HAZARDOUS MATERIALS.....	31
25.1.	Definitions.....	31
25.2.	No Hazardous Materials.....	32
25.3.	Tenant’s Environmental Indemnity.....	32
25.4.	Survival of Obligation	33
26.	SPECIAL PROVISIONS.....	33
26.1.	Extension Options	33
26.2.	Payment of Percentage Share of Operating Expenses.....	34
27.	GENERAL PROVISIONS	34
27.1.	Notices.....	34
27.2.	No Implied Waiver.....	34
27.3.	Amendments.....	35
27.4.	Authority	35
27.5.	Parties and Their Agents; Approvals.....	35
27.6.	Interpretation of Lease.....	36
27.7.	Successors and Assigns	36
27.8.	Brokers	36
27.9.	Severability.....	36
27.10.	Governing Law.....	37

27.11.	Entire Agreement	37
27.12.	Attorneys' Fees.....	37
27.13.	Holding Over	37
27.14.	Time of Essence	38
27.15.	Cumulative Remedies.....	38
27.16.	Survival of Indemnities	38
27.17.	Signs	38
27.18.	Relationship of the Parties.....	39
27.19.	Light and Air	39
27.20.	No Recording	39
27.21.	Options Personal.....	39
27.22.	Public Transit Information	39
27.23.	Taxes, Assessments, Licenses, Permit Fees and Liens	39
27.24.	Non-Liability of City Officials, Employees and Agents	40
27.25.	Prevailing Wages and Working Conditions	40
27.26.	Non-Discrimination in City Contracts and Benefits Ordinance.....	41
27.27.	No Relocation Assistance; Waiver of Claims	42
27.28.	MacBride Principles - Northern Ireland.....	42
27.29.	Tropical Hardwood and Virgin Redwood Ban.....	42
27.30.	Restrictions on the Use of Pesticides	43
27.31.	First Source Hiring Agreement	43
27.32.	Sunshine Ordinance.....	43
27.33.	Conflicts of Interest	44
27.34.	Charter Provisions	44
27.35.	Drug-Free Workplace.....	44
27.36.	Prohibition of Tobacco Sales and Advertising.....	44
27.37.	Prohibition of Alcoholic Beverage Advertising.....	44
27.38.	Requiring Health Benefits for Covered Employees	44
27.39.	Notification of Limitations on Contributions.....	46
27.40.	Preservative-Treated Wood Containing Arsenic.....	46
27.41.	Resource-Efficient City Buildings	47
27.42.	Counterparts	47
27.43.	Effective Date.....	47
27.44.	Acceptance of Lease by Tenant.....	47

27.45. Food Service Waste Reduction	47
27.46. Bottled Drinking Water	47
27.47. Criminal History in Hiring and Employment Decisions	48
27.48. Cooperative Drafting	49
27.49. Sugar-Sweetened Beverage Prohibition	49

LIST OF EXHIBITS:

EXHIBIT A – Premises

EXHIBIT B – Business Plan

EXHIBIT C – Standard Utilities and Services

EXHIBIT D – Building Rules and Regulations

EXHIBIT E – First Source Hiring Agreement

CAFE LEASE

THIS CAFE LEASE (this “Lease”), dated for reference purposes only as of March 11, 2016, is between the CITY AND COUNTY OF SAN FRANCISCO, a municipal corporation (“City” or “Landlord”), and POETS CAFE LLC, a California limited liability company (“Tenant”).

City and Tenant hereby covenant and agree as follows:

1. BASIC LEASE INFORMATION

The following is a summary of basic lease information (the “Basic Lease Information”). Each item below shall be deemed to incorporate all of the terms in this Lease pertaining to such item. In the event of any conflict between the information in this Section and any more specific provision of this Lease, the more specific provision shall control.

Lease Reference Date:	March 1, 2016
Landlord:	CITY AND COUNTY OF SAN FRANCISCO, a municipal corporation, referenced herein as City.
Tenant:	POETS CAFE LLC, a California limited liability company.
Building (Section 2.1):	Main Library, Lower Level 100 Larkin San Francisco, California 94102
Premises (Section 2.1):	Space on the lower level of the Building, located on the floor plan attached as <u>Exhibit A</u> .
Rentable Area of Premises (Section 2.1):	Approximately 1,000 square feet on lower level, and approximately 200 square feet in the Grove Street entrance area.
Term (Section 3.1):	Three (3) Years.
Extension Options (Section 26.1):	Tenant shall have two 2 -year options to extend the Lease in accordance with the provisions of Section 26.1.
Estimated Commencement Date:	April 1, 2016.
Expiration Date:	March 31, 2019.
Initial Monthly Base Rent (Section 4.1):	\$300 per month.

Use (Section 5.1):	Operation of a café as more particularly described in Section 5.1 below.
Tenant Improvements (Section 6.1):	None required.
Utilities and Services (Section 10.1):	Tenant to pay for telephone charges (local and long distance), within the Premises. City to pay for heating, air conditioning, lighting, refuse removal (from designated containers), electricity, water and sewer.
Security Deposit (Section 23.1):	One Thousand Dollars (\$1,000.00)
Notice Address of City (Section 27.1):	Attn: Director of Property Real Estate Division 25 Van Ness Avenue, Suite 400 San Francisco, California 94102 Fax No.: (415) 552-9216
Key Contact for City:	Roberto Lombardi, Facilities Director San Francisco Public Library 100 Larkin, 5 th floor San Francisco, CA 94102 Phone No. - (415) 557-4485 roberto.lombardi@sfpl.org
	AND
	Josh Keene City and County of San Francisco Real Estate Division 25 Van Ness, Suite 400 San Francisco, CA 94102 415-554-9859 joshua.keene@sfgov.org
Notice Address for Tenant (Section 27.1):	Nick Shihadeh 4804 Mission Street #222 San Francisco, CA 94112
Key Contact for Tenant:	Marc Austin
Telephone No.:	(925) 216-4843

2. PREMISES; AS IS CONDITION

2.1. Lease Premises

Subject to the provisions of this Lease, City leases to Tenant and Tenant leases from City those premises in the building identified in the Basic Lease Information (the "Building" or "Main Library") and shown on the floor plan(s) attached hereto as Exhibit A (the "Premises"). The Premises are located on the lower level and Grove Street entrance of the Building specified in the Basic Lease Information. The rentable area of the Premises specified in the Basic Lease Information shall be conclusive for all purposes hereof. The Building, land upon which the Building is located and all other improvements on and appurtenances to such land are referred to collectively as the "Property." Tenant shall have the non-exclusive right of access to and from the Premises by the main entrances to the Building and the Property.

2.2. As Is Condition

TENANT ACKNOWLEDGES AND AGREES THAT THE PREMISES ARE BEING LEASED AND ACCEPTED IN THEIR "AS IS" CONDITION, WITHOUT REPRESENTATION OR WARRANTY OF ANY KIND, AND SUBJECT TO ALL APPLICABLE LAWS, RULES AND ORDINANCES GOVERNING THEIR USE, OCCUPANCY AND POSSESSION. TENANT REPRESENTS AND WARRANTS TO CITY THAT TENANT HAS INVESTIGATED AND INSPECTED, EITHER INDEPENDENTLY OR THROUGH AGENTS OF TENANT'S OWN CHOOSING, THE CONDITION OF THE PREMISES AND THE SUITABILITY OF THE PREMISES FOR TENANT'S INTENDED USE. TENANT HAS DETERMINED, BASED SOLELY ON ITS OWN INVESTIGATION, THAT THE PREMISES ARE SUITABLE FOR TENANT'S BUSINESS AND INTENDED USE. TENANT ACKNOWLEDGES AND AGREES THAT NEITHER CITY NOR ANY OF ITS AGENTS HAVE MADE, AND CITY HEREBY DISCLAIMS, ANY REPRESENTATIONS OR WARRANTIES, EXPRESS OR IMPLIED, CONCERNING THE RENTABLE AREA OF THE PREMISES, THE PHYSICAL OR ENVIRONMENTAL CONDITION OF THE PREMISES OR THE PROPERTY, THE PRESENT OR FUTURE SUITABILITY OF THE PREMISES FOR TENANT'S BUSINESS, OR ANY OTHER MATTER WHATSOEVER RELATING TO THE PREMISES, INCLUDING, WITHOUT LIMITATION, ANY IMPLIED WARRANTIES OF MERCHANTABILITY OR FITNESS FOR A PARTICULAR PURPOSE.

2.1 Accessibility Disclosures

California Civil Code Section 1938 requires commercial landlords to disclose to tenants whether the property being leased has undergone inspection by a Certified Access Specialist ("CASp") to determine whether the property meets all applicable construction-related accessibility requirements.

City is hereby advised that the Premises have not been inspected by a CASp.

3. TERM

3.1. Lease Term The Premises are leased for a term (the "Term") commencing on the date specified in the Basic Lease Information as the estimated commencement date (the

"Estimated Commencement Date"), or such earlier date upon which City delivers and Tenant accepts possession of the Premises, subject to the provisions of Section 3.2 (Delay in Delivery of Possession) and Section 3.3 (Delays Caused by Tenant) below. The Term of this Lease shall end on the expiration date specified in the Basic Lease Information, unless sooner terminated pursuant to the provisions of this Lease. This Lease is subject to the Extension Option(s) set forth in Section 26.1 (Option to Extend Term). City shall deliver the Premises to Tenant on the Commencement Date in their then existing as is condition as further provided above, with no obligation of the City to make any improvements, repairs or alterations. Confirmation of Commencement Date and Expiration Date

The dates on which the Term commences and terminates pursuant hereto are referred to respectively as the "Commencement Date" and the "Expiration Date." If the Commencement Date occurs on a date other than the Estimated Commencement Date, then promptly following the Commencement Date Tenant shall deliver to City a notice substantially in the form attached hereto as Exhibit B, confirming the actual Commencement Date, but Tenant's failure to do so shall not affect the commencement of the Term.

3.2. Delay in Delivery of Possession

If City is unable to deliver possession of the Premises to Tenant on or before the Estimated Commencement Date, then the validity of this Lease shall not be affected thereby and City shall not be liable to Tenant for any Claims (as defined in Section 18 below) resulting therefrom, and Tenant waives all provisions of any laws to the contrary. In such case, the Term and regular payments of Base Rent shall not commence until City delivers possession of the Premises. If the Term commences later or earlier than the Estimated Commencement Date, this Lease shall nevertheless expire on the Expiration Date, unless sooner terminated pursuant to the provisions hereof.

3.3. Delays Caused by Tenant

Notwithstanding anything to the contrary above, if City's inability to deliver possession of the Premises on the Estimated Commencement Date results from Tenant's or its Agents' acts or omissions, then Base Rent payable by Tenant hereunder shall commence on the date when City would have delivered possession of the Premises but for such acts or omissions.

4. RENT

4.1. Base Rent

Throughout the Term beginning on the Commencement Date, Tenant shall pay to City the monthly Base Rent (the "Base Rent") specified in the Basic Lease Information. The Base Rent shall be paid to City in advance, without prior demand and without any deduction, setoff or counterclaim whatsoever, on or before the first day first day of each month during the Term, provided that the initial payment of monthly Base Rent shall be paid by Tenant together with Tenant's execution of this Lease. The Base Rent shall be paid to City in advance, without prior demand and without any deduction, setoff or counterclaim whatsoever, in equal consecutive monthly payments on or before the first day of the Term and on or before the first day of each month thereafter. All sums payable by Tenant to City hereunder shall be paid in cash or by good

check to the City and County of San Francisco in care of the Director of Property at the primary address for City specified in the Basic Lease Information, or such other place as City may designate in writing. Payments made by check must be drawn on a financial institution that is a member of the Federal Deposit Insurance Corporation. If Tenant pays by check and such check is not honored, then City may require Tenant to make all future payments in cash or by cashier's check. If the Commencement Date occurs on a day other than the first day of a calendar month, or the Expiration Date occurs on a day other than the last day of a calendar month, then the Base Rent for such fractional month shall be prorated based on a thirty (30) day month. Within five (5) days after the parties execute this Lease, Tenant shall pay to City the Base Rent for the first full month.

4.2. Additional Charges

Tenant shall pay to City any and all charges and other amounts required under this Lease as additional rent (collectively, "Additional Charges"). All such Additional Charges shall be payable to City at the same place and the same manner as the Base Rent is payable. City shall have the same remedies for a default in the payment of any Additional Charges as for a default in the payment of Base Rent. As used in this Lease, the term "Rent" shall include the Base Rent, Additional Charges and any other amounts Tenant is obligated to pay hereunder, whether or not any such amounts are specifically characterized as rent.

4.3. Late Charges

If Tenant fails to pay any Rent or any portion of Rent within five (5) days following the due date, such unpaid amount shall be subject to a late payment charge equal to six percent (6%) of the unpaid amount in each instance. The late payment charge has been agreed upon by City and Tenant, after negotiation, as a reasonable estimate of the additional administrative costs and detriment that City will incur as a result of any such failure by Tenant, the actual costs thereof being extremely difficult if not impossible to determine. The late payment charge constitutes liquidated damages to compensate City for its damages resulting from such failure to pay and shall be paid to City together with such unpaid amount.

4.4. Default Interest

Any Rent, if not paid within five (5) days following the due date, shall bear interest from the due date until paid at the rate of ten percent (10%) per year or, if a higher rate is legally permissible, at the highest rate an individual is permitted to charge under law (the "Interest Rate"). However, interest shall not be payable on late charges incurred by Tenant nor on any amounts on which late charges are paid by Tenant to the extent this interest would cause the total interest to be in excess of that which an individual is lawfully permitted to charge. Payment of interest shall not excuse or cure any default by Tenant.

5. USE

5.1. Permitted Use

Tenant shall use and continuously occupy the Premises during the Term solely for the operation of a café serving moderately-priced fresh, nutritious and wholesome food and drink items for on-Premises consumption and take-out, and for no other purpose, and the items served

must include, without limitation, high quality coffee and tea, juice, breakfast foods, and baked goods. Notwithstanding the foregoing, Tenant may, at Tenant's election, provide additional food, snack and drink items upon approval of the City. Tenant acknowledges that Tenant does not have the exclusive right to operate a food service establishment in the Building or the exclusive right to sell any item which Tenant is permitted to sell hereunder. Cooking and baking must be performed off-site, although warming of prepared foods shall be permitted on site, provided that no cooking odors are emitted from the Premises which are noticeable in other areas of the Building. If at any time during the term hereof City determines, in City's sole discretion, that the odors emitted from the Premises and noticeable in other areas of the Building are too intense, City may notify Tenant thereof and Tenant shall thereupon promptly use reasonable efforts to correct the problem to City's satisfaction. Tenant shall not sell any merchandise other than food and drinks as specified above without the City's prior consent, which consent may be given or withheld in City's sole discretion. Without limiting the foregoing, the sale of such items as lottery tickets, mugs, clothing, post cards, stationery items, souvenirs and other merchandise, and the use of electronic game machines is prohibited. All fixtures and facilities used by Tenant outside the food preparation areas of the cafe must be completely mobile, and must be able to be moved to designated storage areas in the Premises, as directed by City, when necessary prior to certain special events, for which City shall provide Tenant reasonable advanced notice.

5.2. Standards of Operation; Appearance of Café

Tenant covenants that it will operate Tenant's business in the Premises in a first-class manner as a quality retail establishment in accordance with reputable business standards and practices. Tenant will carry on its business diligently and continuously at the Premises throughout the Lease term. Tenant shall maintain a sufficient selection of nutritious, wholesome food and beverages, moderately priced, and stocked in sufficient quantity, adequate to ensure successful operation of Tenant's business. Coffee service must always include caffeinated and decaffeinated drip coffees, all of high gourmet or artisan type quality. All take-out items shall be wrapped and bagged or boxed, and all take-out beverages shall be sold in recyclable and compostable lidded containers only. Tenant shall carefully supervise and control the operation of its business in the Premises, and shall employ a competent, polite, service oriented, culturally sensitive, and adequate staff, all of whom shall be Tenant's employees and none of whom shall be deemed for any purpose whatsoever to be City's employees. Tenant acknowledges that the identity of Tenant, the specific character of Tenant's business, and the relationship between such use and other uses within the Building have been material considerations to City's entry into this Lease. Any material change in the character of Tenant's business or use which is made without the prior written consent of City, which may be withheld in City's sole discretion, shall constitute a default under this Lease. Tenant shall install and maintain at all times in the Premises high quality fixtures, furnishing, fittings and equipment adequate, appropriate and properly laid out to sustain Tenant's business, and such items must be approved by City, and must not overload the floor or create any objectionable noise. City requires that the café operation include a mobile coffee cart, which will generally be located in the area just inside the Grove Street entrance, with the intent to provide drink and snack service to patrons and staff entering and leaving the Main Library. The Library will provide up to three electrical outlets, in the area of the Grove Street entrance and the bookstore. However the cart must be able to provide hot coffee without requiring water or a sewer connection. The cart must be easily mobile, and Tenant may provide

service, with the approval of City, in its sole discretion, in alternate locations of the library for events, book sales, meetings, and the like.

Tenant shall have right of first refusal to provide catering services for Library events, unless the event requires food service beyond the normal café offerings of coffee, pastries, sandwiches, and other food Tenant regularly serves. If an event refuses to use Tenant for such catering services and as a result the Main Library may lose having such event, Tenant's right of first refusal to provide catering services shall not apply.

All articles in the Premises and the arrangement, style, color and general appearance thereof which are visible to the public from the public areas of the Building, including advertising matter, signs, merchandise and fixtures, shall be attractive, dignified and uncluttered and shall be maintained in a first-class manner in keeping with the character and standards of the Building. All displays, arrangements, signage and advertising visible to the public shall be subject to City's approval, in City's sole discretion. Tenant shall be required to substantially adhere to the Business Plan attached hereto as Exhibit B. Adjustments to the Business Plan may be made with the prior written approval of the City.

5.3. Health and Safety; Janitorial Services; Clean-Up

Tenant shall maintain high standards of sanitation and shall maintain the Premises at all times in a clean and sanitary manner in compliance with all applicable health and sanitation laws and with any reasonable health and safety guidelines promulgated by City. During Tenant's hours of operation, Tenant shall keep the Premises and the tables, booths and chairs in the Premises free of dishes, utensils, food, debris and spills and in a neat, clean, orderly and attractive condition and shall provide and empty garbage receptacles. Tenant shall remove all recycling and trash from the Premises and place same into designated receptacles within the Building, as directed by the Facilities Division staff. Tenant shall clean up and repair (or pay reasonable costs of the City for repair, at the City's discretion), as necessary, any areas of the Building that are dirtied or damaged as a result of Tenant's activities, and shall reimburse City on demand for all cleaning, repair and other expenses incurred by City resulting from Tenant's operations.

5.4. Hours of Operation

Tenant shall continuously operate the Premises for the use specified in the Basic Lease Information for the following minimum hours:

Monday - Friday	6:00am to 4:00 pm
Saturday	8:30am to 3:00 pm
Sunday	11:30 am to 3:00 pm

Tenant shall, subject to approval by the City (or of such other party with authority regarding the operation of the Building designated by City in written notice to Tenant), have sufficient access to the Premises prior to, during, and after the hours that Building is open to the public, to conduct business efficiently. Tenant is permitted to operate the café beyond the

minimum hours specified above, but may not operate the cafe prior to six o'clock in the morning or after the library closes to the public in the evening, unless approved by City in writing.

Tenant shall not operate the Premises at times the Premises are made available for reserved use without permission of City. Set-up for reserved Library uses may require Tenant to relocate its mobile coffee cart to proper storage at least one hour prior to reserved use, upon reasonable advance notice from City. Tenant shall not operate the Premises on the days that Building is closed to the public, whether such closure is due to scheduled holidays, budgetary conditions, force majeure-type events, or any other reason. The Building is currently closed on the following holidays:

- New Year's Day
- Martin Luther King Day
- President's Day
- Memorial Day

- Pride Celebration (last Sunday in June)
- Fourth of July
- Labor Day
- Columbus Day
- Veteran's Day
- Thanksgiving Day
- Friday after Thanksgiving Day
- Christmas Day

Tenant acknowledges that its failure to operate its business in the Premises on the days and during the minimum hours set forth above, will result in City incurring costs, expenses and damages that are not contemplated by this Lease as a result of the adverse impact such violation shall have on other tenants and users of the Building. Tenant also acknowledges that the exact amounts of such costs, expenses and damages are extremely difficult to ascertain. Accordingly, for each day, or part of a day, that Tenant violates the minimum hour requirements set forth in this Section 5.4., Tenant shall pay immediately on demand the sum of Fifty Dollars (\$50.00), as liquidated damages, which sum shall be payable in addition to all other rent and all other rights and remedies available to City as Landlord. The parties agree that such amounts represents a fair and reasonable estimate of the costs, expenses and damages that Landlord shall incur by reason of Tenant violating the minimum hour requirements, but that payment of such amount shall not be deemed to waive any of City's other rights and remedies under this Lease or at law by reason of such failure.

5.5. No Unlawful Uses, Nuisances or Waste

Without limiting the foregoing, Tenant shall not use, occupy or permit the use or occupancy of any of the Premises in any unlawful manner or for any illegal purpose, or permit any offensive, noisy or hazardous use or any waste on or about the Premises. Tenant shall take all precautions to eliminate any nuisances or hazards relating to its activities on or about the Premises, including, but not limited to, odors. The presence of such nuisances or hazards shall be determined in the sole opinion of City. Tenant shall not conduct any business, place any sales display, or advertise in any manner in areas outside the Premises, or on or about the Property.

6. TENANT IMPROVEMENTS

6.1. Tenant Improvement Work

Landlord shall not be required to provide any tenant improvement work in connection with this Lease.

7. ALTERATIONS

7.1. Tenant's Alterations

(a) General

Tenant shall not make or permit any alterations to the Building or to the heating, ventilating, air conditioning, plumbing, electrical, fire protection, life safety, security and other mechanical, electrical, communications systems of the Building ("Building Systems"), and shall not make or permit any alterations, installations, additions or improvements, structural or otherwise (collectively, "Alterations"), in, to or about the Premises, without City's prior written consent in each instance. All Alterations shall be done at Tenant's expense in accordance with plans and specifications approved by City, only by duly licensed and bonded contractors or mechanics approved by City, and subject to any conditions that City may reasonably impose. No Alterations may be made which would be visible from the exterior of the Building. If the cost of any Alterations is in excess of Five Thousand Dollars (\$5,000), then Tenant shall pay to City an administrative fee equal to ten percent (10%) of the total "hard" costs of the work to compensate City for the costs of review. City's approval or denial of plans and specifications shall be provided by the Director of Property.

(b) Asbestos

Without limiting Section 25.2 (No Hazardous Materials) below, in the event that asbestos-containing materials ("ACM") are determined to exist in or about the Premises, Tenant shall ensure that all Alterations and any asbestos related work, as defined in California Health & Safety Code Section 25914.1(b), is performed in compliance with all laws relating to asbestos, including but not limited to California Occupational Safety and Health (OSHA) regulations found in Title 8 of the California Code of Regulations, Sections 1502 and 1529. Additionally, Tenant shall distribute notifications to all employees and contractors as required pursuant to California Health & Safety Code Sections 25915 *et seq.* informing them of the existence of ACM and that moving, drilling, boring, or otherwise disturbing ACM may present a health risk and should not be attempted by an unqualified employee. No Alterations affecting ACM-containing areas or any asbestos related work shall be performed without City's prior written consent in each instance.

(c) Local Hiring Requirements

Tenant and its subtenants shall comply with the applicable requirements of San Francisco Administrative Code Section 6.22(G) in the performance of any Alterations, as further set forth in Section 27.31 below.

(d) Tenant's Alterations that Disturb or Remove Lead-Based Paint

Tenant, on behalf of itself and its Agents or Invitees, shall comply with all requirements of the San Francisco Building Code, Section 3407, and all other applicable present or future federal, state, local and administrative laws, rules, regulations, orders and other governmental requirements, the requirements of any board of fire underwriters or other similar body, any directive or occupancy certificate issued pursuant to any law by any public officer or officers acting in their regulatory capacity (collectively, "Laws"), including, without limitation, the California and United States Occupational Health and Safety Acts and their implementing regulations, when the work of improvement or alteration disturbs or removes exterior lead-based or "presumed" lead-based paint (as defined below). Tenant and its Agents or Invitees shall give to City three (3) business days prior written notice of any disturbance or removal of exterior lead-based or presumed lead-based paint. Further, Tenant and its Agents or Invitees, when disturbing or removing exterior lead-based or presumed lead-based paint, shall not use or cause to be used any of the following methods: **(a)** acetylene or propane burning and torching; **(b)** scraping, sanding or grinding without containment barriers or a High Efficiency Particulate Air filter ("HEPA") local vacuum exhaust tool; **(c)** hydroblasting or high-pressure wash without containment barriers; **(d)** abrasive blasting or sandblasting without containment barriers or a HEPA vacuum exhaust tool; and **(e)** heat guns operating above 1,100 degrees Fahrenheit. Paint on the exterior of buildings built before December 31, 1978, is presumed to be lead-based paint unless lead-based paint testing, as defined in Section 3407 of the San Francisco Building Code, demonstrates an absence of lead-based paint on the exterior surfaces of such buildings. Under this Section, lead-based paint is "disturbed or removed" if the work of improvement or alteration involves any action that creates friction, pressure, heat or a chemical reaction upon any lead-based or presumed lead-based paint on an exterior surface so as to abrade, loosen, penetrate, cut through or eliminate paint from that surface. Notice to City under this Lease shall not constitute notice to the City's Department of Building Inspection required under Section 3407 of the San Francisco Building Code.

7.2. Title to Improvements

Except for Tenant's Personal Property (as described in the next section), or as may be specifically provided to the contrary in the approved Plans, all appurtenances, fixtures, improvements, equipment, additions, and other property attached or affixed to or installed in the Premises at the Commencement Date or during the Term, including, without limitation, the Tenant Improvements and any Alterations, shall be and remain City's property. Tenant may not remove any such property at any time during or after the Term unless City so requests as further provided in Section 24 (Surrender), below.

7.3. Tenant's Personal Property

All furniture, trade fixtures, office equipment and articles of movable personal property installed in the Premises by or for the account of Tenant, without expense to City, and that can be removed without structural or other damage to the Premises (collectively, "Tenant's Personal Property") shall be and remain Tenant's property. Tenant may remove its Personal Property at any time during the Term, subject to the provisions of Section 24 (Surrender of Premises), below. Tenant shall pay any taxes or other impositions levied or assessed upon Tenant's Personal Property, at least ten (10) days prior to delinquency, and shall deliver satisfactory evidence of such payment to City upon request.

7.4. City's Alterations of the Building and Building Systems

City reserves the right at any time to make alterations, additions, repairs, deletions or improvements to the common areas or any other part of the Building or the Building Systems, provided that any such alterations or additions shall not materially adversely affect the functional utilization of the Premises for the uses permitted hereunder.

8. REPAIRS AND MAINTENANCE

8.1. City's Repairs

City shall repair and maintain the structural portions of the Building, including the Building Systems, the elevators and the common areas; provided, however, Tenant shall reimburse City for any damage, excluding normal wear and tear, caused by any act or omission of Tenant, its Agents or Invitees (as such terms are defined in Section 27.5 (Parties and their Agents) below). For the purpose of making any such repairs, City may use structures in the Premises where reasonably required by the character of the work to be performed, provided that such work shall not block the main entrance to the Premises nor unreasonably interfere with Tenant's business. Tenant waives any claim for damages for any injury or inconvenience to or interference with Tenant's business, any loss of occupancy or quiet enjoyment of the Premises or any other loss occasioned thereby.

8.2. Tenant's Repairs

Tenant shall maintain, at no expense to City, the Premises (including, without limitation, the floors, interior plumbing, electrical wiring, fixtures and equipment) in good repair and working order and in a clean, secure, safe and sanitary condition. Without limiting the foregoing, Tenant shall take such action and conduct its operations in such manner that no liquid seeps from the Premises to any other portion of the Building, and shall install and cause to be maintained in good condition and repair, at its expense, all grease traps or other equipment required for proper disposal of kitchen waste, and shall maintain all sanitary waste lines and facilities within the Premises and beyond the Premises to the point of intersection with common waste lines. Tenant shall promptly make all repairs and replacements: (a) at no cost to the City, (b) by licensed contractors or qualified mechanics approved by City, (c) so that the same shall be at least equal in quality, value and utility to the original work or installation, (d) in a manner and using equipment and materials that will not interfere with or impair the operations, use or occupation of the Building or the Building Systems, and (e) in accordance with any applicable Building Rules and Regulations (as defined in Section 23.1 (Rules and Regulations)) and all applicable laws, rules and regulations. If the cost of any such repairs or replacements is in excess of Five Thousand Dollars (\$5,000) and is due to acts or omissions of Tenant, its Agents or Invitees, then Tenant shall pay to City an administrative fee equal to ten percent (10%) of the total "hard" costs of the work. Tenant hereby waives all rights to make repairs at City's expense under Sections 1941 and 1942 of the California Civil Code or under any similar law, statute or ordinance now or hereafter in effect. If City determines in its reasonable judgment that the equipment, plumbing, and facilities described in this Section 8.2 are not being maintained as required hereunder, City may retain the services of a maintenance company selected by City to perform such maintenance and Tenant shall reimburse City for the cost thereof upon demand.

9. LIENS AND ENCUMBRANCES

9.1. Liens

Tenant shall keep the Premises and the rest of the Property free from any liens arising out of any work performed, material furnished or obligations incurred by or for Tenant. In the event Tenant does not, within five (5) days following the imposition of any such lien, cause the lien to be released of record by payment or posting of a proper bond, City shall have, in addition to all other remedies, the right, but not the obligation, to cause the lien to be released by such means as it shall deem proper, including, but not limited to, payment of the claim giving rise to such lien. All such sums paid by City and all expenses incurred by it in connection therewith (including, without limitation, reasonable attorneys' fees) shall be payable to City by Tenant upon demand. City shall have the right to post on the Premises any notices that City may deem proper for the protection of City, the Premises, and the Building, from mechanics' and materialmen's liens. Tenant shall give to City at least fifteen (15) days' prior written notice of commencement of any Alteration, repair or construction on the Premises. Tenant agrees to indemnify, defend and hold City and its Agents harmless from and against any claims for mechanic's, materialmen's or other liens in connection with any Alterations, repairs or construction on the Premises, or materials furnished or obligations incurred by or for Tenant.

9.2. Encumbrances

Tenant shall not create, permit or suffer any liens or encumbrances affecting any portion of the Premises, the Property or City's interest therein or under this Lease.

10. UTILITIES AND SERVICES

10.1. Utilities and Services

City shall provide the basic Building utilities and services described in the attached Exhibit C (the "Standard Utilities and Services") to the Premises, subject to the terms and conditions contained therein. Tenant shall be responsible for furnishing, at no cost to the City, any utilities or services other than or in excess of the Standard Utilities and Services that Tenant may need for its use of the Premises.

10.2. Water and Energy Conservation; Mandatory or Voluntary Restrictions

In the event any law, ordinance, code or governmental or regulatory guideline imposes mandatory or voluntary controls on City or the Property or any part thereof, relating to the use or conservation of energy, water, gas, light or electricity or the reduction of automobile or other emissions, or the provision of any other utility or service provided with respect to this Lease, or in the event City is required or elects to make alterations to any part of the Building in order to comply with such mandatory or voluntary controls or guidelines, such compliance and the making of such alterations shall in no event entitle Tenant to any damages, relieve Tenant of the obligation to pay the full Base Rent and Additional Charges reserved hereunder or to perform each of its other covenants hereunder or constitute or be construed as a constructive or other eviction of Tenant. City shall have the right at any time to install a water meter in the Premises or otherwise to measure the amount of water consumed on the Premises, and the cost of such

meter or other corrective measures and the installation and maintenance thereof shall be paid for by Tenant.

10.3. Excess Use

If Tenant requires any utilities or services to be provided by City hereunder in excess of the Standard Utilities and Services for the Premises, Tenant shall first procure City's written consent, which City may give or withhold in its sole discretion. In the case of City's consent, Tenant shall pay to City, as additional rent, the cost of such excess usage. Failure of City to bill Tenant for such excess utilities or services shall not impair City's right to bill Tenant for such costs at a later date. Without limiting the foregoing, Tenant shall not: (a) connect or use any apparatus, device or equipment that will require a dedicated circuit or that will impair the proper functioning or capacity of the Building Systems; or (b) connect any apparatus, device or equipment through electrical outlets except in the manner for which such outlets are designed and without the use of any device intended to increase the plug capacity of any electrical outlet; or (c) maintain at any time an electrical demand load in excess of any amount specified therefor in the Rules and Regulations. If at any time during the Term City has reason to believe that Tenant may be using any utility or service in excess of the amount allowed to the Premises pursuant to the Standard Building Utilities or Services, City shall have the right to install a separate meter in the Premises or to take other appropriate steps to measure the amount of utility or service used in the Premises, and the cost of such meter and all corrective measures, and the installation and maintenance thereof, shall be paid for by Tenant.

10.4. Floor Load

Tenant shall not place or install in the Premises any equipment that weighs in excess of the normal load-bearing capacity of the floors of the Building without City's prior written consent, which City may give or refuse in its sole discretion. If City consents to the placement or installation of any such machine or equipment in the Premises, Tenant, at no cost to the City, shall reinforce the floor of the Premises, pursuant to plans and specifications approved by City and otherwise in compliance with Section 7.1 (Tenant's Alterations), to the extent necessary to assure that no damage to the Premises or the Building or weakening of any structural supports will be occasioned thereby.

10.5. Interruption of Services

City's obligation to provide utilities and services for the Premises are subject to the Rules and Regulations of the Building, applicable Legal Requirements (as defined below) (including the rules or actions of the public utility company furnishing the utility or service), and shutdowns for maintenance and repairs, for security purposes, or due to strikes, lockouts, labor disputes, fire or other casualty, acts of God, or other causes beyond the control of City. In the event of an interruption in, or failure or inability to provide any service or utility for the Premises for any reason, such interruption, failure or inability shall not constitute an eviction of Tenant, constructive or otherwise, or impose upon City any liability whatsoever, including, but not limited to, liability for consequential damages or loss of business by Tenant; provided, however, that if such interruption, failure or inability impairs Tenant's ability to carry on its business in the Premises for a period of five (5) or more consecutive business days, then Tenant shall have the right, as Tenant's sole remedy, to abate the Rent based on the extent such interruption, failure or inability impairs Tenant's ability to carry on its business in the Premises. Tenant hereby waives

the provisions of California Civil Code Section 1932(1) or any other applicable existing or future Legal Requirement permitting the termination of this Lease due to such interruption, failure or inability.

11. COMPLIANCE WITH LAWS AND RISK MANAGEMENT REQUIREMENTS

11.1. Compliance with Laws

Tenant shall promptly comply, at no cost to the City, with all present or future laws, ordinance, resolution, regulation, requirement, proclamation, order or decree of any municipal, county, state or federal government or other governmental or regulatory authority relating to the Premises or the use or occupancy thereof (the "Legal Requirements") and with any and all recorded covenants, conditions and restrictions affecting the Property or any portion thereof, whether in effect at the time of the execution of this Lease or adopted or recorded at any time thereafter and whether or not within the present contemplation of the parties. Tenant further understands and agrees that it is Tenant's obligation, at no cost to the City, to cause the Premises and Tenant's uses thereof to be conducted in compliance with the Americans With Disabilities Act, 42 U.S.C.A. Sections 12101 *et seq.* and any other applicable disability access laws. Tenant shall not be required to make any structural Alterations in order to comply with such laws unless such Alterations shall be occasioned, in whole or in part, directly or indirectly, by the Tenant Improvements or any other Alterations, Tenant's use of the Premises, or any act or omission of Tenant, its Agents or Invitees. Any Alteration made by or on behalf of Tenant pursuant to the provisions of this Section shall comply with the provisions of Section 8.2 (Tenant's Repairs), above. The parties acknowledge and agree that Tenant's obligation to comply with all Legal Requirements as provided herein is a material part of the bargained for consideration under this Lease. Tenant's obligation under this Section shall include, without limitation, the responsibility of Tenant to make substantial or structural repairs and Alterations to the Premises (including any of the Tenant Improvements or any of Tenant's Alterations), regardless of, among other factors, the relationship of the cost of curative action to the Rent under this Lease, the length of the then remaining Term hereof, the relative benefit of the repairs to Tenant or City, the degree to which the curative action may interfere with Tenant's use or enjoyment of the Premises, the likelihood that the parties contemplated the particular Legal Requirement involved, and whether the Legal Requirement involved is related to Tenant's particular use of the Premises.

11.2. Regulatory Approvals

(a) Responsible Party

Tenant understands and agrees that Tenant's use of the Premises and construction of the Tenant Improvements permitted hereunder may require authorizations, approvals or permits from governmental regulatory agencies with jurisdiction over the Premises, including, without limitation, City and State agencies. Tenant shall be solely responsible for obtaining any and all such regulatory approvals. Tenant shall not seek any regulatory approval without first obtaining the written consent of City under this Lease. Tenant shall bear all costs associated with applying for and obtaining any necessary or appropriate regulatory approval and shall be solely responsible for satisfying any and all conditions imposed by regulatory agencies as part of a regulatory approval; provided, however, any such condition that could affect use or occupancy of the Property or City's interest therein must first be approved by City in its sole discretion. Any fines or penalties levied as a result of Tenant's failure to comply with the terms and

conditions of any regulatory approval shall be immediately paid and discharged by Tenant, and City shall have no liability, monetary or otherwise, for any such fines or penalties. Tenant shall Indemnify City and the other Indemnified Parties hereunder against all Claims (as such terms are defined in Section 18.2 below) arising in connection with Tenant's failure to obtain or failure by Tenant, its Agents or Invitees to comply with the terms and conditions of any regulatory approval.

(b) City Acting as Owner of Real Property

Tenant further understands and agrees that City is entering into this Lease in its capacity as a property owner with a proprietary interest in the Premises and not as a regulatory agency with police powers. Nothing in this Lease shall limit in any way Tenant's obligation to obtain any required approvals from City officials, departments, boards or commissions having jurisdiction over the Premises. By entering into this Lease, City is in no way modifying or limiting Tenant's obligation to cause the Premises to be used and occupied in accordance with all applicable laws, as provided further above.

11.3. Compliance with City's Risk Management Requirements

Tenant shall not do anything, or permit anything to be done, in or about the Premises which would be prohibited by or increase rates under a standard form fire insurance policy or subject City to potential premises liability. Tenant shall faithfully observe, at no cost to the City, any and all requirements of City's Risk Manager with respect to Tenant's use and occupancy of the Premises, so long as such requirements do not unreasonably interfere with Tenant's use of the Premises or are otherwise connected with standard prudent commercial practices of other landlords.

12. SUBORDINATION

This Lease is and shall be subordinate to any reciprocal easement agreement, ground lease, facilities lease or other underlying lease and the lien of any mortgage or deed of trust and all renewals, modifications, consolidations, replacements and extensions of any of the foregoing, that may now exist or hereafter be executed by City affecting the Property, or any part thereof, or City's interest therein, without the necessity of executing any instrument to effectuate such subordination; provided, however, upon Landlord's request, Tenant, or Tenant's successor-in-interest, shall execute and deliver any and all instruments desired by Landlord evidencing such subordination in the manner requested by Landlord. Notwithstanding the foregoing, City or the holder shall, in its respective discretion, have the right to subordinate any such interests to this Lease. If any ground lease or underlying lease terminates for any reason or any mortgage or deed of trust is foreclosed or a conveyance in lieu of foreclosure is made for any reason, Tenant shall attorn to the successor-in-interest to City, at the option of such successor-in-interest. The provisions of this Section shall be self-operative and no further instrument shall be required. Tenant agrees, however, to execute and deliver, upon demand by City and in the form requested by City, any additional documents evidencing the priority or subordination of this Lease.

13. INABILITY TO PERFORM

No actual or constructive eviction, in whole or in part, shall entitle Tenant to any abatement or diminution of Rent or relieve Tenant from any of its obligations under this Lease. If City is unable to perform or is delayed in performing any of City's obligations under this Lease, by reason of acts of God, accidents, breakage, repairs, strikes, lockouts, other labor disputes, protests, riots, demonstrations, inability to obtain utilities or materials or by any other reason beyond City's reasonable control, no such inability or delay shall constitute an eviction under this Lease, or impose any liability upon City or its Agents by reason of inconvenience, annoyance, interruption, injury or loss to or interference with Tenant's business or use and occupancy or quiet enjoyment of the Premises or any loss or damage occasioned thereby. Tenant hereby waives and releases any right to terminate this Lease under Section 1932, subdivision 1 of the California Civil Code or any similar law, statute or ordinance now or hereafter in effect.

14. DAMAGE AND DESTRUCTION

14.1. Damage and Destruction

If the Premises or the Building is damaged by fire or other casualty, then City shall repair the same provided that funds for such repairs are appropriated by City's Board of Supervisors, in its sole discretion, for such purpose and that such repairs can be made within two hundred ten (210) days after the date of such damage (the "Repair Period"). In the event such conditions are satisfied, this Lease shall remain in full force and effect except that Tenant shall be entitled to a proportionate reduction of Base Rent and Additional Charges during the period of such repairs based upon the extent to which such damage and the making of such repairs materially interferes with Tenant's use or occupancy of the Premises.

City shall use reasonable efforts to notify Tenant within ninety (90) days after the date of such damage whether or not such repairs can be made within the Repair Period, and City's determination thereof shall be binding on Tenant. If such repairs cannot be made within the Repair Period, City shall have the option to notify Tenant of: (a) City's intention to repair such damage and diligently prosecute such repairs to completion within a reasonable period after the Repair Period, subject to the Board of Supervisor's appropriation of all necessary funds, in which event this Lease shall continue in full force and effect and the Base Rent and Additional Charges shall be reduced as provided herein; or (b) City's election to terminate this Lease as of a date specified in such notice, which date shall be not less than thirty (30) nor more than sixty (60) days after notice is given by City. In case of termination, the Base Rent and Additional Charges shall be reduced as provided above, and Tenant shall pay such reduced Base Rent and Additional Charges up to the date of termination.

If at any time during the last twelve (12) months of the Term of this Lease, the Premises or the Building is damaged or destroyed, then either City or Tenant may terminate this Lease by giving written notice to the other party of its election to do so within thirty (30) days after the date of the occurrence of such damage; provided, however, Tenant may terminate only if such damage or destruction substantially impairs its use or occupancy of the Premises for the uses permitted hereunder. The effective date of termination shall be specified in the notice of termination, which date shall not be more than thirty (30) days from the date of the notice.

Notwithstanding anything to the contrary in this Lease, City shall have no obligation to repair the Premises or the Building in the event the damage or destruction is attributable to any act or omission of Tenant, its Agents or Invitees. In no event shall City be required to repair any damage to Tenant's Personal Property or any paneling, decorations, railings, floor coverings, or any Tenant Improvements or Alterations installed or made on the Premises by or at the expense of Tenant. In the event the Premises or the Building is substantially damaged or destroyed and City intends to rebuild for public purposes inconsistent with this Lease, City may terminate this Lease upon written notice to Tenant.

14.2. Waiver

City and Tenant intend that the provisions of this Section govern fully in the event of any damage or destruction and accordingly, City and Tenant each hereby waives the provisions of Section 1932, subdivision 2, Section 1933, subdivision 4 and Sections 1941 and 1942, of the Civil Code of California or under any similar law, statute or ordinance now or hereafter in effect.

15. EMINENT DOMAIN

15.1. Definitions

(a) "Taking" means a taking or damaging, including severance damage, by eminent domain, inverse condemnation or for any public or quasi-public use under law. A Taking may occur pursuant to the recording of a final order of condemnation, or by voluntary sale or conveyance in lieu of condemnation or in settlement of a condemnation action.

(b) "Date of Taking" means the earlier of (i) the date upon which title to the portion of the Property taken passes to and vests in the condemnor or (ii) the date on which Tenant is dispossessed.

(c) "Award" means all compensation, sums or anything of value paid, awarded or received for a Taking, whether pursuant to judgment, agreement, settlement or otherwise.

(d) "Improvements Pertaining to the Realty" means machinery or equipment installed for use on the Property that cannot be removed without a substantial economic loss or without substantial damage to the property on which it is installed, regardless of the method of installation. In determining whether particular property can be removed "without a substantial economic loss," the value of the machinery or equipment in place and considered as part of the realty should be compared with its value if it were removed and sold.

15.2. General

If during the Term or during the period between the execution of this Lease and the Commencement Date, there is any Taking of all or any part of the Premises or any interest in this Lease, the rights and obligations of the parties hereunder shall be determined pursuant to this Section. City and Tenant intend that the provisions hereof govern fully in the event of a Taking and accordingly, the parties each hereby waive any right to terminate this Lease in whole or in part under Sections 1265.110, 1265.120, 1265.130, and 1265.140 of the California Code of Civil Procedure or under any similar law now or hereafter in effect.

15.3. Total Taking; Automatic Termination

If there is a total Taking of the Premises, then this Lease shall terminate as of the Date of Taking.

15.4. Partial Taking; Election to Terminate.

(a) If there is a Taking of any portion (but less than all) of the Premises, then this Lease shall terminate in its entirety under either of the following circumstances: (i) if all of the following exist: (A) the partial Taking renders the remaining portion of the Premises untenable or unsuitable for continued use by Tenant, (B) the condition rendering the Premises untenable or unsuitable either is not curable or is curable but City is unwilling or unable to cure such condition, and (C) Tenant elects to terminate; or (ii) if City elects to terminate; provided, however, that this Lease shall not terminate if Tenant agrees to, and does, pay full Rent and Additional Charges, without abatement, and otherwise agrees to, and does, fully perform all of its obligations hereunder.

(b) If there is a partial Taking of a substantial portion of the Building but not the Premises, City shall have the right to terminate this Lease in its entirety.

(c) Either party electing to terminate under the provisions of this Section 15 shall do so by giving the other party written notice to the other party before or within thirty (30) days after the Date of Taking, and thereafter this Lease shall terminate upon the later of the thirtieth (30th) day after such written notice is given or the Date of Taking.

15.5. Rent; Award

Upon termination of this Lease in its entirety pursuant to Section 15.3, or pursuant to an election under Section 15.4 above, then: (a) Tenant's obligation to pay Rent shall continue up until the date of termination, and thereafter shall cease (except that Rent shall be reduced as provided in Section 15.6 below for any period during which this Lease continues in effect after the Date of Taking), and (b) City shall be entitled to the entire Award in connection therewith (including, but not limited to, any portion of the Award made for the value of the leasehold estate created by this Lease and any Improvements Pertaining to the Realty), and Tenant shall have no claim against City for the value of any unexpired term of this Lease, provided that Tenant may make a separate claim for compensation, and Tenant shall receive any Award made specifically to Tenant, for Tenant's relocation expenses or the interruption of or damage to Tenant's business or damage to movable Tenant's Personal Property.

15.6. Partial Taking; Continuation of Lease

If there is a partial Taking of the Premises under circumstances where this Lease is not terminated in its entirety under Section 15.4 above, then this Lease shall terminate as to the portion of the Premises so taken, but shall remain in full force and effect as to the portion not taken, and the rights and obligations of the parties shall be as follows: (a) Base Rent shall be reduced by an amount that is in the same ratio to the Base Rent as the area of the Premises taken bears to the area of the Premises prior to the Date of Taking; provided, however, in no event shall the monthly Base Rent be reduced to less than seventy-five percent (75%) of the monthly Base Rent immediately prior to the Date of Taking, and (b) City shall be entitled to the entire

Award in connection therewith (including, but not limited to, any portion of the Award made for the value of the leasehold estate created by this Lease), and Tenant shall have no claim against City for the value of any unexpired term of this Lease, provided that Tenant may make a separate claim for compensation, and Tenant shall receive any Award made specifically to Tenant, for Tenant's relocation expenses or the interruption of or damage to Tenant's business or damage to movable Tenant's Personal Property.

15.7. Temporary Takings

Notwithstanding anything to contrary in this Section, if a Taking occurs with respect to all or any part of the Premises for a limited period of time not in excess of one hundred eighty (180) consecutive days, this Lease shall remain unaffected thereby, and Tenant shall continue to pay Rent and to perform all of the terms, conditions and covenants of this Lease. In the event of such temporary Taking, Tenant shall be entitled to receive that portion of any Award representing compensation for the use or occupancy of the Premises during the Term up to the total Rent owing by Tenant for the period of the Taking, and City shall be entitled to receive the balance of any Award.

16. ASSIGNMENT AND SUBLETTING

16.1. Restriction on Assignment and Subletting

Tenant shall not directly or indirectly (including, without limitation, by merger, acquisition or other transfer of any controlling interest in Tenant), voluntarily or by operation of law, sell, assign, encumber, pledge or otherwise transfer any part of its interest in or rights with respect to the Premises or its leasehold estate hereunder (collectively, an "Assignment"), or permit or license any portion of the Premises to be used or occupied by anyone other than itself, or sublet any portion of the Premises (collectively, "Sublease"), without City's prior written consent in each instance, as provided herein. Notwithstanding the foregoing, Tenant may Assign this Lease or Sublet any or all portions of the Premises to any Tenant's Affiliate (as defined below) without obtaining the consent of City by giving City written notice of its intent thereof at least fifteen (15) business days before the proposed effective date of such transfer. As used in this Section, the term "Tenant's Affiliate" shall mean, any of the following: (1) any person or entity owning, directly or indirectly, fifty percent (50%) or more of the ownership interests of Tenant (an "Owning Person"), (2) any entity, fifty percent (50%) or more of the ownership interests of which are owned, directly or indirectly, by any Owning Person, (3) any entity, fifty percent (50%) or more of the ownership interests of which are owned, directly or indirectly, by Tenant.

16.2. Notice of Proposed Transfer

If Tenant desires to enter into an Assignment or a Sublease, it shall give written notice (a "Notice of Proposed Transfer") to City of its intention to do so. The Notice of Proposed Transfer shall identify the proposed transferee and state the terms and conditions of the proposed Assignment or Sublease. Tenant shall deliver to City with its request for City's consent the proposed Assignment or Sublease and current financial statements of the proposed Transferee, prepared by an independent certified public accountant, and promptly upon City's request for same, any additional documents or information reasonably related to the proposed transaction or Transferee.

16.3. City's Response

Within twenty (20) business days after City's receipt of the Notice of Proposed Transfer (the "Response Period"), City may elect, by written notice to Tenant, to: (a) sublease the portion of the Premises specified in the Notice of Proposed Transfer on the terms and conditions set forth in such notice, except as otherwise provided in Section 16.4 (Sublease or Recapture Space), or (b) terminate this Lease as to the portion (including all) of the Premises that is specified in the Notice of Proposed Transfer, with a proportionate reduction in Base Rent (a "Recapture").

If City declines to exercise either of its options provided above, then Tenant shall have ninety (90) days following the earlier of (i) City's notice that it will not elect either such option or (ii) the expiration of the Response Period, to enter into such Assignment or Sublease, subject to City's prior written approval of the proposed assignee or subtenant (collectively, "Transferee") and the terms and conditions of the proposed Sublease or Assignment. However, one hundred percent (100%) of any rent or other consideration realized by Tenant under any such Assignment or Sublease in excess of the Base Rent and Additional Charges payable hereunder (or the amount thereof proportionate to the portion of the Premises subject to such Sublease or Recapture) shall be paid to City, after Tenant has recovered any reasonable brokers' commissions and the reasonable cost of any leasehold improvements that Tenant has incurred in connection with such Sublease or Recapture. Tenant shall provide City with such information regarding the proposed Transferee and the Assignment or Sublease as City may reasonably request. City agrees that it will not unreasonably withhold its approval of any proposed Transferee. The parties hereto agree and acknowledge that, among other circumstances for which City may reasonably withhold its consent to a proposed Transferee or a Sublease or Assignment, it shall be reasonable for City to withhold its consent where: (i) the assignment or subletting would involve a change in use from that expressly permitted under this Lease; (ii) City disapproves of the proposed Transferee's reputation or creditworthiness; (iii) City determines that the character of the business that would be conducted by the proposed assignee or subtenant at the Premises, or the manner of conducting such business, would be inconsistent with the character of the Building as a first-class building; (iv) City determines that the proposed assignee may be unable to perform all of Tenant's obligations under this Lease or the proposed subtenant may be unable to perform all of its obligations under the proposed sublease; or (v) the proposed Transferee does not in City's reasonable opinion have sufficient experience operating a business similar to the business to be operated in the Premises at a profit.

If after City declines to exercise any of the foregoing options Tenant desires to enter into such Assignment or Sublease (i) on terms and conditions materially more favorable to Tenant than those contained in the Notice of Proposed Transfer or (ii) with a Transferee that is currently a tenant or other occupant of the Building, then Tenant shall give City a new Notice of Proposed Transfer, which notice shall state the terms and conditions of such Assignment or Sublease and identify the proposed Transferee, and City shall again be entitled to elect one of the options provided in clauses (a) and (b) at any time within twenty (20) business days after City's receipt of such new Notice of Proposed Transfer.

In the event City elects either of the options provided in clauses (a) or (b), City shall be entitled to enter into a lease, sublease or assignment agreement with respect to the Premises (or portion thereof specified in such new Notice of Proposed Transfer) with the proposed Transferee identified in Tenant's notice.

Notwithstanding the foregoing, if any event of default by Tenant is outstanding hereunder at the time of Tenant's Notice of Proposed Transfer (or if any event shall have occurred which with the giving of notice or the passage of time or both would constitute such a default), then City may elect by notice to Tenant to refuse to consent to Tenant's proposed Transfer and pursue any of its right or remedies hereunder or at law or in equity.

16.4. Sublease or Recapture Space

If City elects to Sublease or Recapture from Tenant as described in Section 16.3, City's Response, the following shall apply:

(a) In the case of a Sublease, (i) City shall have the right to use the portion of the Premises covered by the Notice of Proposed Transfer (the "Sublease Space") for any legal purpose, (ii) the rent payable by City to Tenant shall be the lesser of (A) the amount in the Notice of Proposed Transfer or (B) the Base Rent payable by Tenant under this Lease at the time of the Sublease (or the amount thereof proportionate to the Sublease Space if for less than the entire Premises), (iii) City may make alterations and improvements to the Sublease Space and may remove any such alterations or improvements, in whole or in part, prior to or upon the expiration of the Sublease, provided that City shall repair any damage or injury to the Sublease Space caused by such removal, (iv) City shall have the right to further sublease or assign the Sublease Space to any party, without the consent of Tenant, and (v) Tenant shall pay to City on demand any costs incurred by City in physically separating the Sublease Space (if less than the entire Premises) from the balance of the Premises and in complying with any applicable laws or regulations relating to such separation.

(b) In the case of Recapture, (i) the portion of the Premises subject to the Recapture (the "Recapture Space") shall be deleted from the Premises for all purposes hereunder, and Tenant and City shall be relieved of all their rights and obligations hereunder with respect to the Recapture Space except to the extent the same would survive the Expiration Date or other termination of this Lease pursuant to the provisions hereof, and (ii) City shall pay any cost incurred in physically separating the Recapture Space (if less than the entire Premises) from the balance of the Premises and in complying with any applicable governmental laws or regulations relating to such separation.

16.5. Effect of Sublease or Assignment

No Sublease or Assignment by Tenant nor any consent by City thereto shall relieve Tenant, or any guarantor, of any obligation to be performed by Tenant under this Lease. Any Sublease or Assignment not in compliance with this Section shall be void and, at City's option, shall constitute a material default by Tenant under this Lease. The acceptance of any Base Rent or other payments by City from a proposed Transferee shall not constitute consent to such Sublease or Assignment by City or a recognition of any Transferee, or a waiver by City of any failure of Tenant or other transferor to comply with this Section. If there is an Assignment or Sublet, whether in violation of or in compliance with this Section, in the event of default by any Transferee, or any successor of Tenant, in the performance or observance of any of the terms of this Lease or any Sublease or Assignment agreement, City may proceed directly against Tenant without the necessity of exhausting remedies against such Transferee or successor.

16.6. Assumption by Transferee

Each Transferee (other than City) shall assume all obligations of Tenant under this Lease and shall be liable jointly and severally with Tenant for the payment of the Base Rent and Additional Charges, and for the performance of all the terms, covenants and conditions to be performed on Tenant's part hereunder. No Assignment shall be binding on City unless Tenant or Transferee has delivered to City a counterpart of the Assignment and an instrument in recordable form that contains a covenant of assumption by such Transferee satisfactory in form and substance to City. However, the failure or refusal of such Transferee to execute such instrument of assumption shall not release such Transferee from its liability as set forth above. Tenant shall reimburse City on demand for any reasonable costs that may be incurred by City in connection with any proposed Sublease or Assignment, including, without limitation, the costs of making investigations as to the acceptability of the proposed Transferee and legal costs incurred in connection with the granting of any requested consent.

16.7. Indemnity for Relocation Benefits

Without limiting Section 16.6 (Assumption by Transferee) above, Tenant shall cause any Transferee to expressly waive entitlement to any and all relocation assistance and benefits in connection with this Lease. Tenant shall Indemnify City for any and all Losses arising out of any relocation assistance or benefits payable to any Transferee.

17. DEFAULT; REMEDIES

17.1. Events of Default

Any of the following shall constitute an event of default (the "Event of Default") by Tenant hereunder:

(a) a failure to pay Base Rent or Additional Charges when due, and such failure continues for three (3) days after the date of written notice by City. However, City shall not be required to provide such notice more than twice during any twelve (12) month period, and any such failure by Tenant after Tenant has received two (2) such notices in such 12-month period shall constitute a default by Tenant hereunder without any further action by City or opportunity of Tenant to cure except as may be required by Section 1161 of the California Code of Civil Procedure;

(b) a failure to comply with any other covenant, condition or representation made under this Lease and such failure continues for fifteen (15) days after the date of written notice by City, provided that if such default is not capable of cure within such 15-day period, Tenant shall have a reasonable period to complete such cure if Tenant promptly undertakes action to cure such default within such 15-day period and thereafter diligently prosecutes the same to completion within sixty (60) days after the receipt of notice of default from City. City shall not be required to provide such notice more than twice in any twelve (12) month period with respect to any material non-monetary defaults and after the second notice in any calendar year, any subsequent failure by Tenant during such 12-month period shall constitute an Event of Default hereunder;

(c) a vacation or abandonment of the Premises for a continuous period in excess of five (5) business days;

(d) Tenant's failure to be open for business for the Minimum Hours more than three (3) times in any twelve (12) month period; or

(e) an appointment of a receiver to take possession of all or substantially all of the assets of Tenant, or an assignment by Tenant for the benefit of creditors, or any action taken or suffered by Tenant under any insolvency, bankruptcy, reorganization, moratorium or other debtor relief act or statute, whether now existing or hereafter amended or enacted, if any such receiver, assignment or action is not released, discharged, dismissed or vacated within sixty (60) days.

17.2. Remedies

Upon the occurrence of an Event of Default Landlord shall have the following remedies, which shall not be exclusive but shall be cumulative and shall be in addition to any other remedies now or hereafter allowed by law or in equity:

(a) Landlord may terminate Tenant's right to possession of the Premises at any time by written notice to Tenant. Tenant expressly acknowledges that in the absence of such written notice from Landlord, no other act of Landlord, including, but not limited to, its re-entry into the Premises, its efforts to relet the Premises, its reletting of the Premises for Tenant's account, its storage of Tenant's Personal Property and trade fixtures, its acceptance of keys to the Premises from Tenant, its appointment of a receiver, or its exercise of any other rights and remedies under this Section 17.2 or otherwise at law, shall constitute an acceptance of Tenant's surrender of the Premises or constitute a termination of this Lease or of Tenant's right to possession of the Premises.

Upon such termination in writing of Tenant's right to possession of the Premises, this Lease shall terminate and Landlord shall be entitled to recover damages from Tenant as provided in California Civil Code Section 1951.2 or any other applicable existing or future Legal Requirement providing for recovery of damages for such breach, including but not limited to the following:

- (i) The reasonable cost of recovering the Premises; plus
- (ii) The reasonable cost of removing Tenant's Alterations, trade fixtures and improvements; plus
- (iii) All unpaid rent due or earned hereunder prior to the date of termination, less the proceeds of any reletting or any rental received from subtenants prior to the date of termination applied as provided in Section 17.2(b) below, together with interest at the Interest Rate, on such sums from the date such rent is due and payable until the date of the award of damages; plus
- (iv) The amount by which the rent which would be payable by Tenant hereunder, including Additional Charges under Section 4.3 above, as reasonably estimated by Landlord, from the date of termination until the date of the award of damages, exceeds the

amount of such rental loss as Tenant proves could have been reasonably avoided, together with interest at the Interest Rate on such sums from the date such rent is due and payable until the date of the award of damages; plus

(v) The amount by which the rent which would be payable by Tenant hereunder, including Additional Charges under Section 4.3 above, as reasonably estimated by Landlord, for the remainder of the then term, after the date of the award of damages exceeds the amount such rental loss as Tenant proves could have been reasonably avoided, discounted at the discount rate published by the Federal Reserve bank of San Francisco for member banks at the time of the award plus one percent (1%); plus

(vi) Such other amounts in addition to or in lieu of the foregoing as may be permitted from time to time by applicable law, including without limitation any other amount necessary to compensate Landlord for all the detriment proximately caused by Tenant's failure to perform its obligations under this Lease which in the ordinary course of things would be likely to result therefrom.

(b) Landlord has the remedy described in California Civil Code Section 1951.4 (a landlord may continue the lease in effect after the tenant's breach and abandonment and recover rent as it becomes due, if the tenant has the right to sublet and assign subject only to reasonable limitations), and may continue this Lease in full force and effect and may enforce all of its rights and remedies under this Lease, including, but not limited to, the right to recover rent as it becomes due. After the occurrence of an Event of Default, Landlord may enter the Premises without terminating this Lease and sublet all or any part of the Premises for Tenant's account to any person, for such term (which may be a period beyond the remaining term of this Lease), at such rents and on such other terms and conditions as Landlord deems advisable. In the event of any such subletting, rents received by Landlord from such subletting shall be applied (i) first, to the payment of the costs of maintaining, preserving, altering and preparing the Premises for subletting, the other costs of subletting, including but not limited to brokers' commissions, attorneys' fees and expenses of removal of Tenant's Personal Property, trade fixtures and Alterations; (ii) second, to the payment of rent then due and payable hereunder; (iii) third, to the payment of future rent as the same may become due and payable hereunder; (iv) fourth, the balance, if any, shall be paid to Tenant upon (but not before) expiration of the term of this Lease. If the rents received by Landlord from such subletting, after application as provided above, are insufficient in any month to pay the rent due and payable hereunder for such month, Tenant shall pay such deficiency to Landlord monthly upon demand. Notwithstanding any such subletting for Tenant's account without termination, Landlord may at any time thereafter, by written notice to Tenant, elect to terminate this Lease by virtue of a previous Event of Default.

During the continuance of an Event of Default, for so long as Landlord does not terminate Tenant's right to possession of the Premises and subject to Section 16 (Assignment and Subletting) and the options granted to Landlord thereunder, Landlord shall not unreasonably withhold its consent to an assignment or sublease of Tenant's interest in the Premises or in this Lease.

(c) During the continuance of an Event of Default, Landlord may enter the Premises without terminating this Lease and remove all Tenant's Personal Property, Alterations and trade fixtures from the Premises and store them at Tenant's risk and expense. If Landlord removes such property from the Premises and stores it at Tenant's risk and expense, and if

Tenant fails to pay the cost of such removal and storage after written demand therefor and/or to pay any rent then due, then after the property has been stored for a period of thirty (30) days or more Landlord may sell such property at public or private sale, in the manner and at such times and places as Landlord deems commercially reasonable following reasonable notice to Tenant of the time and place of such sale. The proceeds of any such sale shall be applied first to the payment of the expenses for removal and storage of the property, the preparation for and the conducting of such sale, and for attorneys' fees and other legal expenses incurred by Landlord in connection therewith, and the balance shall be applied as provided in Section 17.2(b) above.

Tenant hereby waives all claims for damages that may be caused by Landlord's re-entering and taking possession of the Premises or removing and storing Tenant's Personal Property pursuant to this Section 17.2, and Tenant shall indemnify, defend and hold Landlord harmless from and against any and all Claims resulting from any such act. No re-entry by Landlord shall constitute or be construed as a forcible entry by Landlord.

(d) Landlord may require Tenant to remove any and all Alterations from the Premises or, if Tenant fails to do so within ten (10) days after Landlord's request, Landlord may do so at Tenant's expense.

(e) Landlord may cure the Event of Default at Tenant's expense, it being understood that such performance shall not waive or cure the subject Event of Default. If Landlord pays any sum or incurs any expense in curing the Event of Default, Tenant shall reimburse Landlord upon demand for the amount of such payment or expense with interest at the Interest Rate from the date the sum is paid or the expense is incurred until Landlord is reimbursed by Tenant. Any amount due Landlord under this subsection shall constitute additional rent hereunder.

17.3. Waiver of Redemption

Tenant hereby waives, for itself and all persons claiming by and under Tenant, all rights and privileges which it might have under any present or future Legal Requirement to redeem the Premises or to continue this Lease after being dispossessed or ejected from the Premises.

17.4. City's Right to Cure Tenant's Defaults

If Tenant defaults in the performance of any of its obligations under this Lease, then City may, at its sole option, remedy such default for Tenant's account and at Tenant's expense by providing Tenant with three (3) days' prior written or oral notice of City's intention to cure such default (except that no such prior notice shall be required in the event of an emergency as determined by City). Such action by City shall not be construed as a waiver of such default or any rights or remedies of City, and nothing herein shall imply any duty of City to do any act that Tenant is obligated to perform. Tenant shall pay to City upon demand, as additional rent, all costs, damages, expenses or liabilities incurred by City, including, without limitation, reasonable attorneys' fees, in remedying or attempting to remedy such default. Tenant's obligations under this Section shall survive the termination of this Lease.

18. WAIVER OF CLAIMS; INDEMNIFICATION

18.1. Limitation on City's Liability; Waiver of Claims

City shall not be responsible for or liable to Tenant, and Tenant hereby assumes the risk of, and waives and releases City and its Agents from all Claims (as defined below) for, any injury, loss or damage to any person or property in or about the Premises by or from any cause whatsoever including, without limitation, (i) any act or omission of persons occupying adjoining premises or any part of the Building adjacent to or connected with the Premises, (ii) theft, (iii) explosion, fire, steam, oil, electricity, water, gas or rain, pollution or contamination, (iv) stopped, leaking or defective Building Systems, (v) Building defects, and (vi) any other acts, omissions or causes. Nothing in this Section shall relieve City from liability caused solely and directly by the gross negligence or willful misconduct of City or its Agents, but City shall not be liable under any circumstances for any consequential, incidental or punitive damages.

18.2. Tenant's Indemnity

Tenant, on behalf of itself and its successors and assigns, shall indemnify, protect, defend and hold harmless ("Indemnify") City including, but not limited to, all of its boards, commissions, departments, agencies and other subdivisions, including, without limitation, all of its and their Agents, and their respective heirs, legal representatives, successors and assigns (individually and collectively, the "Indemnified Parties"), and each of them, from and against any and all liabilities, losses, costs, claims, causes of action, judgments, settlements, damages, liens, fines, penalties and expenses, including, without limitation, direct and vicarious liability of every kind (collectively, "Claims"), incurred in connection with or arising in whole or in part from: (a) any accident, injury to or death of a person, including, without limitation, employees of Tenant, or loss of or damage to property, howsoever or by whomsoever caused, occurring in or about the Premises; (b) any default by Tenant under this Lease; (c) the use or occupancy of the Premises by Tenant, its Agents or Invitees or any person or entity claiming through or under any of them; (d) the condition of the Premises; (e) any construction or other work undertaken by Tenant on the Premises whether before or during the Term of this Lease; or (f) any acts, omissions or negligence of Tenant, its Agents or Invitees, in, on or about the Premises or the Property; all regardless of the active or passive negligence of, and regardless of whether liability without fault is imposed or sought to be imposed on, the Indemnified Parties, except to the extent that such Indemnity is void or otherwise unenforceable under applicable law and further except only such Claims as are caused exclusively by the willful misconduct or gross negligence of the Indemnified Parties. The foregoing Indemnity shall include, without limitation, reasonable fees of attorneys, consultants and experts and related costs and City's costs of investigating any Claim. Tenant specifically acknowledges and agrees that it has an immediate and independent obligation to defend the City from any claim which actually or potentially falls within this indemnity provision even if such allegation is or may be groundless, fraudulent or false, which obligation arises at the time such claim is tendered to Tenant by City and continues at all times thereafter. Tenant's obligations under this Section shall survive the termination of the Lease.

19. INSURANCE

19.1. Tenant's Insurance

(a) Tenant, at no cost to the City, shall procure and keep in effect at all times during the Term insurance as follows:

(i) Commercial general liability insurance with limits not less than Two Million Dollars (\$2,000,000) each occurrence combined single limit for bodily injury and property damage, including contractual liability, independent contractors, broad-form property damage, fire damage legal liability (of not less than Fifty Thousand Dollars (\$50,000)), personal injury, products and completed operations, and explosion, collapse and underground (XCU).

(ii) Worker's Compensation Insurance with Employer's Liability Limits not less than One Million Dollars (\$1,000,000) each accident.

(iii) Business automobile liability insurance with limits not less than One Million Dollars (\$1,000,000) each occurrence combined single limit for bodily injury and property damage, including owned and non-owned and hired vehicles, as applicable, if Tenant uses automobiles in connection with its use of the Premises.

(iv) Such other insurance as is generally required by commercial owners on buildings similar in size, character, age and location as the Building, as may change from time to time.

(b) Should any of the required insurance be provided under a claims-made form, Tenant shall maintain such coverage continuously throughout the Term and, without lapse, for a period of three (3) years beyond the expiration or termination of this Lease, to the effect that, should occurrences during the Term give rise to claims made after expiration or termination of this Lease, such claims shall be covered by such claims-made policies.

(c) Should any of the required insurance be provided under a form of coverage that includes a general annual aggregate limit or provides that claims investigation or legal defense costs be included in such general annual aggregate limit, such general aggregate limit shall double the occurrence or claims limits specified above.

(d) All liability insurance policies shall be endorsed to provide the following:

(i) Name as additional insured the City and County of San Francisco, its officers, agents and employees.

(ii) That such policies are primary insurance to any other insurance available to the additional insureds, with respect to any claims arising out of this Lease, and that insurance applies separately to each insured against whom claim is made or suit is brought.

(e) Each insurance policy required pursuant to Section 19.1(a) above shall be issued by an insurance company licensed in the State of California and with a general policyholders' rating of "A-" or better and a financial size ranking of "Class VIII" or higher in the most recent edition of Best's Insurance Guide.

(f) All policies shall be endorsed to provide thirty (30) days' advance written notice to City of cancellation or intended non-renewal (or ten (10) days' advance written notice in case of nonpayment of premium), mailed to the address(es) for City set forth in the Basic Lease Information.

(g) Tenant shall deliver to City certificates of insurance and endorsements from insurers in a form satisfactory to City, evidencing the coverage required hereunder, on or before the Commencement Date, together with complete copies of the policies promptly upon City's request, and Tenant shall provide City with certificates or policies thereafter at least thirty (30) days before the expiration dates of expiring policies. In the event Tenant shall fail to procure such insurance, or to deliver such policies or certificates, City may procure, at its option, without waiving any rights or remedies which City may have for Tenant's default hereunder, the same for the account of Tenant, and the cost thereof shall be paid to City within five (5) days after delivery to Tenant of bills therefor.

(h) Upon City's request, Tenant and City shall periodically review the limits and types of insurance carried pursuant to this Section. If the general commercial practice in the City and County of San Francisco is to carry liability insurance in an amount or coverage materially greater than the amount or coverage then being carried by Tenant for risks comparable to those associated with the Premises, then Tenant shall, at City's request, increase the amounts or coverage carried by Tenant to conform to such general commercial practice.

(i) Tenant's compliance with the provisions of this Section shall in no way relieve or decrease Tenant's liability under Section 18.2 (Tenant's Indemnity), or any of Tenant's other obligations under this Lease.

(j) Notwithstanding anything to the contrary in this Lease, if any of the required insurance coverage lapses, City may elect, at its sole discretion, to terminate this Lease by delivering to Tenant three (3) days' written notice of termination and, if so delivered, this Lease shall so terminate unless Tenant renews the insurance coverage within the 3-day notice period.

19.2. Tenant's Personal Property

Tenant shall be responsible, at no cost to the City, for separately insuring Tenant's Personal Property.

19.3. City's Self Insurance

Tenant acknowledges that City self-insures against casualty, property damage and public liability risks and agrees that City may at its sole election, but shall not be required to, carry any third party insurance with respect to the Building, the Premises or otherwise.

19.4. Waiver of Subrogation

Notwithstanding anything to the contrary in this Lease, City and Tenant (each a "Waiving Party") each hereby waives any right of recovery against the other party for any loss or damage relating to the Building or the Premises or any operations or contents therein, whether or not such loss is caused by the fault or negligence of such other party, to the extent such loss or damage is covered by third party insurance that is required to be purchased by the Waiving Party

under this Lease or is actually covered by insurance held by the Waiving Party or its agents. Each Waiving Party agrees to obtain a waiver of subrogation rights endorsements from applicable insurance carriers issuing policies relating to the Building or the Premises; provided, the failure to obtain any such endorsement shall not affect the above waiver.

20. ACCESS BY CITY

City reserves for itself and any of its designated Agents, the right to enter the Premises as follows: (i) on a regular basis without advance notice to supply any necessary or agreed-upon service to be provided by City hereunder; (ii) on an occasional basis, at all reasonable times after giving Tenant reasonable advance written or oral notice, to show the Premises to prospective tenants or other interested parties, to post notices of non-responsibility, to conduct any environmental audit of Tenant's use of the Premises, to repair, alter or improve any part of the Building, Building Systems or the Premises, and for any other lawful purpose; and (iii) on an emergency basis without notice whenever City believes that emergency access is required. City shall have the right to use any means that it deems proper to open doors in an emergency in order to obtain access to any part of the Premises, and any such entry shall not be construed or deemed to be a forcible or unlawful entry into or a detainer of, the Premises, or an eviction, actual or constructive, of Tenant from the Premises or any portion thereof. Tenant shall not alter any lock or install any new or additional locking devices without the prior written consent of City. All locks installed in the Premises (excluding Tenant's vaults, safes or special security areas, if any, designated by Tenant in writing to City) shall be by keyed to the Building master key system, and City shall at all times have a key with which to unlock all such doors.

21. CERTIFICATES

21.1. Tenant's Certificates

Tenant, at any time and from time to time upon not less than ten (10) days' prior notice from City, shall execute and deliver to City or to any party designated by City a certificate stating: (a) that Tenant has accepted the Premises, (b) the Commencement Date and Expiration Date of this Lease, (c) that this Lease is unmodified and in full force and effect (or, if there have been modifications, that the Lease is in full force and effect as modified and stating the modifications), (d) whether or not there are then existing any defenses against the enforcement of any of Tenant's obligations hereunder (and if so, specifying the same), (e) whether or not there are any defaults then existing under this Lease (and if so specifying the same), (f) the dates, if any, to which the Base Rent and Additional Charges have been paid, and (g) any other information that may be required.

Any such statement may be conclusively relied upon by a prospective purchaser or ground lessee of the Building or by a lender obtaining a lien on the Building as security. If Tenant fails to deliver such statement within the time required hereunder, such failure shall be conclusive upon Tenant that (i) this Lease is in full force and effect, without modification except as may be represented by Landlord, (ii) there are no uncured defaults in Landlord's performance of its obligations hereunder, (iii) not more than one month's installment of Monthly Base Rent has been paid in advance, and (iv) any other statements of fact included by Landlord in such statement are correct.

21.2. City's Certificates

City, at any time and from time to time upon not less than ten (10) days' prior notice from Tenant, shall execute and deliver to Tenant or to any party designated by Tenant a certificate stating: (a) the Commencement Date and Expiration Date of this Lease, (b) that this Lease is unmodified and in full force and effect (or, if there have been modifications, that the Lease is in full force and effect as modified and stating the modifications), (c) whether or not there are any defaults then existing under this Lease (and if so specifying the same), (d) the dates, if any, to which the Base Rent and Additional Charges have been paid, and (e) any other information that may be required.

22. RULES AND REGULATIONS

Tenant shall faithfully comply with the rules and regulations attached to this Lease as Exhibit D (Building Rules and Regulations) and all modifications thereof and additions thereto that City may from time to time put into effect (the "Rules and Regulations"). City shall not be responsible for the non-performance of the Rules and Regulations by any other tenant or occupant of the Building. In the event of any conflict between any provision of this Lease and any provision of the Rules and Regulations, this Lease shall control.

23. SECURITY DEPOSIT

Upon execution of this Lease, Tenant shall deposit with City the sum specified as the security deposit in the Basic Lease Information (the "Security Deposit"), in cash, to secure Tenant's faithful performance of all terms, covenants and conditions of this Lease. Tenant agrees that City may (but shall not be required to) apply the Security Deposit in whole or in part to remedy any damage to the Premises caused by Tenant, its Agents or Invitees, or any failure of Tenant to perform any other terms, covenants or conditions contained herein (including, but not limited to, the payment of Rent or other sum due hereunder either before or after a default), without waiving any of City's other rights and remedies hereunder or at law or in equity and without any obligation. Tenant waives the provisions of Section 1950.7 of the California Civil Code or any similar law, statute or ordinance now or hereafter in effect and agrees that Landlord may retain any portion of Security Deposit reasonably necessary to compensate Landlord for any other foreseeable or unforeseeable loss or damage caused by the acts or omissions of Tenant, its Agents or Invitees. Without limiting the foregoing, Tenant understands and agrees that Landlord may apply some or all of the Security Deposit to the payment of future Rent following a Tenant default.

Should City use any portion of the Security Deposit to cure any default by Tenant hereunder, upon written notice from the City to Tenant specifying the amount of the Security Deposit so utilized by the City and the particular purpose for which such amount was applied, Tenant shall immediately replenish the security deposit to the original amount. If the Base Rent is increased pursuant to any of the provisions of this Lease, Tenant shall increase the amount of the Security Deposit accordingly. City's obligations with respect to the Security Deposit are solely that of debtor and not trustee. City shall not be required to keep the Security Deposit separate from its general funds, and Tenant shall not be entitled to interest on the Security Deposit. The amount of the Security Deposit shall in no way limit the liabilities of Tenant under any provision of this Lease.

24. SURRENDER OF PREMISES

Upon the Expiration Date or other termination of the Term, Tenant shall peaceably quit and surrender to City the Premises together with the Tenant Improvements and all Alterations approved by City in good order and condition, except for normal wear and tear after Tenant having made the last necessary repair required on its part under this Lease, and further except for any portion of the Premises condemned and any damage and destruction for which Tenant is not responsible hereunder. The Premises shall be surrendered free and clear of all liens and encumbrances other than liens and encumbrances existing as of the date of this Lease and any other encumbrances created by City. Immediately before the Expiration Date or other termination of this Lease, Tenant shall remove all of Tenant's Personal Property as provided in this Lease, and repair any damage resulting from the removal; provided, City in its sole discretion shall have the right to reserve ownership of any telecommunications equipment, wire, cabling and/or conduit installed in the Premises or any other portion of the Building by or on behalf of Tenant. If such removal is not completed at the expiration or other termination of this Lease, City may remove the same at Tenant's expense. Notwithstanding anything to the contrary in this Lease, City can elect at any time prior to the Expiration Date or within five (5) days after termination of this Lease, to require Tenant to remove, at Tenant's sole expense, all or part of the Tenant Improvements, Alterations or other improvements or equipment constructed or installed by or at the expense of Tenant including, but not limited to, any telecommunications equipment, wires, cabling and/or conduit installed in the Premises or any other portion of the Building by or on behalf of Tenant. Tenant shall promptly remove such items and shall repair, at no cost to the City, any damage to the Premises or the Building resulting from such removal, or if Tenant fails to repair, City may do so, at Tenant's expense. Tenant's obligations under this Section shall survive the Expiration Date or other termination of this Lease. Any items of Tenant's Personal Property remaining in the Premises after the Expiration Date or sooner termination of this Lease may, at City's option, be deemed abandoned and disposed of in accordance with Section 1980 et seq. of the California Civil Code or in any other manner allowed by law.

Concurrently with the surrender of the Premises, Tenant shall, if requested by City, execute, acknowledge and deliver to City a quitclaim deed to the Premises and any other instrument reasonably requested by City to evidence or otherwise effect the termination of Tenant's leasehold estate hereunder and to effect such transfer or vesting of title to the Tenant Improvements or other improvements or equipment which remain part of the Premises. The terms of this Section shall survive the expiration or sooner termination of this Lease.

25. HAZARDOUS MATERIALS

25.1. Definitions

As used herein, the following terms shall have the meanings set forth below:

(a) "Environmental Laws" shall mean any present or future federal, state, local or administrative law, rule, regulation, order or requirement relating to Hazardous Material (including, without limitation, its use, handling, transportation, production, disposal, discharge or storage), or to health and safety, industrial hygiene or the environment, including, without limitation, soil, air and groundwater conditions.

(b) “Hazardous Material” shall mean any material that, because of its quantity, concentration or physical or chemical characteristics, is at any time now or hereafter deemed by any federal, state or local governmental authority to pose a present or potential hazard to human health, welfare or safety or to the environment. Hazardous Material includes, without limitation, any material or substance defined as a “hazardous substance,” or “pollutant” or “contaminant” pursuant to the Comprehensive Environmental Response, Compensation and Liability Act of 1980 (“CERCLA”, also commonly known as the “Superfund” law), as amended, (42 U.S.C. Sections 9601 *et seq.*) or pursuant to Section 25316 of the California Health & Safety Code; any “hazardous waste” listed pursuant to Section 25140 of the California Health & Safety Code; and petroleum, including crude oil or any fraction thereof, natural gas or natural gas liquids.

(c) “Investigate and Remediate” (“Investigation” and “Remediation”) shall mean the undertaking of any activities to determine the nature and extent of Hazardous Material that may be located in, on, under or about the Property or that has been, are being or threaten to be Released into the environment, and to clean up, remove, contain, treat, stabilize, monitor or otherwise control such Hazardous Material.

(d) “Release” when used with respect to Hazardous Material shall include any actual or imminent spilling, leaking, pumping, pouring, emitting, emptying, discharging, injecting, escaping, leaching, dumping, or disposing into or inside the Premises, or in, on, under or about any other part of the Property or into the environment.

25.2. No Hazardous Materials

Tenant covenants and agrees that neither Tenant nor any of its Agents or Invitees shall cause or permit any Hazardous Material to be brought upon, kept, used, stored, generated or disposed of in, on or about the Property, or transported to or from the Property, with the sole exception that Tenant may keep and use such substances in the Premises in such reasonably limited amounts as are customarily used for cafe purposes (such as normal cleaning supplies) so long as such storage and use are in compliance with all applicable Environmental Laws at all times. Tenant shall give immediate written notice to City of: (a) any action, proceeding or inquiry by any governmental authority (including, without limitation, the California State Department of Health Services, the State or any Regional Water Quality Control Board, the Bay Area Air Quality Management district or any local governmental entity) against Tenant with respect to the presence or Release or suspected presence or Release of Hazardous Material on the Premises, Building or Property or the migration thereof from or to other property; (b) all demands or claims made or threatened by any third party against Tenant or the Premises, Building or Property relating to any loss or injury resulting from any Hazardous Materials; (c) any Release of Hazardous Material on or about the Premises or any other part of the Property has occurred that may require any Investigation or Remediation; and (d) all matters of which Tenant is required to give notice pursuant to Section 25359.7 of the California Health and Safety Code.

25.3. Tenant’s Environmental Indemnity

If Tenant breaches any of its obligations contained in this Section, or, if any act or omission of Tenant, its Agents or Invitees, results in any Release of Hazardous Material in, on, under or about the Premises or any other part of the Property in violation of any applicable Environmental Laws, including but not limited to Chapter 36 of the San Francisco Building

Code, then, without limiting Tenant's Indemnity contained in Section 18.2, Tenant shall, on behalf of itself and its successors and assigns, Indemnify the Indemnified Parties, and each of them, from and against all Claims (including, without limitation, damages for decrease in value of the Premises or the Property, the loss or restriction of the use of rentable or usable space or of any amenity of the Premises or the Property and sums paid in settlement of claims, attorneys' fees, consultants' fees and experts' fees and costs) arising during or after the Term of this Lease and relating to such Release. The foregoing Indemnity includes, without limitation, costs incurred in connection with activities undertaken to Investigate and Remediate Hazardous Material and to restore the Property to its prior condition, fines and penalties assessed for the violation of any applicable Environmental Laws including but not limited to Chapter 36 of the San Francisco Building Code, and any natural resource damages. Without limiting the foregoing, if Tenant or any of its Agents or Invitees, causes or permits the Release of any Hazardous Materials in, on, under or about the Premises or any other part of the Property, Tenant shall immediately and at no expense to City take any and all appropriate actions to return the Premises or the Property affected thereby to the condition existing prior to such Release and otherwise Investigate and Remediate the Release in accordance with all Environmental Laws. Tenant specifically acknowledges and agrees that it has an immediate and independent obligation to defend the City from any claim which actually or potentially falls within this indemnity provision even if such allegation is or may be groundless, fraudulent or false, which obligation arises at the time such claim is tendered to Tenant by the City and continues at all times thereafter. Tenant shall afford City a full opportunity to participate in any discussions with governmental regulatory agencies regarding any settlement agreement, cleanup or abatement agreement, consent decree, or other compromise or proceeding involving Hazardous Material.

25.4. Survival of Obligation

Tenant's obligations under this Section 25 shall survive the Expiration Date or other termination of this Lease.

25.5 Hazardous Substance Disclosure

California law requires landlords to disclose to tenants the presence or potential presence of certain Hazardous Materials. Accordingly, Tenant is hereby advised that occupation of the Premises may lead to exposure to Hazardous Materials such as, but not limited to, gasoline, diesel and other vehicle fluids, vehicle exhaust, office maintenance fluids, tobacco smoke, methane and building materials containing chemicals, such as formaldehyde

26. SPECIAL PROVISIONS

26.1. Extension Options

(a) Option to Extend Term

If mutually agreed upon and properly authorized by City, City grants to Tenant two options to extend the Term of this Lease as to the entire Premises only (the "Extension Options"), each for an additional two (2) years (each, an "Extension Term"), the first Extension Option commencing on the date immediately following the Expiration Date, and only if the first option is exercised, then the second Extension Option commencing two (2) years after the commencement of the initial Extension Term, granted upon the following terms and conditions.

Tenant may exercise the Extension Options at any time during the Term but must give written notice to City thereof not less than one hundred eighty (180) days prior to the Expiration Date, or the expiration of the first Extension Term, as applicable. City may elect to reject Tenant's exercise of the Extension Option if (i) any event of default by Tenant is outstanding either at the time of Tenant's exercise of an Extension Option or at any time prior to the first day of the applicable Extension Term (or if any event shall have occurred which with the giving of notice or the passage of time or both would constitute such a default); (ii) Tenant has assigned its interest hereunder or sublet the Premises; or (iii) City and Tenant have not agreed upon a new Base Rent for the Extension Term by that date which is 45 days prior to the current Expiration Date, whereupon the Extension Option(s) shall be null and void.

(b) Base Rent and Other Terms

If Tenant elects to exercise an Extension Option and City does not reject Tenant's election, then the lease for the applicable Extension Term shall cover the entire Premises and shall be upon all of the terms, covenants and conditions of this Lease, except that Base Rent hereunder shall be adjusted as agreed upon by City and Tenant.

26.2. Payment of Percentage Share of Operating Expenses

There shall be no percentage share of building operating expenses paid by Tenant.

27. GENERAL PROVISIONS

27.1. Notices

Any notice given under this Lease shall be effective only if in writing and given by delivering the notice in person or by sending it first-class mail or certified mail with a return receipt requested or by overnight courier, return receipt requested, with postage prepaid, to: (a) Tenant (i) at Tenant's address set forth in the Basic Lease Information, if sent prior to Tenant's taking possession of the Premises, or (ii) at the Premises if sent on or subsequent to Tenant's taking possession of the Premises, or (iii) at any place where Tenant or any Agent of Tenant may be found if sent subsequent to Tenant's vacating, abandoning or surrendering the Premises; or (b) City at City's address set forth in the Basic Lease Information; or (c) to such other address as either City or Tenant may designate as its new address for such purpose by notice given to the other in accordance with the provisions of this Section at least ten (10) days prior to the effective date of such change. Any notice hereunder shall be deemed to have been given two (2) days after the date when it is mailed if sent by first class or certified mail, one day after the date it is made if sent by overnight courier, or upon the date personal delivery is made. For convenience of the parties, copies of notices may also be given by facsimile to the telephone number set forth in the Basic Lease Information or such other number as may be provided from time to time; however, neither party may give official or binding notice by facsimile. Tenant shall promptly provide City with copies of any and all notices received regarding any alleged violation of laws or insurance requirements or any alleged unsafe condition or practice.

27.2. No Implied Waiver

No failure by City to insist upon the strict performance of any obligation of Tenant under this Lease or to exercise any right, power or remedy arising out of a breach thereof, irrespective

of the length of time for which such failure continues, no acceptance of full or partial Base Rent or Additional Charges during the continuance of any such breach, and no acceptance of the keys to or possession of the Premises prior to the expiration of the Term by any Agent of City, shall constitute a waiver of such breach or of City's right to demand strict compliance with such term, covenant or condition or operate as a surrender of this Lease. No express written waiver of any default or the performance of any provision hereof shall affect any other default or performance, or cover any other period of time, other than the default, performance or period of time specified in such express waiver. One or more written waivers of a default or the performance of any provision hereof shall not be deemed to be a waiver of a subsequent default or performance. Any consent by City hereunder shall not relieve Tenant of any obligation to secure the consent of City in any other or future instance under the terms of this Lease.

27.3. Amendments

Neither this Lease nor any terms or provisions hereof may be changed, waived, discharged or terminated, except by a written instrument signed by the party against which the enforcement of the change, waiver, discharge or termination is sought. Whenever this Lease requires an amendment, waiver, notice, or other instrument or document to be executed by or on behalf of City or its consent or approval, the Director of Property of the City, or his or her designee, shall be authorized to provide such approval and execute such instrument on behalf of City, except as otherwise provided by applicable law, including the City's Charter. Any amendments or modifications to this Lease, including, without limitation, amendments or modifications to the exhibits to this Lease, shall be subject to the mutual written agreement of City and Tenant, and City's agreement may be made upon the sole approval of the Director of Property, or his or her designee; provided, however, material amendments or modifications to this Lease **(i)** changing the legal description of the Premises, **(ii)** increasing the Term (including agreement upon the Extension Options), **(iii)** increasing the Rent, **(iv)** changing the general use of the Premises from the use authorized under Section 5.1 of this Lease, and **(v)** any other amendment or modification that materially increases the City's liabilities or financial obligations under this Lease shall additionally require the approval of the City's Board of Supervisors.

27.4. Authority

If Tenant signs as a corporation or a partnership, each of the persons executing this Lease on behalf of Tenant does hereby covenant and warrant that Tenant is a duly authorized and existing entity, that Tenant has and is qualified to do business in California, that Tenant has full right and authority to enter into this Lease, and that each and all of the persons signing on behalf of Tenant are authorized to do so. Upon City's request, Tenant shall provide City with evidence reasonably satisfactory to City confirming the foregoing representations and warranties.

27.5. Parties and Their Agents; Approvals

The words "City", "Landlord" and "Tenant" as used herein shall include the plural as well as the singular. If there is more than one Tenant, the obligations and liabilities under this Lease imposed on Tenant shall be joint and several. As used herein, the term "Agents" when used with respect to either party shall include the agents, employees, officers, contractors and representatives of such party, and the term "Invitees" when used with respect to Tenant shall include the clients, customers, invitees, guests, licensees, assignees or subtenants of Tenant. All approvals, consents or other determinations permitted or required by City hereunder shall be

made by or through City's Director of Property unless otherwise provided in this Lease, subject to applicable law.

27.6. Interpretation of Lease

The captions preceding the articles and sections of this Lease and in the table of contents have been inserted for convenience of reference only and such captions shall in no way define or limit the scope or intent of any provision of this Lease. This Lease has been negotiated at arm's length and between persons sophisticated and knowledgeable in the matters dealt with herein and shall be interpreted to achieve the intents and purposes of the parties, without any presumption against the party responsible for drafting any part of this Lease. Provisions in this Lease relating to number of days shall be calendar days, unless otherwise specified, provided that if the last day of any period to give notice, reply to a notice or to undertake any other action occurs on a Saturday, Sunday or a bank or City holiday, then the last day for undertaking the action or giving or replying to the notice shall be the next succeeding business day. Use of the word "including" or similar words shall not be construed to limit any general term, statement or other matter in this Lease, whether or not language of non-limitation, such as "without limitation" or similar words, are used.

27.7. Successors and Assigns

Subject to the provisions of this Lease relating to Assignment and Subletting, the terms, covenants and conditions contained in this Lease shall bind and inure to the benefit of City and Tenant and, except as otherwise provided herein, their personal representatives and successors and assigns; provided, however, that upon any sale, assignment or transfer by City named herein (or by any subsequent landlord) of its interest in the Building as owner or lessee, including any transfer by operation of law, City (or any subsequent landlord) shall be relieved from all subsequent obligations and liabilities arising under this Lease subsequent to such sale, assignment or transfer.

27.8. Brokers

Neither party has had any contact or dealings regarding the leasing of the Premises, or any communication in connection therewith, through any licensed real estate broker or other person who could claim a right to a commission or finder's fee in connection with the lease contemplated herein. In the event that any broker or finder perfects a claim for a commission or finder's fee based upon any such contact, dealings or communication, the party through whom the broker or finder makes a claim shall be responsible for such commission or fee and shall Indemnify the other party from any and all Claims incurred by the indemnified party in defending against the same. The provisions of this Section shall survive any termination of this Lease.

27.9. Severability

If any provision of this Lease or the application thereof to any person, entity or circumstance shall be invalid or unenforceable, the remainder of this Lease, or the application of such provision to persons, entities or circumstances other than those as to which it is invalid or unenforceable, shall not be affected thereby, and each other provision of this Lease shall be valid and be enforceable to the fullest extent permitted by law, except to the extent that enforcement of

this Lease without the invalidated provision would be unreasonable or inequitable under all the circumstances or would frustrate a fundamental purpose of this Lease.

27.10. Governing Law

This Lease shall be construed and enforced in accordance with the laws of the State of California and the City's Charter.

27.11. Entire Agreement

This instrument, including the exhibits hereto, which are made a part of this Lease by reference herein, contains the entire agreement between the parties and all prior written or oral negotiations, understandings and agreements are merged herein. The parties further intend that this Lease shall constitute the complete and exclusive statement of its terms and that no extrinsic evidence whatsoever (including prior drafts hereof and changes therefrom) may be introduced in any judicial, administrative or other legal proceeding involving this Lease. Tenant hereby acknowledges that neither City nor City's Agents have made any representations or warranties with respect to the Premises, the Building or this Lease except as expressly set forth herein, and no rights, easements or licenses are or shall be acquired by Tenant by implication or otherwise unless expressly set forth herein.

27.12. Attorneys' Fees

In the event that either City or Tenant fails to perform any of its obligations under this Lease or in the event a dispute arises concerning the meaning or interpretation of any provision of this Lease, the defaulting party or the non-prevailing party in such dispute, as the case may be, shall pay the prevailing party reasonable attorneys' and experts' fees and costs, and all court costs and other costs of action incurred by the prevailing party in connection with the prosecution or defense of such action and enforcing or establishing its rights hereunder (whether or not such action is prosecuted to a judgment). For purposes of this Lease, the terms "court costs and reasonable attorneys' fees" shall mean the fees and expenses of counsel to the Parties, which may include printing, duplicating and other expenses, air freight charges, hiring of experts, and fees billed for law clerks, paralegals, librarians and others not admitted to the bar but performing services under the supervision of an attorney. The term "court costs and attorneys' fees" shall also include, without limitation, all such fees and expenses incurred with respect to appeals, mediation, arbitrations, and bankruptcy proceedings, and whether or not any action is brought with respect to the matter for which such fees and costs were incurred. For the purposes of this Lease, reasonable fees of attorneys of City's Office of the City Attorney shall be based on the fees regularly charged by private attorneys with the equivalent number of years of experience in the subject matter area of the law for which the City Attorney's services were rendered who practice in the City of San Francisco in law firms with approximately the same number of attorneys as employed by the Office of the City Attorney.

27.13. Holding Over

If Tenant retains possession of any portion of the Premises after the expiration or earlier termination of this Lease, then unless City expressly agrees to the holdover in writing, Tenant shall pay City, on a month-to-month basis, Base Rent equal to two hundred percent (200%) of the latest Base Rent payable by Tenant hereunder prior to such expiration, together with an

amount estimated by City for the monthly Additional Charges payable under this Lease, and shall otherwise be on the terms and conditions herein specified so far as applicable (except for those pertaining to the Term and any Extension Options). Any failure by Tenant to surrender, discontinue using, or, if required by City, any failure to remove any property or equipment following written demand for the same by City, shall constitute continuing possession for purposes hereof. Tenant acknowledges that the foregoing provisions shall not serve as permission for the Tenant to hold over, nor serve to extend the term of this Lease beyond the end on the term hereof. Any holding over without City's consent shall constitute a default by Tenant and entitle City to exercise any or all of its remedies as provided herein, notwithstanding that City may elect to accept one or more payments of Rent, and whether or not such amounts are at the holdover rate specified above or the rate in effect at the end of the Term of the Lease.

Any holding over after the expiration of the Term with the express consent of City shall be construed to automatically extend the Term of this Lease on a month-to-month basis at a Base Rent equal to an amount determined by City and Tenant, but in no event less than the latest Base Rent payable by Tenant hereunder prior to such expiration, together with an amount estimated by City for the monthly Additional Charges payable under this Lease, and shall otherwise be on the terms and conditions herein specified so far as applicable (except for those pertaining to the Term and any Extension Options). Tenant's obligations under this Section shall survive the expiration or termination of this Lease.

27.14. Time of Essence

Time is of the essence with respect to all provisions of this Lease in which a definite time for performance is specified.

27.15. Cumulative Remedies

All rights and remedies of either party hereto set forth in this Lease shall be cumulative, except as may otherwise be provided herein.

27.16. Survival of Indemnities

Termination of this Lease shall not affect the right of either party to enforce any and all indemnities and representations and warranties given or made to the other party under this Lease, nor shall it affect any provision of this Lease that expressly states it shall survive termination hereof.

27.17. Signs

Tenant agrees that it will not erect or maintain, or permit to be erected or maintained, any signs, notices or graphics upon or about the Premises which are visible in or from public corridors or other portions of any common areas of the Building, without City's prior written consent, which City may withhold or grant in its sole discretion. Tenant shall not erect any signs visible from the exterior of the Building.

27.18. Relationship of the Parties

City is not, and none of the provisions in this Lease shall be deemed to render City, a partner in Tenant's business, or joint venturer or member in any joint enterprise with Tenant. Neither party shall act as the agent of the other party in any respect hereunder. This Lease is not intended nor shall it be construed to create any third party beneficiary rights in any third party, unless otherwise expressly provided.

27.19. Light and Air

Tenant covenants and agrees that no diminution of light, air or view by any structure that may hereafter be erected (whether or not by City) shall entitle Tenant to any reduction of the Base Rent or Additional Charges under this Lease, result in any liability of City to Tenant, or in any other way affect this Lease or Tenant's obligations hereunder.

27.20. No Recording

Tenant shall not record this Lease or any memorandum hereof in the public records.

27.21. Options Personal

Any right or option to extend the Term of this Lease or renew this Lease is personal to the original Tenant and may be exercised only by the original Tenant while occupying the Premises who does so without the intent of thereafter making any Assignment of this Lease or Subletting of the Premises, or any portion thereof, and may not be exercised by or assigned, voluntarily or involuntarily, by or to any person or entity other than Tenant provided, however, that an option may be exercised by or assigned to an Affiliate. The options, if any, herein granted to Tenant are not assignable separate and apart from this Lease, nor may any option be separated from this Lease in any manner, either by reservation or otherwise.

27.22. Public Transit Information

Tenant shall establish and carry on during the Term a program to encourage maximum use of public transportation by personnel of Tenant employed on the Premises, including, without limitation, the distribution to such employees of written materials explaining the convenience and availability of public transportation facilities adjacent or proximate to the Building and encouraging use of such facilities, all at Tenant's sole expense.

27.23. Taxes, Assessments, Licenses, Permit Fees and Liens

(a) Tenant recognizes and understands that this Lease may create a possessory interest subject to property taxation and that Tenant may be subject to the payment of property taxes levied on such interest.

(b) Tenant agrees to pay taxes of any kind, including possessory interest taxes, that may be lawfully assessed on the leasehold interest hereby created and to pay all other taxes, excises, licenses, permit charges and assessments based on Tenant's usage of the Premises

that may be imposed upon Tenant by law, all of which shall be paid when the same become due and payable and before delinquency.

(c) Tenant agrees not to allow or suffer a lien for any such taxes to be imposed upon the Premises or upon any equipment or property located thereon without promptly discharging the same, provided that Tenant, if so desiring, may have reasonable opportunity to contest the validity of the same.

(d) San Francisco Administrative Code Sections 23.38 and 23.39 require that the City and County of San Francisco report certain information relating to this Lease, and any renewals thereof, to the County Assessor within sixty (60) days after any such transaction, and that Tenant report certain information relating to any assignment of or sublease under this Lease to the County Assessor within sixty (60) days after such assignment or sublease transaction. Tenant agrees to provide such information as may be requested by the City to enable the City to comply with this requirement.

27.24. Non-Liability of City Officials, Employees and Agents

No elective or appointive board, commission, member, officer, employee or other Agent of City shall be personally liable to Tenant, its successors and assigns, in the event of any default or breach by City or for any amount which may become due to Tenant, its successors and assigns, or for any obligation of City under this Agreement.

27.25. Prevailing Wages and Working Conditions

Any undefined, initially-capitalized term used in this Section shall have the meaning given to such term in San Francisco Administrative Code Section 23.61. Tenant shall require its contractors and subcontractors performing (i) labor in connection with a “public work” as defined under California Labor Code Section 1720 *et seq.* (which includes certain construction, alteration, maintenance, demolition, installation, repair, carpet laying, or refuse hauling work if paid for in whole or part out of public funds) or (ii) Covered Construction, at the Premises to (1) pay workers performing such work not less than the highest prevailing rate of wages, (2) provide the same hours, working conditions and benefits as in each case are provided for similar work performed in San Francisco County, and (3) employ apprentices in accordance with San Francisco Administrative Code Section 23.61 (collectively, “Prevailing Wage Requirements”). Tenant agrees to cooperate with the City in any action or proceeding against a contractor or subcontractor that fails to comply with the Prevailing Wage Requirements.

Tenant shall include, and shall require its subtenants, and contractors and subcontractors (regardless of tier) to include, the Prevailing Wage Requirements and the agreement to cooperate in City enforcement actions in any Construction Contract with specific reference to San Francisco Administrative Code Section 23.61. Each such Construction Contract shall name the City and County of San Francisco, affected workers, and employee organizations formally representing affected workers as third party beneficiaries for the limited purpose of enforcing the Prevailing Wage Requirements, including the right to file charges and seek penalties against any contractor or subcontractor in accordance with San Francisco Administrative Code Section 23.61. Tenant’s failure to comply with its obligations under this Section shall constitute a material breach of this Lease. A contractor’s or subcontractor’s failure to comply with this

Section will enable the City to seek the remedies specified in San Francisco Administrative Code Section 23.61 against the breaching party.

Tenant shall also pay, and shall require its subtenants, and contractors and subcontractors (regardless of tier) to pay, the Prevailing Rate of Wage for the following activities on the Premises as set forth in and to the extent required by San Francisco Administrative Code Chapter 21C: a Public Off-Street Parking Lot, Garage or Automobile Storage Facility (as defined in Section 21C.3), a Show (as defined in Section 21C.4), a Special Event (as defined in Section 21C.8), and Broadcast Services (as defined in Section 21C.9).

27.26. Non-Discrimination in City Contracts and Benefits Ordinance

(a) Covenant Not to Discriminate

In the performance of this Lease, Tenant agrees not to discriminate against any employee, any City employee working with Tenant, or applicant for employment with Tenant, or against any person seeking accommodations, advantages, facilities, privileges, services, or membership in all business, social, or other establishments or organizations, on the basis of the fact or perception of a person's race, color, creed, religion, national origin, ancestry, age, height, weight, sex, sexual orientation, gender identity, domestic partner status, marital status, disability or Acquired Immune Deficiency Syndrome or HIV status (AIDS/HIV status), or association with members of such protected classes, or in retaliation for opposition to discrimination against such classes.

(b) Subleases and Other Subcontracts

Tenant shall include in all Subleases and other subcontracts relating to the Premises a non-discrimination clause applicable to such Subtenant or other subcontractor in substantially the form of subsection (a) above. In addition, Tenant shall incorporate by reference in all subleases and other subcontracts the provisions of Sections 12B.2(a), 12B.2(c)-(k), and 12C.3 of the San Francisco Administrative Code and shall require all subtenants and other subcontractors to comply with such provisions. Tenant's failure to comply with the obligations in this subsection shall constitute a material breach of this Lease.

(c) Non-Discrimination in Benefits

Tenant does not as of the date of this Lease and will not during the Term, in any of its operations or in San Francisco or with respect to its operations under this Lease elsewhere within the United States, discriminate in the provision of bereavement leave, family medical leave, health benefits, membership or membership discounts, moving expenses, pension and retirement benefits or travel benefits, as well as any benefits other than the benefits specified above, between employees with domestic partners and employees with spouses, and/or between the domestic partners and spouses of such employees, where the domestic partnership has been registered with a governmental entity pursuant to state or local law authorizing such registration, subject to the conditions set forth in Section 12B.2(b) of the San Francisco Administrative Code.

(d) CMD Form

As a condition to this Lease, Tenant shall execute the "Chapter 12B Declaration: Nondiscrimination in Contracts and Benefits" form (Form CMD-12B-101) with supporting documentation and secure the approval of the form by the San Francisco Contract Monitoring Division. Tenant hereby represents that prior to execution of this Lease, (i) Tenant executed and submitted to the CMD Form CMD-12B-101 with supporting documentation, and (ii) the CMD approved such form.

(e) Incorporation of Administrative Code Provisions by Reference

The provisions of Chapters 12B and 12C of the San Francisco Administrative Code relating to non-discrimination by parties contracting for the lease of City property are incorporated in this Section by reference and made a part of this Agreement as though fully set forth herein. Tenant shall comply fully with and be bound by all of the provisions that apply to this Lease under such Chapters of the Administrative Code, including but not limited to the remedies provided in such Chapters. Without limiting the foregoing, Tenant understands that pursuant to Section 12B.2(h) of the San Francisco Administrative Code, a penalty of \$50 for each person for each calendar day during which such person was discriminated against in violation of the provisions of this Lease may be assessed against Tenant and/or deducted from any payments due Tenant.

27.27. No Relocation Assistance; Waiver of Claims

Tenant acknowledges that it will not be a displaced person at the time this Lease is terminated or expires by its own terms, and Tenant fully RELEASES, WAIVES AND DISCHARGES forever any and all Claims against, and covenants not to sue, City, its departments, commissions, officers, directors and employees, and all persons acting by, through or under each of them, under any laws, including, without limitation, any and all claims for relocation benefits or assistance from City under federal and state relocation assistance laws (including, but not limited to, California Government Code Section 7260 et seq.), except as otherwise specifically provided in this Lease with respect to a Taking.

27.28. MacBride Principles - Northern Ireland

The provisions of San Francisco Administrative Code §12F are incorporated herein by this reference and made part of this Lease. By signing this Lease, Tenant confirms that Tenant has read and understood that the City urges companies doing business in Northern Ireland to resolve employment inequities and to abide by the MacBride Principles, and urges San Francisco companies to do business with corporations that abide by the MacBride Principles.

27.29. Tropical Hardwood and Virgin Redwood Ban

The City and County of San Francisco urges companies not to import, purchase, obtain or use for any purpose, any tropical hardwood, tropical hardwood wood product, virgin redwood or virgin redwood wood product. Except as expressly permitted by the application of Sections 802(b) and 803(b) of the San Francisco Environment Code, Tenant shall not provide any items to the construction of Tenant Improvements or the Alterations, or otherwise in the performance of this Lease which are tropical hardwoods, tropical hardwood wood products,

virgin redwood, or virgin redwood wood products. In the event Tenant fails to comply in good faith with any of the provisions of Chapter 8 of the San Francisco Environment Code, Tenant shall be liable for liquidated damages for each violation in any amount equal to Tenant's net profit on the contract, or five percent (5%) of the total amount of the contract dollars, whichever is greater.

27.30. Restrictions on the Use of Pesticides

Chapter 3 of the San Francisco Environment Code (the Integrated Pest Management Program Ordinance or "IPM Ordinance") describes an integrated pest management ("IPM") policy to be implemented by all City departments. Tenant shall not use or apply or allow the use or application of any pesticides on the Premises or contract with any party to provide pest abatement or control services to the Premises without first receiving City's written approval of an IPM plan that (i) lists, to the extent reasonably possible, the types and estimated quantities of pesticides that Tenant may need to apply to the Premises during the term of this Lease, (ii) describes the steps Tenant will take to meet the City's IPM Policy described in Section 300 of the IPM Ordinance and (iii) identifies, by name, title, address and telephone number, an individual to act as the Tenant's primary IPM contact person with the City. Tenant shall comply, and shall require all of Tenant's contractors to comply, with the IPM plan approved by the City and shall comply with the requirements of Sections 300(d), 302, 304, 305(f), 305(g), and 306 of the IPM Ordinance, as if Tenant were a City department. Among other matters, such provisions of the IPM Ordinance: (a) provide for the use of pesticides only as a last resort, (b) prohibit the use or application of pesticides on property owned by the City, except for pesticides granted an exemption under Section 303 of the IPM Ordinance (including pesticides included on the most current Reduced Risk Pesticide List compiled by City's Department of the Environment), (c) impose certain notice requirements, and (d) require Tenant to keep certain records and to report to City all pesticide use at the Premises by Tenant's staff or contractors.

If Tenant or Tenant's contractor will apply pesticides to outdoor areas at the Premises, Tenant must first obtain a written recommendation from a person holding a valid Agricultural Pest Control Advisor license issued by the California Department of Pesticide Regulation ("CDPR") and any such pesticide application shall be made only by or under the supervision of a person holding a valid, CDPR-issued Qualified Applicator certificate or Qualified Applicator license. City's current Reduced Risk Pesticide List and additional details about pest management on City property can be found at the San Francisco Department of the Environment website, <http://sfenvironment.org/ipm>. Nothing herein shall prevent Tenant, through the Real Estate Division, from seeking a determination from the Commission on the Environment that it is exempt from complying with certain portions of the Pesticide Ordinance as provided in Section 307 thereof.

27.31. First Source Hiring Agreement

Tenant and City are parties to the First Source Agreement attached to this Lease as Exhibit E pursuant to San Francisco Administrative Code, Chapter 83 (the "First Source Agreement"). Any default by Tenant under the First Source Agreement shall be a default under this Lease.

27.32. Sunshine Ordinance

In accordance with Section 67.24(e) of the San Francisco Administrative Code, contracts, contractors' bids, leases, agreements, responses to Requests for Proposals, and all other records

of communications between City and persons or firms seeking contracts will be open to inspection immediately after a contract has been awarded. Nothing in this provision requires the disclosure of a private person's or organization's net worth or other proprietary financial data submitted for qualification for a contract, lease, agreement or other benefit until and unless that person or organization is awarded the contract, lease, agreement or benefit. Information provided which is covered by this Section will be made available to the public upon request.

27.33. Conflicts of Interest

Through its execution of this Lease, Tenant acknowledges that it is familiar with the provisions of Section 15.103 of the San Francisco Charter, Article III, Chapter 2 of City's Campaign and Governmental Conduct Code, and Section 87100 et seq. and Section 1090 et seq. of the Government Code of the State of California, and certifies that it does not know of any facts that would constitute a violation of said provisions, and agrees that if Tenant becomes aware of any such fact during the term of this Lease Tenant shall immediately notify the City.

27.34. Charter Provisions

This Lease is governed by and subject to the provisions of the Charter of the City and County of San Francisco.

27.35. Drug-Free Workplace

Tenant acknowledges that pursuant to the Federal Drug-Free Workplace Act of 1989, the unlawful manufacture, distribution, possession or use of a controlled substance is prohibited on City premises. Tenant agrees that any violation of this prohibition by Tenant, its Agents or assigns shall be deemed a material breach of this Lease.

27.36. Prohibition of Tobacco Sales and Advertising

Tenant acknowledges and agrees that no advertising or sale of cigarettes or tobacco products is allowed on the Premises. This advertising prohibition includes the placement of the name of a company producing cigarettes or tobacco products or the name of any cigarette or tobacco product in any promotion of any event or product.

27.37. Prohibition of Alcoholic Beverage Advertising

Tenant acknowledges and agrees that no advertising of alcoholic beverages is allowed on the Premises. For purposes of this section, "alcoholic beverage" shall be defined as set forth in California Business and Professions Code Section 23004, and shall not include cleaning solutions, medical supplies and other products and substances not intended for drinking. This advertising prohibition includes the placement of the name of a company producing alcoholic beverages or the name of any alcoholic beverage in any promotion of any event or product.

27.38. Requiring Health Benefits for Covered Employees

Unless exempt, Tenant agrees to comply fully with and be bound by all of the provisions of the Health Care Accountability Ordinance (HCAO), as set forth in San Francisco Administrative Code Chapter 12Q, including the remedies provided, and implementing regulations, as the same may be amended from time to time. The provisions of Chapter 12Q are

incorporated herein by reference and made a part of this Lease as though fully set forth. The text of the HCAO is available on the web at <http://www.sfgov.org/olse/hcao>. Capitalized terms used in this Section and not defined in this Lease shall have the meanings assigned to such terms in Chapter 12Q.

(a) For each Covered Employee, Tenant shall provide the appropriate health benefit set forth in Section 12Q.3 of the HCAO. If Tenant chooses to offer the health plan option, such health plan shall meet the minimum standards set forth by the San Francisco Health Commission.

(b) Notwithstanding the above, if the Tenant is a small business as defined in Section 12Q.3(d) of the HCAO, it shall have no obligation to comply with subsection (a) above.

(c) Tenant's failure to comply with the HCAO shall constitute a material breach of this Lease. City shall notify Tenant if such a breach has occurred. If, within thirty (30) days after receiving City's written notice of a breach of this Lease for violating the HCAO, Tenant fails to cure such breach or, if such breach cannot reasonably be cured within such period of thirty (30) days, Tenant fails to commence efforts to cure within such period, or thereafter fails diligently to pursue such cure to completion, City shall have the right to pursue the remedies set forth in Section 12Q.5(f)(1-5). Each of these remedies shall be exercisable individually or in combination with any other rights or remedies available to City.

(d) Any Subcontract entered into by Tenant shall require the Subcontractor to comply with the requirements of the HCAO and shall contain contractual obligations substantially the same as those set forth in this Section. Tenant shall notify City's Purchasing Department when it enters into such a Subcontract and shall certify to the Purchasing Department that it has notified the Subcontractor of the obligations under the HCAO and has imposed the requirements of the HCAO on Subcontractor through the Subcontract. Each Tenant shall be responsible for its Subcontractors' compliance with this Chapter. If a Subcontractor fails to comply, the City may pursue the remedies set forth in this Section against Tenant based on the Subcontractor's failure to comply, provided that City has first provided Tenant with notice and an opportunity to obtain a cure of the violation.

(e) Tenant shall not discharge, reduce in compensation, or otherwise discriminate against any employee for notifying City with regard to Tenant's compliance or anticipated compliance with the requirements of the HCAO, for opposing any practice proscribed by the HCAO, for participating in proceedings related to the HCAO, or for seeking to assert or enforce any rights under the HCAO by any lawful means.

(f) Tenant represents and warrants that it is not an entity that was set up, or is being used, for the purpose of evading the intent of the HCAO.

(g) Tenant shall keep itself informed of the current requirements of the HCAO.

(h) Tenant shall provide reports to the City in accordance with any reporting standards promulgated by the City under the HCAO, including reports on Subcontractors and Subtenants, as applicable.

(i) Tenant shall provide City with access to records pertaining to compliance with HCAO after receiving a written request from City to do so and being provided at least five (5) business days to respond.

(j) City may conduct random audits of Tenant to ascertain its compliance with HCAO. Tenant agrees to cooperate with City when it conducts such audits.

(k) If Tenant is exempt from the HCAO when this Lease is executed because its amount is less than Twenty-Five Thousand Dollars (\$25,000) [Fifty Thousand Dollars (\$50,000) for nonprofits], but Tenant later enters into an agreement or agreements that cause Tenant's aggregate amount of all agreements with City to reach Seventy-Five Thousand Dollars (\$75,000), all the agreements shall be thereafter subject to the HCAO. This obligation arises on the effective date of the agreement that causes the cumulative amount of agreements between Tenant and the Contracting Department to be equal to or greater than Seventy-Five Thousand Dollars (\$75,000) in the fiscal year.

27.39. Notification of Limitations on Contributions

Through its execution of this Lease, Tenant acknowledges that it is familiar with Section 1.126 of the San Francisco Campaign and Governmental Conduct Code, which prohibits any person who contracts with the City for the selling or leasing of any land or building to or from the City whenever such transaction would require approval by a City elective officer, the board on which that City elective officer serves, or a board on which an appointee of that individual serves, from making any campaign contribution to (a) the City elective officer, (b) a candidate for the office held by such individual, or (c) a committee controlled by such individual or candidate, at any time from the commencement of negotiations for the contract until the later of either the termination of negotiations for such contract or six months after the date the contract is approved. Tenant acknowledges that the foregoing restriction applies only if the contract or a combination or series of contracts approved by the same individual or board in a fiscal year have a total anticipated or actual value of \$50,000 or more. Tenant further acknowledges that the prohibition on contributions applies to each Tenant; each member of Tenant's board of directors, and Tenant's chief executive officer, chief financial officer and chief operating officer; any person with an ownership interest of more than 20 percent in Tenant; any subcontractor listed in the contract; and any committee that is sponsored or controlled by Tenant. Additionally, Tenant acknowledges that Tenant must inform each of the persons described in the preceding sentence of the prohibitions contained in Section 1.126. Tenant further agrees to provide to City the name of each person, entity or committee described above.

27.40. Preservative-Treated Wood Containing Arsenic

Tenant may not purchase preservative-treated wood products containing arsenic in the performance of this Lease unless an exemption from the requirements of Environment Code Chapter 13 is obtained from the Department of Environment under Section 1304 of the Environment Code. The term "preservative-treated wood containing arsenic" shall mean wood treated with a preservative that contains arsenic, elemental arsenic, or an arsenic copper combination, including, but not limited to, chromated copper arsenate preservative, ammoniac copper zinc arsenate preservative, or ammoniacal copper arsenate preservative. Tenant may purchase preservative-treated wood products on the list of environmentally preferable alternatives prepared and adopted by the Department of Environment. This provision does not

preclude Tenant from purchasing preservative-treated wood containing arsenic for saltwater immersion. The term "saltwater immersion" shall mean a pressure-treated wood that is used for construction purposes or facilities that are partially or totally immersed in saltwater.

27.41. Resource-Efficient City Buildings

Tenant acknowledges that the City and County of San Francisco has enacted San Francisco Environment Code Sections 700 to 713 relating to green building requirements for the design, construction, and operation of buildings owned or leased by City. Tenant hereby agrees that it shall comply with all applicable provisions of such code sections.

27.42. Counterparts

This Lease may be executed in two or more counterparts, each of which shall be deemed an original, but all of which taken together shall constitute one and the same instrument.

27.43. Effective Date

This Lease shall become effective on the date upon which: (i) City's Board of Supervisors and the Mayor, in their sole and absolute discretion, adopt a resolution approving this Lease in accordance with all applicable laws and (ii) this Lease is duly executed and delivered by the parties hereto.

27.44. Acceptance of Lease by Tenant

This Lease shall be null and void unless Tenant accepts it and returns to City three (3) fully executed counterparts hereof on or before 5:00 p.m. San Francisco Time on May 1, 2016.

27.45. Food Service Waste Reduction

Tenant agrees to comply fully with and be bound by all of the provisions of the Food Service Waste Reduction Ordinance, as set forth in the San Francisco Environment Code, Chapter 16, including the remedies provided therein, and implementing guidelines and rules. The provisions of Chapter 16 are incorporated herein by reference and made a part of this Lease as though fully set forth herein. This provision is a material term of this Lease. By entering into this Lease, Tenant agrees that if it breaches this provision, City will suffer actual damages that will be impractical or extremely difficult to determine. Without limiting City's other rights and remedies, Tenant agrees that the sum of One Hundred Dollars (\$100.00) liquidated damages for the first breach, Two Hundred Dollars (\$200.00) liquidated damages for the second breach in the same year, and Five Hundred Dollars (\$500.00) liquidated damages for subsequent breaches in the same year is a reasonable estimate of the damage that City will incur based on the violation, established in light of the circumstances existing at the time this Lease was made. Such amounts shall not be considered a penalty, but rather agreed monetary damages sustained by City because of Tenant's failure to comply with this provision.

27.46. Bottled Drinking Water

Unless exempt, Tenant agrees to comply fully with and be bound by all of the provisions of the San Francisco Bottled Water Ordinance, as set forth in San Francisco Environment Code Chapter 24, including the administrative fines, remedies, and implementing regulations provided

therein, as the same may be amended from time to time. The provisions of Chapter 24 are incorporated herein by reference and made a part of this Lease as though fully set forth.

27.47. Criminal History in Hiring and Employment Decisions

(a) Unless exempt, Tenant agrees to comply with and be bound by all of the provisions of San Francisco Administrative Code Chapter 12T (Criminal History in Hiring and Employment Decisions; “Chapter 12 T”), which are hereby incorporated as may be amended from time to time, with respect to applicants and employees of Tenant who would be or are performing work at the Premises.

(b) Tenant shall incorporate by reference the provisions of Chapter 12T in all subleases of some or all of the Premises, and shall require all subtenants to comply with such provisions. Tenant’s failure to comply with the obligations in this subsection shall constitute a material breach of this Lease.

(c) Tenant and subtenants shall not inquire about, require disclosure of, or if such information is received base an Adverse Action on an applicant’s or potential applicant for employment, or employee’s: (1) Arrest not leading to a Conviction, unless the Arrest is undergoing an active pending criminal investigation or trial that has not yet been resolved; (2) participation in or completion of a diversion or a deferral of judgment program; (3) a Conviction that has been judicially dismissed, expunged, voided, invalidated, or otherwise rendered inoperative; (4) a Conviction or any other adjudication in the juvenile justice system; (5) a Conviction that is more than seven years old, from the date of sentencing; or (6) information pertaining to an offense other than a felony or misdemeanor, such as an infraction.

(d) Tenant and subtenants shall not inquire about or require applicants, potential applicants for employment, or employees to disclose on any employment application the facts or details of any conviction history, unresolved arrest, or any matter identified in subsection (c) above. Tenant and subtenants shall not require such disclosure or make such inquiry until either after the first live interview with the person, or after a conditional offer of employment.

(e) Tenant and subtenants shall state in all solicitations or advertisements for employees that are reasonably likely to reach persons who are reasonably likely to seek employment with Tenant or subtenant at the Premises, that the Tenant or subtenant will consider for employment qualified applicants with criminal histories in a manner consistent with the requirements of Chapter 12T.

(f) Tenant and subtenants shall post the notice prepared by the Office of Labor Standards Enforcement (“OLSE”), available on OLSE’s website, in a conspicuous place at the Premises and at other workplaces within San Francisco where interviews for job opportunities at the Premises occur. The notice shall be posted in English, Spanish, Chinese, and any language spoken by at least 5% of the employees at the Premises or other workplace at which it is posted.

(g) Tenant and subtenants understand and agree that upon any failure to comply with the requirements of Chapter 12T, the City shall have the right to pursue any rights or remedies available under Chapter 12T or this Lease, including but not limited to a penalty of \$50 for a second violation and \$100 for a subsequent violation for each employee, applicant or

other person as to whom a violation occurred or continued, termination or suspension in whole or in part of this Lease.

(h) If Tenant has any questions about the applicability of Chapter 12T, it may contact the City's Real Estate Division for additional information. City's Real Estate Division may consult with the Director of the City's Office of Contract Administration who may also grant a waiver, as set forth in Section 12T.8.

27.48. Cooperative Drafting

This Lease has been drafted through a cooperative effort of both parties, and both parties have had an opportunity to have the Lease reviewed and revised by legal counsel. No party shall be considered the drafter of this Lease, and no presumption or rule that an ambiguity shall be construed against the party drafting the clause shall apply to the interpretation or enforcement of this Lease.

27.49. Sugar-Sweetened Beverage Prohibition

Tenant agrees that it will not sell, provide, or otherwise distribute Sugar-Sweetened Beverages, as defined by San Francisco Administrative Code Chapter 101, as part of its performance of this Agreement.

NOTWITHSTANDING ANYTHING TO THE CONTRARY CONTAINED IN THIS LEASE, TENANT ACKNOWLEDGES AND AGREES THAT NO OFFICER OR EMPLOYEE OF CITY HAS AUTHORITY TO COMMIT CITY TO THIS LEASE UNLESS AND UNTIL CITY'S BOARD OF SUPERVISORS SHALL HAVE DULY ADOPTED A RESOLUTION APPROVING THIS LEASE AND AUTHORIZING THE TRANSACTIONS CONTEMPLATED HEREBY. THEREFORE, ANY OBLIGATIONS OR LIABILITIES OF CITY HEREUNDER ARE CONTINGENT UPON ADOPTION OF SUCH A RESOLUTION, AND THIS LEASE SHALL BE NULL AND VOID IF CITY'S MAYOR AND THE BOARD OF SUPERVISORS DO NOT APPROVE THIS LEASE, IN THEIR RESPECTIVE SOLE DISCRETION. APPROVAL OF THIS LEASE BY ANY DEPARTMENT, COMMISSION OR AGENCY OF CITY SHALL NOT BE DEEMED TO IMPLY THAT SUCH RESOLUTION WILL BE ENACTED, NOR WILL ANY SUCH APPROVAL CREATE ANY BINDING OBLIGATIONS ON CITY.

City and Tenant have executed this Lease as of the date first written above.

TENANT: POETS CAFE LLC, California limited liability company

By: 
Printed name: MARC AUSTIN
Its: Owner

By: 
Printed name: NICK SHIHADEN
Its: Owner

CITY: CITY AND COUNTY OF SAN FRANCISCO,
a municipal corporation

By: _____
JOHN UPDIKE
Director of Real Estate

RECOMMENDED BY:

LUIS HERRERA, Director
San Francisco Public Library

APPROVED AS TO FORM:
DENNIS J. HERRERA, City Attorney

By: 
Elizabeth A. Dietrich
Deputy City Attorney

EXHIBIT A

SITE PLAN

CONSISTING OF TWO PAGE(S)

[See Attached]

↑ NORTH ↑

FULTON STREET

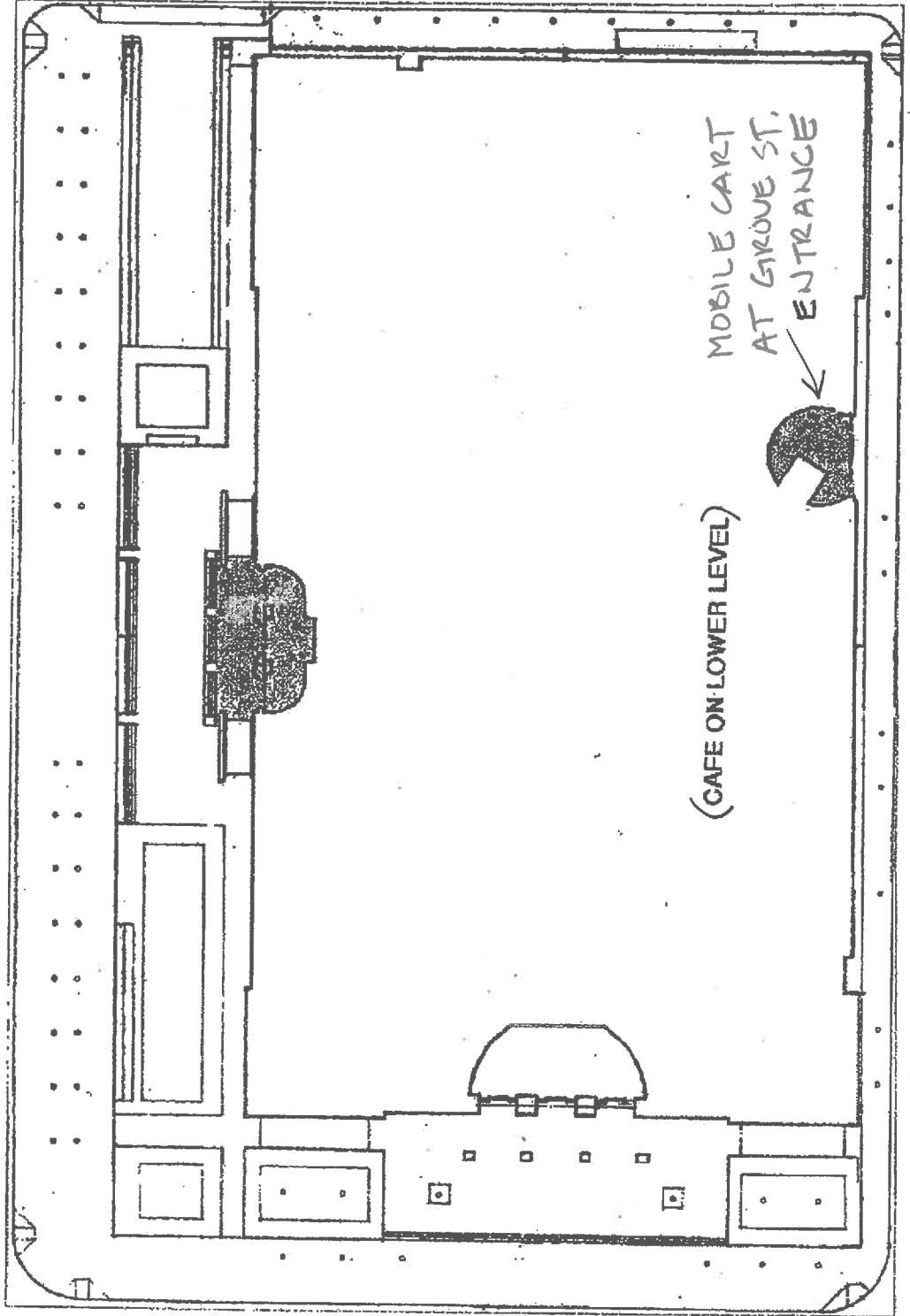

LARKIN STREET

McCALISTER STREET

SAN FRANCISCO PUBLIC LIBRARY

GROVE STREET

SITE PLAN

MAIN LIBRARY CAFE

100 LARKIN

NOTE: AREA DEVOTED "PANTRY"
IS TO BE INCLUDED IN THE
SPACE LEASED TO TENANT.

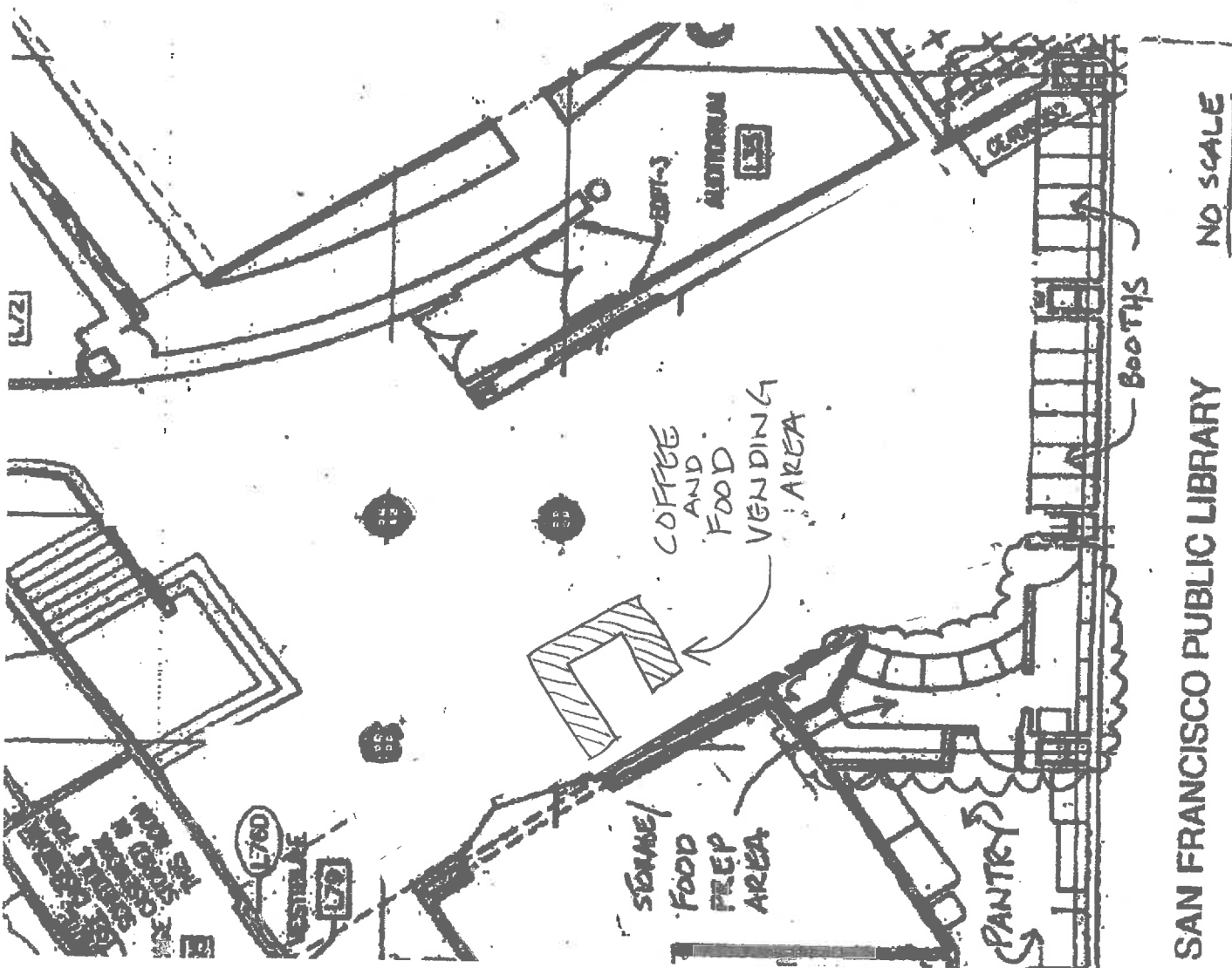

SAN FRANCISCO PUBLIC LIBRARY NO SCALE

EXHIBIT B
BUSINESS PLAN

[See Attached]

Business Plan

Named as SF Public Library Café for purpose of this business plan only

Executive Summary

The San Francisco Library Cafe is a quick-service restaurant/cafe located in the Main branch of the San Francisco public library. The cafe features a full menu of moderately priced breakfast pastries, sandwiches / salads, artisan Coffee drinks and “healthy” snack alternatives. The Coffeehouse section of The SF Library Café features Coffees from a local, artisan coffee roaster such as Peet’s, Blue Bottle, Four barrel, etc., (TBD)

The SF Library Cafe will be owned and operated by Nick Shihadeh and Marc Austin.

This business plan offers executives of the Library an opportunity to review our vision and strategic focus. It also provides a step-by-step plan for the business start-up, establishing favorable sales numbers, gross margin, and profitability.

This plan includes chapters on the company, products and services, market focus, action plans and forecasts, management team, and financial plan.

1.1 Objectives

1. Sales approaching and surpassing \$300,000 by the end of the first year.
2. Targeting and maintaining a net profit of at least 14% by the second year.
3. To cultivate monthly sales to reach \$30,000 by the end of the fourth month of operation, and \$40,0000 monthly by the end of the first year of operation.

1.2 Mission

The SF Public Library Cafe concept is built upon the needs and demands of both employees and patrons of the SF Public Library

The SF Public Library Cafe will provide accessible and affordable high quality food, coffee-based products to the thousands of employees and patrons visiting the Library each day, as well as the thousands of pedestrians walking past the Library wanting grab n go Coffee and pastry products on the way to their offices. . In time, The SF Public Library Cafe will establish itself as a "destination" of choice to the many visitors and employees within the public Library.

Our establishment will provide a "complete, high-quality" experience for those searching for quick and affordable coffees, breakfast, lunch and snacks. Patrons will be able to dine on foods that are healthy, quick and affordable without having to leave the confines of the Library.

The cafe's aim is simple. It will provide a completely sophisticated, sensual, yet quick dining and/or coffeehouse experience for all of the employees and patrons at the Library. It will be an affordable venture, one that will encourage guests to return on many occasions. The menu will feature healthy fare of the type that is frequently demanded by the typical library patron / employee...but currently out of reach because time frequently prevents her/him from leaving the facility to source their cravings.

Finally, and quite significantly, The Library Cafe will provide a much needed quality-based food operation that is currently unavailable to visitors of the Library.

1.3 Keys to Success

The keys to success in this business are:

Product quality: Food, coffee-based beverages, and snacks are our products. They must be of the high quality and value.

1. Service: Our patrons are paying to have a good experience. Their experience will suffer if service is not of the highest caliber. Each member of the staff will be courteous, efficient, and attentive.
2. Marketing: We will need to target our audience early and often. While the business is located in a captive location, many people will have to be re-introduced to the Café.

3. Management: We will need to have a firm grasp on food, beverage, and labor costs. The dining /coffeehouse experience must be delivered in a fashion that will not only inspire repeat business, but encourage word-of-mouth recommendations to others. Proper inventory, employee management, and quality control is key.

Company Summary

The Library Cafe is a bistro and coffeehouse facility located in the main branch of the San Francisco Public Library and directly across the street from the SF Civic Center.

2.1 Company Ownership

The Library Cafe is a privately held limited liability corporation wholly owned by Dream n Dare LLC

2.2 Start-up Summary

The start-up costs for The Library cafe can be found in the table below.

Start-up Requirements	
Start-up Expenses	
Legal	\$2,000
Insurance	\$1,745
Licenses/Tax/Deposits	\$2,000
Expensed Equipment	\$12,600
Employee/Payroll	\$10,000
Misc. Expenses	\$2,000
Total Start-up Expenses	\$30,345
Start-up Assets	
Cash Required	\$30,000
Start-up Inventory	\$10,000

2.3 Company Locations and Facilities

The Library Cafe will be located in the main branch of the San Francisco Public Library

The facility will be divided equally between the cafe/restaurant function and the coffeehouse function. The restaurant will feature minimal dining room seating for approximately 25 patrons. The cafe/coffeehouse will provide a quick-service dine-in and carry-out coffee-based beverages, as well as a dessert bar, sandwiches, salads and snacks. The Library Café will also operate a separate remote Coffee Cart on the outside portion of the library.

Products

The Library Cafe is a cafe/restaurant/coffeehouse venue that sells moderately-priced food to an upscale casual dining market. The Cafe features brewed coffee and espresso-based beverages from a local artisan Coffee Roaster, fruit smoothies and juices, and other beverages typically associated with a coffee shop. A pastry bar will serve a range of freshly prepared desserts, as well as baked goods associated with breakfast.

Luncheon offerings contain both carry-out and dine-in menu selections, featuring gourmet sandwiches, fresh salads and healthy snacks.

3.1 Product Description

The Library Cafe menu will feature a selection of ethnic dishes influenced by the diverse culture of San Francisco.

Specialty coffees, espresso-based drinks, desserts and pastries, and light sandwiches and salads will be available in the cafe.

3.2 Competitive Comparison

The Library Cafes closest competitors (relative to location) are Burger King (across the street), Philz Coffee (2/10 mile), Starbucks (2/10 mile), Celtic Coffee (3/10 mile)

None of these establishments features a fresh made, breakfast / lunch menu. Travel to these establishments is difficult and time consuming.

Relative to the location of these establishments, The Library Cafe will easily allow for patrons and library employees a large variety, healthy alternatives, excellent service and great prices to assure their repeat business.

3.3 Sales Literature

A sample copy of a menu from Murphy's is attached in an appendix at the end of this document.. The Library Café menu would be similar but with modifications.

3.4 Sourcing

The Library Cafe will buy from a select group of local restaurant suppliers and distributors. Direct sales relationships will also be established with fresh produce, meat, and dairy distributors. Negotiations are also underway to establish direct relationships with local, non-profit bakery organizations which assist the community in work and placement programs.

The cafe will also use sustainable, compostable and recyclable products based on availability and within code of San Francisco health department.

3.5 Technology

The Library Café will utilize an “in library” application for employees and patrons of the library to order from anywhere within the library and have their food / drinks ready for pickup or delivered to their location within the library.

We will also utilize a web based ordering system and text message to accommodate for diverse ordering.

3.6 Other Products

While The Library Cafe will focus upon the retail of food and coffee products, we will also put our efforts and focus upon providing full-scale catering for Library gatherings and events.

Market Analysis Summary

The casual dining/quick service restaurant market is a \$100+ billion industry in the United States, with annual increases in revenue outpacing 5% yearly. More and more people are choosing to eat out. One of the most common reasons cited by restaurateurs and industry associations is that women have joined the workforce in record numbers. In fact, from 1955 to 1995, the dollars spent for food away from home rose by almost 20%, coinciding with the number of women entering the work force. With two income earners per household, neither person may have time to fix meals. Since the 1950s, commercial food service sales have continued to rise as more and more people find that eating away from home suits their lifestyles.

Specialty coffee is a \$5+ billion per year industry in the United States, and has grown at a rate in excess of 20% per year in the last decade. That sustained growth is expected into this decade according to the Specialty Coffee Association of America.

4.1 Market Segmentation

A Café /coffeehouse within the SF Public Library would provide one of the best food and beverage opportunities for the thousands of annual visitors to Library

Location is close to many offices and government employees at the Civic Center.

Library patrons and employees will provide primary support; secondary support will come from area pedestrians and event catering within the Library.

Cross-selling opportunities exist with coffee beverages and used books, art and magazines.

The coffee shop and the magazines sold there will be positioned to fill a niche demand for people interested in art, architecture, design photography, and home and garden pursuits.

The immediate market area is within a 2 block radius of The Library and includes employees working at the Civic Center and Law School..

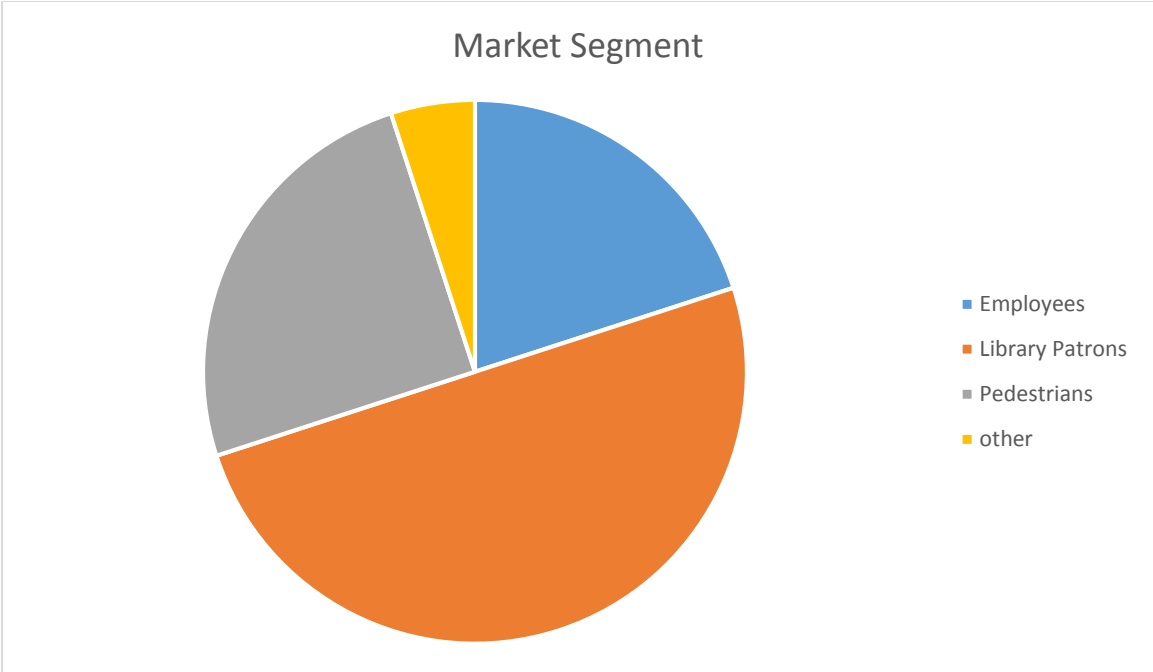

4.2 Target Market Segment Strategy

The Library Cafe will appeal to urban professionals visiting or working within the Library and workers who desire a sophisticated yet casual eating, coffeehouse experience. The business will also meet an under-served need for a pedestrian-friendly coffeehouse establishment for the numerous workers in the area.

Members of this market segment dine out frequently for lunch, approximately three times or more per week. The market segment is largely made up of singles between the ages of 25 and 40, graduate and professional students attending area universities, and business people conducting research.

4.2.1 Market Needs

Our customer's dining needs are critical to the success of The Library Cafe. As a supplier of a quick-service dining experience, The Library Cafe must appeal to people who are interested in integrating our type of products regularly into their dining/food purchase experiences. Moreover,

we must also appeal to those customers who regularly take advantage of other coffeehouse locations.

Many of our potential customers are educated and interested in partaking of new experiences. Keeping the menu offerings "fresh" will remain a constant challenge to the business. Segments of the target market tend to dine out and visit coffee shops frequently. They tend to choose comfortable, affordable venues, and repeat appearances at places that offer familiar scenery with new twists.

4.2.2 Market Trends

San Francisco is experiencing a trend toward high end Artisan coffee shops. They are popular and gaining more recognition. Evidence of this is found in local news and magazine coverage. These venues are finding new homes but lack the desire to open in the surrounding blocks of the Library location.

The market opportunity for coffee shop establishments has never been better in this area of San Francisco. The immediate area surrounding the business venue is underdeveloped with sophisticated coffee locations, yet there is a high demand with the patrons and employees of the Library for a quality brand.

4.3 Industry Analysis

The restaurants and coffeehouses that make up the community of establishments in the area surrounding The Public Library are quite diverse. Their concepts range from typical fast food/chain venues to lower quality / low cost restaurants. However, the predominating nature of the immediately surrounding restaurants and coffee shops is casual/upscale.

4.3.1 Competition and Buying Patterns

The general nature of the competition is typically not the type of foods and beverages associated with the clientele and employees of the library.

Because this population tends to eat out far more than the typical population, they look for value. While they might not regularly frequent a restaurant featuring entree prices of \$17.00 and higher, they will repeat appearances at restaurants featuring entrees ranging between \$5.00 and \$9.00.

4.3.2 Main Competitors

Philz Coffee: Located 3 blocks North of the Library has a local following for quality, local coffee. Philz does not offer espresso beverages and menu offerings are limited. Also, Philz is notoriously slow in service because of the fresh nature in the way they brew their coffee.

Starbucks: Located 2 blocks South of the Library. Starbucks is an iconic brand with huge following. The quality of coffee is sub-par and menu selection is limited. Service can be good or bad.

Burger Ling: Is located directly across the street from the Library and offers no competitive products to the Library Café.

Strategy and Implementation Summary

The Library Cafes strategy is based upon targeting and serving:

- The atypical Library patron. This student or urban professional study's / works long hours and has relatively little time to cook at home. She/he has an active social life and spends a substantial amount of disposable income maintaining it.

5.1 Competitive Edge

The Library Cafe maintains a competitive edge in several significant areas:

- The facility's location give the café a captive audience to library patrons and library employees
- The owners have years of experience in healthy foods and coffee shops, as well as a long standing history of excellent customer service.

5.2 Value Proposition

We think our value proposition is quite clear and quite easily distinguished from most others in the market. We offer affordable and accessible menu items as measured by their inherently natural value, at an affordable price that will encourage regular visits.

5.3 Sales Strategy

The first category of our sales strategy is to establish and maintain a position with our primary constituents: Library patrons and employees.

Our second strategy is to utilize the Library events and gatherings catering opportunities.

Our third strategy targets the 1000's of pedestrians walking past the library daily

5.3.1 Sales Forecast

Our sales forecast assumes no change in cost of prices.

We are expecting to increase sales to \$300,000 at the end of 2016. The growth forecast is in line with the restaurants in the area and is tied to the projected increase in population of the immediate area.

Sales projections take into account seasonal months and colder weather for hot beverage sales.

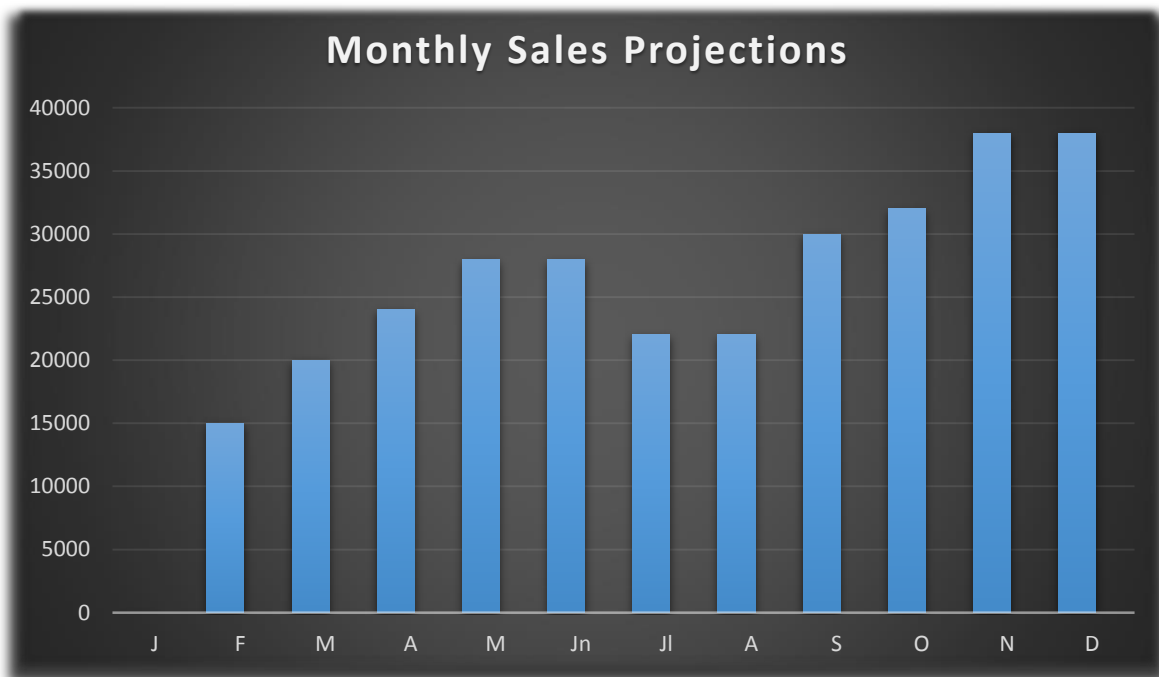

5.5 Marketing Strategy

The most important element of our marketing strategy is the delivery of a quality product. Our food and beverage must first sell themselves through word of mouth.

We anticipate our “In Library” App will allow patrons and employees of the Library the opportunity to place an order and pick up or have delivered in minimal time.

5.5.1 Sales Programs

Specific Sales Programs:

1. Special Event Sales: Develop opportunities to cater to companies for private parties and special events held at the Library.
2. Other special events may be hosted by the café and may include topics such as regular coffee and tea tastings.

5.5.2 Positioning Statement

For our most important target market, local employees and patrons of the library who crave new and sophisticated coffeehouse options, The Library cafe satisfies the need for a casual, all-in-one experience. Unlike our key competition, The Library Cafe is designed to handle this need from its inception, starting with the general layout of the facility. The general food offerings, coupled with the coffee program, will offer the customer an experience unlike anything he or she has currently available.

5.5.3 Pricing Strategy

Our food and drinks options are priced to give us an attractive margin while at the same time offering value to the consumer. We want repeat business. We also want the experience to remain fresh. Therein lies why the food and beverages concept will be relatively flexible.

A sample menu is included in an appendix.

5.5.4 Promotion Strategy

We will promote our company name and label as much as the product itself, because to be successful we have to stand for brand-name integrity, excellent menu offerings, and first class service. Therefore, our promotion strategy includes focusing on the overall experience:

5.5.5 Marketing Programs

Our marketing program will be minimal and no budget will be set aside for such. Given a mostly captive clientele, our product and service is our best marketing program and our spend will be for quality product and employees.

5.6 Strategic Alliances

We depend on our alliances with non-profit organizations throughout San Francisco to use as suppliers and work force where applicable. Our plan is to utilize these organizations to provide opportunity in the community but to realize the business aspect of dealing with customers on a professional basis.

Management Summary

The Library Cafe is owned by a Nick Shihadeh and Marc Austin. The Café will be managed by both.

Additionally, an assistant manager, baristas and servers will perform secondary management functions.

6.2 Personnel Plan

The personnel plan calls for hiring 6 part-time hourly employees at start-up. Part time barristas/bartenders will have to be hired to manage approximately 190 hours of operation per week,

Any additional hires will be part time and devoted to the expansion of any catering function, as well as increased capacity/operation of a private party function.

6.3 Management Team

Nick Shihadeh - Owner: Mr. Shihadeh owns and operates successful cafes throughout the bay area and including Murphys café in Walnut Creek and Tias in Berkeley.

Marc Austin – General Manger: Mr. Austin has worked as a restaurant consultant for over 25 years and throughout the United States. Currently, Mr Austin runs the foodservice sales program for Peet’s Coffee & Tea

Financial Plan

We want to finance growth mainly through cash flow. We recognize that this means we will have to grow more slowly than we might like.

The most important indicator in our case is inventory turnover. We have to make sure that food inventory turnover stays at approximately four turns per month, or we risk loss through spoilage.

Fortunately, we have minimal collection days as we only wait 2-3 days to get paid by our bank on credit / debit transactions.

We must target a net profit of 14% at the least, and hold marketing costs to no more than one to three percent of gross sales.

7.2 Projected Cash Flow

We expect to manage cash flow over the next five years with minimal new investment required over the first two years. It is our expectation that revenue beyond projected sales will be invested in retiring long-term debt early.

7.3 Key Financial Indicators

The most important indicators in our case are daily customer "counts" and weekly sales numbers. We must also make sure that we are turning our inventory rapidly so as to avoid food spoilage.

We must target net profit/sales figures toward the 14% level with gross margins never dipping below 38%. Marketing costs should never exceed three percent of sales.

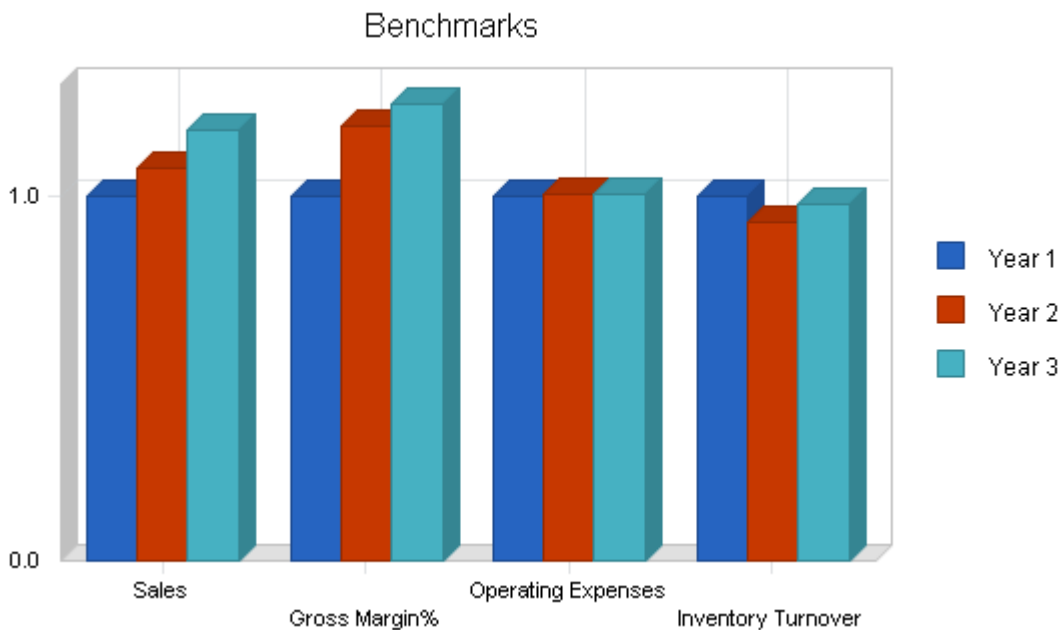

We expect income to approach \$300,000 for calendar year 2016. It should increase to \$500,000 by the end of year 2018.

EXHIBIT C

STANDARD UTILITIES AND SERVICES

The standards set forth below describe the basic utilities and services which are presently in effect for the Building. City reserves the right to adopt any nondiscriminatory modifications and additions to such standards which do not materially impair Tenant's rights under this Lease or Tenant's use of the Premises. City shall give Tenant reasonable advance notice, in accordance with the provisions of this Lease, of any material modifications and additions, which shall be subject to the reasonable approval of Tenant.

Subject to the terms and conditions of this Lease, City shall provide the following basic utilities and services:

A. Elevator. Unattended automatic passenger elevator facilities serving the floor(s) on which the Premises are located, on a 24-hour a day, 7-day a week basis. Freight elevator service is available upon reasonable advance written request, subject to rules and regulations established by City including hours and days of usage.

B. Ventilation; Heating and Air-Conditioning. Ventilation to the Premises, and air-conditioning and heating to the Premises in season, Monday through Friday, except holidays generally recognized in the City of San Francisco, from 6:00 a.m. to 9:00 p.m., and at such temperatures and in such amounts as City deems reasonably necessary for the comfortable occupancy of the Premises, subject to applicable governmental laws, ordinances, rules and regulations. Tenant shall not alter, adjust, tamper with or in any manner affect the installations or facilities supplying climate control to the Building or the Premises.

C. Electricity. Electric current to the Premises on a 24-hours a day, 7-days a week basis, in such quantity as is reasonably determined by City to service standard office lighting and normal fractional horsepower office machines.

D. Water. Water available at current points of supply in public areas for drinking and lavatory purposes only, and hot and cold water in the Premises for drinking and kitchen purposes, on a 24-hours a day, 7-days a week basis.

E. Janitorial Service. Building standard janitorial service to the Premises on a 5-day per week basis, Monday through Friday, except holidays generally recognized in the City of San Francisco, provided the Premises are kept reasonably in order by Tenant. Tenant shall pay to City any cost incurred by City in excess of the services generally provided for other tenants in the Building. Tenant shall pay to City the cost of removal of any of Tenant's extraordinary refuse or rubbish.

EXHIBIT D

RULES AND REGULATIONS

1. The sidewalks, halls, passages, exits, entrances, elevators and stairways of the Building shall not be obstructed by Tenant or used by it for any purpose other than for ingress to and egress from the Premises. City shall in all cases retain the right to control and prevent access to the halls, passages, exits, entrances, elevators, escalators and stairways that are not for the use of the general public, and City shall in all cases retain the right to control and prevent access thereto of all persons whose presence in the judgment of City would be prejudicial to the safety, character, reputation and interests of the Building and its tenants, provided that nothing herein contained shall be construed to prevent such access to persons with whom Tenant normally deals in the ordinary course of its business, unless such persons are engaged in illegal activities. Tenant shall not go upon the roof of the Building, except in areas that City may designate as "Common Areas" from time to time.
2. No sign, placard, picture, name, advertisement or notice visible from the exterior of the Premises shall be installed or displayed by Tenant on any part of the outside or inside of the Building without the prior written consent of City. City shall have the right to remove, at Tenant's expense and without notice, any sign installed or displayed in violation of this rule. All approved signs or lettering on doors shall be printed, painted, affixed or inscribed at the expense of Tenant by a person approved by City, which approval will not be unreasonably withheld. Material visible from outside the Building will not be permitted.
3. The Premises shall not be used for the storage of merchandise held for sale to the general public or for lodging. No cooking shall be done or permitted by Tenant on the Premises, except that use by Tenant of Underwriters' Laboratory-approved microwave oven and portable equipment for brewing coffee, tea, hot chocolate and similar beverages shall be permitted, provided that such use is in accordance with all applicable federal, state and local laws, codes, ordinances, rules and regulations.
4. Tenant shall not employ any person or persons other than the janitor of City for the purpose of cleaning the Premises, unless otherwise agreed to by City in writing. Except with the written consent of City, no person or persons other than those approved by City shall be permitted to enter the Building for the purpose of cleaning same. Tenant shall not cause any unnecessary labor by reason of Tenant's carelessness or indifference in the preservation of good order and cleanliness. 5. City will furnish Tenant with two (2) keys to the Premises, free of charge. City may make a reasonable charge for such additional keys and for having locks changed. Tenant shall not make or have made additional keys without City's prior written consent, which consent shall not be unreasonably withheld or delayed. Tenant shall not alter any lock or install any new or additional locking devices without the prior written consent of City. All locks installed in the Premises, excluding Tenant's vaults and safes, or special security areas (which shall be designated by Tenant in a written notice to City), shall be keyed to the Building master key system. City may make reasonable charge for any additional lock or any bolt (including labor) installed on any door of the Premises. Tenant, upon the termination of its tenancy, shall deliver to City all keys to doors in the Premises. If Tenant loses any keys, Tenant shall pay City for the cost of re-keying the Premises.
6. The elevators to be used for the loading of freight shall be available to Tenant in accordance with such reasonable scheduling as City shall deem appropriate. Tenant shall schedule with City, by written notice given no less than forty-eight (48) hours in advance, its move into or out of the Building, which moving shall occur only on weekend days if required by City; and Tenant shall reimburse City upon demand for any additional security or other charges incurred by City as a consequence of such moving. The persons employed

by Tenant to move equipment or other items in or out of the Building must be acceptable to City. The floors, corners and walls of elevators and corridors used for the moving of equipment or other items in or out of the Building must be adequately covered, padded and protected, and City may provide such padding and protection, at Tenant's expense, if City determines that such measures undertaken by Tenant or Tenant's movers are inadequate. City shall have the right to prescribe the weight, size and position of all equipment, materials, supplies, furniture or other property brought into the Building. Heavy objects shall, if considered necessary by City, stand on wood strips of such thickness as is necessary to properly distribute the weight of such objects. City will not be responsible for loss of or damage to any such property from any cause, and all damage done to the Building by moving or maintaining Tenant's property shall be repaired at the expense of Tenant.

7. Tenant shall not use or keep in the Premises or the Building any kerosene, gasoline or flammable, combustible or noxious fluid or materials or use any method of heating or air conditioning other than those limited quantities necessary for the operation and maintenance of normal office equipment. Tenant shall not use, keep or permit or suffer the Premises to be occupied or used in a manner offensive or objectionable to City or other occupants of the Building by reason of noise, odors, and/or vibrations, or interfere in any way with other tenants or those having business in the Building.
8. City reserves the right to exclude from the Building between the hours of 6 p.m. and 8 a.m. and at all hours on Saturdays, Sundays, and legal holidays all persons who do not present a pass to the Building signed by City and properly in the possession of the person presenting such pass. City will furnish passes to persons for whom Tenant requests the same in writing. Tenant shall be responsible for all persons for whom it requests passes and shall be liable to City for all acts of such persons. City shall in no case be liable for damages for any error with regard to the admission to or exclusion from the Building of any person. In the case of invasion, mob, riot, public excitement or other circumstances rendering such action advisable in City's opinion, City reserves the right to prevent access to the Building during the continuance of same by such action as City may deem appropriate, including closing any doors in the Building.
9. The directory of the Building will be provided for the display of the name and location of tenants and a reasonable number of the principal officers and employees of tenants, and City reserves the right to exclude any other names therefrom. Any additional name that Tenant shall desire to place upon the directory must first be approved by City and, if so approved, a charge will be made for each such name.
10. Tenant shall not cut or bore holes for wires in the partitions, woodwork or plaster of the Premises. Tenant shall not affix any floor covering to the floor of the Premises in any manner except as approved by City.
11. No curtains, draperies, blinds, shutters, shades, screens or other coverings, hangings or decorations shall be attached to, hung or placed in, or used in connection with any window of the Building without City's prior written consent. In any event, with the prior written consent of City, such items shall be installed on the office side of City's standard window covering and shall in no way be visible from the exterior of the Building.
12. Tenant shall see that the doors of the Premises are closed and locked and that all water faucets, water apparatus and utilities are shut off before Tenant or Tenant's employees leave the Premises, so as to prevent waste or damage, and for any default or carelessness in this regard Tenant shall make good all injuries sustained by other tenants or occupants of the Building or City. On multiple-tenancy floors, all tenants shall keep the doors to the Building corridors closed at all times except for ingress and egress, and all tenants shall at

all times comply with any rules or orders of the fire department with respect to ingress and egress.

13. The toilet rooms, toilets, urinals, wash bowls and other apparatus shall not be used for any purpose other than that for which they were constructed, no foreign substance of any kind whatsoever shall be deposited therein. The expense of any breakage, stoppage or damage resulting in any violation of this rule shall be borne by Tenant.
14. Except with City's prior consent, Tenant shall not sell, or permit the sale from the Premises of, or use or permit the use of any sidewalk or mall area adjacent to the Premises for the sale of, newspapers, magazines, periodicals, theater tickets or any other goods, merchandise or service, nor shall Tenant carry on, or permit or allow any employee or other person to carry on, business in or from the Premises for the service or accommodation of occupants or any other portion of the Building, nor shall the Premises be used for manufacturing of any kind, or for any business or activity other than that specifically provided for in Tenant's lease.
15. Tenant shall not install any radio or television antenna, loudspeaker, or other device on or about the roof area or exterior walls of the Building. Tenant shall not interfere with radio or television broadcasting or reception from or in the Building or elsewhere.
16. Tenant shall not use in any space, or in the common areas of the Building, any hand-trucks except those equipped with rubber tires and side guards or such other material-handling equipment as City may approve. No other vehicles of any kind shall be brought by Tenant into the Building or kept in or about the Premises.
17. Tenant shall store all its trash and garbage within the Premises until removal of the same to such location in the Building as may be designated from time to time by City. No material shall be placed in the Building trash boxes or receptacles if such material is of such nature that it may not be disposed of in the ordinary and customary manner of removing and disposing of trash and garbage in the City of San Francisco without being in violation of any law or ordinance governing such disposal.
18. All loading and unloading of merchandise, supplies, materials, garbage and refuse shall be made only through such entryways and freight elevators and at such times as City shall designate. In its use of the loading areas of the Building, Tenant shall not obstruct or permit the obstruction of said loading areas, and at no time shall Tenant park vehicles therein except for immediate loading and unloading purposes.
19. Canvassing, soliciting, peddling or distribution of handbills or any other written material in the Building is prohibited and Tenant shall cooperate to prevent the same.
20. Tenant shall immediately, upon request from City (which request need not be in writing), reduce its lighting in the Premises for temporary periods designated by City, when required in City's judgment to prevent overloads of the mechanical or electrical systems of the Building.
21. City reserves the right to select the name of the Building and to make such change or changes of name as it may deem appropriate from time to time, and Tenant shall not refer to the Building by any name other than: (i) the name as selected by City (as the same may be changed from time to time), or (ii) the postal address approved by the United States Post Office. Tenant shall not use the name of the Building in any respect other than as an address of its operation in the Building without the prior written consent of the City.

22. Tenant assumes all responsibility for protecting its Premises from theft, robbery and pilferage, which includes keeping doors locked and other means of entry closed.
23. No vending machine shall be maintained or operated within the Premises or the Building without City's prior written consent.
24. All incoming mail and package deliveries shall be received at the area in the Building designated by City for such purposes and distributed through means established by City. No messenger or other delivery personnel shall be permitted to enter any area of the Building other than the area designated by City for the pick-up and receipt of such deliveries.
25. City reserves the right to exclude or expel from the Building any person who is, in the judgment of City, intoxicated or under the influence of alcohol or other drug or who is in violation of any of the Rules or Regulations of the Building.
26. No animal or bird shall be permitted in the Premises or the Building, except for service dogs when in the company of their masters.
27. The requirements of Tenant will be attended to only upon application by telephone or writing or in person at the management office of the Building. Employee of City shall not perform any work or do anything outside of their regular duties unless under special instructions from City.
28. City may waive any one or more of these Rules and Regulations for the benefit of any particular tenant or tenants, but no such waiver by City shall be construed as a waiver of these Rules and Regulations in favor of any other tenant or tenants, nor prevent City from thereafter enforcing any such Rules and Regulations against any or all of the tenants of the Building.
29. Wherever the word "Tenant" occurs in these Rules and Regulations, it is understood and agreed that it shall mean Tenant's associates, agents, clerks, employees and visitors. Wherever the word "City" occurs in these Rules and Regulations, it is understood and agreed that it shall mean City's assigns, agents, officers, employees and visitors.
30. These Rules and Regulations are in addition to, and shall not be construed in any way to modify, alter or amend, in whole or part, the terms, covenants, agreements and conditions of any lease of premises in the Building.
31. City reserves the right to make such other and reasonable rules and regulations as in its judgment may from time to time be needed for the safety, care and cleanliness of the Building, and for the preservation of good order therein.
32. Tenant shall be responsible for the observance of all the foregoing Rules and Regulations by Tenant's employees, agents, clients, customers, invitees and guests.

EXHIBIT E

FIRST SOURCE HIRING AGREEMENT

[See Attached]



CITY AND COUNTY OF SAN FRANCISCO
 OFFICE OF ECONOMIC AND WORKFORCE DEVELOPMENT
 WORKFORCE DEVELOPMENT DIVISION



FIRST SOURCE HIRING PROGRAM
 NON-CONSTRUCTION END USE

Business Name: _____ **Phone:** _____
Main Contact: _____ **Email:** _____

Signature of authorized representative* **Date**

**By signing this form, the contractor/lessee agrees to participate in the Workforce System managed by the Office of Economic and Workforce Development (OEWD) and comply with the provisions of the First Source Hiring Agreement pursuant to San Francisco Administrative Code Chapter 83.*

Instructions:

- The employer must notify the First Source Hiring Program (Contact Info below) if an **Entry Level Position** becomes available.

Section 1: Select your Industry

- | | | |
|--|---|--|
| <input type="checkbox"/> Auto Repair | <input type="checkbox"/> Entertainment | <input type="checkbox"/> Personal Services |
| <input type="checkbox"/> Business Services | <input type="checkbox"/> Elder Care | <input type="checkbox"/> Professionals |
| <input type="checkbox"/> Consulting | <input type="checkbox"/> Financial Services | <input type="checkbox"/> Real Estate |
| <input type="checkbox"/> Construction | <input type="checkbox"/> Healthcare | <input type="checkbox"/> Retail |
| <input type="checkbox"/> Government Contract | <input type="checkbox"/> Insurance | <input type="checkbox"/> Security |
| <input type="checkbox"/> Education | <input type="checkbox"/> Manufacturing | <input type="checkbox"/> Wholesale |
| <input type="checkbox"/> Food and Drink | <input type="checkbox"/> I don't see my industry <i>(Please Describe)</i> _____ | |

Section 2: Describe Primary Business Activity

Section 3: Provide information on all Entry Level Positions

Entry-Level Position Title	Job Description	Number of New Hires	Projected Hiring Date

We will not hire any new workers for this project/program.

Please email, fax, or mail this form SIGNED to:

ATTN: Business Services
 Office of Economic and Workforce Development
 1 South Van Ness Avenue, 5th Floor, San Francisco, CA 94103
 Tel: 415-701-4848 Fax: 415-701-4897
<mailto:Business.Services@sfgov.org>
 Website: www.workforcedevelopmentsf.org

FOR CITY USE ONLY: Business Services Staff: _____ Approved: Yes No Date: _____
 Reason: _____