

**GALVEZ AVE**  
(80' WIDE R/W)

N 53°18'15" W  
64.00'

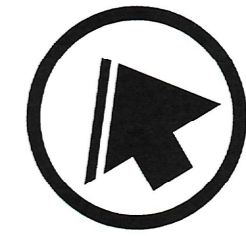

NORTH

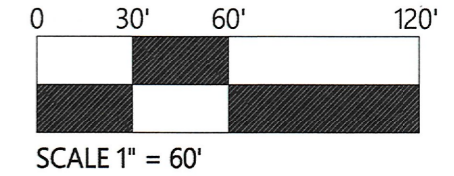

**NOTES:**

1. UNITS SHOWN HEREON ARE IN U.S. SURVEY FEET AND DECIMALS THEREOF.
2. ALL ANGLES SHOWN ARE 90° UNLESS OTHERWISE NOTED.

**BASIS OF BEARINGS:**

THE BEARING SOUTH 53°18'15" EAST, BEING THE NORTHERLY LINE OF INNES AVE AS SHOWN ON THAT CERTAIN RECORD OF SURVEY RECORDED ON DECEMBER 16, 2002 IN BOOK AA OF MAPS AT PAGES 49-58, WAS USED AS THE BASIS OF ALL BEARINGS SHOWN ON THIS MAP.

**LEGEND:**

	VACATION BOUNDARY
	PROPERTY LINE
	AREA TO BE VACATED
AC.	ACRES
APN	ASSESSORS PARCEL NUMBER
CCSF	CITY AND COUNTY OF SAN FRANCISCO
IBI	INDIA BASIN INVESTMENT
P.O.B.	POINT OF BEGINNING
PR.	PROPOSED
R/W	RIGHT-OF-WAY
SQ. FT.	SQUARE FEET

**HAWES ST**  
(64' WIDE R/W)

**HUDSON AVE**  
(80' WIDE R/W)

**HUDSON AVE**  
(TO BE VACATED)  
APN 4646-022

STREET VACATION  
CONTAINS 0.99 AC.  
OR 43,098 SQ. FT. ±

LANDS OF JAJEH  
FAMILY TRUST  
APN 4646-021

LANDS OF CCSF  
APN 4646-001

LANDS OF ELIZABETH ANN  
WINTERSTEEN-MOUSSIER  
APN 4645-010



LANDS OF CCSF  
APN 4646-002

LANDS OF CCSF  
APN 4646-003

**GRIFFITH ST**  
(WIDTH VARIES)

LANDS OF IBI, LLC  
APN 4645-015

**INNES AVE**  
(WIDTH VARIES)

S 53°18'15" E  
"BASIS OF BEARINGS"

P.O.B. S 53°18'15" E 19.50'

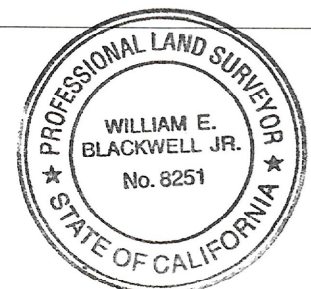

APPROVED:

*William Blackwell*

WILLIAM BLACKWELL, PLS 8251  
ACTING CITY AND COUNTY SURVEYOR

5/10/22

DATE

**CITY AND COUNTY OF SAN FRANCISCO**  
DEPARTMENT OF PUBLIC WORKS

VACATION OF A PORTION OF GRIFFITH STREET BETWEEN INNES AVENUE AND GALVEZ AVENUE AND PORTION OF HUDSON AVENUE BETWEEN GRIFFITH STREET AND HAWES STREET

FILE:  
SUR 2022-001

SHEET 1 OF 1

SCALE 1" = 60'

REVISION: