

All correspondence in connection with  
this contract should include reference to:

N6871102RP02P09

**LEASE**

**BETWEEN**

**THE UNITED STATES OF AMERICA**

**AND**

***TREASURE ISLAND DEVELOPMENT AUTHORITY***

**FOR**

**CHILDCARE CENTER (BLDG 502)**

**NAVAL STATION TREASURE ISLAND**

All correspondence in connection with  
this contract should include reference to:

N6871102RP02P09

TABLE OF CONTENTS

Paragraphs

1. Leased Premises
2. Term
3. Consideration
4. Use Of Leased Premises
5. Subletting
6. Joint Inspection and Inventory Report
7. Environmental Baseline Survey and Findings of Suitability to Lease
8. Alterations
9. Access by Government
10. Utilities and Services
11. Non-Interference with Government Operations
12. Protection and Maintenance Services
13. Environmental Protection Provisions
14. Termination
15. Environmental Contamination
16. Non-Environmental Indemnification by Lessee
17. Insurance
18. Labor Provision
19. Submission of Notices
20. Audit
21. Amendments
22. Failure to Insist on Compliance
23. Disputes
24. Covenant Against Contingent Fees
25. Officials Not to Benefit
26. Liens
27. Taxes
28. Subject to Existing and Future Easements and Rights-of-Way
29. Ingress-Egress and Parking
30. Administration
31. Surrender
32. Interest
33. Availability of Funds
34. Special Provisions
35. List of Exhibits

LEASE  
BETWEEN  
THE UNITED STATES OF AMERICA  
AND  
THE TREASURE ISLAND DEVELOPMENT AUTHORITY

THIS LEASE, made as of this 15<sup>th</sup> day of October, 2001, is by and between THE UNITED STATES OF AMERICA, acting by and through the Department of the Navy, herein called "Government", and the TREASURE ISLAND DEVELOPMENT AUTHORITY, herein called "Lessee";

**WITNESSETH:**

**WHEREAS**, Government has declared certain real and personal property, as more particularly described as the Leased Premises in Paragraph 1, surplus at the Naval Station Treasure Island, San Francisco, California, (the "Installation"), and Lessee has identified an immediate need to use such real and personal property; and

**WHEREAS**, the Secretary of the Navy, pursuant to the provisions of 10 U.S.C. § 2667 (f)(1), has determined that this Lease will facilitate state and local economic adjustment efforts pending final disposition of the Leased Premises; and

**WHEREAS**, the Secretary of the Navy, pursuant to 10 U.S.C. § 2667 (f)(2) has determined that a public interest will be served as a result of this Lease, the fair market value of the Lease is either unobtainable or not compatible with such public benefit; and consequently, consideration for this Lease will be at less than fair market value; and

**WHEREAS**, the Secretary of the Navy, after consultation with the Environmental Protection Agency Administrator has determined that the Leased Premises is suitable for lease, and the uses contemplated for the Lease are consistent with protection of human health and the environment; and

**WHEREAS**, Lessee is recognized by the Secretary of the Defense, through the Office of Economic Adjustment, as the local redevelopment authority with the responsibility for the redevelopment of the Installation; and

**WHEREAS**, Lessee is a municipal corporation, created and organized under the laws of the State of California, with the power to acquire, lease and dispose of federal military installations, and Lessee desires to enter into this Lease to further reuse efforts at the Installation.

N6871102RPO2P09

**NOW THEREFORE**, in consideration of the terms, covenants, and conditions set forth in this Lease, Government and Lessee hereby agree as follows:

**1. LEASED PREMISES:**

Subject to the terms and conditions of this Lease, Government does hereby lease, rent, and demise to Lessee, and Lessee does hereby hire and rent from Government, Buildings 502 and the surrounding premises, as shown on Exhibit A, consisting of approximately 3.11 acres, attached hereto, together with all improvements; and all personal property described in Exhibit B attached hereto, and all rights of ingress and egress to such real property (together, the "Leased Premises").

**2. TERM:**

The term of this Lease shall be for a period of 5 years beginning on 1 October 2001 and ending on 30 September 2006, unless sooner terminated in accordance with the provisions of Paragraph 14, Termination.

**3. CONSIDERATION:**

3.1 As consideration for this Lease, Lessee agrees to (i) actively market the Installation and attempt to sublease those portions of the Leased Premises which are suitable for subleasing, (ii) provide protection and maintenance to the extent described in Paragraph 12 for those portions of the Leased Premises which are or have been during the term of this Lease used or occupied by Lessee or subleased by Lessee to another and (iii) pay Government the Common Services Charge described in Sections 3.1.2 and 3.1.3 below.

3.1.1 As additional consideration, subject to annual appropriations by Lessee's Board of Supervisor's, Lessee shall apply any Revenue (as defined herein) received from subleasing the Premises as follows: first, to reimburse itself for marketing and property management expenses incurred by Lessee; and second, for expenses incurred by Lessee for improvements to the Installation. If sufficient funds for the purposes described in this Section 3.1.1 are not appropriated for any reason in any fiscal year of Lease after the fiscal year in which the Term of this Lease commences, then Government may terminate this Lease, without liability, upon thirty (30) calendar days written notice.

"Revenue" as referred to herein means rental income and any other miscellaneous income derived from the subletting of the Leased Premises less (i) sales tax, use and occupancy tax, franchise tax and any other taxes, building fees, planning fees and inspection fees related to the use and occupancy of the Leased Premises, and (ii) Lessee's cost of operating, maintaining, protecting and repairing the Leased Premises including, without

N6871102RP02P09

limitation, any Common Services Charges paid to Government pursuant to this Section 3.1.

3.1.2 Lessee shall be responsible for paying the cost of services incurred by Government and provided for the benefit of Lessee and sublessees as described and in the amount set forth in Paragraph 3.1.3 (the "Common Services Charge"). Lessee shall pay Government the Common Services Charge on the first day of each month.

3.1.3 The Common Services Charge will be calculated as follows:

\$0.050 per square foot per month of occupied building space (1) used or occupied by Lessee; (2) subleased by Lessee to another.

\$0.003 per square foot per month of land area (1) used or occupied by Lessee; (2) subleased by Lessee to another.

The Common Services Charge may be revised by Government and Lessee on an annual basis, or at other times only upon mutual agreement of Government and Lessee or as required by Section 3.1.4 below.

"Common Services" for the purpose of the Common Services Charge shall include, but are not limited to: fire fighting; general perimeter security (this does not include security of those portions of Leased Premises which are (1) used or occupied by Lessee, (2) subleased by Lessee to another); causeway operations, maintenance and repair; maintenance and repair of roads, streets, sidewalks, curbs and gutters; operation, maintenance and repair of street lighting, street signals and signage; operation, maintenance and repair of storm sewer; pest control, and general administration of these services. Nothing in this Lease commits Government to continue to provide Common Services referenced herein.

3.1.4 If and to the extent Government reduces, modifies or ceases to provide all or portion of the Common Services described herein or to the extent Lessee assumes the responsibility for such Common Services pursuant to a cooperative agreement or other agreement with Government, the Common Services Charge shall be proportionately reduced, to an amount mutually agreed upon by Government and Lessee, so that at all times during the term of this Lease the amount of the Common Services Charge shall accurately and in substantially the same proportion as provided herein reflect the costs of Government in providing such Common Services.

3.1.5 If the Government expects to incur any unanticipated costs which are specifically attributable to an action or inaction of the Lessee, its sublessees, or assigns, the Lessee and the Government shall meet and confer on ways to avoid or mitigate such costs and, if the costs can not be entirely

N6871102RPO2P 09

avoided, the Lessee and Government shall mutually determine the amount that Lessee shall pay from revenue in addition to the Common Services Charge to defray those costs that cannot be avoided or mitigated. If the Lessee and Government are unable to reach agreement on a way to avoid or mitigate the unanticipated costs or the amount of compensation that the Lessee shall pay to the Government to defray such costs, their dispute shall be resolved in accordance with the provisions of Paragraph 23 of this Lease.

3.2 Consistent with standard accounting practices for tax purposes, Lessee shall keep adequate records and books of account showing the actual cost to it of all items of labor, material, equipment, supplies, services and other items of cost incurred by it directly in the performance of any item of work or service in the nature of marketing and management; the repair, restoration, protection and maintenance of Leased Premises which is required by Paragraph 12; or otherwise approved or directed by Government. Lessee shall provide Government with access to such records and books of account and proper facilities for inspection thereof at all reasonable times.

#### **4. USE OF LEASED PREMISES:**

4.1 The Leased Premises may be used and operated by Lessee as a childcare center. Lessee understands and acknowledges that this is not and does not constitute a commitment by Government with regard to the ultimate disposal of Leased Premises, in whole or in part, to Lessee or any agency or instrumentality thereof, or to any sublessee. The Lease may be terminated by Government or Lessee as provided by the terms of the Lease pursuant to Paragraph 14, and Lessee and Government agree to and acknowledge such terms.

4.2 Lessee shall not undertake any activity that may affect an identified historic or archeological property, including excavation, construction, alteration or repairs of Leased Premises, without the approval of Government. Buried cultural materials may be present on the Leased Premises. If such materials are encountered, Lessee shall stop work immediately and notify Government.

#### **5. SUBLETTING:**

5.1 Lessee shall not sublet the Leased Premises or any interest therein or any property thereon, or grant any interest, privilege or license whatsoever in connection with this Lease without the prior written consent of Government. Such consent shall not be unreasonably withheld or delayed. Each sublease shall contain or incorporate by reference the environmental protection provisions set forth in Paragraph 13 herein. Under no circumstance shall Lessee assign this Lease without Government's prior written consent, except that no consent shall be required in connection with an assignment of this Lease to a successor to Lessee which is the local redevelopment authority for the Installation

N6871102RP02P09

recognized by the Secretary of Defense, through the Office of Economic Adjustment.

5.2 Any sublease granted by Lessee shall contain a copy of this Lease as an attachment and be subject to all terms and conditions of this Lease and shall terminate immediately upon the expiration or any earlier termination of this Lease, without any liability on the part of Government to Lessee or any sublessee. Under any sublease made, with or without consent, the sublessee shall be deemed to have assumed the obligations of Lessee under this Lease that relate to the portion of the Leased Premises subleased to such sublessee. No sublease shall relieve Lessee of any of its obligations hereunder.

5.3 Lessee shall furnish Government, for its prior written consent, a copy of each sublease it proposes to execute. Such consent may include a requirement that Lessee renegotiate the sublease to conform with the provisions of this Lease. The determination by Government as to the acceptability of a particular sublease shall principally include approval of the sublessee with respect to its proposed uses of the Leased Premises, the capability of the sublessee to perform its obligations under the sublease, and the conformity of the sublease to the provisions of this Lease. Such consent shall not be unreasonably withheld or delayed. Consent to any sublease shall not be taken or construed to diminish or enlarge any of the rights or obligations of either of the parties under this Lease. Should a conflict arise between the provisions of this Lease and a provision of the sublease, the provisions of this Lease shall take precedence. Upon its execution, a copy of the sublease shall immediately be furnished to Government.

5.4 Either party hereto shall, from time to time during the Term, upon not less than twenty (20) calendar days' prior written notice from the other party, execute, acknowledge and deliver to the other party, or such persons or entities designated by such other party, a statement in writing certifying: (a) the

N6871102RP02P09

commencement date and expiration date of this Lease, (b) that this Lease is unmodified and in full force and effect (or, if there have been modifications, that the Lease is in full force and effect as modified and stating the modifications), (c) that there are no defaults under this Lease (or if so, specifying the same), (d) the dates, if any, to which the Common Services Charge and any other consideration required hereunder has been paid.

**6. JOINT INSPECTION & INVENTORY REPORT:**

6.1 Joint Inspection. Representatives of the Lessee and Government shall conduct a joint inspection of all portions of the Leased Premises to be (1) beneficially used or occupied by the Lessee; (2) assigned by the Lessee to another; or (3) subleased by Lessee to another for any purpose. Such inspections shall be completed before any such use begins and may include a representative of the sublessee if appropriate. Based on the joint inspection, a complete inventory of Government property located on the Leased Premises and a report of the condition of the Leased Premises, including the condition of improvements, appurtenances and personal property thereon, has been prepared and is attached to this Lease as Exhibit C.

6.2 No Warranty by Government. All facilities and property delivered to the Lessee shall be delivered "as is, where is," and, as such, the Government makes no warranty as to such facilities and property either as to their usability generally or as to their fitness for any particular purpose. As provided in Section 12 of this Lease, Lessee shall, at no expense to Government, maintain those portions of the Leased Premises which Lessee uses or subleases, and will from time to time make or cause to be made all necessary and proper repairs, replacements, and renewals which shall thereupon become part of the Leased Premises. During the term of this Lease, Government shall have no responsibility, financial or otherwise, except as otherwise described herein with respect to protection and maintenance of the Leased Premises.

6.3 In accordance with 32 CFR §91.7(h), governing the disposition of personal property at closing military bases, Personal Property shall be identified throughout the Installation for use in connection with redevelopment of the Installation. At no expense to Government, and only with Government approval, Personal Property may be relocated from other buildings to the Leased Premises in order to facilitate redevelopment, including exclusive use thereof by the sublessee during the Term of this Lease. Each inventory, upon completion, shall be identified by building or facility number, and signed and dated by both parties to this Lease and attached to this Lease as part of the Joint Inspection Report attached hereto as Exhibit C.



**7. ENVIRONMENTAL BASELINE SURVEY AND FINDINGS OF SUITABILITY  
TO LEASE:**

An Environmental Baseline Survey for Lease (EBSL) and a Finding of Suitability to Lease (FOSL) are attached to this Lease as Exhibit D and made part of this Lease. The EBSL sets forth the existing environmental conditions of the Leased Premises as represented by the baseline survey which has been conducted by Government. The FOSL sets forth the basis for the Government's determination that Leased Premises are suitable for leasing. Lessee is hereby made aware of the information contained in the FOSL attached hereto as Exhibit D and shall comply with applicable restrictions set forth therein.

**8. ALTERATIONS:**

8.1 Lessee shall not construct, make or permit its sublessees to construct or make any substantial alterations, additions, excavations, improvements to, installations upon or otherwise modify or alter the Leased Premises in any way, including those which may adversely affect the remediation of hazardous materials on the Installation (together, "Alterations") without the prior written consent of Government. Such consent may not be unreasonably withheld or delayed, but may involve, where reasonably necessary, a requirement for Lessee or Lessee's contractor to provide the government with a performance and payment bond satisfactory to it in all respects and other requirements deemed reasonably necessary to protect the interests of the Government.

8.2 Upon termination of this Lease, as directed by Government, Lessee shall, at the option of the Government either:

8.2.1 Promptly remove all alterations, additions, betterments and improvements made or installed and restore the Leased Premises to the same or as good condition as existed on the date of entry under this Lease, reasonable wear and tear and acts of God excepted; or

8.2.2 Abandon such additions or alterations in place, at which time title to such alterations, improvements and additions shall vest in Government.

8.2.3 In either event all personal property and trade fixtures of Lessee or any third person may be removed from the Leased Premises and Lessee shall repair any damage to the Leased Premises resulting from such removal.

N6871102RP02P09

**9. ACCESS BY GOVERNMENT:**

In addition to access required under Paragraph 13, at all reasonable times throughout the term of this Lease, Government shall be allowed reasonable access to the Leased Premises for any purpose. Government will give Lessee or any sublessee at least twenty-four (24) hour prior notice of its intention to enter the Leased Premises, unless it determines the entry is immediately required for safety, environmental, operations or security purposes. Lessee shall have no claim on account of any entries against Government or any officer, agent, employee, contractor or subcontractor of Government. All keys to the buildings and facilities occupied by Lessee or any sublessee shall be made available to Government upon request.

**10. UTILITIES AND SERVICES:**

Procurement of utilities (i.e., electricity, water, gas, sewer, telephone and trash removal) will be the responsibility of Lessee. Lessee agrees to obtain needed utility services from any private or municipal supplier who should, during the term of Lease, become able to deliver such services to Leased Premises. In the event that Government shall furnish Lessee with any utilities or services maintained by Government which Lessee may require in connection with its use of Leased Premises, Lessee shall pay Government the cost incurred in providing such utilities or services in the amounts set forth in Exhibit E attached hereto, which rates shall be determined by Government and Lessee in accordance with applicable laws and regulations. Lessee, at no cost to Government, shall install metering devices for utilities serving the Leased Premises prior to its occupancy. The volume of utilities used by Lessee shall be determined by such metering devices. It is expressly agreed and understood that Government in no way warrants the continued availability, maintenance or adequacy of any utilities or services furnished to Lessee.

**11. NON-INTERFERENCE WITH GOVERNMENT OPERATIONS:**

Lessee shall not conduct operations nor make any alterations that would interfere with or otherwise restrict operations, environmental clean-up or restoration actions by Navy, Environmental Protection Agency (EPA), applicable state equivalent, or their contractors. Environmental clean-up, restoration or testing activities by these parties shall take priority over Lessee's use of Leased Premises in the event of any conflict. However, Government and Lessee agree to coordinate to minimize potential conflicts between necessary remediation of environmental contamination, including investigation and remedial actions, and Lessee's and any sublessee's use of Leased Premises.

All correspondence in connection with  
this contract should include reference to:

N6871102RP02P09

**12. PROTECTION AND MAINTENANCE SERVICES:**

12.1 Except as otherwise specifically provided herein, Lessee shall furnish or cause to be furnished all labor, supervision, materials, supplies and equipment necessary to the operation, maintenance and repair of the following building systems and appurtenances located in or on the Leased Premises: structural (including roof), fencing, plumbing, electrical, heating and cooling systems; exterior utility systems (including fire hydrants and mains); pavement and grounds maintenance (including grass cutting, shrub trimming and tree removal); pest and weed control; security and fire protection within Leased Premises; refuse collection, removal and disposal; and utilities maintenance necessary for the protection of Leased Premises. Government shall not be required to furnish any services or facilities to Lessee or to make any repair or alteration in or to Leased Premises. Lessee hereby assumes the full and sole responsibility for the protection, maintenance and repair of Leased Premises set forth in this paragraph. For specifics as to such protection and maintenance required to be provided by Lessee hereunder, the following provisions shall apply:

12.1.1 The degree of maintenance and repair services to be furnished by Lessee hereunder shall be that which is sufficient to assure weather tightness, structural stability (excluding any seismic retrofit and/or modification to foundations resulting from extraordinary natural occurrences such as earthquakes, floods and landslides), protection from fire hazards or erosion, and elimination of safety and health hazards which arise during the term of the Lease and which are not caused by the actions of Government or its employees, contractors or agents, so that the Leased Premises being serviced will remain in the condition in which they existed at the commencement of the Lease as documented in the Joint Inspection and Inventory Report prepared pursuant to Paragraph 6, ordinary wear and tear and acts of God excepted. Prior to use and occupancy, Lessee shall correct the safety and health hazards described on Exhibit F.

12.2 During term of this Lease, debris, trash and other useless materials placed on the Leased Premises during the term of this Lease shall be promptly removed from the Leased Premises. Upon termination or expiration of this Lease, the Leased Premises shall be left without containers, Lessee's equipment, and other undesirable materials placed on the Leased Premises during the term of this Lease (except by Government) and in as clean condition as received by Lessee.

N6871102RP02P09

12.3 Lessee shall provide or cause to be provided all security services necessary to assure security and safety within the Leased Premises. Any crimes or other offenses, including traffic offenses and crimes and offenses involving damage to or theft of Government property, shall be reported to the appropriate authorities for their investigation and disposition and to Government as property owner.

12.4 Lessee shall take or cause to be taken, all reasonable and necessary fire protection precautions at the Leased Premises. Such precautions may include, but are not limited to, the maintenance of any sprinkler system that exists on the effective date of this Lease and/or the provision of portable fire extinguishers for fire protection of Leased Premises.

12.5 Lessee is responsible for the repair and maintenance of all interior utility systems and those exterior utility systems, distribution lines, connections and equipment which solely support the Leased Premises. This responsibility extends from the Leased Premises to the point of connection with the utility system which serves users other than Lessee.

12.6 Lessee shall ensure only trained and qualified persons are utilized in performance of the maintenance and protection services specified in this paragraph.

### **13. ENVIRONMENTAL PROTECTION PROVISIONS:**

13.1 Lessee, sublessees and contractors shall comply with all applicable Federal, state and local laws, regulations and standards that are or may become applicable during the term of this Lease to Lessee's activities on the Leased Premises.

13.2 Lessee or any sublessee shall be solely responsible for obtaining, at no cost to Government, any environmental permits required for its operations under the Lease, independent of any existing permits held by the Government. Nothing in this Lease shall require Lessee to become a secondary discharger or co-permittee on any existing environmental permit held by Government relating to the operation of the Installation, including, without limitation, any environmental permits associated with the operation of the Installation's sewage treatment plant. Any and all environmental permits required for any of Lessee's or sublessees' operations or activities will be subject to prior concurrence of the Commanding Officer, Engineering Field Activity West, Naval Facilities Engineering Command. Lessee acknowledges that the Government will not consent to being named a secondary discharge or co-permittee for any operations or activities of the Lessee or any sublessee under the Lease. In the event the Government is named as a secondary discharger or co-permittee for any activity or operation of the Lessee or any sublessee, Government shall have the right to take reasonable actions necessary to prevent, suspend, or terminate

N6871102RP02P09

such activity or operation, including terminating this Lease, without liability or penalty.

13.3 Government's rights under this Lease specifically include the right for Government officials to inspect upon reasonable notice the Leased Premises for compliance with environmental, safety and occupational health laws and regulations, whether or not Government is responsible for enforcing them. Such inspections are without prejudice to the right of duly constituted enforcement officials to make such inspections. Government will give Lessee or sublessee twenty-four (24) hours prior notice of its intention to enter Leased Premises unless it determines the entry is immediately required for safety, environmental, operations or security purposes. Lessee shall have no claim on account of any entries against the United States or any officer, agent, employee, contractor or subcontractor thereof.

13.4 Government and its officers, agents, employees, contractors and subcontractors have the right, upon reasonable notice to Lessee and any sublessee, to enter upon the Leased Premises for the purposes enumerated in this subparagraph:

13.4.1 to conduct investigations and surveys, including, where necessary, drilling, soil and water sampling, testpitting, testing soil borings and other activities related to the Installation Restoration Program (IRP);

13.4.2 to inspect field activities of Government and its contractors and subcontractors in implementing the IRP;

13.4.3 to conduct any test or survey related to implementation of the IRP or environmental conditions at Leased Premises or verify any data submitted to EPA or applicable state equivalent by Government relating to such conditions;

13.4.4 to construct, operate, maintain or undertake any other response or remedial action as required or necessary under the IRP, including but not limited to monitoring wells, pumping wells and treatment facilities.

13.5 Lessee agrees to comply with the provisions of any health or safety plan in effect under the IRP during the course of any of the above described response or remedial actions. Any inspection, survey, investigation or other response or remedial action will, to the extent practicable, be coordinated with representatives designated by Lessee and any sublessee. Lessee and sublessee shall have no claim on account of such entries against the United States or any officer, agent, employee, contractor or subcontractor thereof. In addition, Lessee shall comply with all applicable Federal, state and local occupational safety and health regulations.

N6871102RPO2P09

13.6 Lessee further agrees that if the Leased Premises are subject to ongoing environmental remediation by Government, during such period, Lessee shall provide to EPA and applicable state equivalent by certified mail a copy of any sublease of the Leased Premises within fourteen (14) calendar days after the effective date of such sublease. Lessee may delete the financial terms and any other proprietary information from the copy of any agreement of assignment or sublease furnished pursuant to this condition.

13.7 Lessee shall strictly comply with the hazardous waste permit requirements under the Resource Conservation and Recovery Act or its applicable state equivalent. Except as specifically authorized by Government in writing, Lessee must provide at its own expense such hazardous waste management facilities as required by its use of the Leased Premises, complying with all laws and regulations. Government hazardous waste management facilities will not be available to Lessee. Any violation of the requirements of this condition shall be deemed a material breach of this Lease.

13.8 DOD component accumulation points for hazardous and other waste will not be used by Lessee or any sublessee. Neither will Lessee or sublessee permit its hazardous wastes to be commingled with hazardous waste of DOD Component.

13.9 Before beginning operations on the Leased Premises, Lessee shall have a Government-approved plan for responding to hazardous waste, fuel and other chemical spills. Such plan shall be independent of the Installation plan and, except for initial fire response and/or spill containment, shall not rely on the use of Installation personnel or equipment. Should Government provide to the Leased Premises any personnel or equipment whether for initial fire response and/or spill containment, or otherwise on request of Lessee, or because Lessee was not, in the reasonable opinion of Government, conducting timely cleanup actions, Lessee agrees to reimburse Government for its reasonable and actual costs in association with such response or cleanup upon receipt of an invoice for such costs.

13.10 Lessee shall not conduct or permit its sublessees to conduct any subsurface excavation, digging, drilling or other disturbance of the surface without the prior written approval of Government, which consent shall not be unreasonably withheld or delayed.

13.11 To the extent required by law and regulation, Government shall abate, remove or otherwise remedy all friable, accessible and damaged asbestos containing material (ACM), lead based paint (LBP) and polychlorinated biphenyls (PCBs) from Leased Premises. The presence of known ACM, LBP or PCBs shall be fully identified in an Environmental Baseline Survey (EBS) and/or Supplemental Environmental Baseline Survey (SEBS), attached as an Exhibit.

All correspondence in connection with  
this contract should include reference to:

N6871102RP02P09

13.11.1 Except as provided in Paragraph 13.11.2, Government is not responsible for any removal or containment of asbestos containing materials (ACM). If Lessee intends to make any improvements or repairs that require the removal of asbestos, an appropriate asbestos disposal plan must be incorporated into the plans and specifications and submitted to Government. The asbestos disposal plan will identify the proposed disposal site for the asbestos, or in the event the site has not been identified, will provide for disposal at a licensed facility authorized to receive it.

13.11.2 Government shall be responsible for the removal or containment of the ACM identified as requiring abatement shown on Exhibit G attached hereto as damaged or deteriorated ACM. Government agrees to abate these listed items of damaged or deteriorated ACM. Government may choose the most economical means of abating any damaged or deteriorated ACM, which may include removal, repair or containment (encapsulation), or a combination of removal, repair and containment. The forgoing obligation of Government does not apply to any ACM other than that identified in Exhibit G. Notwithstanding Paragraph 13.11.1 above, in an emergency, Lessee will notify Government as soon as practicable of its emergency ACM responses. Lessee shall be responsible for monitoring the condition of existing ACM on Leased Premises for deterioration or damage and accomplishing repairs or abatement pursuant to the applicable conditions of this Lease.

13.12 Lessee shall indemnify and hold harmless Government from any costs, expenses, liabilities, fines or penalties resulting from discharges, emissions, spills, storage or disposal arising from Lessee's occupancy, use or operations, or any other action by Lessee or any sublessee during the term of this Lease giving rise to Government liability under Federal, state or local environmental laws. Lessee's obligations hereunder shall apply whenever Government incurs costs or liabilities as a result of Lessee's activities or activities of any sublessee as provided hereunder. However, this indemnity does not extend to those damages which are due to the fault or negligence of Government or its contractors. This provision shall survive the expiration or termination of this Lease.

N6871102RP02P09

13.13 Storage, treatment or disposal of toxic or hazardous materials on the Leased Premises is prohibited excepted as authorized by Government in accordance with 10 U.S.C. § 2692.

13.14 The responsibility of Government to indemnify and hold harmless the Lessee and any sublessee against any toxic torts and other environmental claims shall be in accordance with Public Law 102-484, the National Defense Authorization Act for Fiscal Year 1993, Section 330, as amended.

13.15 If Lessee or a sublessee encounters pre-existing conditions caused by the Government which require the Government to take action in accordance with Federal, State or local law to remove, remediate, correct, or abate hazardous substances, pollutants or contaminants, the Lessee or sublessee shall promptly notify the Government, cease performance, and secure the work site. Vacation of the Leased Premises, or any part thereof, will be directed pursuant to the provisions of Section 15 of this Lease. The Government will take necessary and appropriate actions, as required by Federal, State or local law, and bear the cost of such removal, remediation, corrective action, or abatement, subject to the availability of funds for such purpose.

#### 14. TERMINATION:

14.1 Government shall have the right to terminate this Lease, in whole or in part, without liability, upon thirty (30) calendar days written notice:

14.1.1 In the event of the Government making a final decision on disposal of the Leased Premises that is inconsistent with continued use thereof by Lessee under this Lease; or

14.1.2 In the event of a national emergency as declared by the President or the Congress of the United States and Government makes a determination that such national emergency requires termination of this Lease; or

14.1.3 If, at any time after January 1, 2003, (a) Government has complied with all applicable legal requirements to convey fee title to the Premises, (b) Government has satisfied in full all of its obligations under this Lease, (c) Government tenders to Lessee a conveyance of fee ownership of the Premises after negotiating in good faith with respect to establishing reasonable terms, conditions of, and consideration for such conveyance, and (d) Lessee fails to accept such conveyance within one hundred eighty (180) calendar days of written notice of such tender; or

14.1.4 In the event of a breach by Lessee of any of the terms and conditions hereof. In the event of a breach involving the performance of any obligation, Lessee shall be afforded thirty (30) calendar days from the receipt of Government's written notice of intent to terminate to complete performance of



All correspondence in connection with  
this contract should include reference to:

N6871102RP02P09

the obligation or otherwise cure the subject breach and avoid termination of this Lease, unless Government determines that a shorter period is required for safety, environmental, operations or security purposes. In the event that Government shall elect to terminate this Lease on account of the breach by Lessee of any of the terms and conditions, Government shall be entitled to recover and Lessee shall pay to Government:

14.1.4(a) The costs incurred in resuming possession of the Leased Premises.

14.1.4(b) The costs incurred in performing any obligation on the part of the Lessee to be performed hereunder, but only after notice to Lessee and the expiration of all applicable cure periods.

14.1.4(c) An amount equal to the aggregate of any maintenance obligations and charges assumed hereunder and not paid or satisfied, which amounts shall be due and payable at the time when such obligations and charges would have accrued or become due and payable under this Lease.

14.2 Lessee shall have the right to terminate this Lease upon thirty (30) calendar days written notice to Government in the event of breach by Government of any of the terms and conditions hereof. In the event of a breach involving the performance of any obligation, Government shall be afforded thirty (30) calendar days from the receipt of Lessee's notice of intent to terminate to complete performance of the obligation or otherwise cure the subject breach and avoid termination of this Lease. Lessee shall also have the right to terminate this Lease in the event of damage to or destruction of all of the improvements on Leased Premises or such a substantial portion thereof as to render Leased Premises incapable or impracticable of use for the purposes for which it is leased hereunder, provided:

14.2.1 Government either has not authorized or directed the repair, rebuilding or replacement of the improvements or has made no provision for payment for such repair, rebuilding or replacement by application of insurance proceeds or otherwise; and

N6871102RPO2P 09

14.2.2 That such damage or destruction was not occasioned by the fault or negligence of Lessee or any of its officers, agents, servants, employees, subtenants, licensees or invitees, or by any failure or refusal on the part of Lessee to fully perform its obligations under this Lease.

14.2.3. If Government requires Lessee or any sublessee to vacate all or a substantial portion of Leased Premises pursuant to any provision of this Lease for a period in excess of thirty (30) calendar days, Lessee may terminate this Lease by written notice to Government given at any time while Lessee shall continue to be denied use of all or a substantial portion of Leased Premises. Lessee shall thereafter surrender possession of Leased Premises within fifteen (15) calendar days of such notice.

**15. ENVIRONMENTAL CONTAMINATION:**

In the event environmental contamination is discovered on the Leased Premises which creates, in Government's determination, an imminent and substantial endangerment to human health or the environment which necessitates evacuation of the Leased Premises, and notwithstanding any other termination rights and procedures contained in this Lease, Lessee shall vacate or require any sublessee to vacate Leased Premises immediately upon notice from Government of the existence of such a condition. Exercise of this right by Government shall be without liability, except that Lessee shall not be responsible for the payment of consideration, the amount of deduction to be determined on a daily pro-rata basis, during the period Leased Premises is vacated, and Lessee shall have the right to terminate this Lease if, as provided in Section 14.3 above, Lessee or any sublessee is deprived of the beneficial use and occupancy of the Leased Premises for a period in excess of thirty (30) days. Government's exercise of this right herein to order the Leased Premises immediately vacated does not alone constitute a termination of the Lease, but such right may be exercised in conjunction with any other termination rights provided in this Lease or by law.

**16. NON-ENVIRONMENTAL INDEMNIFICATION BY LESSEE:**

The Lessee shall hold harmless, indemnify, and defend the Government from and against any suit, claim, demand or action, liability, judgment, cost or other fee arising out of any claim for injury or damage that results from, or is any manner predicated upon activities of the Lessee on the Leased Property during the term of the Lease. This indemnification applies to any fines, claims, demands and causes of action of every nature whatsoever which may be made upon, sustained or incurred by Government by reasons of any breach, violation, omission or non-performance of any term, covenant or condition hereof on the part of Lessee or the employees, agents, servants, guests, invitees and sublessees of Lessee. This indemnification also applies to claims arising out of the furnishing of any utilities or services by Government or any interruption

N6871102RPO2P09

therein or failure thereof, whether or not the same shall be occasioned by the negligence or lack of diligence of Lessee, its officers, agents, servants, employees or sublessees. However, this indemnity does not extend to those damages which are due to the fault or negligence of Government or its contractors. This covenant shall survive the termination of this Lease.

**17. INSURANCE:**

17.1 At the commencement of this Lease, Lessee shall obtain, from a reputable insurance company or companies, liability insurance or shall maintain a program of self-insurance. The insurance shall provide an amount not less than a minimum combined single limit of \$10 million, for any number of persons or claims arising from any one incident with respect to bodily injuries or death resulting therefrom, property damage or both, suffered or alleged to have been suffered by any person or persons resulting from the operations of Lessee, sublessees, contractors and invitees under the terms of this Lease. Lessee shall provide Government certificates of its self-insurance or require its insurance company to furnish Government a copy of the policy or policies, or if acceptable to Government, certificates of insurance evidencing the purchase of such insurance. The minimum amount of liability insurance coverage is subject to revision by Government every three years or upon renewal or modification of this Lease.

17.2 As to those structures and improvements on Leased Premises constructed by or owned by Government, Lessee shall procure and maintain at Lessee's cost a standard fire and extended coverage insurance policy or policies or a program of self-insurance on the Leased Premises in an amount sufficient to demolish damaged or destroyed structures and improvements, remove debris and clear the Leased Premises. Should Lessee elect to purchase commercial insurance in lieu of self-insurance, Lessee shall procure such insurance from a reputable company or companies. In that event, the insurance policy shall provide that in the event of loss thereunder, the proceeds of the policy or policies, at the election of Government, shall be payable to Lessee to be used solely for the demolition of damaged or destroyed structures and improvements, removal of debris and clear the Leased Premises or for repair, restoration, or replacement of the property damaged or destroyed. Any balance of the proceeds not required for such purposes shall be paid to Government. If Government does not elect, by notice in writing to the insurer within thirty (30) calendar days after the damage or destruction occurs, to have the proceeds paid to Lessee for the purposes herein above set forth, then such proceeds shall be paid to Government, provided however that the insurer, after payment of any proceeds to Lessee in accordance with the provision of the policy or policies, shall have no obligation or liability with respect to the use or disposition of the proceeds by Lessee. Nothing herein contained shall be construed as an obligation upon Government to repair, restore or replace Leased Premises or any part thereof.

N6871102RPO2P09

17.3 If and to the extent required by law, Lessee shall provide workmen's compensation or similar insurance or self-insurance in form and amounts required by law.

17.4 During the entire period this Lease shall be in effect, Lessee shall require its contractors or sublessees or any contractor performing work at Lessee's or sublessee's request on Leased Premises to carry and maintain the insurance required below:

17.4.1 Comprehensive general liability insurance, including, but not limited to, contractor's liability coverage and contractual liability coverage, of not less than \$3 million, per occurrence with respect to personal injury or death, and \$5 million, per occurrence with respect to property damage.

17.4.2 Workman's compensation or similar insurance in form and amounts required by law.

17.5 Should Lessee purchase commercial insurance in lieu of self-insurance, all insurance which this Lease requires Lessee or sublessee to carry and maintain or cause to be carried or maintained shall be in such form, for such periods of time, and with such insurers as Government may reasonably require or approve. In that event, all policies or certificates issued by the respective insurers for public liability and property insurance will name Government as an additional insured, provide that any losses shall be payable notwithstanding any act or failure to act or negligence of Lessee or Government or any other person, provide that no cancellation, reduction in amount, or material change in coverage thereof shall be effective until at least thirty (30) calendar days after receipt by Government of written notice thereof; provide that the insurer shall have no right of subrogation against Government; and be reasonably satisfactory to Government in all other respects. In no circumstances will Lessee be entitled to assign to any third party, rights of action which Lessee may have against Government.

17.6 Lessee and sublessees shall deliver or cause to be delivered promptly to Government a certificate of insurance or self-insurance evidencing the insurance required by this Lease and shall also deliver no later than thirty (30) calendar days prior to expiration of any such policy, a certificate of insurance evidencing each renewal policy covering the same risks.

**18. LABOR PROVISION:**

During the term of this Lease, Lessee agrees as follows:

18.1 Lessee will not discriminate against any employee or applicant for employment because of race, color, religion, sex or national origin. Lessee shall

All correspondence in connection with  
this contract should include reference to:

N6871102RPO2P09

take affirmative action to ensure that applicants are employed, and that employees are treated during employment, without regard to their race, color, religion, sex or national origin. Such action shall include, but not be limited to the following: employment, upgrading, demotion or transfer, recruitment or recruitment advertising, layoff or termination, rate of pay or other forms of compensation and selection for training, including apprenticeship. Lessee agrees to post in conspicuous places, available to employees and applicants for employment, notices to be provided by Government setting forth the provisions of this nondiscrimination clause.

18.1.1 Lessee shall, in all solicitations or advertisements for employees placed at Leased Premises by or on behalf of Lessee, state that all qualified applicants will receive consideration for employment without regard to race, color, religion, sex or national origin.

18.1.2 Lessee shall send to each labor union or representative of workers with which it has a collective bargaining agreement or other contract or understanding a notice to be provided by Government, advising the labor union or worker's representative of Lessee's commitments under this equal opportunity clause and shall post copies of the notice in conspicuous places available to employees and applicants for employment

18.1.3 Lessee shall comply with all provisions of Executive Order 11246 of September 24, 1965, as amended by Executive Order 11375 of October 13, 1967, and of the rules, regulations and relevant orders of the Secretary of Labor.

18.1.4 Lessee shall furnish all information and reports required by Executive Order 11246 of September 24, 1965, as amended by Executive Order 11375 of October 13, 1967, and of the rules, regulations and relevant orders of the Secretary of Labor or pursuant thereto, and will permit access to his books, records and accounts by Government and the Secretary of Labor for purposes of investigating to ascertain compliance with such rules, regulations and orders.

All correspondence in connection with  
this contract should include reference to:

N6871102RP02P09

18.1.5 In the event of Lessee's noncompliance with the equal opportunity clause of this Lease or with any of said rules, regulations or orders, this Lease may be canceled, terminated or suspended in whole or in part, after the expiration of all applicable cure periods, and Lessee may be declare ineligible for further Government contracts in accordance with procedures authorized in Executive Order 11246 of September 24, 1965, as amended by Executive Order 11375 of October 13, 1967, and such other sanctions may be imposed and remedies invoked as provided in Executive Order 11246 of September 24, 1965, as amended by Executive Order 11375 of October 13, 1967, or by rule, regulation or order of the Secretary of Labor, or otherwise provided by law.

18.1.6 Lessee will include the above provisions in every sublease unless exempted by rules, regulations or orders of the Secretary of Labor issued pursuant to Section 204 of Executive Order 11246 of September 24, 1965, as amended by Executive Order 11375 of October 13, 1967, so that such provisions will be binding upon each sublessee. Lessee will take such action with respect to any sublessee as Government may direct as a means of enforcing such provisions including sanctions for noncompliance; provided, however, that in the event Lessee becomes involved, or is threatened with litigation with sublessee as a result of such direction by Government, Lessee may request the United States to enter into such litigation to protect the interest of the United States.

18.2 This Lease, to the extent that it is a contract of a character specified in the Contract Work Hours and Safety Standards Act (40 U.S.C. 327-330) and is not covered by the Walsh-Healy Public Contracts Act (41 U.S.C. 35-45), is subject to the following provisions and exceptions of said Contract Work Hours and Safety Standards Act and to all other provisions and exceptions of said law.

18.2.1 Lessee shall not require or permit any laborer or mechanic in any workweek in which he is employed on any work under this Lease to work in excess of 40 hours in such work week on work subject to the provisions of the Contract Work Hours Standards Act unless such laborer or mechanic receives compensation at a rate not less than one and one-half times his basic rate of pay for all such hours worked in excess of 40 hours in such work week. The "basic rate of pay", as used in this clause, shall be the amount paid per hour, exclusive of Lessee's contribution or cost for fringe benefits and any cash payment made in lieu of providing fringe benefits or the basic hourly rate contained in the wage determination, whichever is greater.

All correspondence in connection with  
this contract should include reference to:

N6871102RP02P09

18.2.2 In the event of any violation of the provision of Paragraph 18.2.1, Lessee shall be liable to any affected employee for any amounts due, and to the United States for liquidated damages. Such liquidated damages shall be computed with respect to each individual laborer or mechanic employed in violation of the provisions of paragraph 18.2.1 in the sum of \$10.00 for each calendar day on which such employee was required or permitted to be employed on such work in excess of the standard workday of 8 hours or in excess of the standard work week of 40 hours without payment of the overtime wages required by Paragraph 18.2.1.

18.3 In connection with the performance of work required by this Lease, Lessee agrees not to employ any person undergoing a sentence of imprisonment at hard labor.

**19. SUBMISSION OF NOTICES:**

Notices shall be sufficient under this Lease if made in writing and to the addressees as:

Lessee:           Treasure Island Development Authority  
                    Ms. Annemarie Conroy  
                    San Francisco Mayor's Office  
                    Treasure Island Project  
                    410 Palm Ave. Bldg. 1, Room 237  
                    Treasure Island  
                    San Francisco, CA 94130

Government:    Commander                   BRAC Dept  
                    Engineering Field Division - Southwest  
                    Naval Facilities Engineering Command  
                    1220 Pacific Highway  
                    San Diego, CA

The individuals so designated above shall be representatives of the parties and the points of contact during the period of this Lease.

**20. AUDIT:**

This Lease shall be subject to audit by any and all cognizant Government agencies. Lessee shall make available to such agencies for use in connection with such audits all records which it maintains with respect to this Lease and copies of all reports required to be filed hereunder.

N6871102RP02P09

**21. AMENDMENTS:**

This Lease shall not be amended or modified unless in writing and signed by both parties. No oral statements or representation made by, for or on behalf of either party shall be a part of this Lease. Should a conflict arise between the provisions of this Lease and any exhibit hereto, or any other agreement between Government and Lessee, the provisions of this Lease shall take precedence.

**22. FAILURE TO INSIST ON COMPLIANCE:**

The failure of Government or Lessee to insist, in any one or more instances, upon performance of any of the terms, covenants or conditions of this Lease shall not be construed as a waiver or relinquishment of Government's or Lessee's right to the future performance of any such terms, covenants or conditions and Government's and Lessee's respective obligations in respect of such future performance shall continue in full force and effect.

**23. DISPUTES:**

23.1 This Lease is subject to the Contract Disputes Act of 1978, as amended (41 U.S.C. 601-613) (the Act).

23.2 Except as provided in the Act, all disputes arising under or relating to this Lease shall be resolved under this clause.

23.3 "Claim", as used in this clause, means a written demand or written assertion by Lessee or Government seeking, as a matter of right, the payment of money in a sum certain, the adjustment or interpretation of lease terms, or other relief arising under or relating to this Lease. A claim arising under this Lease, unlike a claim relating to this Lease, is a claim that can be resolved under a lease clause that provides for the relief sought by the claimant. However, a written demand or written assertion by Lessee seeking the payment of money exceeding \$100,000 is not a claim under the Act until certified as required by subparagraph 23.4 below. A voucher, invoice or other routine request for payment that is not in dispute when submitted, is not a claim under the Act. The submission may be converted to a claim under the Act, by complying with the submission and certification requirements of this clause, if it is disputed either as to liability or amount or is not acted upon in a reasonable time.



N6871102RPO2P09

23.4 A claim by Lessee shall be made in writing and submitted within six (6) years after accrual of the claim, to the Naval Facilities Engineering Command, Engineering Field Activity West (ATTN.: Code 64), 900 Commodore Drive, San Bruno, CA 94066-5006 herein called "Command", for a written decision. A claim by the Government against Lessee shall be subject to a written decision by the Command.

23.4.1 Lessee shall provide the certification specified in subparagraph 23.4.3 of this clause when submitting any claim:

- (a) Exceeding \$100,000; or
- (b) Regardless of the amount claimed, when using:
  - (1) Arbitration conducted pursuant to 5 U.S.C. 575-580; or
  - (2) Any other alternative means of dispute resolution (ADR) technique that the agency elects to use in accordance with the Administrative Dispute Resolution Act (ADRA).

23.4.2 The certification requirement does not apply to issues in controversy that have not been submitted as all or part of a claim.

23.4.3 The certification shall state as follows: "I certify that the claim is made in good faith; that the supporting data are accurate and complete to the best of my knowledge and belief; that the amount requested accurately reflects the contract adjustment for which Lessee believes Government is liable; and that I am duly authorized to certify the claim on behalf of Lessee."

23.4.4 The certification may be executed by any person duly authorized to bind Lessee with respect to the claim.

23.5 For Lessee claims of \$100,000 or less, the Command, must, if requested in writing by Lessee, render a decision within 60 calendar days of the request. For Lessee-certified claims over \$100,000, the Command, must, within 60 calendar days, decide the claim or notify Lessee of the date by which the decision will be made.

23.6 The Command's, decision shall be final unless Lessee appeals or files a suit as provided in the Act.

N6871102RP02P09

23.7 At the time a claim by the Lessee is submitted to Command or a claim by Government is presented to Lessee, the parties, by mutual consent, may agree to use ADR. When using arbitration conducted pursuant to 5 U.S.C. 575-580, or when using any other ADR technique that the agency elects to employ in accordance with the ADRA, any claim, regardless of amount, shall be accompanied by the certification described in Paragraph 23.4.3 of this clause, and executed in accordance with Paragraph 23.4.4 of this clause.

23.8 Government shall pay interest on the amount found due and unpaid by Government from (1) the date the Command receives the claim (properly certified if required), or (2) the date payment otherwise would be due, if that date is later, until the date of payment. With regard to claims having defective certifications, as defined in FAR 33.201, interest shall be paid from the date that the Command initially receives the claim. Simple interest on claims shall be paid at the rate, fixed by the Secretary of the Treasury, as provided in the Act, which is applicable to the period during which the Command receives the claim and then at the rate applicable for each 6-month period as fixed by the Treasury Secretary during the pendency of the claim.

23.9 Lessee shall proceed diligently with the performance of Lease, pending final resolution of any request for relief, claim, appeal or action arising under Lease, and comply with any decision of the Command.

**24. COVENANT AGAINST CONTINGENT FEES:**

Lessee warrants that no person or agency has been employed or retained to solicit or secure this Lease upon an agreement or understanding for a commission, percentage, brokerage or contingent fee, excepting bona fide employees or bona fide established commercial agencies maintained by Lessee for the purpose of securing business. For breach or violation of this warranty, Government shall have the right to annul this Lease without liability or in its discretion, to require Lessee to pay the full amount of such commission, percentage, brokerage or contingent fee.

**25. OFFICIALS NOT TO BENEFIT:**

No member of or delegate to Congress or Resident Commissioner, shall be admitted to any share or part of this Lease or to any benefit to arise therefrom, but this provision shall not be construed to extend to this Lease if made with a corporation for its general benefit.

26. LIENS:

Lessee shall promptly discharge or cause to be discharged any valid lien, right in rem, claim or demand of any kind, except one in favor of Government, which at any time may arise or exist with respect to the Leased Property or materials or equipment furnished therefor, or any part thereof, and if the same shall not be promptly discharged by Lessee, or should Lessee or sublessee be declared bankrupt or make an assignment on behalf of creditors, or should the leasehold estate be taken by execution, Government reserves the right to take immediate possession without any liability to Lessee or any sublessee. Lessee and any sublessee shall be responsible for any costs incurred by Government in securing clear title to its property.

27. TAXES:

Lessee shall pay or cause to be paid to the proper authority, when and as the same become due and payable, all taxes, assessments and similar charges which, at any time during the term of this Lease, may be imposed upon Lessee with respect to its operations of the Leased Premises. Title 10 United States Code, Section 2667(e) contains the consent of Congress to the Taxation of Lessee's interest in Leased Premises, whether or not the Leased Premises are in an area of exclusive federal jurisdiction. Should Congress consent to taxation of Government's interest in the property, this Lease will be renegotiated.

28 SUBJECT TO EXISTING AND FUTURE EASEMENTS AND RIGHTS- OF-WAY:

This Lease is subject to all outstanding easements and rights-of-way for location of any type of facility over, across, in and upon Leased Premises or any portion thereof and to the right of Government to grant such additional easements and rights-of-way over, across, in and upon Leased Premises as it shall determine to be in the public interest; provided that any such additional easement or right-of-way shall be conditioned on the assumption by the grantee thereof of liability to Lessee for such damages as Lessee shall suffer for property destroyed or property rendered unusable on account of the grantee's exercise of its rights thereunder. There is hereby reserved to the holders of such easements and rights-of-way as are presently outstanding or which may hereafter be granted, to any workers officially engaged in the construction, installation, maintenance, operation, repair or replacement of facilities located thereon, and to any Federal, state or local official engaged in the official inspection thereof, such reasonable rights of ingress and egress over Leased Premises as shall be necessary for the performance of their duties with regard to such facilities.

N6871102RP02P 09

**29. INGRESS-EGRESS AND PARKING:**

Lessee and any sublessees will be granted reasonable access to Leased Premises under this Lease. Such access will be coordinated with Government. As a condition, Lessee and any sublessees agree to adhere to all base rules and regulations regarding installation security, ingress, egress, safety and sanitation as may be prescribed from time to time by Government. Parking will be coordinated with Government.

**30. ADMINISTRATION:**

Except as otherwise provided for under this Lease, Government shall, under the direction of the Command, have complete charge of the administration of this Lease, and shall exercise full supervision and general direction thereof insofar as the interests of Government are affected.

**31. SURRENDER:**

Upon the expiration of this Lease or its earlier termination in accordance with the terms of this Lease, Lessee shall quietly and peacefully remove itself and its property from Leased Premises and surrender the possession thereof to Government. Government may, in its discretion, declare any property which has not been removed from Leased Premises upon expiration or termination provided for above, as abandoned property upon giving to Lessee an additional 30 calendar days notice after the termination date.

**32 INTEREST:**

32.1 Notwithstanding any other provision of this Lease, unless paid within thirty (30) calendar days from the due date, all amounts that become payable by Lessee to Government under this Lease (net any applicable tax credit under the Internal Revenue Code) shall bear interest from the date due. The rate of interest will be the Current Value of Funds rate published by the Secretary of Treasury pursuant to 31 U.S.C. 3717 (Debt Collection Act of 1982).

32.1.1 Amounts shall be, subject to applicable cure periods, due upon the earliest of:

32.1.1(a) the date fixed pursuant to this Lease,

32.1.1(b) the date of the first written demand for payment, consistent with this Lease, including demand consequent upon default termination,

32.1.1(c) the date of transmittal by Government to Lessee of a proposed supplemental agreement to confirm completed negotiations fixing the amount,

32.1.1(d) if this Lease provides for revision of prices, the date of written notice to Lessee stating the amount of refund payable in connection with a pricing proposal or in connection with a negotiated pricing agreement not confirmed by Lease supplement.

**33. AVAILABILITY OF FUNDS:**

33.1 The Government's obligations under this Lease are subject to the availability of funds appropriated for such purposes. Nothing in this Lease shall be interpreted to require obligations or payments by Government which are in violation of the Anti-Deficiency Act (31 USC 1341).

**34. SPECIAL PROVISIONS:**

34.1 Notwithstanding anything to the contrary contained in this Lease, there shall be no obligation for the payment or expenditure of money by Lessee under this Lease unless the Controller of the City and County of San Francisco first certifies, pursuant to Section 3.105 of the Charter of the City and County of San Francisco, that there is a valid appropriation from which the expenditure may be made and that unencumbered funds are available from the appropriation to pay the expenditure. Without limiting the foregoing, if in any fiscal year of City after the fiscal year in which the Term of this Lease commences, sufficient funds for the payment of any payments required under this Lease are not appropriated for any reason, then either party may terminate this Lease upon thirty (30) calendar days written notice and Lessee shall quietly and peacefully remove itself and its property from Leased Premises and surrender possession thereof to the Government. Notwithstanding the foregoing, this Section 34.1 shall not in any way limit or otherwise impair Lessee's indemnification obligation arising under Sections 13.12 and 16 of this Lease.

34.2 Article 1.5 of the San Francisco Planning Code ("Code") requires the provision of bicycle storage at all properties leased by the City at no cost to the landlord, here the Government, and only if funds are available. In the event public and/or private donations, grants or other funds become available, at any time during this Lease, Lessee shall have the right to request that the Government amend this Lease to include space sufficient for the installation and operation of bicycle storage facilities. In the event of storage locker installation, the storage lockers shall be considered a trade fixture. Government, at no cost to Government, shall reasonably cooperate with City regarding the implementation of this Code.

N6871102RP02P09

34.3 The date on which this Lease shall become effective (the "Effective Date") is the date upon which (i) Lessee's Mayor and Board of Supervisors enact a resolution approving this Lease in accordance with all applicable laws and (ii) this Lease is duly executed by the parties hereto.

34.4 Use of groundwater at the leased premises is prohibited. The Lessee is prohibited from installing any groundwater wells at the subject property without prior written consent by the Government. The Lessee shall be responsible for any damage caused by Lessee to existing or future groundwater monitoring wells.

34.5 Lessee shall be restricted from conducting excavation, drilling, or other ground-disturbing activities, other than minor repairs of the pavement and landscaping, without prior written consent by the Government.

34.6 Lessee shall be required to conduct routine evaluations of the existing Asbestos Containing Material (ACM) and comply with all applicable federal, state and local laws relating to ACM. Before reconstruction or remodeling, Lessee or its sublessee shall submit plans to the Government on how ACM will be managed.

34.7 Lessee shall be required to monitor the condition of existing lead-based paint (LBP) and shall eliminate any hazard that develops from LBP through the duration of the lease. Lessee shall comply with all applicable laws and regulations relating to LBP. Lessee shall obtain prior Government approval before modification, construction, or demolition to any building or structure. Lessor shall submit a LBP remediation plan to Government prior to any construction or modification.

34.8 Notwithstanding any other provisions of this Lease, the Government will provide no services as described in Section 3.1.3 of the lease and the Common Service Charge as described in Section 3.1.3 shall be waived for the duration of this lease. Should the Lessee fail to provide Common Services to the leased premises, the Government may terminate the Lease, without liability, upon thirty (30) calendar days written notice.

**35. LIST OF EXHIBITS:**

The following exhibits are a part of this Lease:

- Exhibit A - Leased Premises
- Exhibit B - Inventory of Personal Property
- Exhibit C - Joint Inspection Report
- Exhibit D - EBS and FOSL

All correspondence in connection with  
this contract should include reference to:

N6871102RP02P09

- Exhibit E - Requirements for Use of Government Owned Utilities
- Exhibit F - Safety and Health Hazards to be Corrected
- Exhibit G - Government's Obligations to Abate Asbestos

**IN WITNESS WHEREOF**, the parties hereto have, on the respective dates set forth below duly executed this Lease as of the day and year first above written.

WITNESS

THE UNITED STATES OF AMERICA

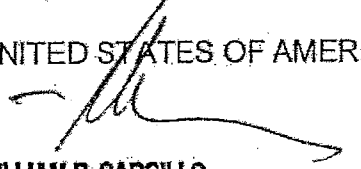
By:   
WILLIAM R. CARSILO  
Real Estate Contracting Officer  
DEPARTMENT OF THE NAVY

Date: \_\_\_\_\_

TREASURE ISLAND DEVELOPMENT AUTHORITY

By:   
ANNEMARIE CONROY  
Executive Director  
Treasure Island Development  
Authority Project

Date: \_\_\_\_\_

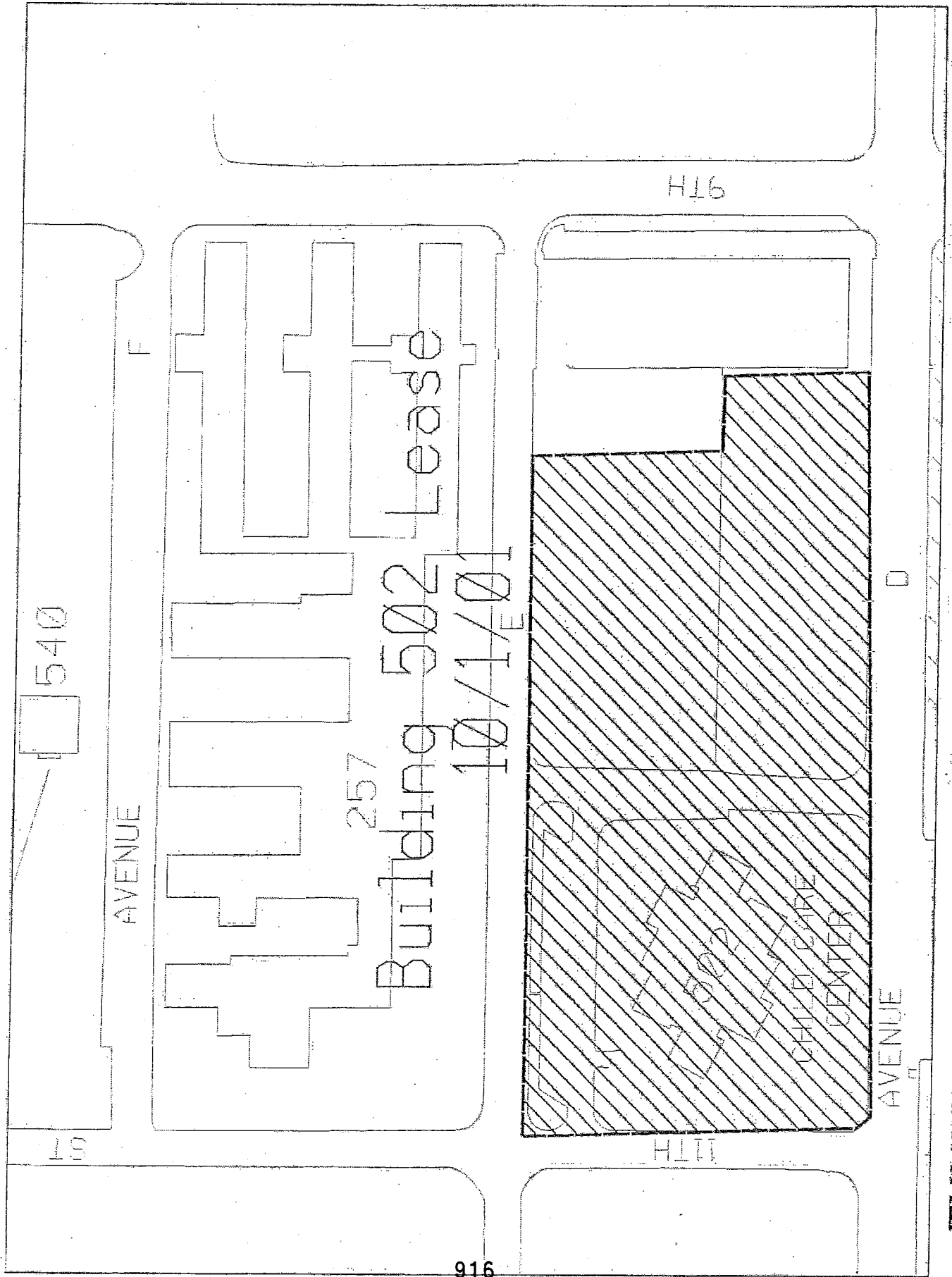

EXHIBIT "A"



N6871102RP02P09

All correspondence in connection with  
this contract should include reference to:

**Exhibit B**

**INVENTORY OF PERSONAL PROPERTY**

To be completed at time of move-in by both parties.

N6871102RP02P09

All correspondence in connection with  
this contract should include reference to:

**Exhibit C**

**JOINT INSPECTION REPORT**

To be completed at time of move-in by both parties.

EXHIBIT "D"  
Bldg. 562  
EBS

COMPREHENSIVE LONG-TERM ENVIRONMENTAL ACTION NAVY (CLEAN II)  
Northern and Central California, Nevada, and Utah  
Contract Number N62474-94-D-7609  
Contract Task Order No. 0126

Prepared For

DEPARTMENT OF THE NAVY  
Amelia Duque, Engineer-in-Charge  
Engineering Field Activity West  
Naval Facilities Engineering Command  
San Bruno, California

SITE-SPECIFIC  
ENVIRONMENTAL BASELINE SURVEY  
FOR REUSE ZONE 1  
NAVAL STATION  
TREASURE ISLAND, CALIFORNIA

FINAL  
July 17, 1997

Prepared By

PRC Environmental Management, Inc.  
135 Main Street, Suite 1800  
San Francisco, CA 94105

and

Uribe & Associates  
2930 Lakeshore Avenue, Suite 200  
Oakland, California 94610

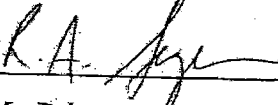
  
Ms. Rebecca Sugerman, PRC Project Manager

  
Ms. Lynne Srinivasan, U&A Project Manager

EXHIBIT E

UTILITIES AGREEMENT  
SUPPORTING LEASE OF CHILDCARE CENTER (BLDG 502)  
NAVAL STATION TREASURE ISLAND

---

ARTICLE 10, UTILITIES

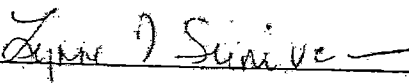
(a) Portions of the Government's utilities systems serving the Station are located within the Premises and are reserved for use by the Government hereunder. The Lessee agrees to allow the Government or its utility suppliers reasonable access to the Premises for such operation, maintenance, repair and replacement of these utilities systems as may be required. In executing operation, maintenance, repair or replacement of these systems, the Government agrees to take all reasonable steps to limit interference with the use of the Premises by the Lessee or its approved sublessees or assignees.

(b) Prior to commencement of the term of this Lease, the Government and the Lessee will agree upon the terms and conditions for delivery of utility services by the Government to the Lessee which agreement will be appended as Exhibit "E" to this Lease. Conditions will include the following:

(1) Sewage discharge by the Lessee to the Government owned sewer system must meet all requirements of any applicable waste water discharge permit or contract issued by or between the Government and Bay Area Water Quality Management Board for discharge of sewage from the Station.

(2) Storm water discharged from the Premises must meet the requirements of permits issued to the Government in accordance with the National Pollution Discharge Elimination System (NPDES) for discharge of storm water from the Station. In addition, the Lessee agrees to participate in any storm water quality management program required by applicable local, State, or Federal regulations.

(c) The Lessee may, at its own cost, replace, remove, or relocate utility systems on the Premises in order to use the Premises, so long as there is no unreasonable interference with use by the Government of the utility systems and provided the Government has approved the replacement, removal or relocation in advance. Government approval shall not be unreasonably denied or delayed.

N6871102RP02P09

## **BACKGROUND**

This exhibit implements the agreement stipulated in ARTICLE 10, of the Lease between the Lessee and the Government.

## **AGREEMENT**

Pursuant to the requirements stipulated in ARTICLE 10 of said Lease, the Lessee and the Government hereby agree to the following with respect to Government-owned utility systems and to Government-provided utility services:

### **1. General**

All utility services delivered at the premises shall be obtained from the City and County of San Francisco (CCSF) in accordance with provisions of Cooperative Agreement N624749720003 entered into by the Navy and CCSF. The Lessee agrees to conform to conditions of service which may be laid out by CCSF in addition to the general requirements of paragraphs 2.0 through 7.0, below. Assistance in obtaining service from CCSF can be obtained by contacting:

**San Francisco Public Utilities Commission  
410 Palm Ave., Building 1  
Treasure Island  
San Francisco, CA 94130**

**Attn.: Chuck Swanson, Utilities Project Manager  
Phone: 415 274 0333**

### **2.0 Metering**

Electric, natural gas and water service will be authorized by the Government only after installation of meters which fully and exclusively measure consumption on the Premises. Prior to commencement of service the Lessee will insure that any additional metering which may be required has been installed by the San Francisco Public Utilities Commission (SFPUC), as the representative of the CCSF, or in accordance with SFPUC requirements and with written SFPUC authorization. Unless otherwise stipulated by the SFPUC, the volume of sewer discharge from the Premises will be assumed to equal water consumption as measured by applicable meters.

### **3.0 Commencement of Service**

Service will commence after the Lessee, or any sublessee authorized by the Government, has established an account with the SFPUC and has made any advance service deposit which the SFPUC may require.

All correspondence in connection with  
this contract should include reference to:

N6871102RPO2P09

#### 4.0 Rates

Until further notice by the Government, the following rates are in effect:

| Utility     | Unit                     | Charge<br>Per Unit |
|-------------|--------------------------|--------------------|
| electricity | MWH (million watt-hours) | \$142.75           |
| natural gas | MFC (1,000 cubic feet)   | \$ 6.00            |
| water       | KGAL (thousand gallons)  | \$ 5.40            |
| sewer       | KGAL                     | \$ 5.75            |

#### 5.0 Billing and Payment

Monthly bills for utilities services will be issued by the SFPUC to the Lessee or to a Government authorized sublessee as agreed upon between the Lessee and the SFPUC. Payment to the SFPUC is due within 10 working days of receipt of the bill. Adjustments to billed amounts may be requested only after receipt of the billed amount by the SFPUC and may be granted by the SFPUC only after an error in the originally presented bill is clearly established and documented.

#### 6.0 Service to Sublessees

As stated in paragraph 5.0, above, payment for utility service may be made directly to the SFPUC by a Government authorized sublessee, rather than by the Lessee, subject to agreement by the SFPUC. In the event any such agreement is made, the Lessee will insure that the applicable sublease contains provisions sufficient to bind the sublessee to all conditions of service given here as well as to any additional conditions of service which may be imposed by the SFPUC.

#### 7.0 Failure by Sublessees to Make Payment

Any Government authorized sublessee obligated to make payment for utility services directly to the SFPUC will be considered in arrears if payment of any bill is not received within 30 working days of presentation to the sublessee by the SFPUC. In any such case, the liability for payment will immediately revert to the Lessee and will remain with the Lessee for the remainder of the term of this Lease.

All correspondence in connection with  
this contract should include reference to:

N6871102RP02P09

**Exhibit F**

**SAFETY AND HEALTH HAZARDS TO BE CORRECTED**

Prior to occupancy and operation as a childcare center, Lessee shall restore and repair any internal surfaces containing mold or mildew and take any necessary measures to prevent future occurrences of mold or mildew.

All correspondence in connection with  
this contract should include reference to:

N6871102RP02P09

**Exhibit G**

**GOVERNMENTS OBLIGATION TO ABATE ASBESTOS**

No asbestos abatement to be performed by Government.