

File No. 120864

Committee Item No. 1

Board Item No. 51

COMMITTEE/BOARD OF SUPERVISORS

AGENDA PACKET CONTENTS LIST

Committee: Neighborhood Services & Safety Date October 3, 2013

Board of Supervisors Meeting Date October 22, 2013

Cmte Board

- | | | |
|-------------------------------------|-------------------------------------|--|
| <input type="checkbox"/> | <input type="checkbox"/> | Motion |
| <input type="checkbox"/> | <input checked="" type="checkbox"/> | Resolution |
| <input type="checkbox"/> | <input type="checkbox"/> | Ordinance |
| <input type="checkbox"/> | <input type="checkbox"/> | Legislative Digest |
| <input type="checkbox"/> | <input type="checkbox"/> | Budget and Legislative Analyst Report |
| <input type="checkbox"/> | <input type="checkbox"/> | Legislative Analyst Report |
| <input type="checkbox"/> | <input type="checkbox"/> | Youth Commission Report |
| <input type="checkbox"/> | <input type="checkbox"/> | Introduction Form (for hearings) |
| <input checked="" type="checkbox"/> | <input checked="" type="checkbox"/> | Department/Agency Cover Letter and/or Report |
| <input type="checkbox"/> | <input type="checkbox"/> | MOU |
| <input type="checkbox"/> | <input type="checkbox"/> | Grant Information Form |
| <input type="checkbox"/> | <input type="checkbox"/> | Grant Budget |
| <input type="checkbox"/> | <input type="checkbox"/> | Subcontract Budget |
| <input type="checkbox"/> | <input type="checkbox"/> | Contract/Agreement |
| <input type="checkbox"/> | <input type="checkbox"/> | Form 126 – Ethics Commission |
| <input type="checkbox"/> | <input type="checkbox"/> | Award Letter |
| <input checked="" type="checkbox"/> | <input checked="" type="checkbox"/> | Application |
| <input checked="" type="checkbox"/> | <input checked="" type="checkbox"/> | Public Correspondence |

OTHER (Use back side if additional space is needed)

<input type="checkbox"/>	<input type="checkbox"/>	_____
<input type="checkbox"/>	<input type="checkbox"/>	_____
<input type="checkbox"/>	<input type="checkbox"/>	_____
<input type="checkbox"/>	<input type="checkbox"/>	_____
<input type="checkbox"/>	<input type="checkbox"/>	_____
<input type="checkbox"/>	<input type="checkbox"/>	_____
<input type="checkbox"/>	<input type="checkbox"/>	_____
<input type="checkbox"/>	<input type="checkbox"/>	_____
<input type="checkbox"/>	<input type="checkbox"/>	_____
<input type="checkbox"/>	<input type="checkbox"/>	_____

Completed by: Derek Evans Date 9/27/13
 Completed by: Derek Evans Date 10/15/13

An asterisked item represents the cover sheet to a document that exceeds 25 pages.
 The complete document can be found in the file.

FILE NO. 120864

RESOLUTION NO.

1 [Liquor License - 1600 Post Street]

2
3 **Resolution determining that the issuance of a Type 21 off-sale general license to**
4 **Paul SukChan Lee for Han Mi Gift Center, located at 1600 Post Street (District 5),**
5 **will serve the public convenience and necessity of the City and County of San**
6 **Francisco, in accordance with California Business and Professions Code, Section**
7 **23958.4**

8
9 WHEREAS, Paul Lee is seeking the issuance of a Type 21 off-sale general
10 license for the Han Mi Gift Center, located at 1600 Post Street; and,

11 WHEREAS, The Planning Department has verified that the area is properly
12 zoned and recommends approval; and,

13 WHEREAS, The Police Department has filed no protests with the Department of
14 Alcoholic Beverage Control under the California Business and Professions Code,
15 Section 24013, and recommends that the Department of Alcoholic Beverage Control
16 issue the liquor license with conditions; and,

17 WHEREAS, The conditions recommended by the Police Department are the
18 following: 1) Sales, service and consumption of alcoholic beverages shall be permitted
19 only from 9:00 a.m. to 11:00 p.m. each day of the week; 2) Loitering (defined as "to
20 stand idly about; linger aimlessly without lawful business") is prohibited on any
21 sidewalks or property adjacent to the licensed premises under the control of the
22 licensee as depicted on the ABC-257 dated July 19, 2012; 3) No noise shall be audible
23 beyond the area under control of the licensee(s) as defined on the ABC-257; 4) No
24 more than 10% of the square footage of the premises will be used for the serving,
25

1 tasting or consumption of alcohol; 5) No person under the age of 21 shall sell or deliver
2 alcoholic beverages; 6) The sale of distilled spirits in sizes smaller than 200ml is strictly
3 prohibited; 7) Malt beverages in quantities of 16oz, 32oz, 40oz or similar size
4 containers are prohibited; 8) No malt beverages shall be sold with alcohol content
5 greater than 5.9% by volume; 9) No wine shall be sold with the alcohol content greater
6 than 15% by volume except "Dinner Wines" which have been aged two years or more
7 and maintained in corked bottles; and 10) Wine shall not be sold in bottles or
8 containers smaller than 750ml; now, therefore, be it

9 RESOLVED, That in accordance with the California Business and Professions
10 Code, Section 23958.4, the Board of Supervisors of the City and County of
11 San Francisco hereby determines for the foregoing reasons that the issuance of a Type
12 21 off-sale general license to Paul Lee for the Han Mi Gift Center, located at 1600 Post
13 Street, will serve the public convenience and necessity of the City and County of San
14 Francisco; and, be it

15 FURTHER RESOLVED, That the Board of Supervisors of the City and County of
16 San Francisco hereby endorses and adopts the recommendations of the Police
17 Department listed above, and recommends that the Department of Alcoholic Beverage
18 Control issue the license with those conditions.



San Francisco Police Department
ABC Liaison Unit



Alcoholic Beverage License -
*Public Convenience and
Necessity Recommendation*

To: The San Francisco Board of Supervisors Neighborhood Services and
Safety Committee

Supervisor David Campos
Supervisor Eric Mar
Supervisor Norman Yee

From: Inspector Nelly Gordon
ABC Liaison Unit (ALU) 553-1049

Date: November 19, 2012 , amended on 10/15/2013 by Officer Al Duarte

Subject: P.C.N. Investigation Regarding:

DBA: Han Mi Gift Center
1600 Post Street
Eun Lee
415 505-7630

Eun Lee has filed an application with the California Department of Alcoholic Beverage Control (ABC) seeking a Type 21 (Off-Sale General Package Store) license for 1600 Post Street (located on the northwest corner of Post and Laguna Street).

This currently operating gift and cosmetic store would like to add alcohol as one of their products for sale.

For the purposes of this hearing, the California Department of Alcoholic Beverage Control (ABC) seeks a determination from the Board of Supervisors as to the approval or denial of this license.

Police Calls for Service: From July 2011 to July 2012

2 Police calls

Police Reports: From July 2011 to July 2012

None

Notifications

It should be noted that during the application process, notification date for the 500' mailer was on August 7, 2012. The Notice to the Public was posted on July 28, 2012.

San Francisco Plot Information:

This premise is located in Plot 538

The High Crime area is defined as 215 or more police reports in a plot.

This plot had 185 police reports recorded for 2010.

Applicant premises is **not** located in a "High Crime" area.

State Census Tract Information:

This premise is located in Census Tract 0155.00

Population for this tract is: 3,622

On-sale license authorized by census tract: 12
Active on-sale licenses: 55

Off-sale licenses authorized by census tract: 3
Active off-sale licenses: 8

Applicant premise is currently located in an "undue concentration" area.

Letters of Protest:

No record with the California Department of Alcoholic Beverage Control, (ABC).

Letters of Support:

No record with the California Department of Alcoholic Beverage Control, (ABC).

Departmental Recommendation:

No opposition from **Northern Police Station**

ALU recommends approval. The following conditions have been recommended to the California Department of Alcoholic Beverage Control, (ABC):

Conditions amended on 10/15/2013

1. Sales, service and consumption of alcoholic beverages shall be permitted only from 9:00 a.m. to 11:00 p.m. each day of the week.
2. Loitering (loitering is defined as "to stand idly about; linger aimlessly without lawful business") is prohibited on any sidewalks or property adjacent to the licensed premises under the control of the licensee as depicted on the ABC-257 dated 7/19/12.
3. No noise shall be audible beyond the area under control of the licensee(s) as defined on the ABC-257, dated 7/19/12.
4. No more than 10% of the square footage of the premises will be used for the serving, tasting or consumption of alcohol.
5. No person under the age of 21 shall sell or deliver alcoholic beverages.
6. The sale of distilled spirits in sizes smaller than 200ml is strictly prohibited.
7. Malt beverages in quantities of 16oz, 32oz, 40oz or similar size containers are prohibited.
8. No malt beverages shall be sold with alcohol content greater than 5.9% by volume.
9. No wine shall be sold with the alcohol content greater than 15% by volume except "Dinner Wines" which have been aged two years or more and maintained in corked bottles.
10. Wine shall not be sold in bottles or containers smaller than 750ml.

Amended on 10/15/2013



San Francisco Police Department
ABC Liaison Unit



Alcoholic Beverage License -
*Public Convenience and
Necessity Recommendation*

To: The San Francisco Board of Supervisors' Committee on City
Operations & Neighborhood Services

Supervisor Sean Elsbernd
Supervisor Carmen Chu
Supervisor Christina Olague

From: Inspector Nelly Gordon 
ABC Liaison Unit (ALU) 553-1049

Date: November 19, 2012

Subject: P.C.N. Investigation Regarding:

DBA: Han Mi Gift Center
1600 Post Street
Eun Lee
415 505-7630

Eun Lee has filed an application with the California Department of Alcoholic Beverage Control (ABC) seeking a Type 21 (Off-Sale General Package Store) license for 1600 Post Street (located on the northwest corner of Post and Laguna Street).

This currently operating gift and cosmetic store would like to add alcohol as one of their products for sale.

For the purposes of this hearing, the California Department of Alcoholic Beverage Control (ABC) seeks a determination from the Board of Supervisors as to the approval or denial of this license.

Police Calls for Service: From July 2011 to July 2012

2 Police calls

Police Reports: From July 2011 to July 2012

None

*Superseded
10/10/13*

Notifications

It should be noted that during the application process, notification date for the 500' mailer was on August 7, 2012. The Notice to the Public was posted on July 28, 2012.

San Francisco Plot Information:

This premise is located in Plot **538**

The High Crime area is defined as 215 or more police reports in a plot.

This plot had 185 police reports recorded for 2010.

Applicant premises is **not** located in a "High Crime" area.

State Census Tract Information:

This premise is located in Census Tract **0155.00**

Population for this tract is: 3,622

On-sale license authorized by census tract: 12

Active on-sale licenses: 55

Off-sale licenses authorized by census tract: 3

Active off-sale licenses: 8

Applicant premise is currently located in an "undue concentration" area.

Letters of Protest:

No record with the California Department of Alcoholic Beverage Control, (ABC).

Letters of Support:

No record with the California Department of Alcoholic Beverage Control, (ABC).

Departmental Recommendation:

No opposition from **Northern Police Station**

ALU recommends approval. The following conditions have been recommended to the California Department of Alcoholic Beverage Control, (ABC):

1. Sales, service and consumption of alcoholic beverages shall be permitted only from 9:00 a.m. to 11:00 p.m. each day of the week.
2. Loitering (loitering is defined as "to stand idly about; linger aimlessly without lawful business") is prohibited on any sidewalks or property adjacent to the licensed premises under the control of the licensee as depicted on the ABC-257 dated 7/19/12.
3. No noise shall be audible beyond the area under control of the licensee(s) as defined on the ABC-257, dated 7/19/12.
4. No more than 10% of the square footage of the premises will be used for the serving, tasting or consumption of alcohol.
5. There shall be no cups, glasses or similar receptacles commonly used for the drinking of beverages, sold, furnished or given away at the petitioner's premises in quantities of less than twenty-four in their original multi-container packages.
6. All ice shall be sold at or about prevailing prices in the area and in quantities of not less than three (3) pounds per sale and shall not be given away free.
7. No person under the age of 21 shall sell or deliver alcoholic beverages.
8. The sale of distilled spirits in sizes smaller than 200ml is strictly prohibited.
9. No malt beverages in quantities of 16oz, 32oz, 40oz or similar size containers are prohibited.
10. No malt beverages shall be sold with alcohol content greater than 5.9% by volume.
11. No wine shall be sold with the alcohol content greater than 15% by volume except "Dinner Wines" which have been aged two years or more and maintained in corked bottles.
12. Wine shall not be sold in bottles or containers smaller than 750ml.



**California Department of Alcoholic
Beverage Control**
*License Query System Summary
as of 7/30/2012*

License Information
License Number: 524196
Primary Owner: LEE, EUN YOUNG
ABC Office of Application: 24 - SAN FRANCISCO
Business Name
<i>... No Active DBA found ...</i>
Business Address
Address: 1600 POST ST Census Tract: 0155.00
City: SAN FRANCISCO County: SAN FRANCISCO
State: CA Zip Code: 94115
Licensee Information
Licensee: LEE, EUN YOUNG
Licensee: LEE, PAUL SUKCHAN
License Types
1) License Type: 21 - OFF-SALE GENERAL
License Type Status: PENDING
Status Date: 26-JUL-2012 Term: 12 Month(s)
Original Issue Date: Expiration Date:
Master: Y Duplicate: 0 Fee Code: P40
License Type was Transferred On: FROM: 21-265275
Current Disciplinary Action
<i>... No Active Disciplinary Action found ...</i>
Disciplinary History
<i>... No Disciplinary History found ...</i>
Hold Information
Hold Date: 26-JUL-2012 Type: FORM 220
Escrow
Escrow: BAY COMMERCIAL BANK ESCROW SERVICES DIVISION, 3895 E CASTRO VALLEY BLVD STE A CASTRO VALLEY,CALIFORNIA 94552

--- End of Report ---

For a definition of codes, view our [glossary](#).



**California Department of Alcoholic
Beverage Control**
License Query System Summary
as of 7/30/2012

License Information
License Number: 265275
Primary Owner: KIM, JAMES SIK
ABC Office of Application: 24 - SAN FRANCISCO
Business Name
Doing Business As: HANDY STOP SHOP
Business Address
Address: 697 S VAN NESS AVE Census Tract: 0228.01
City: SAN FRANCISCO County: SAN FRANCISCO
State: CA Zip Code: 94110
Licensee Information
Licensee: KIM, JAMES SIK
Licensee: KIM, SUSAN
License Types
1) License Type: 21 - OFF-SALE GENERAL
License Type Status: SURRENDERED
Status Date: 27-JUL-2010 Term: 12 Month(s)
Original Issue Date: 29-OCT-1991 Expiration Date: 31-MAY-2013
Master: Y Duplicate: 0 Fee Code: P40
Current Disciplinary Action
<i>... No Active Disciplinary Action found ...</i>
Disciplinary History
Reg. Number: 97041311
1) Section: 25658(a)
2) Section: 24200(a&b)
Proceeding Status: CLOSED Decision: POIC
Suspension Days: 10 Stayed Days: 0 POIC/Fine: 1185
Suspension Start Date: Suspension End Date:
Hold Information
<i>... No Active Holds found ...</i>
Escrow
<i>... No Escrow found ...</i>

--- End of Report ---

For a definition of codes, view our [glossary](#).

Go gle

Address 1602 Post Street

Address is approximate

Exact location of 1600 Post Street.

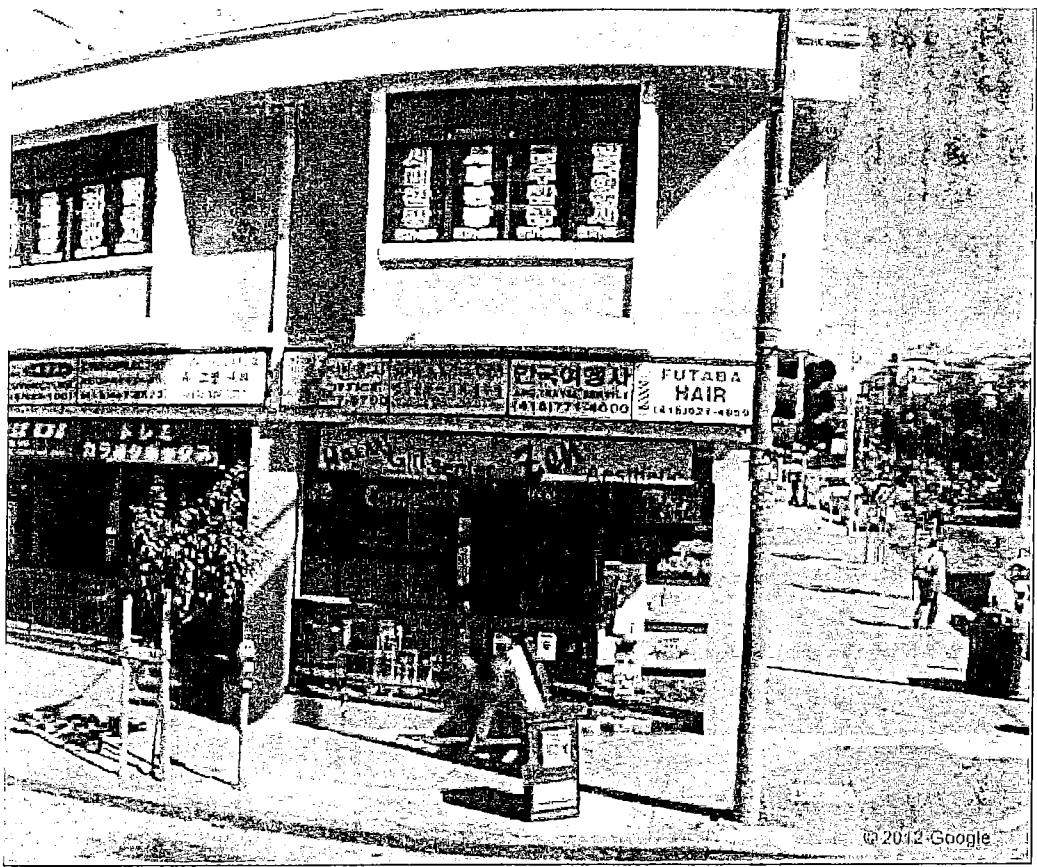

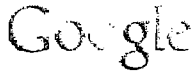

Address 1600 Post St
San Francisco, CA 94115

Get Google Maps on your phone
Text the word "GMAPS" to 466453

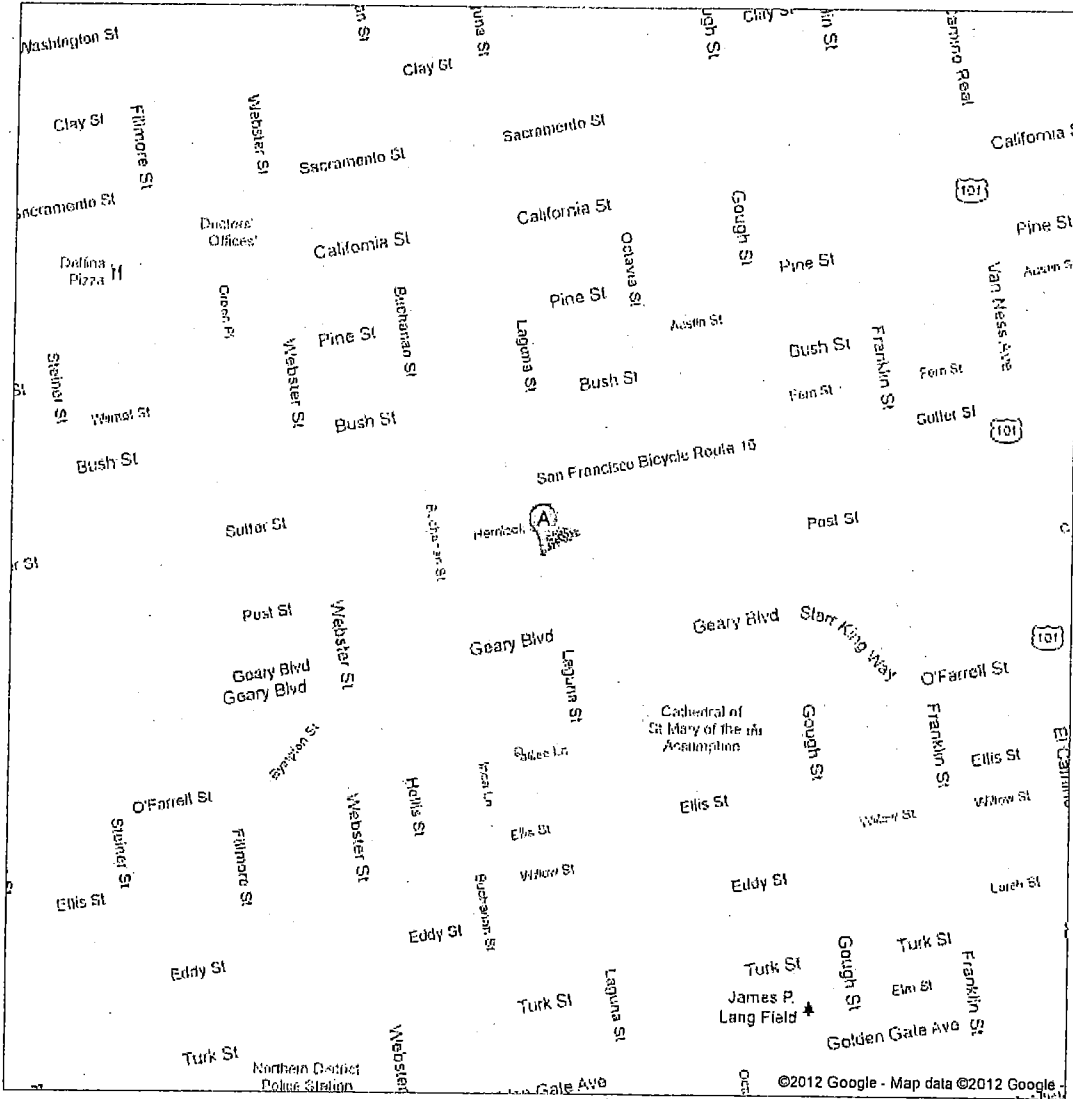
1600 Post Street

500 ft radius

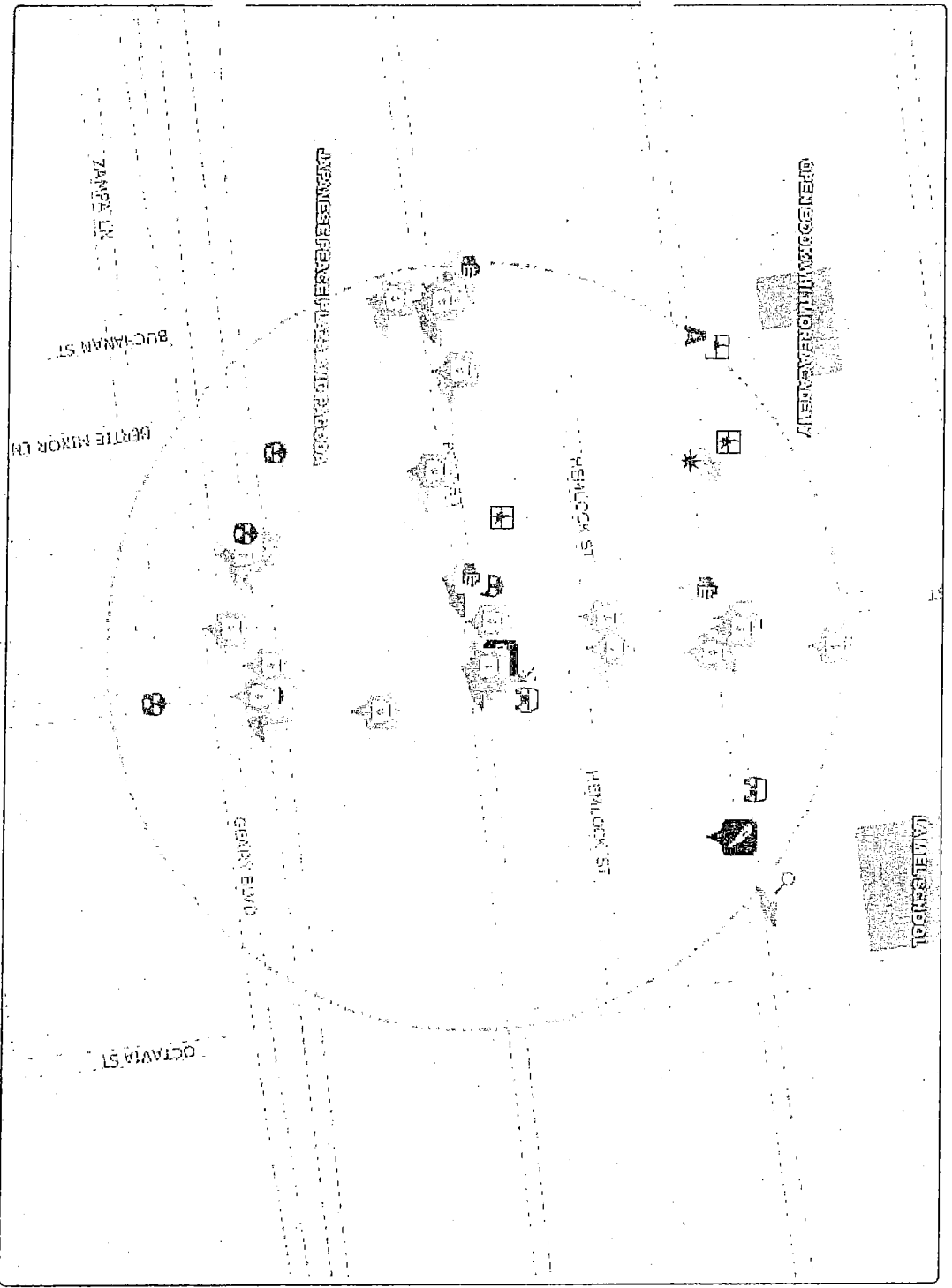

Map Legend	
	Incidents (178)
	Larceny/Theft (105)
	Non-Criminal (14)
	Robbery (13)
	Vandalism (8)
	Burglary (8)
	Assault (7)
	Vehicle Theft (5)
	Warrants (5)
	Other Offenses (4)
	Disorderly Conduct (2)
	Missing Person (2)
	Warrants (2)
	Forgery/Counterfeiting (1)
	Weapon Laws (1)
	Drug/Narcotic (1)

All representations on this map are distributed and transmitted "AS IS" without warranties of any kind, either expressed or implied including without limitation, warranties of title or implied warranties of merchantability or fitness for a particular purpose. In no event shall San Francisco Police Department become liable to users of these data for any loss or damages, consequential or otherwise, including but not limited to time, money, goodwill, arising from the use, operation or modification of the data. The visual presentation of data is being provided strictly as a courtesy, not as an obligation to its users.

WARNING: This map does not meet the national map accuracy standards.

Department of Alcoholic Beverage Control

State of California
Edmund G. Brown Jr., Governor

INFORMATION AND INSTRUCTIONS -

SECTION 23958.4 B&P

- Instructions
- This form is to be used for all applications for original issuance or premises to premises transfer of licenses.
 - Part 1 is to be completed by an ABC employee, given to applicant with pre-application package, with copy retained in holding file or applicant's district file.
 - Part 2 is to be completed by the applicant, and returned to ABC.
 - Part 3 is to be completed by the local governing body or its designated subordinate officer or body, and returned to ABC.

PART 1 - TO BE COMPLETED BY ABC

1. APPLICANT'S NAME Paul Sukchan Lee / Eun Young Lee

2. PREMISES ADDRESS (Street number and number only, zip code) 1600 Post St., San Francisco, CA 94115

3. LICENSE TYPE 21

4. TYPE OF BUSINESS

<input type="checkbox"/> Full Service Restaurant	<input type="checkbox"/> Holbrau/Cafeteria	<input type="checkbox"/> Cocktail Lounge	<input type="checkbox"/> Private Club
<input type="checkbox"/> Deli or Specialty Restaurant	<input type="checkbox"/> Comedy Club	<input type="checkbox"/> Night Club	<input type="checkbox"/> Veterans Club
<input type="checkbox"/> Cafe/Coffee Shop	<input type="checkbox"/> Brew Pub	<input type="checkbox"/> Tavern: Beer	<input type="checkbox"/> Fraternal Club
<input type="checkbox"/> Bed & Breakfast	<input type="checkbox"/> Theater	<input type="checkbox"/> Tavern: Beer & Wine	<input type="checkbox"/> Wine Tasting Room
<input type="checkbox"/> Wine only	<input type="checkbox"/> All		

<input type="checkbox"/> Supermarket	<input type="checkbox"/> Membership Store	<input type="checkbox"/> Service Station	<input type="checkbox"/> Swap Meet/Flea Market
<input checked="" type="checkbox"/> Liquor Store	<input type="checkbox"/> Department Store	<input type="checkbox"/> Convenience Market	<input type="checkbox"/> Drive-in Dairy
<input type="checkbox"/> Drug/Variety Store	<input type="checkbox"/> Florist/Gift Shop	<input type="checkbox"/> Convenience Market w/Gasoline	
<input type="checkbox"/> Other - describe:			

5. COUNTY POPULATION 812,820

6. TOTAL NUMBER OF LICENSES IN COUNTY 980

7. RATIO OF LICENSES TO POPULATION IN COUNTY On-Sale Off-Sale

8. NSUS TRACT NUMBER 0155.10

9. NO. OF LICENSES ALLOWED IN CENSUS TRACT 3

10. NO. OF LICENSES EXISTING IN CENSUS TRACT 6

On-Sale Off-Sale

11. IS THE ABOVE CENSUS TRACT OVERCONCENTRATED WITH LICENSES? (i.e., does the ratio of licenses to population in the census tract exceed the ratio of licenses to population for the entire county?)

Yes, the number of existing licenses exceeds the number allowed

No, the number of existing licenses is lower than the number allowed

3x publications

12. DOES LAW ENFORCEMENT AGENCY MAINTAIN CRIME STATISTICS?

Yes (Go to Item #13) No (Go to Item #20)

13. CRIME REPORTING DISTRICT NUMBER 538

14. TOTAL NUMBER OF REPORTING DISTRICTS 654

15. TOTAL NUMBER OF OFFENSES IN ALL REPORTING DISTRICTS 117,591

16. AVERAGE NO. OF OFFENSES PER DISTRICT 179

17. 120% OF AVERAGE NUMBER OF OFFENSES 214.80

18. TOTAL NUMBER OF OFFENSES IN REPORTING DISTRICT 185

19. IS THE PREMISES LOCATED IN A HIGH CRIME REPORTING DISTRICT? (i.e., has a 20% greater number of reported crimes than the average number of reported crimes as determined from all crime reporting districts within the jurisdiction of the local law enforcement agency)

Yes, the total number of offenses in the reporting district equals or exceeds the total number in item #17

No, the total number of offenses in the reporting district is lower than the total number in item #17

Area not

20. CHECK THE BOX THAT APPLIES (check only one box)

a. If "No" is checked in both item #11 and item #19, Section 23958.4 B&P does not apply to this application, and no additional information will be needed on this issue. Advise the applicant to bring this completed form to ABC when filing the application.

b. If "Yes" is checked in either item #11 or item #19, and the applicant is applying for a non-retail license, a retail bona fide public eating place license, a retail beer license issued for a hotel, motel or other lodging establishment as defined in Section 25503.16(p) B&P, or a retail license issued in conjunction with a beer manufacturer's license, or winemaker's license, advise the applicant to complete Section 2 and bring the completed form to ABC when filing the application or as soon as possible thereafter.

c. If "Yes" is checked in either item #11 or item #19, and the applicant is applying for an off-sale beer and wine license, an off-sale general license, an on-sale beer license, an on-sale beer and wine (public premises) license, or an on-sale general (public premises) license, advise the applicant to take this form to the local governing body, or its designated subordinate officer or body to have them complete Section 3. The completed form will need to be provided to ABC in order to process the application.

Governing Body/Designated Subordinate Name: (BACK) Board of Supervisors

DEPARTMENT USE ONLY

FILED BY (Name of Department Employee) DA

PART 2 - TO BE COMPLETED BY THE APPLICANT (If box #20b is checked)

21. Based on the information on the reverse, the Department may approve your application if you can show that public convenience or necessity would be served by the issuance of the license. Please describe below the reasons why issuance of another license is justified in

Multiple horizontal lines for handwritten response to question 21.

22. APPLICANT SIGNATURE

23. DATE SIGNED

PART 3 - TO BE COMPLETED BY LOCAL OFFICIALS (If box #20c is checked)

The applicant named on the reverse is applying for a license to sell alcoholic beverages at a premises where undue concentration exists (i.e., in over-concentration of licenses and/or a higher than average crime rate as defined in Section 23958.4 of the Business and Professions Code). Sections 23958 and 23958.4 of the Business and Professions Code requires the Department to deny the application unless the local governing body of the area in which the applicant premises are located, or its designated subordinate officer or body, determines within 90 days of notification of a completed application that public convenience or necessity would be served by the issuance. Please complete items #24 to #30 below and certify or affix an official seal, or attach a copy of the Council or Board resolution or a signed letter on official letterhead stating whether or not the issuance of the applied for license would serve as a public convenience or necessity.

24. WILL PUBLIC CONVENIENCE OR NECESSITY BE SERVED BY ISSUANCE OF THIS ALCOHOLIC BEVERAGE LICENSE?

Yes No See Attached (i.e., letter, resolution, etc.)

25. ADDITIONAL COMMENTS, IF DESIRED (may include reasons for approval or denial of public convenience or necessity).

Multiple horizontal lines for handwritten additional comments.

26. CITY/COUNTY OFFICIAL NAME

27. CITY/COUNTY OFFICIAL TITLE

28. CITY/COUNTY OFFICIAL PHONE NUMBER

29. CITY/COUNTY OFFICIAL SIGNATURE

30. DATE SIGNED

Department of Alcoholic Beverage Control
LICENSED PREMISES DIAGRAM (RETAIL)

State of California

1. APPLICANT NAME (Last, first, middle) Paul SukChan Lee and Eunice Lee	2. LICENSE TYPE Type 21
3. PREMISES ADDRESS (Street number and name, city, zip code) 1600 Post St. San Francisco, CA 94115	4. NEAREST CROSS STREET Laguna

The diagram below is a true and correct description of the entrances, exits, interior walls and exterior boundaries of the premises to be licensed, including dimensions and identification of each room (i.e., "storeroom", "office", etc.).

DIAGRAM

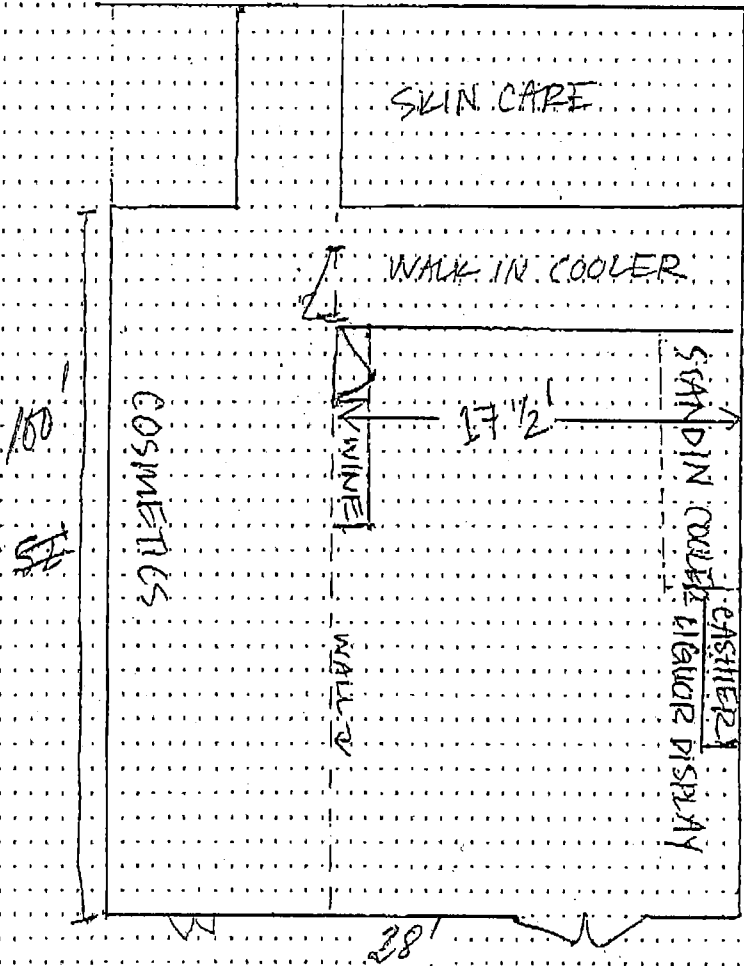

RECEIVED
 JUL 25 2012
 Dept of Alcoholic Beverage Control
 San Francisco

It is hereby declared that the above-described boundaries, entrances and planned operation as indicated on the reverse side, will not be changed without first notifying and securing prior written approval of the Department of Alcoholic Beverage Control. I declare under penalty of perjury that the foregoing is true and correct.

APPLICANT'S SIGNATURE (Only one signature required) Paul Lee	DATE SIGNED 7-11-2012
FOR ABC USE ONLY	
CERTIFIED COPY/CT (signature) [Signature]	INSPECTION DATE 8/7/12
PHINVED NAME CAROLINA EUBEN	

ABC-257 (5/05)

prem approx 28' x 150'

Under renovation for the store of ABC

Department of Alcoholic Beverage Control
PLANNED OPERATION (RETAIL)

SECTION I - FOR ALL RETAIL APPLICANTS

1. APPLICANT NAME(S) Paul SulChan Lee and Eunice Lee		2. LICENSE TYPE(S) Type 21																																	
3. PREMISES ADDRESS (Street number and name, city, zip code) 1600 Post St. San Francisco, CA 94115		4. NEAREST CROSS STREET Laguna St.																																	
5. TYPE OF BUSINESS (Choose one that best describes the planned operation) <table style="width:100%; border: none;"> <tr> <td><input type="checkbox"/> Full Service Restaurant</td> <td><input type="checkbox"/> Cafeteria/Hofbrau</td> <td><input type="checkbox"/> Cocktail Lounge</td> <td><input type="checkbox"/> Private Club</td> </tr> <tr> <td><input type="checkbox"/> Deli or Specialty Restaurant</td> <td><input type="checkbox"/> Comedy Club</td> <td><input type="checkbox"/> Night Club</td> <td><input type="checkbox"/> Veterans Club</td> </tr> <tr> <td><input type="checkbox"/> Cafe/Coffee Shop</td> <td><input type="checkbox"/> Brew Pub</td> <td><input type="checkbox"/> Tavern</td> <td><input type="checkbox"/> Fraternal Club</td> </tr> <tr> <td><input type="checkbox"/> Bed & Breakfast</td> <td><input type="checkbox"/> Theater</td> <td><input type="checkbox"/> Wine Tasting Room</td> <td></td> </tr> <tr> <td><input type="checkbox"/> Supermarket</td> <td><input type="checkbox"/> Membership Store</td> <td><input type="checkbox"/> Service Station</td> <td><input type="checkbox"/> Swap Meet/Flea Market</td> </tr> <tr> <td><input type="checkbox"/> Liquor Store</td> <td><input type="checkbox"/> Department Store</td> <td><input type="checkbox"/> Convenience Market</td> <td><input type="checkbox"/> Drive-In Dairy</td> </tr> <tr> <td><input checked="" type="checkbox"/> Variety/Drug Store</td> <td><input type="checkbox"/> Gift Shop/Florist</td> <td><input type="checkbox"/> Convenience Market w/Gasoline</td> <td></td> </tr> <tr> <td colspan="4"><input type="checkbox"/> Other - describe:</td> </tr> </table>				<input type="checkbox"/> Full Service Restaurant	<input type="checkbox"/> Cafeteria/Hofbrau	<input type="checkbox"/> Cocktail Lounge	<input type="checkbox"/> Private Club	<input type="checkbox"/> Deli or Specialty Restaurant	<input type="checkbox"/> Comedy Club	<input type="checkbox"/> Night Club	<input type="checkbox"/> Veterans Club	<input type="checkbox"/> Cafe/Coffee Shop	<input type="checkbox"/> Brew Pub	<input type="checkbox"/> Tavern	<input type="checkbox"/> Fraternal Club	<input type="checkbox"/> Bed & Breakfast	<input type="checkbox"/> Theater	<input type="checkbox"/> Wine Tasting Room		<input type="checkbox"/> Supermarket	<input type="checkbox"/> Membership Store	<input type="checkbox"/> Service Station	<input type="checkbox"/> Swap Meet/Flea Market	<input type="checkbox"/> Liquor Store	<input type="checkbox"/> Department Store	<input type="checkbox"/> Convenience Market	<input type="checkbox"/> Drive-In Dairy	<input checked="" type="checkbox"/> Variety/Drug Store	<input type="checkbox"/> Gift Shop/Florist	<input type="checkbox"/> Convenience Market w/Gasoline		<input type="checkbox"/> Other - describe:			
<input type="checkbox"/> Full Service Restaurant	<input type="checkbox"/> Cafeteria/Hofbrau	<input type="checkbox"/> Cocktail Lounge	<input type="checkbox"/> Private Club																																
<input type="checkbox"/> Deli or Specialty Restaurant	<input type="checkbox"/> Comedy Club	<input type="checkbox"/> Night Club	<input type="checkbox"/> Veterans Club																																
<input type="checkbox"/> Cafe/Coffee Shop	<input type="checkbox"/> Brew Pub	<input type="checkbox"/> Tavern	<input type="checkbox"/> Fraternal Club																																
<input type="checkbox"/> Bed & Breakfast	<input type="checkbox"/> Theater	<input type="checkbox"/> Wine Tasting Room																																	
<input type="checkbox"/> Supermarket	<input type="checkbox"/> Membership Store	<input type="checkbox"/> Service Station	<input type="checkbox"/> Swap Meet/Flea Market																																
<input type="checkbox"/> Liquor Store	<input type="checkbox"/> Department Store	<input type="checkbox"/> Convenience Market	<input type="checkbox"/> Drive-In Dairy																																
<input checked="" type="checkbox"/> Variety/Drug Store	<input type="checkbox"/> Gift Shop/Florist	<input type="checkbox"/> Convenience Market w/Gasoline																																	
<input type="checkbox"/> Other - describe:																																			
6. PATRON CAPACITY	7. SURROUNDING AREA <input checked="" type="checkbox"/> Commercial <input type="checkbox"/> Residential <input type="checkbox"/> Other	8. PREMISES IS LOCATED IN <input type="checkbox"/> Free Standing Building <input type="checkbox"/> Shopping Center (Name): <input type="checkbox"/> 10 Units or Less <input type="checkbox"/> More than 10 Units																																	
9. FOOD SERVICE <input checked="" type="checkbox"/> None <input type="checkbox"/> Minimal <input type="checkbox"/> Full Meals	10. PARKING LOT? <input type="checkbox"/> Yes <input checked="" type="checkbox"/> No	11. PATIO? <input type="checkbox"/> Yes <input checked="" type="checkbox"/> No	12. WILL YOU HIRE A MANAGER? (Rule 57.5) <input type="checkbox"/> Yes <input checked="" type="checkbox"/> No																																
14. MEAL TYPE <input type="checkbox"/> Dinner House <input type="checkbox"/> Seafood <input type="checkbox"/> Fast Food/Deli <input type="checkbox"/> Other: <input type="checkbox"/> Pizza/Pasta N/A		15. TYPE OF FOOD <input type="checkbox"/> American <input type="checkbox"/> Greek <input type="checkbox"/> Indian <input type="checkbox"/> French <input type="checkbox"/> Chinese <input type="checkbox"/> Korean <input type="checkbox"/> Italian <input type="checkbox"/> Thai <input type="checkbox"/> Japanese <input type="checkbox"/> Other: N/A																																	
13. WILL YOU HAVE A FOOD LESSEE? (Rule 57.7) <input type="checkbox"/> Yes <input checked="" type="checkbox"/> No																																			
16. HOURS OF FOOD SERVICE BREAKFAST HOURS From: To: LUNCH HOURS From: To: DINNER HOURS From: To:																																			
17. OPERATING HOURS <table style="width:100%; border-collapse: collapse;"> <thead> <tr> <th></th> <th>Sunday</th> <th>Monday</th> <th>Tuesday</th> <th>Wednesday</th> <th>Thursday</th> <th>Friday</th> <th>Saturday</th> </tr> </thead> <tbody> <tr> <td>Opening Time</td> <td>9:50AM</td> <td>9:00AM</td> <td>9:00AM</td> <td>9:00AM</td> <td>9:00AM</td> <td>9:00AM</td> <td>9:00AM</td> </tr> <tr> <td>Closing Time</td> <td>11:00PM</td> <td>12:00AM</td> <td>12:00AM</td> <td>12:00AM</td> <td>12:00AM</td> <td>12:00AM</td> <td>12:00AM</td> </tr> </tbody> </table>									Sunday	Monday	Tuesday	Wednesday	Thursday	Friday	Saturday	Opening Time	9:50AM	9:00AM	9:00AM	9:00AM	9:00AM	9:00AM	9:00AM	Closing Time	11:00PM	12:00AM	12:00AM	12:00AM	12:00AM	12:00AM	12:00AM				
	Sunday	Monday	Tuesday	Wednesday	Thursday	Friday	Saturday																												
Opening Time	9:50AM	9:00AM	9:00AM	9:00AM	9:00AM	9:00AM	9:00AM																												
Closing Time	11:00PM	12:00AM	12:00AM	12:00AM	12:00AM	12:00AM	12:00AM																												
18. ENTERTAINMENT (One or more may apply. Please describe any entertainment with an asterisk (*) below) <table style="width:100%; border: none;"> <tr> <td><input checked="" type="checkbox"/> None</td> <td><input type="checkbox"/> *Amplified Music</td> <td><input type="checkbox"/> Patron Dancing</td> <td><input type="checkbox"/> Card Room</td> </tr> <tr> <td><input type="checkbox"/> Recorded Music</td> <td><input type="checkbox"/> *Live Entertainment</td> <td><input type="checkbox"/> Bikini/Topless/Exotic</td> <td><input type="checkbox"/> Movies</td> </tr> <tr> <td><input type="checkbox"/> Juke Box</td> <td><input type="checkbox"/> *Floor/Stage Shows</td> <td><input type="checkbox"/> Pool/Billiard Tables</td> <td><input type="checkbox"/> "Hot Spot"/Lottery</td> </tr> <tr> <td><input type="checkbox"/> *Other</td> <td><input type="checkbox"/> Karaoke</td> <td><input type="checkbox"/> *Amateur/Pro Sports Events</td> <td><input type="checkbox"/> Video/Coin-Operated Games</td> </tr> </table> *Description:				<input checked="" type="checkbox"/> None	<input type="checkbox"/> *Amplified Music	<input type="checkbox"/> Patron Dancing	<input type="checkbox"/> Card Room	<input type="checkbox"/> Recorded Music	<input type="checkbox"/> *Live Entertainment	<input type="checkbox"/> Bikini/Topless/Exotic	<input type="checkbox"/> Movies	<input type="checkbox"/> Juke Box	<input type="checkbox"/> *Floor/Stage Shows	<input type="checkbox"/> Pool/Billiard Tables	<input type="checkbox"/> "Hot Spot"/Lottery	<input type="checkbox"/> *Other	<input type="checkbox"/> Karaoke	<input type="checkbox"/> *Amateur/Pro Sports Events	<input type="checkbox"/> Video/Coin-Operated Games																
<input checked="" type="checkbox"/> None	<input type="checkbox"/> *Amplified Music	<input type="checkbox"/> Patron Dancing	<input type="checkbox"/> Card Room																																
<input type="checkbox"/> Recorded Music	<input type="checkbox"/> *Live Entertainment	<input type="checkbox"/> Bikini/Topless/Exotic	<input type="checkbox"/> Movies																																
<input type="checkbox"/> Juke Box	<input type="checkbox"/> *Floor/Stage Shows	<input type="checkbox"/> Pool/Billiard Tables	<input type="checkbox"/> "Hot Spot"/Lottery																																
<input type="checkbox"/> *Other	<input type="checkbox"/> Karaoke	<input type="checkbox"/> *Amateur/Pro Sports Events	<input type="checkbox"/> Video/Coin-Operated Games																																
18. PREMISES IS LOCATED ON <input checked="" type="checkbox"/> Major Thoroughfare <input type="checkbox"/> Secondary Street <input type="checkbox"/> Other		19. TYPE OF STRUCTURE <input checked="" type="checkbox"/> Single Story <input type="checkbox"/> Two-Story <input type="checkbox"/> Multi-Story - Number of stories:																																	
21. PASS-THROUGH WINDOW? <input type="checkbox"/> Yes <input checked="" type="checkbox"/> No	22. FIXED BARD? <input type="checkbox"/> Yes - how many: <input checked="" type="checkbox"/> No	23. WHAT PERCENTAGE OF YOUR TOTAL SALES WILL BE ALCOHOLIC BEVERAGES? 5%																																	
FOR ABC USE ONLY																																			
24. INFORMATION GIVEN (R-27, R-107, Sec. 25612.5, Sec. 23700.1, etc.)			25. DATE ENTERED INTO CABIN																																

RECEIVED
 JUL 25 2012
 Department of Alcoholic Beverage Control
 San Francisco

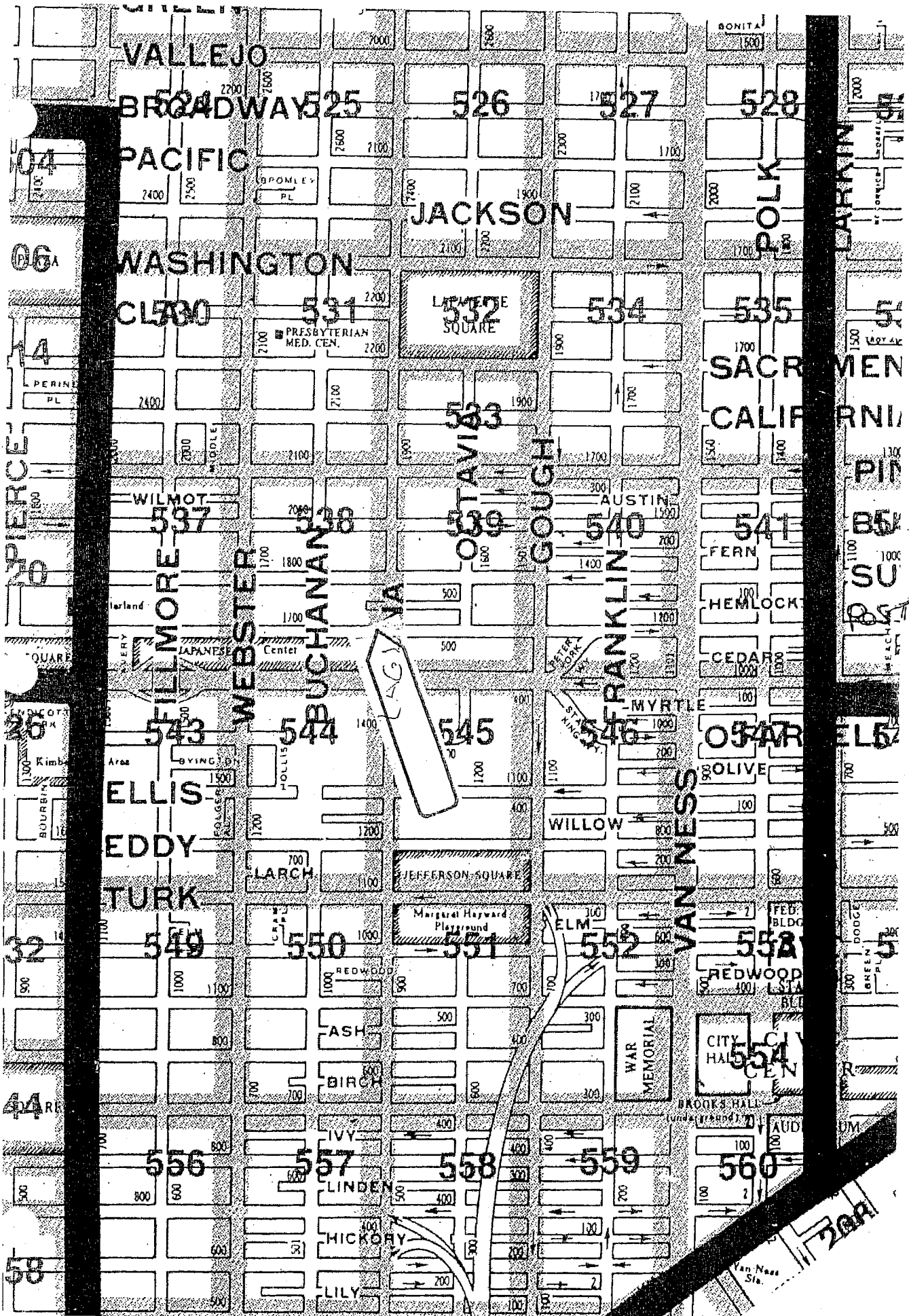

export To **New!**

Records **1** through **1** of **1**

Call No	Report No	Received Date	Received Time	Priority	Call Type	Unit ID	Disposition	Location
<u>120072067</u>		01/07/2012	16:08:06	C	601	3E12D	ADV	1600 POST ST

End of document

export To  **New!**

Records **1** through **3** of **3**

Call No	Report No	Received Date	Received Time	Priority	Call Type	Unit ID	Disposition	Location
<u>113030630</u>		10/30/2011	02:35:41	C	852			1600 POST ST
<u>112731576</u>		09/30/2011	11:57:17	C	7I	3E76	HAN	1600-BLK POST ST
<u>112731536</u>		09/30/2011	11:43:27	C	7I	3E76	HAN	1600-BLK POST ST

End of document



SAN FRANCISCO PLANNING DEPARTMENT

FAX

Date:	8/5/13
To:	Derek Evans, Clerk
Fax No.:	(415) 554-7714
Phone No.:	n/a
From:	Christine Lamorena
Phone No.:	(415) 575-9085
Re:	Liquor License Review

1650 Mission St.
Suite 400
San Francisco,
CA 94103-2479

Reception:
415.558.6378

Fax:
415.558.6409

Planning
Information:
415.558.6377

Web Site:
sfplanning.org

No. of Pages (incl. cover sheet)

2

Notes

Facsimile

Received Time Aug. 5. 2013 4:11PM No. 1299

2198

LIQUOR LICENSE REVIEW

TO: Planning Department
 AnMarie Rodgers/CTYPLN/SFGOV
 Georgia Powell/CTYPLN/SFGOV@SFGOV
 Fax No.: 558-6409

File: 120864

Block/lot: 0686/052

Zoning: RM-3

Quad: NW

ms #1201704

TO: Police Department
 Inspector Kenneth Stocker
 Inspector Julie Lazar
 Fax No.: 553-1463

DATE: September 5, 2012

This item is tentatively scheduled to be heard on October 22, 2012.
PLEASE EMAIL YOUR RESPONSE BY: October 17, 2012, to Derek Evans,
 Clerk, City Operations and Neighborhood Services Committee.
Derek.Evans@sfgov.org - Fax No: 554-7714

Applicant Name: Paul SukChan Lee
and Business Name: Han Mi Gift Center.(1600 Post Street)

Applicant Address: 1600 Post Street
 San Francisco, CA 94109
and Phone No. (415) 931-1600

PLANNING COMMENTS: Approval Denial
*ABC license Type 21 is permitted with a liquor store
 use per Planning Code section 711.45.*

[Signature]
 E. Lamorena
 09-05-13

POLICE COMMENTS: Approval Denial



We, the undersigned neighbors, fully support the proposed convenience store located at 1600 post Street The owner, Paul Lee, has run a business for over 20 years at the premises and has always been an upstanding member of the community.

The addition of the convenience store at 1600 Post Street will provide the neighborhood with a shopping option that will help better serve the Japan town area by adding a wider variety of goods, including alcohol, to its products offering.

Name	Signature	Address
1. MIN, HaeJA	<i>Haeja Min</i>	1615 Sutter st ^{Apt # 209} San Francisco, CA
2. Jennifer Byun	<i>J Byun</i>	1610 Post street # 203 S-F, CA 94115
3. TINA CHOI	<i>Tin choi</i>	1435 LAGUNA ST #4. SF 94115
4.		
5.		
6.		
7.		

We, the undersigned neighbors, fully support the proposed convenience store located at 1600 post Street The owner, Paul Lee, has run a business for over 20 years at the premises and has always been an upstanding member of the community.

The addition of the convenience store at 1600 Post Street will provide the neighborhood with a shopping option that will help better serve the Japan town area by adding a wider variety of goods, including alcohol, to its products offering.

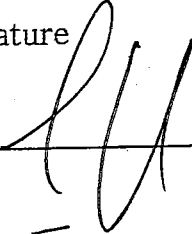
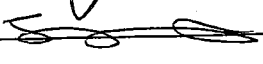
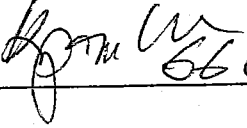
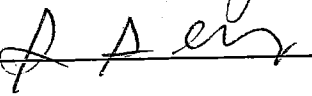
- | Name | Signature | Address |
|----------------------------|--|---|
| 1. Steve Im |  | 66 Cleary Court #508
San Francisco, CA 94109 |
| 2. ^{CHANG} Chy La |  | 1610 post st. S.F. CA 94115 |
| 3. KWAN N. Kim (Kwan C) | | 1608 Laguna St SF 94115 |
| 4. Jeon Cha KIM | | 1620 Post St S.F. Ca 94115 |
| 5. Eun Lee Eason | | 20 Bertie Minor Ln #5 San Francisco, CA 94115 |
| 6. KAPSUK WOO |  | 66 Cleary Court #1101 SF CA 94109 |
| 7. SUN SOON CHANG |  | 1435 LAGUNA #5
S.F 94115 |

120864
RECEIVED
BOARD OF SUPERVISORS
SAN FRANCISCO

2012 AUG 21 PM 3:18

M

San Francisco Board of Supervisors
City Operations and Neighborhood Services
1 Dr. Carlton B. Goodlet Place, Room 244
San Francisco, CA 94102
Attn: Gail Johnson, Committee Clerk

Re: Request for Determination of Public Convenience or Necessity for the Store
located at 1600 Post Street

Dear Ms. Johnson and Members of the City Operations and Neighborhood Services
Committee:

I recently applied for the transfer of a Type-21 license (see application no. 524196) to my store located at 1600 Post St., San Francisco, CA (the "Store").

I have been informed by the Department of Alcoholic Beverage Control ("ABC") that a determination of public convenience or necessity by the Board of Supervisors is a condition to the ABC's issuance of this license.

I respectfully request that the Board determine that the issuance of a Type-21 license to this Store will serve public convenience or necessity.

I. Project Description.

I have run a high end gift and cosmetic shop at 1600 Post St. for the last 20 years servicing locals and tourists but because of the economic downturn, I would like to include offering food, non-alcoholic and alcoholic beverages. The Store intends to carry spirits, wine and domestic and imported beer.

II. The Sale of Alcohol at the Store will serve Public Convenience or Necessity.

I am committed to continue being a good community partner. I hope to provide a wider product offering to my customers without negatively impacting the surrounding area. Located on the outskirts of Japantown, the neighborhood has had several corner grocery stores that sell alcohol close including the 105-year-old Sakai market. The Store's proximity to the Kabuki and other Hotels will give tourists another shopping option.

The enhanced product offering will serve to add convenience to the thousands of business people, local shoppers and tourists that pass through the area each year. By adding wider variety of goods, including alcohol, to its product offering, The Store will provide a better shopping experience for its customers. We intended to offer a variety of snacks such as potato chips, candy and ice cream as well as non-alcoholic drinks like soda, sport/energy drinks and water. Our alcoholic drinks will include beer, wine and some spirits.

Conclusion.

The issuance of a Type-21 license to the Store will enable me to provide Japantown with another added value shopping option that will help better serve the area. I would like to stress that we are looking to service our neighbors and the many tourists we see per day and will not carry products that will attract bad elements to the Store or cause the police problems. I am committed to providing this experience in a safe and conscientious manner, with minimal disruption to the surrounding neighborhood.

For these reasons, I respectfully request that the Board determine that public convenience or necessity will be served by the issuance of a Type-21 license to the Store. Thank you in advance for your consideration.

Very truly yours,

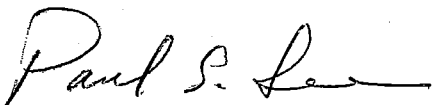

Paul SukChan Lee

LIQUOR LICENSE REVIEW

TO: Planning Department
AnMarie Rodgers/CTYPLN/SFGOV
Georgia Powell/CTYPLN/SFGOV@SFGOV
Fax No.: 558-6409

File: 120864

TO: Police Department
Inspector Kenneth Stocker
Inspector Julie Lazar
Fax No.: 553-1463

DATE: September 5, 2012

This item is tentatively scheduled to be heard on October 22, 2012.
PLEASE EMAIL YOUR RESPONSE BY: October 17, 2012, to Derek Evans,
Clerk, City Operations and Neighborhood Services Committee.
Derek.Evans@sfgov.org - Fax No: 554-7714

Applicant Name: Paul SukChan Lee
and Business Name: Han Mi Gift Center (1600 Post Street)

Applicant Address: 1600 Post Street
San Francisco, CA 94109
and Phone No. (415) 931-1600

PLANNING COMMENTS: Approval Denial

POLICE COMMENTS: Approval Denial

