

LEGEND

- ASSESSORS BLOCK AND LOT NUMBERS
- NEW CURB LINE
- PROPERTY LINE
- EXISTING OFFICIAL CURB TO REMAIN
- EXISTING OFFICIAL CURB TO BE REMOVED
- AREA UNDER SFPW JURISDICTION FOR MAINTENANCE

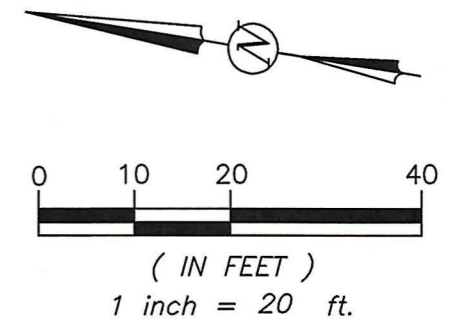

VICINITY MAP
NOT TO SCALE

CURVE TABLE			
CURVE #	LENGTH	RADIUS	DELTA
C1	5.86	10.00	33°33'26"
C2	11.71	20.00	33°33'26"
C3	11.71	20.00	33°33'26"
C4	5.86	10.00	33°33'26"

LINE TABLE	
LINE #	LENGTH
L1	22.10

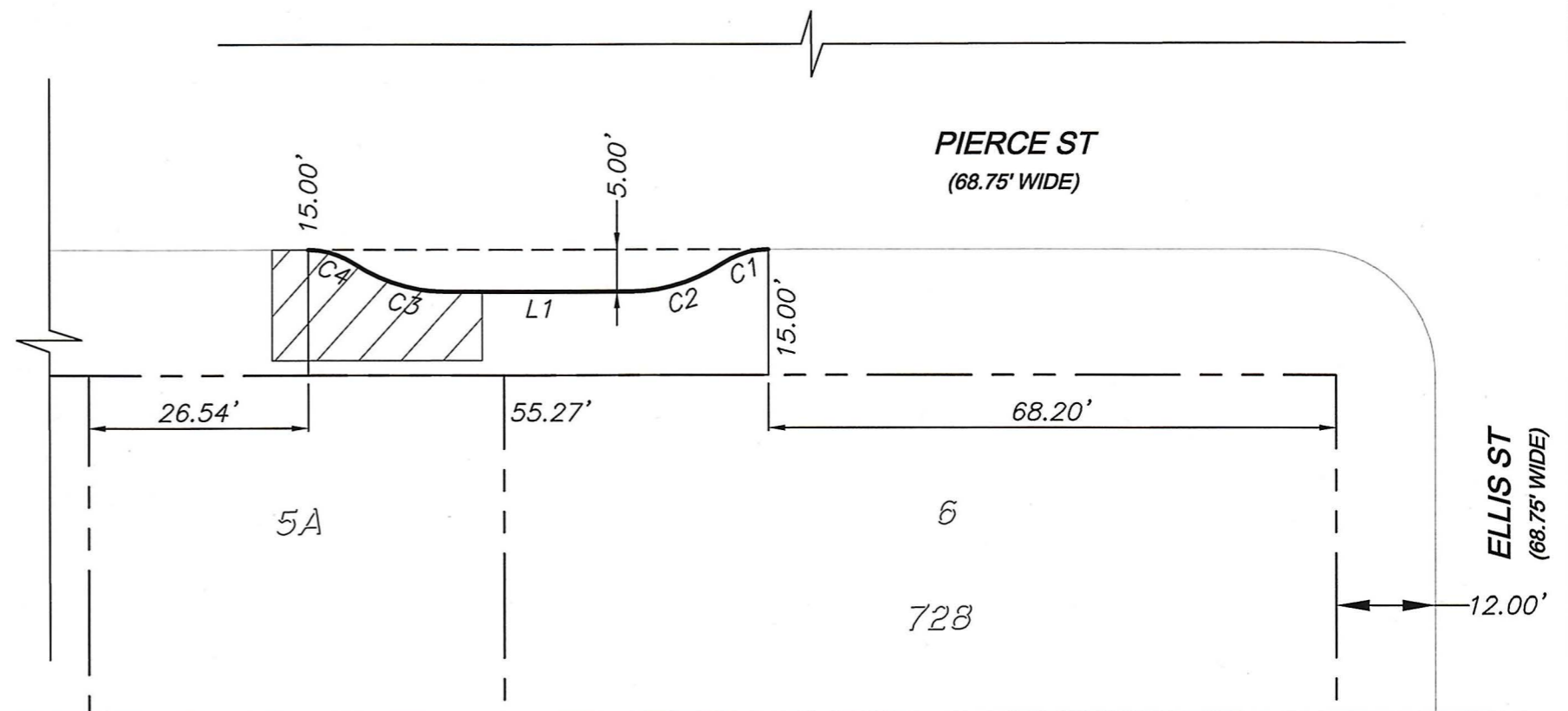

Jawong Oct 17, 2019 - 12:55pm J:\Survey\Sidewalk Changes\2018\2019_019 1301 Pierce Street.DWG\AB 0782 LDT 006.dwg



APPROVED:
Bruce R. Storrs
BRUCE R. STORRS, PLS 6914
CITY & COUNTY SURVEYOR

10-17-2019
DATE

CITY AND COUNTY OF SAN FRANCISCO
DEPARTMENT OF PUBLIC WORKS

OFFICIAL SIDEWALK CHANGE AT THE WESTERLY SIDE OF PIERCE STREET, BETWEEN OFARRELL STREET AND ELLIS STREET, FRONTING AB 0728 LOTS 005A AND 006

FILE: Q-20-1080	SHEET 1 OF 1	SCALE: 1"=40'	REVISION
-----------------	--------------	---------------	----------