

LEGEND

- AB 3708 LOT 006 ASSESSOR'S LOT & BLOCK
- P.O.B. POINT OF BEGINNING
- MEAS. MEASURED
- STREET RIGHT OF WAY AREA TO BE VACATED

MAP REFERENCES

- [1] CITY OF SAN FRANCISCO MONUMENT MAP NO. 316 ON FILE IN THE OFFICE OF THE CITY AND COUNTY SURVEYOR.
- [2] BLOCK DIAGRAM OF 100 VARA BLOCK 346 DATED SEPTEMBER 13, 1909 ON FILE IN THE OFFICE OF THE CITY AND COUNTY SURVEYOR.

NOTES

- 1. ALL ANGLES ARE 90 DEGREES UNLESS NOTED OTHERWISE.
- 2. DIMENSIONS ARE IN FEET AND DECIMALS THEREOF.

GRAPHIC SCALE

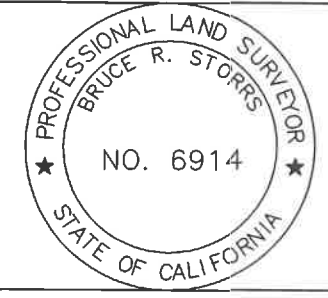
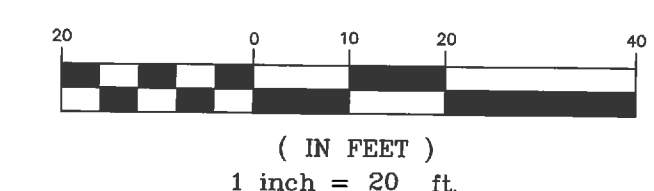

APPROVED: *Bruce R. Storrs*
 BRUCE R. STORRS
 CITY & COUNTY SURVEYOR

4/18/16
 DATE

CITY AND COUNTY OF SAN FRANCISCO
DEPARTMENT OF PUBLIC WORKS

STREET VACATION OF A PORTION OF JESSIE ST. AND A PORTION OF ELIM ALY. GENERALLY BOUNDED BY AB 3708 AND FIRST ST.

FILE: SUR 2016-002	SHEET 1 OF 1	SCALE: 1:20	CHANGE
-----------------------	--------------	-------------	--------