

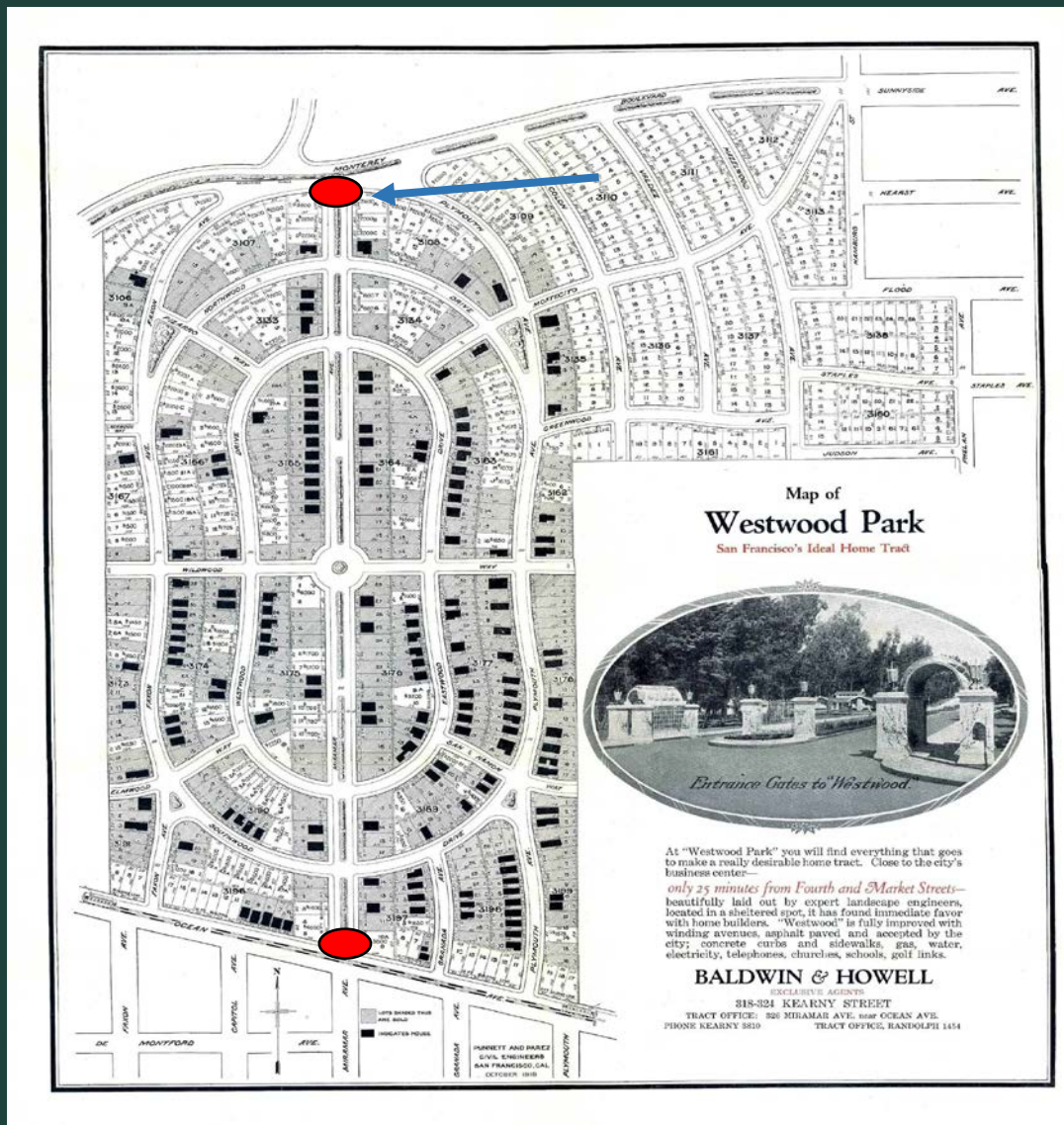

Westwood Park Entrance Gates: Landmarking a Historic Treasure

San Francisco Land Use & Transportation Committee
May 15, 2023

Presentation by the Westwood Park Association



1919 map of Westwood Park. Entrance Gates were built on Miramar Avenue at Monterey Boulevard (top) and Ocean Avenue (bottom).



Westwood Park Entrance Gates, looking South on Miramar Avenue from Monterey Boulevard



View of Westwood Park Entrance Gates, looking North on Miramar Avenue toward Monterey Blvd



Close up view of Entrance Gates on
Miramar Avenue & Monterey Boulevard



Court of the Ages, 1915 Panama Pacific International Exposition

Renowned architect Louis Christian Mullgardt designed the Westwood Park Entrance Gates, 1915-16

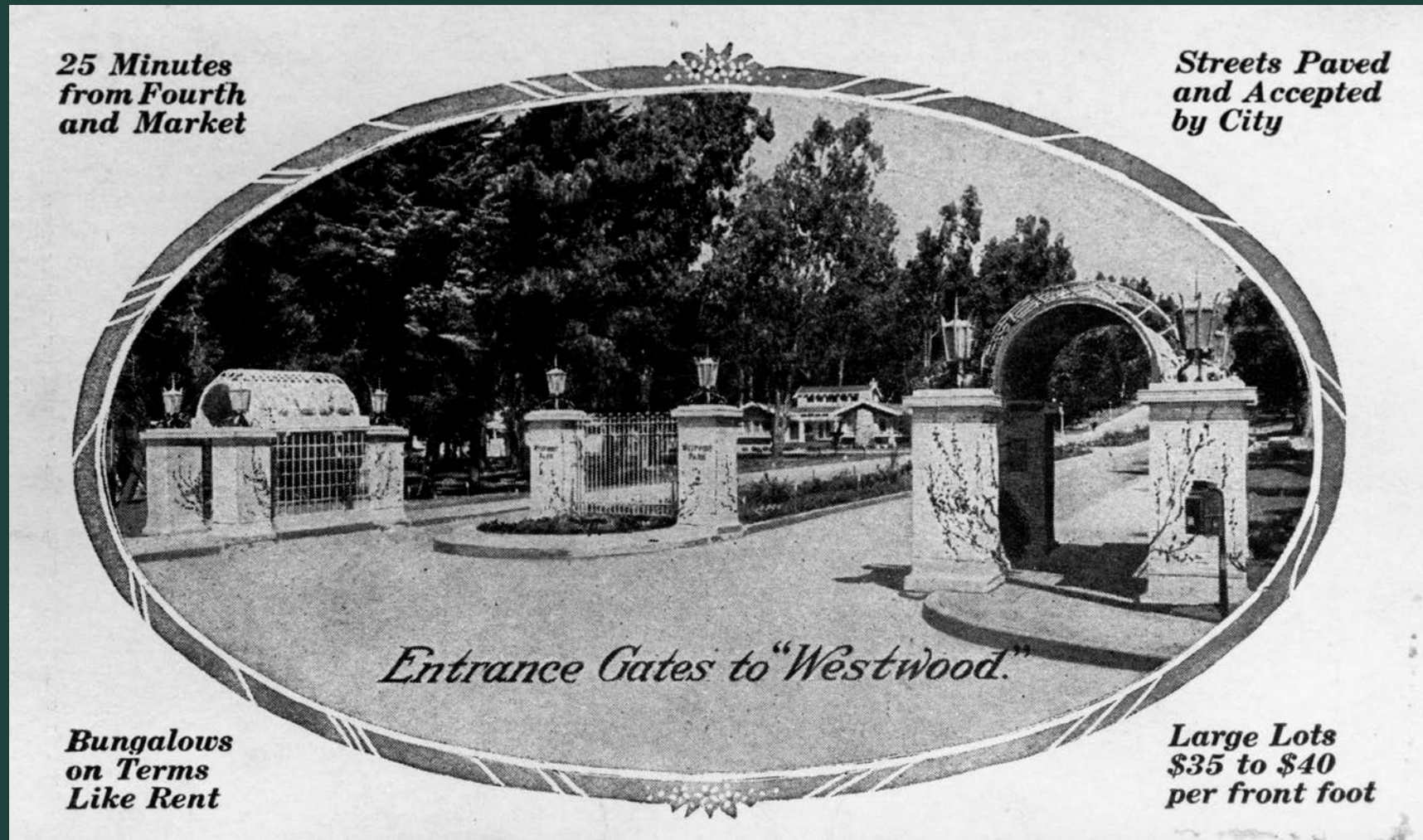

1920s brochure photo of Westwood Park Entrance Gate,
at Miramar Avenue & Ocean Avenue (No longer existing)



Construction photo in Sutro Forest, of Miramar Avenue & Monterey Boulevard Entrance Gates - from a 1916 neighborhood brochure



Pedestrian crossing at Westwood Park Entrance Gates,
located at Miramar Avenue & Monterey Boulevard



One of the two barrel-vaulted portals (restored in 2003), with a curved wrought iron grill and lamps mounted above.



One of four surviving, freestanding Westwood Park pillars

“Not all city landmarks are buildings. However, buildings are the principal landmarks in cities and the principles which make them well or ill apply also to most other kinds of landmarks, such as monuments, dramatic fountains, and so on.”

-Jane Jacobs

Author of “The Death and Life of Great American Cities”