



# 30 Otis Project 12th Street Plaza Major Encroachment Permit

Installation of a public plaza on part of 12th Street between South Van Ness Ave. and Otis St.



# Plaza Context

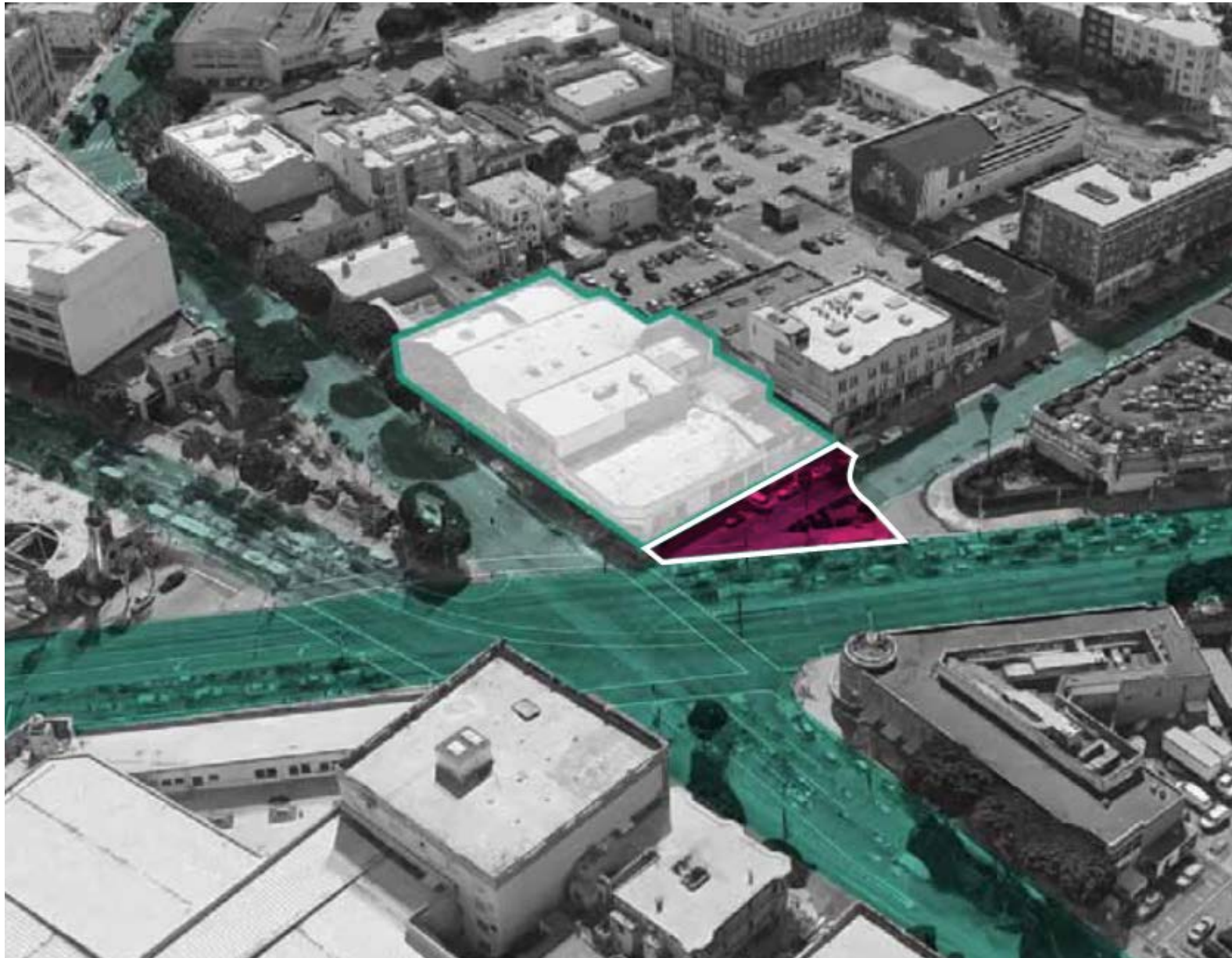

- Intended to be a centerpiece of the revitalized Mission and S. Van Ness intersection from which The HUB Plan emanates
- Provide a dynamic place of refuge, a key part of The HUB's goal of making the wide intersection more pedestrian friendly
- Coordinated with SFMTA to ensure proper traffic flow to and from 12th Street /South Van Ness
- Completion expected early 2024

# Resolutions and Obligations

- In Kind Agreement Obligation
  - Install public open space improvements on a portion of 12th Street between South Van Ness Ave. and Otis Street
- Resolution
  - Fulfills IKA Obligations in allowing SFDPW to enter into an Encroachment Permit and Maintenance Agreement with Permittee for installation and maintenance of public improvements
- Owner obligations
  - Monitoring and maintenance of plaza features
  - Maintain liability insurance policy
- 12/11/2023 Land Use Committee amendments added final approval of Sidewalk Easement conditionally approved in 2021 – considered and requires continuance



# Plaza Plan & Design

Frida is a world renowned Mexican Architect known for public space installations and interventions. Her work is highly conceptual and rigorous.

Frida studied architecture at the Universidad Iberoamericana and received a Master's Degree in Art and Design and the Public Domain at the Harvard Graduate School of Design.

She was commissioned to design the Serpentine Pavilion 2018, becoming the youngest architect selected for this prestigious public commission and the first woman since Zaha Hadid. Frida was also recently selected to design the new Oscar L. Tang and H.M. Agnes Hsu-Tang Wing at The New York Met, becoming the first woman selected to design a wing at The Met.

[FridaEscobedo.com](http://FridaEscobedo.com)

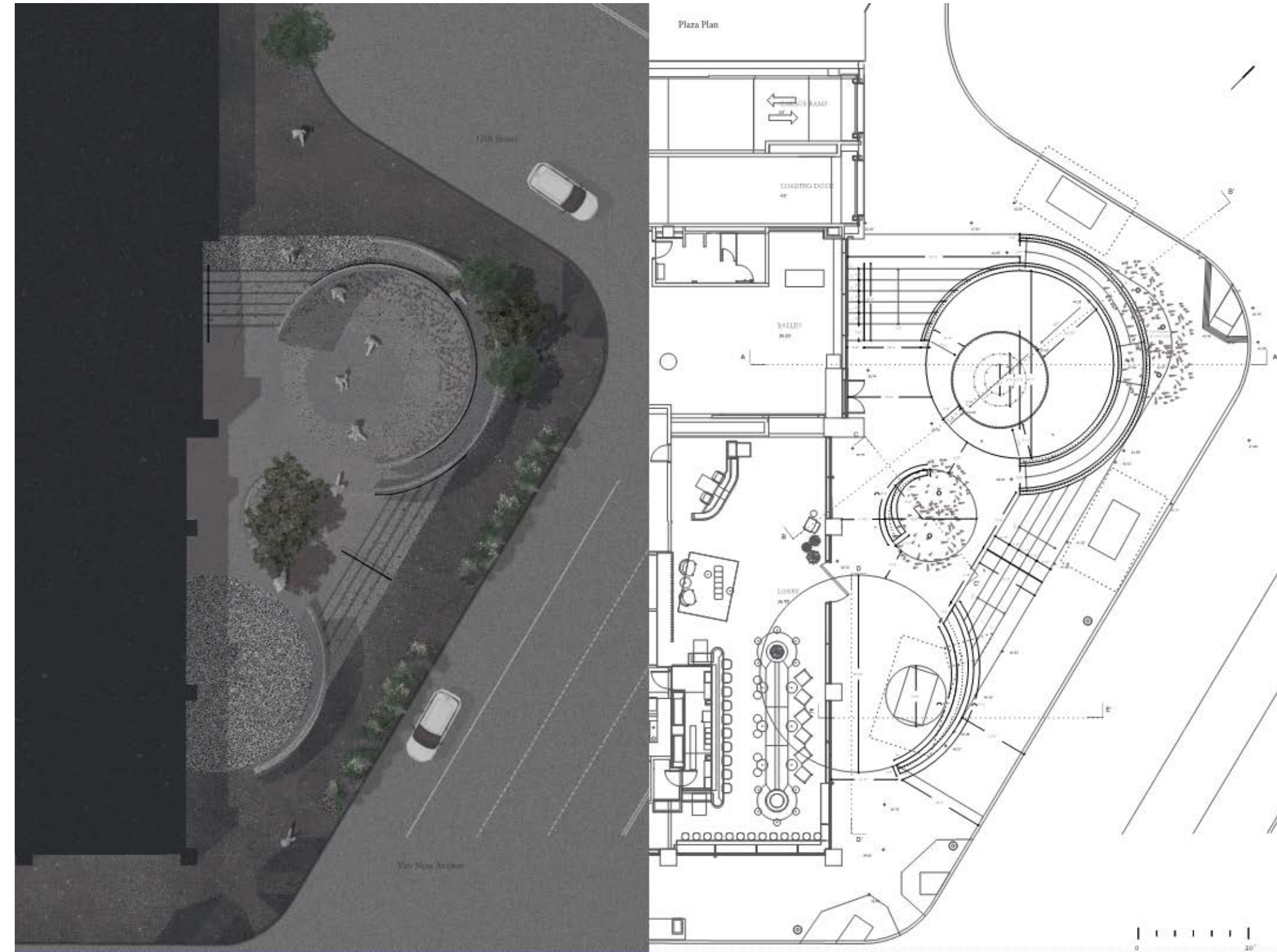



Thank you - Questions?

