

MAP SHOWING THE OPENING OF MISSION BAY PARK P10

**CITY AND COUNTY OF SAN FRANCISCO
DEPARTMENT OF PUBLIC WORKS
BUREAU OF STREET USE AND MAPPING**

SCALE: 1" = 50'
REFERENCES:
BOOK DD OF SURVEY MAPS, PAGES 116-121
BOOK CC OF SURVEY MAPS, PAGES 123-131
BOOK Z OF SURVEY MAPS, PAGES 97-113

THIS MAP, COMPRISING OF ONE (1) SHEET, IS APPROVED AND MADE OFFICIAL AND THE PARCELS SHOWN HEREON ARE DECLARED TO BE OPEN PUBLIC RIGHT-OF-WAY FOR PARK AND OPEN SPACE PURPOSES TO BE KNOWN BY NAME AS SHOWN ON THIS MAP BY ORDINANCE NO. _____ OF THE BOARD OF SUPERVISORS, ADOPTED THIS _____ DAY OF _____, 2013.

APPROVED AS TO FORM: _____
BY: _____ CITY AND COUNTY SURVEYOR
APPROVED THIS _____ DAY OF _____, 2013
BY ORDER NO. _____ DIRECTOR OF PUBLIC WORKS

RECORDER'S STATEMENT
FILED THIS _____ DAY OF _____, 2013, AT _____ M.
IN BOOK _____ OF SURVEY MAPS, AT PAGE _____, AT THE
REQUEST OF THE COUNTY SURVEYOR OF THE CITY AND COUNTY
OF SAN FRANCISCO.
SIGNED _____ COUNTY RECORDER

LEGEND
AREA TO BE DEDICATED AS PARK P10 RIGHT-OF-WAY
(R) RADIUS
R RADIUS
D DELTA
L LENGTH

NOTES:
* SEE SHEET 2 FOR CURVE AND LINE DATA FOR PARK AREAS.

DETAIL "A"
SCALE: 1"=20'

DETAIL "B"
SCALE: 1"=20'

MAP SHOWING THE OPENING OF MISSION BAY PARK P10

CITY AND COUNTY OF SAN FRANCISCO
DEPARTMENT OF PUBLIC WORKS
BUREAU OF STREET USE AND MAPPING

SCALE: 1" = 20'

REFERENCES:

BOOK DD OF SURVEY MAPS, PAGES 116-121
BOOK CC OF SURVEY MAPS, PAGES 123-131
BOOK Z OF SURVEY MAPS, PAGES 97-113

SHEET 2 OF 2 SHEET

A-17-173

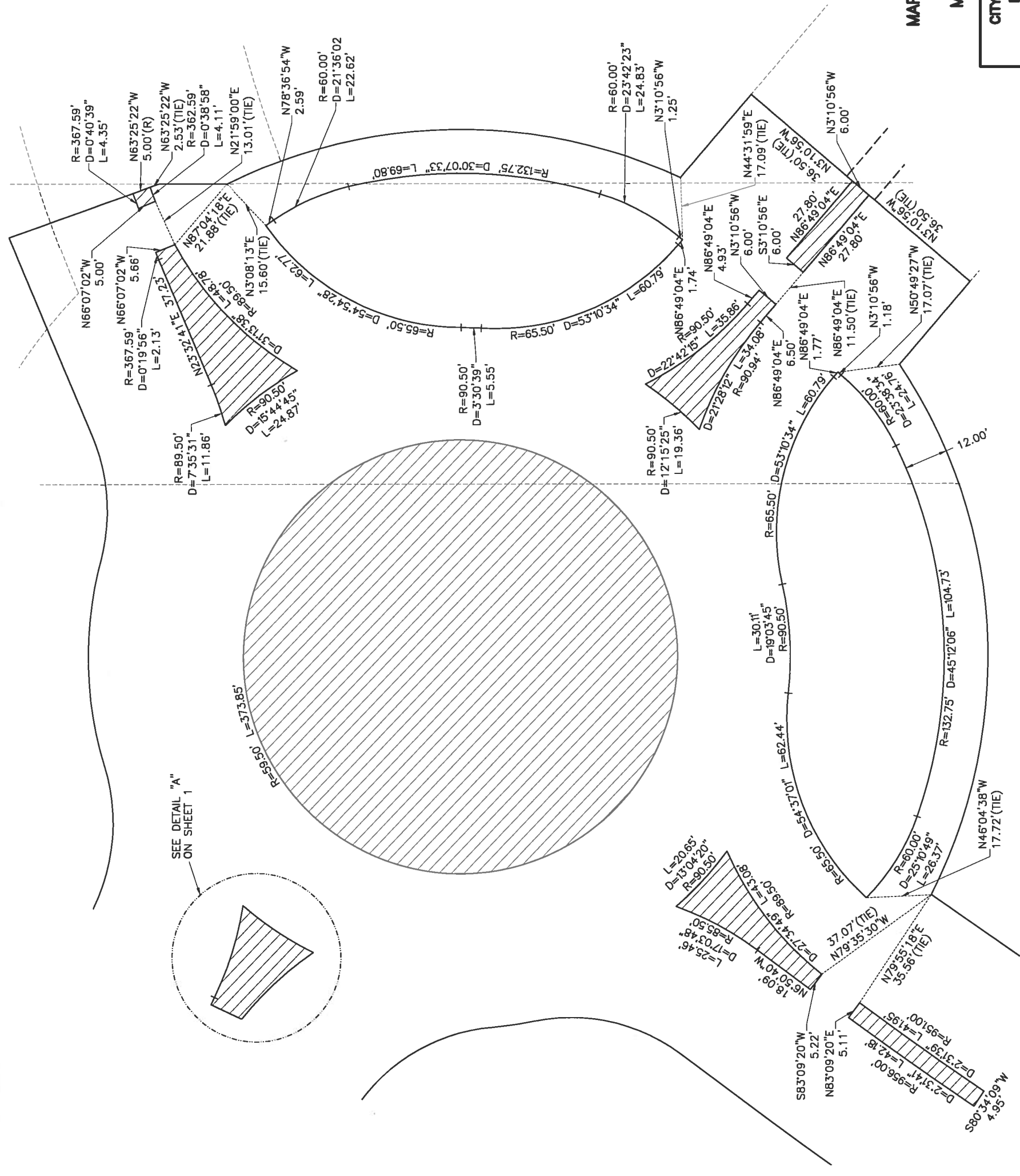

SEE DETAIL "A"
ON SHEET 1

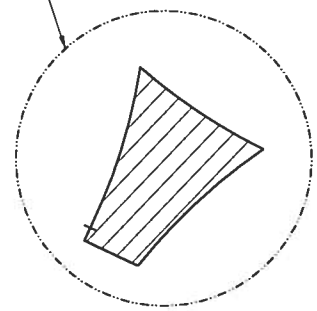

LEGEND
 AREA TO BE DEDICATED AS PARK P10 RIGHT-OF-WAY
 (R) RADIAL
 R RADIUS
 D DELTA
 L LENGTH