

LEGEND

(E) EXISTING FEATURE DIMENSION

P.O.B. POINT OF BEGINNING (SEE SHEET 4 FOR MAP CLOSURE INFO)

— PROPOSED CURB LINE

— EXISTING CURB LINE TO REMAIN

- - - EXISTING CURB LINE TO BE REMOVED

- - - RIGHT-OF-WAY LINE

*DRIVEWAY LOCATIONS AND WIDTHS ARE APPROXIMATE.

REFERENCES:

APPROVED:

Bruce R. Storrs

BRUCE R. STORRS
CITY & COUNTY SURVEYOR

3/27/12
DATE

BY	DATE
DRW	
CK	
APP	

CITY AND COUNTY OF SAN FRANCISCO
DEPARTMENT OF PUBLIC WORKS

OFFICIAL SIDEWALK CHANGE ON THE SOUTH SIDE OF CESAR CHAVEZ STREET
BETWEEN GUERRERO STREET AND VALENCIA STREET

SCALE: 1" = 40'

SHEET 1 OF 4

FILE Q-20-701

CHANGE

FILED: 2012 MAR 27 10:17 AM
 S.F. COUNTY CLERK
 150 CALIFORNIA STREET, SUITE 100
 SAN FRANCISCO, CA 94102

CALIFORNIA PACIFIC MEDICAL CENTER
SAINT LUKE'S CAMPUS

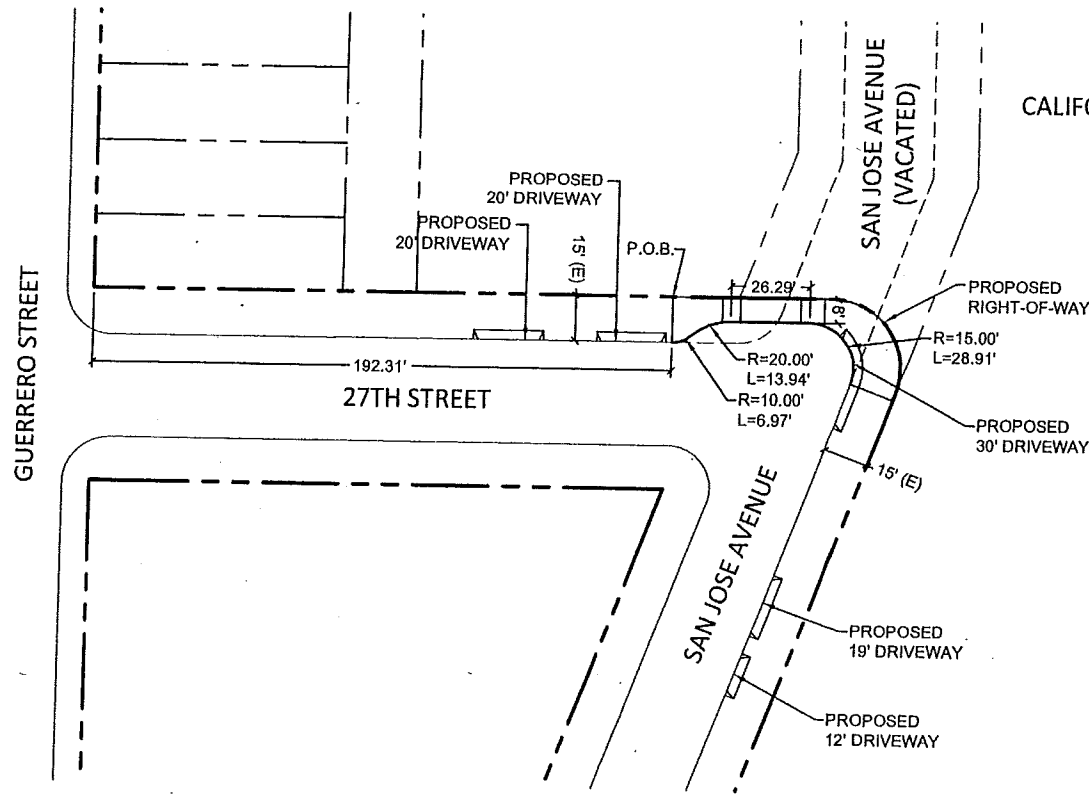

LEGEND

- (E) EXISTING FEATURE DIMENSION
- P.O.B. POINT OF BEGINNING (SEE SHEET 4 FOR MAP CLOSURE INFO)
- PROPOSED CURB LINE
- EXISTING CURB LINE TO REMAIN
- - - - EXISTING CURB LINE TO BE REMOVED
- - - - RIGHT-OF-WAY LINE

*DRIVEWAY LOCATIONS AND WIDTHS ARE APPROXIMATE.

REFERENCES:

APPROVED:

Bruce R. Storrs
BRUCE R. STORRS
CITY & COUNTY SURVEYOR

3/27/12
DATE

BY DATE

DRW
CK
APP

CITY AND COUNTY OF SAN FRANCISCO
DEPARTMENT OF PUBLIC WORKS

OFFICIAL SIDEWALK CHANGE ON THE NORTH SIDE OF 27TH STREET
AT THE INTERSECTION WITH SAN JOSE AVENUE

SCALE:
1" = 40'

SHEET
2 OF 4

FILE

Q-20-701

CHANGE

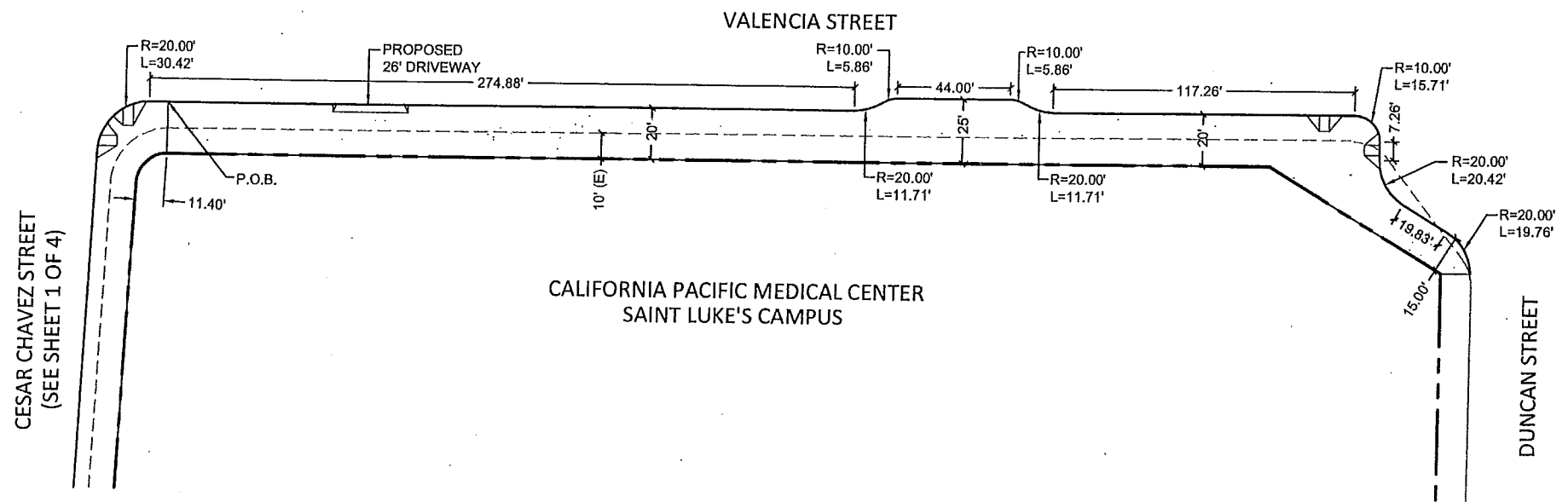

CALIFORNIA PACIFIC MEDICAL CENTER
SAINT LUKE'S CAMPUS

CESAR CHAVEZ STREET
(SEE SHEET 1 OF 4)

DUNCAN STREET

- LEGEND**
- (E) EXISTING FEATURE DIMENSION
 - P.O.B. POINT OF BEGINNING (SEE SHEET 4 FOR MAP CLOSURE INFO)
 - PROPOSED CURB LINE
 - EXISTING CURB LINE TO REMAIN
 - EXISTING CURB LINE TO BE REMOVED
 - ===== RIGHT-OF-WAY LINE

*DRIVEWAY LOCATIONS AND WIDTHS ARE APPROXIMATE.

REFERENCES:

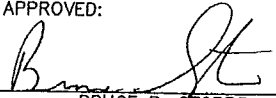
APPROVED:

 BRUCE R. STORRS
 CITY & COUNTY SURVEYOR

DATE: 3/27/12

BY	DATE
DRW	
CK	
APP	

CITY AND COUNTY OF SAN FRANCISCO
DEPARTMENT OF PUBLIC WORKS

OFFICIAL SIDEWALK CHANGE ON THE WEST SIDE OF VALENCIA STREET
BETWEEN CESAR CHAVEZ STREET AND DUNCAN STREET

SCALE: 1" = 40'	SHEET 3 OF 4	FILE Q-20-701	CHANGE
--------------------	-----------------	------------------	--------

K:\Engineering\76104\76104.dwg 28 Mar 2012 2:10:30pm

