

File No. 130509

Committee Item No. 18

Board Item No. 11

COMMITTEE/BOARD OF SUPERVISORS

AGENDA PACKET CONTENTS LIST

Committee: Land Use and Economic Development Date June 17, 2013

Board of Supervisors Meeting Date July 9, 2013

Cmte Board

- | | | |
|-------------------------------------|-------------------------------------|--|
| <input type="checkbox"/> | <input type="checkbox"/> | Motion |
| <input type="checkbox"/> | <input type="checkbox"/> | Resolution |
| <input checked="" type="checkbox"/> | <input checked="" type="checkbox"/> | Ordinance |
| <input checked="" type="checkbox"/> | <input checked="" type="checkbox"/> | Legislative Digest |
| <input type="checkbox"/> | <input type="checkbox"/> | Budget and Legislative Analyst Report |
| <input type="checkbox"/> | <input type="checkbox"/> | Youth Commission Report |
| <input type="checkbox"/> | <input type="checkbox"/> | Introduction Form |
| <input checked="" type="checkbox"/> | <input checked="" type="checkbox"/> | Department/Agency Cover Letter and/or Report |
| <input type="checkbox"/> | <input type="checkbox"/> | MOU |
| <input type="checkbox"/> | <input type="checkbox"/> | Grant Information Form |
| <input type="checkbox"/> | <input type="checkbox"/> | Grant Budget |
| <input type="checkbox"/> | <input type="checkbox"/> | Subcontract Budget |
| <input type="checkbox"/> | <input type="checkbox"/> | Contract/Agreement |
| <input type="checkbox"/> | <input type="checkbox"/> | Form 126 – Ethics Commission |
| <input type="checkbox"/> | <input type="checkbox"/> | Award Letter |
| <input type="checkbox"/> | <input type="checkbox"/> | Application |
| <input type="checkbox"/> | <input type="checkbox"/> | Public Correspondence |

OTHER (Use back side if additional space is needed)

- | | | |
|-------------------------------------|-------------------------------------|---|
| <input checked="" type="checkbox"/> | <input checked="" type="checkbox"/> | Maps |
| <input checked="" type="checkbox"/> | <input checked="" type="checkbox"/> | Planning Resolution 10082 |
| <input checked="" type="checkbox"/> | <input checked="" type="checkbox"/> | Planning Motion 10083 (see file 120357) |
| <input checked="" type="checkbox"/> | <input checked="" type="checkbox"/> | Notice |
| <input type="checkbox"/> | <input type="checkbox"/> | |
| <input type="checkbox"/> | <input type="checkbox"/> | |
| <input type="checkbox"/> | <input type="checkbox"/> | |
| <input type="checkbox"/> | <input type="checkbox"/> | |
| <input type="checkbox"/> | <input type="checkbox"/> | |
| <input type="checkbox"/> | <input type="checkbox"/> | |
| <input type="checkbox"/> | <input type="checkbox"/> | |
| <input type="checkbox"/> | <input type="checkbox"/> | |
| <input type="checkbox"/> | <input type="checkbox"/> | |

Completed by: Alisa Miller Date June 13, 2013
 Completed by: Alisa Miller Date June 20, 2013

82 16
1 [General Plan Maps - Urban Design Element and Van Ness Area Plan - California Pacific
2 Medical Center - Cathedral Hill Campus]

3 Ordinance amending the General Plan, Map 5 of the Urban Design Element, to reflect
4 the proposed maximum plan dimensions and maximum diagonal plan dimensions of
5 385 feet and 466 feet, respectively, for the Cathedral Hill Campus Hospital site and 265
6 feet and 290 feet, respectively, for the Cathedral Hill Campus Medical Office Building
7 site; Map 1 of the Van Ness Area Plan, to designate the sites of the proposed Cathedral
8 Hill Campus Hospital and Cathedral Hill Campus Medical Office Building as the Van
9 Ness Medical Use Subdistrict and increase the floor area ratio to 7.5:1 for the Cathedral
10 Hill Campus Medical Office Building site; Map 2 of the Van Ness Area Plan, to create a
11 230-V height/bulk district coterminous with the Hospital site; and adopting findings,
12 including environmental findings, Planning Code, Section 340, findings, and findings of
13 consistency with the General Plan and the priority policies of Planning Code, Section
14 101.1.

15 NOTE: Additions are single-underline italics Times New Roman;
16 deletions are ~~strike-through italics Times New Roman~~.
17 Board amendment additions are double-underlined;
18 Board amendment deletions are ~~strikethrough normal~~.

19 Be it ordained by the People of the City and County of San Francisco

20 Section 1. Findings. The Board of Supervisors of the City and County of San Francisco
21 hereby finds and determines that:

22 (a) Pursuant to San Francisco Charter Section 4.105 and Planning Code Section
23 340, any amendments to the General Plan shall first be considered by the Planning
24 Commission and thereafter recommended for approval or rejection by the Board of
25 Supervisors. On May 23, 2013, by Resolution No. 18882, the Commission conducted a

1 duly noticed public hearing on the General Plan Amendments pursuant to Planning Code
2 Section 340, found that the public necessity, convenience and general welfare require the
3 proposed General Plan Amendments, adopted the General Plan Amendments, and
4 recommended them for approval to the Board of Supervisors. A copy of Planning
5 Commission Resolution No. 18882 is on file with the Clerk of the Board of Supervisors in File
6 No. 130509, and the Board hereby incorporates those findings by reference.

7 (b) The Board finds that this ordinance is, on balance, in conformity with the priority
8 policies of Planning Code Section 101.1 and consistent with the General Plan as it is
9 proposed for amendment herein and in the related ordinances amending Maps 4 and 5 of the
10 General Plan Urban Design Element, and the Van Ness Area Plan to accommodate the Near-
11 Term Projects at the Cathedral Hill and St. Luke's Campuses described in California Pacific
12 Medical Center's Long Range Development Plan ("LRDP") (Ordinances No. _____ and
13 _____) for the reasons set forth in Planning Commission Motion No. 18883, and the
14 Board hereby incorporates these findings herein by reference.

15 (c) On April 26, 2012, by Motion No. 18588, the Planning Commission certified as
16 adequate, accurate and complete the Final Environmental Impact Report ("FEIR") for the
17 California Pacific Medical Center LRDP. On March 12, 2013, by adoption of Motion No. M13-
18 042, the Board of Supervisors affirmed the certification of the EIR and rejected the appeal of
19 Planning Commission Motion No. 18588. Copies of Planning Commission Motion No. 18588
20 and Board of Supervisors Motion No. M13-042 are on file with the Clerk of the Board of
21 Supervisors in File No. 120549 and 120550. In accordance with the actions contemplated
22 herein, this Board has reviewed the FEIR, and the FEIR Addendum for the revised CPMC
23 LRDP Project, and adopts and incorporates, as though fully set forth herein, the findings,
24 including a statement of overriding considerations and the mitigation monitoring and reporting
25 program, pursuant to the California Environmental Quality Act (California Public Resources

1 Code Section 21000 et seq.), adopted by the Planning Commission on May 23, 2013, in
2 Motion No. 18880. Said Motion is on file with the Clerk of the Board of Supervisors in File No.
3 120357.

4
5 Section 2. The Board of Supervisors hereby approves amendments to the General
6 Plan, as follows:

7 (a) Map 5 (Urban Design Guidelines for Bulk of Buildings) of the Urban Design
8 Element of the General Plan of the City and County of San Francisco shall be amended to
9 change the bulk limits for the site identified for the proposed Cathedral Hill Campus Hospital
10 (Block 0695/Lots 005, 006 and their successor Blocks and Lots) from a maximum plan
11 dimension of 110' and maximum diagonal plan dimension of 140' to a maximum plan
12 dimension of 385' and maximum diagonal plan dimension of 466', and to change the bulk
13 limits for the site identified for the proposed Cathedral Hill Campus Medical Office Building
14 (Block 0694/Lots 005, 006, 007, 008, 009, 009A, 010 and their successor Blocks and Lots)
15 from a maximum plan dimension of 110' and maximum diagonal plan dimension of 125' to a
16 maximum plan dimension of 265' and maximum diagonal plan dimension of 290'.

17 (b) Map 1 (Generalized Land Use and Density Plan) of the Van Ness Area Plan of
18 the General Plan of the City and County of San Francisco shall be amended to change the
19 Floor Area Ratio (FAR) of the site identified for a medical office building within the proposed
20 Van Ness Medical Use Subdistrict (Block 0694/Lots 005, 006, 007, 08, 009, 009A, 010 and
21 their successor Blocks and Lots) from 7.1:1 to 7.5:1 and to designate the sites identified for
22 the new hospital and medical office building as the "Van Ness Medical Use Subdistrict"; and

23 (c) Map 2 (Height and Bulk Districts) of the Van Ness Area Plan of the General Plan
24 of the City and County of San Francisco shall be amended to increase the maximum height of
25

1 the hospital site (Block 0695/Lots 005, 006 and their successor Blocks and Lots) from 130-V
2 to 230-V.

3
4 Section 3. This section is uncodified. Effective Date. This ordinance shall become
5 effective 30 days from the date of passage.
6

7
8 APPROVED AS TO FORM:
DENNIS J. HERRERA, City Attorney

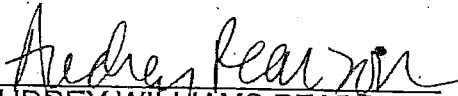
9
10 By: 
AUDREY WILLIAMS PEARSON
11 Deputy City Attorney

12 n:\speclas2013\1100299\00837993.doc
13
14
15
16
17
18
19
20
21
22
23
24
25

REVISED LEGISLATIVE DIGEST

(6/4/2013, Substituted)

[General Plan Maps - Urban Design Element and Van Ness Area Plan - California Pacific Medical Center - Cathedral Hill Campus]

Ordinance amending the General Plan, Map 5 of the Urban Design Element, to reflect the proposed maximum plan dimensions and maximum diagonal plan dimensions of 385 feet and 466 feet, respectively, for the Cathedral Hill Campus Hospital site and 265 feet and 290 feet, respectively, for the Cathedral Hill Campus Medical Office Building site; Map 1 of the Van Ness Area Plan, to designate the sites of the proposed Cathedral Hill Campus Hospital and Cathedral Hill Campus Medical Office Building as the Van Ness Medical Use Subdistrict and increase the floor area ratio to 7.5:1 for the Cathedral Hill Campus Medical Office Building site; Map 2 of the Van Ness Area Plan, to create a 230-V height/bulk district coterminous with the Hospital site; and adopting findings, including environmental findings, Planning Code, Section 340, findings, and findings of consistency with the General Plan and the priority policies of Planning Code, Section 101.1.

Existing Law

Currently, maps in the San Francisco General Plan Urban Design Element and Van Ness Area Plan proscribe certain limits to the height, bulk and floor area ratios for developments located near the intersection of Geary Street/Boulevard and Van Ness Avenue.

Amendments to Current Law

This Ordinance amends three maps in the San Francisco General Plan:

- 1) Urban Design Element Map 5, regulating the bulk of buildings, is amended to allow maximum dimensions and maximum plan dimensions of 385 feet and 466 feet (from 110' and 140') respectively for the site identified for the proposed Cathedral Hill Campus Hospital, and to allow a maximum plan dimension and maximum diagonal plan dimension of 265 feet and 290 feet (from 110' and 125') respectively, for the site proposed for the Cathedral Hill Campus Medical Office Building, on the block bounded by Van Ness Avenue, Geary Street, Cedar Street and just west of Polk Street.
- 2) Van Ness Area Plan Map 1 is amended to allow a floor area ratios of 7.5 to 1.1 (from 7.1 to 1) for the Cathedral Hill Campus Medical Office Building site, and to designate the sites for the hospital and office building as the "Van Ness Medical Use Subdistrict."
- 3) Van Ness Area Plan Map 2, governing height and bulk districts, is amended to allow a maximum height and bulk of 230-V (from 130-V) at the Cathedral Hill Campus Hospital site.

Background Information

This Ordinance is substitute legislation concerning California Pacific Medical Center's (CPMC) Long Range Development Plan ("LRDP"). This Ordinance substitutes for legislation originally introduced in April 2012. After introduction of the original legislation, CPMC revised its LRDP. The revised LRDP is described generally below. The proposed revisions from April 2012 include an increase in the size of the new hospital at the St. Luke's Campus (from 80 beds to 120 beds) and a decrease in the size of the new hospital at the Cathedral Hill Campus (from 555 beds to 274 – 304 beds).

CPMC currently operates four acute care medical centers in San Francisco: the California Campus, the Pacific Campus, the St. Luke's Campus, and the Davies Campus. As part of its program to meet state seismic readiness deadlines, CPMC's proposes a five campus system with three acute care hospitals – at Davies, St. Luke's, and a new hospital at the proposed Cathedral Hill Campus – providing approximately 692 licensed beds and three full-service emergency departments (one at each of the acute care hospitals). Once the proposed hospital is constructed at the Cathedral Hill Campus, the acute care services at the California and Pacific campuses will be transferred to the Cathedral Hill Hospital. The Pacific Campus's existing acute care hospital would undergo renovation and reuse as an ambulatory care center. CPMC would sell the California Campus after the transfer of acute care and non-acute care services to the Cathedral Hill and/or the Pacific Campus. In the near term, CPMC would also construct a new medical office building at Cathedral Hill, a new medical office building at Davies, and at St. Luke's, replace the existing hospital with a new 142-foot, 120 bed-hospital and construct a new medical office building. More details regarding the LRDP, including plans and renderings, can be found on the Planning Department's website at cpmc.sfplanning.org.

This ordinance concerns the proposed Cathedral Hill Campus at Van Ness Avenue and Geary Boulevard/Street. The Cathedral Hill Campus includes a new acute care hospital on the block bounded by Van Ness, Geary, Franklin and Post Streets, a new medical office building on the block bounded by Van Ness, Geary, Cedar and Polk Streets, and a pedestrian tunnel underneath Van Ness Avenue connecting the two facilities. Additional medical office space for the campus will be provided within the existing building at 1375 Sutter Street.

The proposed Cathedral Hill Hospital will be a 274 to 304-bed, 226' tall, 12-story, approximately 730,888 gross square foot acute care hospital with related hospital space, including 276 parking spaces on three underground levels. The proposed medical office building, across Van Ness Avenue, will be nine stories, approximately 130' tall, and will contain approximately 261,691 gross square feet of floor area and 542 off-street parking spaces on seven underground levels.

Among other approvals, the Cathedral Hill Campus will require ordinances to amend the San Francisco Planning Code and Zoning Map. CPMC also seeks approval of a development agreement with the City.

General Plan Van Ness Area Plan Map 1

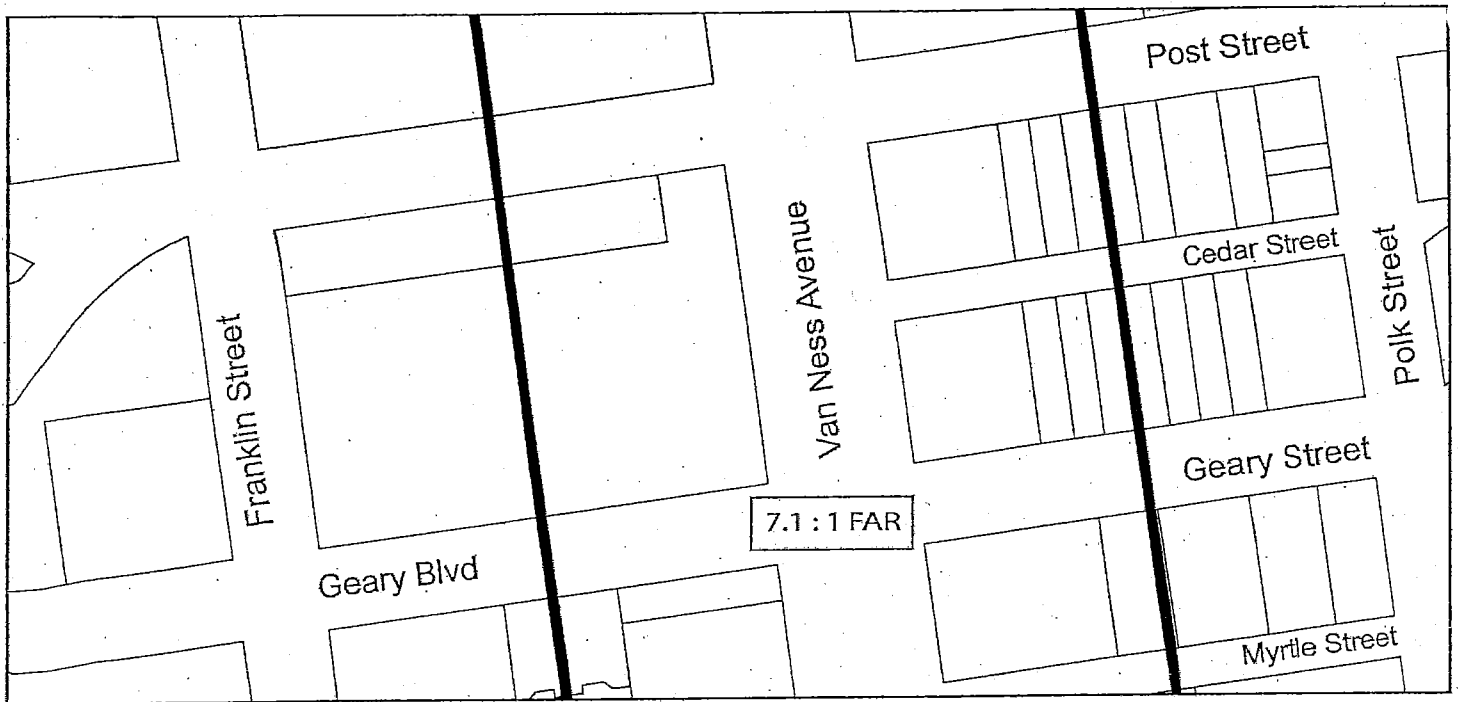

EXISTING

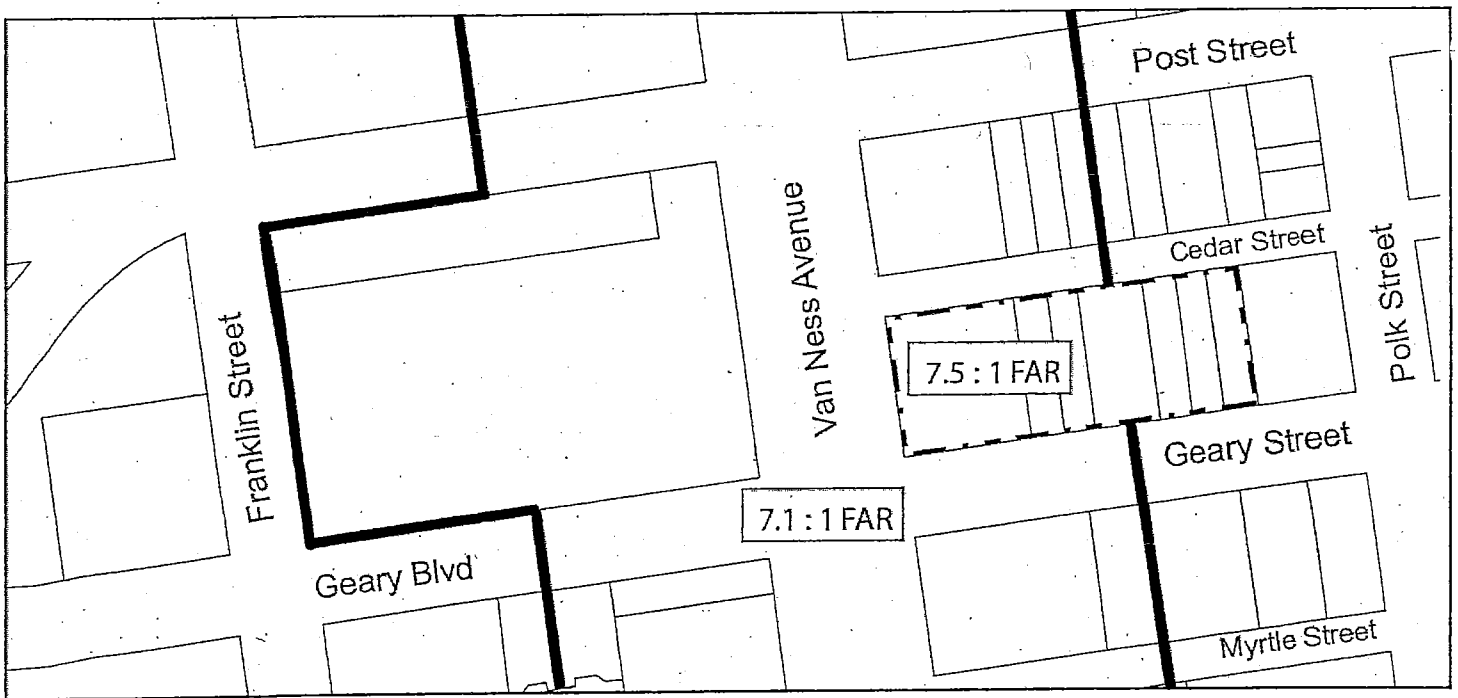

PROPOSED



General Plan Van Ness Area Plan Map 2

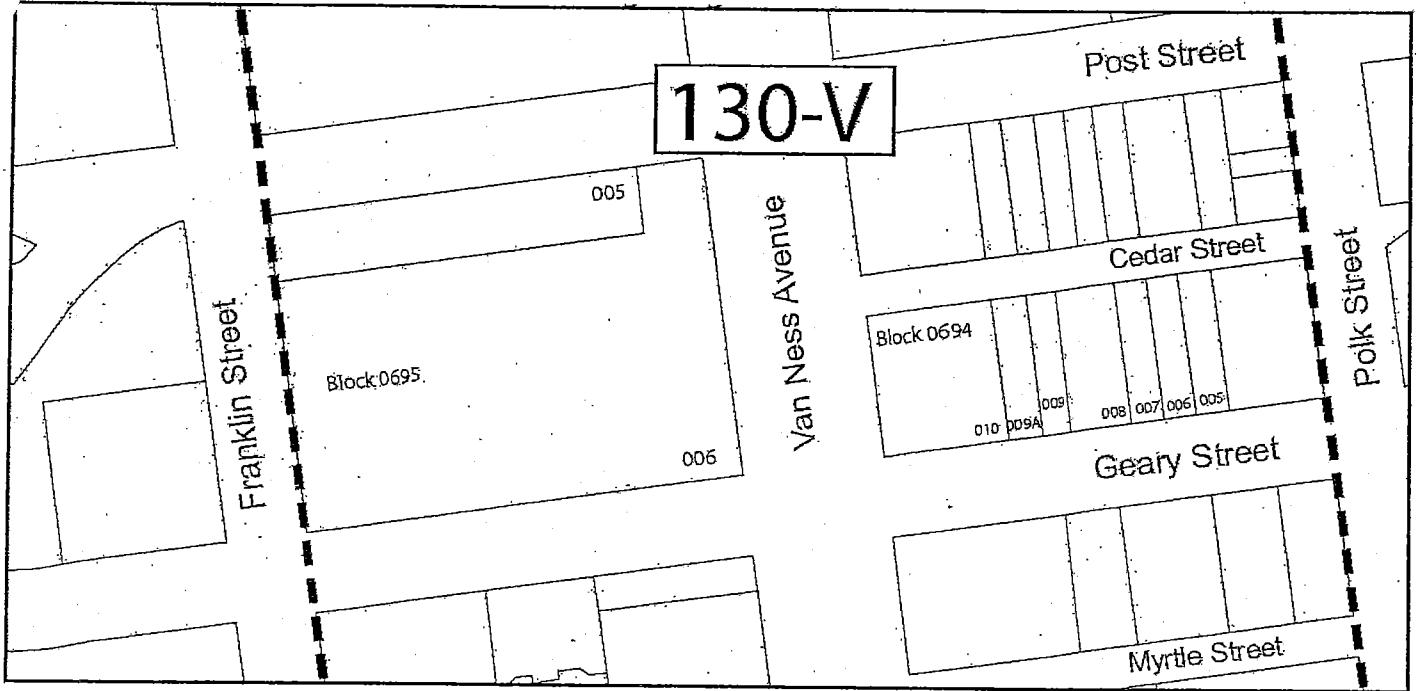

EXISTING

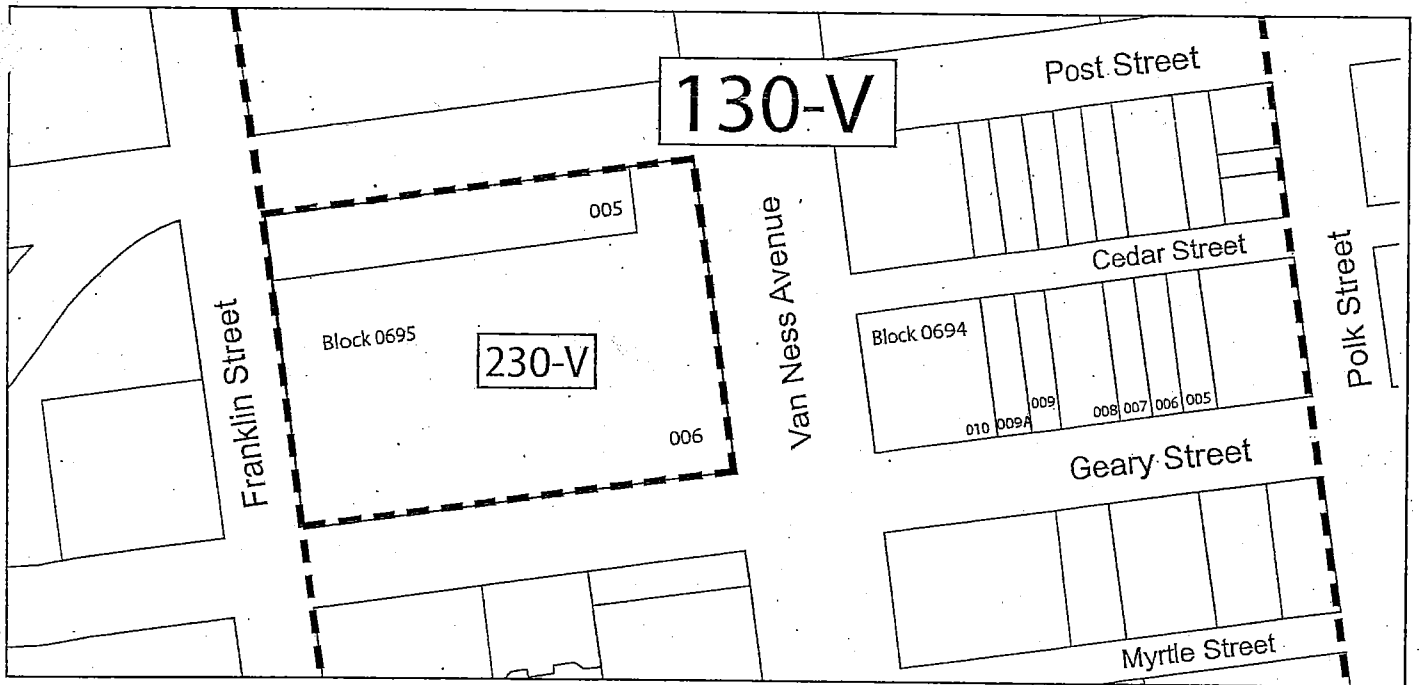

PROPOSED



General Plan Urban Design Element Map 5

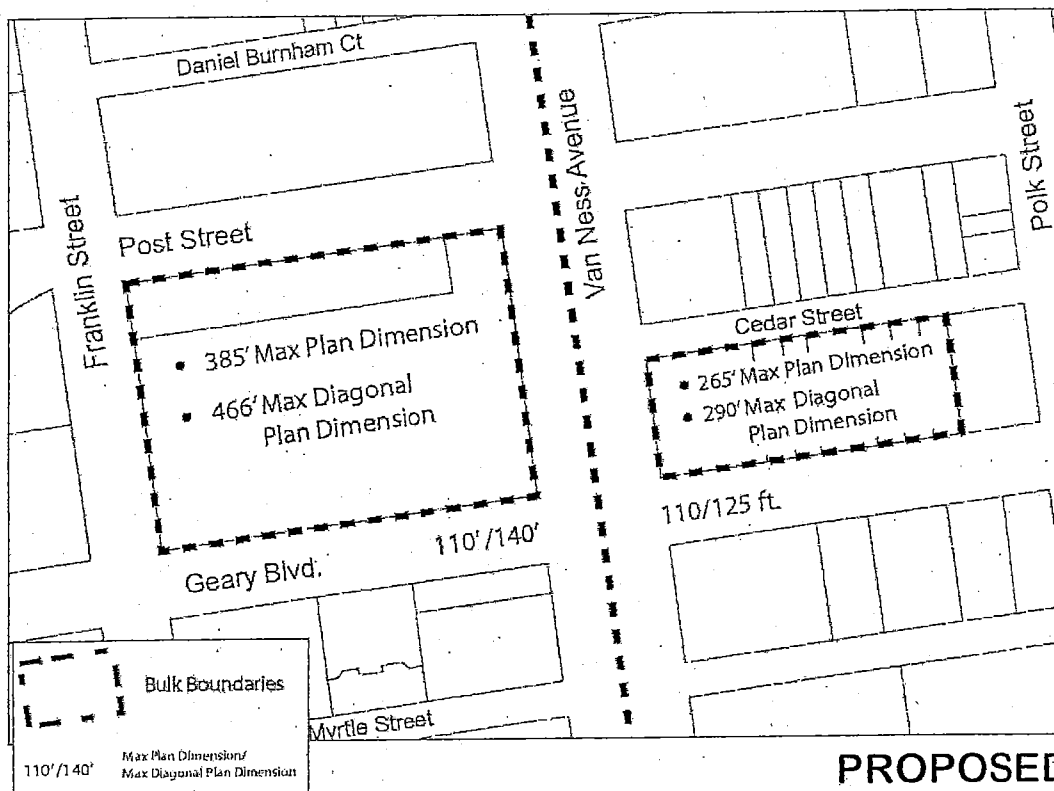
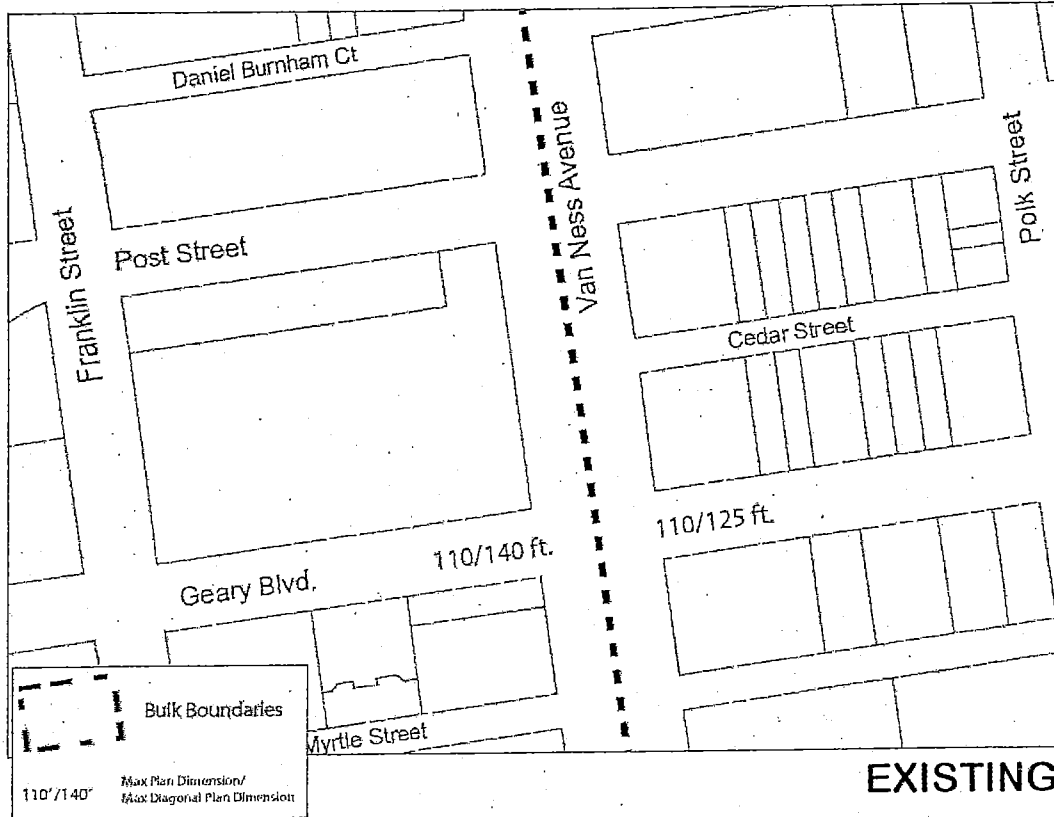



SAN FRANCISCO PLANNING DEPARTMENT

May 24, 2013

Ms. Angela Calvillo, Clerk
Board of Supervisors
City and County of San Francisco
City Hall, Room 244
1 Dr. Carlton B. Goodlett Place
San Francisco, CA 94102

1650 Mission St.
Suite 400
San Francisco,
CA 94103-2479

Reception:
415.558.6378

Fax
415.558.6409

Planning
Information:
415.558.6377

Re: Transmittal of Planning Department Case Numbers:
2009.0885MTZCBRSK, 2009.0886MTZCBRSK, 2012.0403W:
California Pacific Medical Center Long Range Development Plan Project

BOS File No.'s: 120357, 120358, 120359, 120360, 120366, plus *pending* General Plan
Amendment File No's _____ and _____.

Planning Commission Recommendation: Approval

Dear Ms. Calvillo,

Attached please find one original hardcopy plus this electronic transmittal of the proposed General Plan Amendment Ordinances, Planning Code Text Amendment Ordinances, Zoning Map Amendment Ordinances, and a Development Agreement Ordinance (collectively, the "Ordinances") for Board of Supervisors' approval. These Ordinances are associated with the California Pacific Medical Center Long Range Development Plan Project (hereinafter "CPMCLRDP Project"), which is a multi-phased development strategy to meet state seismic safety requirements for hospitals and to create a 20-year framework for CPMC's four existing medical campuses and for construction of a proposed new medical campus (the "Cathedral Hill Campus") in San Francisco. The proposed LRDP would facilitate the development of certain Near-Term Projects under the CPMC LRDP at CPMC's St. Luke's, Cathedral Hill, and Davies Campuses.

On April 5, 2012, the Planning Commission ("Commission") initiated General Plan amendments in connection with the CPMC LRDP Project. Mayor Lee introduced the Planning Code Text and Map Amendments proposed as part of CPMC's LRDP at the Board of Supervisors' hearing on April 10, 2012. On April 26, 2012, the Commission certified the Final EIR (FEIR) for the LRDP Project by Motion No. 18588, (affirmed by the Board of Supervisors in Motion M13-042), adopted CEQA findings, and adopted other Motions and Resolutions with respect to the LRDP Project. These approvals were forwarded to the Board on April 30, 2012. Thereafter, the Land Use and Economic Development Committee held several hearings on the Ordinances, and continued them to the call of the chair on July 16, 2012. On March 12, 2013, the Board adopted Resolution No. 77-13, endorsing a term sheet for a revised CPMC LRDP Project, which includes an increase in size of the new hospital at the St. Luke's Campus (from 80 to 120 beds), and a decrease in the size of the new hospital at the Cathedral Hill Campus (from 555 beds to 274-304 beds). The Resolution urged City staff to make the preparation of revised planning approval documents among its highest priorities and to present to the Planning Commission the revised documents and approvals necessary for the revised LRDP Project.

www.sfplanning.org

On April 16, 2013, the Board of Supervisors' denied the General Plan Amendments associated with CPMC's previous LRDP Project, so that they would not be deemed approved by operation of law, under Charter section 4.105.

On April 11, 2013, the Commission conducted a duly noticed public hearing at a regularly scheduled meeting to consider the initiation of the proposed General Plan Amendment Ordinances associated with CPMC's Revised LRDP Project.

On May 23, 2013, the Commission held a duly noticed public hearing and voted on various CPMC LRDP Project approvals, including recommending approval of the proposed Ordinances and approval with modifications to the draft Development Agreement. It is the Planning Department's understanding that the attached Ordinances amending the Planning Code, Zoning Map and the Development Agreement will be introduced as substitute legislation on June 4, 2013.

The proposed Ordinances include the following amendments:

General Plan Amendments

- Cathedral Hill Campus:

- (1) amend the text of the Van Ness Area Plan (VNAP) to support a high density medical center at the intersection of Van Ness Avenue and Geary Street/Boulevard that is consistent with the City's Better Streets Plan, and to reflect various elements of this use;
- (2) amend Map 1 of the VNAP to designate the sites proposed for the new Cathedral Hill Campus Hospital and Cathedral Hill Campus Medical Office Building ("MOB") as the "Van Ness Medical Use Subdistrict," and to increase the allowable Floor Area Ratio for the Cathedral Hill Campus MOB site from 7.1:1 to 7.5:1;
- (3) amend Map 2 of the VNAP to create a 230-V Height and Bulk District coterminous with the Cathedral Hill Campus Hospital site, in order to increase the height limit for the Cathedral Hill Campus Hospital site from 130' to 230'; and
- (4) amend Map 5 of the Urban Design Element to reflect the proposed bulk limits to be a maximum plan dimension and maximum diagonal plan dimension of 385' and 466', respectively, for the Hospital site, and 265' and 290', respectively, for the MOB site.

- St. Luke's Campus:

- (1) amend Map 4 of the Urban Design Element to reflect a maximum height of 145'-0" for the portion of the site where the proposed hospital tower will be located, and 105'-0", for the balance of the St. Luke's Campus; and
- (2) amend Map 5 of the Urban Design Element to reflect the proposed bulk limits to be a maximum plan dimension and maximum diagonal plan dimension of 229' and 285', respectively, for the Hospital site, and 204' and 228', respectively, for MOB site.

Planning Code Text Amendments

- Cathedral Hill Campus:

- (1) amend Planning Code Section 243, the Van Ness Special Use District, to create the Van Ness Medical Use Subdistrict, encompassing the sites of the proposed Cathedral Hill Campus Hospital, the Cathedral Hill Campus MOB, and the area where the proposed Van Ness Avenue pedestrian tunnel will be located, allow an FAR of up to 7.5:1 for the

Cathedral Hill MOB, and allow modification of various otherwise applicable standards within the Van Ness Medical Use Subdistrict; and

- (2) amend Section 124(d) to allow an FAR of up to 7.5:1 for the Cathedral Hill Campus MOB site.

- St. Luke's Campus:

- (1) add Section 249.68 to establish the Cesar Chavez/Valencia Streets Medical Use Special Use District and to allow and FAR of up to 2.6 to 1 therein; and
- (2) add a new subsection "k" to Section 124 to allow an FAR of up to 2.6:1.0 within the Cesar Chavez/Valencia Streets Medical Use SUD.

Planning Code Map Amendments

- Cathedral Hill Campus:

- (1) amend the Planning Code Zoning Map Sheet HT02 to reclassify the Cathedral Hill Campus Hospital site from 130-V to 230-V Height and Bulk District; and
- (2) amend the Planning Code Zoning Map Sheet SU02 to show the boundaries of the Van Ness Medical Use Subdistrict.

- St. Luke's Campus:

- (1) amend the Planning Code Zoning Map Sheet HT07 to reclassify the height and bulk district for the portion of the site where the St. Luke's Campus Hospital tower would be located to 145-E, and the balance of the Campus to 105-E; and
- (2) amend the Planning Code Zoning Map Sheet SU07 to show the boundaries of the Cesar Chavez/Valencia Streets Medical Use SUD.

The core elements of the proposed Development Agreement include the following:

- A secure future for St. Luke's – 120 bed acute care hospital with Centers of Excellence in Community and Senior Health, as well as comprehensive emergency services
- A continued level of Baseline Charity Care for San Francisco's most vulnerable populations for a period of 10 years. Over and above the Baseline Commitment, CPMC will be responsible for the healthcare services of 5,400 new Medi-Cal managed care beneficiaries for a period of 10 years
- Funding for a new Innovation Fund to support and improve the capacity of community clinics to increase their participation in managed Medi-Cal programs
- Protection of the City's Health Service System ("HSS) from premium increases by capping rates for 10 years
- Funding for affordable housing
- Funding for MTA transit facilities and service
- Funding for pedestrian safety and streetscape improvements
- Workforce requirements related to local hire for construction, job training programs, and the creation of career paths for San Franciscans

At the May 23, 2013 Planning Commission Hearing, the Planning Commission recommended the following changes to the Development Agreement:

- Eliminate the provision in Exhibit K, Item 9 of the Development Agreement, which requires the Cathedral Hill parking garage to close at 7 pm to persons who are not visitors, employees and staff of the Campus.
- Amend Section 4.2.1 in the form provided at the hearing by staff to provide for Delay Payment.
- Amend Section 8.2.2 to:
 - Provide notice to San Franciscans for Healthcare, Housing, Jobs, and Justice ("SFHHJJ"), the Community Advisory Groups required by the use permits for each CPMC Campus, and any other member of the public who wishes to receive notice of any of the following:
 - The Planning Department's receipt of CPMC's annual Compliance Statement;
 - The issuance of the "City Report"; and
 - Any formal requests to the Planning Department for Material Change or that is not a Material Change to the Development Agreement.
- To conform all language in the Development Agreement regarding entry level hiring to state that CPMC's hiring goals shall be to fill at least forty percent (40%) of Available Entry Level Positions with System Referrals.

In addition, at the May 23, 2013 Planning Commission Hearing, the Commission requested that the Board of Supervisors consider asking CPMC to either retain their existing in-patient psychiatric beds, or explore providing community-based psychiatric services through the Innovation Fund of the Development Agreement.

The following is a list of accompanying documents (one hard copy, plus electronic copy via email):

- Planning Commission Resolution No.'s 18880, 18881, 18882, 18883, 18884, 18885, 18886, 18887, 18888, 18889, 18890, 18891, 18892, 18893.
- Draft General Plan Amendments Ordinances: St. Luke's [Board File No. Pending ____] Cathedral Hill Campus [Board File No. Pending ____, ____] (originals delivered)

If you have any questions or require further information please do not hesitate to contact me at (415) 558-6395.

Sincerely,

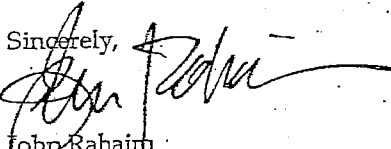
John Rahaim
Planning Director

cc:

Mayor's Office, Jason Elliot
Supervisor David Chiu
Supervisor Malia Cohen
Supervisor Scott Wiener
City Attorney, Audrey Pearson

SAN FRANCISCO
PLANNING DEPARTMENT



**SAN FRANCISCO
PLANNING DEPARTMENT**

Planning Commission Resolution No. 18882

**General Plan Amendment
HEARING DATE: MAY 23, 2013**

1650 Mission St.
Suite 400
San Francisco,
CA 94103-2479

Reception:
415.558.6378

Fax:
415.558.6409

Planning
Information:
415.558.6377

Date: May 9, 2013
Case No.: 2005.0555E; 2009.0885MTZCBRSK; 2012.0403W
Project Address: 1100, 1101 Van Ness Avenue; 1255 Post Street; 1020, 1028-1030, 1034-1036, 1040-1052, 1054-1060, 1062 Geary Street
Zoning/Ht. & Blk. RC-4/Van Ness Special Use District/130-V
Proposed Zoning/ Van Ness Special Use District, Van Ness Avenue Medical Use Subdistrict
Height & Bulk: 230-V (Hospital site), 130-V (MOB site)
Assessor's Block/Lot: 0695/005, 006; 0694/005, 006, 007, 008, 009, 009A, 010
Project Sponsor: Geoffrey Nelson, CPMC
 633 Folsom Street, 5th Floor
 San Francisco, CA 94107
 (415) 600-7206
NelsonGK@Sutterhealth.org
Staff Contact: Elizabeth Watty - (415) 558-6620
Elizabeth.Watty@sfgov.org

RECOMMENDING THAT THE BOARD OF SUPERVISORS ADOPT FINDINGS RELATING TO AMENDMENTS TO THE GENERAL PLAN TO: (1) AMEND THE TEXT OF THE VAN NESS AREA PLAN TO SUPPORT A HIGH DENSITY MEDICAL CENTER AT THE INTERSECTION OF VAN NESS AVENUE AND GEARY STREET/BOULEVARD THAT IS CONSISTENT WITH THE CITY'S BETTER STREETS PLAN AND REFLECT VARIOUS ELEMENTS OF THIS USE; (2) AMEND MAP 1 OF THE VAN NESS AREA PLAN ("VNAP") TO DESIGNATE THE SITES PROPOSED FOR THE NEW CATHEDRAL HILL CAMPUS HOSPITAL AND CATHEDRAL HILL MEDICAL OFFICE BUILDING ("MOB") AS "THE VAN NESS MEDICAL USE SUBDISTRICT", AND TO INCREASE THE ALLOWABLE FLOOR AREA RATIO ("FAR") FOR THE CATHEDRAL HILL CAMPUS MOB SITE FROM 7.1:1 TO 7.5:1; (3) AMEND MAP 2 OF THE VAN NESS AREA PLAN TO CREATE A 230-V HEIGHT AND BULK DISTRICT COTERMINOUS WITH THE HOSPITAL SITE, IN ORDER TO AMEND THE HEIGHT LIMIT FOR THE CATHEDRAL HILL CAMPUS HOSPITAL SITE FROM 130'-0" TO 230'-0"; AND (4) AMEND MAP 5 OF THE URBAN DESIGN ELEMENT TO REFLECT THE PROPOSED MAXIMUM PLAN AND MAXIMUM DIAGONAL PLAN DIMENSIONS OF 385'-0" AND 466'-0", RESPECTIVELY, FOR THE CATHEDRAL HILL CAMPUS HOSPITAL SITE, AND 265'-0" AND 290'-0", RESPECTIVELY, FOR THE CATHEDRAL HILL CAMPUS MOB SITE; AND MAKE AND ADOPT FINDINGS, INCLUDING FINDINGS UNDER PLANNING CODE SECTION 340, ENVIRONMENTAL FINDINGS AND FINDINGS OF CONSISTENCY WITH THE GENERAL PLAN AND THE EIGHT PRIORITY POLICIES OF PLANNING CODE SECTION 101.1. THIS MOTION SUPERSEDES IN ITS ENTIRETY RESOLUTION NO. 18591, APPROVED BY THE PLANNING COMMISSION ON APRIL 26, 2012.

PREAMBLE

On June 10, 2005, Ralph F. Marchese of The Marchese Company, Inc., acting on behalf of the California Pacific Medical Center (hereinafter referred to variously as "CPMC" and "Project Sponsor"), submitted an Environmental Evaluation Application ("EEA") with the Planning Department ("Department"), Case No. 2005.0555E¹. The Department issued a Notice of Preparation of Environmental Review on July 1, 2006, to owners of properties within 300 feet, adjacent tenants, and other potentially interested parties. However, as planning for the CPMC Long Range Development Plan ("LRDP") continued, additional components were added to the LRDP that resulted in a reissuance of a revised NOP for a 30-day public review period on May 27, 2009.

On July 21, 2010, the Draft Environmental Impact Report ("DEIR") for CPMC's LRDP Project, including the Cathedral Hill Campus Hospital and Medical Office Building ("MOB") Project, was prepared and published for public review, and was available for public comment until October 19, 2010.

On September 23, 2010, the Commission conducted a duly noticed public hearing at a regularly scheduled meeting to solicit comments regarding the DEIR. On March 29, 2012, the Department published a Comments and Responses document, responding to comments made regarding the DEIR prepared for the LRDP. Together, the Comments and Responses document, the DEIR, and any Errata Sheets, (the Appendices to the DEIR and C&R document), Department staff testimony and responses to questions and comments at the Commission's April 26, 2012, public hearing regarding certification of the Final EIR, and all of the supporting information that has been reviewed and considered by the Department, comprise the Final EIR for the LRDP ("FEIR").

On April 26, 2012, the Commission reviewed and considered the FEIR and found that the contents of said report and the procedures through which the FEIR was prepared, publicized, and reviewed complied with the California Environmental Quality Act (California Public Resources Code Sections 21000 *et seq.*) ("CEQA"), 14 California Code of Regulations Sections 15000 *et seq.* (the "CEQA Guidelines"), and Chapter 31 of the San Francisco Administrative Code ("Chapter 31").

The Commission found the FEIR was adequate, accurate and objective, reflected the independent analysis and judgment of the Department and the Commission, and that the summary of comments and responses contained no significant revisions to the DEIR, and certified the FEIR for the LRDP Project in compliance with CEQA, the CEQA Guidelines and Chapter 31.

Department staff prepared a Mitigation Monitoring and Reporting program ("MMRP") for the LRDP Project, which material was made available to the public and this Commission for this Commission's review, consideration and action.

On June 10, 2010, the Project Sponsor submitted a request, as modified by subsequent submittals, to the Department to amend the following sections of the General Plan: (1) the text of the Van Ness Area Plan to support a high density medical center at the intersection of Van Ness Avenue and Geary Boulevard that

¹ At the time of this application, the Cathedral Hill Campus Hospital site was within the boundaries, and was governed by the land use controls, of the Western Addition A-2 Plan. Those controls expired on January 1, 2009.

is consistent with the City's Better Streets Plan and reflect various elements of this use; (2) "Map 1 - Generalized Land Use and Density Plan" of the Van Ness Area Plan to designate the sites proposed for the new Cathedral Hill Campus Hospital and MOB as "The Van Ness Medical Use Subdistrict", and to increase the allowable floor area ratio ("FAR") for the Cathedral Hill Campus Hospital site from 7.1:1 to 9:1, and to increase the FAR for the Cathedral Hill Campus MOB site from 7.1:1 to 7.5:1; (3) "Map 2 - Height and Bulk Districts" of the Van Ness Area Plan to create a 265-V Height and Bulk District coterminous with the Hospital site, in order to amend the height limit for the Cathedral Hill Campus Hospital site from 130'-0" to 265'-0"; (4) "Map 4 - Height Map" of the Urban Design Element, to reflect a maximum height applicable to the Hospital site of 265'-0"; and (5) "Map 5 - Bulk Map" of the Urban Design Element, to reflect the proposed maximum plan and maximum diagonal plan dimensions of 385'-0" and 466'-0", respectively, for the Cathedral Hill Campus Hospital site, and 265'-0" and 290'-0", respectively, for the Cathedral Hill Campus MOB site (2009.0885M), with respect to a proposal to: (1) demolish the existing Cathedral Hill Hotel and 1255 Post Street office building (Assessor's Block/Lot 0695-005, 006) and construct a new, approximately 15 story, 555-bed, 875,378 gsf acute care hospital with 513 underground parking spaces at 1101 Van Ness Avenue; (2) demolish seven existing vacant residential and commercial buildings (Assessor's Blocks/Lots 0694-005, 0694-006, 0694-007, 0694-008, 0694-009, 0694-009A, 0694-010) and construct a new, approximately 261,691 gsf MOB with 542 underground parking spaces at 1100 Van Ness Avenue; (3) construct a pedestrian tunnel under Van Ness Avenue to connect the Cathedral Hill Campus Hospital to the Cathedral Hill Campus MOB; and (4) various streetscape, sidewalk, and landscape improvements surrounding the Campus (collectively, "Cathedral Hill Project"), within the RC-4 (Residential-Commercial, High Density) District, VNSUD, and 130-V Height and Bulk District.

On June 10, 2010, the Project Sponsor submitted a request, as modified by subsequent submittals, to the Department to amend the following sections of the San Francisco Planning Code: Section 243, the Van Ness Special Use District, to create a new Van Ness Medical Use Subdistrict, that would allow an FAR up to 9:1 for the Cathedral Hill Campus Hospital site and 7.5:1 for the Cathedral Hill Campus MOB site; allow modification of otherwise applicable standards for building projections to allow for coverage of drop-off and entry areas required by medical facilities; allow modification of otherwise applicable standards for obstructions over streets or alleys for vertical dimension and horizontal projections to allow architectural features that achieve appropriate articulation of building facades and that reduce pedestrian level wind currents; allow modification through Conditional Use Authorization of otherwise applicable standards for street frontage requirements as necessary for large-plate medical facilities on sloping sites with multiple frontages; allow modification through Conditional Use Authorization of otherwise applicable parking standards for medical centers, provided that the amount of parking shall not exceed 150% of the number of spaces otherwise allowed by the Planning Code; allow modification of otherwise applicable loading standards for medical centers; and to allow modification through Conditional Use Authorization of otherwise applicable bulk standards to allow for the unique massing requirements of medical facilities. (Case No. 2009.0885T).

On June 10, 2010, the Project Sponsor submitted a request, as modified by subsequent submittals, to the Department to amend the following Zoning Maps of the San Francisco Planning Code: (1) Map HT02 to reclassify the Cathedral Hill Campus Hospital site from 130-V to 265-V Height and Bulk District; and (2) Map SU02 to show the boundaries of the Van Ness Medical Use Subdistrict (Case No. 2009.0885Z).

On June 10, 2010, the Project Sponsor filed an application, as modified by subsequent submittals, with the Department for Conditional Use Authorization to allow (1) the Cathedral Hill Campus Hospital and Cathedral Hill Campus MOB as a medical center use within the RC-4 District and pursuant to the provisions for the Van Ness Special Use District ("VNSUD"); (2) allow construction of buildings over 50'-0" in an RC-4 District; (3) authorize demolition of five residential dwelling-units at the Cathedral Hill Campus MOB site; (4) modify standards for active ground floor uses and width of curb cuts; (5) provide an exception to allow wind speeds greater than 11 mph at certain sidewalk locations around the perimeter of the Campus; (6) modify the bulk limits applicable to the Cathedral Hill Campus Hospital and MOB sites; (7) modify the 3:1 residential to net new non-residential ratio requirement in the VNSUD, pursuant to Planning Code Sections 145.1, 209.3, 243, 253, 270, 271, 303, and 317.

On June 10, 2010, the Project Sponsor submitted a request, as modified by subsequent submittals, for the allocation of Office Space for approximately 242,987 sf of medical office space along with ancillary hospital and medical support service space on the upper floors of the proposed Cathedral Hill Campus MOB (Case No. 2009.0885B).

On April 28, 2011, the Project Sponsor submitted a request for a General Plan Referral, Case No. 2009.0885R, regarding construction of a tunnel that would connect the Cathedral Hill Campus Hospital and MOB sites below grade under Van Ness Avenue, installation of two diesel fuel tanks under the Geary Boulevard sidewalk at the Cathedral Hill Campus Hospital site; and sidewalk widening along various streets adjacent to the Campus (2009.0885R).

On March 30, 2012, the Project Sponsor submitted an Application for a Development Agreement relating to the construction and reconstruction of Health Care Facilities in furtherance of the CPMC's Long Range Development Plan by and between the City and County of San Francisco and CPMC, pursuant to Administrative Code Section 56.4. This Application was endorsed and accepted as complete by the Planning Director on April 4, 2012.

On April 5, 2012, the Commission conducted a duly noticed public hearing at a regularly scheduled meeting and adopted Resolution No. 18571, initiating the requested General Plan Amendments.

On April 10, 2012, the Mayor, at the Board of Supervisors hearing, introduced the (1) Planning Code Text Amendments in Board File No. 120357; (2) the Zoning Map Amendments in Board File No. 120359, (3) the street encroachment ordinance in Board File No. 120362, (4) the Development Agreement in Board File No. 120366, and (5) sidewalk width legislation in Board File No. 120364.

On April 26, 2012, by Motion No. 18588, the Commission certified as accurate, adequate and complete the FEIR for the LRDP Project, which includes the Cathedral Hill Campus Hospital and MOB Project. A copy of Commission Motion No. 18588 is in the file for Case No. 2005.0555E. Also on April 26, 2012, by Motion No. 18589, the Commission adopted findings, including a statement of overriding considerations, and an MMRP, pursuant to CEQA.

On April 26, 2012, the Planning Commission conducted a duly noticed public hearing at a regularly scheduled meeting and adopted: (1) Motion No. 18592, approving the General Plan and Planning Code Section 101.1 Findings; (2) Resolution No. 18597, recommending that the Board of Supervisors approve

the requested Planning Code Text Amendments and the requested Zoning Map Amendments; (3) Motion No. 18598, approving the Conditional Use Authorization; (4) Motion No. 18599, approving the Office Allocation; (5) Motion No. 18600, approving the General Plan Referral; and (6) Resolution No. 18602, recommending that the Board of Supervisors approve the Development Agreement.

On April 26, 2012, the Commission conducted a duly noticed public hearing at a regularly scheduled meeting on Case No. 2009.0885MTZCBRSK.

On May 16, 2012, an appeal of Planning Commission Motion No. 18588 certifying the FEIR was filed with the Board and the Board held a duly noticed public hearing July 17, 2012 to consider the appeal of the FEIR certification and on March 12, 2013, by adoption of Motion No. M13-042, the Board rejected the appeal and affirmed the decision of the Planning Commission to certify the FEIR and found the FEIR to be complete, adequate, and objective, and reflecting the independent judgment of the City in compliance with CEQA, the Guidelines and Chapter 31.

On June 15, June 25, July 9 and July 16, 2012, having received the Planning Commission's recommendations, a Land Use Committee of the Board held public hearings on the prior version of the project and draft development agreement and other draft approvals and thereafter, CPMC, working with City staff, proposed revisions to the project and to the draft development agreement and approvals.

On March 12, 2013, the Board adopted Resolution No. 77-13, endorsing a term sheet for a revised CPMC LRDP Project which includes an increase in size of the new hospital at the St. Luke's Campus (from 80 to 120 beds), and a decrease in the size of the new hospital-at the Cathedral Hill Campus (from 555 beds to 274-304 beds). The Resolution urged City staff to make the preparation of revised planning approval documents among its highest priorities and to present to the Planning Commission the revised documents and approvals necessary for the revised CPMC LRDP Project.

Staff subsequently worked with the project sponsor to identify revisions to the April 26, 2012, Planning Commission approvals to reflect the revised CPMC LRDP Project, including the following changes to the Cathedral Hill Campus Hospital site as compared to the original CPMC LRDP Project: decreased maximum height (from 265 feet to 230 feet), FAR (from 9.0:1 to 7.0:1) and parking spaces (513 to 276)².

On April 1, 2013, CPMC revised its EEA to reflect the revised CPMC LRDP Project, consistent with the term sheet endorsed by Board Resolution No. 77-13, including the revisions to the Cathedral Hill Campus Hospital described above.

On April 9, 2013, CPMC submitted a letter asking the Planning Department to modify the CPMC LRDP Project applications as required to reflect the term sheet endorsed by the Board.

² The project sponsor is considering the distribution of parking spaces among the Cathedral Hill parking garages, and the actual number of spaces per garage may vary, but will not exceed the lesser of 990 spaces or 125% of the Code minimum required number of spaces for the overall Cathedral Hill Campus.

On April 11, 2013, the Commission conducted a duly noticed public hearing at a regularly scheduled meeting and adopted Resolution No. 18844, initiating the requested General Plan Amendments for the revised CPMC LRDP Project.

On May 9, 2013, Department staff made available the Addendum to the FEIR for the revised CPMC LRDP Project ("Addendum"), an updated MMRP, and the revised approval documents for the revised CPMC LRDP Project, all as more particularly described in Motion No. 18880.

On May 23, 2013, the Commission conducted a duly noticed public hearing at a regularly scheduled meeting and adopted Resolution No. 18880, adopting CEQA findings, including a Statement of Overriding Considerations, and adopting an updated MMRP, and adopted other Motions and Resolutions with respect to the revised CPMC LRDP Project. In accordance with the actions contemplated herein, the Commission has reviewed the FEIR and the Addendum and adopts and incorporates by reference as though fully set forth herein the findings, including the statement of overriding considerations, pursuant to CEQA, adopted by the Commission on May 23, 2013, in Motion No. 18880.

The Planning Department, Jonas P. Ionin, is the custodian of records, located in the File for Case No. 2005.0555E, at 1650 Mission Street, Fourth Floor, San Francisco, California.

On May 23, 2013, the Commission conducted a duly noticed public hearing at a regularly scheduled meeting and adopted the following Motions and Resolutions superseding in their entirety the April 26, 2012 approvals: (1) Motion No. 18883, making findings of consistency with the General Plan and Planning Code Section 101.1; (2) Resolution No. 18888, recommending that the Board of Supervisors approve the requested Planning Code Text and Map Amendments; (3) Motion No. 18889 approving the Conditional Use Authorization; (4) Motion No. 18890, approving the allocation of the proposed office space; (5) Motion No. 18891 approving a General Plan Referral; and (6) Motion No. 18893, recommending that the Board of Supervisors approve the proposed revised draft Development Agreement; and

On May 23, 2013, the Commission conducted a duly noticed public hearing at a regularly scheduled meeting on General Plan Amendment Application No. 2009.0885MTZCBRSK.

The Planning Department, Jonas P. Ionin, is the custodian of records, located in the File for Case No. 2009.0885MTZCBRSK, at 1650 Mission Street, Fourth Floor, San Francisco, California.

The Commission has heard and considered the testimony presented to it at the public hearing and has further considered written materials and oral testimony presented on behalf of the applicant, Department staff, and other interested parties.

The Commission has reviewed the proposed General Plan Amendment Ordinances; and

MOVED, that the Commission hereby recommends that the Board of Supervisors approve the proposed General Plan Amendment Ordinances, and adopt the attached Resolution to that effect.

FINDINGS

Having reviewed the materials identified in the preamble above, and having heard all testimony and arguments, this Commission finds, concludes, and determines as follows:

1. The Commission finds the Cathedral Hill Project to be a beneficial development to the City that could not be accommodated without the actions requested.
2. CPMC has provided quality health care to the San Francisco community for over 150 years. It is the largest medical center in the City, and is presently responsible for about one-third of all hospitalizations, about one-half of all births in the City, about 40 percent of all patients receiving health services in the City and almost 40 percent of emergency visits. Each year CPMC cares for more than 75,000 persons in its emergency departments. The LRDP would ensure CPMC's continued existence and viability in San Francisco.
3. The existing acute care hospitals at the Pacific and California Campuses do not meet State seismic standards. Regardless of the State legal mandate, it is in the public interest that CPMC meet these seismic standards as soon as possible. These Ordinances, along with the Development Agreement and related approvals, achieve the objective of allowing CPMC's facilities to be rebuilt to meet the desired and legally mandated seismic standards, without any interruption in delivery of acute care services at the existing hospitals due to construction.
4. The Cathedral Hill Hotel and 1255 Post Street office building sites were selected for the location of a new acute care hospital because these aggregated parcels met CPMC's site selection objectives, including: (1) being available for sale; (2) being large enough to accommodate the co-location of acute care services from the California and Pacific Campuses; (3) preventing the interruption of existing services at the California and Pacific Campuses during the construction; (4) being located on geologically stable soil; (5) being at a major transit nexus; and (6) the availability of adjacent properties for the construction of a medical office building.
5. The General Plan was not created with the new construction of hospitals as a focused land use typology, and thus does not recognize the complexity, site and Building Code constraints, and health care delivery intricacies involved therein.
6. A number of conforming amendments to elements of the San Francisco General Plan, including General Plan maps, are required in order to resolve the aforementioned issues and facilitate the implementation of the CPMC LRDP.
7. The CPMC LRDP and its proposed amendments to the General Plan support the underlying goals of the General Plan, such as maintaining a sound and diverse economic base, providing expanded employment opportunities, promoting high quality urban design, enhancing San Francisco's position as a national and regional center for health services, and promoting adequate health services in all geographic districts.
8. CPMC's facilities, particularly if they are rebuilt to remain operational after an earthquake, are an essential part of the City's preparation for, and ability to respond to a disaster. If CPMC were not to build the new hospitals, the City would lose approximately one-third of all acute care beds, and three full-service emergency departments, one of which provides specialty pediatric emergency care.

9. Construction of the LRDP will double the number of earthquake safe beds in San Francisco, inject \$2 billion into the local economy, and create 1,500 high paying union construction jobs.
10. The LRDP would allow the City to retain CPMC as a substantial employer, employing over 6,000, of which about half are San Francisco residents. The LRDP would also permit the City to retain and enhance its domestic and international reputation as an education, training, and research center for medical services that benefit the residents of San Francisco. This benefits the City and its residents because it will attract patients, doctors and researchers to San Francisco.
11. Under the terms of the Development Agreement, CPMC would increase entry-level local construction employment and internship opportunities. CPMC would make good faith efforts to achieve 30% local hire measured by construction trade hours for the Near-Term Projects under the LRDP overall for each contractor, by each trade. CPMC would achieve 50% local hire for new entry-level administrative and engineering positions and internships, would fill half of all new apprentice positions with graduates from the CityBuild Academy, and would create and administer a structured program to advance apprentices from CityBuild Academy to journey-level status in their trade by the end of the Project. CPMC plans to hire at least 40% of all permanent entry-level hires annual for the term of the DA from the City's workforce system, targeting residents of the Western Addition, Tenderloin, Mission/SOMA, Outer Mission/Excelsior, Chinatown and Southeastern neighborhoods. CPMC would also provide \$4 million for community workforce services, which would provide grants to community-based organizations through the City's Office of Economic and Workforce Development for recruitment, training, and job retention services.
12. The Near-Term Projects will assure the availability of modern and high quality, general and specialized inpatient and out-patient, emergency and urgent health care to the residents of San Francisco, including seniors, Medicare, Medi-Cal, insured and un-insured.
13. The Near-Term Projects at the Cathedral Hill Campus will assure the availability of medical offices for physicians located near hospital facilities to serve the residents of San Francisco.
14. The new Cathedral Hill Campus Hospital would be a full-service, acute care hospital with an approximately 24,530 sf emergency department integrated into the CPMC city-wide system of care. It would provide critical services including inpatient medical care, Obstetrics/Gynecology, Medical/Surgical, Intensive Care, as well as specialized programs such as organ transplantation, interventional cardiology and newborn intensive care.
15. Emergency services, including psychiatric emergency care, would be provided at the St. Luke's, Davies and Cathedral Hill Campuses. These emergency departments serve patients regardless of ability to pay.
16. The 18 psychiatric inpatient beds in the mental health center on the Pacific Campus would remain in service.
17. Under the terms of the proposed Development Agreement, CPMC would commit to providing services to the poor and underserved, including traditional charity care, hospital care for additional Medi-Cal managed care beneficiaries enrolled in the San Francisco Health Plan, unpaid costs and other benefits for the poor and underserved. Specifically, CPMC would commit to:

- a. Two new, seismically-safe hospitals, at the St. Luke's and Cathedral Hill campuses;
 - b. A secure future for St. Luke's hospital;
 - c. Significantly increased provision of healthcare for low-income and underserved San Franciscans, including hospital care for 5,400 additional Medi-Cal beneficiaries, and caring for a baseline of about 30,000 unduplicated Medi-Cal or charity care patients plus \$8 million in community benefits annually; and
 - d. \$9 million endowment by CPMC of a new Community Care Innovation Fund, to support the services of community clinics and other social service organizations.
18. Under the terms of the proposed Development Agreement, CPMC would provide additional funding to the City, including:
- a. \$5 million in funding for the proposed Van Ness and Geary BRT projects;
 - b. \$6.5 million transit fee to MTA to help alleviate transit delay and meet new demands on the transit system associated with the new Cathedral Hill Campus;
 - c. A surcharge on parking at the new Cathedral Hill Campus of \$0.50 off-peak and \$0.75 peak for each entry and exit to provide an estimated \$300,000 per year of additional funding to MTA for a period of 10 years;
 - d. \$4.25 million in funding for pedestrian safety and public realm improvements in the Tenderloin, including pedestrian-scale lighting, sidewalk widening and changing one-way streets to two-way;
 - e. \$1.55 million in funding for transit and safety improvements in the neighborhoods surrounding the Cathedral Hill Campus;
 - f. \$400,000 in funding to MTA for studies regarding improvements to bicycle facilities around and between the proposed new CPMC facilities;
 - g. \$200,000 grant for the Safe Passage Pilot Program in the Tenderloin;
 - h. A series of pedestrian safety improvements around the Davies Campus, valued at approximately \$475,000;
 - i. A series of pedestrian safety improvements around the St. Luke's Campus, valued at approximately \$3,300,000;
 - j. A contribution of \$3 million for enforcement and traffic safety measures around the Pacific and California Campuses.
19. The LRDP will be constructed at no cost to the City, and will provide substantial direct and indirect economic benefits to the City;
20. The LRDP is necessary and desirable, is compatible with the surrounding neighborhoods, and would not be detrimental to persons or adjacent properties in the vicinity;
21. The General Plan Amendments are necessary in order to approve the CPMC LRDP Project;
22. **General Plan Compliance.** The Cathedral Hill Project is, on balance, consistent with the Objectives and Policies of the General Plan, as outlined in Motion No. 18883.

23. Planning Code Section 101.1(b) establishes eight priority-planning policies and requires review of permits for consistency with said policies. On balance, the Cathedral Hill Project complies with said policies, as outlined in Motion No. 18883.
24. The Cathedral Hill Project is consistent with and would promote the general and specific purposes of the Code provided under Section 101.1(b) as outlined in Motion No. 18883 and also in that, as designed, the Cathedral Hill Project would contribute to the healthcare delivery and emergency services in San Francisco, include substantial economic benefits to the City during both the construction and operational phases, provide substantial other public benefits as outlined in the proposed Development Agreement, and be compatible with the character and stability of the neighborhood, thereby constituting a beneficial development.
25. Based on the foregoing, the public necessity, convenience and general welfare require the proposed General Plan amendments.

I hereby certify that the Planning Commission ADOPTED the foregoing Resolution on May 23, 2013.

Jonas P. Ionin
Acting Commission Secretary

AYES: Commissioners Antonini, Borden, Fong, Hillis, Moore, Sugaya, Wu

NAYS:

ABSENT:

ADOPTED: May 23, 2013



SAN FRANCISCO PLANNING DEPARTMENT

see
File 120357



Planning Commission Motion No. 18883 GENERAL PLAN FINDINGS

PLANNING CODE SECTION 101.1 FINDINGS

HEARING DATE: MAY 23, 2013

1650 Mission St.
Suite 400
San Francisco,
CA 94103-2479

Reception:
415.558.6378

Fax:
415.558.6409

Planning
Information:
415.558.6377

Date: May 9, 2013
Project Name: California Pacific Medical Center Long Range Development Plan
Case Numbers: 2005.0555E; 2009.0886MTZCBRKS;
 2009.0885MTZCBRKS; 2004.0603C; 2012.0403W
Initiated by: Geoffrey Nelson, CPMC
 633 Folsom Street, 5th Floor
 San Francisco, CA 94107
 (415) 600-7206
NelsonGK@Sutterhealth.org
Staff Contact: Elizabeth Watty, Planner
Elizabeth.Watty@sfgov.org, 415-558-6620
Recommendation: Adopt General Plan/Planning Code 101.1 Consistency Findings

ADOPTING FINDINGS OF CONSISTENCY WITH THE SAN FRANCISCO GENERAL PLAN AND PLANNING CODE SECTION 101.1 FOR THE CALIFORNIA PACIFIC MEDICAL CENTER'S REVISED LONG RANGE DEVELOPMENT PLAN TO ALLOW THE IMPLEMENTATION OF THE NEAR-TERM PROJECTS AND THE LEGISLATION ASSOCIATED THEREWITH, ALONG WITH THE DEVELOPMENT AGREEMENT ("PROJECT"), AT THE CATHEDRAL HILL CAMPUS (ASSESSOR'S BLOCKS-LOTS: 0690-016, 0694-005, 0694-006, 0694-007, 0694-008, 0694-009, 0694-009A, 0694-010, 0695-005, 0695-006); St. LUKE'S CAMPUS (ASSESSOR'S BLOCKS-LOTS 6575/001, 002; 6576/021 AND A PORTION OF SAN JOSE AVENUE BETWEEN CESAR CHAVEZ STREET AND 27TH STREET) AND THE DAVIES CAMPUS (ASSESSOR'S BLOCK-LOTS 3539-001), AND INCLUDING ENVIRONMENTAL FINDINGS. THIS MOTION SUPERSEDES IN ITS ENTIRETY MOTION NO. 18592 ADOPTED BY THE PLANNING COMMISSION ON APRIL 26, 2012.

PREAMBLE

The CPMC Long Range Development Plan ("LRDP") is a multi-phased development strategy to meet state seismic safety requirements for hospitals mandated originally in 1994 by Senate Bill ("SB") 1953 as modified through successor legislation, and to create a 20-year framework for CPMC's four existing medical campuses and for construction of a proposed new medical campus in San Francisco.

The four existing CPMC medical campuses are the St. Luke's Campus in the Mission District, Pacific Campus in the Pacific Heights area, the California Campus in the Presidio Heights area, and the Davies Campus in the Duboce Triangle area. The proposed new medical campus is the Cathedral Hill Campus located along Van Ness Avenue in the vicinity of the intersection of Van Ness Avenue and Geary Boulevard/Geary Street.

**PLEASE FIND
ALL PUBLIC CORRESPONDENCE**

related to the

**California Pacific Medical Center
Long Range Development**

(File Nos. 120357-120366, and 130508-130510)

in

File No. 120357

BOARD of SUPERVISORS



City Hall
1 Dr. Carlton B. Goodlett Place, Room 244
San Francisco 94102-4689
Tel. No. 554-5184
Fax No. 554-5163
TDD/TTY No. 554-5227

NOTICE OF PUBLIC HEARING

BOARD OF SUPERVISORS OF THE CITY AND COUNTY OF SAN FRANCISCO LAND USE AND ECONOMIC DEVELOPMENT COMMITTEE

NOTICE IS HEREBY GIVEN THAT the Land Use and Economic Development Committee will hold a public hearing to consider the following proposals, which the Planning Commission recommended for approval on May 23, 2013, and said public hearing will be held as follows, at which time all interested parties may attend and be heard:

Date: Monday, June 17, 2013

Time: 1:30 P.M.

Location: Committee Room 263, located at City Hall
1 Dr. Carlton B. Goodlett Place, San Francisco, CA

Subject: CALIFORNIA PACIFIC MEDICAL CENTER LONG RANGE
DEVELOPMENT PLAN

120357 Planning Code - Maximum Floor Area Ratios - Van Ness Medical Use Subdistrict
Within the Van Ness Special Use District - California Pacific Medical Center:
Cathedral Hill Campus

Ordinance amending the Planning Code, Section 124, to allow a floor area ratio of 7.5:1 for a medical office building within the Van Ness Special Use District, Medical Use Subdistrict; amending Section 243 to include the establishment of the Van Ness Medical Use Subdistrict and associated controls; and adopting findings, including environmental findings, Planning Code, Section 302, findings, and findings of consistency with the General Plan and the priority policies of Planning Code, Section 101.1.

120358 Planning Code - Maximum Permitted Floor Area Ratio - Cesar Chavez/Valencia
Streets Medical Use Special Use District - California Pacific Medical Center: St.
Luke's Campus

Ordinance amending the Planning Code, by adding Section 124(l), to allow a floor area ratio of 2.6 to 1 in the Cesar Chavez/Valencia Streets Medical Use Special Use District; adding Section 249.68 to establish the Cesar Chavez/Valencia Streets Medical Use Special Use District; and adopting findings, including environmental findings, Planning Code, Section 302, findings, and findings of consistency with the General Plan and the priority policies of Planning Code Section 101.1.

120359 Zoning Map - California Pacific Medical Center: Cathedral Hill Campus

Ordinance amending the Planning Code, Zoning Map, Sectional Maps SU02 and HT02, to reflect the creation of the Van Ness Medical Use Subdistrict (Assessor's Block No. 0695/Lot Nos. 005 and 006, and Block No. 0694/Lot Nos. 005, 006, 007, 008, 009, 009A, and 010); allow an increase in height at Assessor's Block No. 0695/Lot Nos. 005, and 006, in order to allow for a new seismically safe hospital; and adopting findings, including environmental findings, Section 302, findings, and findings of consistency with the General Plan and the priority policies of Planning Code, Section 101.1.

120360 Zoning Map - California Pacific Medical Center: St. Luke's Campus

Ordinance amending the Planning Code, Zoning Map, Sectional Maps SU07 and HT07, to reflect the creation of the Cesar Chavez/Valencia Streets Medical Use Special Use District at the California Pacific Medical Center's St. Luke's Campus (Assessor's Block No. 6575/Lot Nos. 001 and 002; Block No. 6576/Lot No. 021, and a portion of San Jose Avenue between Cesar Chavez and 27th Streets); to allow increased heights in the western portion of the California Pacific Medical Center's St. Luke's Campus (all of Assessor's Block No. 6575, Block No. 6576/Lot No. 21, and a portion of San Jose Avenue between Cesar Chavez and 27th Streets) in order to allow for a new seismically safe replacement hospital; and adopting findings, including environmental findings, Section 302, findings, and findings of consistency with the General Plan and the priority policies of Planning Code, Section 101.1.

120361 Summary Street Vacation - Portion of San Jose Avenue Between 27th Street and Cesar Chavez Street - California Pacific Medical Center: St. Luke's Campus

Ordinance ordering the summary street vacation of a portion of San Jose Avenue, between 27th Street and Cesar Chavez Street, as shown on Department of Public Works SUR Map No. 2012-001, dated May 14, 2012; rescinding an existing encroachment permit; making findings pursuant to the California Streets and Highways Code, Chapter 4, Sections 8330 et seq; adopting environmental findings pursuant to the California Environmental Quality Act, and findings that the actions contemplated herein are consistent with the General Plan and the eight priority policies of Planning Code, Section 101.1; and authorizing official acts in connection with this Ordinance.

120362 Street Encroachments - Van Ness Avenue, Cedar Street, and Geary Boulevard - California Pacific Medical Center: Cathedral Hill Campus

Resolution granting revocable permission to the California Pacific Medical Center to occupy a portion of the public right-of-way on Van Ness Avenue, in order to construct and maintain a pedestrian tunnel under Van Ness Avenue (State Highway 101), to connect the new medical office building and the new hospital located at 1100 and 1101 Van Ness Avenue, respectively; to construct and maintain off-site improvements on the north side of Cedar Street, between Van Ness Avenue and Polk Street, across the street from the medical office building and on the south side of Cedar Street contiguous to the property at 1001 Polk Street (Assessor's Block No. 0694, Lot No. 004), including reconstructing and widening the existing sidewalk, installing new landscaping and reconstructing the existing roadway with pavers; and to install and maintain two 30,000 gallon diesel fuel tanks within the public right of way under Geary Boulevard, between Franklin Street and Van Ness Avenue, in order to serve the hospital at 1101 Van Ness Avenue; and making environmental findings, and findings of consistency with the General Plan and the priority policies of Planning Code, Section 101.1.

120363 Land Transfer Agreement - Sale of a Portion of San Jose Avenue Between 27th Street and Cesar Chavez Street - Sutter West Bay Hospitals - California Pacific Medical Center: St. Luke's Campus

Resolution authorizing the Director of Property to execute a land transfer agreement with Sutter West Bay Hospitals, doing business as California Pacific Medical Center (CPMC), for the future conveyance by the City and County of San Francisco to CPMC of real property consisting of a portion of San Jose Avenue between 27th Street and Cesar Chavez Street; and making findings, including findings under the California Environmental Quality Act, and findings of consistency with the General Plan and Planning Code, Section 101.1.

120364 Changing the Official Sidewalk Widths - Portions of Post Street, Geary Boulevard, Geary Street, Cedar Street, and Van Ness Avenue - California Pacific Medical Center: Cathedral Hill Campus

Ordinance amending Ordinance No. 1061, entitled "Regulating the Width of Sidewalks," by adding thereto Section 1596, to change the official sidewalk width of: the southerly side of Post Street, starting at the southeast intersection with Franklin Street, continuing east to the southwest intersection with Van Ness Avenue; the northerly side of Geary Boulevard, starting at the northeast intersection with Franklin Street, continuing east to the northwest intersection with Van Ness Avenue; the northerly side of Geary Street, starting at the northeast intersection of Van Ness Avenue, continuing east 325 feet; both sides of Cedar Street, starting at the intersection with Van Ness Avenue, continuing east to the intersection with Polk Street; the westerly side of Van Ness Avenue, starting at the intersection with Geary Boulevard, continuing north to the intersection with Post Street; and the easterly side of Van Ness Avenue, starting at the intersection with Geary Street, continuing north to the intersection with Cedar Street; making environmental findings and findings pursuant to the General Plan and Planning Code, Section 101.1; and requiring relocation, modification, or both of facilities affected by the sidewalk width change.

120365 Changing the Official Sidewalk Widths - Portions of Cesar Chavez Street, Valencia Street and 27th Street - California Pacific Medical Center: St. Luke's Campus

Ordinance amending Ordinance No. 1061, entitled "Regulating the Width of Sidewalks," by adding thereto Section 1591, to change the official sidewalk width of: the southerly side of Cesar Chavez Street, starting at the southeast intersection with Guerrero Street, continuing east to the southwest intersection with Valencia Street; the westerly side of Valencia Street, starting at the southwest intersection with Cesar Chavez Street, continuing south to the northwest intersection with Duncan Street; and the northern portion of 27th Street, starting at the intersection of 27th Street and San Jose Avenue, continuing west for 44.24 feet; making environmental findings, and findings pursuant to the General Plan and Planning Code, Section 101.1; and requiring relocation, modification, or both of facilities affected by the sidewalk width change.

120366 Development Agreement - Sutter West Bay Hospitals - California Pacific Medical Center

Ordinance approving a Development Agreement between the City and County of San Francisco and Sutter West Bay Hospitals, for certain real property associated with the California Pacific Medical Center Long Range Development Plan located at various locations in the City and County of San Francisco and generally referred to as the St. Luke's Campus, Cathedral Hill (Van Ness and Geary) Campus, Davies Campus, Pacific Campus and California Campus; making findings under the California Environmental Quality Act, findings of conformity with the General Plan and the eight priority policies of Planning Code, Section 101.1(b); and waiving certain provisions of Administrative Code, Chapter 56, and ratifying certain actions taken in connection therewith.

130508 General Plan - Van Ness Area Plan - California Pacific Medical Center - Cathedral Hill Campus

Ordinance amending the General Plan, Van Ness Area Plan, in order to facilitate the development of a high density medical center at the transit nexus of Van Ness Avenue and Geary Boulevard, and reflect various elements of this use; and adopting findings, including environmental findings, Planning Code, Section 340, findings, and findings of consistency with the General Plan and the priority policies of Planning Code, Section 101.1.

130509 General Plan Maps - Urban Design Element and Van Ness Area Plan - California Pacific Medical Center - Cathedral Hill Campus

Ordinance amending the General Plan, Map 5 of the Urban Design Element, to reflect the proposed maximum plan dimensions and maximum diagonal plan dimensions of 385 feet and 466 feet, respectively, for the Cathedral Hill Campus Hospital site and 265 feet and 290 feet, respectively, for the Cathedral Hill Campus Medical Office Building site; Map 1 of the Van Ness Area Plan, to designate the sites of the proposed Cathedral Hill Campus Hospital and Cathedral Hill Campus Medical Office Building as the Van Ness Medical Use Subdistrict and increase the floor area ratio to 7.5:1 for the Cathedral Hill Campus Medical Office Building site; and Map 2 of the Van Ness Area Plan, to create a 230-V height/bulk district coterminous with the Hospital site; and adopting findings, including environmental findings, Planning Code, Section 340, findings, and findings of consistency with the General Plan and the priority policies of Planning Code, Section 101.1.

130510 General Plan Maps - Urban Design Element - California Pacific Medical Center's St. Luke's Campus

Ordinance amending the General Plan, Map 4 of the Urban Design Element, to increase the height limit for the California Pacific Medical Center's St. Luke's Campus, Assessor's Block No. 6575, Lot No. 001-002, and Block No. 6576, Lot.021, and the portion of San Jose Avenue between Cesar Chavez Street and Twenty Seventh Street to 145 feet for a portion of the St. Luke's Campus Hospital site where the hospital tower will be located, and 105 feet for the balance of the Campus; and Map 5 of the Urban Design Element, to reflect the proposed maximum plan dimensions and maximum diagonal plan dimensions of 229 feet and 285 feet, respectively, for the St. Luke's Campus Hospital site and 204 feet and 228 feet, respectively, for the St. Luke's Medical Office Building site; and adopting findings, including environmental findings, Section 340, findings, and findings of consistency with the General Plan and the priority policies of Planning Code, Section 101.1.

In accordance with Section 67.7-1 of the San Francisco Administrative Code, persons who are unable to attend the hearing on this matter may submit written comments to the City prior to the time the hearing begins. These comments will be made a part of the official public record in this matter, and shall be brought to the attention of the Members of the Committee. Written comments should be addressed to Angela Calvillo, Clerk of the Board, Room 244, City Hall, 1 Dr. Carlton Goodlett Place, San Francisco, CA 94102. Information relating to this matter is available in the Office of the Clerk of the Board and agenda information relating to this matter will be available for public review on Friday, June 14, 2013.

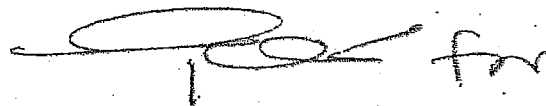

Angela Calvillo, Clerk of the Board

DATED: June 4, 2013
PUBLISHED/MAILED/POSTED: June 7, 2013

AdTech New Order



- Home
- New Order
- Copy Order
- Order Lookup
- Order Tracking
- Open [0]
- Ready [0]
- Sent [2]
- Newspapers
- Accounting
- Reports
- Help

Your Order is sent.

Customer Information

Customer Name	S.F. BD OF SUPERVISORS (NON-CONSECUTIVE)	Master Id	52704
Address	1 DR CARLTON B GOODLETT PL #244	Phone	4155547704
City	SAN FRANCISCO	Fax	4155547714
State - Zip	CA - 94102		

Product Information

Legal GOVERNMENT - GOVT PUBLIC NOTICE

Order Information

Attention Name Alisa Miller **Billing Reference No.** **Save**

Ad Description AM - 06.17.13 Land Use - CPMC Hearing **Sale/Hrg/Bid Date**

Special Instructions

Orders Created

Order No.	Newspaper Name	Publishing Dates	Ad	Price Description	Price	Ad Status
2494946	SAN FRANCISCO CHRONICLE-CITY&CO. 10%, CA Billed To: S.F. BD OF SUPERVISORS (OFFICIAL NOTICES) Created For: S.F. BD OF SUPERVISORS (OFFICIAL NOTICES)	06/07/2013	Depth : 16.60" Lines : 205	\$ No Pricing Formula for 2175		Pricing will be done by DJC Sent

Order No.	Newspaper	View
2494946	SAN FRANCISCO CHRONICLE-CITY&CO. 10%	View Ad In PDF

NOTICE OF PUBLIC HEARING
BOARD OF SUPERVISORS OF THE CITY AND COUNTY
OF SAN FRANCISCO
LAND USE AND ECONOMIC DEVELOPMENT
COMMITTEE
MONDAY, JUNE 17, 2013 - 1:30 PM
COMMITTEE ROOM 263, CITY HALL
1 DR. CARLTON B. GOODLETT PLACE, SAN
FRANCISCO, CA

NOTICE IS HEREBY GIVEN THAT the Land Use and Economic Development Committee will hold a public hearing to consider the following proposals regarding the **CALIFORNIA PACIFIC MEDICAL CENTER LONG RANGE DEVELOPMENT PLAN**, which the Planning Commission

recommended for approval on May 23, 2013, and said public hearing will be held as follows; at which time all interested parties may attend and be heard. **120357:** Planning Code - Maximum Floor Area Ratios - Van Ness Medical Use Subdistrict Within the Van Ness Special Use District - California. **120358:** Planning Code - Maximum Permitted Floor Area Ratio - Cesar Chavez/Valencia Streets Medical Use Special Use District - California Pacific Medical Center: St. Luke's Campus. **120359:** Ordinance amending the Planning Code, Zoning Map, Sectional Maps SU02 and HT02, to reflect the creation of the Van Ness Medical Use Subdistrict (Assessor's Block No. 0695/Lot Nos. 005 and 006, and Block No. 0694/Lot Nos. 005, 006, 007, 008, 009, 009A, and 010); allow an increase in height at Assessor's Block No. 0695/Lot Nos. 005, and 006, in order to allow for a new seismically safe hospital; and adopting findings, including environmental findings, Section 302, findings, and findings of consistency with the General Plan and the priority policies of Planning Code, Section 101.1. **120360:** Ordinance amending the Planning Code, Zoning Map, Sectional Maps SU07 and HT07, to reflect the creation of the Cesar Chavez/Valencia Streets Medical Use Special Use District at the California Pacific Medical Center's St. Luke's Campus (Assessor's Block No. 6575/Lot Nos. 001 and 002, Block No. 6576/Lot No. 021, and a portion of San Jose Avenue between Cesar Chavez and 27th Streets); to allow increased heights in the western portion of the California Pacific Medical Center's St. Luke's Campus (all of Assessor's Block No. 6575, Block No. 6576/Lot No. 21, and a portion of San Jose Avenue between Cesar Chavez and 27th Streets) in order to allow for a new seismically safe replacement hospital; and adopting findings, including environmental findings, Section 302, findings, and findings of consistency with the General Plan and the priority policies of Planning Code, Section 101.1. **120361:** Summary Street Vacation - Portion of San Jose Avenue Between 27th Street and Cesar Chavez Street - California Pacific Medical Center: St. Luke's Campus. **120362:** Street Encroachments - Van Ness Avenue, Cedar Street, and Geary Boulevard - California Pacific Medical Center: Cathedral Hill Campus. **120363:** Resolution authorizing the Director of Property to execute a land transfer agreement with Sutter West Bay Hospitals, doing business as California Pacific Medical Center (CPMC), for the future conveyance by the City and County of San Francisco to CPMC of real property consisting of a portion of San Jose Avenue between 27th Street and Cesar Chavez Street; and making findings, including findings under the California Environmental Quality Act, and findings of consistency with the General Plan and Planning Code, Section 101.1. **120364:** Changing the Official Sidewalk Widths - Portions of Post Street, Geary Boulevard, Geary

Street, Cedar Street, Franklin Street, and Van Ness Avenue - California Pacific Medical Center: Cathedral Hill Campus.

120365: Changing the Official Sidewalk Widths - Portions of Cesar Chavez Street, Valencia Street and 27th Street - California Pacific Medical Center: St. Luke's Campus.

120366: Ordinance approving a Development Agreement between the City and County of San Francisco and Sutter West Bay Hospitals, for certain real property associated with the California Pacific Medical Center Long Range Development Plan located at various locations in the City and County of San Francisco and generally referred to as the St. Luke's Campus, Cathedral Hill (Van Ness and Geary) Campus, Davies Campus, Pacific Campus and California Campus; making findings under the California Environmental Quality Act, findings of conformity with the General Plan and the eight priority policies of Planning Code, Section 101.1(b); and waiving certain provisions of Administrative Code, Chapter 56, and ratifying certain actions taken in connection therewith.

130508: Ordinance amending the General Plan, Van Ness Area Plan, in order to facilitate the development of a high density medical center at the transit nexus of Van Ness Avenue and Geary Boulevard, and reflect various elements of this use; and adopting findings, including environmental findings, Planning Code, Section 340, findings, and findings of consistency with the General Plan and the priority policies of Planning Code, Section 101.1.

130509: Ordinance amending the General Plan, Map 5 of the Urban Design Element, to reflect the proposed maximum plan dimensions and maximum diagonal plan dimensions of 385 feet and 466 feet, respectively, for the Cathedral Hill Campus Hospital site and 265 feet and 290 feet, respectively, for the Cathedral Hill Campus Medical Office Building site; Map 1 of the Van Ness Area Plan, to designate the sites of the proposed Cathedral Hill Campus Hospital and Cathedral Hill Campus Medical Office Building as the Van Ness Medical Use Subdistrict; and Map 2 of the Van Ness Area Plan, to create a 230-V height/bulk district coterminous with the Hospital site; and adopting findings, including environmental findings, Planning Code, Section 340, findings, and findings of consistency with the General Plan and the priority policies of Planning Code, Section 101.1.

130510: Ordinance amending the General Plan, Map 4 of the Urban Design Element, to increase the height limit for the California Pacific Medical Center's St. Luke's Campus, Assessor's Block No. 6575, Lot No. 001-002, and Block No. 6576, Lot 021, and the portion of San Jose Avenue between Cesar Chavez Street and Twenty Seventh Street to 145 feet for a portion of the St. Luke's Campus Hospital site where the hospital tower will be located, and 105 feet for the balance of the Campus; and Map 5 of the Urban Design Element, to reflect the proposed

maximum plan dimensions and maximum diagonal plan dimensions of 229 feet and 285 feet, respectively, for the St. Luke's Campus Hospital site and 204 feet and 228 feet, respectively, for the St. Luke's Medical Office Building site; and adopting findings, including environmental findings, Section 340, findings, and findings of consistency with the General Plan and the priority policies of Planning Code, Section 101.1.

In accordance with Section 67.7-1 of the San Francisco Administrative Code, persons who are unable to attend the hearing on this matter may submit written comments to the City prior to the time the hearing begins. These comments will be made a part of the official public record in this matter, and shall be brought to the attention of the Members of the Committee. Written comments should be addressed to Angela Calvillo, Clerk of the Board, Room 244, City Hall, 1 Dr. Carlton Goodlett Place, San Francisco, CA 94102. Information relating to this matter is available in the Office of the Clerk of the Board and agenda information relating to this matter will be available for public review on Friday, June 14, 2013.

Angela Calvillo, Clerk of the Board

Miller, Alisa

From: glenda_sobrique@dailyjournal.com
Sent: Wednesday, June 05, 2013 10:47 AM
To: Miller, Alisa
Subject: Confirmation of Order 2494946 for AM - 06.17.13 Land Use - CPMC Hearing

Dear Customer:

The order listed below has been received and processed. If you have any questions regarding this order, please contact your ad coordinator or the phone number listed below.

Customer Account Number: 120503
Type of Notice : GPN - GOVT PUBLIC NOTICE
Ad Description : AM - 06.17.13 Land Use - CPMC Hearing
Our Order Number : 2494946
Newspaper : SAN FRANCISCO CHRONICLE-CITY&CO. 10%
Publication Date(s) : 06/07/2013

Thank you for using the Daily Journal Corporation.

GLENDASOBRIQUE
DAILY JOURNAL CORPORATION
CALIFORNIA NEWSPAPER SERVICE BUREAU
915 E. FIRST ST., LOS ANGELES, CA 90012
Phone: (800) 788 7840 / (213)229-5300
Fax: (800) 540 4089 / (213)229-5481

CALIFORNIA NEWSPAPER SERVICE BUREAU

DAILY JOURNAL CORPORATION

Mailing Address : 915 E FIRST ST, LOS ANGELES, CA 90012
Telephone (213) 229-5300 / Fax (213) 229-5481
Visit us @ WWW.LEGALADSTORE.COM

Alisa Miller
S.F. BD OF SUPERVISORS (OFFICIAL NOTICES)
1 DR CARLTON B GOODLETT PL #244
SAN FRANCISCO, CA 94102

CNS 2494946

COPY OF NOTICE

Notice Type: GPN GOVT PUBLIC NOTICE
Ad Description AM - 06.17.13 Land Use - CPMC Hearing

To the right is a copy of the notice you sent to us for publication in the SAN FRANCISCO CHRONICLE. Please read this notice carefully and call us with any corrections. The Proof of Publication will be filed with the Clerk of the Board. Publication date(s) for this notice is (are):

06/07/2013

Daily Journal Corporation
Serving your legal advertising needs throughout California. Call your local

- BUSINESS JOURNAL, RIVERSIDE (951) 784-0111
DAILY COMMERCE, LOS ANGELES (213) 229-5300
LOS ANGELES DAILY JOURNAL, LOS ANGELES (213) 229-5300
ORANGE COUNTY REPORTER, SANTA ANA (714) 543-2027
SAN DIEGO COMMERCE, SAN DIEGO (619) 232-3486
SAN FRANCISCO DAILY JOURNAL, SAN FRANCISCO (800) 640-4829
SAN JOSE POST-RECORD, SAN JOSE (408) 287-4866
THE DAILY RECORDER, SACRAMENTO (916) 444-2355
THE INTER-CITY EXPRESS, OAKLAND (510) 272-4747

NOTICE OF PUBLIC HEARING
BOARD OF SUPERVISORS
OF THE CITY AND COUNTY
OF SAN FRANCISCO
LAND USE AND ECONOMIC
DEVELOPMENT COMMITTEE
MONDAY, JUNE 17, 2013 - 1:30 PM
COMMITTEE ROOM 263, CITY HALL
1 DR. CARLTON B. GOODLETT
PLACE, SAN FRANCISCO, CA
NOTICE IS HEREBY GIVEN THAT the
Land Use and Economic Development
Committee will hold a public hearing to
consider the following proposals regard-
ing the CALIFORNIA PACIFIC MEDI-
CAL CENTER LONG RANGE DEVEL-
OPMENT PLAN, which the Planning
Commission recommended for approval
on May 23, 2013, and said public hear-
ing will be held as follows, at which time
all interested parties may attend and be
heard. 120357: Planning Code - Maxi-
mum Floor Area Ratios - Van Ness
Medical Use Subdistrict Within the Van
Ness Special Use District - California
Pacific Medical Center: Cathedral Hill
Campus. 120358: Planning Code -
Maximum Permitted Floor Area Ratio -
Cesar Chavez/Valencia Streets Medical
Use Special Use District - California Pa-
cific Medical Center: St. Luke's Campus.
120359: Ordinance amending the Plan-
ning Code, Zoning Map, Sectional Maps
SU02 and HT02, to reflect the creation
of the Van Ness Medical Use Subdistrict
(Assessor's Block No. 0695/Lot Nos.
005 and 006, and Block No. 0694/Lot
Nos. 005, 006, 007, 008, 009, 009A,
and 010); allow an increase in height at
Assessor's Block No. 0695/Lot Nos.
005, and 006, in order to allow for a new
seismically safe hospital; and adopting
findings, including environmental find-
ings, Section 302, findings, and findings
of consistency with the General Plan
and the priority policies of Planning
Code, Section 101.1. 120360: Ordinance
amending the Planning Code, Zoning
Map, Sectional Maps SU07 and HT07
to reflect the creation of the Cesar
Chavez/Valencia Streets Medical
Use Special Use District at the Califor-
nia Pacific Medical Center's St. Luke's
Campus (Assessor's Block No. 6575/Lot
Nos. 001 and 002, Block No. 6576/Lot
No. 021, and a portion of San Jose
Avenue between Cesar Chavez and
27th Streets); to allow increased heights
in the western portion of the California
Pacific Medical Center's St. Luke's
Campus (all of Assessor's Block No.
6575, Block No. 6576/Lot No. 21, and a
portion of San Jose Avenue between
Cesar Chavez and 27th Streets) in order
to allow for a new seismically safe re-
placement hospital; and adopting find-
ings, including environmental findings,
Section 302, findings, and findings of
consistency with the General Plan and
the priority policies of Planning Code,
Section 101.1. 120361: Summary Street
Vacation - Portion of San Jose Avenue
between 27th Street and Cesar Chavez
Street - California Pacific Medical Cen-
ter: St. Luke's Campus. 120362: Street
Encroachments - Van Ness Avenue,
Cedar Street, and Geary Boulevard -
California Pacific Medical Center: Ca-
thedral Hill Campus. 120363: Resolution
authorizing the Director of Property to
execute a land transfer agreement with

Sutter West Bay Hospitals, doing busi-
ness as California Pacific Medical Cen-
ter (CPMC), for the future conveyance
by the City and County of San Francisco
to CPMC of real property consisting of a
portion of San Jose Avenue between
27th Street and Cesar Chavez Street;
and making findings, including findings
under the California Environmental
Quality Act, and findings of consistency
with the General Plan and Planning
Code, Section 101.1. 120364: Changing
the Official Sidewalk Widths - Portions
of Post Street, Geary Boulevard, Geary
Street, Cedar Street, and Van Ness
Avenue - California Pacific Medical Cen-
ter: Cathedral Hill Campus.
120365: Changing the Official Sidewalk
Widths - Portions of Cesar Chavez
Street, Valencia Street and 27th Street -
California Pacific Medical Center: St.
Luke's Campus. 120366: Ordinance ap-
proving a Development Agreement be-
tween the City and County of San Fran-
cisco and Sutter West Bay Hospitals, for
certain real property associated with the
California Pacific Medical Center Long
Range Development Plan located at
various locations in the City and County
of San Francisco and generally referred
to as the St. Luke's Campus, Cathedral
Hill (Van Ness and Geary) Campus, Da-
vies Campus, Pacific Campus and Cali-
fornia Campus; making findings under
the California Environmental Quality Act,
findings of conformity with the General
Plan and the eight priority policies of
Planning Code, Section 101.1(b); and
waiving certain provisions of Administra-
tive Code, Chapter 56, and ratifying cer-
tain actions taken in connection
therewith.
130508: Ordinance amending the Gen-
eral Plan, Van Ness Area Plan, in order
to facilitate the development of a high
density medical center at the transit
nexus of Van Ness Avenue and Geary
Boulevard, and reflect various elements
of this use; and adopting findings, in-
cluding environmental findings, Planning
Code, Section 340, findings, and find-
ings of consistency with the General
Plan and the priority policies of Planning
Code, Section 101.1.
130509: Ordinance amending the Gen-
eral Plan, Map 5 of the Urban Design
Element, to reflect the proposed maxi-
mum plan dimensions and maximum di-
agonal plan dimensions of 385 feet and
465 feet, respectively, for the Cathedral
Hill Campus Hospital site and 265 feet
and 290 feet, respectively, for the Ca-
thedral Hill Campus Medical Office
Building site; Map 1 of the Van Ness
Area Plan, to designate the sites of the
proposed Cathedral Hill Campus Hospi-
tal and Cathedral Hill Campus Medical
Office Building as the Van Ness Medical
Use Subdistrict and increase the floor
area ratio to 7.5:1 for the Cathedral Hill
Campus Medical Office Building site;
and Map 2 of the Van Ness Area Plan,
to create a 230-V height/bulk district co-
terminous with the Hospital site; and
adopting findings, including environ-
mental findings, Planning Code, Section
340, findings, and findings of consis-
tency with the General Plan and the pri-
ority policies of Planning Code, Section
101.1.



130510:Ordinance amending the General Plan, Map 4 of the Urban Design Element, to increase the height limit for the California Pacific Medical Center's St. Luke's Campus, Assessor's Block No. 6575, Lot No. 001-002, and Block No. 6576, Lot 021, and the portion of San Jose Avenue between Cesar Chavez Street and Twenty Seventh Street to 145 feet for a portion of the St. Luke's Campus Hospital site where the hospital tower will be located, and 105 feet for the balance of the Campus; and Map 5 of the Urban Design Element, to reflect the proposed maximum plan dimensions and maximum diagonal plan dimensions of 229 feet and 285 feet, respectively, for the St. Luke's Campus Hospital site and 204 feet and 228 feet, respectively, for the St. Luke's Medical Office Building site; and adopting findings, including environmental findings, Section 340, findings, and findings of consistency with the General Plan and the priority policies of Planning Code, Section 101.1.

In accordance with Section 67.7-1 of the San Francisco Administrative Code, persons who are unable to attend the hearing on this matter may submit written comments to the City prior to the time the hearing begins. These comments will be made a part of the official public record in this matter, and shall be brought to the attention of the Members of the Committee. Written comments should be addressed to Angela Calvillo, Clerk of the Board, Room 244, City Hall, 1 Dr. Carlton Goodlett Place, San Francisco, CA 94102. Information relating to this matter is available in the Office of the Clerk of the Board and agenda information relating to this matter will be available for public review on Friday, June 14, 2013.

Angela Calvillo, Clerk of the Board

BOARD of SUPERVISORS

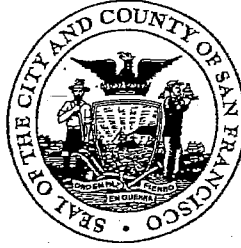

City Hall
1 Dr. Carlton B. Goodlett Place, Room 244
San Francisco 94102-4689
Tel. No. 554-5184
Fax No. 554-5163
TDD/TTY No. 544-5227

PROOF OF MAILING

Legislative File Nos. 120357, 120358, 120359, 120360, 120361, 120362, 120363,
120364, 120365, 120366, 130508, 130509, 130510

Description of Items: California Pacific Medical Center (CPMC) Legislation Package

- 120357 Planning Code - Maximum Floor Area Ratios - Van Ness Medical Use Subdistrict Within the Van Ness Special Use District - California Pacific Medical Center: Cathedral Hill Campus
- 120358 Planning Code - Maximum Permitted Floor Area Ratio - Cesar Chavez/Valencia Streets Medical Use Special Use District - California Pacific Medical Center: St. Luke's Campus
- 120359 Zoning Map - California Pacific Medical Center: Cathedral Hill Campus
- 120360 Zoning Map - California Pacific Medical Center: St. Luke's Campus
- 120361 Summary Street Vacation - Portion of San Jose Avenue Between 27th Street and Cesar Chavez Street - California Pacific Medical Center: St. Luke's Campus
- 120362 Street Encroachments - Van Ness Avenue, Cedar Street, and Geary Boulevard - California Pacific Medical Center: Cathedral Hill Campus
- 120363 Land Transfer Agreement - Sale of a Portion of San Jose Avenue Between 27th Street and Cesar Chavez Street - Sutter West Bay Hospitals - California Pacific Medical Center: St. Luke's Campus
- 120364 Changing the Official Sidewalk Widths - Portions of Post Street, Geary Boulevard, Geary Street, Cedar Street, Franklin Street, and Van Ness Avenue - California Pacific Medical Center: Cathedral Hill Campus
- 120365 Changing the Official Sidewalk Widths - Portions of Cesar Chavez Street, Valencia Street and 27th Street - California Pacific Medical Center: St. Luke's Campus
- 120366 Development Agreement - Sutter West Bay Hospitals - California Pacific Medical Center
- 130508 General Plan - Van Ness Area Plan - California Pacific Medical Center - Cathedral Hill Campus
- 130509 General Plan Maps - Urban Design Element and Van Ness Area Plan - California Pacific Medical Center - Cathedral Hill Campus
- 130510 General Plan Maps - Urban Design Element - California Pacific Medical Center's St. Luke's Campus

I, JAMES RAUNH, an employee of the City and County of San Francisco, mailed the above described document(s) by depositing the sealed items with the United States Postal Service (USPS) with the postage fully prepaid as follows:

Date: 6/7/13

Time: 6:00 PM

USPS Location: 1300 EVANS AVE SF CA 94188

Mailbox/Mailslot Pick-Up Times (if applicable): _____

Signature:

Instructions: Upon completion, original must be filed in the above referenced file.

Complete Mailing List

for

**California Pacific Medical Center Long
Range Development Plan**

Public Hearing Notice

can be found in

File No. 120357

