



DEPARTMENT OF
HOMELESSNESS AND
SUPPORTIVE HOUSING

33 GOUGH STREET UPPER MARKET SAFE NAVIGATION CENTER

BUDGET & FINANCE COMMITTEE

FEBRUARY 26, 2020

- ▶ San Francisco and The Bay Area are in the midst of a **housing affordability crisis**
- ▶ The unsheltered population has increased 19%
- ▶ Over 8,000 people experience homelessness in San Francisco on any give night, over 5,000 people live unsheltered
- ▶ Nearly 1,000 people on the shelter waiting list

- ▶ The proposed Upper Market SAFE Navigation Center:
 - ▶ Approximately 200 beds
 - ▶ Run by a non-profit provider
 - ▶ Expanded intake hours and enhanced medical services onsite
 - ▶ 24/7 access, referral only no walk-ins
 - ▶ Good Neighbor Policy
 - ▶ Allows for partners, pets and property
 - ▶ Congregate space separate from sleeping areas

HSH's Community Engagement Process Included:

- ▶ Small neighborhood stakeholder meeting
- ▶ Mailed written notice and information posted on HSH website
- ▶ Two large community input forums
 - ▶ January 27, 2020
 - ▶ February 10, 2020
- ▶ Community commitments moving forwards

SITE DESIGN – GOUGH STREET ENTRANCE

Modular
restroom facilities

Containers for
client storage



Pedestrian
entrance

Vehicle
entrance

SITE DESIGN – UPPER LEVEL FLOOR PLAN

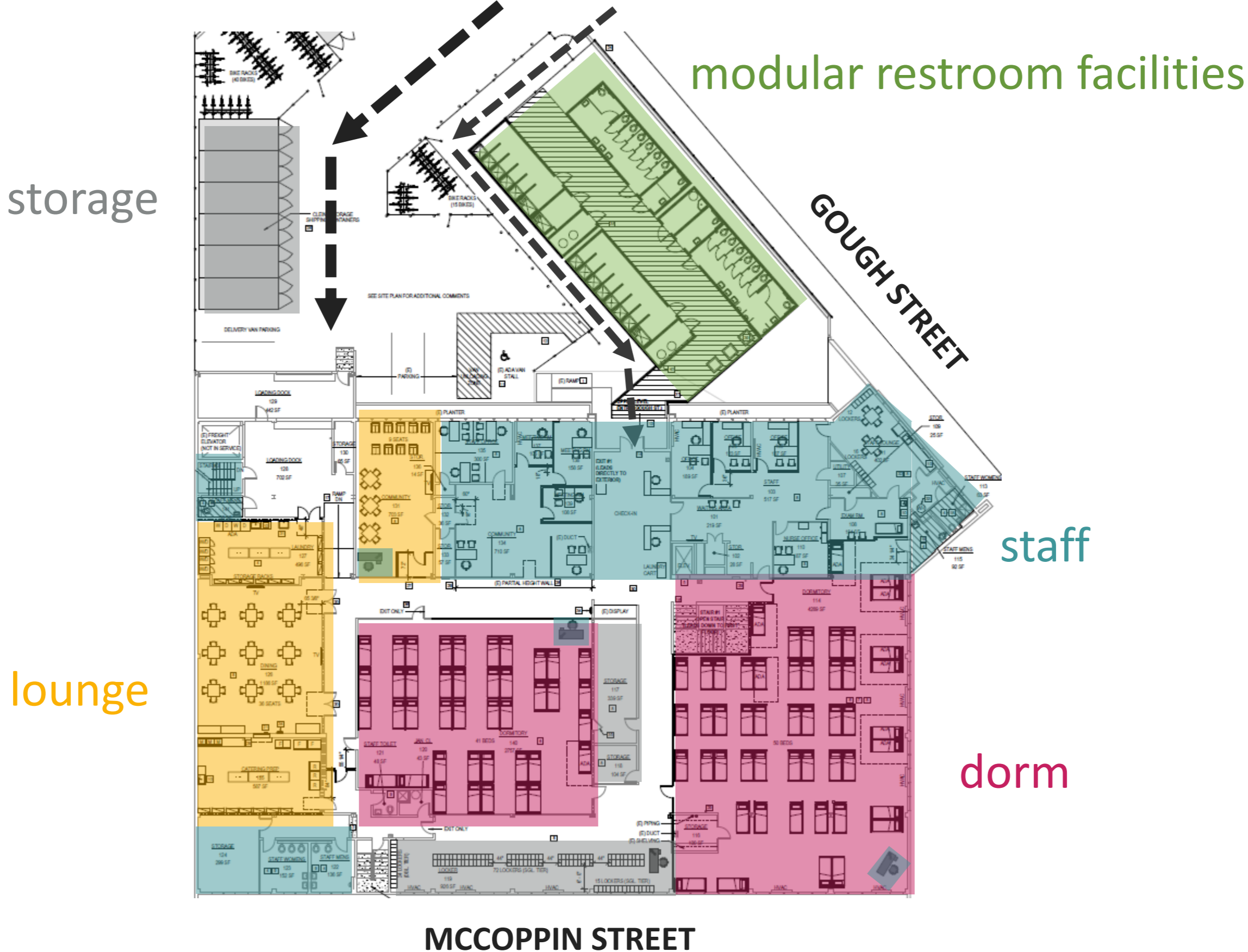

SITE DESIGN – MCCOPPIN STREET LOWER LOT

Client outdoor space

Emergency exit



Modular restroom facilities

SITE DESIGN – LOWER LEVEL FLOOR PLAN



- ▶ 49,000 sq. ft. building plus two adj. parking lots
- ▶ 36 months (month to month thereafter)
- ▶ \$104,942 per month (\$1.2593M per year)
 - ▶ \$25.70 per sq. ft. per year
 - ▶ NNN structure
 - ▶ Fixed rate (no escalation)
 - ▶ One month free rent

THANK YOU



DEPARTMENT OF
HOMELESSNESS AND
SUPPORTIVE HOUSING